

Contract NAS5-21796, Type II, March 1973

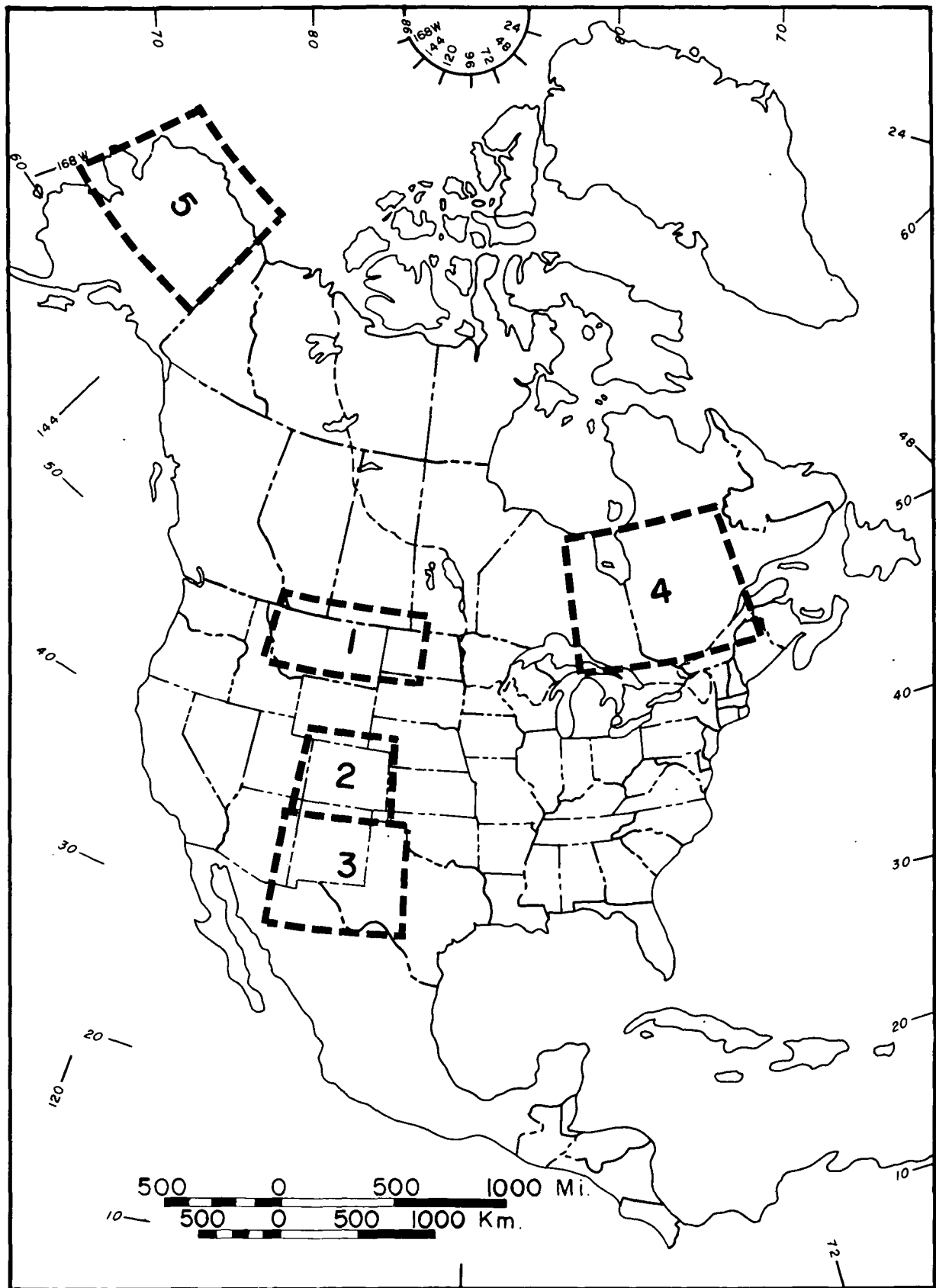

Figure 1: ERTS Study Area - Investigation 181

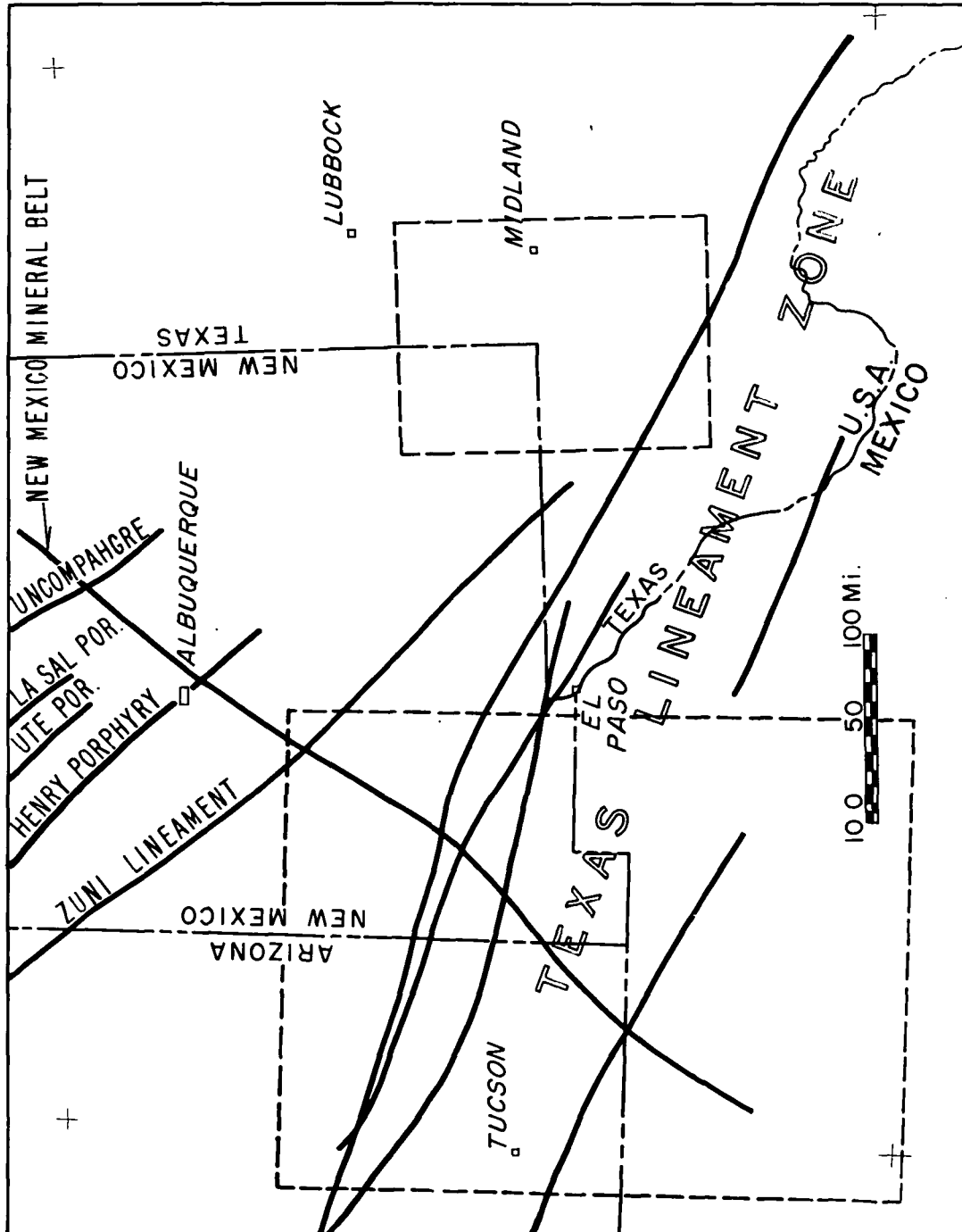

Figure 2: Arizona, New Mexico, Texas and Mexico Area - Published Lineaments

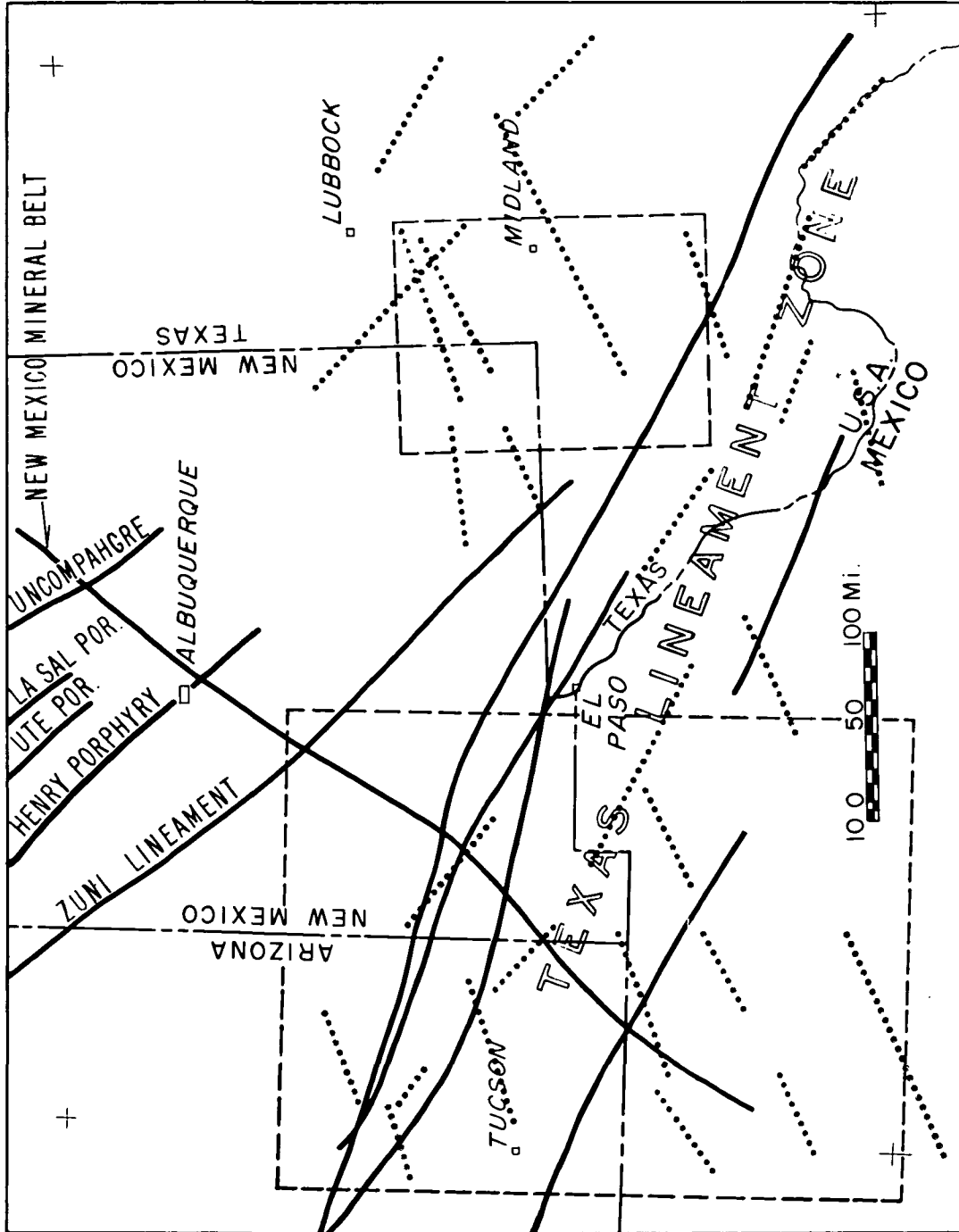

Figure 3: Published Lineaments and New ERTS-I Lineaments (dotted lines). Local areas (dashed lines) are discussed in more detail.

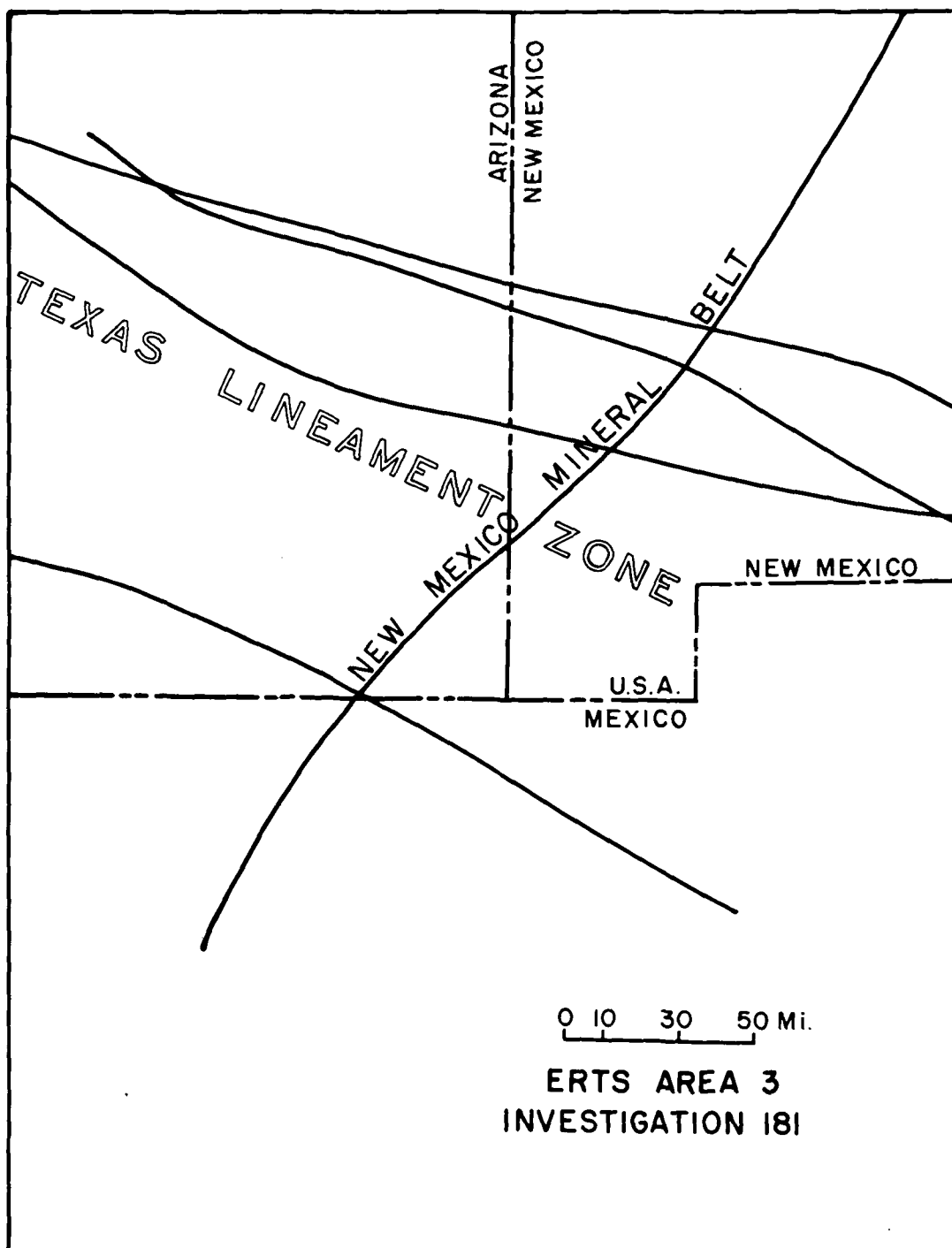

Figure 4: Arizona, New Mexico, Mexico - Published Lineaments

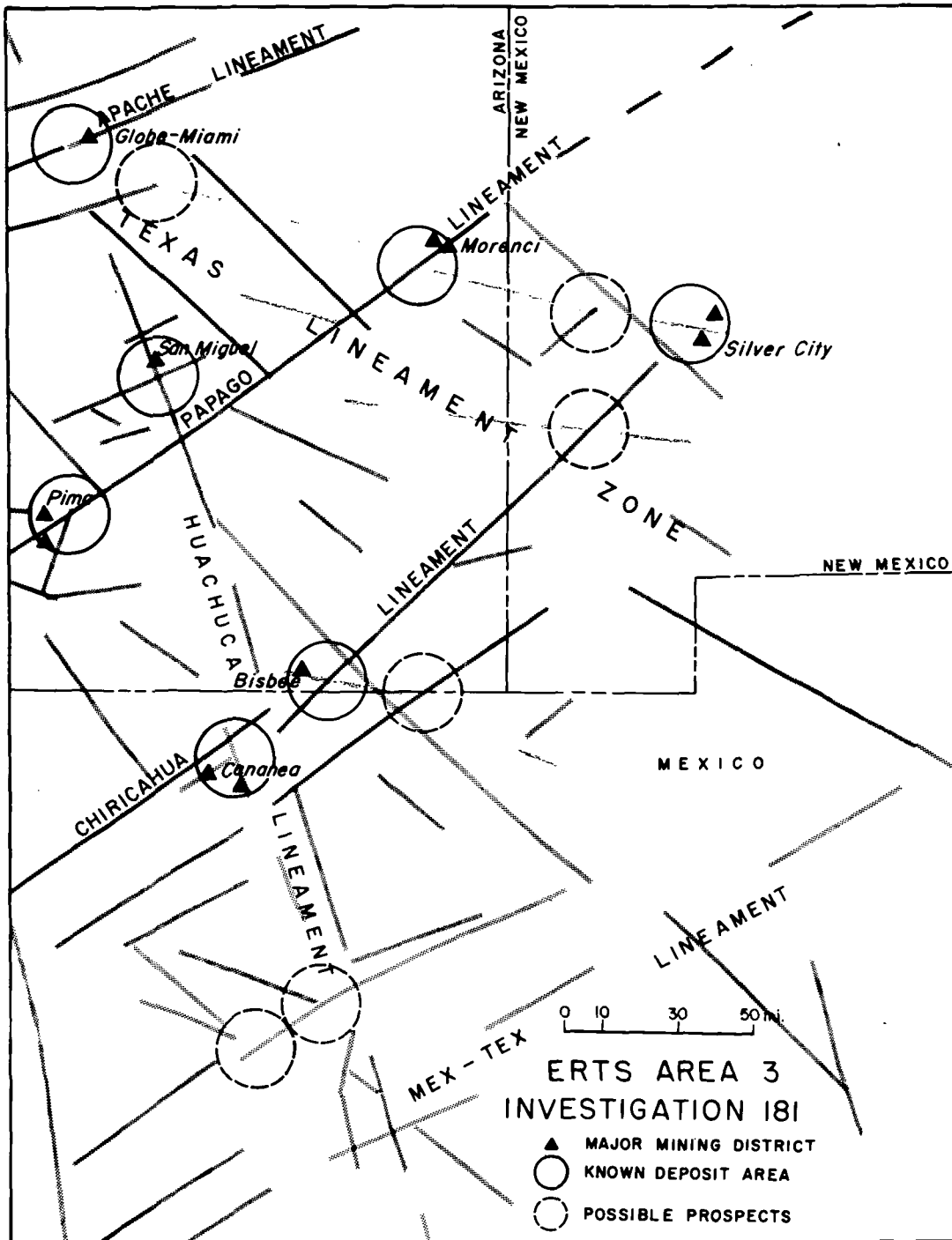

Figure 5: Arizona, New Mexico, Mexico - New ERTS Lineaments and Major Mining Districts

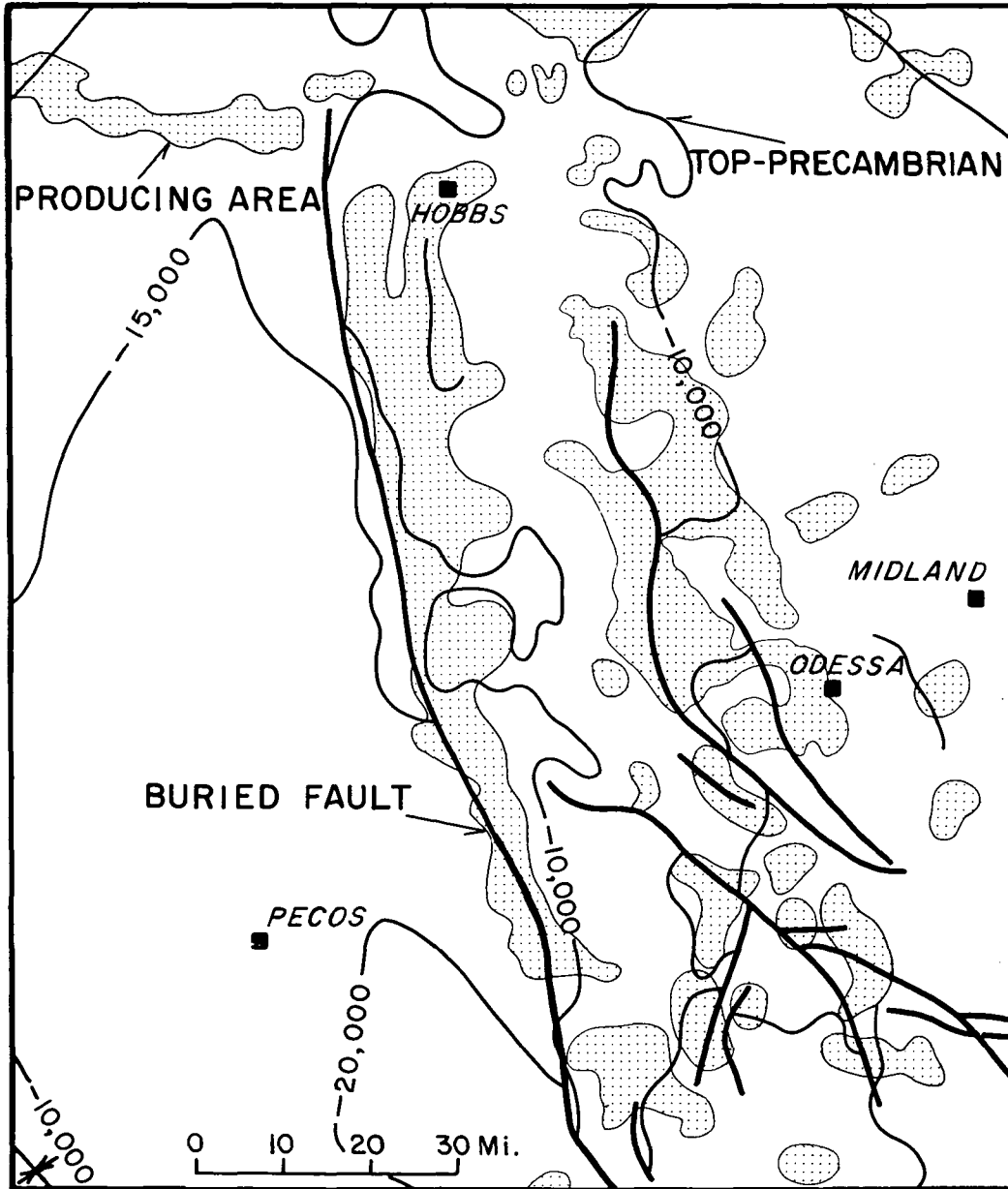

Figure 6: Central Basin Platform, West Texas -  
Known Features

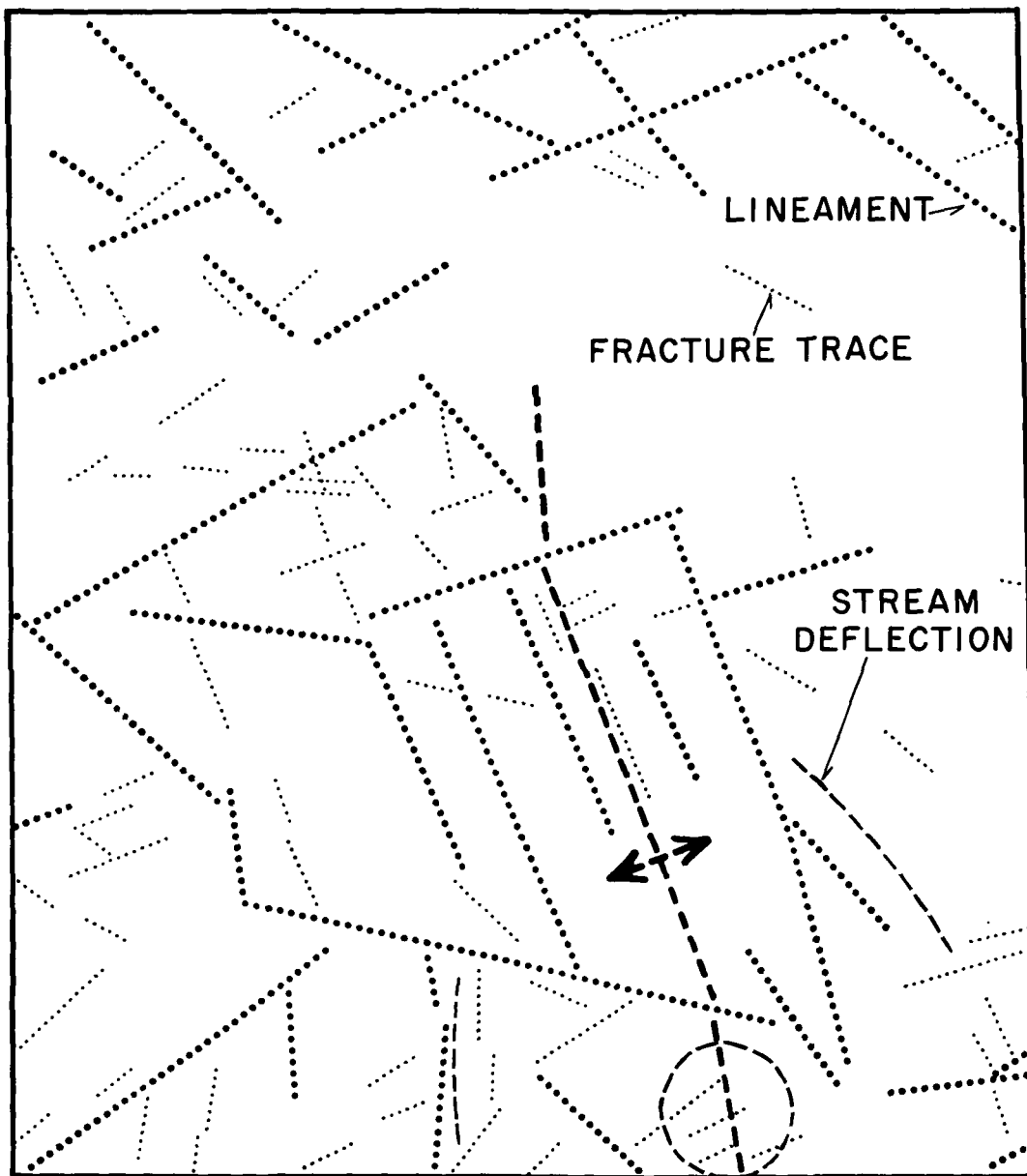

Figure 7: Central Basin Platform, West Texas -  
New ERTS Data

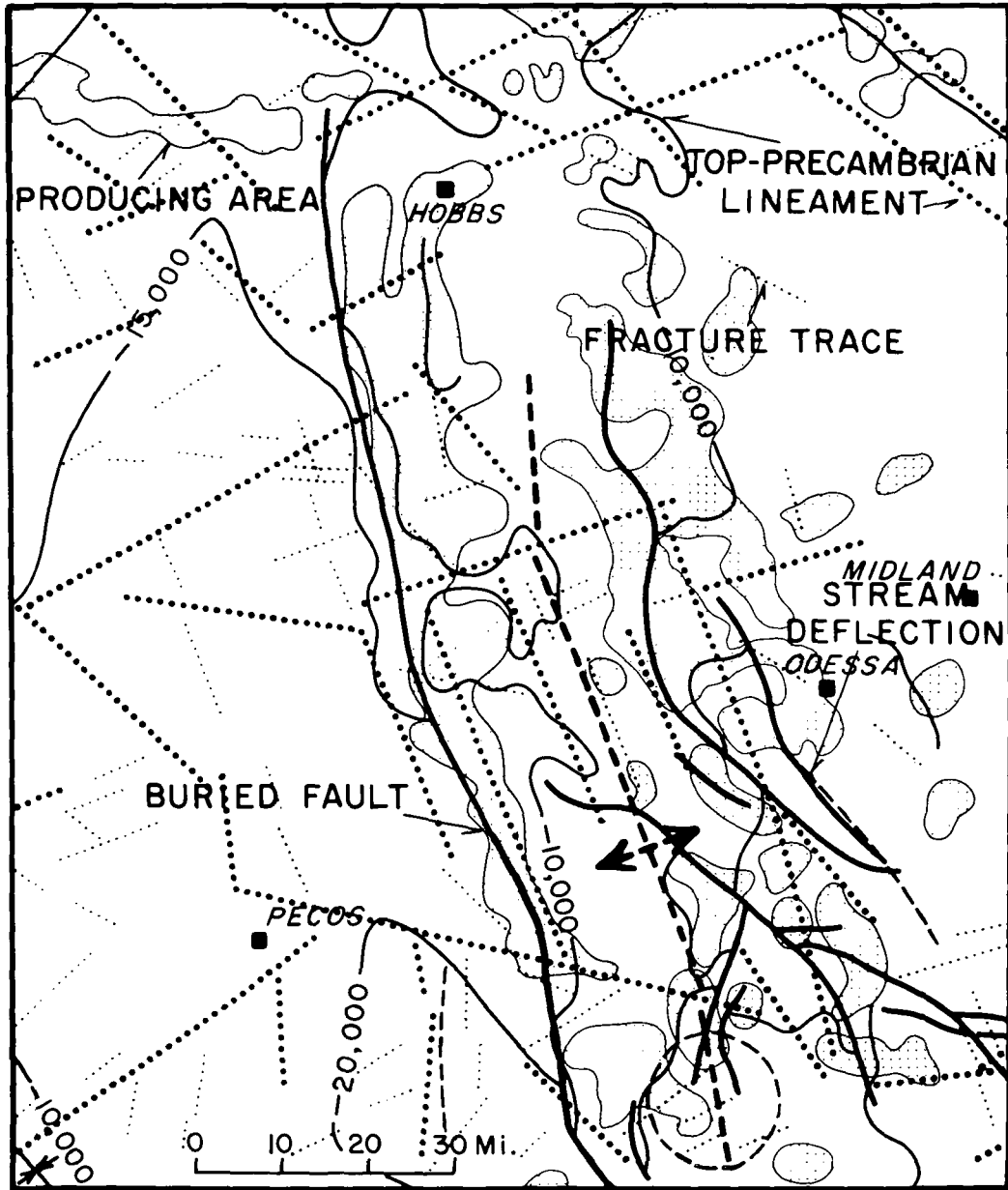

Figure 8: Central Basin Platform, West Texas -  
Known Features and New ERTS Data





Contract NAS5-21796, Type II, March 1973

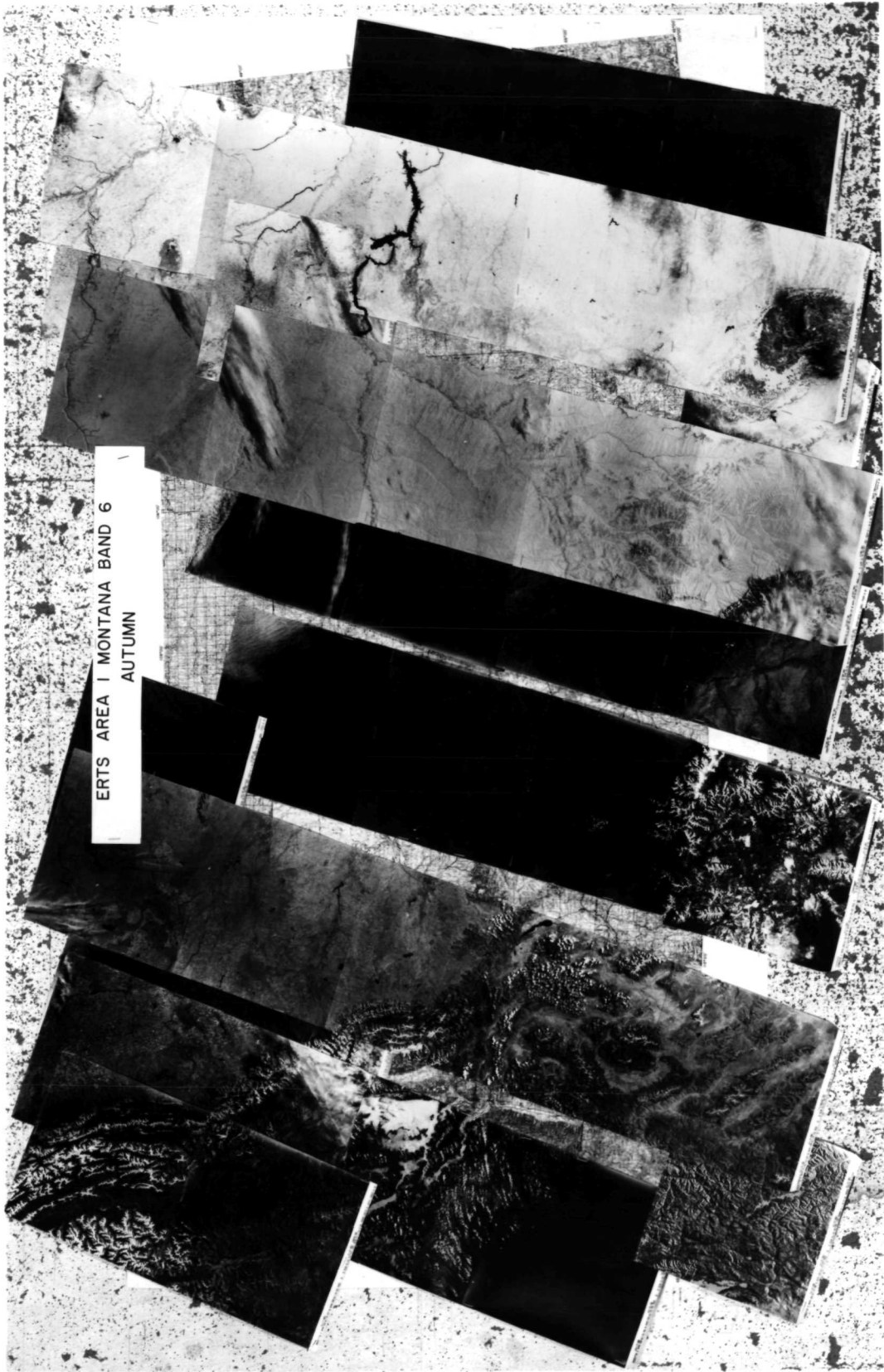

Figure 9. Area 1 Mosaic Status, February, 1973



Contract NAS5-21796, Type II, March 1973

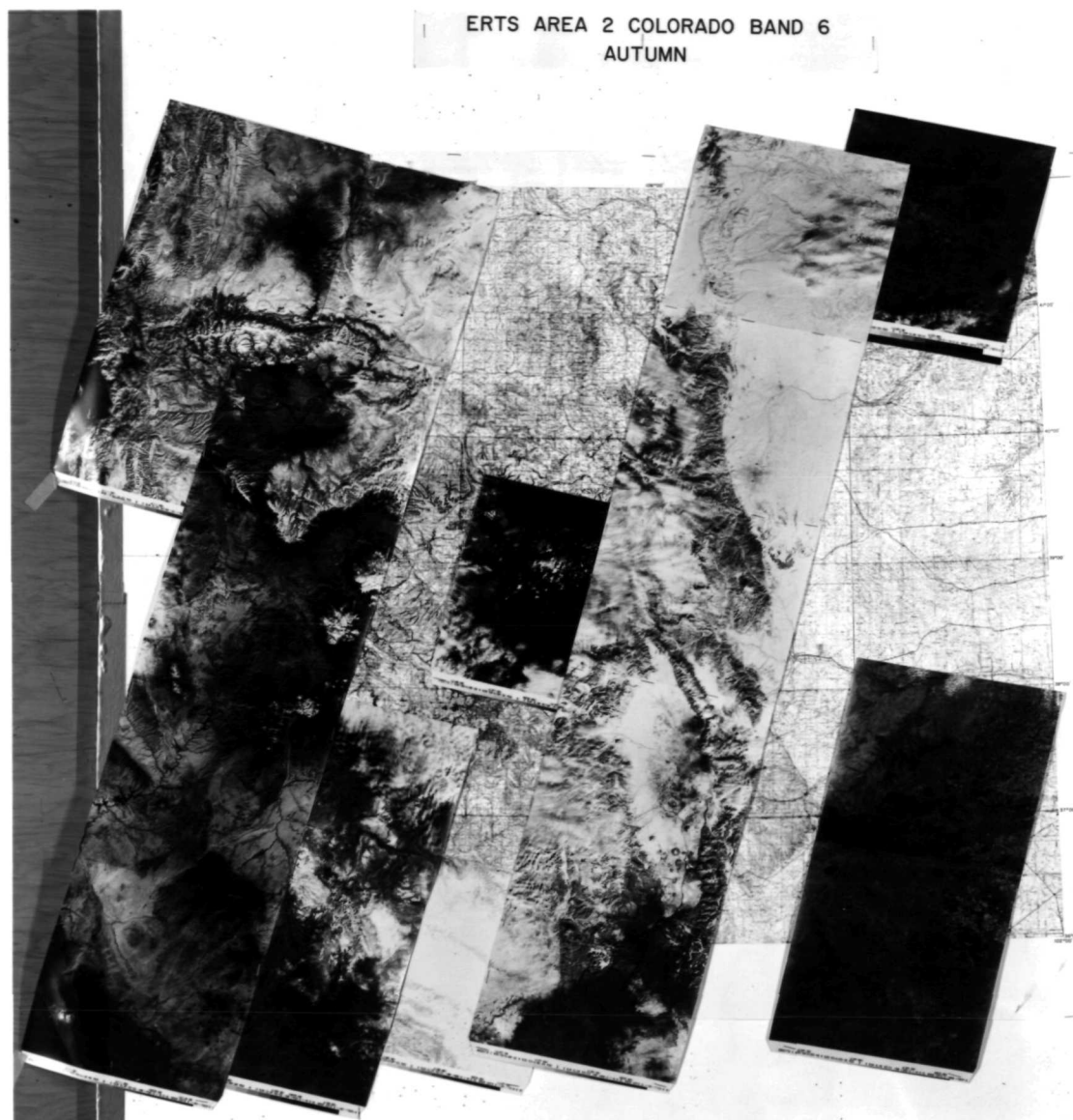

Figure 10. Area 2 Mosaic Status, February, 1973



Contract NAS5-21796, Type II, March 1973



Figure 11. Area 3 Mosaic Status, February, 1973



Contract NAS5-21796, Type II, March 1973



ERTS AREA 4 SUPERIOR PROVINCE BAND 6  
AUTUMN

Figure 12. Area 4 Mosaic Status, February, 1973



Contract NAS5-21796, Type II, March 1973



Figure 13. Area 5 Mosaic Status, February, 1973