



University of HUDDERSFIELD

University of Huddersfield Repository

Kaye, Vicky

Meeting Educational requirements for a Community Matron/Case Management role from a HEI's perspective

Original Citation

Kaye, Vicky (2007) Meeting Educational requirements for a Community Matron/Case Management role from a HEI's perspective. In: Community Matrons 2007: Delivering a New Generation of Health Care Delivery, 14 September 2007, New Century House, Manchester. (Unpublished)

This version is available at <http://eprints.hud.ac.uk/5743/>

The University Repository is a digital collection of the research output of the University, available on Open Access. Copyright and Moral Rights for the items on this site are retained by the individual author and/or other copyright owners. Users may access full items free of charge; copies of full text items generally can be reproduced, displayed or performed and given to third parties in any format or medium for personal research or study, educational or not-for-profit purposes without prior permission or charge, provided:

- The authors, title and full bibliographic details is credited in any copy;
- A hyperlink and/or URL is included for the original metadata page; and
- The content is not changed in any way.

For more information, including our policy and submission procedure, please contact the Repository Team at: E.mailbox@hud.ac.uk.

<http://eprints.hud.ac.uk/>

COMMUNITY MATRONS

DELIVERING A NEW GENERATION OF HEALTHCARE

www.communitymatrons.co.uk

Friday 14 September 2007
New Century House, Corporation Street
Manchester

Exhibition and Sponsorship Prospectus

**“Long-term conditions will be the leading cause
of disability by 2020” WHO**

“In the UK there are currently more than 17.5 million people living with chronic conditions such as diabetes, arthritis and heart failure ... there are estimated to be approx 1,500 community matrons currently working in the NHS ... and by March next year, 220,000 of the most needy patients will be getting support and care in their homes from 3,000 community matrons and other case managers ...”

**Patricia Hewitt MP
Secretary of State for Health
May 2007**

THE WORK OF COMMUNITY MATRONS is to improve the quality of life of people suffering with long term conditions (LTCs). Both a consequence of and a means of achieving this objective is reducing the number of times people with LTCs need to be admitted to hospital and when hospital admission is necessitated, to then reduce the length of stay required. While these two outcomes are very significant, and not only for the financial savings attributed to them, they are but two indicators among a great many other indicators of how improvements to the quality of life manifest.

COMMUNITY MATRONS 2007 brings together these autonomous practitioners in a forum that will share examples of best practice and innovation. Presentations reflect all areas that are key to the fully functioning community matron role. These range from preparation for the community matron role, dynamic case management models, IT solutions, managing risk through to supporting community matrons in practice.

COMMUNITY MATRONS

DELIVERING A NEW GENERATION OF HEALTHCARE

www.communitymatrons.co.uk

This conference is organised by Health Networks whose aim is to deliver quality conference programmes with a focus on shared learning and a strong emphasis on delegate exchange and debate.

Friday 14 September 2007
New Century House, Corporation Street
Manchester

THE PROGRAMME WILL INCLUDE :

- Keynote speech from Maureen Morgan, Professional Officer for Policy and Practice, DOH
- The challenges and opportunities of bridging new frontiers: crossing boundaries within and out with healthcare and across private, public and voluntary sectors
- IT models that are offering solutions in areas of planning, co-ordination and delivery of care and in measuring outcomes
- The Risk Management Framework: Independence, Choice and Risk (DOH May 2007) and the guidance and support it offers community matrons
- The rewards, challenges and aspirations of community matrons (and much more) as reported in the Community Matrons Online Survey 2007

THE DELEGATES

This conference will be attended by key stakeholders in healthcare including:

- Community Matrons
- LTCs Leads and Managers
- Case Managers
- Heads of Nursing
- Advanced Practitioners
- Healthcare Planners and Commissioners
- Educationalists
- Service Users

KEYNOTE SPEAKER

Maureen Morgan

Professional Officer for Policy & Practice
Department of Health

CHAIR

Chris Mullen MBE

Associate Director of Workforce Strategy
NHS Northwest

SPEAKERS

Jayne Molyneux

Director of Managed Healthcare Services
CareMax International Ltd

Yvonne Fenn

Community Matron
Serco Health

Patricia Robinson

Consultant Nurse LTCs
Croydon PCT

Vicky Kaye

Senior Lecturer
University of Huddersfield

Beverley Waddell

Nurse Consultant Older People /
Active Case Management
Manchester PCT

Kim Lee

Community Matron Cardio-Respiratory Care
Eastern and Coastal PCT

Sharon Lee

Community Matron Cardio-Respiratory Care
Eastern and Coastal PCT

Hazel Price

Kent TeleHealth Project Manager
Kent County Council

Carol Godleman

Risk Framework Lead
CSIP

Professor Jean Faugier

Director
Tall Poppies Coaching and Consulting

COMMUNITY MATRONS

DELIVERING A NEW GENERATION OF HEALTHCARE

www.communitymatrons.co.uk

EXHIBITION AND SPONSORSHIP

The exhibition will contribute greatly to the benefit of the delegates. All catering (tea/coffee breaks and lunch) will be served from the exhibition area ensuring a flow of delegates throughout the day.

SPONSORSHIP OPPORTUNITIES AVAILABLE :

A	Listed as sponsor with logo on <ul style="list-style-type: none"> ○ conference programme ○ cover of conference delegate packs ○ report cover of 'Community Matrons' National Online Survey' 	£1,200
B	Logo with hyperlink displayed on the 'Supporting You' page of Community Matrons 2007 website (this includes one free delegate place)	£550
C	Promotional insert in Delegate Pack	£750
D	Exhibitors stand *	£850
E	All inclusive package (A-E)	£2,500

All prices exclude VAT

* where a wi-fi connection is required, the fee charged by the venue, will be added to the account

STANDS

- Tables provided are approximately 4'6" x 2'6" (1.4m x .8m) together with two chairs
- Access to an electrical socket is available if required
- Exhibitors may bring their own stands but width is restricted to 4'6" (1.4m)
- Catering for two stand members will be provided

PROMOTION

- Direct mailing UK-wide to all Heads of Community Services, Nursing and other interested parties
- Website promotion on www.communitymatrons.co.uk and www.health-networks.co.uk
- Electronic marketing – featuring updates on the programme, speakers and sponsors
- Actively promoting the online network forum bringing delegates together for open discussion
- We are inviting poster displays
- Copies of conference posters will be published in the Delegate's Conference Pack
- Copies of conference posters will be hosted on the Poster page of the website

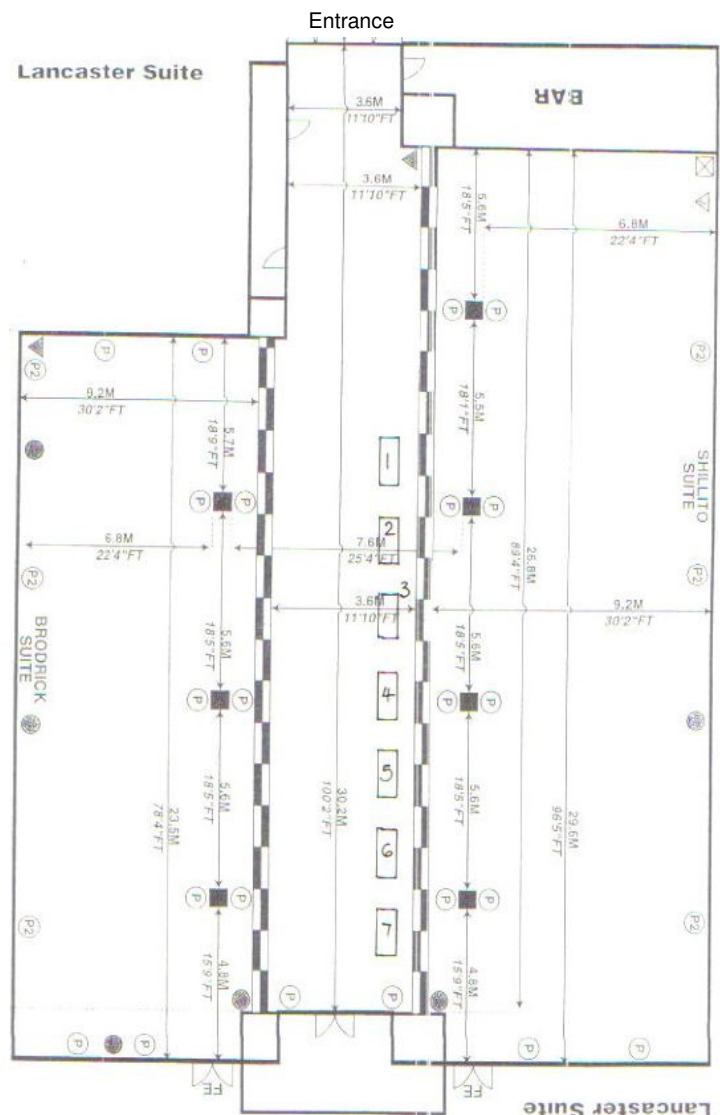

BOOKING FORM

PLEASE COMPLETE IN BLOCK CAPITALS

COMMUNITY MATRONS 2007
DELIVERING A NEW GENERATION OF HEALTHCARE

Please complete this form and return by
 Fax 020 8626 7079
 Post Health Networks, PO Box 49291, London SE9 4WN
 Email sponsors@health-networks.co.uk
 Online www.communitymatrons.co.uk/sponsors

Full Name : **PO Number :**
Job Title : **Office No :**
Company : **Mobile No :**
Address : **Fax No :**
Email :

Postcode :

We wish to exhibit at the **Community Matrons 2007** Conference

	A £1,200	B £550	C £750	D £850	E £2,500	STAND NOS 1 TO 7
MANCHESTER 14 SEPTEMBER 2007	<input type="checkbox"/>	<input type="checkbox"/>	<input type="checkbox"/>	<input type="checkbox"/>	<input type="checkbox"/>	<input type="checkbox"/>

Description of goods / services to be displayed :

Signature _____

Date _____

Please note that full payment must be received before the conference space is confirmed

Terms and Conditions

- Definitions**
‘Exhibitor’ means any company, organisation or person or any agent or representative of such company organisation or person who has made a successful application for space allocation in the conference.
- Space Bookings**
Any company, organisation or individual wishing to be an Exhibitor must complete and return the pro forma booking form. No application will be considered accepted until a signed booking form has been received by Health Networks and written acceptance of the booking has been sent by Health Networks to the Exhibitor.
- Payment Terms**
Payment is due within 30 days of the date of Health Networks’ invoice. In the case of application being made within 30 days of the conference date, payment is due with the application. Please note that without full payment prior to the conference, exhibition space will not be confirmed.
- Sharing/Subletting Space**
The Exhibitor shall not share with any other individual or organisation in whole or part of the space allocated without the prior written consent of Health Networks.
- Cancellation/Non Payment**
If the Exhibitor cancels or reduces its booking after acceptance of its application by Health Networks or fail to make payment in accordance with Clause 3 above, the Exhibitor will remain liable for payment of the total charges payable pursuant.
- Enquiries**
If you require any further information or help, please call 020 8144 2411.

Health Networks reserve the right to make changes, which are outside their control, to the programme and speakers without prior notice