

RICE UNIVERSITY  
Rice School of Architecture

**DELAYED OBJECT:** Havana's Post-Mercado  
by Melissa McDonnell

A THESIS SUBMITTED  
IN PARTIAL FULFILLMENT OF THE  
REQUIREMENTS FOR THE DEGREE

**Masters of Architecture**

APPROVED, THESIS COMMITTEE:

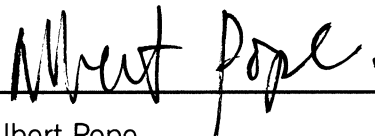

---

Albert Pope  
Gus Sessions Wortham Professor of Architecture,  
Director

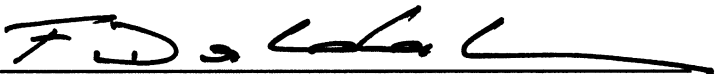

---

Farés el-Dahdah  
Associate Professor of Architecture, Critic

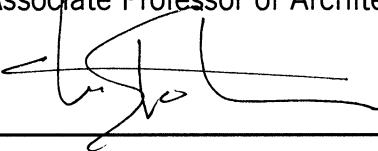

---

Christopher Hight  
Associate Professor of Architecture, Advisor

Houston, Texas  
May 2011

## ABSTRACT

This thesis seeks to produce space resistant to hegemonic ordering, as a means to reconcile co-existing histories and ideologies in Havana. The architectural proposal is a co-occupied retail field, hung above the datum of existing fabric. The field is both ground to the department store above and canopy to the market below. While the department store produces a space of endless, universal flows.

## TABLE OF CONTENTS

Project Text	4
Maps	5
Program Studies	9
Model Studies	12
Site Studies	14
Plans, Renderings, Sections	20
Exploded Axonometric	34
Model Studies	35



Havana's past has fixed the city to an architecture of colonnades, lovely but aged songs lingering in the thick, warm air and a weathered palette of colors. Its future is also fixed. A city suspended in time, post-revolution Havana suggests a return to the Batista days of Caribbean Las Vegas, with an American ruling class and vacation-packaged nostalgia. But rather than existing according to the binary code of the classic and grotesque, Havana has the ability to produce another kind of spatial condition. This condition could resemble the heterotopia Michel Foucault described – a singular, real space, which juxtaposes different spaces and locations that are incompatible with each other.

This thesis seeks to produce space resistant to hegemonic ordering, as a means to reconcile co-existing histories and ideologies in Havana. A Post-Mercado site is one that allows seemingly incompatible economic systems, which produce objects of necessity and objects of luxury. Raul Castro's Economic Guidelines, issued this past November, will create a new scale of local wholesale and co-op distribution to supply the burgeoning, privatized industry. At the same time, the reforms will affect the large economic scale of foreign investment and retailers. The presence of both economic scales, results in a territory of resistance. The former requires the development of new territory within the existing colonial city fabric, while the latter requires a registration of a discrete new ground.

The architectural proposal is a co-occupied retail field, hung above the datum of existing fabric. The field is both ground to the department store above and canopy to the market below. While the department store produces a space of endless, universal flows. The market resists homogenous coalescence through the local order of fabric. Co-habitation uses simultaneity as a means to resist totalizing, singular structures, while producing new territories for occupying the city and exchanging material objects.

# HAVANA STREET MAP

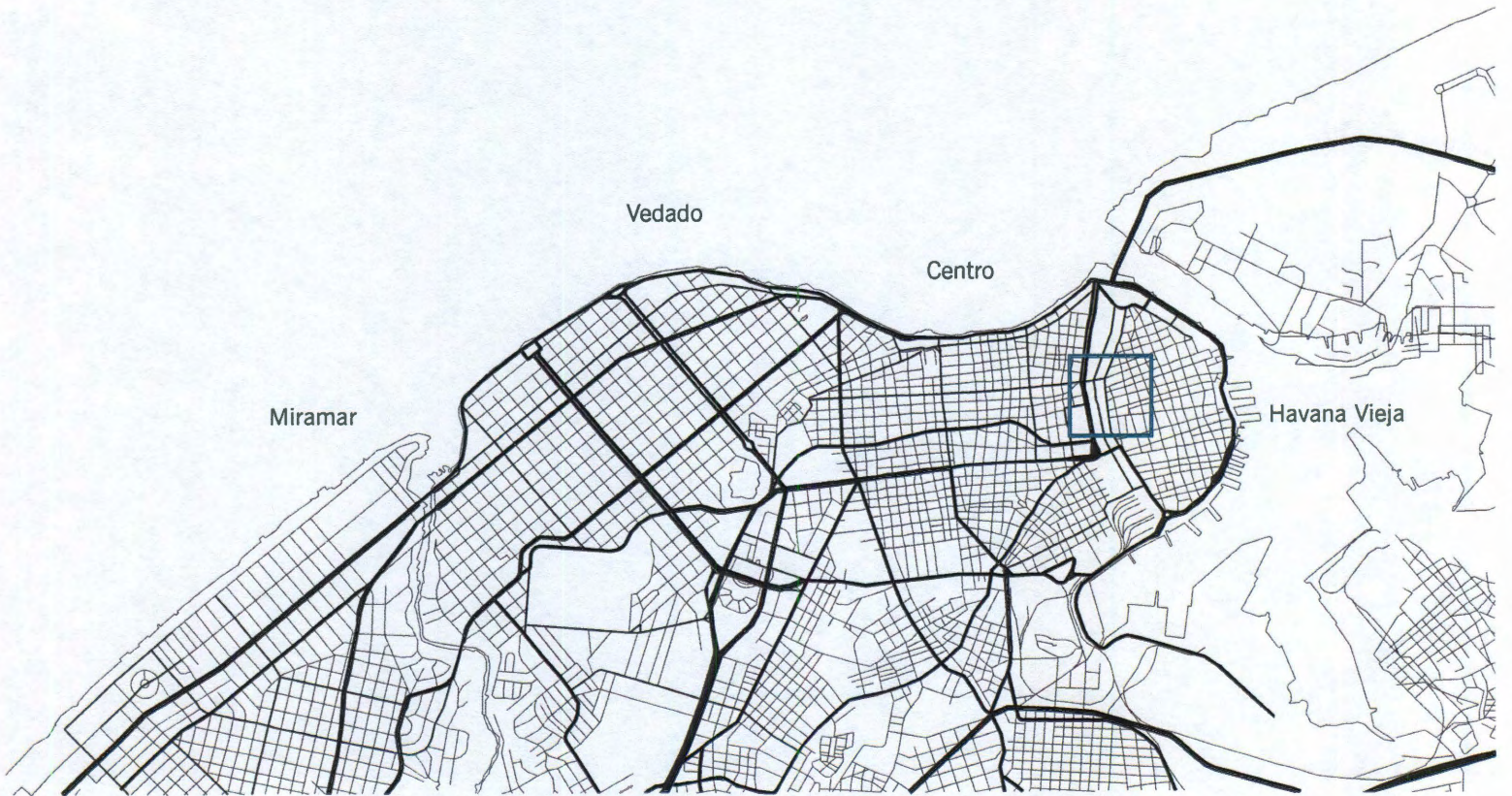

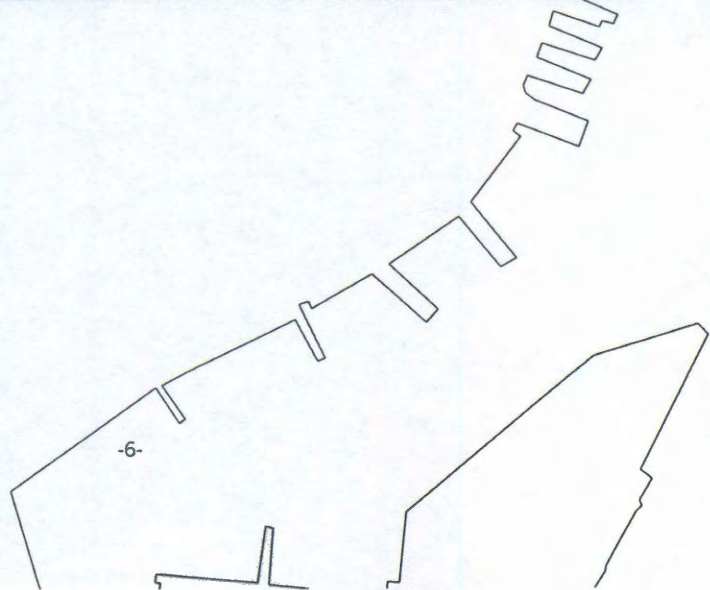

# HAVANA'S BUILDING FABRIC

Havana has been managing growth within the city through small scale operations of renovation and restoration. Larger master plans proposing to deflate the block through large scale venacular cuts out, have never reached the implimentation stage

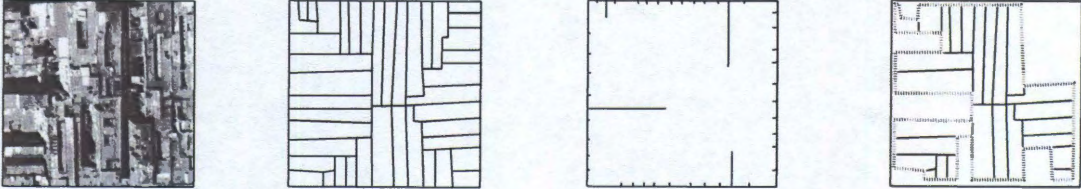

Historical Restoration- facade is restored, while interior remains or is completely removed

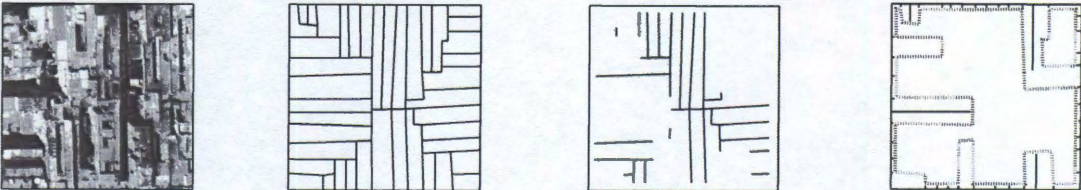

Local Renovation- internal organization is shifted through renovation with no visable sign on the facade

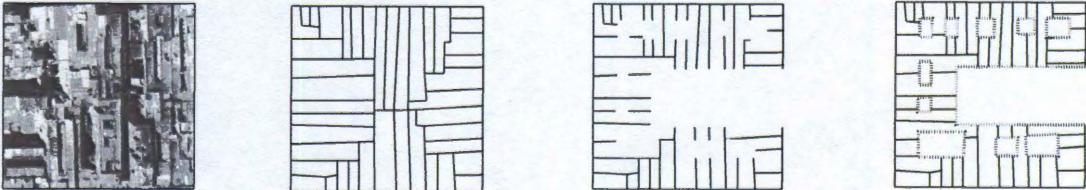

Sert's 1958 Master Plan- deflate block through patio insertion

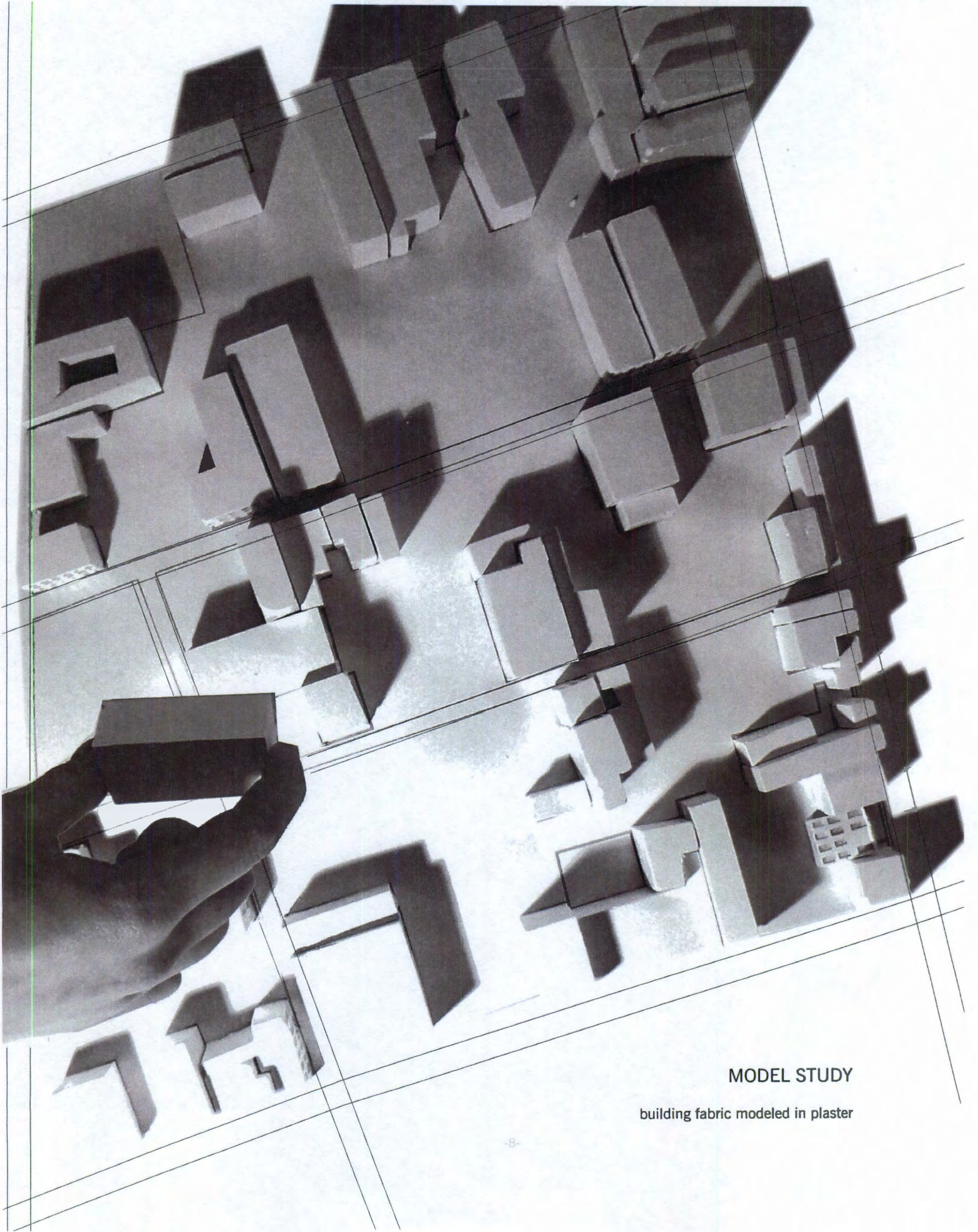

**MODEL STUDY**

building fabric modeled in plaster



PROGRAM STUDY

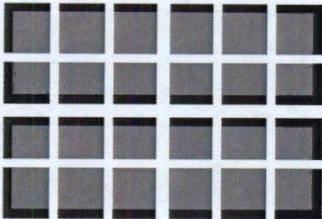

plan



section

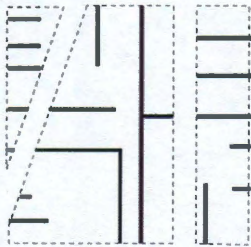

projective plan

Centralized Market- Les Halles -  
the market maintains the street

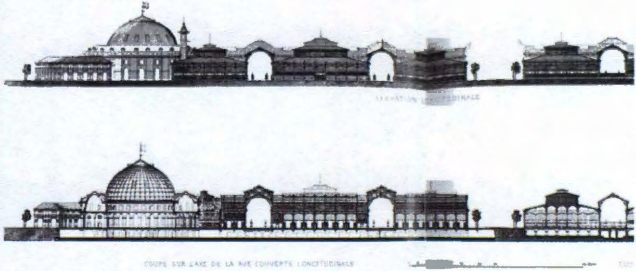
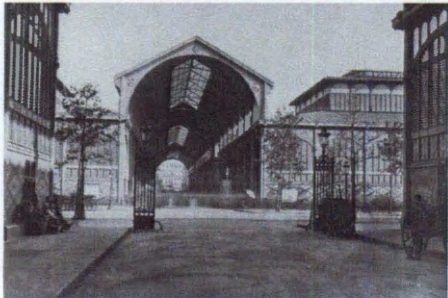

PROGRAM STUDY

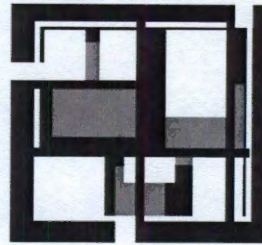

plan

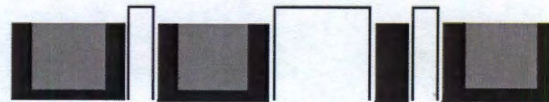

section

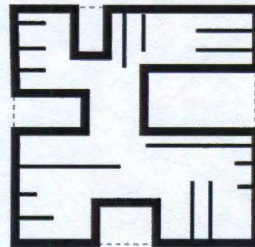

projective plan

Department Store- Au Bon Marche  
the market internalizes the street, disorientates shopper

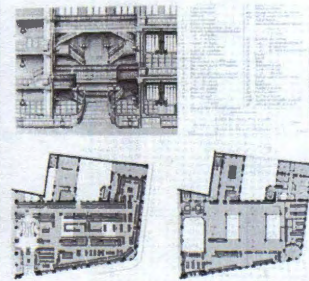
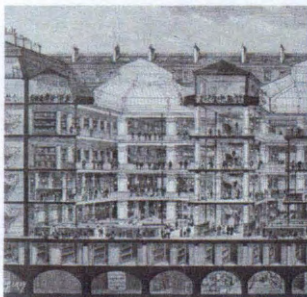

PROGRAM STUDY

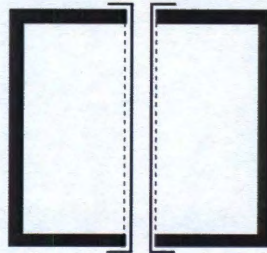

plan



section

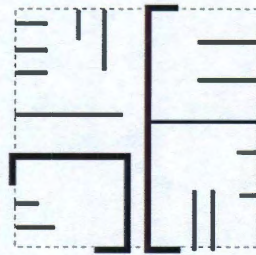

projective plan

Street Market- The Arcades - the market is the street



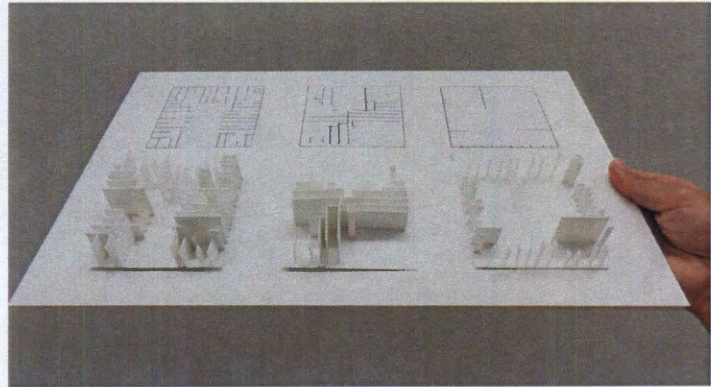
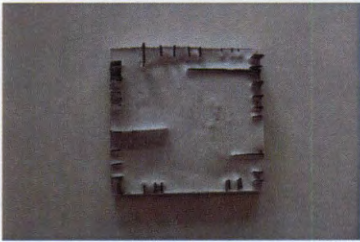
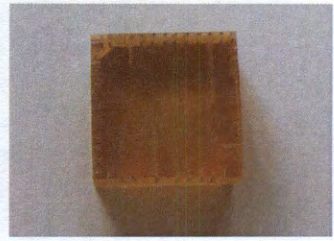
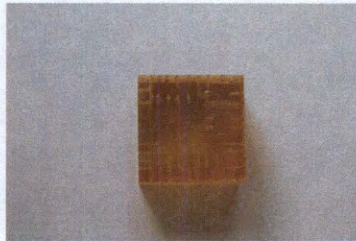
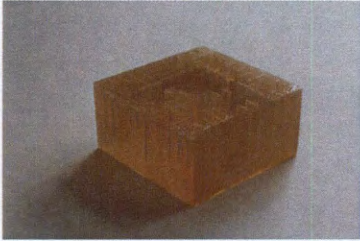
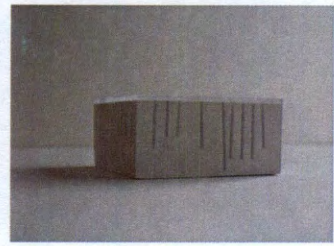
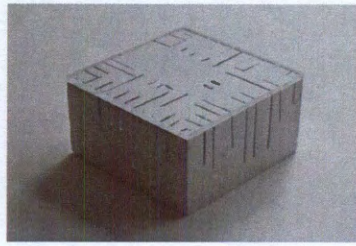
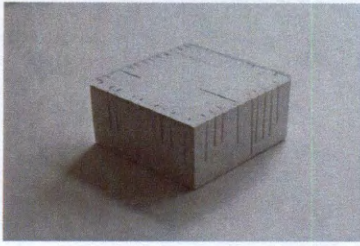

### MODEL STUDY

building fabric modeled in  
plaster, resin, acrylic

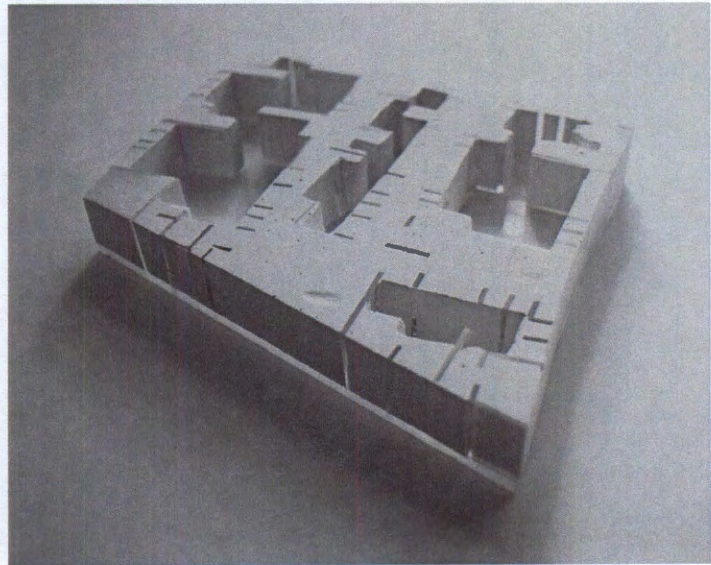
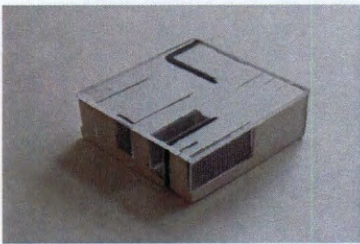

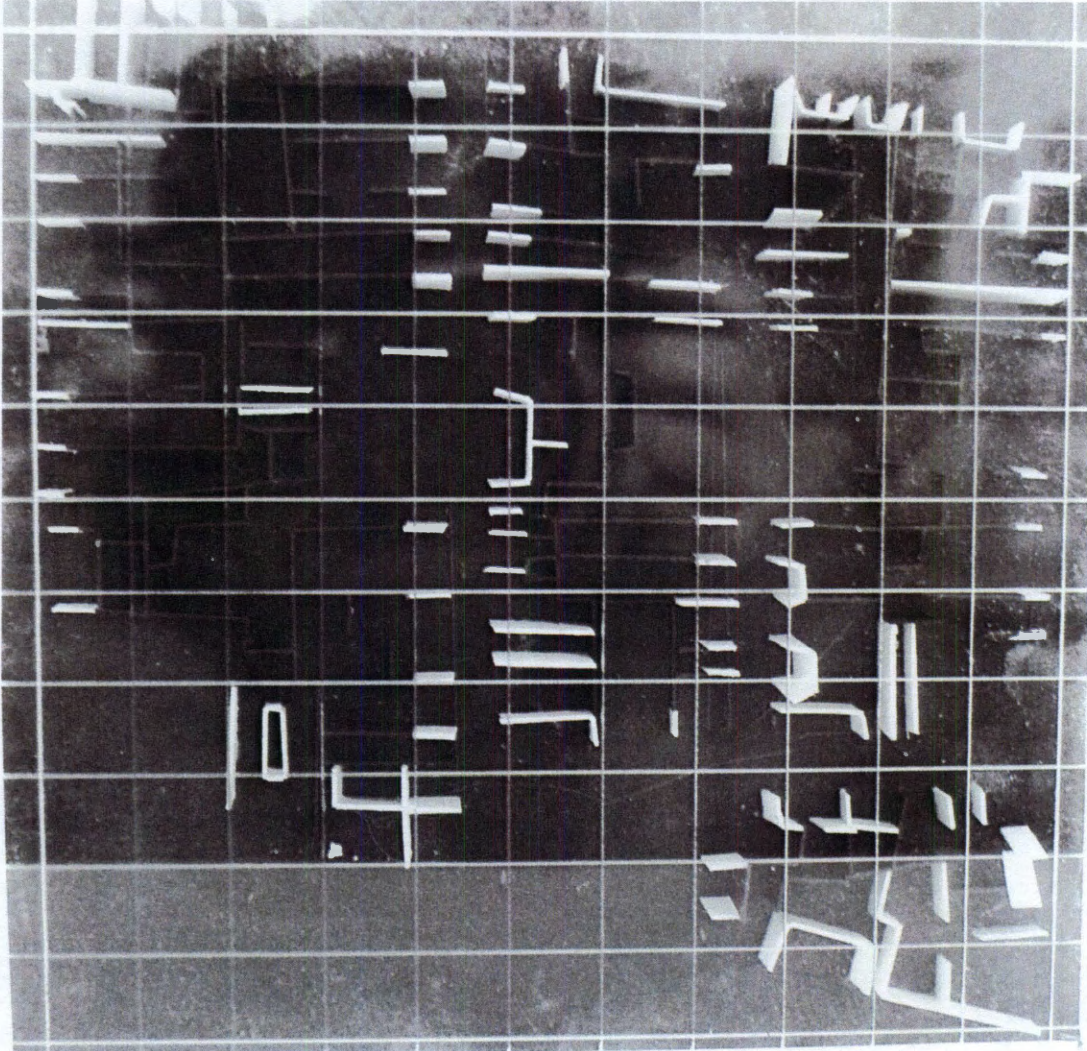

## MODEL STUDY

building fabric modeled in paper, acrylic

OCCUPATION OF GROUND



Symbiotic lift

canopy on Obispo street

the modern dwelling built on the colonial factory receives ocean views and breezes and has minimal visibility from the street

the modern building uses piloti to free the ground plane and accelerate air flow in Cubas hot, humid climate



## TERRITORIALIZATION OF GROUND

universal grid according to Laws of the Indies 1573 with ideal block size

grid begins at Plaza de Armas- the entry to Havana

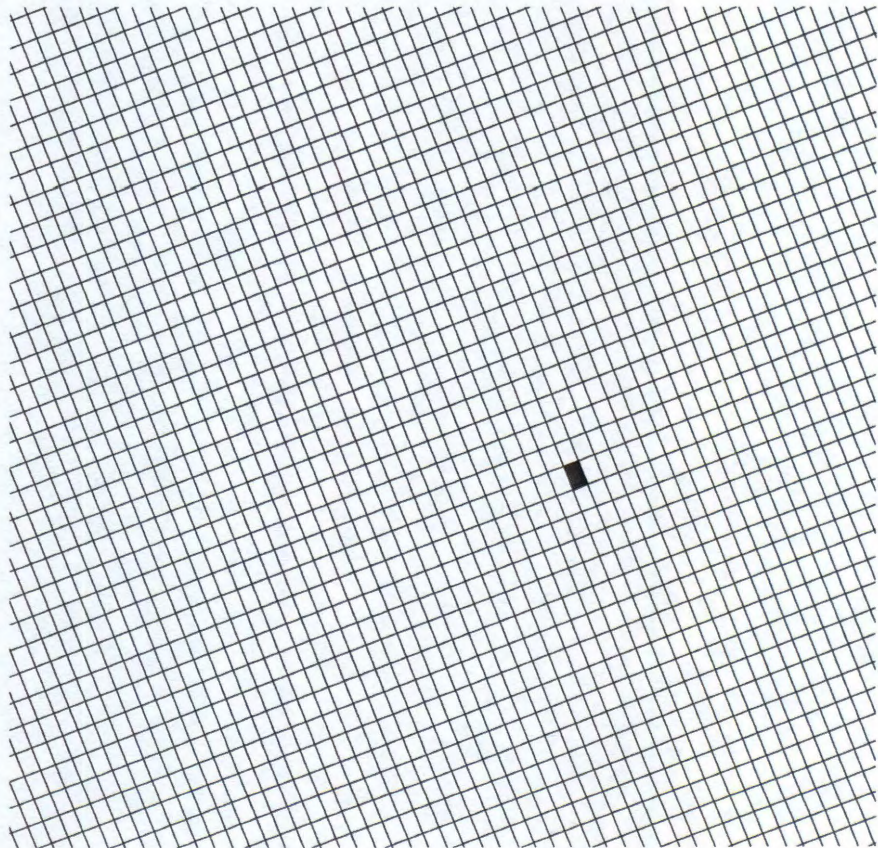
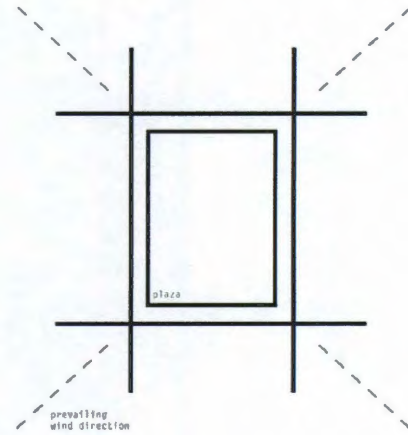

-  restoration
-  historical market/ plaza
-  contemporary markets
-  site
-  central district
-  historical shopping streets

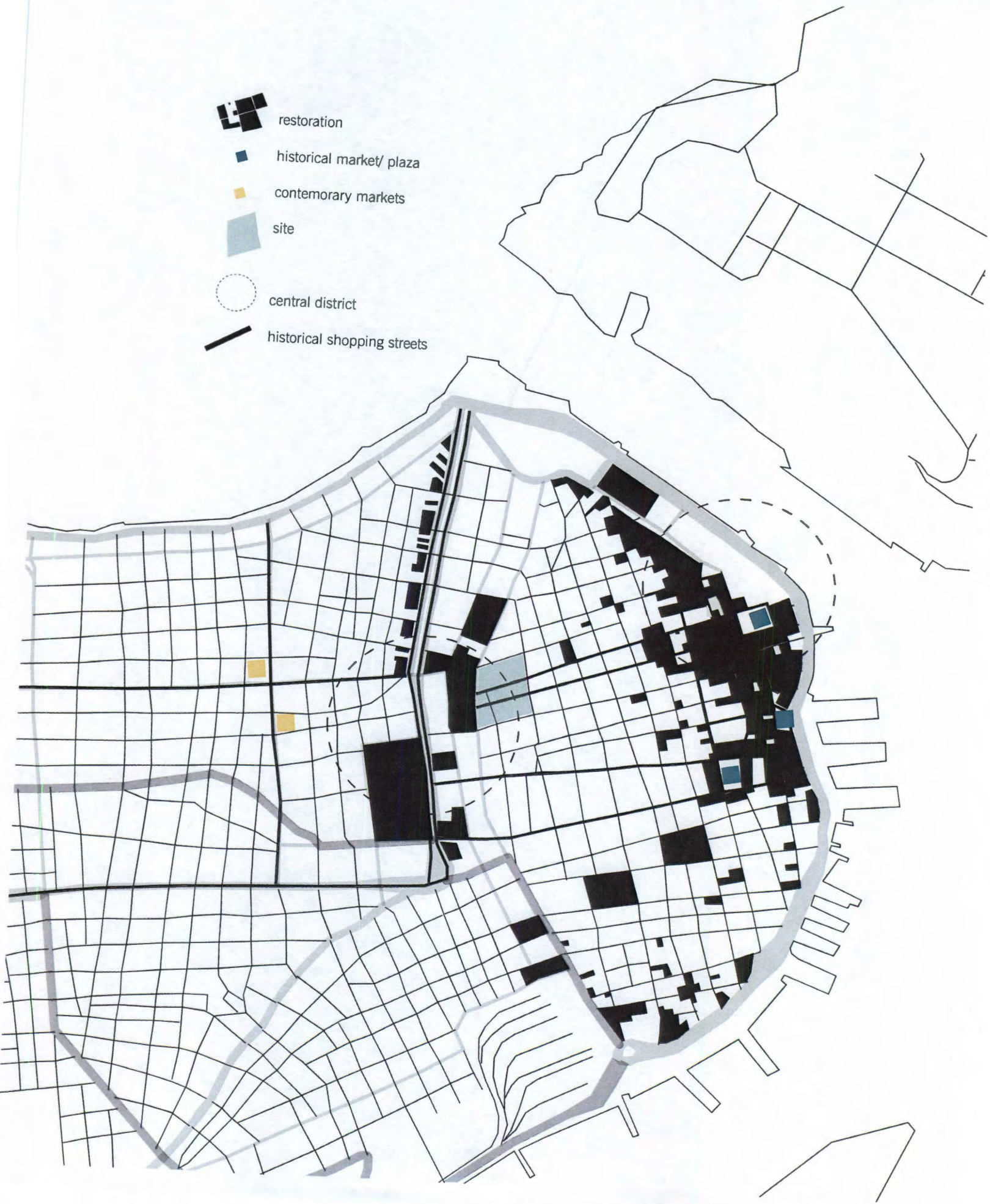



SITE MAP



**SITE MAP**

Prado to Malecón

Site of City Wall 1560-1860

O'Reilly to Plaza de Armas

National Capitol



## NEW TERRITORY

due to the state of disrepair, some buildings will be removed iopenign up spaces for a new city market

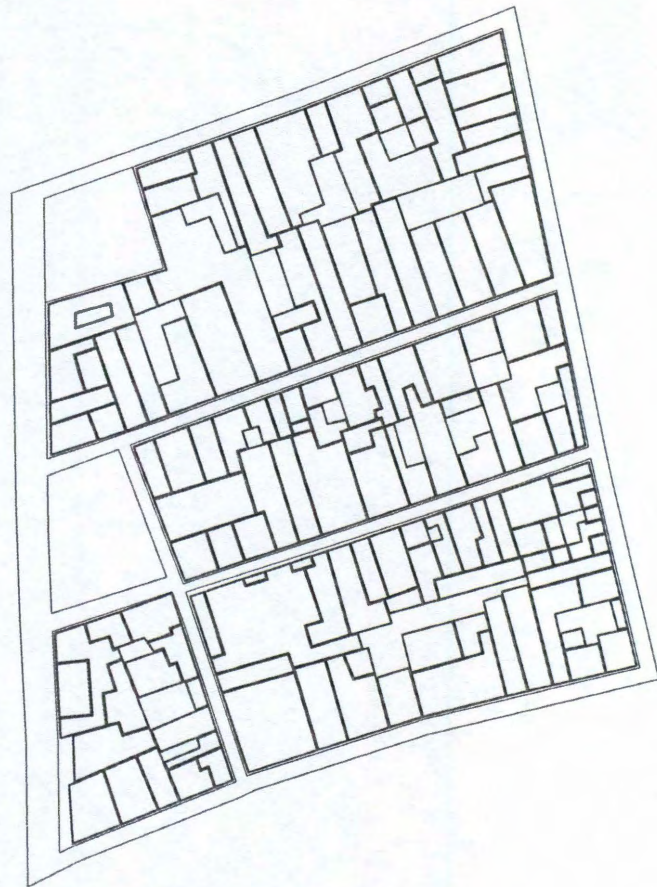

Existing Fabric

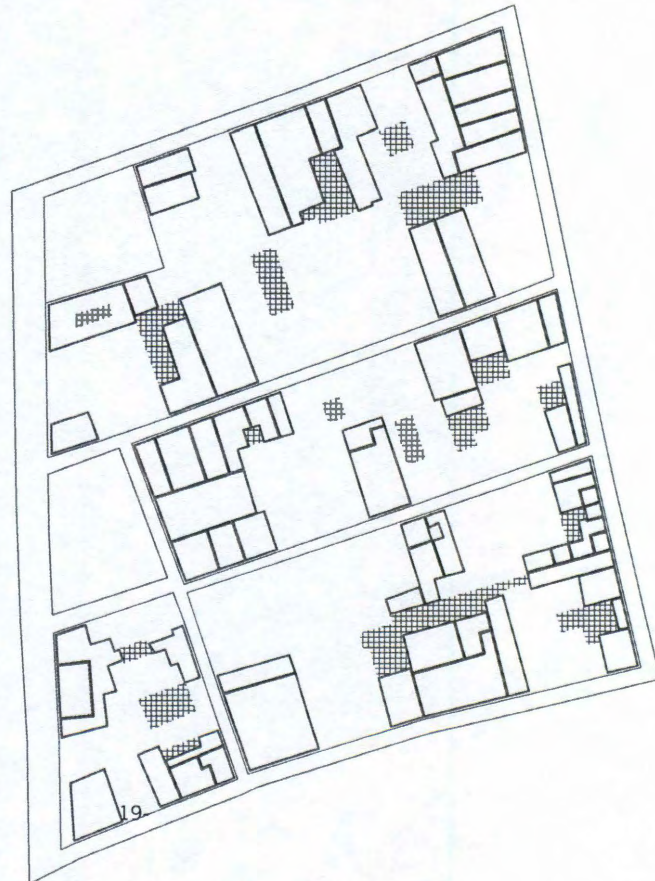

Removed Fabric



market level plan +16'- not to scale

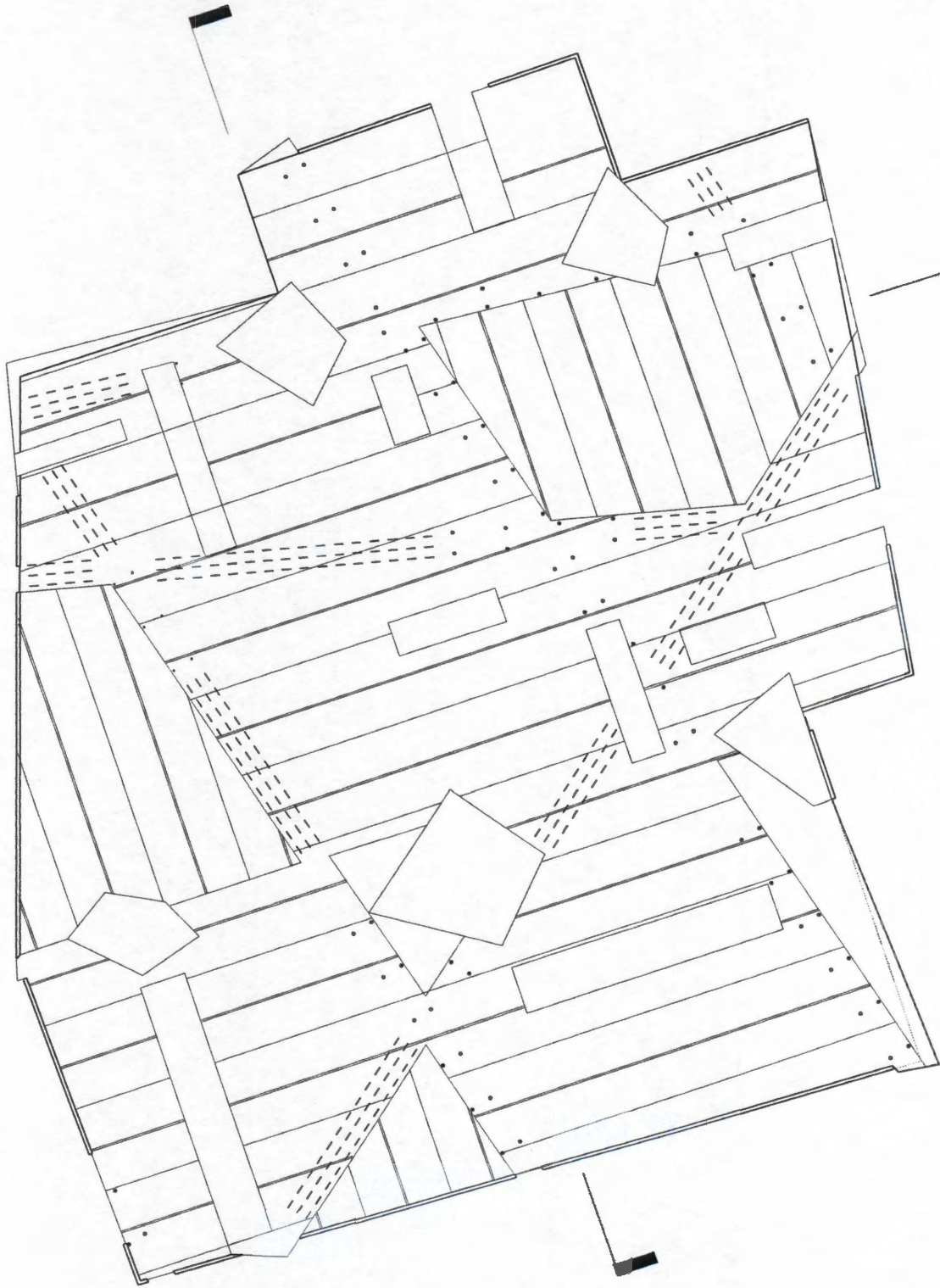

market rcp 60'\_ not to scale

Rendering of market below

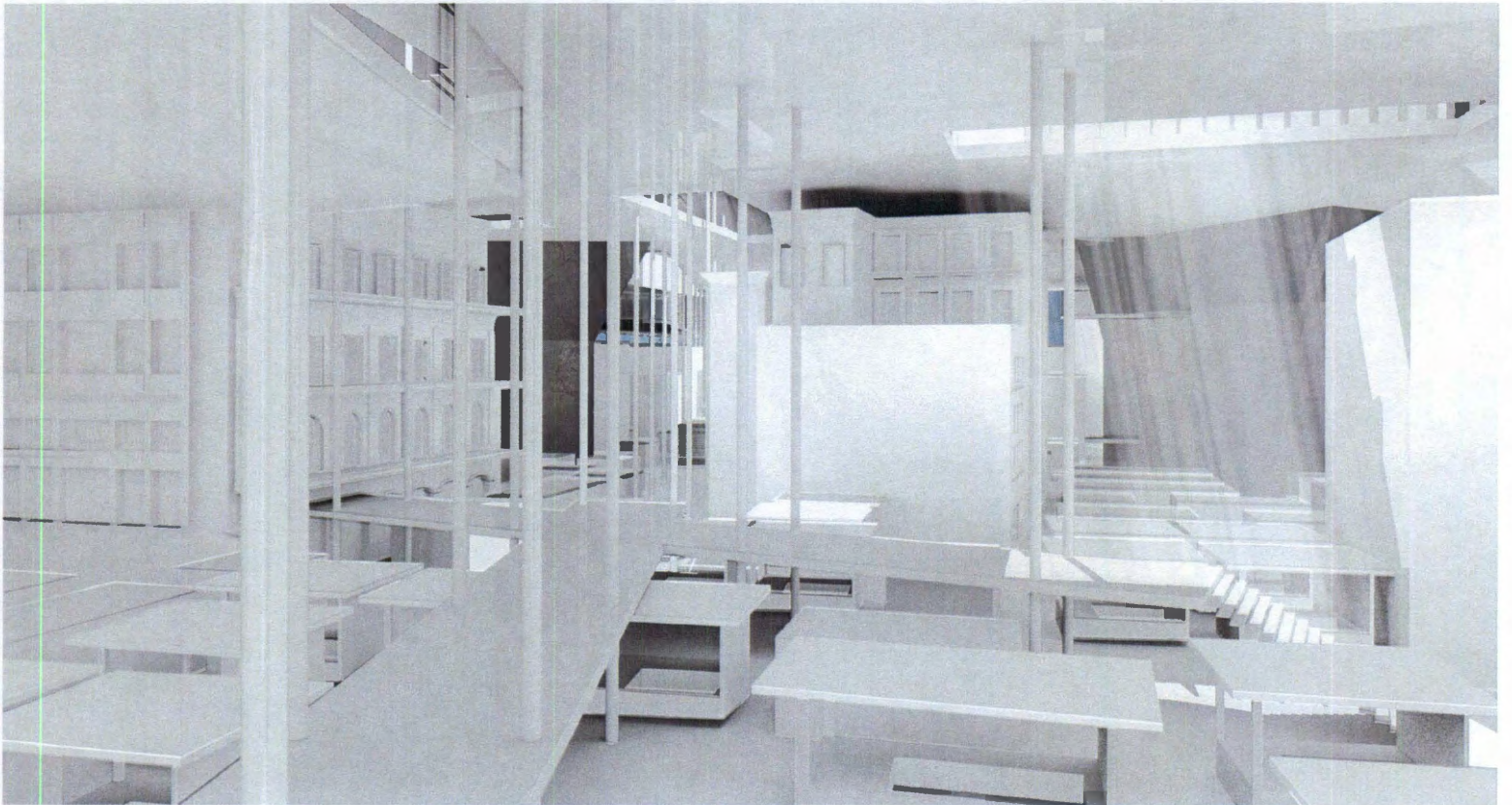

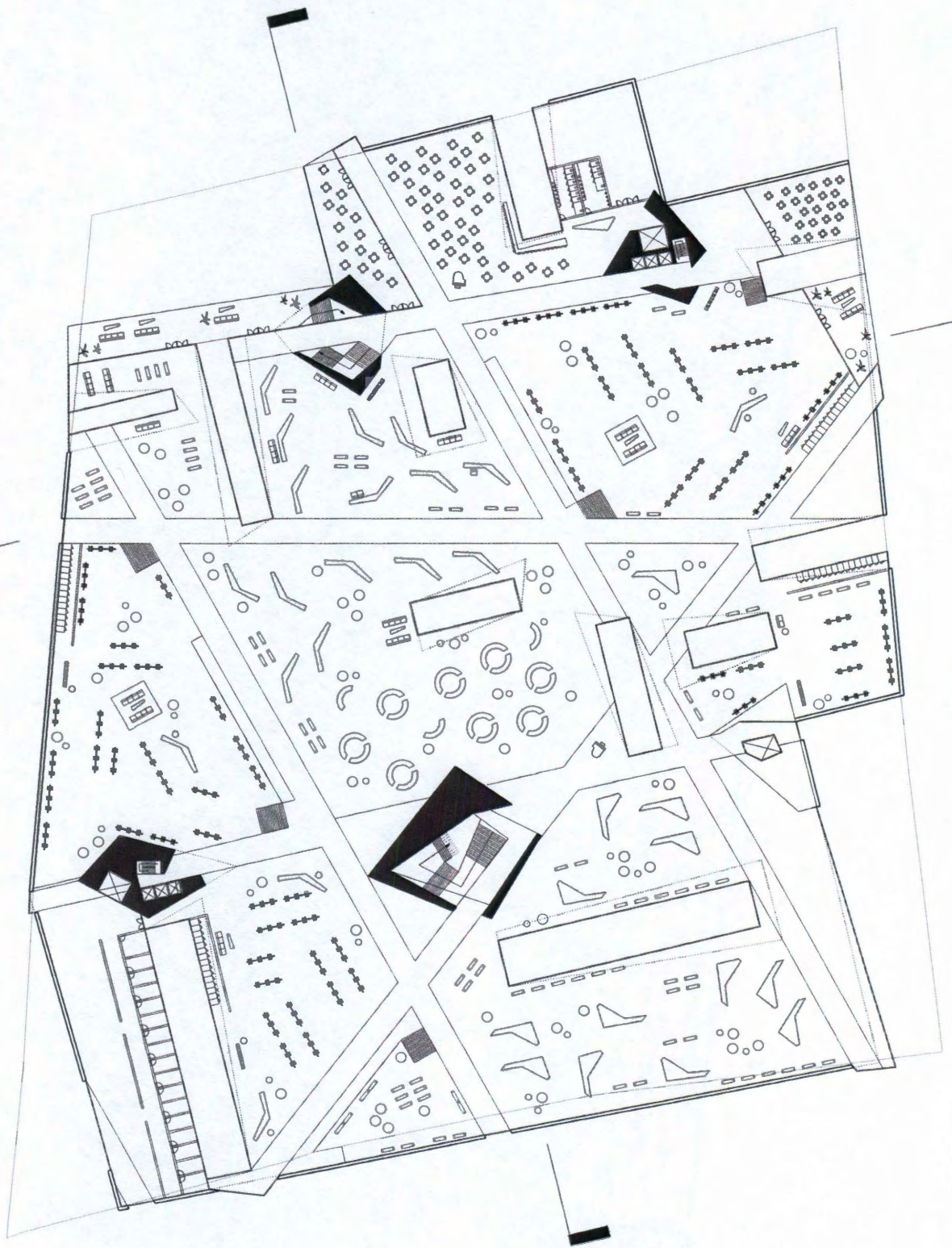

department store plan 62' not to scale

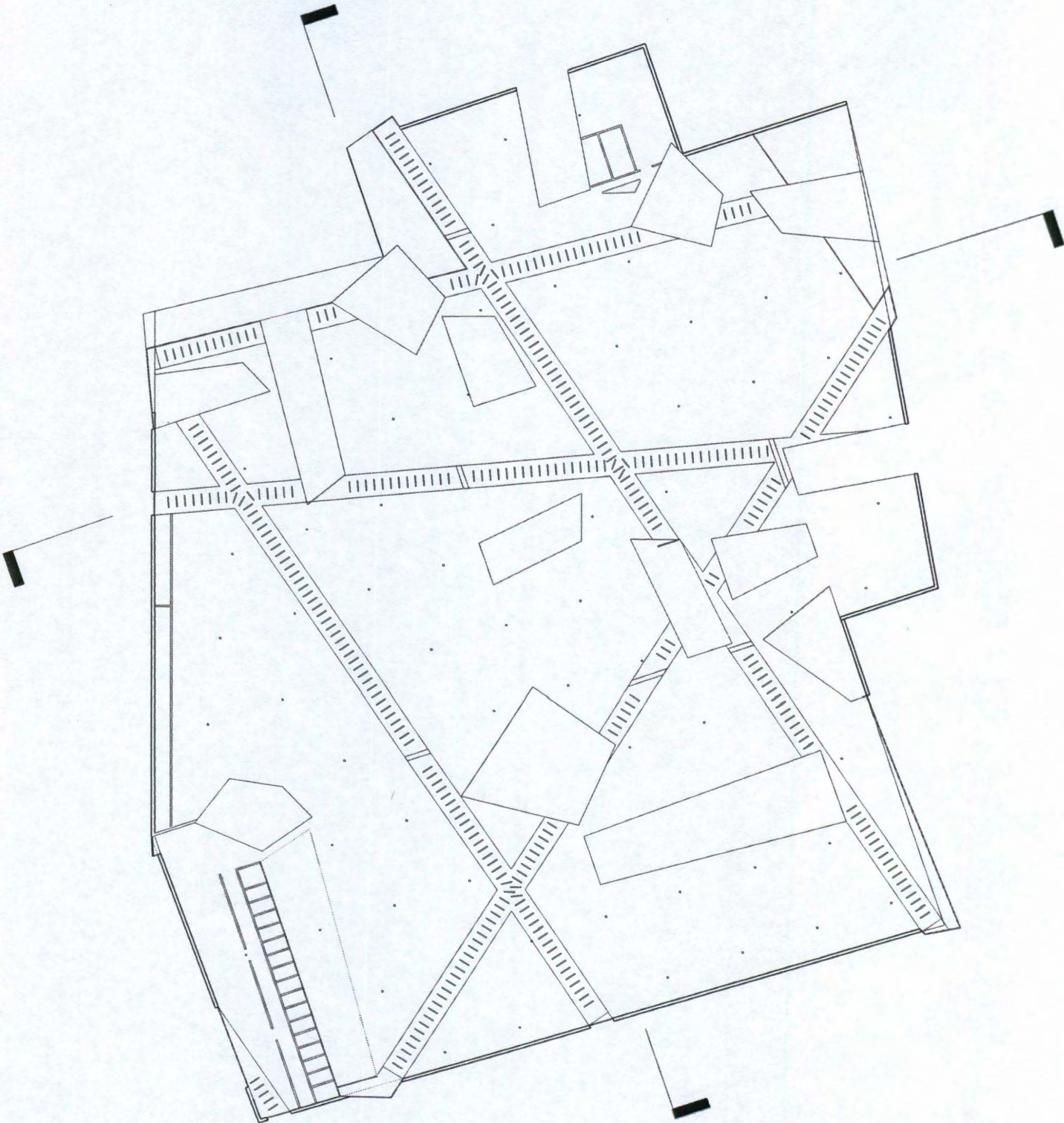

department store rcp 74' \_ not to scale



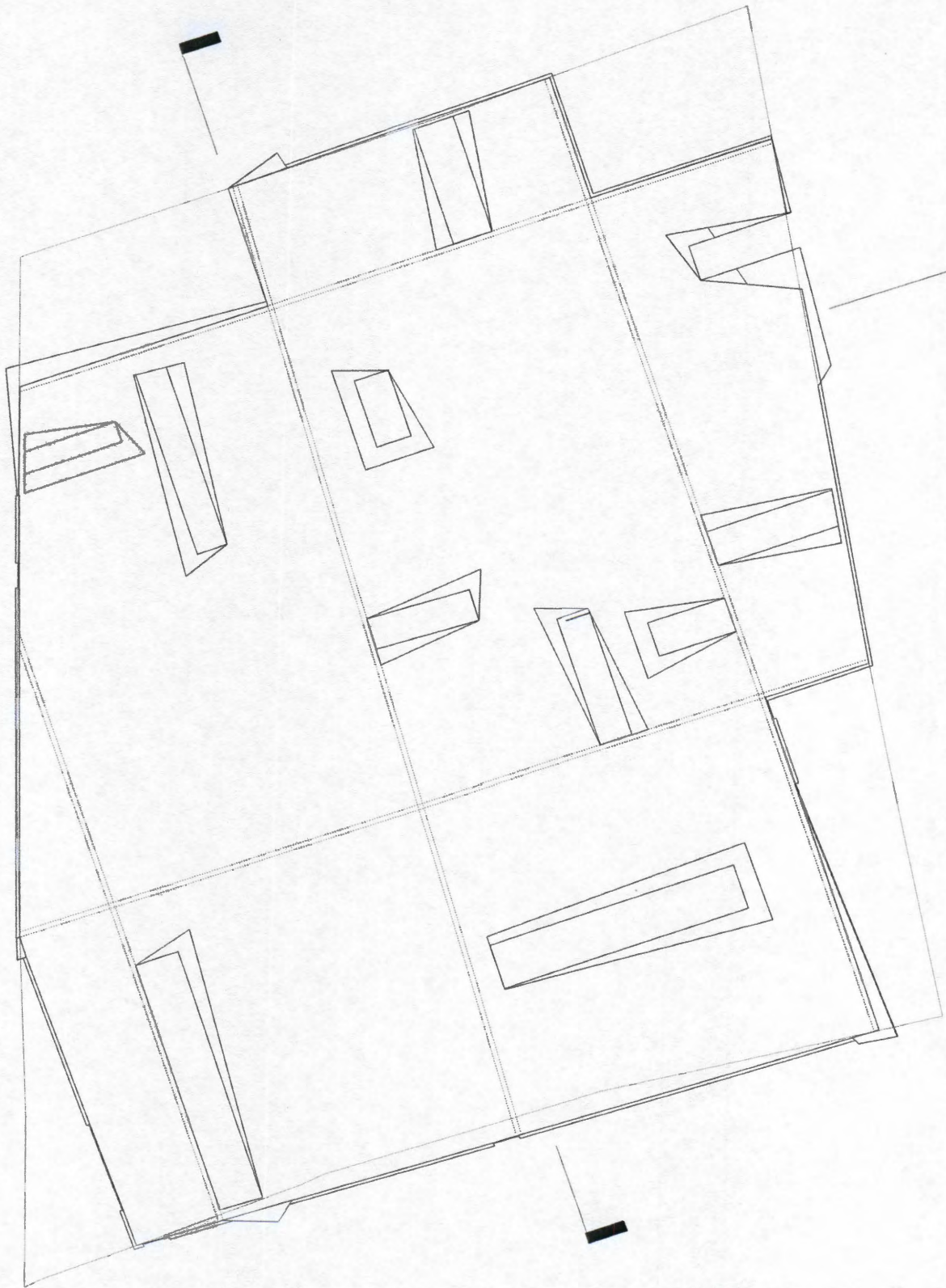

roof plan 86'\_ not to scale

Rendering of department store above

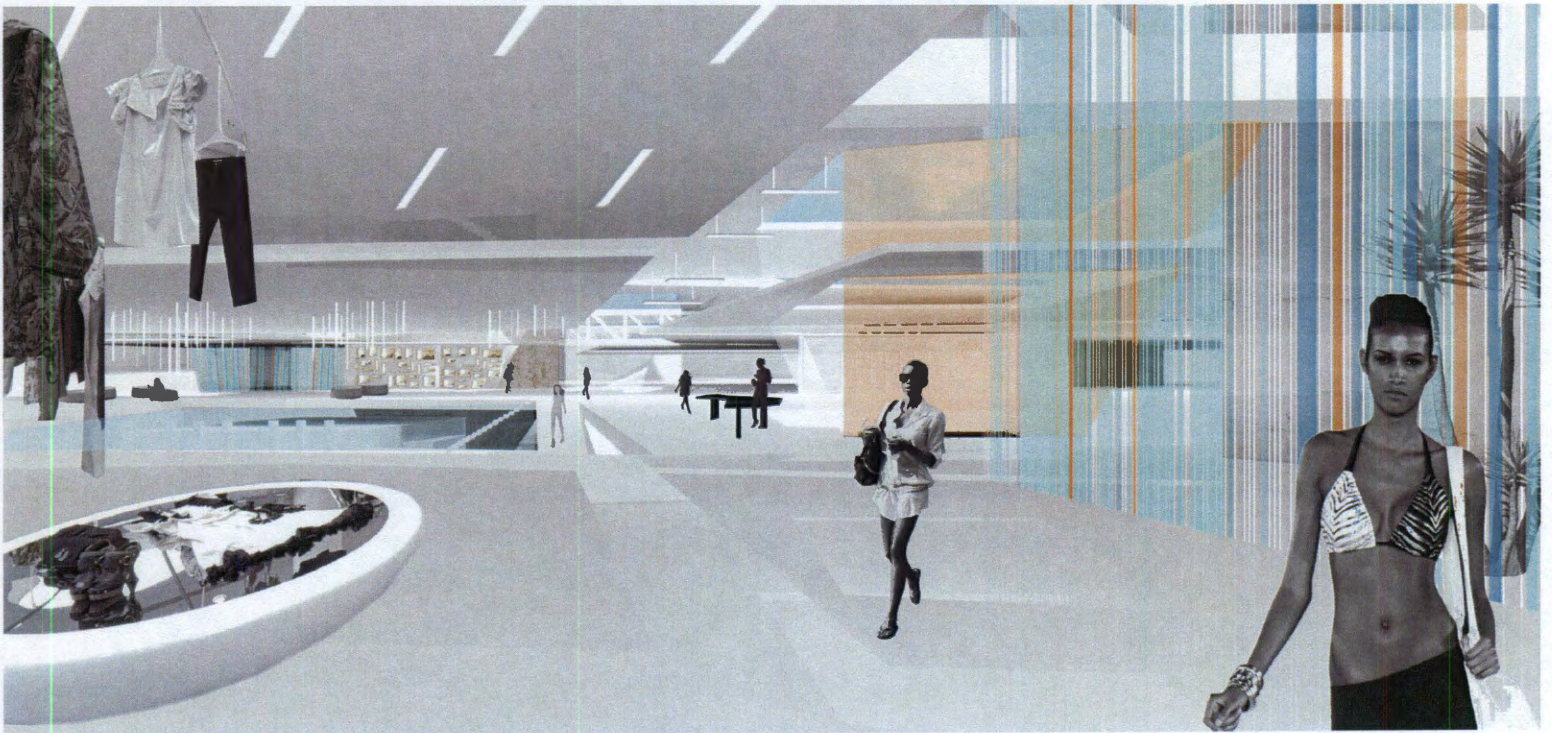

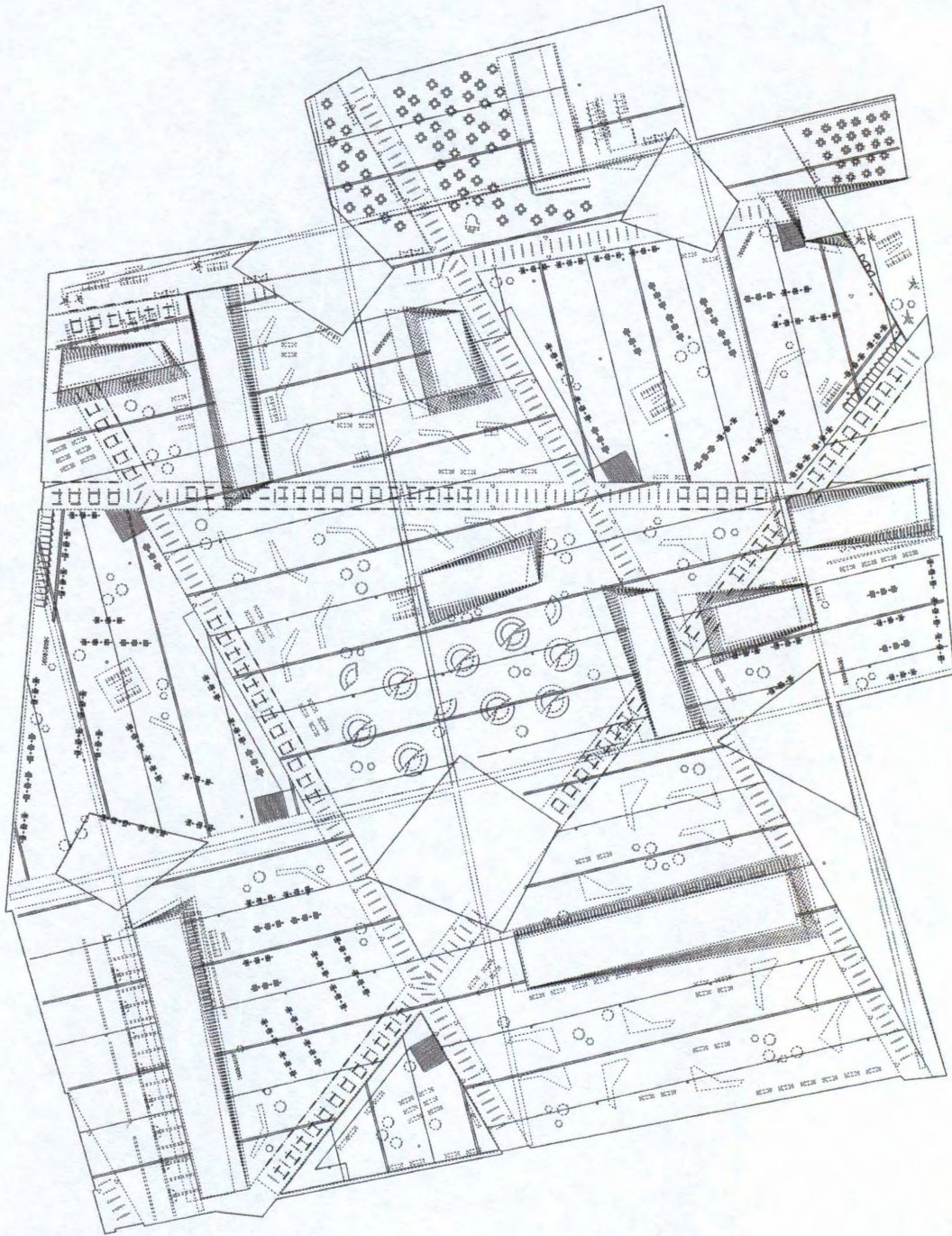

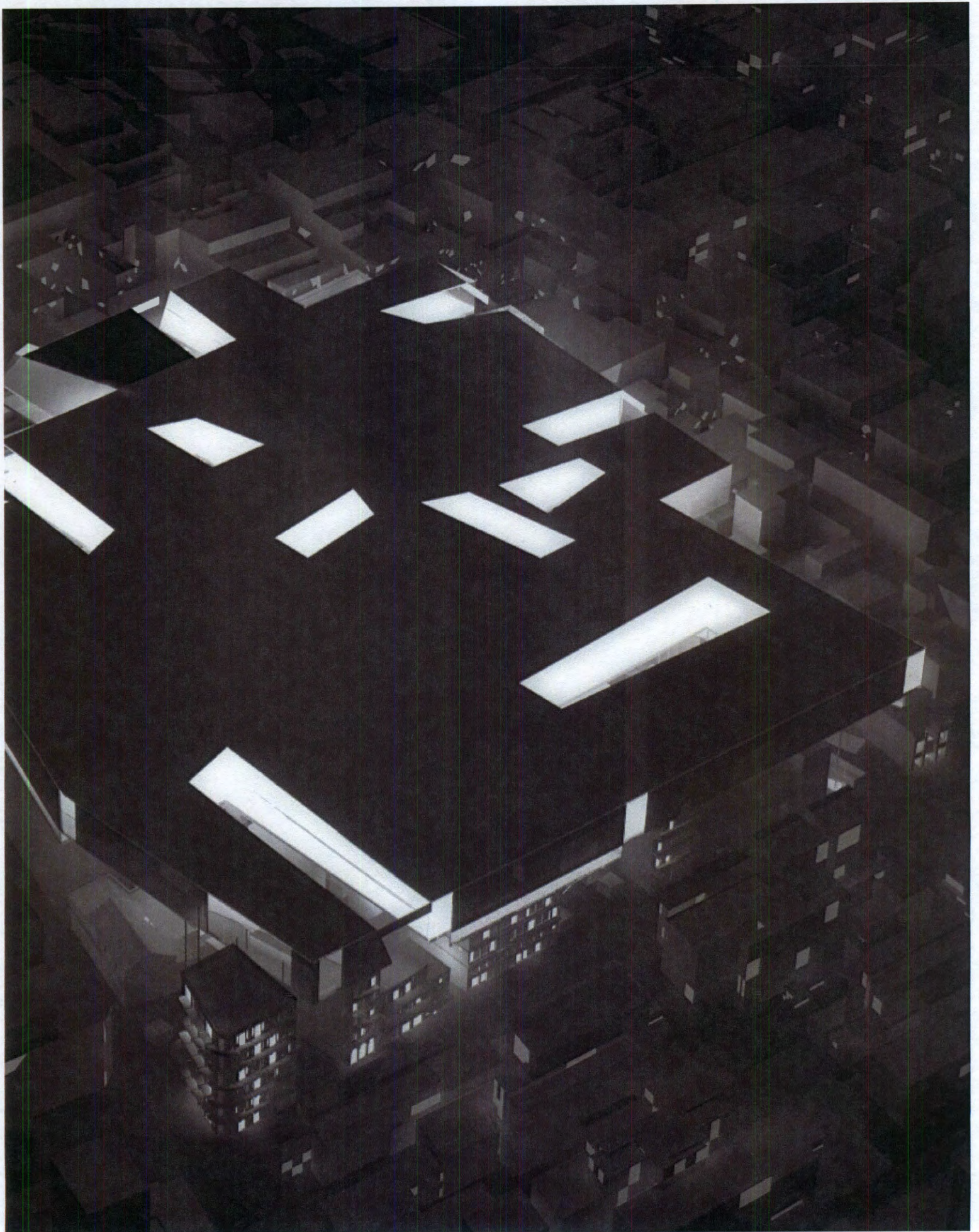

PROGRAM

Points of contact and exchange differ between the department store level – smooth spatial flow – and the market level – aggregated field.



Department store-level



Market-level

section a\_ not to scale

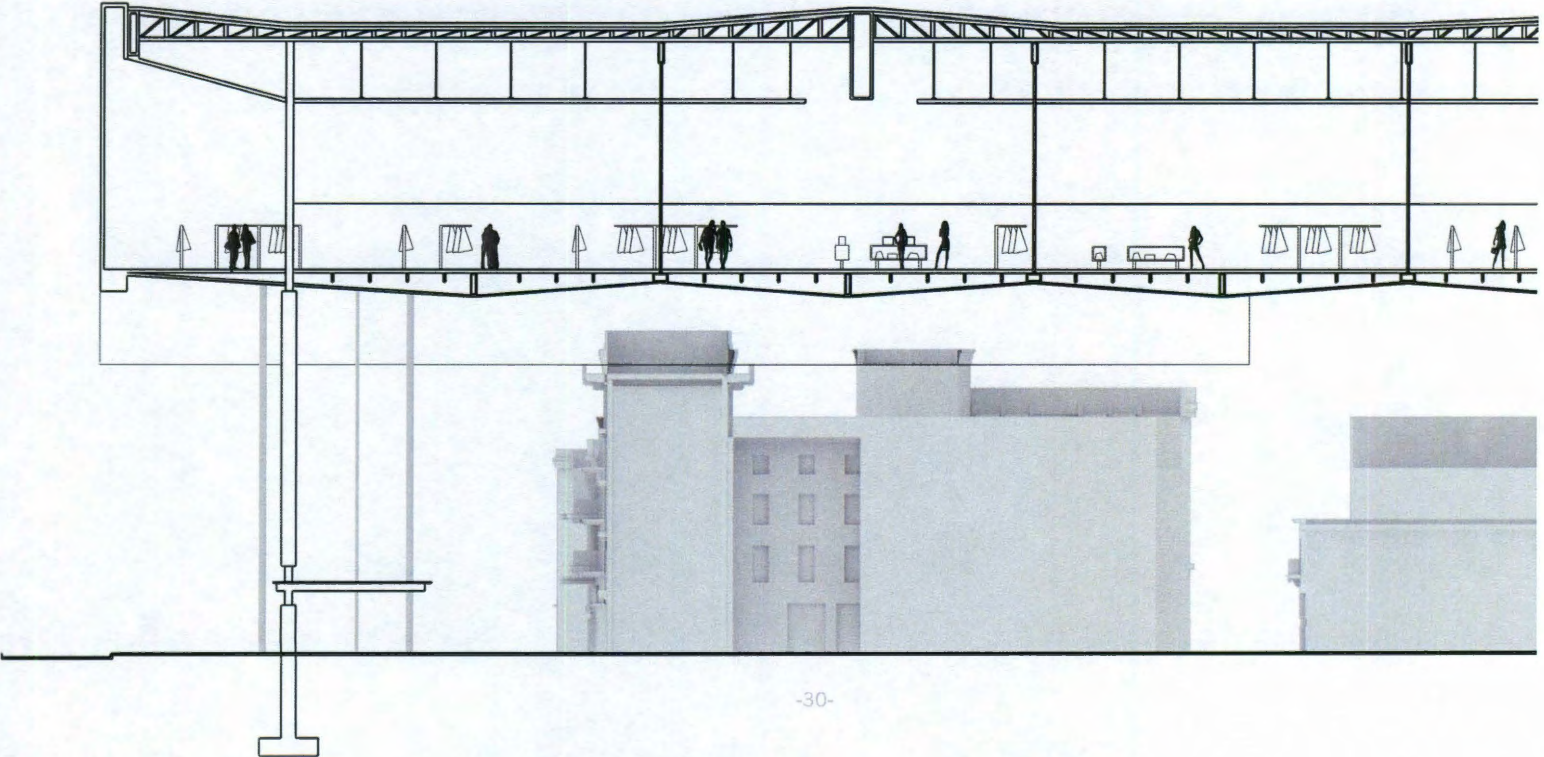
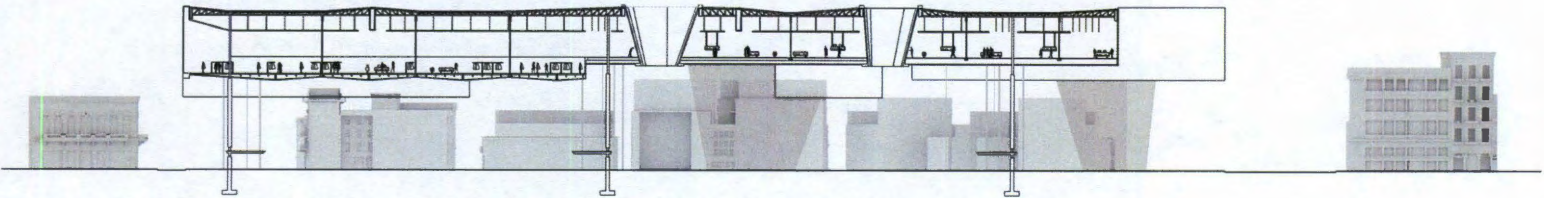

Rendering of department store above

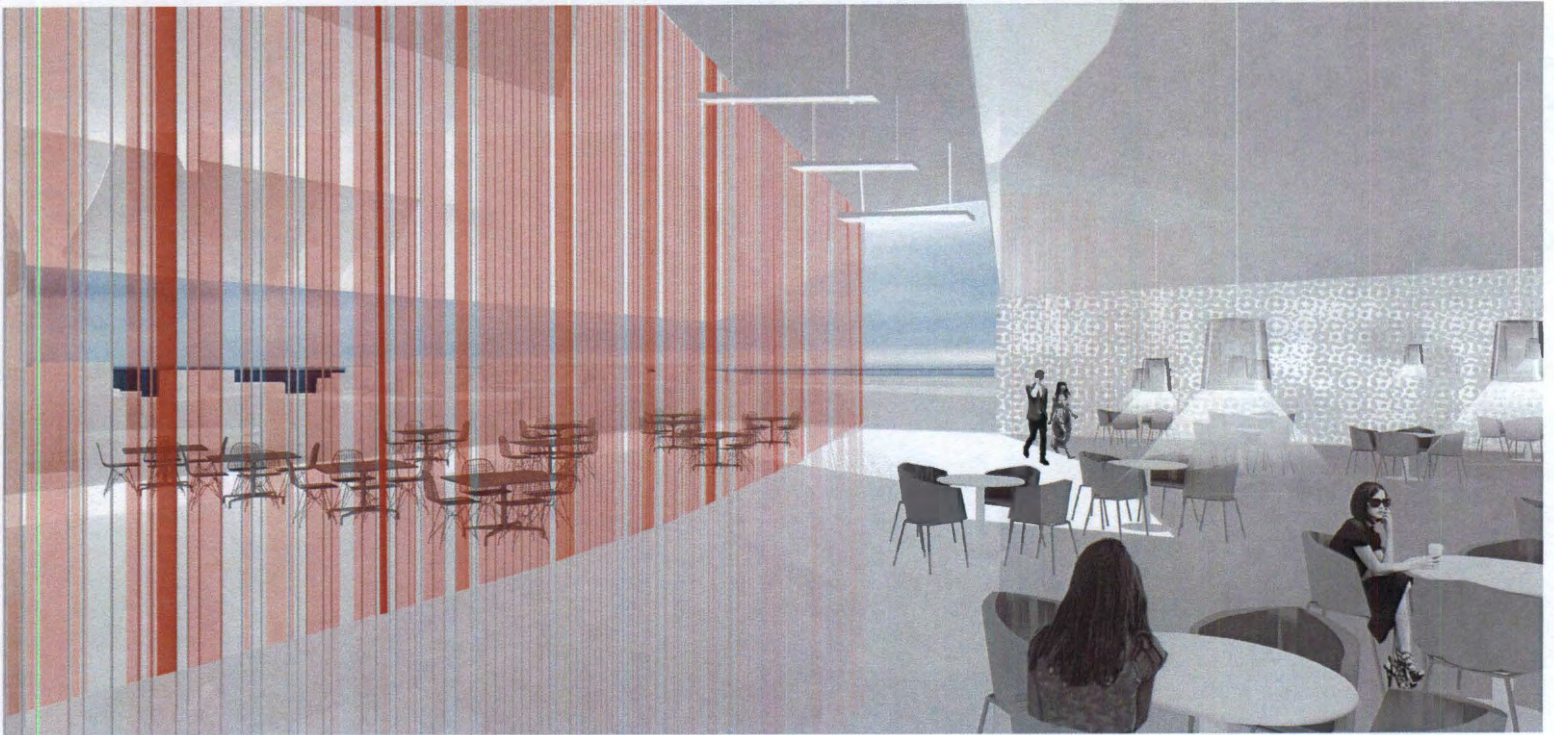

section b\_ not to scale

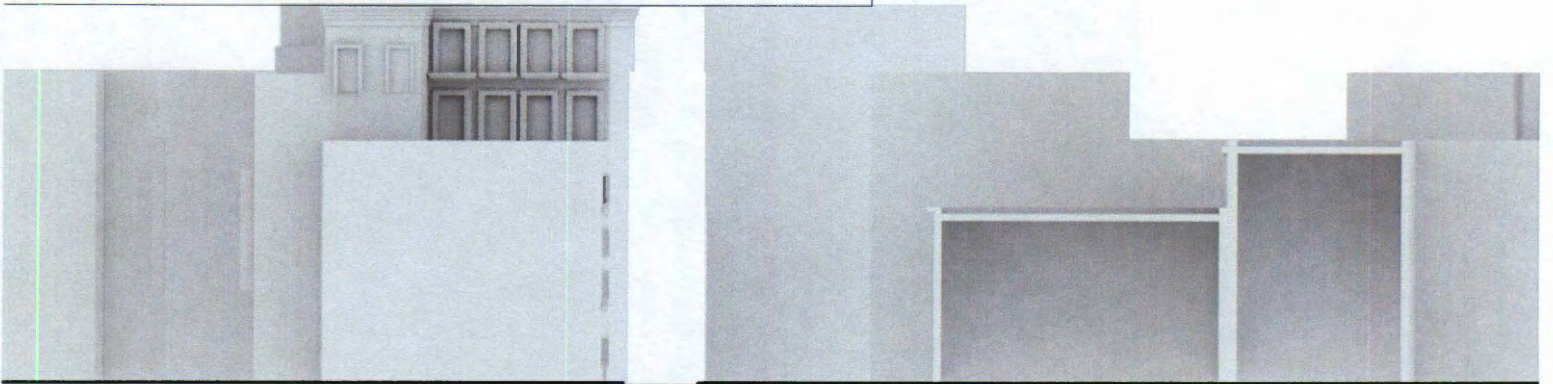
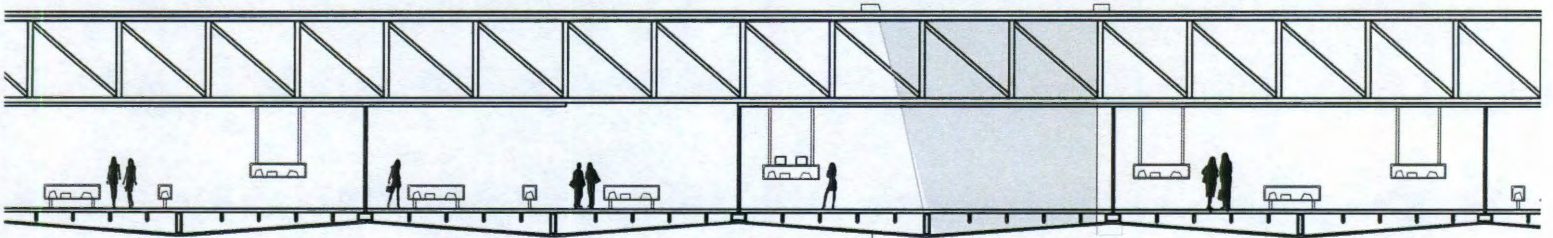
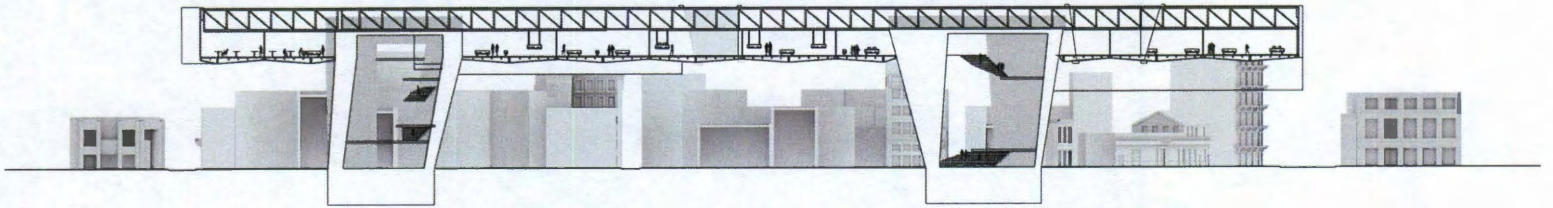



Rendering of market exterior

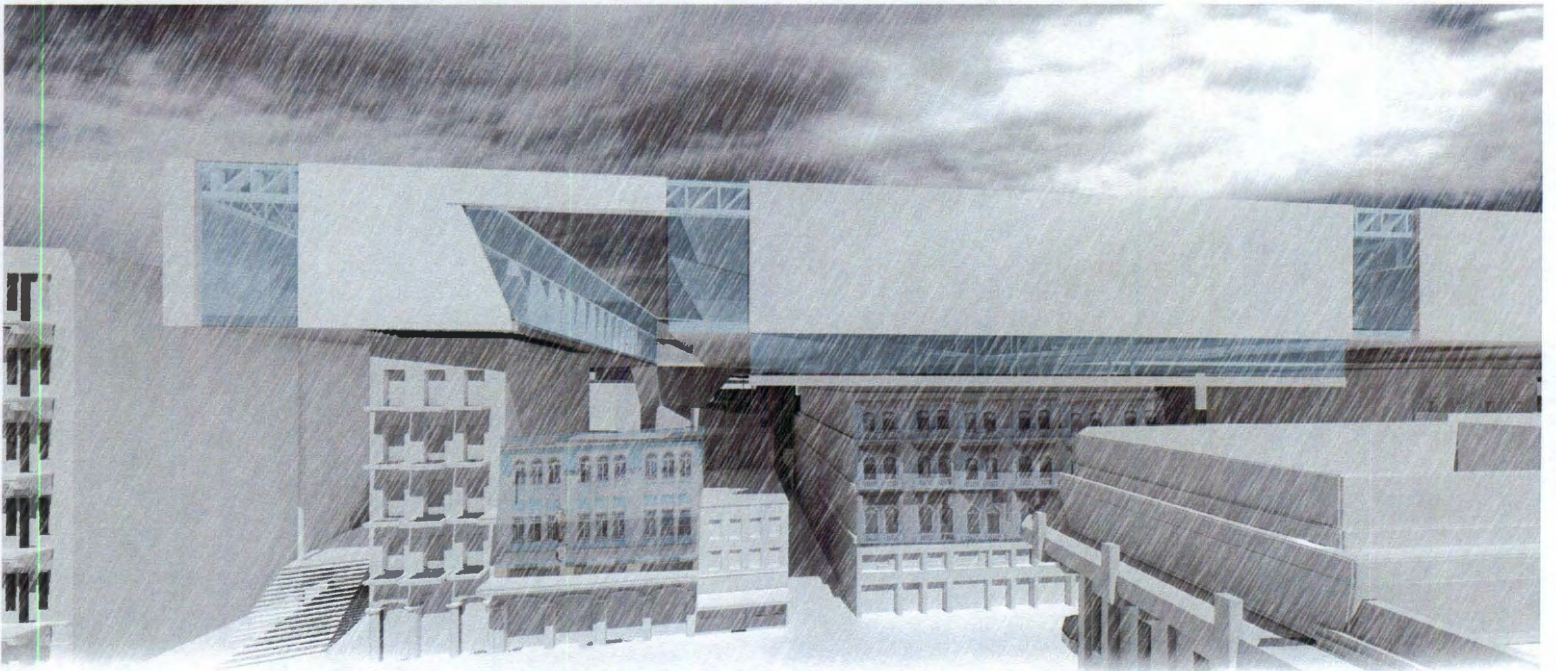

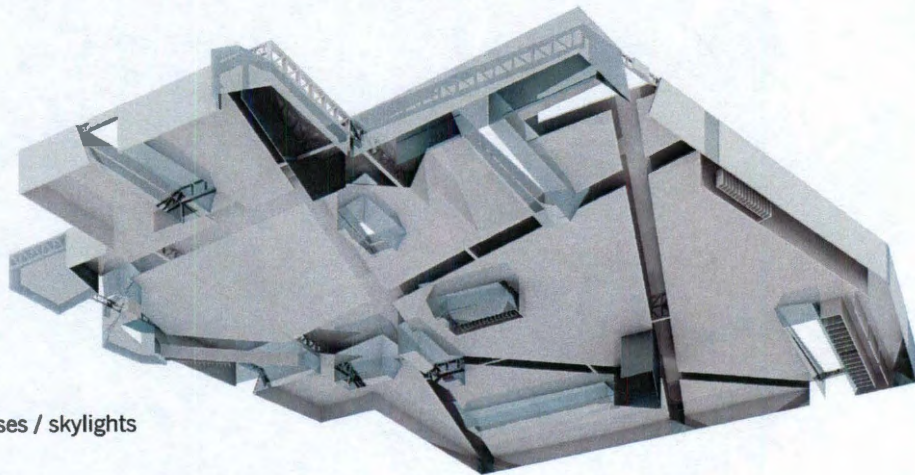

roof / trusses / skylights



ceiling / cores



columns

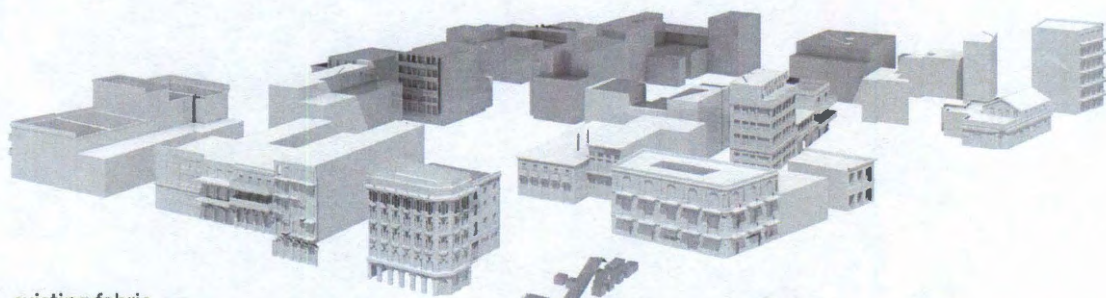

existing fabric



market

## MODEL STUDY

modeled in plaster, resic, acrylic

