

Utah State University

DigitalCommons@USU

---

inSites

Landscape Architecture and Environmental  
Planning

---

2001

## InSites, 2000-2001

Utah State University

Follow this and additional works at: <https://digitalcommons.usu.edu/insites>



Part of the [Environmental Design Commons](#), and the [Landscape Architecture Commons](#)

---

### Recommended Citation

Utah State University, "InSites, 2000-2001" (2001). *inSites*. 11.

<https://digitalcommons.usu.edu/insites/11>

This Book is brought to you for free and open access by the Landscape Architecture and Environmental Planning at DigitalCommons@USU. It has been accepted for inclusion in inSites by an authorized administrator of DigitalCommons@USU. For more information, please contact [digitalcommons@usu.edu](mailto:digitalcommons@usu.edu).



# *inSites*

Utah State  
UNIVERSITY

*Department of Landscape Architecture and Environmental Planning*

*College of Humanities Arts and Social Sciences 2000-2001*

## *Welcome to inSites!*

inSites is the record of academic achievement, faculty accomplishments, student progress, alumni achievements and program aspirations for LAEP at Utah State University. As you will see there has been a lot of activity in Logan and elsewhere. Please take some time to read about your favorite faculty members, your former classmates, yourself, and the exciting projects undertaken in LAEP in the past two years. There are many new projects underway, academic programs, research projects, and outreach projects. Let us hear from you with your reactions to the changes and information about your own work.

Sincerely,



Karen Hanna, ASLA  
*Professor and Head*

### *What's Inside?*

<i>Faculty Updates.....</i>	<i>2</i>
<i>Alumni Updates.....</i>	<i>6</i>
<i>From the Studio.....</i>	<i>12</i>
<i>On Campus.....</i>	<i>16</i>
<i>In Memory.....</i>	<i>21</i>
<i>Advisory Board.....</i>	<i>22</i>
<i>Update your Info.....</i>	<i>24</i>

# Faculty Updates



*Karen Hanna, Department Head*

Professor Craig Johnson was very happy in July of 2000. After two years as interim head, he was able to turn the role over to Professor Karen Hanna. Professor Hanna came to Utah State from the University of Arkansas, where she had been departmental chairperson

for six years and a member of the faculty for a total of 10 years. Prior to her academic service in Fayetteville, Ms. Hanna had been in private practice as a landscape architect in California.

Karen earned her BLA from the University of Michigan in 1971. Upon graduation she went to England where she worked for Michael Brown in Richmond, Surrey. She then returned to the office of Royston, Hanamoto, Beck and Abey in San Francisco where she had done a summer internship. In 1976-77, Karen taught in the Landscape Architecture Department at Cal Poly, San Luis Obispo, before moving to San Diego. Back in private practice, she opened her own office in 1987. Ms. Hanna's practice work included regional planning, park planning and design, residential subdivision design, and custom residential design.

In the early 1970s Ms. Hanna had her first introduction to geographic information systems (GIS) - not yet known by that name. She joined GIS pioneers in applying computer technology to produce suitability maps for planning. Two of those early computer-based projects were the "Smith River Highway Visual Analysis Study" and the "Recreation and Open Space Elements of the Santa Barbara County General Plan." The Smith River project won a national ASLA award and one from the U.S. Forest Service.

Almost 20 years later Karen completed a graduate degree in geography from the University of Arkansas. The Center for Advanced Spatial Technologies (CAST), where she did her graduate work, is a highly regarded GIS center at the U of A. Her thesis, on adapting the landscape architect's design process to GIS, became the book *GIS in Site Design*, published by John Wiley & Sons in 1998. Professor Hanna's second book is a set of 10 case studies, and a new, vector approach to the GIS design process. The second book was published by ESRI Press in 1999, and 3,000 copies were given to attendees at the ASLA annual meeting in Boston. That book is titled *GIS for Landscape Architects*.

In 1998, Karen received a Fulbright award to the Netherlands. She introduced a course called "GIS in Site Design" to the Landscape Architecture Department at the Landbouwwuniversiteit Wageningen. Ms. Hanna is now working toward a PhD at Wageningen, focusing on the integration of geo-spatial technologies in landscape architecture curricula. Karen has lectured on her GIS work in Great Britain, the Netherlands, across the US, and online.

Ms. Hanna is also currently serving as president of CELA, the Council of Educators in Landscape Architecture. CELA is the academic organization for most of the programs of landscape architecture in the US, Canada, Australia, and New Zealand. There are more than 80 member programs, representing about 750 full-time faculty. CELA is responsible for publishing *Landscape Journal*, oversight of an annual meeting and its proceedings, and production of a quarterly newsletter.

At USU Karen has taught site analysis, and GIS design and planning studios. At Arkansas she taught design studio, GIS design studio, construction and professional practice. Also, while at Arkansas she served as director of the department's botanical garden in Hot Springs.

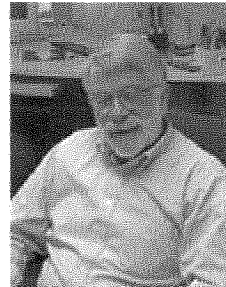

*David L. Bell, Associate Professor and USU Extension Community Development*

As USU Extension Landscape Architect, Dave Bell continues to help communities, counties, and agencies all over the state plan and revitalize downtown areas, parks, and other public spaces and influence the preservation of historical sites. Closer to home, Dave also teaches a class in construction documents to LAEP undergrads.

At the behest of former Utah planning director Brad Barber, following the Governor's Growth Summit, Dave made many presentations to growth committees, conferences, the Farm Bureau, and others.

Behind the scenes, he has been indispensable in educating communities, counties, and developers about principles of managed growth and farmland preservation. His guide to growth management -- originally proposed as a version of Arendt's *Rural by Design for the West* -- is the heart of a Website 'tool box' put together and later published in booklet form by the Western Rural Development Center at USU. Dave is working to get the booklet into the hands of all Utah Association of Governments directors. He will also conduct a day-long workshop on the concepts in the guide next spring at the annual League of Cities and Towns conference.

Budget constraints have severely curtailed the amount of traveling Dave can do, which, in turn, limits his impact. "If I don't sit down and talk to people," he points out, "it just doesn't get done."



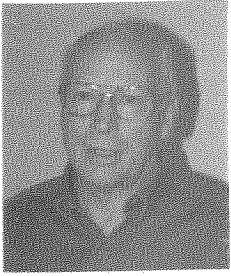

*Vern J. Budge, Associate Professor*

Vern is back on campus after a year's sabbatical, which he spent primarily in southern California with Kam-meyer and Associates, working in his areas of expertise: residential planning (the Tejon Ranch being one significant example) and recreation design. With technology an indispen-sible part of that office practice, he had the opportunity to become more comfortable using the computer as a design tool.

Before heading out to California, he and a group of LAEP undergrads and graduate students spent two weeks near Scofield, Utah, reclaiming a stream through the Blazon coal mine. The idea originated with Dick Rol, BLA '99, who was working at the time for the Utah Department of Natural Resources, Division of Oil, Gas and Mining. Since available funding was inadequate for the kind of state-of-the-art reclama-tion that was needed, Dick contacted Vern to solicit help from the department.

The volunteer crew worked on restoring the stream and replanting the surrounding riparian area, sometimes using cuttings they took from nearby indigenous species but also bringing in seeds and seedlings from a commercial nursery.

While in California, Vern photographed many exam-ples of historic and recently completed landscape architectural sites and developments, as well as ongoing projects between San Diego and Santa Barbara which he will use in his classes in recreation, open space planning, design, construction, and site planning.



*John C. Ellsworth, Associate Professor and Graduate Program Coordina-tor*

In July of this year, John Ellsworth became the department's graduate pro-gram director. He is also advisor to all students in the Master of Landscape Architecture (MLA) program, as well as faculty advisor to both the ASLA student chapter and the Zeta Chapter (LAEP) of Sigma Lambda Alpha, the national honor society of landscape architecture.

Last year Prof. Ellsworth taught courses in Construc-tion I and II, junior design studio, senior studio, and graduate readings seminar. This year, he is teaching Construction I, Introduction to Landscape Architecture (both semesters), the graduate research methods seminar, senior studio, and the graduate readings seminar. He is also developing an Introduc-tion to Landscape Architecture freshman course for online dis-tance education. The first offering is scheduled for summer semester 2002.

This past summer, Professor Ellsworth taught a three-day course in visual resource simulation for the Bureau of

Land Management at its national training center in Phoenix. Funding was provided by a series of BLM grants. He is involved in negotiations with BLM to teach the course next May on the USU campus and to develop additional courses for BLM for both face-to-face and distance education delivery.

He also received a grant from the College of Human-ities, Arts, and Social Sciences at USU to fund curriculum enhancement of the construction courses. A grant from Logan City will fund research on visual impacts of a proposed new landfill in Cache County.

Professor Ellsworth presented papers at the 2001 Intermountain GIS User's Conference in Boise; the Integrated Mining and Land Reclamation Planning Conference in Reno; the American Society for Surface Mining and Reclamation Conference in Albuquerque; the Utah Chapter ASLA annual meeting in Salt Lake City; the annual meeting of the Council of Educators in Landscape Architecture in San Luis Obispo, to name a few.

He also wrote a chapter titled Design Principles for Reclaiming Visual Quality on Surface Mined Landscapes for the new book *Environmental Design for Reclaiming Surface Mines*, published by Mellen Press this summer, and served as a peer reviewer for *Landscape Journal*.



*Craig W. Johnson, Professor*

When USU President Kermit Hall tells audi-ences that one of the university's strengths is its ability to attract research money, he may have been thinking about Professor Craig Johnson, who has had several grant pro-posals funded over the past three years. He also partnered with other successful grant

writers. The department is grateful not only to faculty members who conceive projects but to the public and private grantors that fund them and the students who devote long hours working on them.

Following is a brief summary of what Professor John-son has been working on:

\**Landscape Plants from Utah's Mountains (A Guide to Native Plants and Their Use in the Landscape)*. The first draft of this long-overdue publication was Richard Sutton's (MLA) graduate thesis. Now, in collaboration with graduate students Jared Barnes and Wendy Mee, aided by the expertise of Roger Kjelgren, associate professor in horticulture at USU, and Sutton, who is now a professor in landscape architecture at the University of Nebraska, Professor Johnson has shep-herded the book towards a March publication by USU Exten-sion. Funding to compile the book has been provided by the Mariner S. Eccles Foundation, the Center for Landscape Water Conservation, and USU Extension.

# Faculty Updates

Continued.....

\*The first phase of a research project funded by the Utah Department of Transportation to determine how to assure greater success for wetland mitigation projects has been completed. Lars Anderson, who conducted a roadside project as a student of Professor Johnson and is now a landscape architect with UDOT, was instrumental in involving the department in this research, as was Terry Johnson, also with UDOT. Lars writes to say, "USU did an exceptional project, and we are very happy. The graduate students deserve much of the credit; however, once again, Craig Johnson is the one who pulls it all together and pushes everyone's effort to a higher level. Craig is really the 'master mind' behind the project."

\*Professor Johnson is a partner in the development of an online urban forestry course funded by the U.S. Forest Service and the Utah Department of State Lands and Forestry. This project grew out of his earlier work on urban forestry manuals for Utah and the interior western states.

\*As a subcontractor to the Department of Horticulture at Brigham Young University, he is working on a USFS-funded study of invasive plant management and ecological restoration on the Wasatch Front. His roles are primarily to determine how to build trails and manage other construction to minimize disturbance of the land and to research the extent to which native seedlings can compete with exotics.

\*The National Resource Conservation Service (NRCS) is funding a pilot planning project to conserve biodiversity along the Henry's Fork corridor in southeastern Idaho.

Two other projects for which funding is being sought are:

\*The Center for Historic Vegetation Research. The center will provide a single source for consultants working on landscape restorations, re-creations, and reclamation to find out what plants originally grew within Utah and ultimately in the entire Great Basin area. This ongoing effort will employ graduate students from the LAEP, history, archeology, and anthropology departments to cull information from every available source to determine what plant communities existed in pioneer and pre-pioneer eras throughout the state and region. The resulting library of information will be available in GIS format.

Besides its aesthetic and historic importance, the information will be useful in water conservation. "In the not-too-distant future, water will be a driving issue in what we plant," Professor Johnson points out. "If we restore original plant regimes, we can make significant strides toward restoring the historical hydrology."

The funding source will be announced early in 2002.

\*History of Prominent Utah Landscape Architects. There is an urgent need to document the work and lives of Utah landscape architects before too many more pass from this earth. As early as November, if expected funding becomes available, a group of ASLA members and USU faculty and students will develop criteria for determining who should be included and in what order; and the history department will train LAEP stu-

dents in gathering oral histories. As soon as possible, they will begin taping interviews with the first two landscape architects. Professor Johnson estimates it will take 10 to 12 years to complete oral histories of landscape architects who retired before 1965.

A history of the ASLA in Utah is also part of the initial research. This aspect of the proposal was developed by members of the Utah Chapter of ASLA and trustees of the chapter's landscape architecture endowment fund.

A likely repository of this research will be the special landscape architecture collection now under discussion, which will become a reality as soon as \$250,000 in funding is in place. The collection would be part of the USU library system.

\*An application for a grant to develop habitat guidelines for webless migrating birds (such as mourning doves, sandhill cranes, and bandtailed pigeons) for private landowners has been sent to U.S. Fish and Wildlife Service.

Current field service projects on which Professor Johnson and various groups of students are working include:

\*a wetland habitat planting design for Cache County Juvenile Detention Facility, funded by Utah State Correctional Facilities

\*an Ogden Nature Center habitat restoration and management plan, funded by the Ogden Nature Center

\*habitat restoration of Utah State Prison property at Point of the Mountain, funded by the Utah Division of Wildlife Resources

In conjunction with habitat biologists with the NRCS, he has also applied for a grant to research and develop "Game Species-Specific Habitat Planning on Private Property--Guidelines for Farmers and Ranchers."

In addition, Professor Johnson serves on the National Advisory Board for a congressionally funded conservation buffers research project through the National Agroforestry Center, Lincoln, Nebraska. Opportunities for additional funded research projects may come from this grant.

Of all who benefit from this work, not the least are the students in Professor Johnson's courses in planting design, applied landscape ecology, conservation biology, and social/behavior dimensions in design.



*Caroline Lavoie,*  
Associate Professor

We're delighted to announce that Caroline was granted tenure in the spring of 2001 and has been promoted to the rank of Associate Professor.

The department is especially enthusiastic about Caroline's exhibit at the Thatcher Mansion in Logan this fall. On display through November 9, 2001, the exhibit, "Creating Meaningful Linkages: Milling Industries, Irrigation Canals and Ditches in Logan, Utah," emphasizes the

preservation of the existing system of irrigation canals in relation to the milling industry as an integral part of Logan's historical identity.

The exhibition displayed design proposals at three spatial scales and included models, plans, photographs, and drawings. The overall site design focuses on the mill race canal, which extends from Architectural Design West's office to Merlin Olsen Park. A detailed plan includes the design proposal for a community park on the site of the abandoned Thatcher Mill. These design proposals will, we hope, inspire Logan's citizens to appreciate their historical roots and celebrate their local landscape.

Caroline made a public presentation about her analysis and her design proposal on Oct. 19.

The project became possible when Caroline was named a Fellow of the Mountain West Center for Regional Studies in Utah, an honor which was accompanied by a \$6,000 grant for 1999-2001. A Utah Humanities Council grant helped underwrite the exhibition.

Caroline continues to pursue her interests in theoretical ideas that influence the design of urban spaces and address some of the limitations of the urban design process. Within this realm, Caroline presented findings of another of her research projects to national conferences in planning and landscape architecture. Her study, "Urban Space and Cultural Difference in European and North American Cities: A Comparison Among (Im)migrant Communities of Maghrebi in Paris, Turkish in Berlin, and Italians in Montreal," was also published by invitation in the December 1999 issue of the Japanese journal *Landscape Design*. Funded by USU, the project led to a trip to Turkey in the summer of 1999, opening further possibilities to explore Turkish immigrants' cultural expressions in and changes to urban landscapes.

At the invitation of the University of Colorado, Caroline traveled to Denver in December 1999 to jury graduate students' final project presentations.

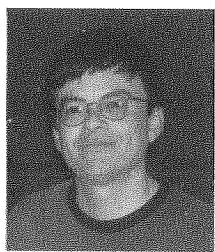

*Carlos V. Licon, Instructor*

Carlos moved with his wife, Laura, and daughters, Ana Laura, 6, and Ana Maria, 1, from Tempe, Arizona, to Logan for the 2001-2002 academic year. He lectures in graphics, planning, and site analysis.

Why USU? "My dissertation manager, Edward Cook, is an alumnus of this university and speaks very highly of it," he says. He is also eager to gain experience outside the Southwest and Mexico. "We're feeling very happy and very welcome here," he told *inSites*. It almost goes without saying that Carlos brings much-needed diversity to the department.



A PhD candidate in environmental design and planning at Arizona State University in Tempe, Carlos is focusing his research on "producing a model to assess sustainable development possibilities based on economic, social and environmental limitations."

He holds a degree in architecture (with honors) from ITESM in Monterrey, Mexico; a Master of Administration from ITESM in Chihuahua, Mexico; and a Master of Environmental Planning from ASU.

Carlos participated in an environmental planning project with the local Hopi community in northern Arizona. His research on energy consumption and the sustainable future of Arizona was presented at the Twenty-Third National Passive Solar Conference of the American Solar Energy Society and The American Institute of Architects in Albuquerque in 1998.



*John K. Nicholson, Associate Professor*

Professor Nicholson is on sabbatical getting ready to teach in a new international MLA program offered at Anhalt University of Applied Sciences during the spring semester in Bernburg, Germany.

He will also be lecturing in both Ljubljana, Slovenia, and Zagreb, Croatia, this winter. "I am hoping that my past two sabbaticals (two Fulbright awards - one to Hannover in 1988 and the other to Dresden in 1995) will give me the ability to quickly acclimate to the significantly different social and academic environment abroad," he says. In the meantime, he is "pushing hard, learning to use 3D Studio VIS (computer software) in design."

During the 2000-2001 academic year, Prof. Nicholson taught LAEP 3300 (Advanced Computer Applications in Landscape Architecture) and introduced 3-D modeling techniques.

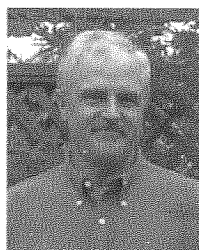

*Michael L. Timmons, Associate Professor and Undergraduate Program Director*

Landscape history continues as Mike's passion, and the slide collection, continues to grow. Trips this year to Virginia, Pennsylvania, Florida, Arizona, and California ensured a new infusion of visual images. Friendly Fred is alive and well, producing frozen fish fillets in the sophomore design studio, while juniors continue to experience recreation design through a variety of hands-on, real-world projects. Last year's class developed designs for an Alzheimer's courtyard at Sunshine Day Center in Logan and a recreation/historic preservation plan for the Stockmore Ranger Station near Duchesne, Utah. This year, students designed an

# Faculty Updates

Continued.....

accessible playground known as Angel's Landing, and are currently developing master plans for the Santa Clara Reserve near St. George (see separate articles).

Mike continues to be actively involved with the Honors program, serving as the LAEP Honors Coordinator. A university Honors course developed by him is unique in its interdisciplinary nature. The course, entitled the Arts in Interesting Times, is team-taught by faculty from music, art, and literature, in addition to the landscape architectural component covered by Timmons.

In his new role as undergraduate coordinator, Mike meets with prospective undergraduate students and their parents, and is responsible for their initial advising. He welcomes references of promising potential LAEP students and encourages alumni to send prospects his way!

Mike continues to serve as a member of the Landscape Architect Licensing Board for the State of Utah. He has been active on the Council of Landscape Architectural Registration Boards (CLARB), attending meetings and serving as a member of the Landscape Architects Registration Exam (LARE) grading committee at sessions in Philadelphia and Tucson. He has been asked to assist with the writing of portions of the LARE to be administered to examinees throughout North America during the coming year.

The raised bed garden Mike constructed several years ago provides many hours of pleasant release in the summer time. Last year, peppers provided the main interest -- habaneros, jalapenos, serranos, poblanos, purple, variegated, cherry bombs, and plenty of anaheims. (The main conversation items were the Peter Peppers.) This has been the year of the heirloom tomato -- Aunt Ruby's German Green, Lillian's Yellow, Elberta Girl, Sausage, Brandywine, Black Prince, and Italian Gold, to name a few. While the growing season provides hours of peaceful outdoor therapy, harvest season is chaos. Salsa, anyone?

Mike does manage to squeeze time for design in between garden duties and enjoys revitalizing his creative energy on local residential projects.

## Dick Toth

After many years of working with colleagues in the College of Natural Resources, Dick Toth has joined them on a full-time basis. His recent regional planning work demands more of his time and he can complete that work more efficiently in CNR. Recent projects include studies of the Mojave Desert, the Cub River Watershed, and the Wasatch Front.

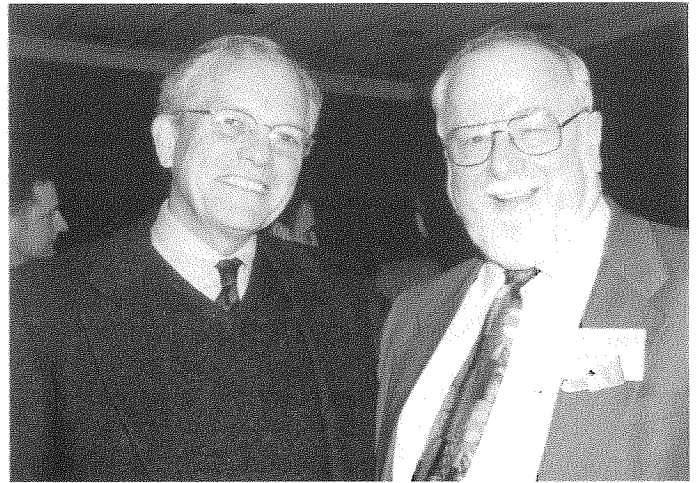

Gere Smith and Tony Bauer at the LAEP Awards Banquet.

# Alumni Updates

(1999 to the present) by Mike Timmons

The following updates reflect some of the correspondence we have had with alumni, as well as items we have been made aware of in recent months. We would like to expand this feature in future issues of *inSites*, and encourage you to complete and submit the attached form to help us all get updated!

**Allysia Angus**, MLA '99, works for the Bureau of Land Management in Escalante, Utah.

**Fauzi Abu Bakar**, BLA '87, principal, Arkilandskap Sdn Bhd, worked on the KL International Airport featured in *Architecture Malaysia* in October 1998. Arkilandskap was responsible for the North Forest and the Forest in the airport components. Fauzi was in Logan for USU's 1999 Homecoming festivities, representing the 200-plus member Malaysian Chapter of the USU Alumni Association, of which he is president.

**Tony Bauer**, BLA '62, has recently published two books on reclamation. One is a LATIS book prepared for the ASLA, titled *Reclamation of Pits and Quarries*. It is an electronic publication available through the ASLA Web site. The second publication, *Shaping Landscapes for Tomorrow*, was prepared for the National Stone, Sand and Gravel Association. Tony also gave a three-lecture electronic educational series on the Reclamation of Pits and Quarries. This series can be viewed on the ASLA Web site.

**Jay Bollwinkel**, BLA '97, with MGBA the Grassli Group, Salt Lake City, is serving as president of the Utah Chapter ASLA this year.

**Jereck Boss**, BLA '93, with GSBS pc, Salt Lake City, went off the Executive Committee of the Utah Chapter ASLA this year, after serving terms as member-at-large, president, and past-president.

**Deb Bowden**, BLA '83, is in private practice with her

husband in their own firm, Ivy Design, in Boise, Idaho. She is serving as the Idaho/Montana ASLA Chapter president. Deb writes that "the bulk of the work we undertake is cultural and estate-oriented, though we do our share of commercial. We work in Sun Valley quite a bit, master planning condominium developments and estates, do some corporate work--and some campus work--and we try to remember that this should be fun!! It's tough when work can demand 20 hours of your day, and we are determined to prioritize family (Remsen, 6, and Aurielle, 4). Our most trying effort, consuming the last six years, has been a project called the Idaho Anne Frank Human Rights Memorial, which will be built this year. It's gained national attention, and we look forward to some award review on it."

**Gerald Brown**, BLA '73, principal in the firm Carol R Johnson Associates based in Cambridge, Massachusetts, has opened a branch office in Salt Lake City and has hired **Susan Crook**, MLA '89; **Richard Gilbert**, BLA '96; **Steven Gilbert**, BLA '96; **Eric Powell**, BLA '99; and **Janae Stephenson**, BLA '98. **Pete Wall**, MLA '02, has interned with CRJA for the past two summers.

**Terrell Budge**, BLA '90, received his MLA from the Harvard Graduate School of Design and is employed with Design Workshop's Park City office, as is **Justin Hamula**, BLA '95, who served as president of the ASLA Utah Chapter this past year and continues on the Executive Committee in the position of past president.

**Jim Butterfus**, BLA '78, is the park landscape architect in Zion National Park. He has hosted visits by the LAEP 3100 Recreation Design Studio the past several years.

**Alan Christensen**, BLA '77, is the owner of Alan Christensen Enterprises in American Fork, Utah.

**Lisa (Kenneson) Campbell**, BLA '88, lives in Vancouver, Washington, and is in her tenth year with David Evans and Associates (DEA), an engineering, planning, survey and landscape architecture firm in Portland, Oregon. Lisa writes, "We have a 13-month-old son, Nathan, named after Nathan Maughn (BLA '88, deceased), one of the greatest inspirations in my life."

**Walt Cole**, BLA '83, is with the Alexandria, Virginia, office of EDAW. His work for on Disney Development Company's Celebration Village and Town Center was featured in the August 1998 issue of *Landscape Architect and Specifier News*.

**Larry Collinwood**, BLA '98, a landscape designer with the Salt Lake City Community and Economic Development Department, was a member of the plant selections steering committee for the Memory Grove revegetation project after a tornado destroyed nearly all the park's trees and shrubs in 1999.

**Dell Cook**, BLA '65, has closed his private practice in Salt Lake City and now works for the city's Community and Economic Development Department. Dell's son **Troy Cook**, BLA '00, worked for EDAW in California for a year, then moved

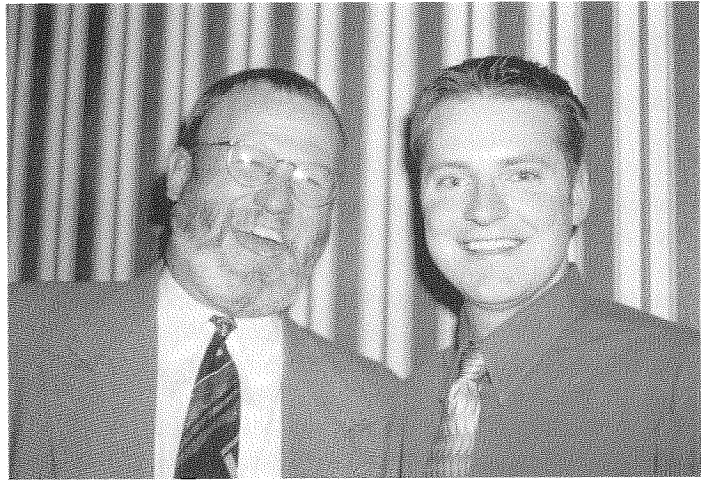

*Bruce Jorgensen and James Dotson at last year's LAEP awards banquet. James joined the alumni as a 2001 graduate.*

this summer to Portland, Oregon, where he is employed by Walker-Macy.

**Kimball Erdman**, BLA '97, received his MLA from the University of Oregon in June 1999. His thesis examined Chinese gardens of the Ming and Qing periods, and research on the project took him to Beijing, Shanghai, and Suzhou. While at Oregon, Kimball taught the AutoCAD classes for the LA department and assisted in the landscape history courses. He is working at LANDSCAPES in Charlotte, Vermont, specialists in historic preservation, where his first projects in the office have included work on Poplar Forest, Virginia (Thomas Jefferson estate) and Mellon Park, Pittsburgh (an Olmsted design).

**Dave Garce**, BLA '80, is in private practice, dividing his time between Salt Lake City and Southern California. Dave has been teaching the professional practice course for our department the last couple of years.

**Kelly Gillman**, BLA '99, works for The Sear-Brown Group in Salt Lake City.

**Greg Graves**, MLA '86, a landscape architect with Bingham Engineering, Salt Lake City, serves on the Utah Water Conservation Forum board of directors.

**Dave Green**, BLA '97, GSBS-pc, helped facilitate Envision Utah citizen involvement sessions.

**Stefan Johansson**, BLA '94, is working for Gibbs and Brown, Edmonton, Alberta. He is also teaching part-time at Northern Alberta Institute of Technology (NAIT).

**Yong-Gi Kim**, BLA '98, completed his MLA degree at Cornell, with a concentration in hotel and resort development/planning and tourism. He is currently employed with Belt Collins in Hawaii.

**Kevin Krogh**, BLA '85, is a tenure-track assistant professor in the Department of Languages and Philosophy at USU.



# Alumni Updates

(1999 to the present) Continued.....

**Danette Leatherman**, BLA '97, with Carole Boleman Associates in the Indianapolis area, writes that she is enjoying work and has passed the LARE.

**Don Leslie**, BLA '97, a landscape architect for The Sear-Brown Group, Salt Lake City, has been working on venue development for the Salt Lake City 2002 Winter Olympic Games. He is also serving a second year as secretary for the Utah Chapter ASLA.

**Stuart Loosli**, BLA '65, with MHTN Architects, Salt Lake City, serves as treasurer for the Utah Chapter ASLA. The design he contributed for First Encampment Park in Salt Lake City won a Utah ASLA 2000 Honor Award. Stuart also serves on the University of Utah Research Park Advisory Board of Review.

**Eric Lyman**, BLA '83, has his own landscape architecture firm in Draper, Utah. He is a board member of the Utah Irrigation Association and TreeUtah and serves on the Sandy City Trails Committee.

**Jamie Maslyn**, MLA '97, CIVITAS, visited the LAEP Department in November 1999 and conducted a three-day sketch problem in the recreation design studio. Jamie presented the Denver Commons Park and her paper, given at the 1999 ASLA annual meeting, entitled, "The Modern Landscape Architect and Creativity: What Creates It, Shapes It, and Inspires It?" Most recently, she has been heavily involved working with principal Mark Johnson, BLA '75, on the design of the new Salt Lake City Library plaza, with Moshe Safdie and Associates, Somerville, Massachusetts.

**Greg McPherson**, MS '81, Dr. Greg McPherson received the L.C. Chadwick Award for Arboricultural Research from the International Society of Arboriculture for research activities that have fundamentally altered our perception of the role of trees in cities. His benefit cost analysis model demonstrated the environmental value of trees and provided arborists with a needed tool for quantifying the benefits and costs associated with trees. Greg received the award at the opening ceremony of the annual meeting in Baltimore.

**Bruce Meeks**, BLA '87, Meeks and Associates, Malibu, California, had a design featured on the cover of the January 1999 issue of *Landscape Architect and Specifier News*.

**Kirk Miller**, BLA '97, is with Sno.engineering in Park City. Kirk informs us that among his current projects are 2002 Olympic venue planning for Elk Meadows, Park City Mountain Resort, Deer Valley, Canyons, and Snowbasin Ski Resorts. He has also been able to design a couple of mountain activity centers, which include tube hills, snowboard terrain parks, thrill sleds, "devil karts," alpine slides, and "any other type of mountain sliding adventure that can be put into the program."

**Andrea Moser**, BLA '00, works as a planner with Bio-West, Inc., Logan. **Mason Palmer**, BLA '98, is also with Bio-West, working as a landscape architect and planner.

**Jeffrey Peay**, BLA '97, is a landscape architect with

Envirosapes Landscape Architecture and Planning in St. George, Utah. Jeffrey also volunteers with Habitat for Humanity.

**Dale Schafer**, BLA '87, has moved to New York City, following three years in Los Angeles working with Melendez Associates, where he worked with **Jinho Jo**, BLA '93. Dale is now with Thomas Balsley Associates and is working on a new pedestrian open space in Battery Park City that connects the north side of the World Financial Center to a new theater complex and residential parcels. He has also been involved with the General Motors Plaza at the southeast corner of Central Park and a new downtown park in New Rochelle, New York.

**Norani Abu Seman**, BLA '88, NR Consultants, was featured in *Architecture Malaysia*, October 1998, for her work in the Central Area of the KLIA.

**Mike Shafer**, BLA '83, is with the City of Colorado Springs Parks and Recreation Department.

**Jan Striefel**, BLA '78, principal of Landmark Design, Inc., Salt Lake City, is serving her second year as Utah Chapter Trustee on the national ASLA board. **Mathew Winward**, BLA '00, has joined the staff at Landmark Design, which also includes **Hugh Holt**, BLA '86, **Wendy Vaughn**, BLA '96, and **James Zaugg**, BLA '98.

**Sumner Swaner**, BLA '84, president of Swaner Design, Inc., sponsored a one-day Community Open Space Planning Forum on open space trends for the Intermountain West, featuring Utah Governor Michael Leavitt and other noteworthy speakers. **Sharon Hauri**, MLA '00, is employed by Swaner Design and serves on the ASLA Utah Chapter Executive Committee as member-at-large.

**John Taufer**, BLA '80, is running a successful practice in Glenwood Springs, Colorado, where he is busy with planning and growth-related issues. John informs us that **Greg Mozian**, BLA '78, is still in the area running a successful design/build landscape practice, as is **Tom Stevens**, BLA '80, who has moved into the field of land development.

**Barbara Wyatt**, MLA '78, is in private practice in Madison, Wisconsin, specializing in historic landscape preservation. She is a past president of the Alliance for Historic Landscape Preservation.

A significant number of LAEP graduates are working for the California Department of Transportation (CalTrans). Those we have been made aware of are **Mike Ferrara**, MLA '89, Sacramento; **Curtis Johnson**, BLA '81, Los Angeles; **Ken Thomson**, BLA '98, Stockton; **Elbert Cox**, BLA '89 and **Rich Kester**, BLA '88, Fresno; and **Ted Thurston**, BLA '89 and **Michael Kohlbenschlag**, BLA '76, San Diego.

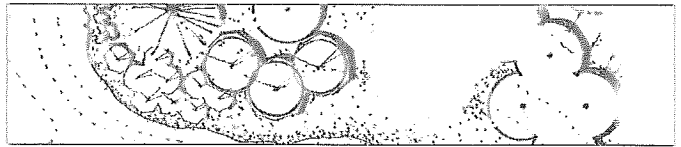

# Class of '81 Reunion

Members of the Class of '81 held a 20 year "mini-reunion" Oct. 5-7 in Logan. Participants met with students during afternoon studios on Friday and assembled with LAEP faculty for an evening social and dinner. Saturday provided an opportunity to explore the old and new Logan hangouts and watering holes, as well as to enjoy the autumn splendor of Logan Canyon. Rumor has it that at least a few paintings left Jerry Fuhrman's studio as souvenirs of Cache Valley, Alumni, who came literally from coast to coast, included:

**Kurt Altwater** - Senior Vice President, Bank of America, San Francisco - commercial real estate finance

**Dale Buckstaff** - Boulder, Colorado - insurance sales and marketing

**Steve Call** - Summit County, Utah, Planning Department

**Nola Chavez** - National Park Service, Denver

**Mark Dawson** - Principal, Sasaki Associates, Watertown, Massachusetts - director of landscape architecture

**Scott Johnson** - Partner, McConnell Johnson, Wilmington, Delaware - commercial brokerage

**Paul Keeler** - Owner, Deseret Land Design, Brigham City - residential design & build

**Bruce Maw** - Campus Landscape Architect, Brigham Young University, Provo

**John Peters** - Principal / Owner, JPA, Ridgeway, Colorado - land planning, landscape architecture, and site engineering

**Michael Schneider** - Principal/Owner - Orange Street Gallery, Los Angeles

## Looking back: Alums reunite in St. Louis

by Craig Johnson

A number of alums stopped by the LAEP table at the 2000 ASLA Annual Meeting in St. Louis. It was nice to get reacquainted, trade war stories and re-live the good old days. The fact that many of you recall the good old days in the basement of Old Main and Mechanic Arts suggests more than a few old timers were in St. Louis.

It's always nice to be reminded of the exceptional people who have gone through our program and on to work that benefits society and the environment. Thanks to all who stopped by (hope I haven't forgotten anyone). We appreciate your continued support.

**Anthony Bauer** (1962)

**Joe Porter** (1963)

**Bruce Jorgensen** (1969)

**Robert W. Smith** (1970)

**Kent Sundberg** (1974)

**Mark Johnson** (1975)

**Jim McKnight** (1979)

**John Ellsworth** (1982)

**Deborah Bowden** (1983)

**Joe Donaldson** (1983)

**Bob Cushman** (1986)

**Cari Goetcheus** (1987)

**Lee Skabelund** (1988)

**Jereck Boss** (1993)

**Justin Hamula** (1995)

**Danette Leatherman** (1997)

**Ann Mullins** (1997)



A table of USU LAEP Alumni enjoying themselves at the 2001 awards banquet.

# Alumni Updates

(1999 to the present) Continued....

## Distinguished alumni recognition awards

Each spring at the annual awards banquet, the department presents Distinguished Alumni Awards in recognition of professional success and accomplishments.

### 1999-2000 Recipients

#### *Stuart Macdonald, M.L.A., 1979*

Stuart Macdonald came to USU in 1976 with a bachelor's degree in English from San Francisco State. Graduating from the LAEP master's program in 1979, his first job was with U.S. Forest Service recreation in Oregon, followed by service as a VISTA volunteer in Denver.

After working as a trails planner for Jefferson County's open space program, Stuart was hired in 1984 as the first State Trails Coordinator for Colorado State Parks. He works with a wide variety of trail groups, communities, and agencies on trail planning, development, funding, and management issues. He administers Colorado's three-million-dollar annual trail grants program and supervises the state's off-highway vehicle program. He has served as chair of the National Recreational Trails Advisory Committee and founded the National Association of State Trail Administrators. For the past two years, he was on a national committee charged with writing regulations for trails under the Americans with Disabilities Act. He also edits a national trails newsletter and, since 1996, has been developing and maintaining the American Trails Web site. Stuart lives in Denver and commutes by bicycle to his office downtown.

#### *Burton L. Taylor, B.L.A. 1948 (posthumous)*

Burton L. Taylor received his bachelor's degree from Utah State Agricultural College in 1948, a member of the huge post-war class of six. (The total number of LAEP graduates since the founding of the program in 1939 had been eight.)

Burt completed his MLA at Harvard in 1951 and entered private practice. His extensive list of projects included work with Shurcliff & Merrill, Victor Gruen Associates, and Pereira and Luckman. As a planner with the Department of the Army, Burt was responsible for the master planning of numerous Army bases and their amenities. Burt was enticed back to Logan to become the second head of the LAEP program in 1964 when Laval Morris retired. In May 1966, the department received its first accreditation, becoming the 19th accredited landscape architecture program in the country.

During Burt's administration, the number of majors in the program increased from 73 to 185, the highest number in the highest enrollment in history, until recently, and the faculty was expanded to six full-time members. His vision to develop a graduate program was rewarded with the recognition of both the MS and MLA degrees in 1968. Burt was instrumental in obtaining new space for the department in the Mechanic Arts Building in 1970. The department had operated for years from cramped quarters in the basement of Old Main. He stepped down as department head in 1973 and passed away shortly thereafter.

#### *Theodore D. Walker, B.L.A. 1957*

Ted Walker has a long and distinguished career as a practitioner, educator, and writer/publisher of landscape architectural books. His extensive professional experience included six years as campus planner for Brigham Young University and many years of private practice in Utah, Indiana and Arizona. He earned a Master of Landscape Architecture at the University of Illinois in 1967 and served on the faculty at Purdue University from 1972-80, attaining the rank of Associate Professor.

Ted has been an active member of ASLA, serving in various leadership capacities at the regional and national level, including trustee of the Indiana chapter. He has served as a member of the Landscape Architectural Accreditation Board (LAAB). Ted is a Fellow of ASLA and received a CELA Award of Recognition for Contributions to Education.

In 1970, Walker founded PDA Publishing, which served as a conduit for most of his own books, including:

*Perception and Environmental Design*, 1971

*Perspective Sketches*, 1972, 1975, 1977

*Plants in the Landscape*, 1975

*Plan Graphics*, 1975, 1977

*Site Design and Construction Detailing*, 1978

*Designs for Parks and Recreation Spaces*, 1987

Ted is also an accomplished cellist and has played with regional symphonies.

## 2000-2001 Recipients

### *Dave Bell, B.L.A., 1970*

As the USU Extension Landscape Architect since 1993, Dave Bell has raised awareness in rural areas throughout the state of the need for planning and of what can be done to preserve farmland and the sense of community in the face of inevitable growth and development. His ability to listen and pull people into discussions has lowered barriers to new ideas and made people comfortable with managed growth concepts.

After earning an MLA from the University of Michigan, Dave worked on new community planning, first for the Rouse Company in Baltimore, later for Land Design Research in Columbia, Maryland. In 1976, he moved back to Utah where, in partnership with Jay Nielson, he founded Land Design, with offices in Logan and Salt Lake City. Together they designed residential and waterfront projects all over the world, from Houston and Baltimore to Hong Kong, Singapore, and Sicily. One of the firm's highest profile projects the Triad Center, for which they did the site development and landscape architecture was also the one that put them out of business. Afterwards, Dave worked for Design Workshop in Denver and Phoenix for five years, planning the new towns of Estrella (in Phoenix) and Summerlin in Las Vegas, plus a ski resort in Japan. Returning to Logan, he consulted on his own until taking the Extension position.



*Karen Hanna presents the Distinguished Alumni Award to Bruce Jorgensen.*

### *Bruce Jorgensen, B.L.A., 1969*

Bruce Jorgensen, ASLA, an associate principal with Gillies Stransky Brems Smith pc, Salt Lake City, has been active in both the state and national ASLA, serving as Utah chapter president and two terms as trustee. He sat on the awards committee for Envision Utah (which is master-planning the Wasatch "Front and Back"), as well as on Salt Lake City's Urban Forestry Board. He currently serves on the LAEP Advisory Board.

Bruce has influenced site planning up and down the state, from St. George to Logan. Working with renowned Utah landscape architect Karsten Hansen and with the Salt Lake County Parks Department, he designed numerous parks along the Wasatch Front. His work on visual inventories for the BLM at the Book Cliffs and at a site near Moab became the basis for identifying wilderness areas in the state. At GSBS, Bruce headed master plans for Micron, Intel, and others and, in partnership with Salt Lake City and volunteer groups, he master-planned a system of inter-connecting trails and parks from the foothills to the Great Salt Lake. Most recently, he worked on the siting of the massive Gateway Project in downtown Salt Lake City.

### *Mark Dawson, B.L.A., 1988*

Mark launched his career with Sasaki Associates, Watertown, Massachusetts, immediately after graduating from USU in 1981. He left ten years later to form his own landscape architectural practice in Dallas but returned to Sasaki in 1995. He has since become a principal with the company, overseeing the work of some 250 landscape architects.

Mark has, of course, contributed to numerous projects that have made Sasaki justifiably renowned. The best known of his achievements may be Legoland, the \$165 million amusement park in Carlsbad, California. Mark coordinated design and served as overall supervisor and project manager. His work included water features, lighting of landscape 'showscapes,' and all site improvements.

Mark is the principal in charge of design and implementation of the master plan of water frontage uses for National Harbor in Washington, DC, a development along the Potomac River. His designs will include a new water front promenade, dock space, plazas, and landscape along the entire two miles of the development's river frontage.

Other highlights of his work as a landscape architect and planner include the Green Garden Residential Development in Jakarta, Indonesia; the Hayden Library Expansion at Arizona State University in Tempe; and the Choctaw Center and Resort and the Choctaw Casino in Philadelphia, Mississippi.

A member of ASLA, Mark is registered in 10 states, as well as with CLARB (the Council of Landscape Architectural Registration Boards). He is a member of the LAEP Advisory Board.



*Mark Dawson receives the Distinguished Alumni Award.*

# From the Studios.....

## Around Town

### *River Heights* by Craig Johnson

Last spring (2001), the entire senior class of 24 students spent seven and a half weeks reading extensively about landscape ecology and conservation biology. They were studying a two-and-a-half-mile stretch of the Spring Creek corridor south of Logan between River Heights and Providence, figuring out how to protect it in the face of active development.

The creek corridor is a critical piece of landscape. It hosts some 65 species of wildlife, including 30 to 35 species that use the area for breeding. It is also the original location of the City of Providence. Spring Creek provides open-space linkage between the Logan River and the Bonneville Shoreline Trail. Recognizing its importance, the communities of River Heights and Providence have applied for a MacAllister grant to acquire conservation easements on the land.

After inventorying plant and animal species and developing general conservation scenarios that would restore habitat and protect biodiversity along the corridor, students showed what was possible inside that easement in terms of conservation. At a public presentation attended by 60 to 70 people, they advised citizens, elected officials, and developers to “do the right thing” and preserve, enhance, and restore habitat within the corridor. Ultimately the community will hire consultants for detailed design and planning.



*Model of Sunshine Terrace by Senior Josh Runhaar.*

interaction with the landscape.

Students conducted extensive background research to understand the specialized recreational needs and design requirements for accommodating the aging and disabled. Meetings with Sunshine Terrace employees and clients of the present Day Center helped to define design issues and requirements. A site plan was developed, showing general landscape treatment, and a portion of the site was developed in greater detail as a three-dimensional model. Final designs were presented to the staff and clients of the Day Center and the Sunshine Terrace Board of Directors.

The design ideas that were developed will help to inform the ultimate landscape development of the site, providing a significant therapeutic setting for future clients of the Center.

Student Ryan Weston's design guidelines for the Center won a 2000 ASLA Utah Chapter Student Honor Award. Weston's guidelines stipulated the height of table planters to accommodate wheel chair access; paths that offer interesting views, with plants alongside that people can smell and touch and with textured edge guides and changing patterns of pavement to provide direction for the visually impaired; bench arrangements that offer the choice

### *Sunshine Terrace Day Center*

by Michael Timmons

Since 1948, the Sunshine Terrace Foundation has provided services in nursing care, adult day care, and assisted living. The nursing center provides subacute extended care, special needs care, short-term rehabilitation, and respite care. The main nursing facility, located at 225 N. 200 West in Logan, is a 172-bed nursing facility serving individuals of all ages. The Day Center, accessed from 300 West, provides an important service for clients who live primarily with their families but require and/or desire attention during the day.

A new facility, currently under construction, will replace the existing Sunshine Terrace Day Center on a site located adjacent to the Terrace Grove Assisted Living Center, one block north of the current location. This new structure will not only provide a tremendous upgrade architecturally, but will allow an enhanced



*Model of a therapy garden by Senior Laura Bohn.*

of being up front, in back, to the side, in groups, off alone, in sun and in shade; trees whose foliage moves easily and “creates noise even in a slight breeze;” plants selected to form an ecosystem that attracts birds and butterflies but not bees and undesirable insects; and many other ideas to make the landscape a place where visitors can themselves garden or merely enjoy the space, “taking their cares and attention off their individual circumstances,” as Weston wrote in his description.

## *Angel's Landing* by Michael Timmons

Cache Valley has not had a playground that adequately meets the needs of children with disabilities. A number of community parents and advocates have been interested in seeing one constructed, and Keith Christensen's (MLA '01) master's thesis, “Accessible Play: Outdoor Playspace Guidelines for Children with Special Needs,” provided the impetus for a proposed new playground called Angel's Landing.

Designed by students in the Junior Recreation Design Studio under the direction of Professors Budge and Timmons, the locally funded and community built project will be constructed either on or near an existing playground in the Willow Park recreational complex in southwest Logan. The existing playground is in a state of disrepair and will be removed.

The design solutions, created in three-dimensional model form, were presented to a jury of key individuals, who will be instrumental in overseeing the project's implementation.

Keith's master's thesis has already led him into a unique professional niche as an accessibility specialist with the USU Center for Persons with Disabilities.

## *Downtown Logan* by Karen Hanna

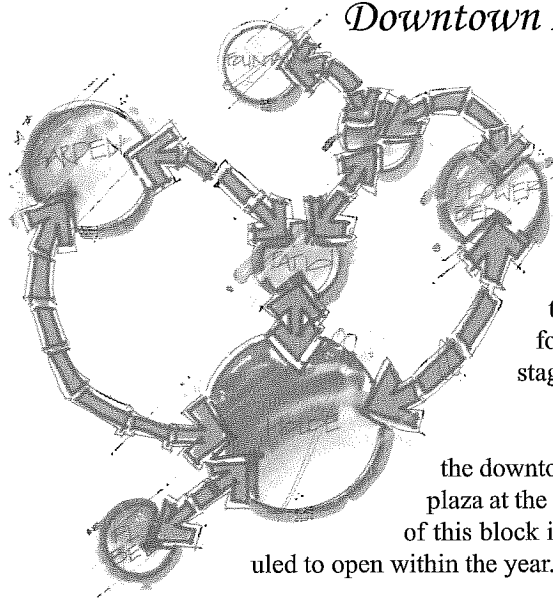

Several projects have been underway recently that coincide with the City of Logan's current visioning effort. Mayor Doug Thompson initiated the visioning exercise for downtown Logan last spring. About 150 people formed advisory groups that have participated in a series of meetings and workshops. These groups are made up of retailers, residents, professionals, hospitality and food service providers, government workers, and historic preservationists. This summer, retail consultant Robert Gibbs, of Birmingham, Michigan, led a three-day workshop for selected members of the advisory groups and a report is in the final stages now.

In conjunction with this effort, LAEP has undertaken several projects in the downtown area. Caroline Lavoie's senior design studio prepared plans for a new plaza at the Cache County Courthouse, on the corner of 200 North and Main. The rest of this block is currently under construction, with several new federal buildings scheduled to open within the year.

Mike Timmons' sophomore design studio prepared designs for “block 10”. This is the block immediately south of 100 South and just east of Main. It is where the farmer's market is held, and the canal bisects the site. These plans were also reviewed by city staff.

Karen Hanna taught a GIS-based class in the spring, using a digital database of 12 blocks of downtown Logan. Three groups of students used the existing database and added new data that they collected on pedestrian routes, existing trees and existing building types. Each group prepared a conceptual plan of downtown based on a village concept, the new-urbanist concept, or a super-block approach. These, too, were presented to several Logan City staff, including the city planner, Jay Nielson, the city engineer, Mike Meacham, and the economic development officer, Nevin Limburg.

Karen Hanna is currently teaching the LAEP 6100, Regional Planning, also using GIS technology. She is assisted in this class by Carlos Licon, Debi Jensen, and Kris Kvarfordt. Ms. Jensen is ESRI's site license manager for USU, and has been instrumental in organizing the database. The project looks at future growth patterns along two corridors in Cache Valley. Each study area is 10 miles long and one mile wide. One begins just south of Wellsville and follows Hwy. 89 to Logan. The other begins at 600 West and follows Hwy. 30 to the Cache County line. The students are studying transportation-oriented design theory and watershed protection strategies for this project.

# From the Studios.....

Continued....

## Around the Region

### *Santa Clara Reserve* by Michael Timmons

The Junior Recreation Design Studio is currently involved with master planning and detail design development for a significant parcel of BLM land adjacent to the rapidly urbanizing communities of Ivins and Santa Clara in the southwestern corner of Utah. Included on the site is a three-mile segment of the Santa Clara River, which is richly endowed with a riparian plant community, significant collections of ancient petroglyphs, dwellings, and burial sites, and thousands of acres of rugged southern Utah landscape.

Cimmaron Chacon, MLA '99, the BLM landscape architect in St. George, has coordinated LAEP involvement on the project, which included a three-day camping trip and site inventory in late September. Students met with representatives of Ivins and Santa Clara cities, in an effort to understand the local perspective on the site, and with BLM specialists, who provided briefings on site resources.

The 33 members of the class then spent a day hiking assigned segments of the site in 95 degree heat. While Professors Timmons and Budge, along with a handful of select grad students, smugly returned to their digs in the air-conditioned Red Mountain Spa, the resourceful campers made their way to an evening of swimming, cliff diving, dutch oven cooking and karaoke around the campfire at Gunlock Reservoir.

Alternative master plans will be developed, which will attempt to balance the need for preservation and interpretation of the archaeological resource with the ever-increasing demand for recreation in this developing part of the state. Detailed design studies will allow further examination of recreational and cultural park facilities. A return trip to present findings to interested citizens and agency personnel will take place at the end of the semester.

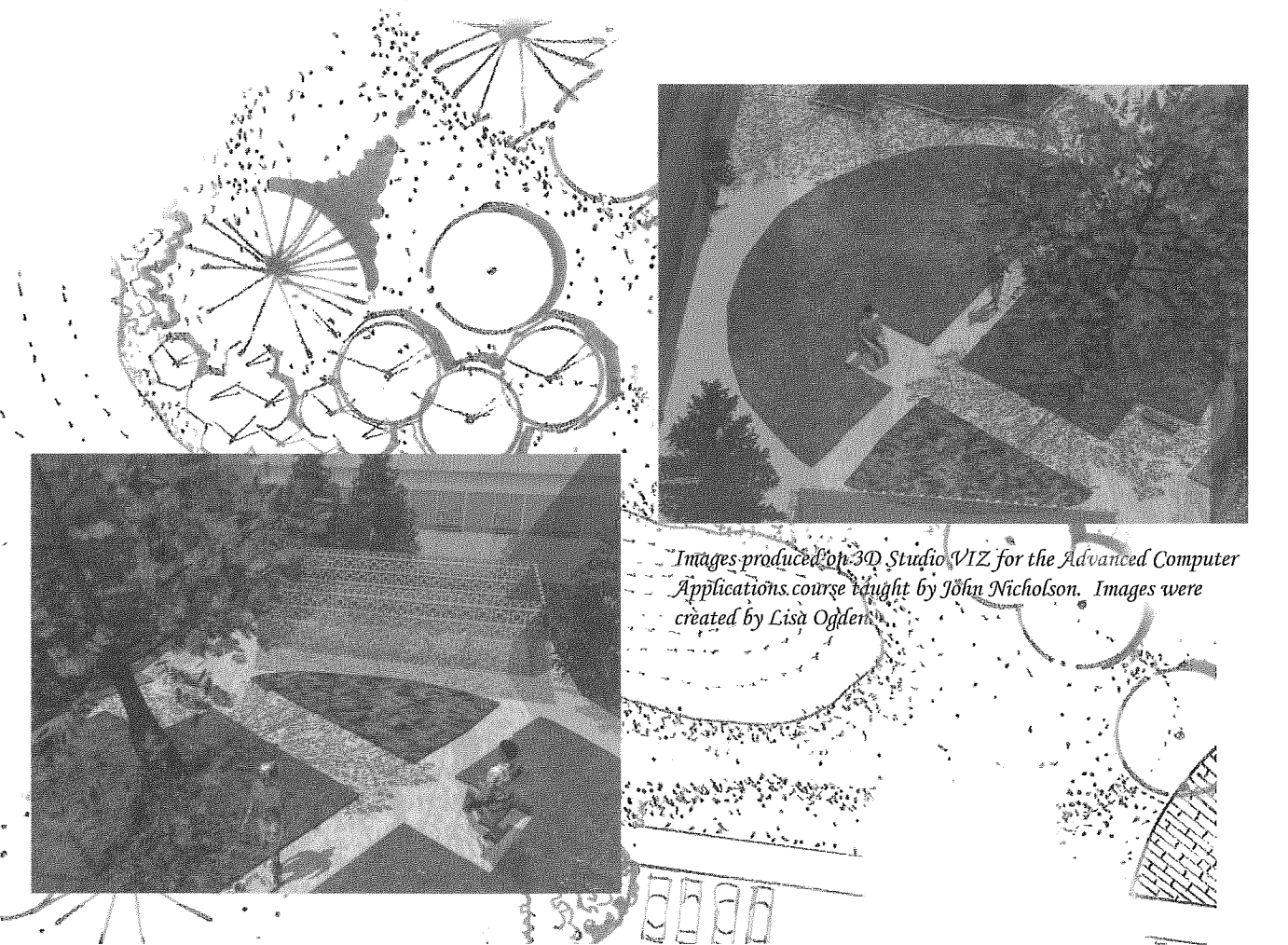

*Images produced on 3D Studio VIZ for the Advanced Computer Applications course taught by John Nicholson. Images were created by Lisa Ogden.*

## *Around the World Spring Break Field Trip*

Some 20 students, sophomores, juniors, and graduate students, joined Dick Toth, Dave Bell, and Craig Johnson during spring break last year for the annual tour, this time exploring Seattle, Vancouver, and Portland. In Seattle, besides touring the University of Washington, downtown Seattle, Freeway Park and, new urbanism housing projects, the group also met with city transportation planners, Jones and Jones, Walker Macey, and the Peridian Group.

Alum Carol Mayer Reed joined the group in Portland and guided them through such sights as Pioneer Square, urban infill housing, the river front development, Weyerhaeuser headquarters, Halprin fountains, and Freeway Park.

Sites visited in Vancouver, which all agreed is an amazing place, included the British Columbia Hall of Justice, Gastown, the Museum of Anthropology, and many of the city's urban parks.

With half a day to a whole day in each city to explore on their own, students were able to take in a lot more private offices, public sites, and public agencies.

All this and a full credit, too!

## *The Global Village*

*Students, faculty exchange visits with counterparts in other countries by Prof. John Nicholson, Coordinator of International Programs, and Prof. Mike Timmons, Associate Professor and Undergraduate Program Director*

The department is continuing to strengthen its international ties with other universities. Of particular note is our 15-year relationship with the University of Ljubljana, Slovenia. The contact began with a visit to USU by Prof. Dusan Ogrin in 1986 and a Fulbright-sponsored visit to Ljubljana by Prof. Toth in 1988. During the spring quarter of 1991, thanks to a \$25,000 Samantha Smith Memorial Exchange Grant, which is administered by the United States Information Agency (USIA), our department hosted 23 students from Ljubljana. In 1993, Professors Budge and Nicholson accompanied nine USU students to Ljubljana for spring semester. Since then, visits have included:

Two students from Ljubljana to USU in 1995

*Natalie Robins* (USU) to Slovenia in 1998

*Allysia Angus* (USU) to Slovenia in 1999

One student from Ljubljana to USU in 1999

*Nancy Montieth* (USU) to Slovenia in 2000

This year, *Melanie Andrus*, a USU junior, is in Ljubljana. She writes that things are going very well, and she was excited about a trip to Italy the class was taking October 19-21, 2001.

*Valentina Toman* from Slovenia is attending USU

this semester, where she is enrolled in landscape history, planting design, and recreation design. She lives in San Juan Hall, where she participates as a member of USU's Global Village program. This new program creates a unique on-campus experience, which includes special programming for Honors students and students with international backgrounds or career interests, language enrichment activities, foreign food potlucks, fireside chats with faculty and foreign visitors, National Park excursions and cultural events. As with previous visitors from Ljubljana, Valentina brings a fresh outlook to the studio and exposes LAEP students to new and different approaches to landscape architecture.

The Marie Eccles Caine Foundation made it possible for Dr. Davor Gazvoda, a scholar from the University of Ljubljana and a major figure in landscape architecture education in Europe, to join us for a two-week visit and workshop last fall. An assistant professor of landscape architecture with the biotechnical faculty, Dr. Gazvoda also has his own private practice and is very active in the European Conference of Landscape Architecture Schools (ECLAS). He received his Doctor of Design degree from Harvard in 1997.

In exchange, Prof. Nicholson will be lecturing in Ljubljana, as well as in Zagreb, Croatia, this winter.

As important as it is, Slovenia is certainly not our only international connection. The Marie Eccles Caine Foundation is also supporting Prashant Bhat, a guest landscape architect from India, this fall, thanks to a grant application written by Prof. Ellsworth.

*Yaritza Pinzon*, an exchange student from Mexico, is also spending the academic year with us.

## *The globe comes to LAEP*

The LAEP Department has always benefited from an influx of students of various nationalities. These foreign guests bring a diversity of perspectives to the program and challenge our preconceived notions of design and culture. This year, in addition to the exchange students from Slovenia and Mexico mentioned above, we are enriched by 10 foreign nationals attending as LAEP majors, representing six countries: *Masaki Onogi, Saori Endo*, and *Yoshinori Watanabe*, from Japan; *Jianxin Dai* and *Jiayi Wan* from the Peoples' Republic of China; *Florencia deMiguel*, Argentina; *Dorothy Kim and Chang Kook Kim*, Korea; *AnaBell Cardenas*, Ecuador; and *Suzanna Sumartoyo*, Ethiopia. Welcome to all of you!

## *Morris Traveling Fellowship*

The Morris Traveling Fellowship was established July 2, 1976, for the Department of Landscape Architecture and Environmental Planning at Utah State University through a fund donated by LaVal S. Morris, his wife Rachel Bankhead Morris, their sons John Koran and Willford Bryon Morris, and La Val's brother, Collin Morris. The purpose of the fellowship is to enrich a student's formal education through travel, which the Morris' felt to be a most important factor in rounding out one's understanding and skills in environmental design.



# From the Studios.....

*Continued....*

The fellowship is awarded annually to an outstanding graduating senior or graduate student in the LAEP Department for travel outside North America. Applicants must supply, with the application, a specific statement of travel goals and objectives outlining their focus. A condition of the award is the creation of a tangible product representing their travel experiences, and a formal presentation of their travels to the department upon their return.

**Stephanie Grigsby** traveled to New Zealand during the spring of 2000. Her trip took her throughout the country, from Auckland to Fjordland. Her presentation to the department during LAEP Week, April 2001, conveyed the splendor of this wonderful island nation and the sensitive care for the land displayed by the population.

**Nancy Montieth** was awarded the Morris Traveling fellowship for a proposed trip to India for this fall but has delayed her trip for a year, given the fighting in nearby Afghanistan.

## *Other Travelers*

**Megan McCullough**, an LAEP senior, is completing her education through a program entitled "The Shape of Two Cities," offered through the Graduate School of Architecture, Planning, and Preservation at Columbia University. Megan is spending fall semester in New York City and spring semester in Paris. Intensive design studios in both cities instill the students with an appreciation for urban history and the uniqueness of design response in the two very different cultures. Megan plans to return for commencement in Logan next spring (2002).

Senior students **Laura Bohn**, **Florencia deMiguel**, and **Jamie Drysdale** participated in the Italia 2000 foreign study program, offered by the University of Manitoba, in the summer of 2000. The six-week course, based in a small community in the foothills of the Alps north of Venice, focused on design explorations for urban open space and historic restoration. Numerous trips took the students to significant sites throughout northern Italy and Rome. Despite the rigor of the program, the students seem to have found ample time to soak in the essence of life in Italy.

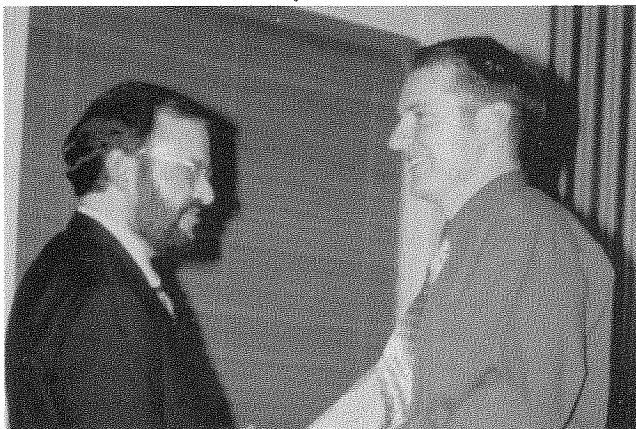

*John Ellsworth and James Dotson at the 2001 Awards Banquet.*



*John Ellsworth and Jared Barnes at the 2001 LAEP Awards Banquet. Jared was the coordinator of the 2001 Sustainability Conference.*

## On Campus.

### *Students develop seminar, course, and organization on sustainability*

*by Jeremy Call, MLA 2003*

For those of you who have attended the First or Second Annual Sustainability Conference organized by From the Ground Up, you know that the events not only offered professional development opportunities for faculty, professionals, and students alike, but also showcased a number of engaging speakers and addressed some of the most pressing concerns regarding sustainability in the fields of planning and design in the Intermountain West. For those of you who were unable to participate previously, we hope that you will plan to join us April 10-11, 2002, for the Third Annual Sustainability Conference--the only event at Utah State University specifically geared toward addressing sustainability and the most exciting student-sponsored symposium in the region.

The idea began in 1999 with Sharen Hauri (MLA '00) and a group of students who felt that knowledge of sustainable design and resource use could be enriched by a conference. Organizing themselves into From the Ground Up, they set to work organizing a symposium and a one-credit seminar course for students taught by students as a forum to discuss theories and case studies of sustainability with respect to the fields of landscape architecture and environmental planning.

The culmination of the winter semester course was a kick-off conference entitled Sustainable Landscapes, which was patterned after similar student-sponsored events at other universities. The purpose of the conference was to make information more accessible and more usable by engaging participants in discussions with people actively involved in finding ways to live with less impact on the land.

The conference in April 2000 was a huge success, drawing in more than 200 students from USU and other universities and more than 70 community leaders, professionals, and concerned citizens. Sixteen speakers, including such notable leaders such as Achva Stein, Tom Ash, Sumner Swaner (BLA '84), Greg McPherson (MS '81), and Brooke Williams, discussed a range of topics from community and land planning to resource conservation.

Last spring, MLA student Jared Barnes and a group of committed volunteers took up the challenge of making the conference a university tradition by again organizing and implementing a regional conference in April 2001. Landscape Frontiers: Design for the New Millennium examined new ways to incorporate sustainable practices at all levels of landscape scale. The conference followed LAEP week and featured 12 speakers, including Joe Porter (BFA '63) of Design Workshop, Inc., Denver; Darrel Morrison from the University of Georgia; Gerald Smith from Cal Poly, San Louis Obispo; Joan Woodward from Cal Poly, Ponomo; Tony Bauer (USU BS '62), emeritus form Michigan State University; Joe Donaldson (MLA '82); and Carol Mayer Reed (MLA '77), a founding partner of Mayer/Reed in Portland.

This year the torch has been passed to Wendy Mee, a graduating MLA student (2002), and another group of students who are determined to make the 2002 event, Landscape Transects, the most engaging student-sponsored conference in the region. The conference will explore the interdependencies of sustainability, from wilderness to the urban core. Attendees will have the opportunity to hear presentations from prominent speakers and local practitioners and learn how to apply this knowledge to the Intermountain West.

This fall, From the Ground Up launched a new Web site at [sustainablelandscapes.org](http://sustainablelandscapes.org), where participants can get up-to-date information on conference registration, sponsors, and schedules. We welcome those who wish to present or offer suggestions and invite them to contact Wendy at [wmee@sustainablelandscapes.org](mailto:wmee@sustainablelandscapes.org).

From the Ground Up would like to recognize the generous support of the LAEP faculty and the College of Humanities, Arts, and Social Sciences; the College of Natural Resources and its affiliated departments, including the Natural Resource and Environmental Policy Program; the Utah Botanical Center; the Bear River Institute; the Bear River Association of Governments; the Utah Humanities Council; the Utah Chapter of ASLA, and the Marriner S. Eccles Foundation, who have contributed time, effort, and funds to subsidize registration fees and make the conference a success. We also would like to thank the volunteers, speakers, and participants of the previous years and invite you to participate once again in a conference that is shaping the dialogue of sustainability in the Intermountain West.

## *New faces in Logan*

Utah State University and LAEP welcomed several new personalities this year. Starting at the top is our new president. Kermit Hall came to USU as president in January and substituted his formal inauguration with a student showcase and an Inaugural Student Scholarship Endowment. Prior to his appointment to USU, President Hall was provost at North Carolina State, following a distinguished academic career at Ohio State University.

A highly respected historian, President Hall is one of five who was selected to determine which of John F. Kennedy's papers would be made public. He is also a recognized expert in constitutional law. Dr. Hall has an MSL degree from Yale University Law School, a PhD in history from the University of Minnesota, an MA degree from Syracuse University, and a BA degree from the University of Akron. He also completed the program at Harvard University's Institute for Educational Management.

President Hall has initiated his stay in Utah by milking a cow in every county in the state. He has also made a dynamic impression on the state legislature as evidenced by his procurement of funds for expansion of the Merrill Library.

Jack Payne is the University's new Vice-President for University Extension, and Continuing Education. Dr. Payne studied wildlife biology at USU before spending two decades with Ducks Unlimited. He will work to clarify the mission of USU as a land-grant institution.

Liz Grobsmith is the new dean of the College of Humanities, Arts and Social Sciences. Since LAEP is a member of HASS, Dean Grobsmith will be directly involved in the future of the department. Dr. Grobsmith comes to Logan from Colorado Springs, where she was dean of Arts and Sciences at Colorado State. Her degrees are in music and anthropology, and her research concerns Native Americans in the West.

HASS's former dean, Stan Albrecht, is now USU's provost. It's comforting to know that Stan is familiar with the successes and needs of LAEP.

Marsha Ainscough is the department assistant for LAEP. Marsha spent a year in the graduate studies office of the College of Business before joining landscape architecture. She has returned to Cache Valley after 20 years as a corporate assistant in southern California. Marsha's skills include desktop publishing, editing, bookkeeping and all-around problem-solving. Her positive, cheerful disposition is much appreciated by faculty and students alike.

Carlos Licon has come as a lecturer to LAEP. He moved here from Tempe, Arizona, where he is a PhD candidate in environmental planning. A native of Mexico, Carlos earned his first degree in Monterrey, Mexico, and practiced architecture in Chihuahua. His MEP is from Arizona State, and his doctoral dissertation will examine indicators of sustainable communities. Carlos is teaching graphics, planning, and site analysis.

# On Campus

Continued.....

## School of the Arts

The College of Humanities, Arts and Social Sciences is working on a proposal to form a School of the Arts. The School would include the Departments of Art, LAEP, Music, and Theater, as well as the Nora Eccles Harrison Museum of Art, and the creative writing center of the English Department.

Initial proposals include a Center for the Digital Arts, a Community of the Arts, and a Foundation Group for introductory courses. The Center for the Digital Arts would be a teaching facility, a research laboratory, an archiving facility, and a production center for new educational delivery methods. The Community of the Arts would continue the work currently being done by all the units, including concerts, plays, artists and writers in residence, and outreach such as community design. The Foundation Group would bring introductory courses into a common program. Common courses might include two and three dimensional design, drawing, and computer courses such as CAD and photo-simulation.

The primary goal of the School of the Arts is to promote collaboration in the arts. The traditional role of landscape architects as designers would be emphasized through projects such as land art, earth sculpting, and design of performance venues. LAEP's strong affiliation with natural resources and regional planning would not be diminished as a result of its participation in the School of the Arts. It is likely that most arts participation would be at the undergraduate level, while the graduate program would continue its focus on communities and the environment.

The School of the Arts has been identified by USU's President Hall as a top priority for the upcoming capital campaign. HASS is very proud of its arts programs and is committed to improving their excellence.

## Posters on the Hill

Students show public (and legislators) the quality and value of their research

The Cub River Watershed Futures Study, Phase Two, was part of an exhibit in the Capitol Rotunda and a presentation to legislators during the 2001 legislative session. "Posters on the Hill: A Celebration of Undergraduate Research" showcased 15 undergraduate USU research projects, as well as projects from University of Utah students.

As course work for the undergraduate spring semester studio on residential and community design, junior-year students Brett Nielsen, Phil Washburn, Jonathan Fredericks, Jason Lee, and Brian Stevens analyzed the area between Logan, Utah, and Preston, Idaho, to determine impacts of population growth on transportation systems, infrastructure, and general public health, welfare, and safety issues. Mentored by Professors Toth and Budge, the students also studied how quality of life issues of the local population can be represented or defended in the face of this development.

Phase Two of the study was split into four parts: reading and research to study current trends in community and residential development; current design standards (reflecting trends in the area), innovative design (contributing to "sense of community"), and new community design (based upon economic and environmental concerns).

Funding was provided by the Bear River Resource Conservation Development Office; the Franklin County (Idaho) Commissioner's office; Cache County planning office; Bear River Association of Governments; USU Extension -- Water Quality Programs; the Marriner S. Eccles Foundation; and the USDA Natural Resource Conservation Service (NRCS).

Dr. Joyce Kinkead, USU Associate Vice President for Research, organized this first "Posters on the Hill" project.

Phases One and Two of the Cub River Watershed Futures Study each received a 2001 Award of Merit from the Utah Chapter of the American Society of Landscape Architects.

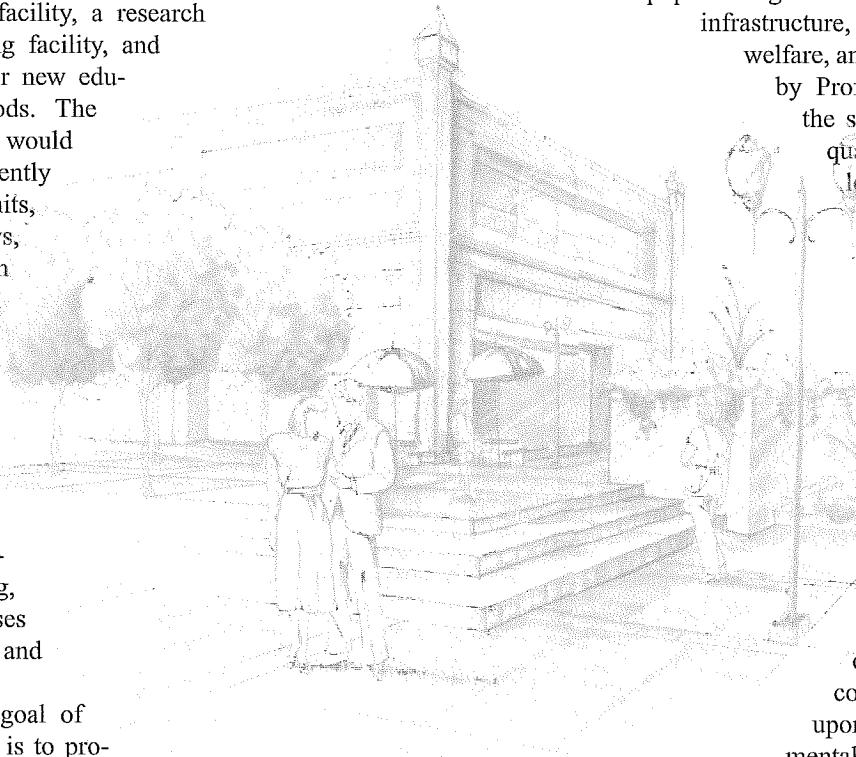

Perspective drawn by Allison Hopkin

## Landscape Architecture archive at USU *by Betty Schoeffler*

Bill Neff's work as a Utah nurseryman and landscape architect spanned much of the Twentieth Century. When he died earlier this year, the papers documenting his role in the history of the designed landscape in Utah -- his correspondence, photographs, designs, plans, lists and other memorabilia -- came very close to being destroyed. Once they were rescued, it was difficult to find a place for them. No central repository existed anywhere in the Intermountain West for material relating to landscape architecture, design, plants, and planning.

Neff's friend and colleague Esther Truitt Henrichsen, a landscape historian, contacted the Catalog of Landscape Records in the United States at Wave Hill, which gathers and catalogs information about the location and content of collections related to our use of the land. After some investigation, Catha Grace Rambusch at Wave Hill found a perfect place for Neff's papers: Utah State University, with one of the top 10 graduate schools of landscape architecture in the country. Problem was, Merrill Library on the USU campus had neither space nor staff to handle such a project.

At about the same time, the archivist at Design Workshop, Inc. (DWI), Denver, and USU Special Collections Curator Ann Buttars paid a visit to LAEP Department Head Karen Hanna to discuss DWI's wish to find a permanent home for its documents.

Buttars had been on the lookout for a new area of expansion that could become a significant part of a new USU library now being discussed. She accepted the Neff collection, put it in library storage, and continued discussions with Karen about a Western Landscape Architecture Archive.

All that stands in the way of this invaluable resource for historians and students is about \$250,000 in funding. Buttars estimates that amount is the minimum necessary to endow staff, storage, reproduction, processing, and preservation. Jeannie Simmons in USU's Central Development Office has been involved in the archive discussions almost from the beginning. HASS's development office will be working on fundraising, with help from LAEP.

The LAEP Department wants to work out an agreement of support, both academic and financial, between the department and Special Collections as soon as possible. The ongoing role for the department will include helping to identify and categorize the material and providing graduate student support for the archiving process.

Although Buttars prefers not to accept any more materials until something is formalized, she is encouraging landscape architects to contact her. "I would be particularly interested in hearing from people as to whether this is a good idea or not. Is there an interest? Are there architects who would place their materials with us? Are there willing donors?" It's not inconceivable, she hints, that a portion of the new library building could be named after a major contributor.

For more information, contact Buttars at (435) 797-2661; or by e-mail at <AnnBut@ngw.lib.usu.edu>; or write to Special Collections and Archives, Merrill Library 143, Utah State University, 3000 Old Main Hill, Logan, UT 84322-3000. Or get in touch with Karen Hanna, (435) 797-0500; e-mail <kchanna@cc.usu.edu>; or write her in care of the LAEP Dept., USU, Logan, UT 84322-4005.

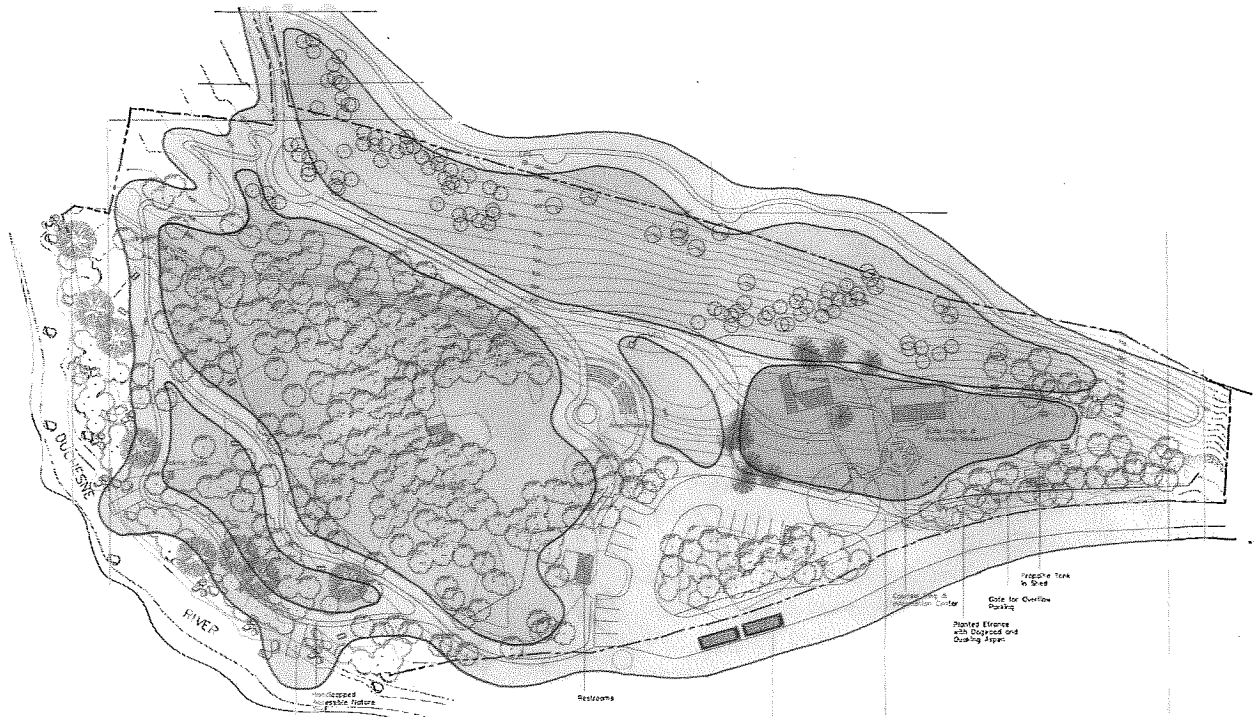

*Proposal for the Stackmore ranger Station. This map depicts management zones in order to evaluate maintenance costs after initial installation. Project by Karl Koeppen, Kris Kvarfordt, and Shalae Larsen.*

# On Campus

Continued.....

## 2000-2001 Scholarships and Awards

### HASS Seniors

James Dotson, Jon Fredericks, Lisa Sokol

### Outstanding Juniors

Nominations: Kris Kvarfordt, Lisa Ogden, Amy Reiter, Shalae Larsen

### Outstanding Sophomores

Nominations: Maria Adams, Melanie Andrus, Shar Sontag, Aaron John

### Outstanding Graduate Students

1st Year: Jennifer Brown, Adam Lankford, David Brown

2nd Year: Carrie Morgan, Jianxin Dai, Abe Medina

Teacher of the Year  
Craig Johnson

Advisor of the Year  
John Ellsworth

Hubbard Award  
Shalae Larsen

Faculty Medal  
James Dotson

Development Scholarship  
Kris Kvarfordt  
Jianxin Dai

President's Fellowship  
David Booth

Morris Fellowship  
Nancy Montieth

David Jensen Award  
Shalae Larsen

### ASLA Awards

Honor: Nancy Montieth  
James Dotson  
Jason King  
Ashley Stillman

Merit: Jared Barnes  
Lisa Sokol  
Jon Fredericks  
Deandra Harps

## LAEP Department Honors on the rise

The Honors Program at USU initiated a Departmental Honors program a few years ago to allow students to pursue accelerated, individualized, and innovative studies within their majors. Departments wishing to participate in the program develop their own criteria within a structure fixed by the Honors Program, which meets departmental standards, needs, and resources. In order to participate, LAEP students must be matriculated, upper-division students, with a 3.5 minimum GPA. Upon graduation, the diploma will read 'with Honors in Landscape Architecture and Environmental Planning.'

According to Michael Timmons, LAEP honors coordinator, "the program has seen marked growth, jumping from the first LAEP Honors recipient in 1999 and the second in 2001, to the current program enrollment of seven seniors and seven juniors." (Robyn Daines, Assistant Director for USU's Honors Program, gives all the credit for success to Professor Timmons, who, she says, "actively recruits all the best students.")

One of the primary requirements of the program involves the completion of a senior thesis or project, which is independently developed by the student, working with a faculty mentor. The project must then be presented in a public forum.

The first LAEP graduate to receive Department Honors was Natalie Robbins, BLA '99, whose project involved a detailed community renovation plan for Big Water, Utah. Corbett Belcher, BLA '01, undertook a canal trail feasibility study for the City of North Logan.

Current projects and theses underway range from "An Inventory and Analysis of the Design Work of Andrew Spurluck" and a "Design Evaluation of the Gateway Center in Salt Lake City" to the provision of planning and design assistance to rural communities in northern Utah under the auspices of the 21st Century Communities Project.



Kristofor L. Kvarfordt receiving Development Scholarship from Karen Hanna at the 2001 Awards Banquet

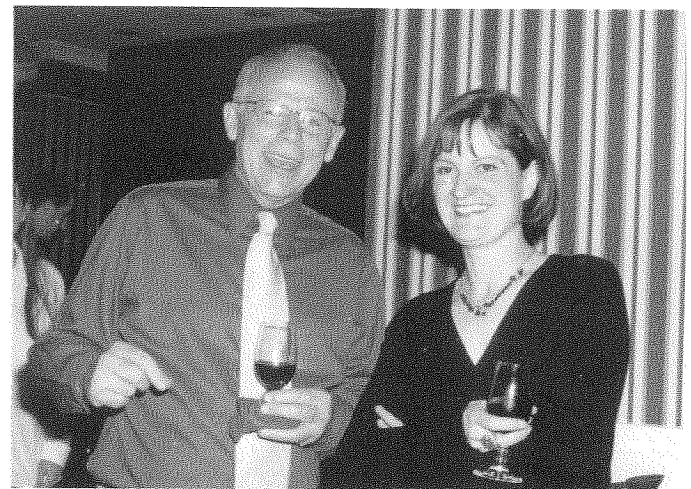

Darrel Morrison and Caroline Lavoie enjoying themselves at the 2001 LAEP Awards Banquet.

# In Memory

Since the last edition of *InSites*, the LAEP family has lost three alumni.

## **Steven Cooper, BLA '84**

We were saddened to learn of the passing of Steven Cooper, BLA '84, within the past two years. Classmate Deb Bowden writes, "He was incredibly accomplished as an L.A., having worked at the China Lake Naval Weapons Center in Southern California. He had achieved many things there, one of which was to have been named Chief Archaeological Officer, and he was successful in mapping/protecting many cultural Indian sites/relics in the back acreages of the site. He was quite amazing as to where he took his career and the wealth of issues/aspects he attended there. Not a place many of us go."

## **Susan Drechsel Grey, BLA '74**

Susan passed away in July 2000 following an extended battle with cancer. Susan Grey had pursued a career as a graphics specialist at the USU Space Dynamics Laboratory and was a longtime Cache Valley resident. Susan's struggles to regain her health had become well known in Logan over the past few years, as several fundraising activities had been launched on her behalf to help offset the cost for a stem cell rescue procedure, a part of her cancer treatment her insurance company wouldn't pay for. Although the transplant had a price tag of \$90,000, Susan's friends undertook the monumental task of getting her the treatment she needed and succeeded admirably in their efforts.

## **Roger Sunada, BLA '77**

Roger Sunada, BLA '77, passed away in December 2000. The following tribute was written by Joe Campo, MLA '96, who is a technical writer with SolidWorks in Concord, Massachusetts.

"I will always remember Roger Sunada as a low-key, mild-mannered, inspirational visionary who led by example. Roger hired me in 1995 to do my thesis project for the City of Logan, where I researched Cache County for potential 100-year capacity landfill sites. Not many leaders look that far into the future, but Roger realized that you have to start planning now to try to handle future solid waste land requirements and issues.

"After we finished the project, we kept in touch over the years. Roger sent me news about Logan's Department of Environmental Health Web site. He wrote me about his son doing a mission in Taiwan, because he knew my wife was born there. When he e-mailed me about his bone marrow cancer, I was shocked. Roger didn't complain. Instead, he suggested that perhaps his assistant, Issa, could help me with what I needed. Pure Roger, selfless and kind to the end.

"Roger had never met me before he hired me for our landfill project. I know other job applicants had stronger academic qualifications, but somehow Roger trusted and believed in me. He inspired me to go beyond what I imagined I could do, to exceed what I perceived were my capabilities. I think this is the sign of a true leader and visionary."

*Steven, Susan, and Roger you will be missed.*

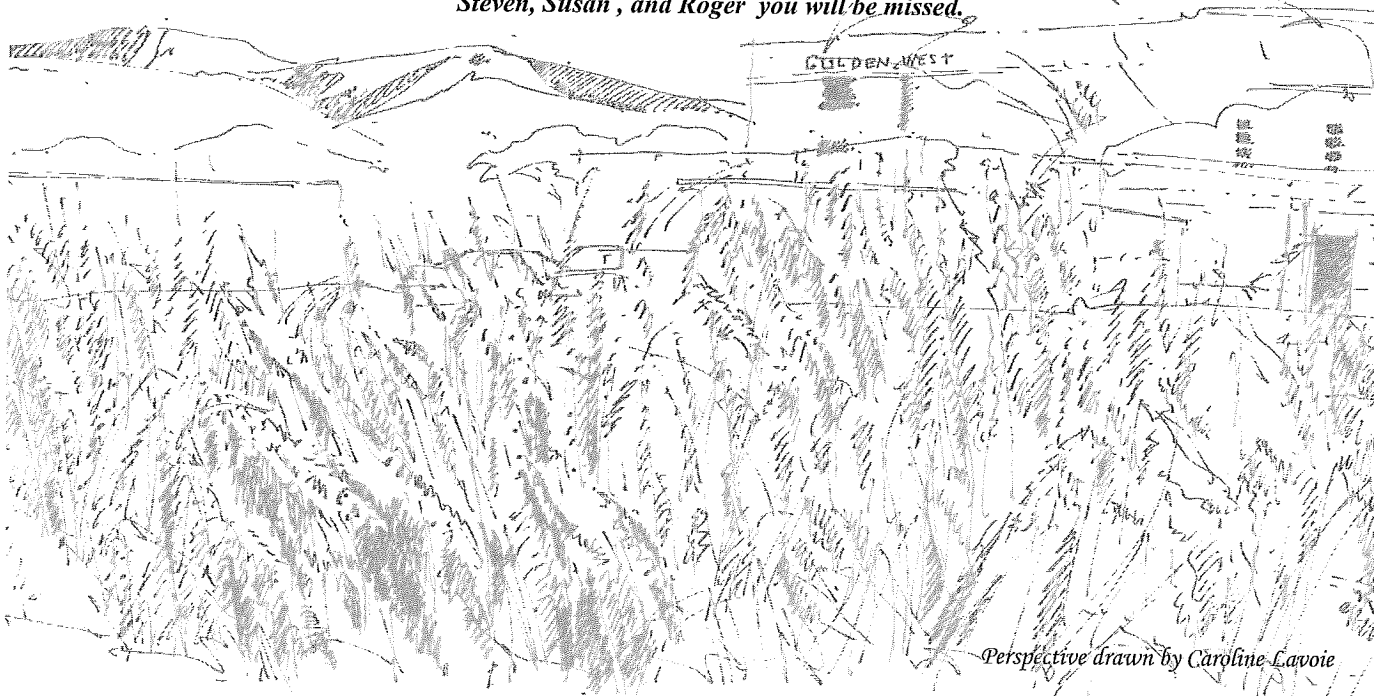

*Perspective drawn by Caroline Lavoie*

# Advisory Board



*Utah State University LAEP Advisory Board: November 10, 2000*  
*Back row, Left to right: Stuart Loosli, Bill Miller, S.J. Camarata, Jerry Brown, Tony Bauer*  
*Third row: Mark Dawson, Todd Johnson, Mark Johnson, Kurt Allen, Summer Swaner, Jareck Boss, Jan Streifel, Gere Smith*  
*Second row: David Hatch, Susan Crook, Kevin Burke, Justin Hamula, Carol Mayer-Reed, Bruce Jorgenson, Tony Wegener*  
*Front row: Left to right: Jay Nielson, Kort Utley, Jay Bollwinkfel*

## *LAEP's New Advisory Board*

The purpose of any advisory board is to give advice, to listen to the concerns of the program faculty, and to help the program address issues and needs. LAEP greatly expanded its Advisory Board in November 2000 and hosted a two-day meeting in Logan. This meeting was followed by another in April 2001, and a third in November 2001. The size of the board was increased from eight to 40, with about 25 in attendance at each meeting. What was noteworthy is that LAEP cannot cover travel costs and many members came from other states, even from the East and West Coasts, at their own expense.

The enthusiasm of the participants was obvious. Instead of looking forward to the social events, many members asked for more working sessions. Interest in the program is expressed through the committees on which each member serves. There are four committees that consider issues related to curriculum, research and outreach, technology, and development. A fifth committee nominates new members to the board as members rotate off each spring.

You need not be an alumnus of the program to be a member. The board includes a number of alums, both from public and private practice, alums in other pursuits, non-alums who are in landscape architecture or related design professions, local businesspersons and friends of LAEP. Members serve three-year terms and may be considered for a second consecutive term if they choose. If you would like to be considered for membership on the board please contact Karen Hanna ([kchanna@cc.usu.edu](mailto:kchanna@cc.usu.edu)), or Jay Nielson ([jnielson@loganutah.org](mailto:jnielson@loganutah.org)), chair of the nominating committee.

LAEP would like to thank all advisory board members for your support, for your donations and for the goodwill you have shared on our behalf.

## *Private giving to Public Institutions*

There is a perception among many that tuition covers the cost of higher education, which is not true. Alternatively, some believe that the state makes up the difference between tuition and all the other expenses of running a university. Unfortunately, this can be true, but it is not always sufficient.

For a number of reasons, the costs of providing education have increased dramatically, while in many cases the revenues have remained static. Consider the following, some or all of which may be valid at any given institution.

1. In many states there has been a proliferation of new community colleges, with some older ones being upgraded to four-year institutions. More campuses means state money must go further.
2. More institutions are competing for grants and other types of funding from public and private foundations. Greater competition tends to favor those institutions with the best record of success in previous grants.
3. While the sciences have access to large research grants, and the fine and performing arts often have generous benefactors, the design disciplines usually have neither. Design disciplines are often among the least funded on any campus.
4. More institutions are competing for private donations, but the needs have grown faster than the donor base. Proportionally fewer students are receiving scholarships and grants, while more are relying on loans.

You can help. LAEP has recently initiated a campaign for a new scholarship for undergraduate students to honor Kenji Shiozawa. Professor Shiozawa earned his MLA at Utah State before joining the faculty of LAEP. He taught in the department through the 1950s, before a long, productive career in the U.S. Forest Service. LAEP is actively working to build an endowment so this will be a self-sustaining scholarship. Please use the form below for your gift. You may give to other department needs if you wish.

Thank you.

### *LAEP Donation, Fall 2001*

Name: \_\_\_\_\_

Address: \_\_\_\_\_

Evening Phone: \_\_\_\_\_ Check #: \_\_\_\_\_

Donation: \$25 \_\_\_\_\_ \$50 \_\_\_\_\_ \$100 \_\_\_\_\_ Other \_\_\_\_\_

Credit Card:Type: \_\_\_\_\_ Card No. \_\_\_\_\_ Exp. \_\_\_\_\_

Signature: \_\_\_\_\_

Mail to: LAEP, Shiozawa Scholarship, FAV 230, USU, Logan, UT 84322-4005

#### *About inSites*

*Department of LAEP - 4005 Old Main Hill - Utah State University - Logan, Utah 84322-4005*

*inSites is published yearly by the Department of Landscape Architecture and Environmental Planning at Utah State University. This newsletter is for Alumni of LAEP at Utah State, it is intended to help alumni maintain contact with the Department, the professors and their classmates.*

*Editor and Writer: Betty Schoeffler  
Graphic Designer: Kristofor Kvarfordt  
Entourage Graphics: Allison Hopkin  
Kristofor Kvarfordt  
Caroline Lavoie*

*Please visit our new website at [www.usu.edu/laep/](http://www.usu.edu/laep/)*



# Update Your Info

Name: \_\_\_\_\_

Home Address: \_\_\_\_\_

Home Phone: \_\_\_\_\_ Email: \_\_\_\_\_

Name of Employer: \_\_\_\_\_

Job Title: \_\_\_\_\_

Business Phone: \_\_\_\_\_

Business Address: \_\_\_\_\_

Graduation date: \_\_\_\_\_ Degree earned: \_\_\_\_\_

Additional degrees and schools: \_\_\_\_\_

Specializations: \_\_\_\_\_ Interests: \_\_\_\_\_

Contact information of other alumni you know: \_\_\_\_\_

To reply by email please contact Marsha Ainscough [ainscoughm@hass.usu.edu](mailto:ainscoughm@hass.usu.edu)

**Utah State**  
UNIVERSITY

*inSites*

*LÆP Department  
Utah State University  
4005 Old Main Hill  
Logan, UT 84322-4005*

