

Family, housing and household in early modern London

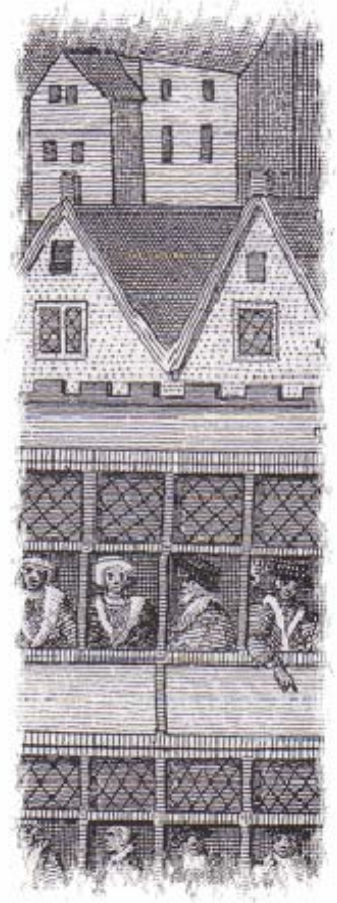

Sample Parishes

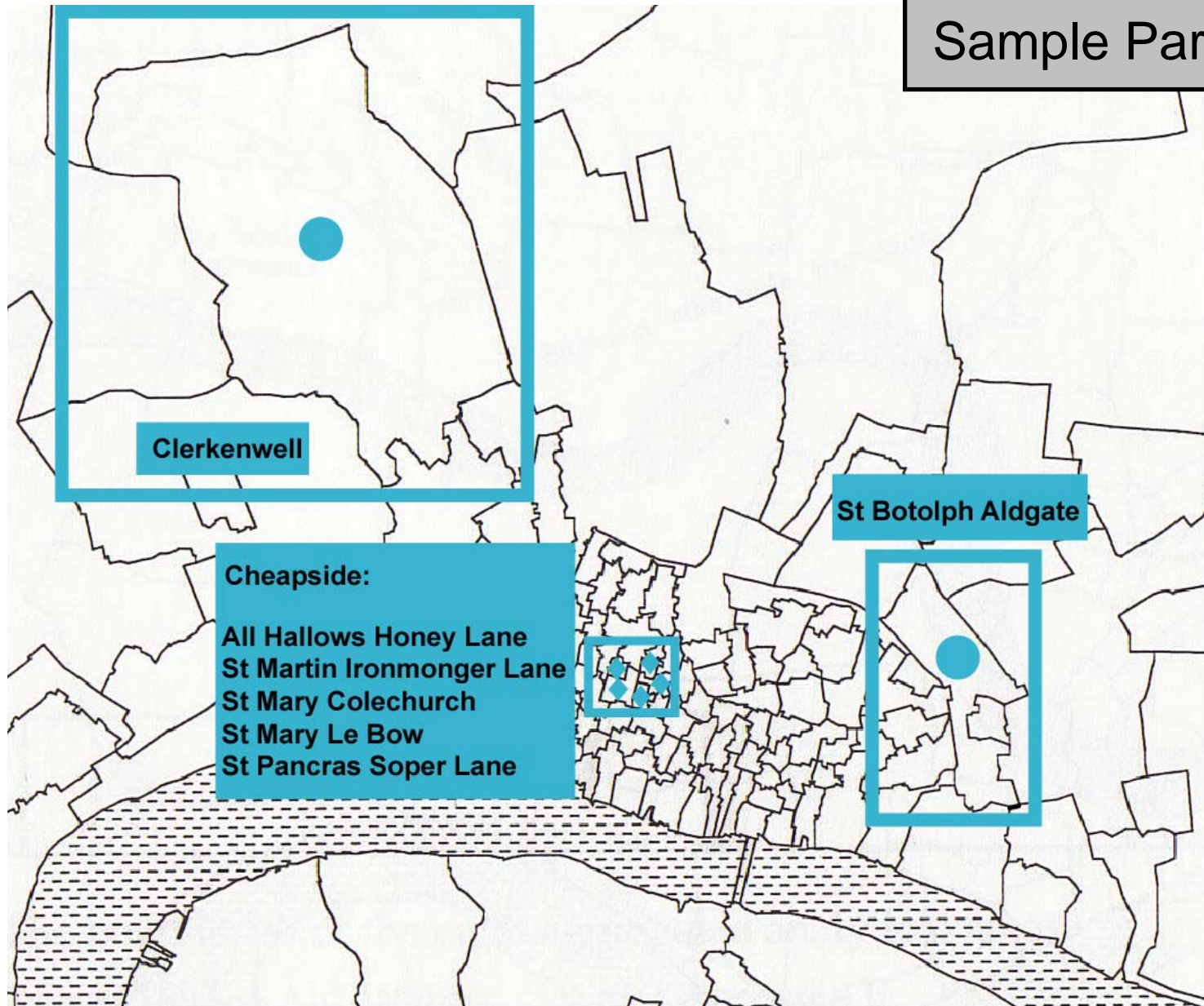

Clerkenwell

Cheapside:

**All Hallows Honey Lane
St Martin Ironmonger Lane
St Mary Colechurch
St Mary Le Bow
St Pancras Soper Lane**

St Botolph Aldgate

Marriage Duty Assessment 1695

The Respective Names and Qualities of His Sovereign and Respective Inhabitants and their Families of Residence and Being in the Parish of St Mary Le Bow London Together with their Several Asses Occasional Payments

Their Names	Qualities	Occasional Payments			
		Burials 2 s D	Births 2 s D	Marriages 2 s D	Bachelors & Widowers
John Baptist Peters	Attorney at Law	1-4-0	12	-	-
Martha Peters	his wife	- 14	-	-	-
Richard Peters	his eldest son	- 14	-	-	-
Martha Peters	his Daughters 2	14	-	-	-
Francis Peters		14	-	-	-
Edward Harris	his Clarke	- 14	-	12-6	-
John Lillistone	his maid servt	4	-	-	-
John Whitwolam	his foot boy	4	-	-	-
William Ramsay	Taylor	0-4-0	2-8	-	-
Margaret Ramsay	his wife	0-4	-	-	-
Sarah Ramsay	his Daughters 2	0-4	-	-	-
Elizabeth Ramsay		0-4	-	-	-
Judanna Weston	Affaird or woman	0-4	-	-	-



Poll Tax

St Mary Le Bowe Precinct.			
Marmaduke Ileb and wife & } two children Mary & Ann —	—	4	
William Wood Lodger —	—	1	
Mary wood his sister Lodger —	—	1	
Arthur Beltsworth —	00.	11.	
two children Thomas & Arthur —	—	2	
A serv ^t maid Martha wages 4 ^l —	—	5	
A footboy —	—	1	
Morab Wym and wife —	—	2	
a serv ^t maid bestw 40 ^l & 2 ^d —	—	3	
a boy William —	—	1	
Edward Martin ^s Wife and Child —	—	3	
Thomas Light ^s Wife & one Child —	—	3	
Three Apprent Thomas. Alex: William	—	3	

Marriage Duty Assessment 1695: Housefuls

John Baker	a Bookkeeper
Mary Baker	his wife
Robert Baker	his three daughters
Joseph Lauroufon	Belt maker
Mary Lauroufon	his wife
Joseph Lauroufon	his son
James Clarke	his apprentice
Maria Birch	maid servt
James Rowling	gent & widower
Mary Bland	a Nurs
Mary Bland	his daughter
Richard Howard	a yeoman
Thomas Spence	musick ma ^r . viduic
Benjamin Spence	his son
Bridgett Spence	his daughter
Sarah Nicholson	widow a servt
Richard Spence	Whitingm. & Barber
John Edwards	carpenter
Mary Edwards	his wife
Elizabeth Edwards	his daughter
Ann Bradford	maid servt
Thomas Sharp	apprentice
	Barber



John Bakewell	a Bookkeeper	1
Mary Bakewell	his wife	
Mary Bakewell		
Samuel Bakewell	his first daughter	
Elizabeth Bakewell		
Joseph Lawtonson	Bolt maker	
Mary Lawtonson	his wife	
Joseph Lawtonson	his son	
James Clarke	his Apprentice	
Maria Birn	maid serv	
James Reeling	gent & widower	
Mary Bland	a Nurse	1
Mary Bland	her daughter	
Elizabeth Howard	a young	

Jam Bakewell	a Booke keeper	1
Mary Bakewell	his wife	
Mary Bakewell		
Samuel Bakewell	his first daughter	
Elizabeth Bakewell		
Joseph Lawtonson	Bolt maker	
Mary Lawtonson	his wife	
Joseph Lawtonson	his son	
James Clarke	his Apprentis	
Martha Birt	maid serv	
James Revoiling	gent & widower	
Mary Bland	a Nurse	1
Mary Bland	her daughter	
Elizabeth Howard	a young	

Poll Tax: households

St Mary Le Bowe Precinct.

Marmaduke Heb and wife & ?	-	4
two children Mary & Ann	-	2
William Wood Lodger	-	1
Mary Wood his sister Lodger	-	1

Mary Bakewell	a Bookkeeper
Mary Bakewell	his wife
Mary Bakewell	
Elizabeth Bakewell	his first daughter
Joseph Lanyon	Boat maker
Mary Lanyon	his wife
Joseph Lanyon	his son
James Clarke	his apprentice
Maria Birch	maid
James Revelling	gent & widower
Mary Bland	a nurse
Mary Bland	his daughter
Elizabeth Howard	a person

Mary Bakewell	a Bookkeeper
Mary Bakewell	his wife
Mary Bakewell	
Elizabeth Bakewell	his first daughter
Joseph Lanyon	Boat maker
Mary Lanyon	his wife
Joseph Lanyon	his son
James Clarke	his apprentice
Maria Birch	maid serv
James Revelling	gent & widower
Mary Bland	a Nurse
Mary Bland	his daughter
Elizabeth Howard	a person

John Sloud	Bond Coler
Sarah Sloud	his wife
Sam ^l Sloud	his son
Sarah Sloud	his daughter
Nicholas Fripp	Bond Coler
Ann Fripp	his wife
Ann Fripp	his daughter
Mary Fripp	doers
John Russell	doers
Sherrington Hodges	Meads 4 3
Mary Compton	doers
Bridgett Mason	
Richard Hooker	

Cheapside Sample Parishes

Parish	Population	Housefuls	Households	Families	Units
All Hallows Honey Lane	194	26	54	55	125
St Mary Colechurch	358	54	108	111	183
St Martin Ironmonger Lane	254	40	82	82	213
St Mary Le Bow	672	105	185	188	429

Parish	Mean HF Size	Mean HH Size	Mean FAM Size	Mean Unit Size
All Hallows Honey Lane	7.5	3.6	3.5	1.6
St Mary Colechurch	6.6	3.3	3.2	2.0
St Martin Ironmonger Lane	6.4	3.1	3.1	1.2
St Mary Le Bow	6.4	3.6	3.1	1.6
Non-metropolitan national average (Laslett)	4.71			

Cheapside Sample Parishes

Parish	Population	Housefuls	Households	Families	Units
All Hallows Honey Lane	194	26	54	55	125
St Mary Colechurch	358	54	108	111	183
St Martin Ironmonger Lane	254	40	82	82	213
St Mary Le Bow	672	105	185	188	429

Parish	Mean HF Size	Mean HH Size	Mean FAM Size	Mean Unit Size
All Hallows Honey Lane	7.5	3.6	3.5	1.6
St Mary Colechurch	6.6	3.3	3.2	2.0
St Martin Ironmonger Lane	6.4	3.1	3.1	1.2
St Mary Le Bow	6.4	3.6	3.1	1.6
Non-metropolitan national average (Laslett)	4.71	4.71		

St Mary Le Bow and St Botolph Aldgate, 1695

James Parke
John Hall
1695

William Frigg
Elizabeth Frigg
Benjamin Frigg
Halt Frigg
Mary Frigg
and Harvey }
Mary Parke }

Paul Parker
Mary Parker
Sarah Wood
John Doll

Thomas Curker
John Curker

John Whiting
Elizabeth Whiting
James Whiting
Elizabeth Whiting
Robert Whiting
Mary Whiting }
Sarah Beindon }
John Yarnor }
Hester Yarnor }
Benj. Whiting }
Miss Raper }

Right Street Street
George
quaint
State

Joseph Quinon
Hester Quinon }
John Quinon }
Elizabeth Quinon }

John Quinon
his wife
Sarah Quinon
Elizabeth Quinon
Elizabeth Quinon }
Elizabeth Quinon }
Elizabeth Quinon }

Rita Quinon
Elizabeth Quinon

Elizabeth Quinon

John Quinon
Elizabeth Quinon
John Quinon
Elizabeth Quinon

John Quinon
Mary Quinon
Sarah Quinon

James Quinon
Anne Quinon
Elizabeth Quinon

Miss Wood
James Quinon

John Quinon
John Quinon

11/2

ALL HALLOWS HONEY LANE: 2

This tenement, on the W. corner of Honey Lane and Cheapside, was bounded to the W. by 1 and to the N. by 3.

In 1858 this was no. 112 Cheapside.

i. THIRTEENTH TO SIXTEENTH CENTURY

In 1231 this was probably the tenement of Jocus son of Peter Serlon which lay to the S. of 3. Peter Serlon was probably a successor of Serlo le Mercer, who in the early 13th century appears to have held 2 and other properties near by. In 1235 the king confirmed Serlo le Mercer's gifts to the convent of St. John the Baptist, Haliwell (fd. bef. 1150), which included his share of the lands, houses, and shops which he and Solomon de Basing had in *Hunykyne* of the fee of Thomas de Haverhull, his share of the lands and houses he and Solomon had there of the fee of Martin son of William, and his share of the moiety of a seld with shops and solars which he and Solomon had in Cheapside in the parish of All Hallows Honey Lane of the fee of John Herlicun. It is possible that only the 3rd of these properties is 2, in Cheapside and Honey Lane, but if so it is not clear precisely where the other properties lay; at a later date 2 was the only property of Haliwell Priory in this parish. The nuns of Haliwell had erected a pentice in Cheapside by 1246.

The property was charged with several quit-rents, the origins of which are obscure. In 1283, Hugh de Bedeford and his wife Joan distrained in the tenement for arrears of 40s. of a rent of £1. 6s. 8d. which they claimed the prioress of Haliwell's tenants were bound to pay them. She denied liability, and again in 1286 Hugh and Joan took nam of a blanket (*chalon*), a balance, and 3 furs of lambskin, for £1. 13s. 4d. arrears of the same rent. The prioress again denied that Hugh and Joan were in seisin of the rent by her hands or her

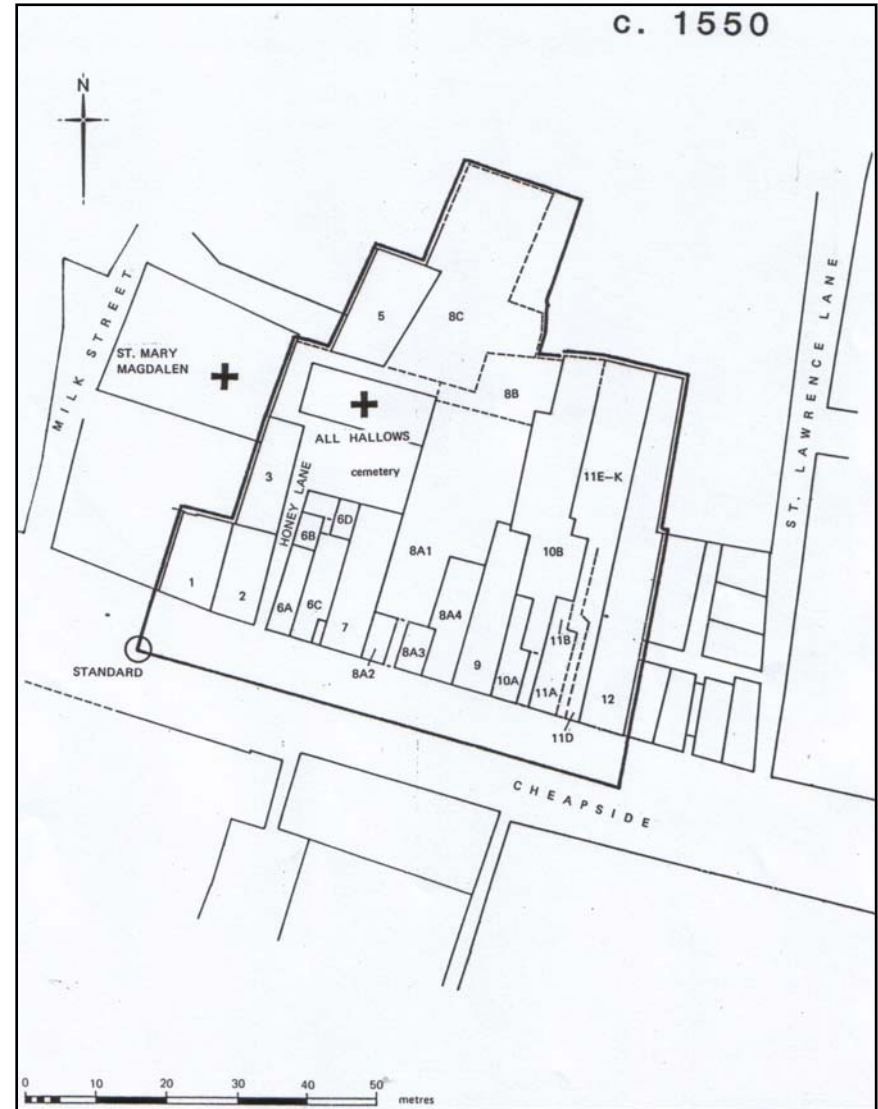

The Cheapside Gazetteer