

1-8-2024

## Refugee Health in Philadelphia

Marc Altshuler, MD

Thomas Jefferson University, marc.altshuler@jefferson.edu

Follow this and additional works at: <https://jdc.jefferson.edu/ctlworkshops>

 Part of the [Health Law and Policy Commons](#), [Human Rights Law Commons](#), [International Humanitarian Law Commons](#), [Medicine and Health Sciences Commons](#), and the [Politics and Social Change Commons](#)

[Let us know how access to this document benefits you](#)

---

### Recommended Citation

Altshuler, MD, Marc, "Refugee Health in Philadelphia" (2024). *Academic Commons Workshops and Presentations*. Presentation 9.

<https://jdc.jefferson.edu/ctlworkshops/9>

This Article is brought to you for free and open access by the Jefferson Digital Commons. The Jefferson Digital Commons is a service of Thomas Jefferson University's [Center for Teaching and Learning \(CTL\)](#). The Commons is a showcase for Jefferson books and journals, peer-reviewed scholarly publications, unique historical collections from the University archives, and teaching tools. The Jefferson Digital Commons allows researchers and interested readers anywhere in the world to learn about and keep up to date with Jefferson scholarship. This article has been accepted for inclusion in Academic Commons Workshops and Presentations by an authorized administrator of the Jefferson Digital Commons. For more information, please contact: [JeffersonDigitalCommons@jefferson.edu](mailto:JeffersonDigitalCommons@jefferson.edu).

# Refugee Health in Philadelphia



Marc Altshuler, MD

Professor, Department of Family and Community Medicine  
Director, Jefferson's Center for Refugee and Immigrant Health  
Thomas Jefferson University

# Objectives

- Define refugee resettlement and the creation of the U.S. Refugee Resettlement Program
- Learn about the history of refugee health in Philadelphia
- Discuss the creation of the Jefferson Center for Refugee Health and the Philadelphia Refugee Collaborative

# United Nations High Commissioner for Refugees (UNHCR)

- Following World War II, the United Nations High Commissioner for Refugees (UNHCR) was formed in 1950 to help the millions of Europeans who fled Europe and lost their homes.
- They were given 3 years to complete their work and then disband.
- 70+ years later, the UNHCR is still in existence.



# UNHCR 2024

- Goal to safeguard the rights and well-being of individuals forced to flee
- Ensures that everyone can exercise the right to seek asylum and find safe refuge in another State
- Today, a staff of some 19,000 people in more than 137 countries continues
- UNHCR has helped over 50 million refugees successfully restart their lives, and supports 90 million displaced persons
- [www.unhcr.org](http://www.unhcr.org)



# Definition of Refugee:

- ‘Someone who, owing to a well-founded fear of being **persecuted** for reasons of race, religion, nationality, membership of a particular social group, or political opinion, is outside the country of his nationality, and is **unable** to or, owing to such fear, is unwilling to avail himself of the protection of that country.’
- They are defined and protected in international law and must not be expelled or returned to situations where their life and freedom are at risk.

*Source: UN Convention Relating to  
the Status of Refugees, Article 1A  
(1951)*



## Other Terms:

**Immigrant** – a foreign-born resident who is not a US citizen, lawfully admitted for permanent residence

**Asylee** – an immigrant who has fled their country for reasons as a refugee and request sanctuary in another country

**Internally Displaced Person (IDP)** – unlike refugees, they are displaced within their own country—frequently for some of the same reasons as refugees.



# 108.4 million people worldwide were forcibly displaced

At the end of 2022 as a result of persecution, conflict, violence, human rights violations or events seriously disturbing public order.

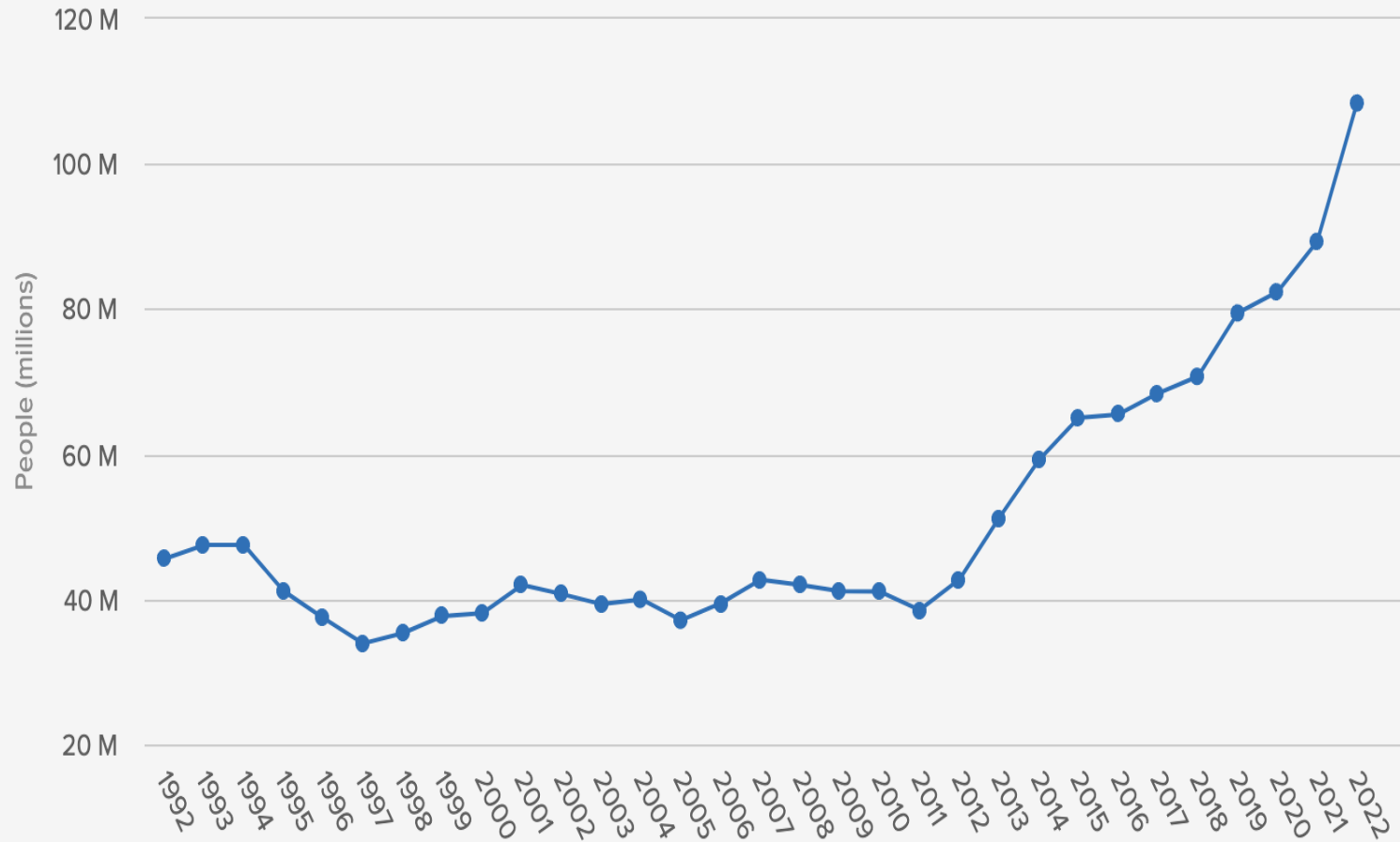

14 June 2023

Source: [UNHCR Global Trends 2022](#)

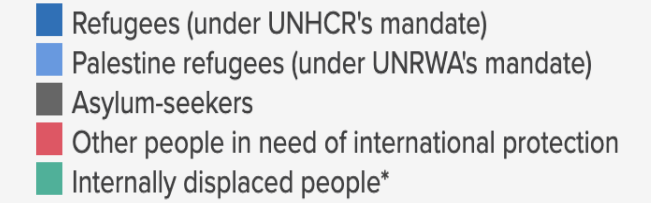

14 June 2023

\* Source: Internal Displacement Monitoring Centre

Source: [UNHCR Global Trends 2022](#)



# Demographics of forcibly displaced people

Children account for 30 per cent of the world's population, but 40 per cent of all forcibly displaced people.

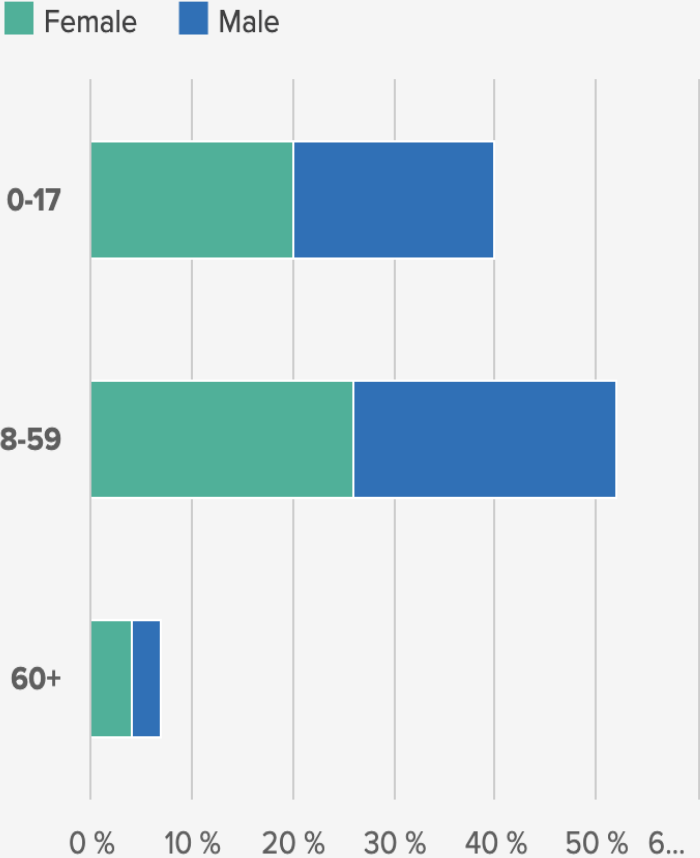

# Major hosting countries

Türkiye hosted nearly 3.6 million refugees, the largest population worldwide, followed by the Islamic Republic of Iran with 3.4 million.

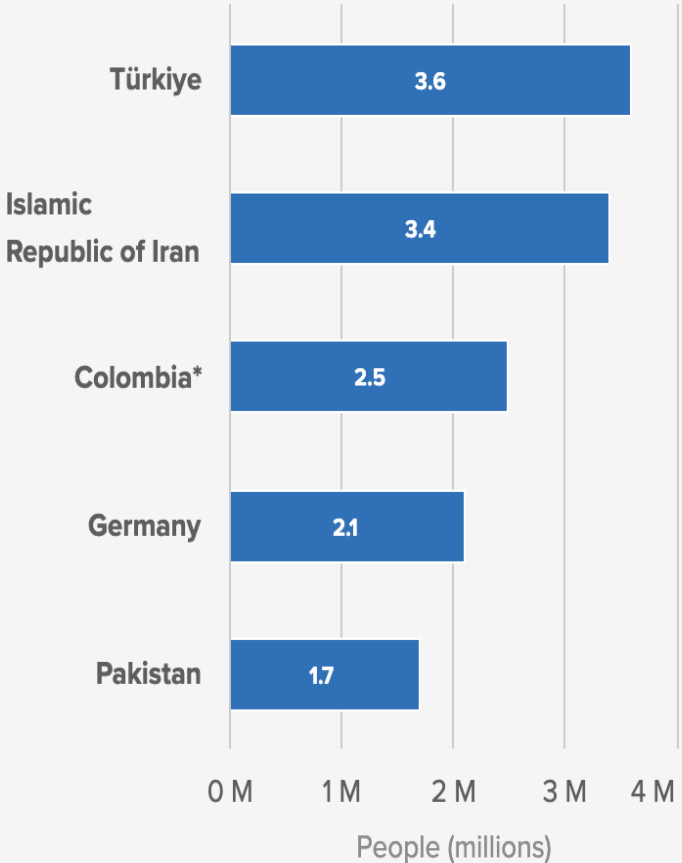

# Major source countries

52 per cent of all refugees and other people in need of international protection came from just three countries.

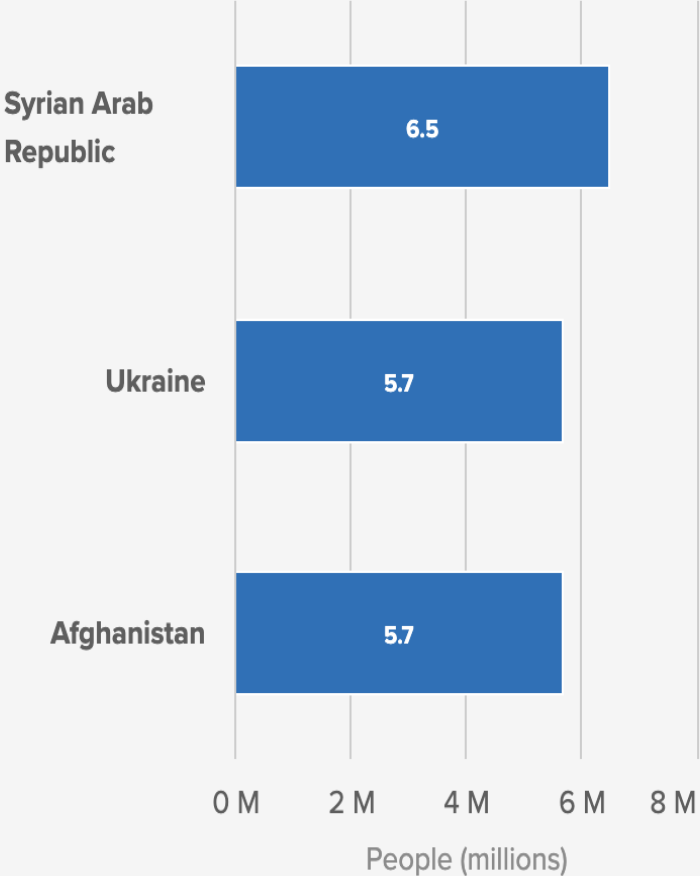

# Refugee Health in US - Refugee Act of 1980

- Officially, established a domestic refugee resettlement program
- Outlined the process for the annual admission of refugees
- Number of refugees admitted to US. is decided by the President, in consultation with Congress. Projected admissions numbers are proposed on an annual basis.
- Since 1975, the United States has resettled over 3 million refugees.



# U.S. Refugee Admissions & Refugee Resettlement Ceilings, FY 1980-2023

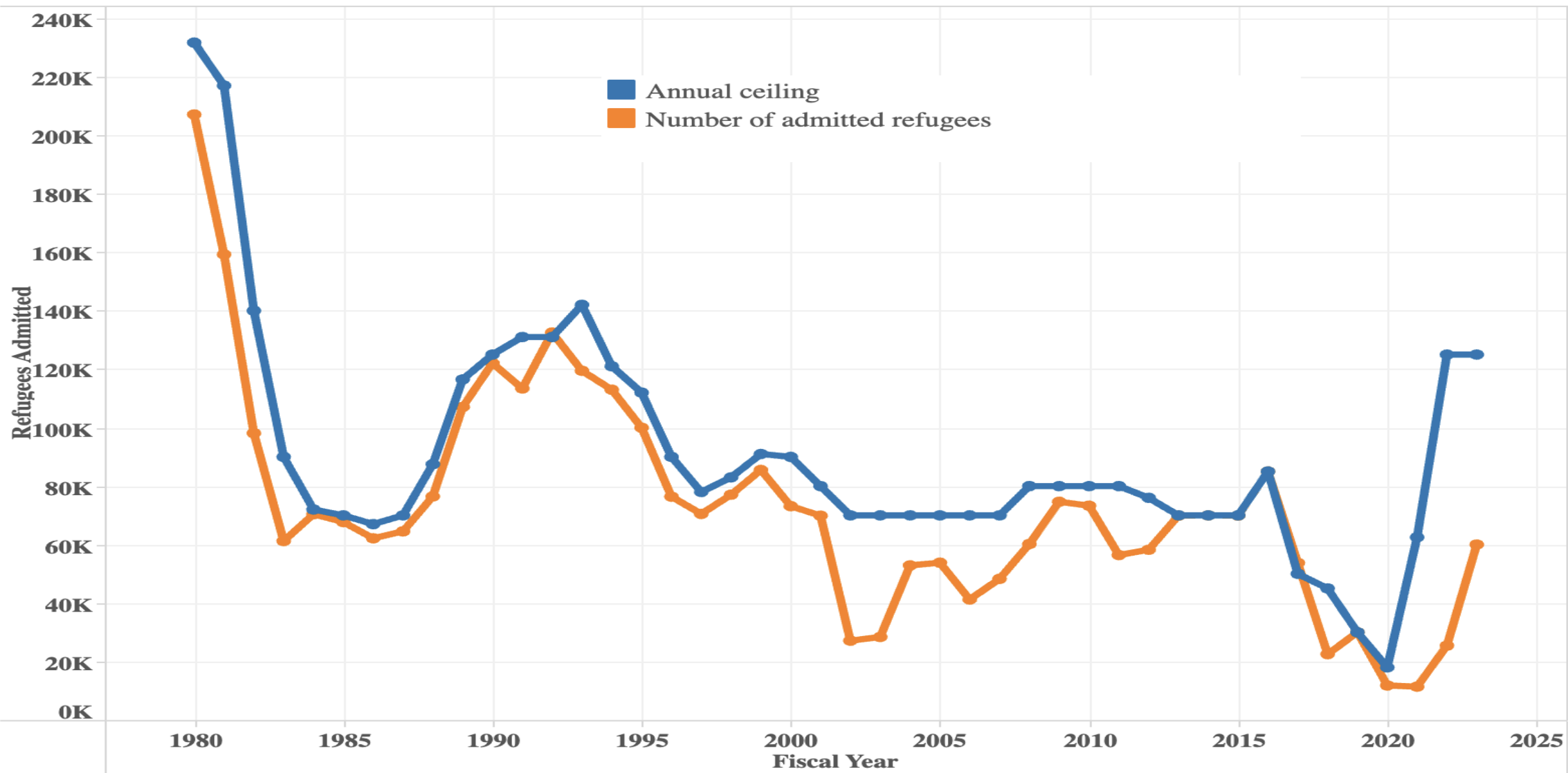

## Statistics Fiscal Year 2016-2023:



- FY 2016: 85,000
- FY 2017: 53,700
- FY 2018: 22,600
- FY 2019: 30,000
- FY 2020: 11,800
- FY 2021: 11,400
- FY 2022: 25,000
- FY2023: 125,000

Refugee admissions from Middle east and SE Asia decreased 92% from 2016-2019



## In Focus

[Addressing Climate Change](#)

[Coronavirus \(COVID-19\)](#)

[Cybersecurity](#)

[Deferred Action for Childhood Arrivals](#)

**[Operation Allies Welcome](#)**

[Recognizing DHS Excellence](#)

[Uniting for Ukraine](#)

# Operation Allies Welcome

On August 29, 2021, President Biden directed the Department of Homeland Security (DHS) to lead and coordinate ongoing efforts across the federal government to support vulnerable Afghans, including those who worked alongside us in Afghanistan for the past two decades, as they safely resettle in the United States. At the President's direction, the Secretary of Homeland Security is working with representatives from across the government to coordinate our response and ensure unity of effort.

To lead the effort in support of Operation Allies Welcome, DHS established a Unified Coordination Group (UCG). The UCG reports directly to the Secretary of



Washington (Sept. 3, 2021) Homeland Security Secretary





U.S. DEPARTMENT of STATE

[Newsroom](#) [Business](#) [Employees](#) [Job Seekers](#) [Students](#) [Travelers](#) [Visas](#)



[POLICY ISSUES](#) [COUNTRIES & AREAS](#) [BUREAUS & OFFICES](#) [ABOUT](#)

[Latest Ukraine Updates](#)

**United with Ukraine**

[How to Help](#)

[Holding Russia and Belarus to Account](#)

[Disarming Disinformation](#)

[Russia's Filtration Operations](#)

[Home](#) > [Policy Issues](#) > [United with Ukraine](#)



# United with Ukraine

# Important Organizations

- UN High Commissioner for Refugees (**UNHCR**)
  - Provides services in refugee camps, including protection, health care, referral for resettlement, etc.
- Intergovernmental Organization for Migration (**IOM**)
  - Arranges refugee travel and travel loan
- US Citizenship and Immigration Service (**USCIS**)
  - Formerly the Immigration and Naturalization Services (INS)
  - Overseas federal immigration and naturalization laws
- Office of Refugee Resettlement (**ORR**)
  - Plans, develops, and directs implementation of comprehensive program for domestic refugee resettlement
- Volunteer Resettlement Agency (**Volag**)
  - National or local non-profits
  - Initial refugee resettlement processing
  - Assists with healthcare, employment, schooling, and housing





# How do refugees come to the US?

- [https://www.washingtonpost.com/video/politics/this-is-what-it-takes-for-a-refugee-to-be-admitted-into-the-us/2017/02/09/340c8922-ef0a-11e6-a100-fdaaf400369a\\_video.html?utm\\_term=.9e5d07c8fcba](https://www.washingtonpost.com/video/politics/this-is-what-it-takes-for-a-refugee-to-be-admitted-into-the-us/2017/02/09/340c8922-ef0a-11e6-a100-fdaaf400369a_video.html?utm_term=.9e5d07c8fcba)

# Jefferson's Center for Refugee Health



2005

Refugee Arrives in Philadelphia

HIAS and Council



Lutheran Children & Family Service

Nationalities Service Center

Referrals from family and friends

Public Health Centers  
Private Physicians  
(Screenings Only)

# Refugee Resettlement Agency Responsibilities:

## Reception Services:

- Airport pickup
- Pocket money
- Housing
- Hot culturally appropriate meal
- Basic furnishings and household items
- Culturally appropriate food staples (until food stamp case is opened)

## Core Services:

- Social security cards (w/in 10 days)
- Welfare benefits (w/in 10 days)
- **Medical screening (w/in 30 days)**
- Enroll children in school (w/in 30 days)
- ESL referral (w/in 10 days)
- Employment referral (w/in 10 days)
- Home visits (24 hr, 30 and 90 days)

## Cultural Orientation

- Role of agency
- Housing
- Transportation
- Hygiene
- Budgeting and finances
- Public benefits
- Safety
- Travel Loan repayment
- Selective service registration
- Change of address

# Jefferson Center for Refugee Health (CRH)

- July 2007: Partnership established between NSC and Jefferson, first refugee medical home in Philadelphia.
- 2008-2011: Awarded HRSA Residency Training Grant to care for vulnerable populations
- 2010: Creation of the Philadelphia Refugee Health Collaborative
- 2011-2016: Awarded HRSA Training Grant to address new demographics in underserved populations
- 2016: Designated by CDC as a Center for Excellence in Refugee Health
- 2021: Opened the Wyss Wellness Center



# Who are the refugees living in Philadelphia

- <https://www.youtube.com/watch?v=DJh9IQTIvGI>



# PHILADELPHIA REFUGEE HEALTH COLLABORATIVE

[ABOUT](#)[NEWS](#)[MEMBERS](#)[PROVIDERS](#)[RESOURCES](#)[CONNECT](#)

Powered by Google Translate

## What's New?

- [Conference on Serving Deaf Refugees](#)
- [Working Group Releases Mental Health and Language Access Report](#)
- [Oppose the RAISE Act Today!](#)
- [CDC Notification](#)
- [Language Access Training](#)



Learn about the Health Insurance Marketplace & your new coverage options.

[GET ANSWERS NOW](#)

## Improving Refugee Health in Philadelphia

Formed in September 2010, the Philadelphia Refugee Health Collaborative (PRHC) is a regional coalition consisting of Philadelphia's three refugee resettlement agencies and eight refugee health clinics. The core mission of the Collaborative is ***to create an equitable system of refugee health care in the Philadelphia region that ensures a consistently high standard of care for all newly arrived refugees***. Each year, PRHC provides domestic health screenings, primary care (including newborn, pediatrics, adult medicine, geriatric, obstetric and gynecologic care) and access to laboratory, radiology and subspecialty services to 800 newly arrived refugees. PRHC also provides ongoing primary care and women's health services to established refugee patients.

## Refugee Health Clinics

- Jefferson Center for Refugee Health, Department of Family & Community Medicine
- Nemours Pediatrics
- Drexel Women's Care Center
- Penn Center for Primary Care (PCPC)
- Children's Hospital of Philadelphia, Refugee Health Program
- Einstein Community Practice
- Einstein Pediatrics
- Health Connection, Public Health Management Corporation
- Rising Sun, Public Health Management Corporation

## Resettlement Agencies

- Nationalities Service Center (NSC)
- HIAS Pennsylvania
- Bethany Christian Services (BCS)



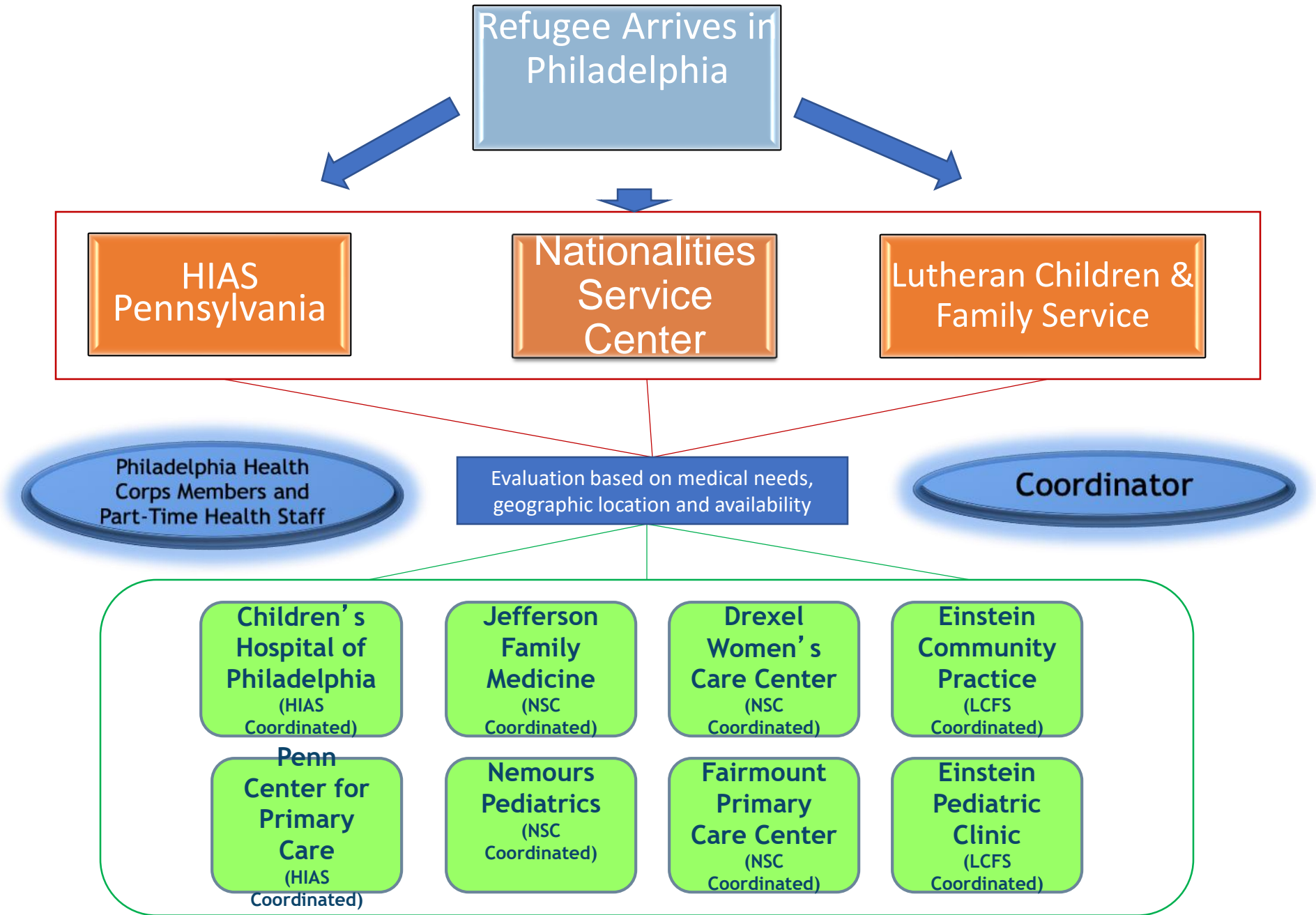



# Hansjörg Wyss Wellness Center



# Hansjorg Wyss Wellness Center



Welcome Desk  
Gift of  
Methodist Hospital  
Foundation



வரவேற்பு  
සුභසාගරණී  
Welcome  
Karibu  
خوش آمدید  
Selamat datang  
ようこそ  
स्वागतम्  
Maligayang pagdating  
مرحبًا  
Hurasaka neza  
Karibuni  
සාමන්ත  
Hosgetimiz  
සුභසාගරණී  
Welcome  
Karibu  
خوش آمدید  
Selamat datang  
ようこそ  
स्वागतम्



DUDLEY STREET

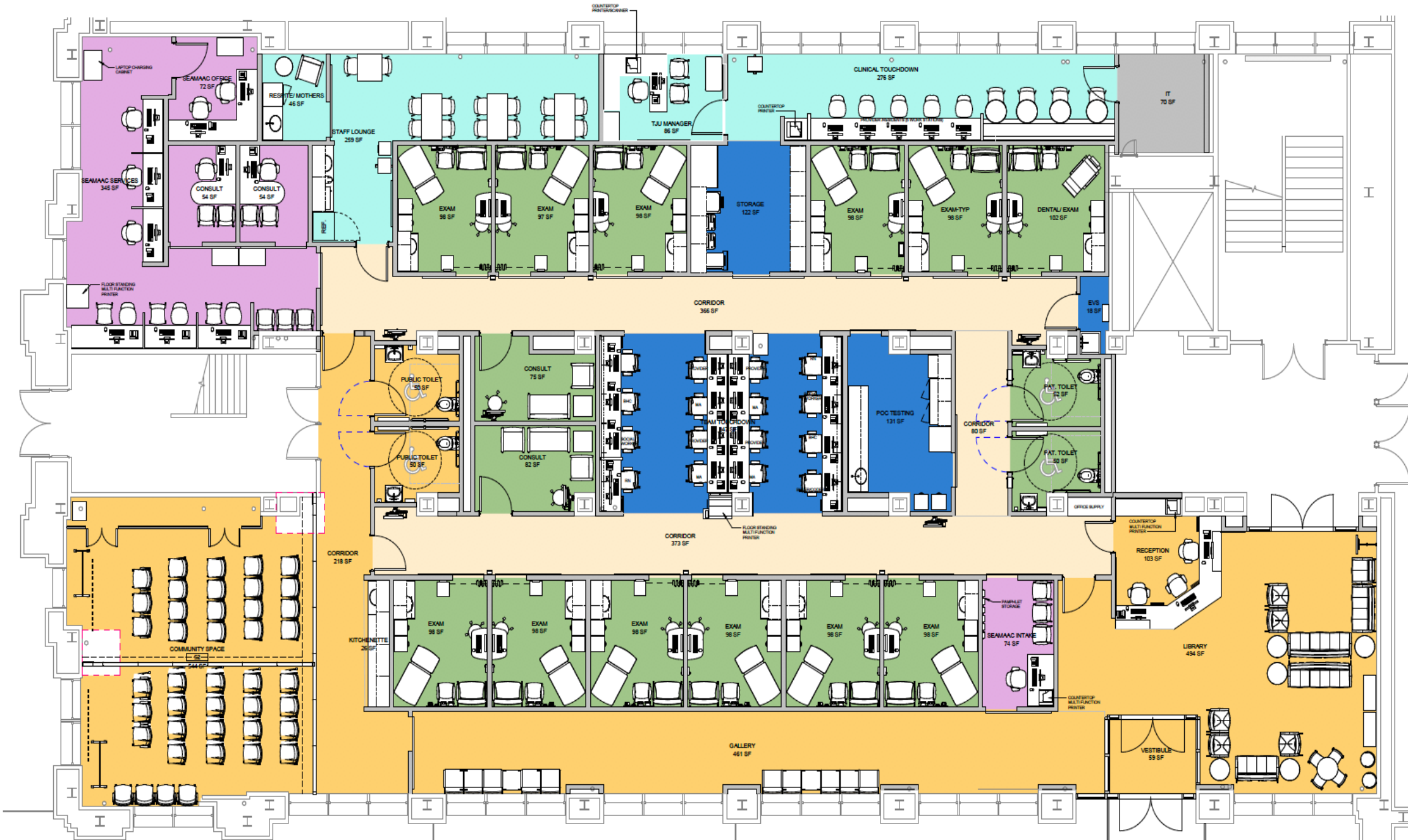

# The Hansjörg Wyss Wellness Center

## IMPACT BY THE NUMBERS

Since opening its doors on April 9, 2021 within Philadelphia's historic Bok Building at 9th and Mifflin streets, the **Hansjörg Wyss Wellness Center** has become an anchor of the surrounding community. This state-of-the-art facility has brought medical and support services; social services; and community arts, education, and gathering spaces to an area with a largely immigrant and refugee population.

**~3,000**  
PATIENTS  
SERVED, FROM  
PEDIATRICS TO  
90 YEARS OLD

**6,350+**  
COVID  
VACCINES  
ADMINISTERED

**40+**  
DIFFERENT  
LANGUAGES  
SPOKEN BY  
PATIENTS

*"The Wyss Center and its physicians have been invaluable partners in our efforts to welcome waves of immigrants from Afghanistan, Ukraine, and the Texas border.*

**41%**  
OF PATIENTS  
LIVE IN THE  
SAME ZIP CODE  
AS THE CENTER  
(19148)

**63%**  
OF PATIENTS ON  
MEDICAID OR  
UNINSURED

*I know that when I am*

# Suggested reading

Books:

- Fadiman, Anne
  - The Spirit Catches You and You Fall Down.*
- Housseini, Khaled
  - A Thousand Splendid Suns.*
- Beah, Ishmael
  - A Long Way Gone.*
- Eggers, Dave
  - What is the What?*
- Kidder, Tracy
  - Mountains Beyond Mountains*
  - A Strength in What Remains*



# Resources:

- Websites

- CDC: <https://www.cdc.gov/immigrantrefugeehealth/index.htm>
- CAREREF: <https://careref.web.health.state.mn.us/>
- ORR: <https://www.acf.hhs.gov/orr>
- UNHCR: <https://www.unhcr.org/>
- Society of Refugee Health Providers: <https://refugeesociety.org/>

## Conferences:

- North American Refugee Health Conference: <https://refugeesociety.org/narhc-conference/>

# THANK YOU

