

This is a repository copy of *Marking Time? A fifteenth-century liturgical calendar in the wall paintings of Pickering parish church, North Yorkshire.*

White Rose Research Online URL for this paper:
<http://eprints.whiterose.ac.uk/910/>

Article:

Giles, Kate orcid.org/0000-0002-3141-2505 (2000) *Marking Time? A fifteenth-century liturgical calendar in the wall paintings of Pickering parish church, North Yorkshire.* Church Archaeology. pp. 42-51. ISSN 1366-8129

Reuse

Items deposited in White Rose Research Online are protected by copyright, with all rights reserved unless indicated otherwise. They may be downloaded and/or printed for private study, or other acts as permitted by national copyright laws. The publisher or other rights holders may allow further reproduction and re-use of the full text version. This is indicated by the licence information on the White Rose Research Online record for the item.

Takedown

If you consider content in White Rose Research Online to be in breach of UK law, please notify us by emailing eprints@whiterose.ac.uk including the URL of the record and the reason for the withdrawal request.

Marking time? Wall paintings at St. Peter and St. Paul's church, Pickering (North Yorkshire)

Dr Kate Giles, Department of Archaeology,
University of York



The nave, looking east

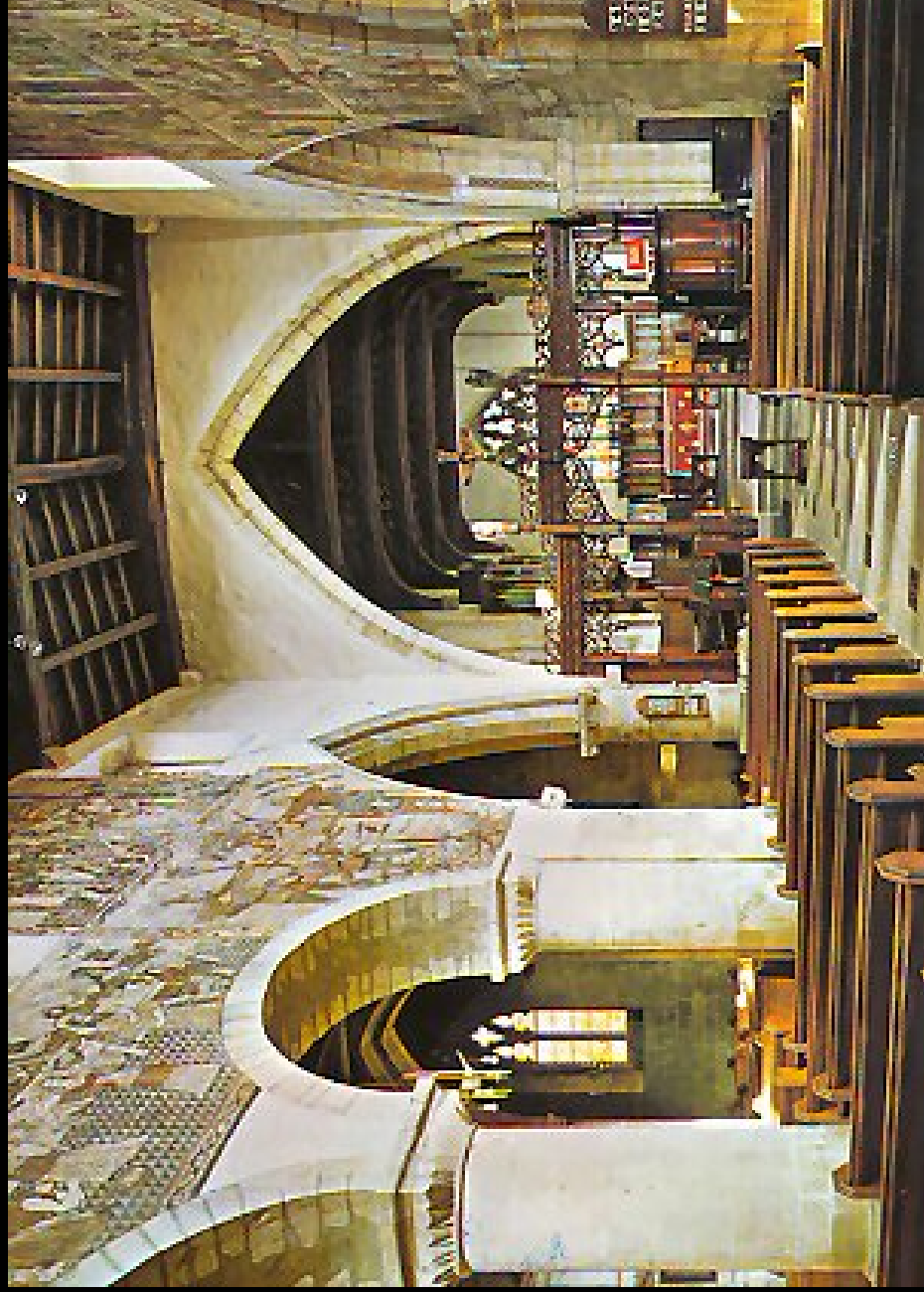

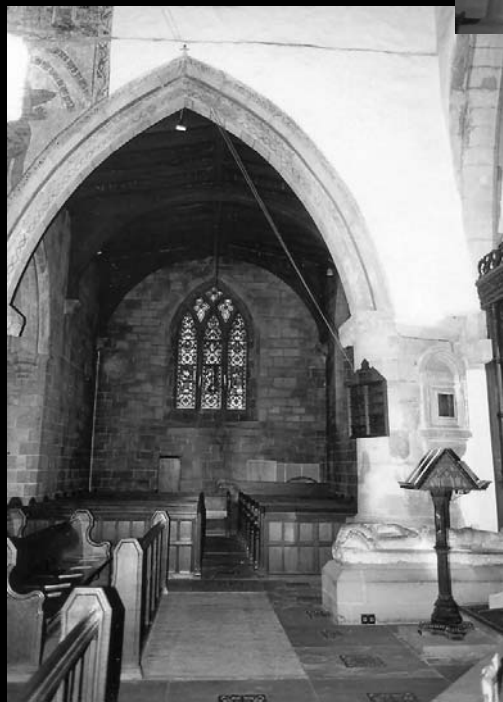

Chancel

12th and 14th century
alterations

North
transept

South
transept

15th century alterations

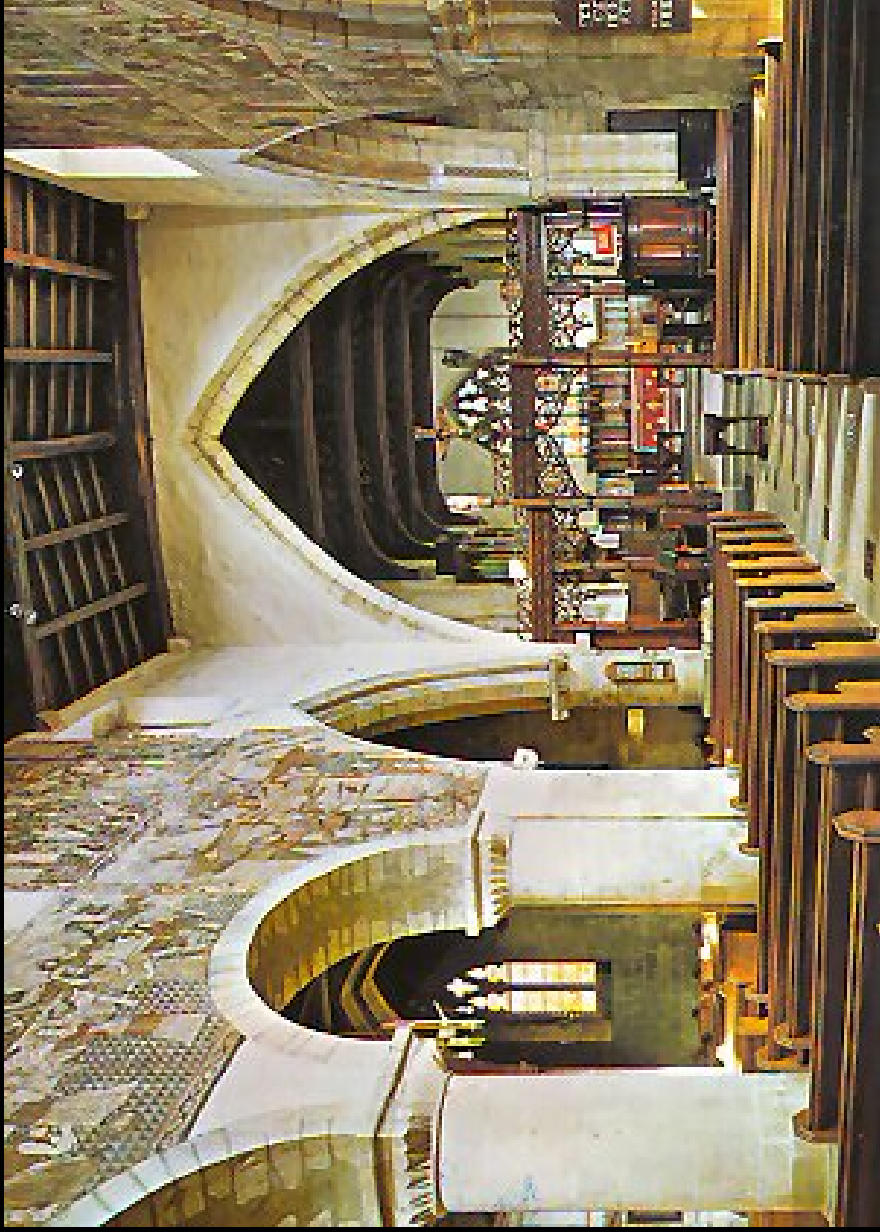

Hey Dikes' sketch (in a dark vestry!)



The extent of the original scheme(s)?

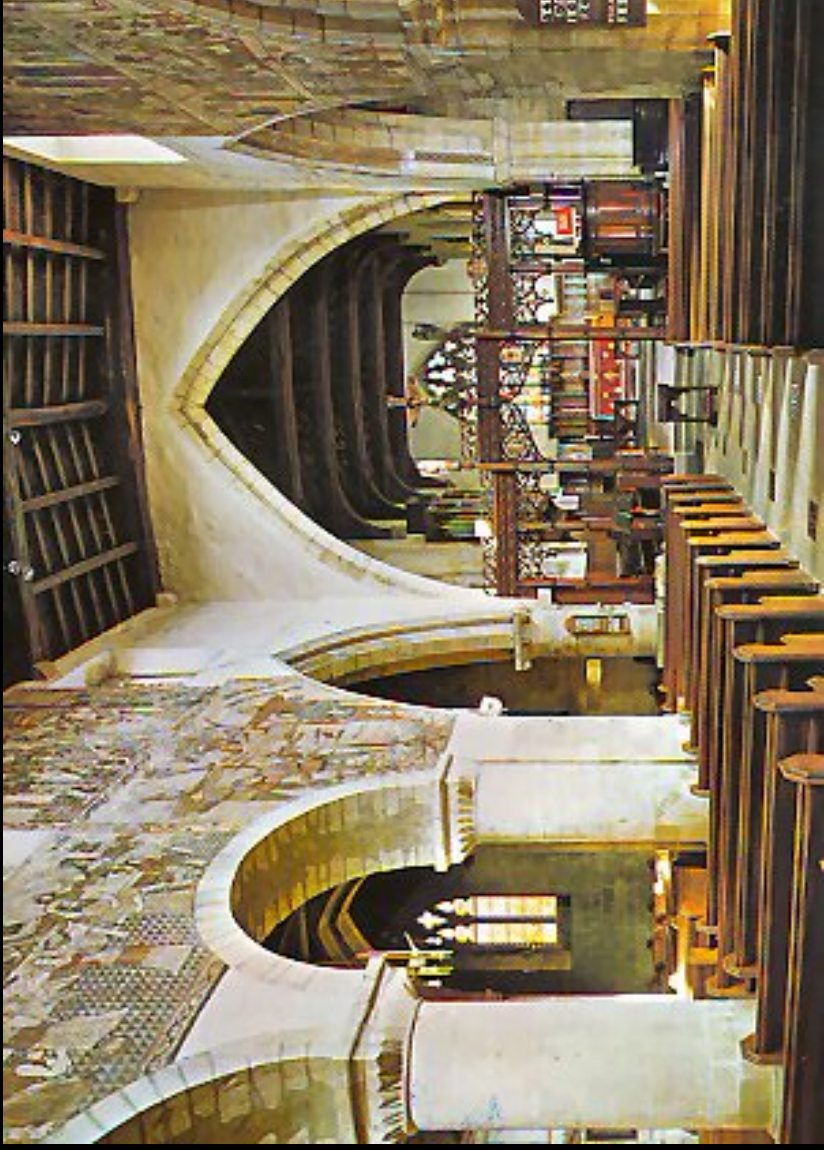

Pickering's cycle, from the east



St George and St Christopher



St John the Baptist



St Catherine of Alexandria

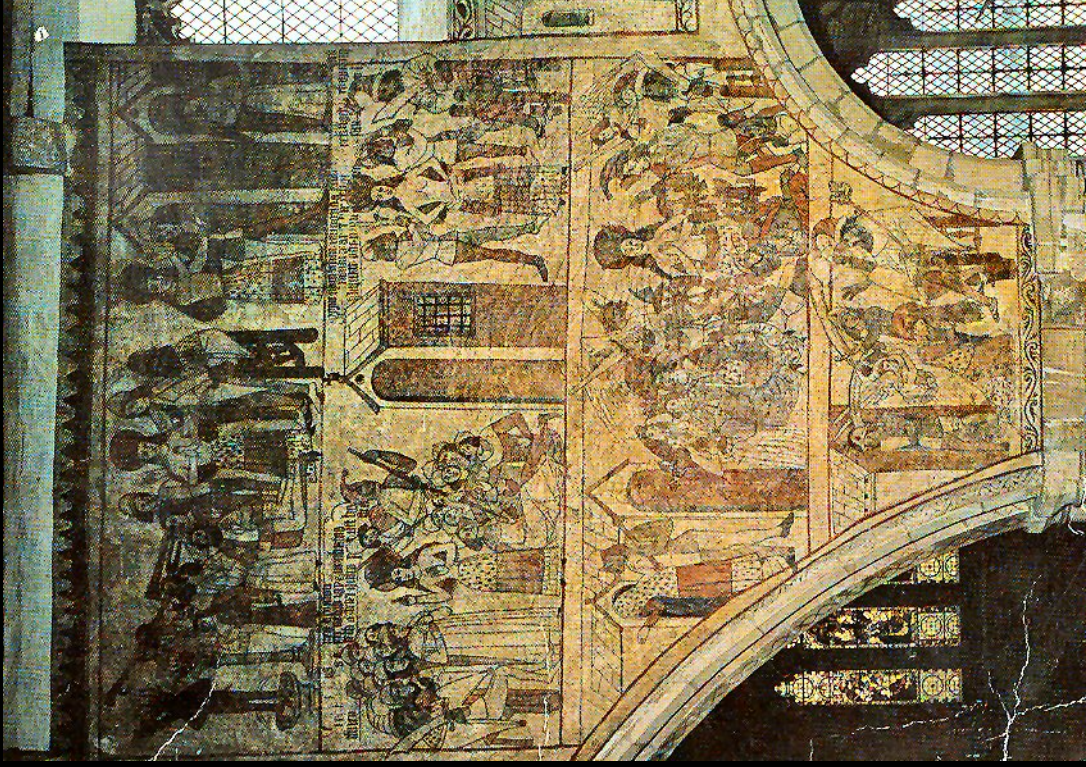

The corporal acts of mercy and the passion of Christ



The passion of Christ

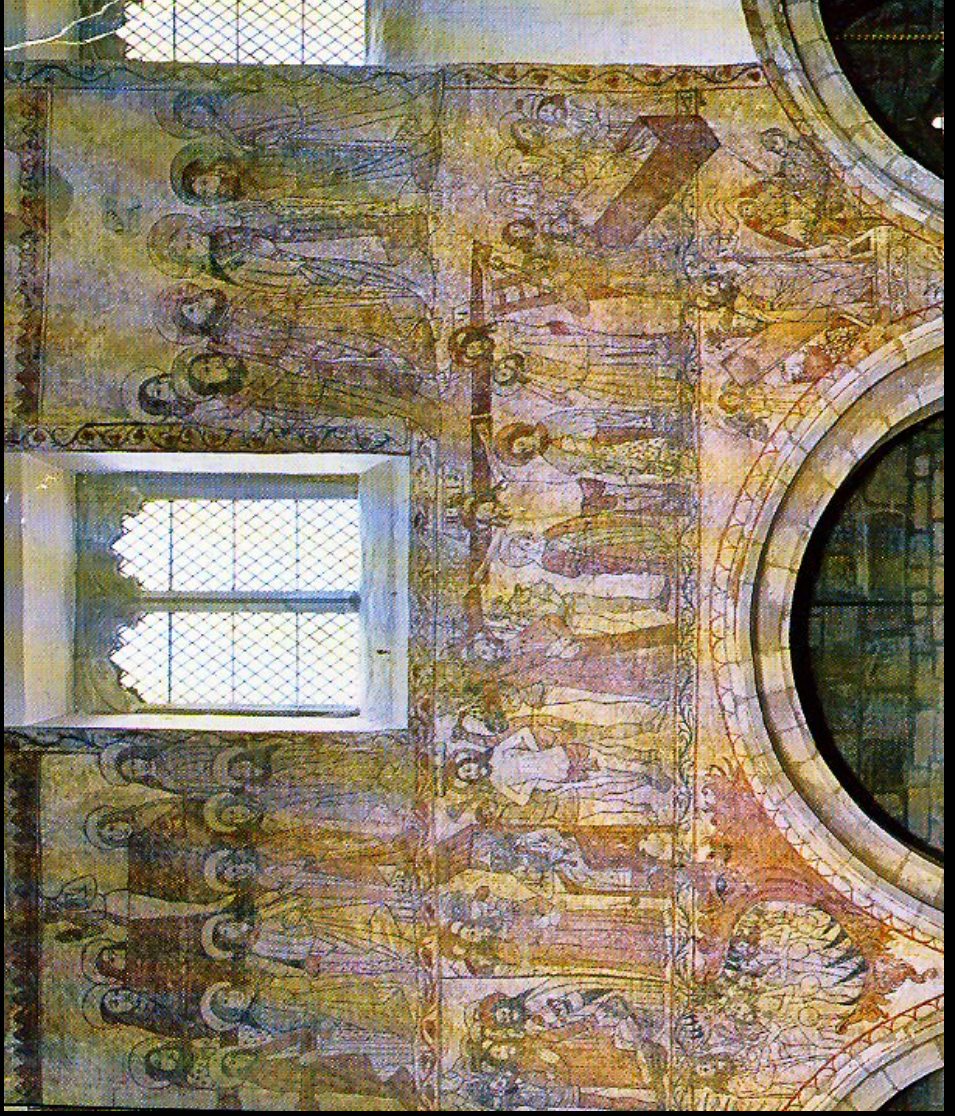

Death, Funeral and Ascension of the Virgin?

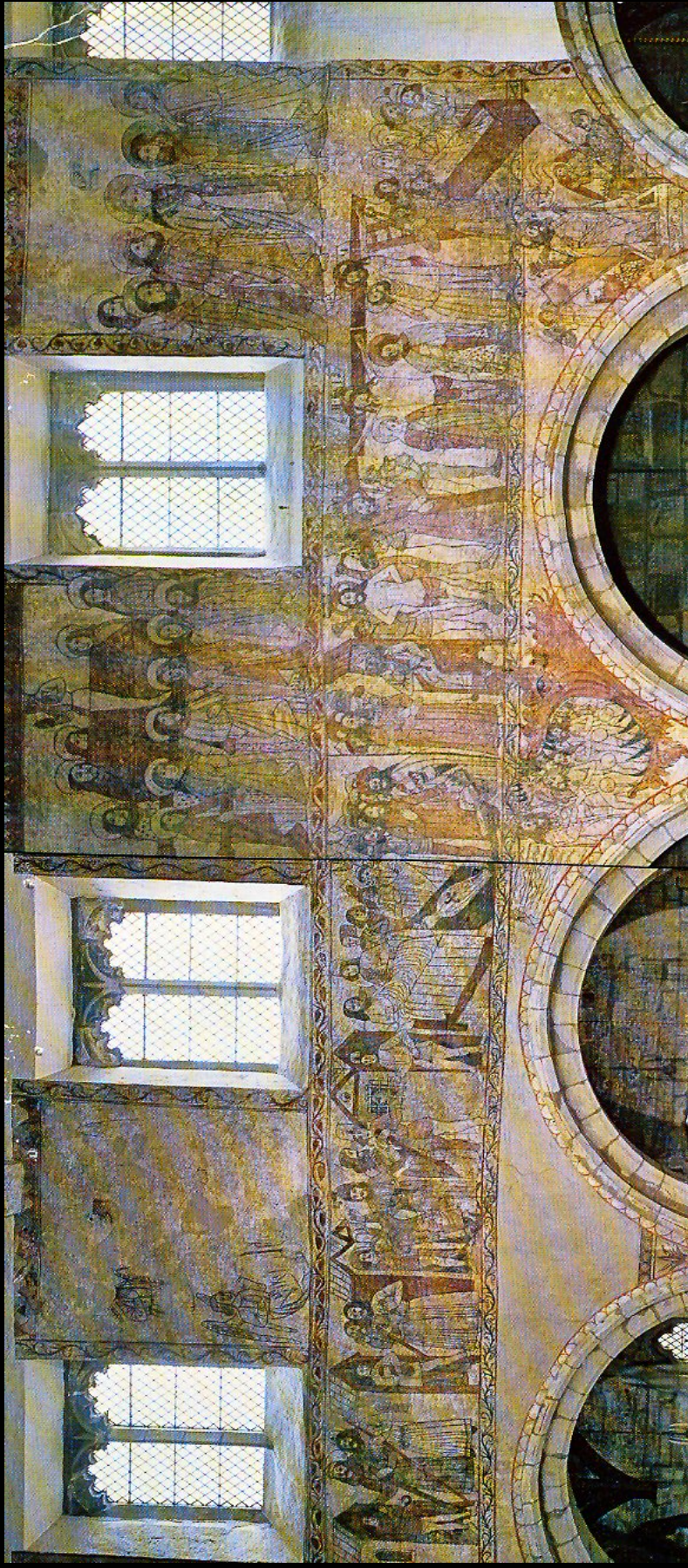

Coronation of the Virgin



The north wall



The south wall

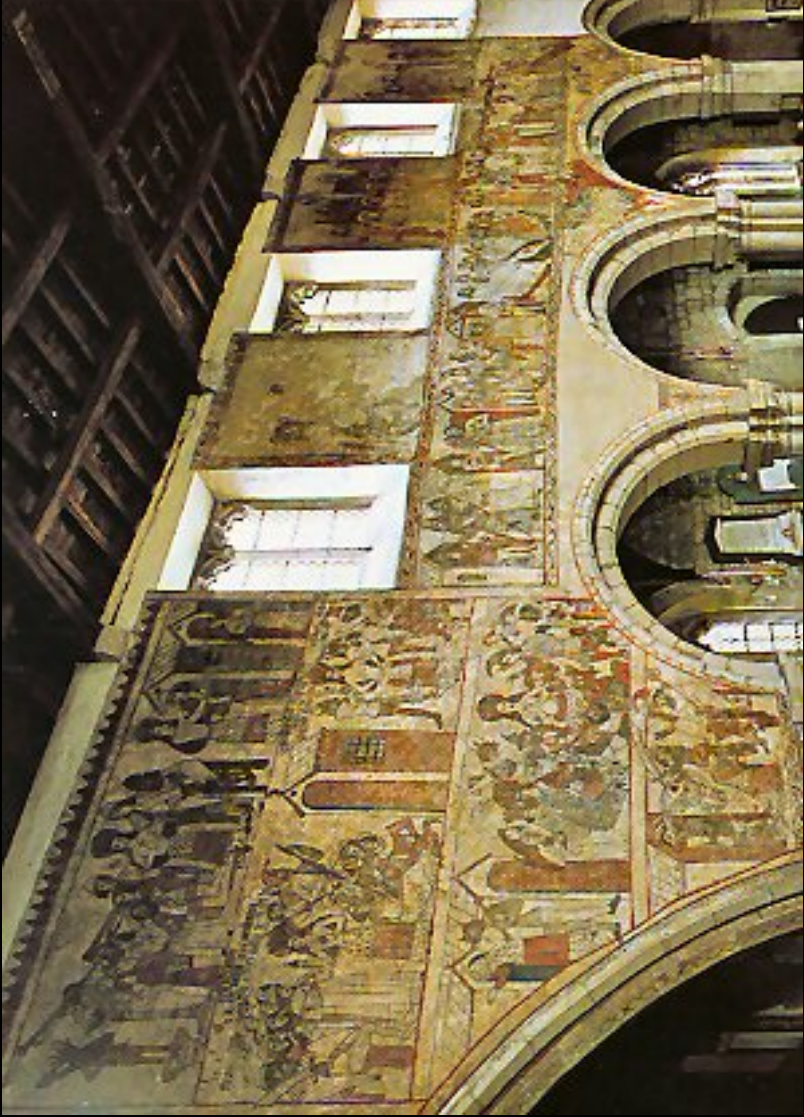

A liturgical calendar?

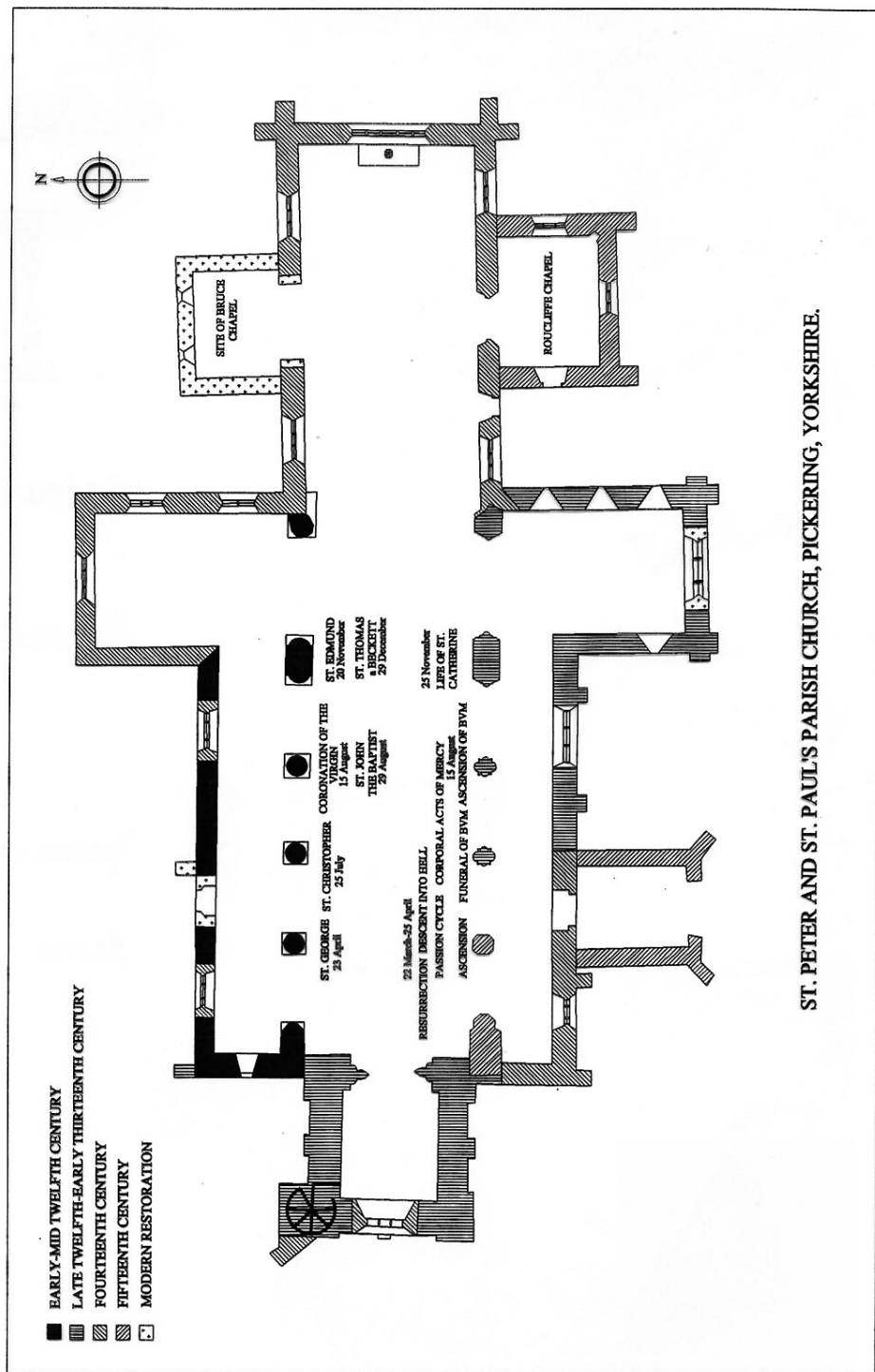

ST. PETER AND ST. PAUL'S PARISH CHURCH, PICKERING, YORKSHIRE.

Liturgical calendars

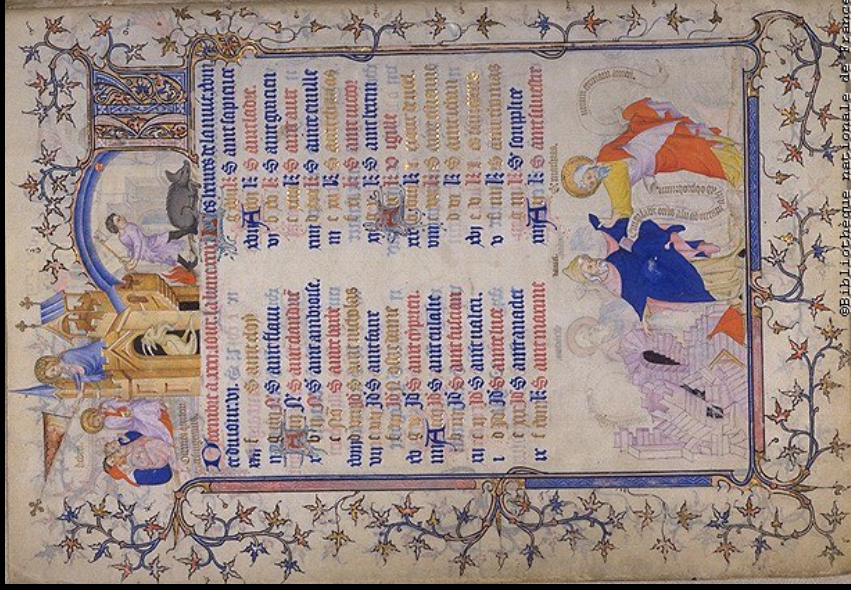

Conclusion

- We need to develop more 'integrated' approaches to the interpretation of medieval buildings
- During the 15th century certain levels of society within the laity are playing an active role in the parish church. How are they using material culture? What for? (the rise of the mediocres?)
- And how does this change in the Reformation? (the rise of the middling sort)