

2006

EPV 035 Sanders Field Notes 2006

Katherine Sanders

Follow this and additional works at: <https://digital.kenyon.edu/honduras>



Part of the Archaeological Anthropology Commons

Recommended Citation

Sanders, Katherine, "EPV 035 Sanders Field Notes 2006" (2006). *Four Valleys Archive*. Paper 96946.
<https://digital.kenyon.edu/honduras/96946>

This Field Notes is brought to you for free and open access by the Anthropology at Digital Kenyon: Research, Scholarship, and Creative Exchange. It has been accepted for inclusion in Four Valleys Archive by an authorized administrator of Digital Kenyon: Research, Scholarship, and Creative Exchange. For more information, please contact noltj@kenyon.edu.

6 February, 2006

2006-35-01 E.U.A

In the field at Fam. Talked about soil analysis and relationship to human usage of the area. Began making rough maps of the site but moved quickly onto finding our sites for the day (mine was #36 on the "associated points" map). I had the furthest North point and my 1x1 meter square was pre-staked in the NE & NW corners. Made my grid with help from Salvador. Despite feeling sleep deprived my mood is good and the sun is finally out! Started excavating square OP-02 + sub-op 36. My lot is shaded by a nearby tree - roots may extend into my excavation area. Phosphate levels in my area are low, ^{999.0:} SW ~~999.0~~ and ^{999.07} in my N.E corner. * Began digging in 10cm increments. My workers are Jorge + Armenias. We actually dug down 14cm for the 1st lot. We found 4 pieces of ceramics and one piece of obsidian. ^(1 bag in worth) The ~~soil~~ ^{topsoil} is thick and clay-like and ^{tenacious} ~~very sticky~~ Dark brown in color. The line level is hard to use as I started out measuring from my SE corner (b/c it is the highest point) but the exact elevations were taken from my North points - changed to measuring from my NE corner. There is a large pebble on the south end of the ~~test~~ pit. It juts out roughly 9 cm into the test pit and along the side for \approx 23cm. Final Elevations @ NW 998.88 NE 998.93 SW 998.81 SE 998.94



6-7 February, 2006

2006-35-02

→ Lot #2.

Found traces of carbon. Amounts so insignificant & shallow Patrick said to not bother keeping it. We began digging 6 more cm in order to make up for overdigging the first lot. So far, so good and the test pit is looking even at 20cm deep. We found more ceramics, orange in color and about 6 pieces and another rock that Jorge (my worker) claims is some special Maya volcanic obsidian working tool - I think probably not. The soil has not changed much - as it dries it becomes a more medium than dark brown. Stopped for the day around noon. I took the bag from lot one's finds to the lab and Jorge took the bag of lot 2 finds so we can continue filling it tomorrow.

FEB. 7 → Started work around 7:45 am. It's raining a little and the workers are putting up tarps. After some conflicting debate we are allowed to put up our tarps over the test pits. While the blue of the tarp affects soil color - it's all wet anyway so analysis will be difficult regardless.

We started digging continuing into the next 6cm (20cm total) of the test pit. At about exactly 20cm soil changes a bit in the southern part of the pit exposing a very soft red rock. Another rock is also exposed at about 19cm in the north edge of the test pit. Further

7 February 2006

2006-35-03

Cleaning around the edges of the rock, expose more rocks and the beginning of a floor pattern. only ~~2~~ 6 pieces of ceramic are found. Cleaning around the rocks to expose edges and a more distinct floor is done - roots are cut. With the discovery of the feature lot 2 is now a lot deeper than 20 cm. It now extends from ~~2~~ 14 cm - 29 cm.

The SW corner is at 30 cm \therefore 16 cm more
The SE corner is at 28 cm \therefore 14 cm more
The NE corner is at 26 cm \therefore 12 cm more
The NW corner is at 30 cm \therefore 16 cm more
The center is at 29 cm \therefore 15 cm more

The cobbles are in 3 rough East to west rows and vary in size, height, shape and proximity to one another*. I would think a thick layer of dirt between the rocks would have been implemented to create an even surface. There are also "lower quality rocks" such as a soft red one and a shale-like. The rocks do not appear to have been quarried at all with many rounded cobbles that look like they were simply pulled out of a river. It doesn't appear that much time or resources were invested into this floor. The soil between the rocks is slightly different than the topsoil from lot 1 (one) and most of lot 2. Around the stones the soil is silty clay of a medium brownish ~~grey~~ grey color with \approx 1 cm inclusions of very angular red stones (iron rich?). These are moderately sorted at about a 5% composition.

* see drawing

7 February 2006

2006-35-04

Day in-brief

Lot 2 BGS - 14 - 229 cm

Break down:

Initial elev: NW 998.88 cm NE 998.93 SW 998.89

Final elev: NW 998.72 NE 998.81 SW 998.73

→ ie: SE 998.94

fe: SE 998.80

Significance → cobblestone surface

Soil type → above rocks same topsoil, dark brown humus

→ among rocks silty clay med brown/grey with moderately sorted small angular inclusions.

Finds - One bag worth of ceramics.

Descriptions - 3 digital photos (on my camera)

1 plan (A) drawing 02/36/02

ROCK T

1 (tallest) 998.88 (19cm BGS)

2 (shortest) 998.79 (28cm BGS)

08 February, 2006

2006; 35-05

EV.A, LOT THREE (3)

- Removing floor in order to hopefully uncover some pre-classic pottery.
- Soil remains the same silty clay w/ inclusions although now it is more greyish brown than brownish grey - still silty clay
- Tell the guys to dig roughly 10cm more (39-40 B&S) - after only about 3cm we find more pottery than in either of the first two lots
- Continue digging until 40cm B&S

Final Elevations -

NW	NE	SW	SE
998.61	998.67	998.63	998.68
(11cm deeper)	(14cm)	(10cm)	(12cm)

- As we reach 40cm B&S soil remains a medium greyish brown silty clay but is even more tenacious, less malleable and appears to have fewer inclusions. (i.e. more well sorted and inclusions more at 1%)

Diary: raining again. Worked from 7am to noon. Spent most of today finishing Plan A drawing of the N. plaza surface. Began lot 3 removed rocks and dug with a goal B&S depth of 40 cm. Did not finish. Found ceramics & bajareque in higher concentrations than previous lots.

09 February, 2006

2006 - 35 - 06

Lot three (3) continued.

- Dug to BGS 40cm finding more ceramics and a couple pieces of bajareque (fewer than yesterday)

- My workers agree that the soil is harder at the final depth.

- Discussed with Patrick why soil difference was so minimal and possible significance of Lot 3.

Due to lack of a rock under surface I assume the floor surface of lot 2 to be the first "heavy" occupation and first floor built in the area of the north plaza. The dirt underneath remains silty clay and while more compact, did not appear to be a solid floor surface in itself. Could have been a rough floor or a period between steady occupation - a (though most likely not a period between occupation based on the ceramics & bajareque found. → 1 bag full

→ EU. A, Lot Four (4)

- Continue digging 10cm more (50cm BGS)
- Found a sample of carbon against the southern edge of the test pit → very small, but bagged it anyway (may not keep it however)
- Also finding larger chunks of ceramics
- At around 50cm BGS we found a large red rock with lots of crannies - will ask Patrick what it is - called early breakable ^{red porous,} _{rounded stone.} next to this rock is uncovered what could be

09 February, 2006

2006-35-07

Lot four continued...

a relatively large piece of ceramic in the NE corner. Because it is below 50cm we will level out the rest of the test pit and excavate that pottery in the 5th lot.

• Dirt has stayed the same although possibly more grey in color (well sorted silty clay with few inclusions and very tenacious)

→ lot summary

Final Elevations: BGS = 40-50cm

NW 998.51 NE 998.57 SW 998.53 SE 998.58

Findings - Small carbon samples (not large enough to keep)

- Ceramics

- Red porous stone, weathered round, unique, easily breakable (by striking w/ trowel) (also not kept) looks like pigment could be used?

- 1 bag full

⇒ E.U.A, Lot Five (5)

• Lowered another 10cm (BGS 50-60cm)

• Found more decorated pottery and a carbon sample at \approx 53cm BGS (quite small; will probably be thrown out)

• Soil remains the same - silty clay, greyish brown; few inclusions

• Some of the pottery appears to fit together (although breaks are ancient) - trash deposit?

• Soil does however have occasional larger rock (some very angular and some rounded river stones)

09 February, 2006

2006, 35-08

Lot five continued...

Which vary in size from 1-3 inches. However they occur infrequently (1-2% inclusions - if they can even be considered such).

* 253 cm in we finished for today. Will finish lot 5 tomorrow.

Day: No rain, but overcast & ~~clear~~ chilly.

Finished lot three and four and started on five. Tarp came down and still no stratigraphic layers (minus the floor) apparently visible. Everyone seems to have strep throat. Worked again from 7am - noon.

10 February, 2006

2006-35-09

EU.A

Lot Five continued...

- finding some ceramic that is much thicker than previously seen (about 1 full cm thickness, not decorated. (one piece very dark in color) - indicative of earlier or non-fine ware?)
- ≈ 57 cm BGS in NW area of test pit found a small patch of red soil near a pottery sherd. only about a small fistful and same silty clay - red = iron?
- Another tiny carbon deposit uncovered in southern part of test pit - way too small to keep.
- large rock (≈ 25 cm) exposed along my eastern wall. rounded river stone-like. I don't think intentionally placed due to its isolation

Summary:

Final Elevations: BGS 50-60 cm

NW 998.41 NE 998.47 SW 998.43 SE 998.48

Soil - silty clay, med. greyish brown (no change!)

Findings - ceramics (1 bag full)

10 February, 2006

2006-35-10

EU. A

⇒ LOT SIX (6)

- Goal depth 70cm BGS
- Soil staying the same in first few centimeters but becoming more compact & tenacious - breaking up into fist-sized chunks. When tested, however, still silty clay, well sorted w/ few inclusions
- right at \pm 70cm some stones exposed in NE area - possibly finding river bed?
- • noticed my elevation calculations are looking a little off → remember to double check later
- found an interesting lithic(?) red, smooth cut face w/ grey, bumpy ~~outer~~ rock. → maybe a core?

Summary:

Final Elevations - BGS 60-70cm
NW 998.31 NE 998.37 SW 998.33 SE 998.38

Soil - silty clay, greyish brown. very tenacious and appears more compact.

Findings - One lithic, one sherd, one tiny piece that could be bijouque or ceramic

EU A

⇒ LOT SEVEN (7)

- Goal depth 80cm BGS
- found small bit of stucco, but only an isolated couple of pieces so far.

10 February, 2006

2006-35-11

Lot seven continued...

° Soil remaining the same. noticing some small angular inclusions at about 5% composition. Also finding some large angular inclusions (5-10cm \pm) and rounded river stones - overall still silty clay (inclusions don't seem to be predominant enough in overall soil)

- A couple more pieces of flakey rock stuff found \rightarrow more stucco? looks red like bajareave but flakes (dry) more than crumble
 \rightarrow asked Marcello if it's nothing
- The "stucco" I found is actually decayed toba.

Summary:

Final elevations - BGS 70-80cm
NW 998.21 NE 998.27 SW 998.23 SE 998.28

Soil - remained the same w/ more angular inclusions + some larger rocks (river stone?)

Findings - toba + 1 piece of ceramic

EU.A

\Rightarrow LOT E14HT (8)

- As we dig we find larger river stones that are removed (their placement is random) these stones average \pm 20cm and smaller and are concentrated in the NE corner

10 February 2006

2006-35-12

Lot Eight continued...

- Soil does not appear to have changed
- One large (≈ 35 cm long?) cobble in the middle of the test pit, along w/ more river stones in the SW corner are unearthed \rightarrow deposited same time?

Diary:

Tarp up again - rain. worked last half day (7am-noon). Continued lots - finding no features. T&LF.

13 February 2006

2006-35-13

Diary: Rainy & cold again. Today is our first full day in the field (7am - 4pm) which seems like a very long time - plus Mondays are hard. Finishing up lot 8 today to 90cm and then continuing lots until bedrock. Then will do segment drawing of strata.

Lot 8 continued...

Summary:
- Continued w/ same silty clay soil (same med. grey/brown color). River cobbles (natural deposit) somewhat abundant.

Elevations: B&S: 80-90cm
Final - NW 998.11 NE 998.17 SW 998.15 SE 998.18

Findings - Empty lot → no artifacts, river cobbles
Bags - \emptyset

13 February, 2006

2006-35-14

EU. A

⇒ Lot Nine (9)

- BGS goal 90-100 cm
- A few centimeters in I find my 1st soil change! Darker, smother, stickier than the silty clay above. Tell workers to level off at change so I can measure the depth. Change is not too abrupt, changes into more of a ~~clayey sand~~ ^{sandy clay} of approximately the same color but with bits of fairly dark brown mixed in (presumably the sand?) Continuing to remove cobbles.

Summary:

Soil - change to sandy clay

Findings - empty lot

Bags - 0

Elevations - BGS: 90-100 cm

Final -

NW 998.01 NE 998.07 SW 998.03 SE 998.08

13 February, 2006

2006-35-15

EU. A

LOT TEN (10)

- Soil remained sandy clay w/ more cobble stones uncovered
- BGS goal of 110cm
- No artifacts or features found
- Some river pebbles found also → Jorge agrees probably a river deposit.

Summary -

Final Elevations - BGS: 100-110cm
NW 997.91 NE 997.97 SW 997.93 SE 997.98
Bags: 2

EU. A

⇒ LOT Eleven (11)

- Workers keep digging to 120cm BGS while I help set up a trenchon structure #9.
- Soil remains the same but many more pebbles + river stones being pulled out → many more inclusions + poorly sorted ≈ 35% composition. One very large cobble on my Northern wall (≈ 50cm).
- Right at 120cm the soil becomes even more sandy → Clayey sand.
(will excavate 10 more cm to complete a lot in the new soil)

13 February, 2006

2006-35-16

lot eleven(11) continued...

Summary:

Final Elevations - BGS: 110-120cm
NW 997.81 NE 997.87 SW 997.83 SE 997.88

Bags: 2

EU. A



LOT TWELVE (12)

- Final lot BGS: 120-130cm

- soil change to clayey sand (complete)

Still very poorly sorted w/ both rounded?
angular inclusions sand up to \approx 40%

composition

- at 130cm found one pre-classic
pot sherd

Summary:

Soil - complete change to clayey sand w/
many inclusions, poorly sorted.

Finds - ~~one~~ one late pre-classic pot sherd

Bags - 2 one

Final Elevation - BGS: 120-130cm

NW 997.71 NE 997.77 SW 997.73 SE 997.78

13 February, 2006

2006-35-17

EU. A

LOT THIRTEEN (13)

- Due to the pre-classic pottery found in my last lot (may even be early) we decide to dig another lot → making sure cobbles aren't rough terrace structure hiding a wealth of pre-classic sherds (Patrick's far fetched idea) How CRAZY!
- Continuing to 140cm
- found bit of "ceramic" could also be decaying rock on eastern wall.

Summary -

Soil - clayey sand

Findings - possible ceramics

Bags - one

Final Elevations -

BGS = 130-140cm

NW 997.61

NE 997.67

SW 997.63

SE 997.68

EU. A

→ LOT FOURTEEN (14)

- Going down to BGS 150cm to make sure there's no more pottery
- Soil becomes very rocky (almost seems were lifting out more rocks/pebbles than soil) → soil type stayed the same: clayey sand, poorly sorted, 40% (at least) inclusions of both rounded + angular types. (seems like the gravelly bottom of a river) med-grey/brown in color.

14 February, 2006

2006-35-18

→ LOT FOURTEEN CONTINUED...

Summary

Soil - clayey sand (same as before)

Findings - nothing

Bags - 0

Final Elevations -

BGS - 140-150cm

NW 997.51 NE 997.57 SW 997.53 SE 997.58

Diary - Finished up lots. Will most likely finish setting up trenches today & sketching sections of my test pit. It's overcast & drizzle but no rain - so tarp is down. Rocky found a little frog in her pit. It's very cute & distracting. Had a very hard time waking up this morning and I have one puffy eye for some reason; this could be a long day.

15 February, 2006

2006-35-19

Final Notes - 02/36¹¹³

• Investigating a low phosphate spot in the Northern Plaza.

• Site is directly North of Structure #9 and is the furthest point North of all the test pits.

• Test pit is 1x1 meter

• Reached a 150cm BGS final depth

• Starting Elevations

~~NE~~ NW 999.02 NE 999.07 SW 999.03 SE 999.08

Final Elevations

NW 997.51 NE 997.57 SW 997.53 SE 997.58

• Datum point - NE corner

• deposit a (see section drawing)

The first 20cm were composed of topsoil of dark brown humus. Found some, albeit very few (24 sherds), ceramic pieces. Also found one piece of obsidian

deposit b

The next 20-30cm BGS I uncovered a cobble stone floor associated with late classic occupation - Part of a larger North Plaza floor most likely. Cobbles were loosely spaced and both angular & rounded to suggest it was not a terribly precise construction (not much invested in materials of building). Pottery sherds were found in between and just above the floor. Soil - very dark greyish brown silty clay with relatively few inclusions. Rock \approx 25x10cm average.

15 February, 2006

2006-35-20

Final Notes - 02/36 continued...²¹³

deposit c

Next 30-40cm B&S was architectural fill and held most pottery (in terms of density). Also found bajareque in this level. Soil remained silty clay but changed to very dark brown and became slightly more tenacious and harder to dig through.

deposit d

This layer was a large section of (most likely) more architectural fill. It extended about 40-70cm B&S. Pottery sherds and bajareque also found in this layer (making me associate it with the layer above). Soil lightens to a dark brown but remains silty clay. Also continues to harden & become even more tenacious.

deposit e

This layer appears to be a sloping river deposit with cobbles and river pebbles abundant and no pottery or bajareque found. Soil changed to sandy clay with more poorly sorted inclusions of a both rounded and angular nature. Color remains dark brown. This deposit continues approximately 70-90cm B&S. cobbles \approx 35x15cm average.

15 February, 2006

2006-35-21

Final Notes 02/36 Continued... ^{3/3}

deposit f

From 90 cm to the end of my test pit at \approx 150 cm BGS there continue to be river cobbles and many stone inclusions. At about 130 cm BGS a pre-classic pottery sherd was unearthed. Other than this, the lots at this level are empty (I assume washed into river sediment?)

Soil - becomes clayey sand and lightens in color to a brown. It is very gritty with many inclusions in the sediment and large cobbles.

Overall it appears that humus accumulated over the floor feature (abs. elevation 998.81 cm [NE]) which was built on top of fill which was fairly dense in cultural material (came from trash?). The fill leveled off the uneven surface deposited by the river as it moved further North.

15 February, 2006

2006-35-22

Diary - Finished Section Drawings for E.U.A on Sub-op #36. Wrote up Final notes. Days are still running about 7:30am to 3pm. Took me until about 2pm to completely close sub-op 36. Began my trench on building #9.

Trench - 17 meters long. 17 separate 1x1 meter units.

Runs ^(roughly) S → N bisecting structure 9.

There are some large roots, trunks & rocks. May possibly not excavate ones that are too obstructed.

• Structure 9 is a long short mound off of structure # 8. Appears to be a sloping terrace. Will most likely find a platform and stairs

• Wileysda has a trench parallel to mine on the shallower end (further from structure 8) of #9. Sub op 44.

• Will start from my S end on the 1st 1x1m unit → unit A

• Datum point will be my NE corner

• Structure #9 separates the plaza from the Northern Plaza at the foot of str. 8 which lays directly west

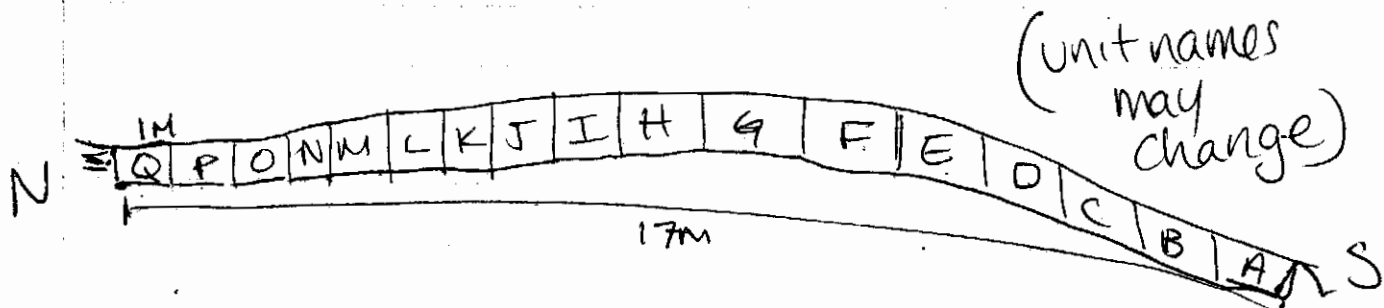

15 February, 2006

2006-35-23

OP: 02
Sub OP: 45
EU: A

⇒ LOT ONE

Began removing topsoil. wanted to go down 10cm, but overshot & will be going down 20cm. No official elevations yet, but will calculate as known ⇒ until then B&S.

* Did not finish lot today. See tomorrow's notes.

16 February, 2006

2006-35-24

02/45

EU. A

Lot one (1) continued...

- found some ceramic (small sherds) and one piece of obsidian

- Found good size bit of carbon the first in the ~~S~~ SW corner (1) and the second in the SE corner (2).

Because it is found in association with some sherds & the obsidian piece, I saved the carbon. However probably does not need to be tested as still quite shallow.

- As we went to 20cm the topsoil changed ~~a bit~~ from humus to a silty clay at the very end of the lot.

Summary -

Soil = topsoil humus, dark greyish brown

Findings - ceramic, obsidian, carbon

* Elevations -

BGS - 0-20cm

Bags - **2** (including carbon)

16 February, 2006

2006-35-25

02/45
E U. A

→ LOT TWO (2)

- full soil change to silty clay - lighter in color than topsoil.
- Found ceramic shards including a handle
- Found another obsidian blade
- Cobble uncovered on my east facing edge. Extends ≈ 12 cm into the unit and about 12 cm wide at its base.
- Found more carbon \rightarrow bagged it. Small amount, but I thought maybe deep enough to be of use/interest.
- In the northern part of my unit found a hole about 2 cm diameter that goes down 35 cm \rightarrow why is it not filled in? Thought it was a post hole, but it's a total mystery. I think it leads to hell. Patrick disagrees.

Summary -

Soil - Silty Clay, med. brown

well sorted (except 1 pebble + 1 larger cobble)

Findings - Carbon, obsidian & ceramic

* Elevations -

BGS - 20-30 cm

Bags - 2 (including carbon)

16 February, 2006

2006-35-26

02145

EU.A

→ Lot Three (3)

- Digging down to BGS 340cm
- found small obsidian blade and a ~~chert~~ piece that may be a core (2 total)
- Also finding more pottery sherds
- Another fleck of obsidian found → really quite small but bagged it anyway
- Soil is silty clay still but less malleable / more tenacious and breaking in larger fragments.
- Found another larger piece of obsidian and another lithic → maybe chert?
- Another obsidian piece - wow lots!
- May have some uncarved toba?

Summary:

Soil - tenacious, hard silty clay med. brown

Elevations: BGS 30-40cm

Final:

Findings - lithics (mostly Obsidian),

ceramics & toba

BGS - 30-40cm

Bags - 1

16 February, 2006

2006-35-27

02/45

EU. A

⇒ LOT FOUR (4)

- change of soil; still clay (silty clay) but very, very hard and compacted. Med. brown with a little bit of a red hue.
- No pottery uncovered thus far maybe a floor.
- Most likely a floor as no artifacts are uncovered. ∴ floor would extend from at least BGS 40-50cm.
- will most likely move to unit B to follow floor.

Summary:

Soil - very compact silty clay, med/brown

Elevations -

NW 49cm^{BGS} NE 50cm^{BGS} SW 43cm^{BGS} SE 43cm^{BGS}

Findings - Empty of artifacts; floor/occupation level of compact soil.

BGS - 40-50cm

Bags - none

16, February 2006

2006-35-28

02/45

EU.B

→ Lot ~~one (7)~~ ~~SIX~~ FIVE (5)

- Beginning to dig excavation unit B which is 1x1m directly above EU.A. looking for the floor which we found in EU.A in order to follow it (hopefully up to a feature - stairs of the structure?)
- Lot one is topsoil humus and is dark brown in color.
- We find a very small piece of obsidian and a ceramic sherd

Summary-

Soil - topsoil humus

Findings - obsidian (1), sherd (1)

Elevations

NW 10cm^{BGS} NE 10cm^{BGS}

SW 8cm^{BGS} SE 9cm^{BGS}

BGS - 0-10cm

Bags - 1

20 February, 2006

2006-35-29

02/45
EU. B

Diary - overcast & rainy day with tarp
back up. Makes it hard to see stratigraphic layers (the
floor I have is not clearly visible). Continuing in Excavation
unit B to hopefully find the continuation of the
floor/cultural level. I am very burned from the
beach and I wish I was back in bed.

→ LOT ~~TWO (2)~~ SIX (6)

• Continued down an extra 10cm to roughly
20cm BGS

- found ceramic sherds (very few \approx 6 sherds)
- soil like in previous excavation unit is
med brown silty clay with 2 larger rocks
as the only inclusions (tumble?)
- beginning of a soil change to a more clayey silty
clay that's lighter in color.

Summary -

Soil - silty clay, well sorted, med brown no
inclusions minus 2 larger rocks (NE + SW corners)

Findings - 6 pieces of ceramic

Elevations - BGS

NW 20cm BGS NE 20cm BGS

SW 18cm BGS SE 18cm BGS

BGS - 10-20cm

Bags - one

20 February, 2006

2006-35-30

02/45

EU. B

→ LOT SEVEN (7)

- Continued to 30cm BGS
- uncovering more large rocks (potentially more tumble off my structure)
- Finding ~~and~~ more obsidian (2 small pieces) and more ceramic sherds (in more abundance than previous lot) → Also chert (1 piece)
- Now at least 8 rocks
- Soil is still silty clay, but has about 15% angular inclusions. color appears lighter, but hard to see in overcast conditions - prob. med. brown.
- FOUND Pre-classic rim → very shallow still

Summary -

Elevations in BGS:

NW 29cm^{BGS} NE 30cm^{BGS} SW 27cm^{BGS} SE 27cm^{BGS}

Soil = silty clay, med. brown 15% angular inclusions → 8 (larger stones)

Findings = lithics (obsidian; chert), ceramic
(including one pre-classic rim)

BGS: 20-30cm

Bags: one

20 February, 2006

2006-35-31

02/45

EU. B

→ LOT EIGHT (8)

• Soil appears to stay the same as above
(Silty clay med brown with some angular inclusions)

• Continuing to find ceramics, one obsidian blade + bajareque

• ~~also~~ found carbon at the end of this lot (2 samples - 2nd bag)

Summary -

soil = silty clay

Findings = ceramics, carbon, bajareque, obsidian

Elevations:

NW 40cm^{B65}

NE 41cm^{B65}

SW 39cm^{B65}

SE 39cm^{B65}

B65: 30-40cm

Bags: 2

20 February, 2006

2006-35-32

02/45

EU. B

→ LOT NINE (9)

- Found + went \approx 5cm through the floor
- some ceramic found (much less than lot 8)
- potential pre-classic piece
- went down 5cm before realizing I was at my floor.

Summary.

Soil = very clayey silty clay, tan (yellow brown) in color and hard w/ few inclusions \rightarrow more uniform clay

Findings = 15 pieces of pottery + one carbon sample

Elevations.

↻ NW 46cm BGS NE 45cm BGS SW 44cm BGS SE 45cm BGS

BGS - 40-45cm

Bags - 2

20 February, 2006

2006-35-33

02/45

EU. C

→ LOT TEN (10)

- First lot in new excavation unit C. Taking off the topsoil → about 10cm
- Found some small pieces of ceramic

Soil - dark grey/brown humus

Finding - pottery

BGS Elevations -

NE 10cm NW 13cm SE 10cm SW 10cm

BGS - 0-10cm

Bags - 1

→ LOT ELEVEN (11)

• silty clay w/ inclusions - mostly angular and small (≠ 1cm) about 15% composition.

- Tumble cobbles exposed → attempting to follow natural stratigraphy

BGS -

Summary: Finding pottery, chert, obsidian + bazarque

BGS Elevations:

NW 30cm^{BGS} NE 39cm^{BGS} SW 22cm^{BGS} SE 25cm^{BGS}

→ uneven due to incline + attempt to stay fairly level.

BGS - 10-25cm

Bags = 1

20 February, 2006

2006-35-34

02/45
E. U. C

→ LOT TWELVE (12)

- Soil still silty clay → maybe about 20% inclusion composition of both small angular & rounded pieces. Still med. brown in color
- Finding pottery (as should in abundance in this lot because it is directly above what I believe to be my floor)
- Taking out tumble rocks (see rough placement drawing on lot 11 form)
- Found carbon → tiny sample & totally not worth the energy to make the bag.

→ Didn't finish lot today → finish tomorrow

21 February 2006

2006-35-35

02/45
EU. C

Diary: Sunny. Hope I don't get more
Sunburn.

⇒ LOT TWELVE continued...

- Found another carbon sample today along w/ more ceramic, an obsidian blade + bajareque
- continued digging but only in the Northern half of the unit where we began uncovering more structural looking rocks (same plane, lying flat) They appear to only be on the Eastern Side however — will keep digging to hopefully unearth some on the western edge as well.
- Found a small piece of uncarved toba.
- Flat rocks uncovered on western side as well, lower than the eastern ones → fairly straight line → basal wall
- ~~★~~ TOOK photo and removed tumble
- under the tumble found large ceramic sherds
- continued down to floor level
BGS ± 38cm

Summary:

Soil - silty clay med. brown w/ inclusions

~~and~~ Elevations BGS

NW 40cm^{BGS} NE 38cm^{BGS} SW 37cm SE 39cm

★ NW + NE measured from top of wall rock

Findings: Ceramic, bajareque, lithics (obsidian + chert)
carbon

21 February 2006

2006-35-36

02/45

E.V.C

→ LOT THIRTEEN

• Go through the floor to see if basal wall extends further down

• In the floor level we found more ceramics along with obsidian + carbon
(including fireware)

Summary:

Finds: ceramic, obsidian, carbon

Soil: silty clay, ~~very~~ little - no inclusions
yellowish brown.

Elevations: BGS

NW 40

NE 38

SW 50cm SE 51cm

BGS - \approx 38 - 50cm

Bags - 2

→ N measurements still tops of wall rocks.

21 February 2006

2006-35-37

02/45
EU. D

⇒ LOT FOURTEEN (14)

- Starting next ~~to~~ unit to see where my wall goes since it is only one layer thick in unit C.
- going through topsoil → humus dark greyish brown
- Found some carbon

Summary:

Findings - carbon

Bags - one

Elevations as BGS-

NW 13

NE 12

SW 12

SE 14

BGS = 0-13cm

⇒ LOT FIFTEEN (15)

- ~~Overburden on top of wall or~~ soil accumulation + topsoil
- going down another roughly 20cm
- med. brown silty clay soil.
- One rock found → could be a step up.
↳ more rock exposed on same level in line w/ others + most likely a step

Summary:

Findings: Ceramic, taba, bajareque ~
obsidian

Elevations: BGS: 213-240cm

BGS NW 40cm

NE 41cm

SW 34cm

SE 39cm

* Not finished 2/21, see tomorrow's notes p. *38

22 February, 2006

2006-SS-38

Diary: Sunny and will probably be hot today. The soil in the trench is drying out making strata more visible, but more crumbly.

02/45
EU.D

⇒ lot Fifteen continued...

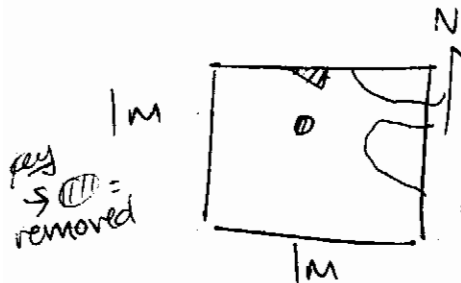

• with about 5cm left in this soil type (lot) the lot looks roughly like ~~my~~ sketch w/ tumble.

• removing rocks as they come completely loose

★ (see p. 37 for summary + elevations)

⇒ took ~~the~~ photos of tumble



LOT SIXTEEN (16)

• continuing to the level of the rocks in my basal wall from unit C.

• Finding ceramics and some nice obsidian blades. ALSO carbon in what I think might be a testable amount.

• ① pieces of obsidian so far ⇒ most small one big cool one + one piece of chert

• Another carbon sample found against the west side of my unit towards the very end of the lot (labeled #2)

• Also found bajareque

• Dug a bit further - exposed a second row of rocks behind my basal wall.

02/145 22 February 2006

2006-35-39

Ev. D → LOT SIXTEEN continued...

• found more obsidian (3 more) + another small piece of chert.

• 2 lines of rocks now exposed (one line from unit C and another from unit D)

Directly behind the stones the soil changes to a lighter yellowy brown → similar to my floor from before.

Summary:

Soil - Silty Clay changing slightly at very end of lot to a finer silty clay (fewer inclusions) yellowy brown in color. Silty clay in the lot is darker than lot 15 w/ more inclusions - maybe 15% composition somewhat angular.

Findings -

- 9 pieces of obsidian
- 3 pieces of chert
- 2 carbon samples
- 1 piece of tobacco
- 127 pieces of pottery
- 18 pieces of bazarque

Elevations:

NW 57cm

NE 63cm

BGS - 40-256cm

SW 50cm

SE 52cm

Bags - 2

22 February 2006

2006-35-40

02/45
EUE

→ LOT SEVENTEEN (17)

- Starting new unit
- Same topsoil humus + going into ^{more clayey} silty clay
- found a stone in the Eastern side of my unit → in line w/ other stones on the surface (visible on the rest of str. 09) — at least 8 of them.
- Another rock next to the previously found one is also uncovered → we took initial lot to make it even.

Summary.

Elevations in BGS: N 24 NE 23 SW 12 SE 17
BGS 0-18 cm

Findings - 19 pieces of ceramic
3 pieces obsidian
1 piece chert?

Soil: silty clay topsoil moving into a slightly lighter (med. brown) silty clay

22 February 2006

2006-35-41

02/45

EU.E

⇒ LOT EIGHTEEN (18)

• continuing down in the first half of my lot first to see if the rocks I found extend downward at all.

Rocks are both tilting and are not supported by any other rocks beneath except for one relatively small + rounded one.

• 2 more rocks towards the south end of the unit become visible but with no clear connection to the others.

Elevations:
in BGS: NW 37

⊙ BGS-18 \approx 32cm

NE 43cm

SW 22

SE 33cm

Findings:

44 pieces of ceramic
1 piece of obsidian
bajareque (4 pieces?)

Bags: one

23 February 2006

2006-35-42

02/45

EU-F

Diary - Sunny again today. Already hot @ 7:45am when we start work. Starting a new unit to see if I can make sense of the rocks in Unit E.

⇒ COT 19

- Going through topsoil.
- Finding some small amounts of pottery - mostly small pieces
- Very large stone in the northern part of my pit. Very close to the surface. Isolated, seems like tumble. Hopefully the next lot will explain better or remove it at tumble.

Summary:

Soil - topsoil silty clay dark grey/brown - same as the rest of my trench's topsoil.

Findings - 7 pieces of pottery
2 small pieces of obsidian

Elevations:

in BGS: NW 18cm NE 20cm SW 12cm SE 12cm

BGS: 0-16cm

Bags: one

23 February 2006

2006-35-43

02/45
EU. F

→ LOT 20

"Excavating around my rock to see if there are more. Finding some smaller rounded rocks that don't seem to fit any pattern - more tumble?"

- Finding pottery, but not much.

- Also obsidian.

- Soil is med. brown silty clay w/ a fairly uniform (smooth) texture - few inclusions. I think it extends $\approx 30\text{cm}$ to the base of my previous unit (E) but will take it in 2 lots. to make sure I don't miss any changes + to assess whether to take out my tumble rocks.

Summary Findings -

Ceramics (55)

Obsidian (1)

Chert (1)

Soil - Med. brown silty clay w/ no inclusions

Elevations:

NW 37cm NE 46cm SW 25cm SE 28cm

BGS: 16-35cm

Bags: one

23 February 2006

2006-35-44

02/45
EU.F

⇒ LOT 21

- Looking to see if there are any rocks beneath the stuff I thought was tumble in the lot above (20)

- not finding many more rocks - so confused

- Carbon + ceramics found.

- where are the rocks?!

- 2nd carbon sample found → much smaller possibly part of the same deposit.

Summary:

Findings: 63 pieces of ceramic, toba (3)
bajareque (3 very small pieces), 1 obsidian shard

in BGS:

NW 44cm NE 50cm SW 38cm SE 44cm

BGS² = 35-44cm

Bags - 2

Soil - Same as Lot 20 → silty clay, tenacious
but smooth (no inclusions) in med. brown

23 February 2006

2006-35-45

02/45

EU. 4

→ LOT 22

- Moving up a unit to help explain more. Hoping to find another wall & relate it w/ the rocks (tumble?) in units E & F.

Summary-

Findings -

ceramic (6)

chert (1)

Elevations:

NW rock

NE rock

SW 15cm SE 23cm

BGS 0-19cm

Soil - silty clay topsoil in dark grey brown + moving in to my 2nd soil of more tenacious silty clay in med. brown

- moving on to Unit H in order to see how far back the tumble + possible wall continues. will most likely sketch both units in a plan before removing tumble

23 February 2006

2006-35-46

02/45
EU.H



LOT 23

• moving up a unit to see extent of potential wall rocks

Summary

Soil - topsoil/humus dark grey brown

Elevations

NW rock NE rock SW rock SE 27cm

BGS - 0 - ≈ 27 cm

Bags - 1

Findings

4 pieces of ceramic +
one rock w/ potential use w/ ~~rock~~

Sketch:

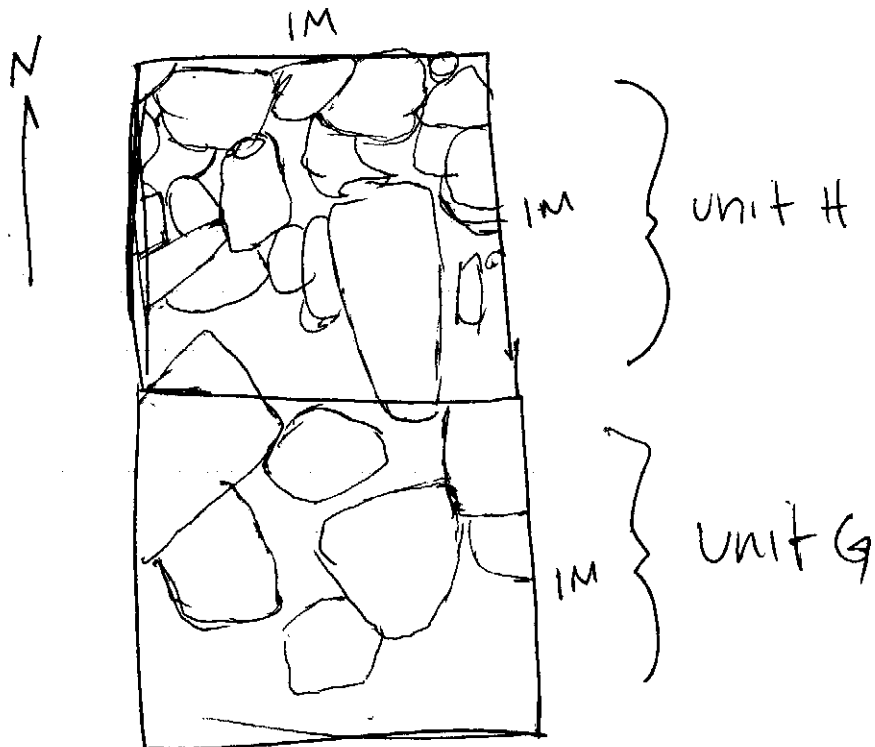

24 February 2006

2006-35-47

Diary:
overcast
but warm.
perfect.

Working
till 1-1:30pm
and having
the Paradise
Crew visit

02/45
EU. G + H

LOT 24

• Combined units for a 2x1m lot where I'm removing tumble from above a possible wall.

• Measured from my only clear corner where depth actually changed - unit H's SE → BGS 29cm

• Found wall in my N ~~side~~ edge of my unit H and possible connecting floor → need to go further down to see if rocks are on top of others and if my flat rocks in front of the wall are associated w/ more.

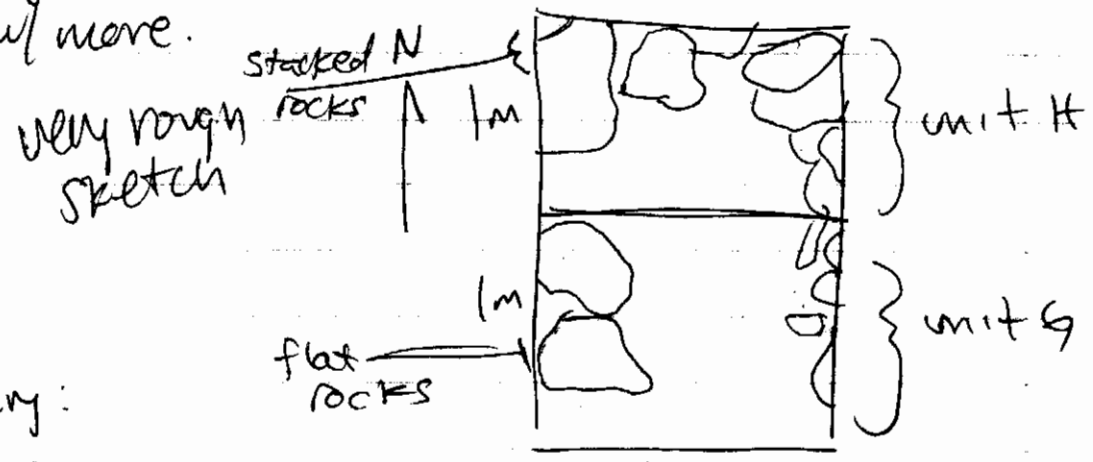

Summary:

Findings: 11 pieces of ceramic, 1 small piece of obsidian

Soil: Silty clay w/ somewhat angular inclusions (15%?) med. brown

BGS: 27-29cm

24 February 2006

2006-35-48

02/45

EU. G + H

→ LOT 25

• Going down further to uncover rocks in structure. Finding rocks underneath the others and extending toward my flatter rocks

• Lots of rocks in my west facing edge - especially in unit H - not sure if it is tumble as they are fairly nicely stacked.

• Soil is silty clay (uniform & inclusion-free) in a lighter brown w/ flecks of yellow

• Finding very little cultural material - some pottery

*Stepped into unit F & took a rock out of the side edge (west facing)

Summary:

Findings:

34 pieces of pottery

3 pieces bajareave

1 piece chert?

Elevations:

(taken again from unit H's SE corner)

BGS: 29-39 cm

Soil: yellowy brown silty clay

24 February 2006

2006-35-49

02/45

EU. G

→ LOT 26

• excavating 1/2 of unit G to see what is in front of the terrace and if it goes down further.

• Found one rock

• Elevations at the southern most end of my trench remained the same as it was initially in the first lot in UNIT G → lot 22

∴ SW 15cm + SE 23cm

• Rocks don't appear to have another support layer beneath

Summary

Findings: 2 pieces of obsidian
7 pieces of ceramic
1/2 piece of Lajarcave
1 piece of matate

BAS = 220 - 38cm

SE 42cm

SW ~~34~~ 39cm

Bags: 2

27 February 2006
02/45

2006-35-50

Diary: We're doing two units at a time today and got an extra worker each. Mines name is Serafin. It's hot + sunny again today - Got my official Elevations ∴ new units will have final elevations + will do math later for the others.

EU. E

⇒ Lot 27

- Went back to EU. E to go down to floor surface. Will hopefully eventually make up to where I think my wall is in unit #.

- Taking out lots of soil + some tumble rocks. - all soil after first couple tumble rocks

- Finding bajareque - seems somewhat more abundant in this lot, however this a big lot. We aren't finding ~~any~~ any more rocks - the bajareque might suggest that there was a building (organic) here.

- Also finding some pottery - ~~not large~~ ^{fairly large} amount ~~but~~ ^{but} most pieces are small - medium sized → it is a big lot however

- Went through my floor - again! Ah.

Even though it is clearly visible in cross section.

Frustrating, but I'll make sure they stop in the next unit - fortunately no features here.

27 February 2006

2006-35-51

→ LOT 27 continued...

Summary:

BGS Elevations: BGS ~~32~~ 32-63cm
NW 66cm BGS NE 70cm^{BGS} SW 56cm^{BGS} SE 65cm^{BGS}

~~Findings: obsidian (6), ceramic (65), bajareque
bags - chert (2), tobacco (2)~~

Findings:

165 - Ceramic, 1 - obsidian, 55 - bajareque, 2 tobacco

EU. Q

→ LOT 28

• Starting at southernmost point
~~and~~ unit of my trench - EU. Q.
Hoping to eventually find N. Plaza
floor.

- Going down ≈ 10cm through topsoil
although new guy: Enemias are working
there so this could be interesting
- Workers actually doing really well! yes!
- basic stuff → topsoil humus, some ceramic

Summary =

Elevation: BGS: 0-10cm

6 pieces of ceramic, 2 pieces of chert

Ending elevations:

BGS - 1

NW 999.10

NE 999.08

SW 999.15

SE 999.14

27 February, 2006

2006-35-52

02/45

EU. Q

⇒ LOT 29

- Going down another 10cm
- Finding ceramic
- Soil is still silty clay - less organic now and turning a med. brown.

Following the pattern of deposition from the rest of the units.

However - oddly large pebble inclusions at about 1-5% composition. Very rounded (and between 5-10cm long each) almost look like perfect skipping stones - river deposit?

- Finding flat stones @ \approx 1cm \rightarrow maybe my floor already. - uncovering them + cleaning up

Summary

Findings - 74 pieces of ceramic (2 large)
3 ~~large~~ chunks of baroque
1 carbon sample
4 pieces of obsidian

Elevations: $\text{BGS: } 10-20\text{bgs}$

NW ^{25bgs}	NE ^{22bgs}	SW ^{18bgs}	SE ^{18bgs}
998.95	998.96	999.07	999.08

27 February 2006

2006-35-53

02/45

EU-P

→ LOT 30

- taking topsoil off my next unit to see if my floor continues
- Lots of roots → could have damaged floor
- found a couple small pieces of ceramic and one tiny piece of obsidian so far
- did not finish today -
will finish tomorrow.

28 February 2006

2006-35-54

02/45

EU. P

→ LOT 30 continued

With the incline of slope on my trench, this lot (measuring w/ line level) seems to be going deeper than the 1st lot of Q - we may find floor.

Summary:

Final Elevations: NW 999.15 NE 999.14 SW 999.11 SE 999.17

Bags: 0 20cm

Findings: 63 ceramic, (1) obsidian

Bags: 1

Diary: Raining lightly and overcast today. working for now with tarps up. Wanted to protect my earlier notes so they wouldn't get wet and left most at home - realizing now I need them as I move through earlier units. will have to look up elevations + prev. lot # later. Jorge doesn't seem to like going through the bigger lots + is hacking quite freely at them with what looks like a ~~pick~~ pick axe (sp?) - hopefully he won't destroy anything (although I realize w/o rain the silty clay had become quite hard + there may be no other way to do it.).

28 February 2006

2006-35-55

02/45

EV. F

* → LOT 31

- Continuing in EV. F down to the floor surface - if I have a wall in my trench it will start at that level ∴ moving through units @ this level.

- BGS is about ~~50~~ 50cm (ish) → w/o old notes I don't have exact (will fill in tonight)

- Finding lots of ceramic although less than yesterday. Also Guatemalan cloudy obsidian → suggesting different trade networks than the Paraiso site.

- found some carbon, but from different locations in the lot + in small quantities.

- found bajareque but noticeably less than in the unit before (E, lot 27)

Summary:

BGS: $\pm 50 - 68$ cm

Elevations

NW: 61 cm

NE 68 cm

SW 60 cm

SE 62 cm

Findings: 10 pieces ceramic, 5 obsidian (2 Guat.)
11 bajareque, 1 toba + carbon sample

Bags: 2

28 February 2006

2006-35-56

02/45

EU.P

⇒ LOT 32

- Continue digging down from B&S 20cm to uncover continuation of N-Plaza floor
- Found it.

- Soil - uniform (no inclusions) med brown silty clay

Findings - 25 pieces of ceramic

Elevations = B&S = 20-30cm

^{B&S}	NW 18cm	NE 19cm	SW 22cm	SE 30cm
^{Final}	999.07	999.05	999.09	999.07

→ Taking photos of this + connecting floor in unit Q lot 29.

28 February 2006

2006-35-59

02/45

EV. 6

★ ⇒ LOT 33

- Only excavating in front of potential floor/wall. ~~100~~ 35 x 100cm.
- BGS is about 44cm → going down to earthen floor level
- The rest of unit & looks like the top of a terrace so leaving as is for now
- Rocks under the terrace → wall!
- Wall is jagged and looks fairly damaged but the rocks are clearly stacked and flat laying.

Summary:

BGS: $\approx 44 - 74$ cm

Elevations: NW — NE — SW 64 SE 74cm

(Only 1/3 of Unit excavated)

Findings

22 pieces of ceramic

1 piece biface, 1 piece to be

bags. 2

28 February 2006

2006-35-58

02/45

EV. 0

→ LOT 34

• Went all the way down to floor surface - despite me telling them to only do topsoil again! I forgive them though because most of the lot is taken up by a huge tree stump.

• They hack at the stump for a long time - I collect the clippings for bonfire night!

• Floor level continues throughout this lot

Findings - ceramic⁽⁷⁸⁾ + obsidian⁽²⁾, (1) tobacco

Elevations - BGS = 0-24

NW 20cm N (stump) SW 22cm SE 24cm^{BGS}
30cm (near stump)

28 February 2006

02/45

EU. F

2006-35-59

→ ADD
Unit B

B45 = 45-50cm more than last
Unit

→ LOT 35

- Going through floor level to see
if there is an extension of the wall
beneath and to even out the trench.

• found ceramics + bone!
associated together → possibly pre-
classic rim?

• Finding carbon around the same
area → def. not as associated (a little higher
up + to the East + West)

18 ceramics

6 obsidian

2 chert

bone

9 Lajaveque

Carbon

→ Finish tomorrow

1 March 2006

~~29 February 2006~~

2006-35-60

02145

EU. F

→ LOT 35 continued...

- really big piece of lapador found under one of my tumble/fill rocks.

• today we find ← 97 pieces of ceramic, 8 bajareque w/glyphs!!
3 obsidian

Summary:

Findings = 175 pieces of ceramic, 17 bajareque, 9 obsidian, 2 chert, bone & carbon

Bags: 68 - 73 cm

Elevations:

NW 73 cm	NE 81 cm	SW 07 cm	SE 70 cm
999.35	999.31	999.31	999.27

Bags: 3

* Diary - Cool and partly cloudy when we start work at 7:30 am → going to be hot later I think. I'm feeling a little sleep deprived which might make working w/ my 2 simultaneous units even more stressful today.

1 March 2006

~~29 February 2006~~

2006-35-61

02145

EU.N

→ LOT 36

• Taking topsoil off next unit. floor may continue, but I see what looks like tumble rocks in the cross section, so possibly starting up on the structure.

Summary:

Findings - 2 pieces of ceramic
2 pieces of bajareque
1 obsidian

Elevations: BGS - 0-10cm

NW 9cm

NE 8cm

SW 10cm

SE 10cm

1 March 2006

~~29 February 2006~~

2006-35-62

02/45

EV. N

→ LOT 37

• Continuing down to the floor level to see if it has ended yet, look at possible tumble + ~~loose~~ get closer to my building

• Tumble over top of floor surface

• removed tumble rocks (~~about 10-20~~ ~~cm~~ ~~long~~)
about 6-20-30cm long)

• Exposed continuation of north Plaza floor (now 4 units) ~~at 20-30cm~~

Summary:

Findings: ceramic (99), chert (3) Bags-1
obsidian (2) bajanque (2) toba (2)

Elevations: 10-36cm

NW 28cm NE 25 SW 36cm SE 31

Soil:

Soil - med. brown silty clay

1 March 2006

~~29 February 2006~~

2006-35-63

02/45

EU. 9

→ LOT 38

- Cleaning up wall and removing rocks
- BGS - 74-82cm
- * Remember to take photo when finished.
- found small amounts of carbon among stones + on floor - very small. ~~not~~ collected one representative sample of the carbon in the lot.

Summary:

Elevations in BGS: SE 82 SW 75; BGS 74-82cm

Findings - ceramic (7), carbon, tobacco (1),
Obsidian

1 March 2006

~~29 February 2006~~

2006-35-64

02/45

EU.M

→ LOT 39

• moving up a unit again to get closer to my building + follow plaza floor

- Large Stump in this unit
- Lots of tumble

Summary:

Elevations: BGS: 0.25 bags 1

NW 24 cm NE 19 cm SW 25 cm SE 25 cm

Findings - 2 obsidian, 1 chert, 29 ceramic
Soil - overburden ~~tumus~~. dark grey brown silty clay.

EU.M

→ LOT 40

- taking out tumble
- Finding more plaza floor

Summary:

Findings: 21 ceramic, 2 toba, 3 lithics (chert 2)
1 obsidian

Soil - med brown silty clay

Elevations - BGS 25-48

NW 39 cm NE 34 cm SW 47 cm SE 48 cm
999.20 999.19 999.30 999.25

1 March 2006

~~29 February 2006~~

2006-35-65

02/45

EVIL

→ LOT 41

~~EVIL~~

- Topsoil off in the next cart
- Finding more tumble. I assume proximity to a possible wall like Wileyda's (sub op 44)

Summary:

Findings: ceramic (24), obsidian, (2),
bajareque (1)

Soil - silty clay humus - dark grey brown
→ following pattern in whole trench.

Elevations: BGS 0-28cm

NW 17cm	NE 11cm	SW 28cm	SE 19cm
999.60	999.62	999.77	999.77

Elevations are closest to corners considering
tumble rock obstructions.

March 2006

2006-35-66

Diary: overcast today, will most likely clear up later. Took photos of the units I've finished for now - G, O, N + M. Wileyda ~~for~~ is working on her last unit - between her walls is pure fill (hint if mine is same building).

* Realized "Initial" Elevations on lot forms means the actual start and not the finals for the previous lot → from now on writing actual initial elevations.

02/45
EU. L

→ LOT 42

- Taking out tumble to expose wall and go down to floor surface
- took section in 2 parts: halfway down finding more stones - could be tumble or partially destroyed step.
- found a bent, rusty nail → mixed context?

Summary:

Findings: 24 pieces of ceramic, 3 bajareque
1 obsidian, 2 chert, 1 rusty nail

Elevations: BG S 28-52cm

NW 32cm NE 27cm SW 52cm SE 38cm

Soil: silty clay, med. brown

2 March 2006

2006-35-67

02/45

EU. K

→ 43

- Moving up to see if I can uncover a terrace connected to my wall → I'm assuming symmetrical building
- Going through topsoil, same as the rest of the trench silty clay dark greyish brown
- lots of root ~~in~~ obstructions
- Uncovering mostly tumble rocks

Findings: ceramic-S3, obsidian-2

Elevations: BGS: 0-23cm top of rock
NW 20cm NE ~~20~~ 9cm SW 8cm SE 23cm

Bags: 1

Soil: overburden topsoil; silty clay dark grey brown

March 2006

2006-35-68

02/45

Unit L

→ LOT 44

• Going down to floor surface to see if there are rocks beneath possible step. If not, it's tumble.

• took out tumble rocks in front to expose a shallow wall/step up.

Summary:

Findings - 48 pieces of ceramic
1 obsidian
1 chert

Elevations - ~~BE~~ S - 52-55

NW 48

NE 52

SW 47

SE 38

Soil - remains silty clay, med brown, as in the rest of this side of the trench, uniform w/ no inclusions. Slight yellowy tinge (could be sun affecting color perception)

2 March 2006

2006-35-69

02/45

Unit J

→ LOT 45

- uncovering more of the same tumble from unit K → eventually will hopefully uncover a terrace surface

- May have a floor → started taking some obvious tumble out

Summary

Findings: ceramic-61

Elevations: B&S - 0-30
NW 12cm NE 30 SW 24 SE 14cm

2 March 2006

2006-35-70

02/45

EU. I

→ LOT 46

* Same as units K+J, excavating dirt without removing tumble to expose the whole top of Str. 09.

* Same as unit J, took out obvious tumble

Summary:

Findings: ceramic -30

Elevations: BGS - 0 - 24cm
NW 24 NE 14cm SW ^{10cm} ~~10cm~~ SE 10cm
(rock) (rock)

* Remember to fix lot L, etc. initial elevations

3 March 2006

2006-35-71

02/45

Diary: took photos of units M, L, K, J, I. Realized I made it leap year in my notes → 29 Feb, should be 1 Mar. Photos still have incorrect dates, but lot forms + notes fixed.

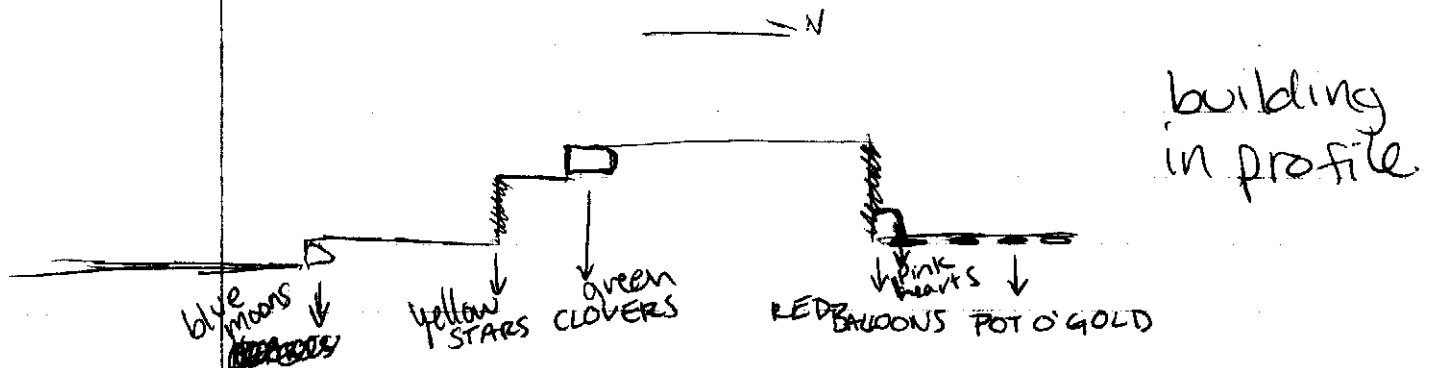

Starting to name features and final notes drawing today. Also removing stumps in units O & M. Will mark as cleaning lots if anything is found.

EU.O
→ LOT ~~46~~ 47

· cleaning lot → taking out stump found ceramics + a cool lithic thing → axe head? green stone alba

7 - March 2006
02/45

200635 - 72

Diary - Spent today + yesterday working on drawing the section of my trench and looking at soil. Yesterday was overcast and today was partially sunny → ~~o~~ munsell somewhat difficult.

Final notes:

EV. A

Started at the southernmost end of my trench. Measuring BGS in each corner and subtracting from initial elevations once I received them. As with all of my units I started out taking out topsoil and moved in 10cm increments to discover soil changes (as this was my first unit). Hit an ~~ea~~ earth floor at about 45cm BGS and went through another 5cm through (40-50cm BGS lot) the empty lot to make sure it was my floor. Soil throughout is silty clay with three color changes - humus is dark greyish brown, next deposit is dark brown and floor is dark yellowish brown. In the first three lots (1, 2 & 3) found ceramics, obsidian, ~~to~~ and a couple carbon samples

7 March 2006

2006-35-73

02/45

Final notes

EU. B

Took unit in ~~five~~ lots (5, 6, 7, ~~8, 9~~) following soil change - ~~dark~~ brown silty clay in 2 lots because I originally thought one section had more inclusions, looking at cross section, it is all uniform. Digging down to floor level to follow it in and find something structural. Soil divisions remained the same with dark greyish brown silty clay topsoil extending about 10-20cm on average BGS. Dark brown silty clay extends about from 20-40cm BGS and the silty clay dark yellowish brown floor extending about 40 or 45cm to 50cm BGS. My workers continually go through part of my floor despite its visibility in cross section - we go 5cm through the floor in lot 9 (40-45cm BGS) and find a potentially pre-classic piece of ceramic. Other findings in this unit include late classic ceramic, carbon, obsidian, chert, bajareque and a potential pre-classic rim in lot 7 (20-30cm BGS) as well.

7 March 2006

2006-35-74

02/45

Final notes

EU.C; lots 10, 11, 12 & 13

Continued down to floor level again to follow it to my structure. Encountered some tumble in lot 11 and assumed proximity to something structural. In lot 12 I found what I thought to be a wall. I cleared it of tumble and dug into the floor a little in lot 13 to see how deep the "wall" extended. It was only one course of rocks deep (however it continued into EU.D to 2 courses of rocks wide - see EU.D for name). Soil deposition stayed the same in this unit w/ three slight color changes and fairly well sorted, predominately inclusion free silty clay. Total BGS was 0-50cm for the unit and findings included ceramic, obsidian, carbon, chert, & bajareque.

7 March 2006

2006-85-75

02/45

Final notes

EU.D

lots 14, 15 & 16

Exposed the 2nd course of rocks in my basal "wall" at floor level. With no rocks behind or beneath these 2 rows, and more earth floor extending to the north in the unit, I assume these rocks are more of a step or threshold. I name it "**BLUE MOONS**". Final depth of this unit is roughly 999.20. Silty clay, dark yellowish brown between rocks in BLUE MOONS (support my idea of a threshold) and following the same depositional colors from units A, B & C.

EU.E

LOTS 17, 18, 27

Followed continuation of earth floor after BLUE MOONS. Took out some fairly large pieces of tumble in lot 17 & 18 - assume proximity to something structural. Found 55 pieces of bajreqve which makes me think there was an organic structure associated with the stone part of the structure.

Diary: Sunny day. Final notes. Final photos.

8 March 2006

2006-35-76

02/45

Final notes

EU. F

Lots 19, 20, 21, 31, 35

Following floor level yet again. Finding lots of tumble and ~~exposed~~ the front of my YELLOW STARS wall. Cleaned YELLOW STARS and removed out of place rocks; wall still damaged looking. Found rocks at the same height as YELLOW STARS in section, very possible that YELLOW STARS used to be more than one course long and what is now left is fill → making it a short terrace and clean wall that has since collapsed. Interesting finds included Bone and ceramic in lot 35 and possible pre-classic pottery & cloudy Guatemalan obsidian in lot 31. Soil changes stay the same up to the wall (possible flaw in my terrace theory) but could mean floor is earliest.

8 March 2006

2006-35-77

02/45

Final notes.

EU. G

lots 22, 26, 24, 25, ~~26~~, 33, 38

Exposed YELLOW STARS completely with the very top rocks beginning a 116cm long terrace (only exposed to the end of unit G at this point, when combined w/ unit H discovered the terrace continued a little further before leading to my next feature). After YELLOW STARS, yellowish brown soil disappears leaving dark greyish brown topsoil and a dark brown deposit underneath (same pattern as before). Found ceramic, obsidian, bajareque, chert, uncaned toba, carbon in lot 38 and a piece of amatate in lot 26.

EU. H

lots 23, 24, 25

Combined with unit G for some lots. Exposed last bit of terrace off of YELLOW STARS and uncovered a small step up to the summit of my structure - GREEN CLOVERS. First 2 rocks in this wall are perfectly aligned with each other w/ the last one jutting out (25cm to south) and being exceptionally large (2x as big as the rocks it is in line w/ and 2nd biggest in my structure). Summit behind GREEN CLOVERS seems composed predominately of tumble or fill cobbles.

8 March 2006

2006-35-78

02/45

Final notes

EU. I

lots 46

~~EU~~ Uncovering more of the structures
Summit I began exposing in unit H. Rocks are very close to the surface and it only takes me one lot to clear as much as possible without removing rocks extensively. Very hard to see soil changes in such a small section with so many obstructions (also true for the rest of the Summit ~~at~~ units J, K). Rocks are large and jumbled - too high to be tumble, so I assume fill. It is clear this structure is very damaged. Only finds are ceramic sherds.

EU. J

lots 45

Very similar to EU. I. Exposing the very top of str. 09 by taking out sediment. Rocks appear to be fill or collapse still. Only finds ~~are~~, like EU. I, ceramics. Still hard to see soil changes (captured best I could in section drawing) and measuring these units is difficult due to all the obstructions. Went down roughly 30cm Bas

8 March 2006

2006-35-79

02/45

Final notes

EU. K

Lots 43

Continuation of str. 09 summit fill - pretty much exactly the same as EU's I+J.

At Northernmost end of the Unit we uncover the very top of a wall (that extends ^{into} and develops more when excavating Unit L) that I name RED BALLOONS.

In this unit I find more ceramic and two pieces of obsidian. We dug to approximately 23cm BGS.

EU. L

Lots 41, 42, 44

Uncover tumble in lot 41 - coming up to some new feature and the end of the summit. RED BALLOONS wall becomes more clear and defined. Further in to the unit (to North) I uncover a "step" also arguably part of RED BALLOONS. This step has clearly aligned rocks on the same level directly underneath and out from my wall, so I feel it is possibly a separate feature. I name it PINK HEARTS. Finding ceramics, obsidian, chert and a very little bit of bajareque. Also find what appears to be a rusty metal nail in lot 42 - implies mixed context? At the base of the

8 March 2006

2006-35-80

02/45

Final notes

EU. L continued...

unit I find the North Plaza floor, known as POT O' GOLD. With the cobble stone floor also comes my IV soil type. Depositional layers are still Dark grey brown humus to dark brown, but between cobbles in the floor soil is dark yellowish brown (all three are silty clay still) - color in floor is very similar to the earth floor in units A-F, however elevations and context are different enough to classify them as separate soils (POT O' GOLD is at a higher elevation and is more developed - as it has cobbles - so I will assume it is younger)

EU. M

lots 39+40

Digging down to POT O' GOLD - difficult due to a large tree stump in this unit. Encountered more tumble here (most likely from RED BALLOONS or PINK HEARTS). Dark greyish brown humus fades out in this unit and dark brown sediment becomes top deposit. Dark yellowish brown soil still between cobbles in POT O' GOLD which I find at approximately 48cm BGS. Found ceramics, obsidian, chert, and 2 small pieces of uncarved toba.

8 March 2006

2006-35-81

02/45

Final notes

EU. N

lots 36 + 37

Very clearly only 2 soils in this lot (and continuing to the end of the trench) with everything above the floor being dark brown silty clay and the floor soil remaining dark yellowish brown. POT O' GOLD found at roughly 36cm BGS. Lots of ceramics found along with obsidian, chert and a very little bit of bajareque & toba.

EU. O

lots 34 + 47 (cleaning lot)

Took unit in one lot down to floor - POT O' GOLD - level. Difficult because, like unit M, there is a large tree stump obstructing much of the unit. Stump completely removed in cleaning lot 47 and found 5 pieces of ceramic and a green stone acha head (found nothing like this in the rest of my trench). POT O' GOLD reached at 24cm BGS. Findings included ceramic, obsidian & Toba.

8 March 2006

2006-35-82

02/45

Final notes

EU.P

lots 30+32

Took unit in two lots and reached POT O' GOLD at roughly 30cm BGS. Only found ceramics and one tiny piece of obsidian.

EU.Q

lots 28+29

Took unit in two lots and reached POT O' GOLD at roughly 20cm. Found usual ceramics, obsidian, chert along w/ 2⁺ large chunks of bajareque and a carbon sample. This unit is also unique because it had about 2% 1-5% composition of river pebbles (5-10cm in length) which made it different than the rest of my above POT O' GOLD units - "inclusions" not visible in cross section however (strange). Because I also found the North Plaza floor in my test pit (02/36) I'm realizing the vast extent of this floor which must have been impressive. ~~despite the surrounding area~~

8 March 2006

2006-35-83

02/45

Final notes

Interpretations:

My earthen floor goes up to the level of my BLUE MOONS rocks in cross-section therefore I feel it was a threshold as opposed to an elevated step or wall. I also think that my earthen floor is the oldest part of this structure because it is the most basic "construction" and is at the lowest elevation. I believe that the earthen floor continued as it is exposed today after BLUE MOONS and there may have been an organic structure somewhere between BLUE MOONS and my next wall, YELLOW STARS. This is due to the large amounts of bajareque found in Unit E. Because I think the earthen floor is the earliest part of Structure 09, any organic construction could potentially be from any phase of occupation, however I would speculate that it ~~is~~^{could} be early. The next wall (moving South to North) is YELLOW STARS. I think, due to the condition of this wall, that it in fact is only the very top of a terrace that extended southward and cut off further down in a cleaner looking wall - YELLOW STARS as it is now has many tilting and jutting out rocks that look more like fill for a terrace than a convincing wall. I also see evidence for this terrace theory in aligning flat rocks in my cross section (Unit F) and the fact that I found tumble in previous units. My next "step up"

8 March 2006

2006-35-84

02/45

Final notes

Interpretation continued...

is at GREEN CLOVERS, however the terrace that starts at YELLOW STARS seems to go under GREEN CLOVERS, which makes me speculate that the terrace off of YELLOW STARS continued and was the "old summit" of this building. Therefore GREEN CLOVERS would be part of a later addition to give height to the structure and the jumbled rocks in units H, I, J, K would be part of the fill of a terrace that no longer exists (possibly taken out to help form the chimneys that sat between my sub-op and sub-op 44 - also on str. 09). On the northern end of the summit the building comes down in two steps - which I've named RED BALLOONS and PINK HEARTS. While currently PINK HEARTS abut RED BALLOONS perfectly like a step, it is very possible that tumble fell off the top of PINK HEARTS to make it look like a step where it could have been a multi-course wall w/ RED BALLOONS originally. This is most likely the case since rocks have fallen in both directions - behind PINK HEARTS against RED BALLOONS ^(to South) as well as off the front of PINK HEARTS ^(to North). The North Plaza floor meet directly up with structure 09 beneath PINK HEARTS. In my trench I have named

8 March 2006

2006-35-85

02/45

Final notes

Interpretation continued...

the plaza floor POT O'GOLD and it extends until the end of my trench through all remaining units (L, M, N, O, P & Q). Because I found the same floor in my test pit 02/36, I can estimate the extent of the Plaza floor in the Northern region of the site and it extends the width of the site. Since it is thought that people entered El Cafetal (S-002) from the North, Str. 09 would have been one of the first ~~things~~ things people saw - in fact it would be somewhat blocking their way into the rest of the site. I speculate that Str. 09 would have been a place to monitor + welcome those who entered the site. Its placement within the site forces people into more narrow entryways - similar to crowd control. The structure itself is strange - having no evidence of an actual building (terraces leading to terraces) and while it appears to be aligned with Str. 08, that building faces South and has no clear connection to mine.

8 March 2006

2006-35-86

02/45

Final notes

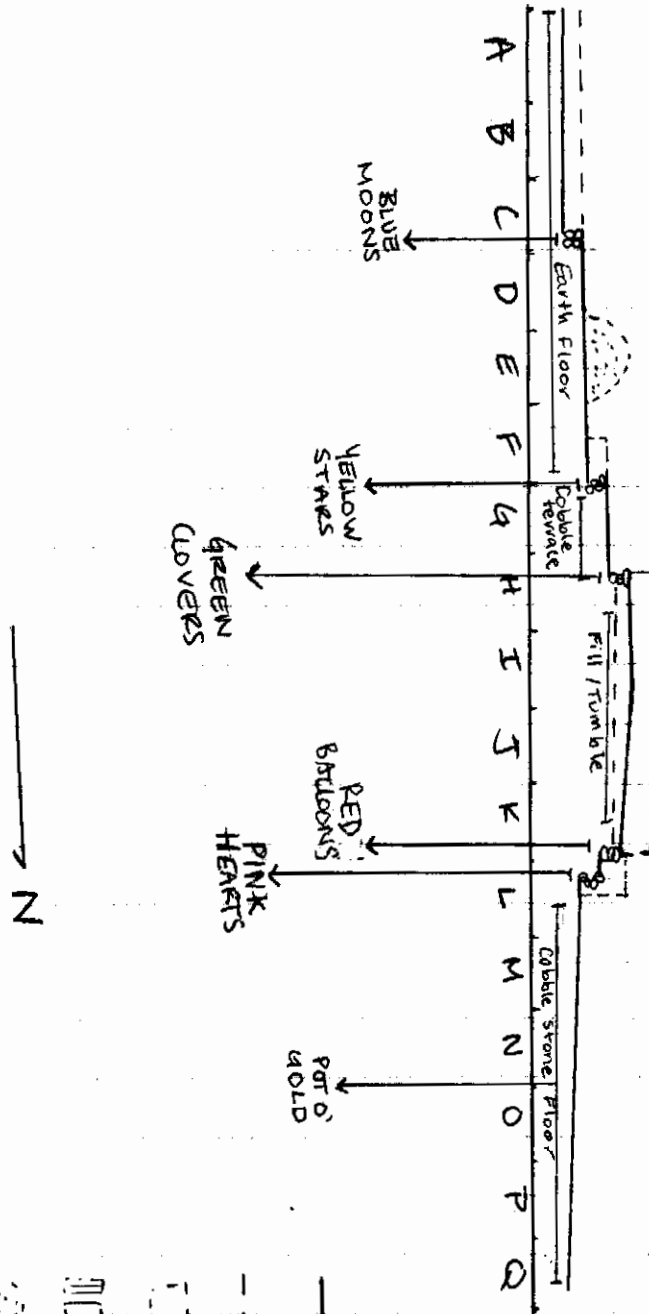

- = current
- - - - - = theory
- - - - - = rock
- ▢ = earth
- ⊙ = organic construction (see previous)

8 March 2006

02/45

Final notes

name	largest rock	smallest rock	modal size	rock form	material type
Blue moons	27x22x08	14x19x04	18x18x08	Somewhat rounded	6-cobbles 2-sedimentary
Yellow stars	24x20x13	13x15x5	16x19x9	Somewhat angular	5-cobbles 6-sedimentary
green clavers	50x28x27	20x17x8	36x24x20	Somewhat angular	2-cobbles 2-sedimentary
Red balloons	22x32x12	10x10x4	14x22x13	Somewhat angular	9-cobbles 1-sedimentary
Pink hearts	36x30x6	17x6x10	28x18x5	Somewhat rounded	5-cobbles 1-sedimentary
pot o' gold	27x26x7	8x4	21x25	Somewhat rounded	7-cobbles 5-sedimentary

2006-35-87

rock chart

Ⓢ height = in ground

8 March 2006
02/145 Final notes

Feature CV

2006-35-RR

unit name	length	width	weight	alignment	courses	top measure	bottom measure
Blue moons	60cm	1 meter	20cm	10° NE	2	39cm ^{Bas}	57cm ^{Bas}
yellow stars	~70cm	1 meter	58cm	10° NE	1	38cm ^{Bas}	95cm ^{cm}
green clovers	~74cm	1 meter	42cm	355° NW	1 (well defined)	15cm ^{Bas}	53cm ^{Bas}
Red Balloons	~40cm	1 meter	39cm	6° NE	1 (well defined)	30cm ^{Bas}	55cm ^{Bas}
Pink hearts	~61cm	1 meter	40cm	12° NE	1 (well defined)	29cm ^{Bas}	74cm ^{Bas}
Pot o' gold	550cm	1 meter	~8cm	12° NE 4° NE	~19	54cm ^{Bas}	17cm ^{Bas}

↓ inground cross

↓ deepest shallowest point ^{Bas}

37 Associated points

Kate

Date	Feature	Class	Sub-class	#	Description	North	East	Elev
2006-02-24	Archaeology	Trench corner		134	02/45 A SW	72.46	2.32	999.35
2006-02-24	Archaeology	Trench corner		135	02/45 B SW	73.46	2.41	999.48
2006-02-24	Archaeology	Trench corner		136	02/45 C SW	74.32	2.58	999.53
2006-02-24	Archaeology	Trench corner		137	02/45 D SW	75.46	2.68	999.65
2006-02-24	Archaeology	Trench corner		138	02/45 E SW	76.40	2.75	999.76
2006-02-24	Archaeology	Trench corner		139	02/45 F SW	77.39	2.85	999.93
2006-02-24	Archaeology	Trench corner		140	02/45 G SW	78.37	2.96	1,000.08
2006-02-24	Archaeology	Trench corner		141	02/45 H SW	79.36	3.08	1,000.19
2006-02-24	Archaeology	Trench corner		142	02/45 Q SW	80.35	3.15	1,000.28
2006-02-24	Archaeology	Trench corner		143	02/45 I SW	80.35	3.15	1,000.28
2006-02-24	Archaeology	Trench corner		144	02/45 J SW	81.28	3.30	1,000.34
2006-02-24	Archaeology	Trench corner		145	02/45 K SW	82.26	3.38	1,000.21
2006-02-24	Archaeology	Trench corner		146	02/45 L SW	83.29	3.43	1,000.05
2006-02-24	Archaeology	Trench corner		147	02/45 M SW	84.29	3.50	999.77
2006-02-24	Archaeology	Trench corner		148	02/45 N SW	85.35	3.60	999.59
2006-02-24	Archaeology	Trench corner		149	02/45 O SW	86.28	3.66	999.44
2006-02-24	Archaeology	Trench corner		150	02/45 P SW	87.33	3.76	999.31
2006-02-24	Archaeology	Trench corner		151	02/45 SW Q	88.26	3.81	999.25
2006-02-24	Archaeology	Trench corner		152	02/45 O NW	89.28	3.86	999.20
2006-02-24	Archaeology	Trench corner		153	02/45 Q NE	89.23	4.90	999.18
2006-02-24	Archaeology	Trench corner		154	02/45 Q SE	88.27	4.81	999.24
2006-02-24	Archaeology	Trench corner		155	02/45 P SE	87.26	4.76	999.37
2006-02-24	Archaeology	Trench corner		156	02/45 O SE	86.26	4.71	999.43
2006-02-24	Archaeology	Trench corner		157	02/45 N SE	85.28	4.59	999.53
2006-02-24	Archaeology	Trench corner		158	02/45 M SE	84.30	4.50	999.73
2006-02-24	Archaeology	Trench corner		159	02/45 L SE	83.29	4.41	999.96
2006-02-24	Archaeology	Trench corner		160	02/45 K SE	82.32	4.34	1,000.24
2006-02-24	Archaeology	Trench corner		161	02/45 J SE	81.30	4.23	1,000.29
2006-02-24	Archaeology	Trench corner		162	02/45 I SE	80.20	4.15	1,000.29
2006-02-24	Archaeology	Trench corner		163	02/45 H SE	79.30	4.05	1,000.20
2006-02-24	Archaeology	Trench corner		164	02/45 G SE	78.30	3.97	1,000.12
2006-02-24	Archaeology	Trench corner		165	02/45 F SE	77.34	3.90	999.97
2006-02-24	Archaeology	Trench corner		166	02/45 E SE	76.32	3.78	999.81
2006-02-24	Archaeology	Trench corner		167	02/45 D SE	75.31	3.63	999.76
2006-02-24	Archaeology	Trench corner		168	02/45 C SE	74.37	3.61	999.56

999.18 999.24 999.34

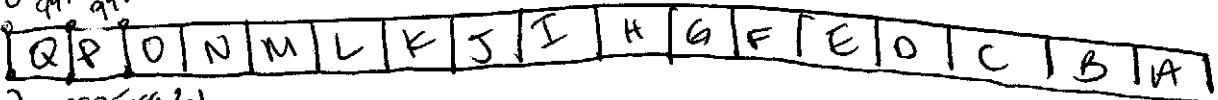

999.2 999.35 999.51

37 Associated points

Date	Feature	Class	Sub-class	#	Description	North	East	Elev
2006-02-24	Archaeology	Trench corner	B SE	169	02/45	73.34	3.50	999.46
2006-02-24	Archaeology	Trench corner	A SE	170	02/45	72.38	3.35	999.41

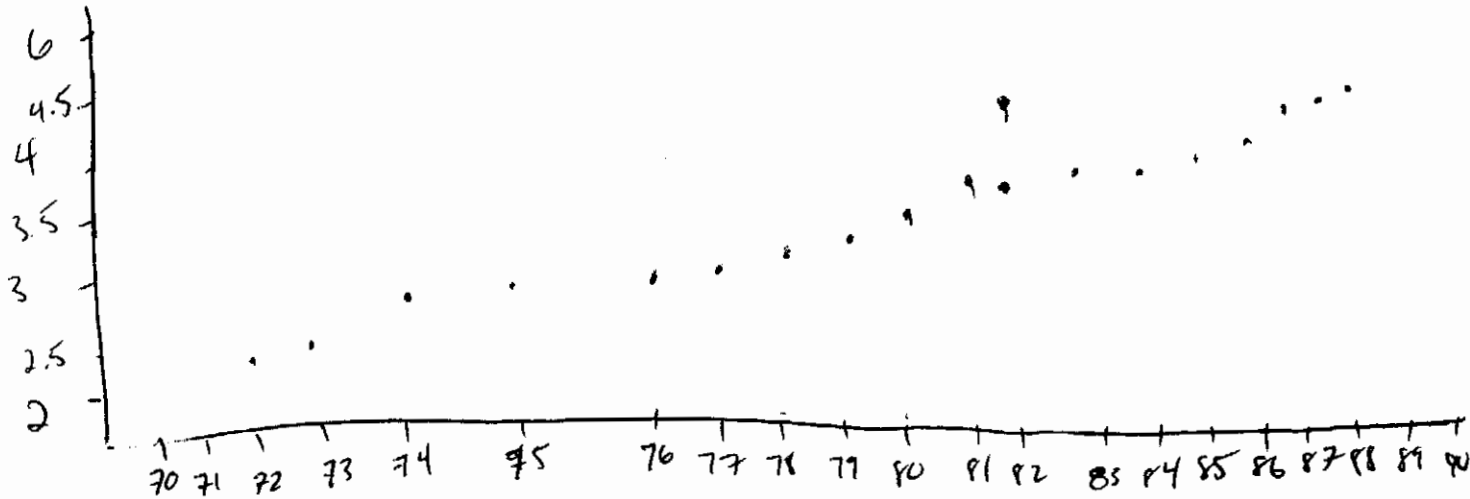

22 Associated points

<i>Date</i>	<i>Feature</i>	<i>Class</i>	<i>Sub-class</i>	<i>#</i>	<i>Description</i>	<i>North</i>	<i>East</i>	<i>Elev</i>
2006-02-05	Archaeology	Trench corner	SW	01	02/26 - Allie	-10.00	28.00	1,000.55
2006-02-05	Archaeology	Trench corner	SE	02	02/26 - Allie	-10.00	29.00	1,000.64
2006-02-05	Archaeology	Trench corner	NE	03	02/27 - Edwin	13.00	-47.00	999.21
2006-02-05	Archaeology	Trench corner	NW	04	02/27 - Edwin	13.00	-48.00	999.22
2006-02-05	Archaeology	Trench corner	NE	05	02/28 - Whitney	35.00	-39.00	999.30
2006-02-05	Archaeology	Trench corner	NW	06	02/28 - Whitney	35.00	-40.00	999.31
2006-02-05	Archaeology	Trench corner	SE	07	02/29 - Thomas	24.00	-7.00	999.80
2006-02-05	Archaeology	Trench corner	SW	08	02/29 - Thomas	24.00	-8.00	999.80
2006-02-05	Archaeology	Trench corner	NW	12	02/30 - John C.	36.00	17.00	999.99
2006-02-05	Archaeology	Trench corner	NE	11	02/30 - John C.	36.00	18.00	999.99
2006-02-05	Archaeology	Trench corner	NW	13	02/31 - Jon P.	48.00	44.00	999.82
2006-02-05	Archaeology	Trench corner	NE	14	02/31 - Jon P.	48.00	45.00	999.84
2006-02-05	Archaeology	Trench corner	NE	15	02/32 - Wileyda	57.00	37.00	999.59
2006-02-05	Archaeology	Trench corner	NW	16	02/32 - Wileyda	57.00	36.00	999.56
2006-02-05	Archaeology	Trench corner	NW	10	02/33 - Cori	59.00	-17.00	999.24
2006-02-05	Archaeology	Trench corner	NE	09	02/33 - Cori	59.00	-16.00	999.27
2006-02-05	Archaeology	Trench corner	NW	17	02/34 - Rocki	69.00	14.00	999.30
2006-02-05	Archaeology	Trench corner	NE	18	02/34 - Rocki	69.00	15.00	999.28
2006-02-05	Archaeology	Trench corner	NW	19	02/35 - Erlend	84.00	31.00	999.32
2006-02-05	Archaeology	Trench corner	NE	20	02/35 - Erlend	84.00	32.00	999.36
2006-02-05	Archaeology	Trench corner	NW	21	02/36 - Kate	97.00	24.00	999.02
2006-02-05	Archaeology	Trench corner	NE	22	02/36 - Kate	97.00	25.00	999.07

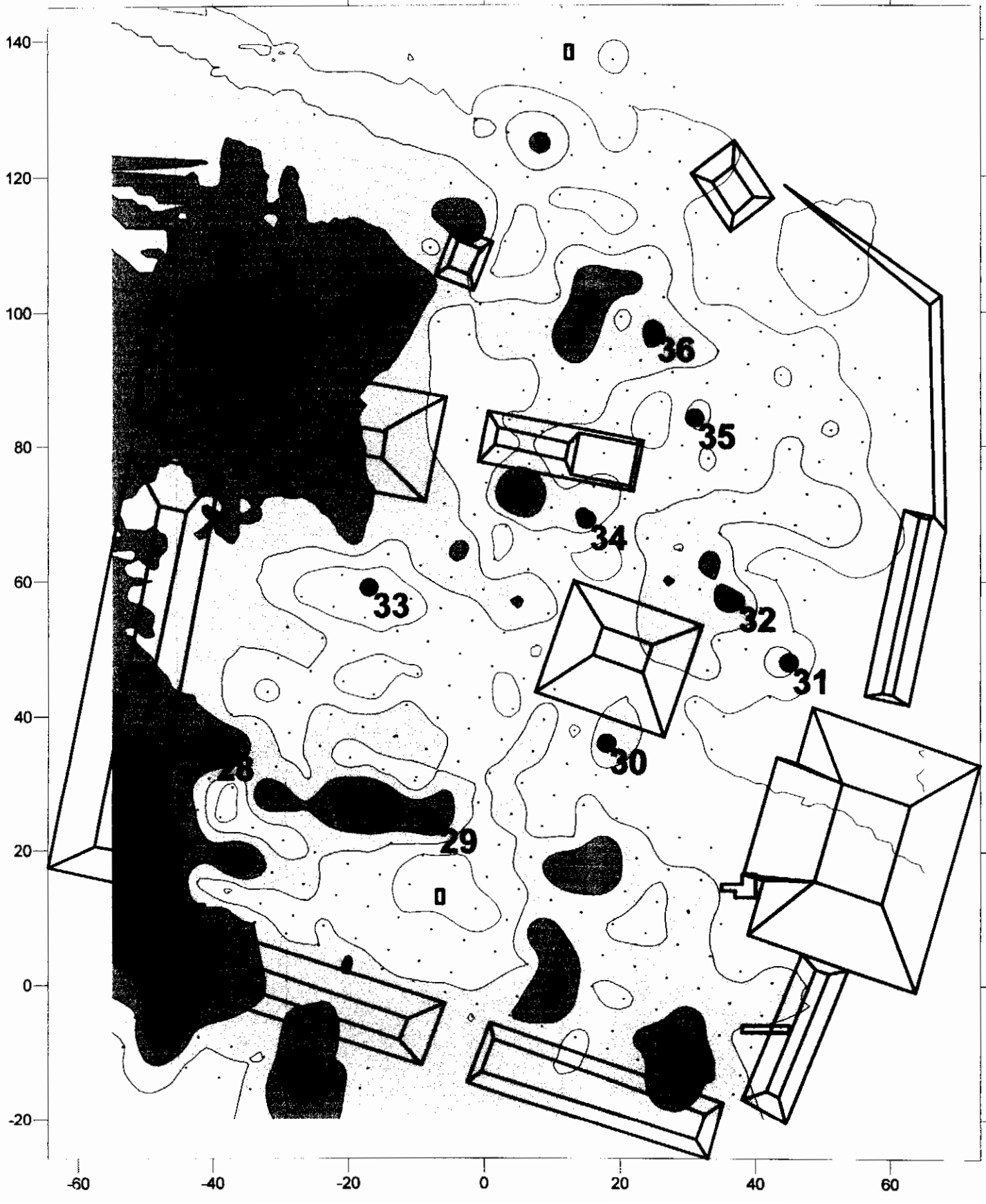

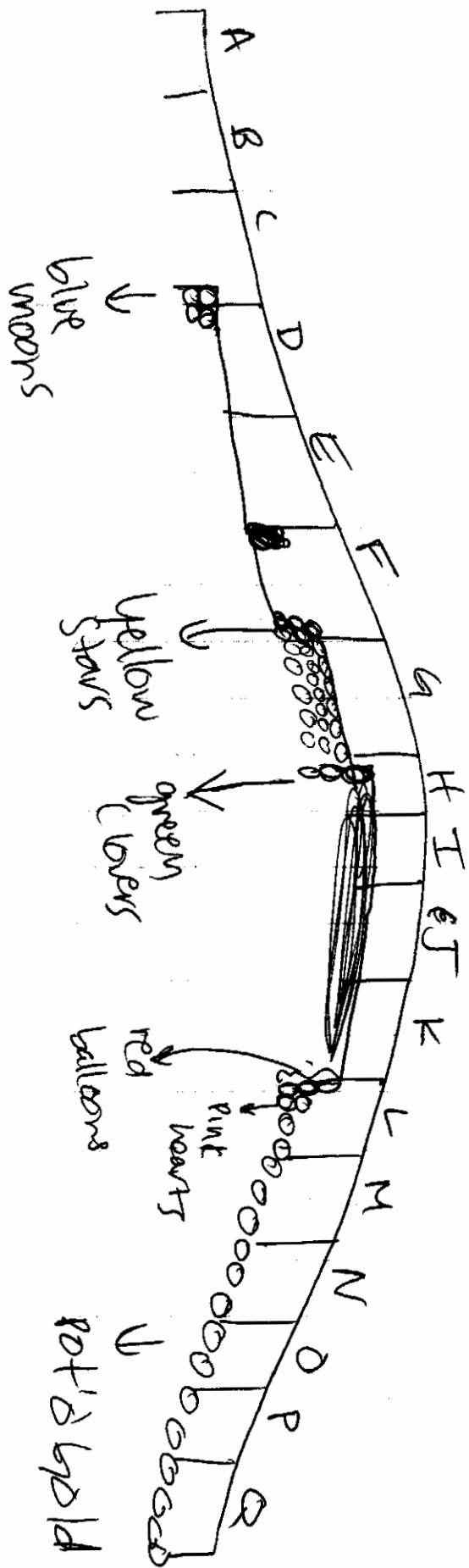

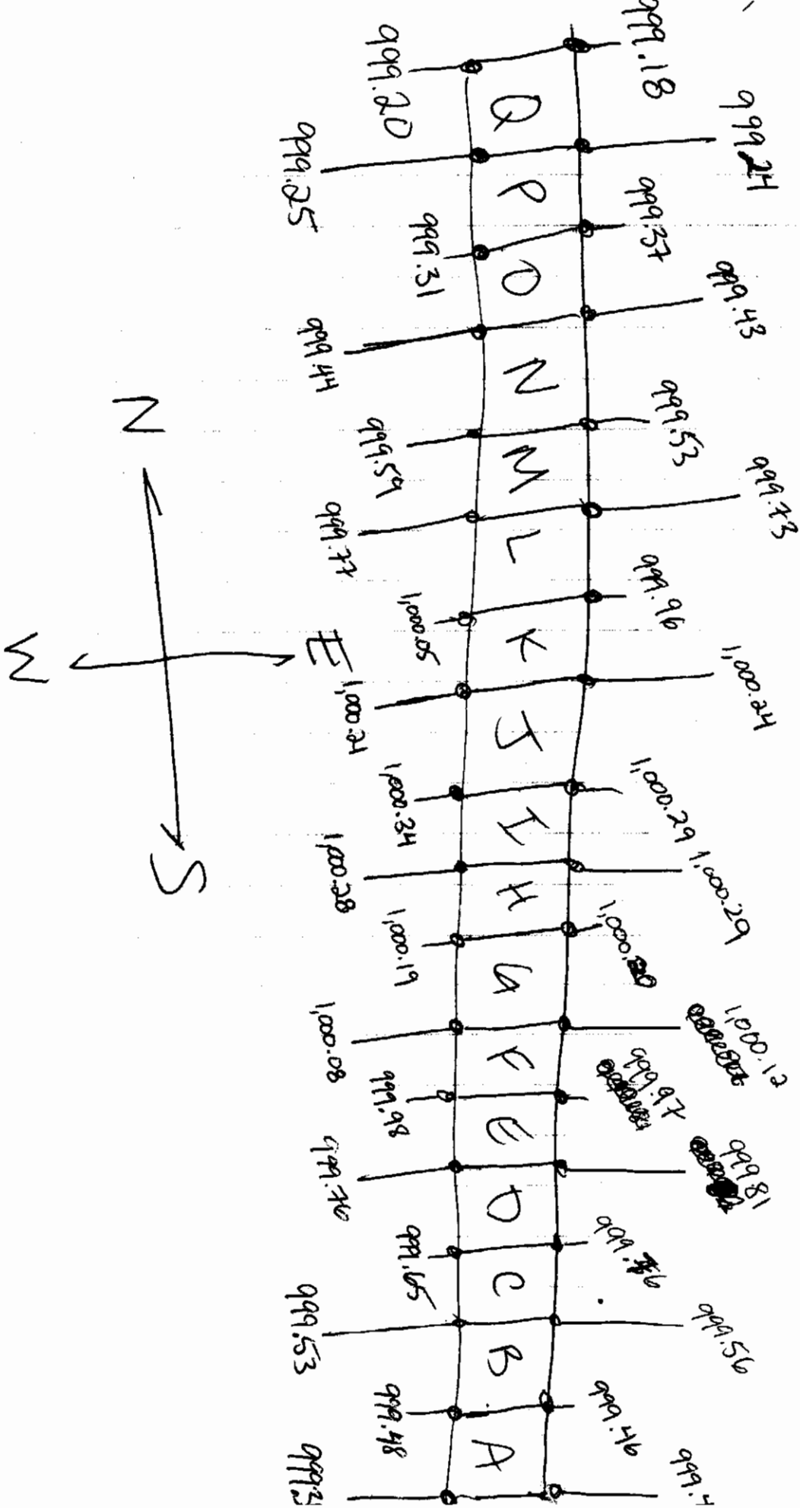

LOTS OF INTEREST:

02/36/EU.A

LOT 2 → above & between N. plaza surface

LOT 3 → below N. Plaza surface

LOT 12 → pre-classic Sherd

02/45

EU. D

LOT 16 → above + between basal wall ⇒ ^{Carbon} =

LOT 15 → around + above step (2.000)

~~2.000~~

EU. F LOT 35 → lots of stuff

EU.N. → lot 37 → above floor