

2022

Field Drawing of Plan View of Unit E From Penny (8BR158)

Lauren Lehman
University of Central Florida

Bethany Boylan
University of Central Florida

Bailey Perreault
University of Central Florida

Find similar works at: <https://stars.library.ucf.edu/penny-excavation>
University of Central Florida Libraries <http://library.ucf.edu>

This Excavation Map is brought to you for free and open access by the Penny Site (8BR158) at STARS. It has been accepted for inclusion in Penny Site Excavation by an authorized administrator of STARS. For more information, please contact STARS@ucf.edu.

Recommended Citation

Lehman, Lauren; Boylan, Bethany; and Perreault, Bailey, "Field Drawing of Plan View of Unit E From Penny (8BR158)" (2022). *Penny Site Excavation*. 28.
<https://stars.library.ucf.edu/penny-excavation/28>

Measurements taken in metric, paper in standard

Contract -
1 square = 10cm

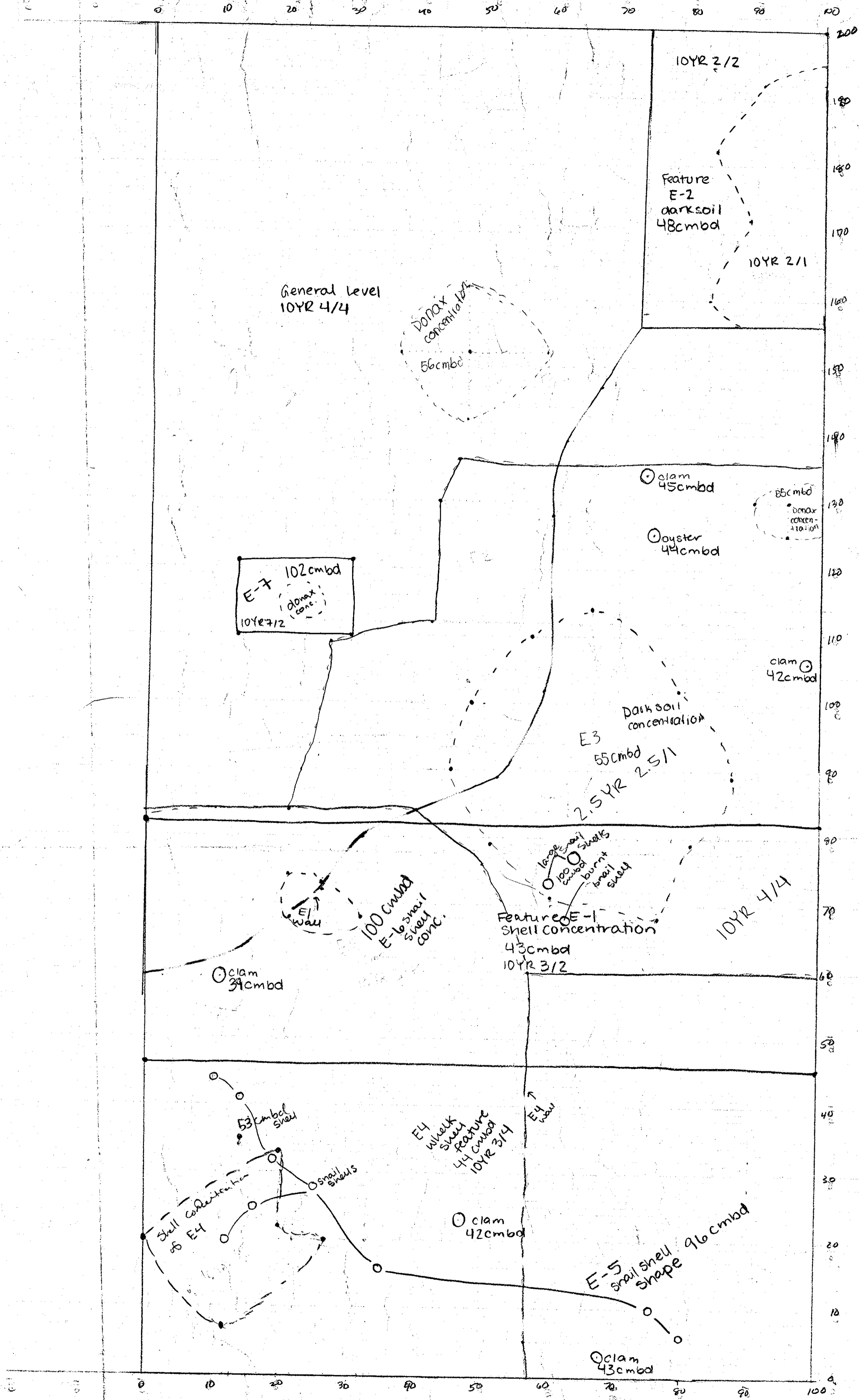

Feature E-1
Munsell 10YR 3/2 very dark grayish brown

Feature E-2
soil - 10YR 2/2 very dark brown, sandy, slightly darker
feature - 10YR 2/1 black, circular dark spot, almost ashy

General level
Munsell 10YR 4/4 dark yellowish brown, sandy, root inclusions

Feature E4
10YR 4/3 Brown

E3 Munsell
feature 2.5YR 2.5/1 black
matrix 10YR 4/4 dark yellowish brown

E5 Munsell
10YR 7/2 light gray
(no matrix)