

Kennesaw State University

DigitalCommons@Kennesaw State University

Bachelor of Architecture Theses - 5th Year

Department of Architecture

Spring 5-9-2022

Chattahoochee River Front: Creating a Public Space for the City of Atlanta

samantha manders

Follow this and additional works at: https://digitalcommons.kennesaw.edu/barch_etd



Part of the [Environmental Design Commons](#), [Historic Preservation and Conservation Commons](#), [Landscape Architecture Commons](#), [Urban, Community and Regional Planning Commons](#), and the [Urban Studies and Planning Commons](#)

Recommended Citation

manders, samantha, "Chattahoochee River Front: Creating a Public Space for the City of Atlanta" (2022). *Bachelor of Architecture Theses - 5th Year*. 227.
https://digitalcommons.kennesaw.edu/barch_etd/227

This Thesis is brought to you for free and open access by the Department of Architecture at DigitalCommons@Kennesaw State University. It has been accepted for inclusion in Bachelor of Architecture Theses - 5th Year by an authorized administrator of DigitalCommons@Kennesaw State University. For more information, please contact digitalcommons@kennesaw.edu.



CHATTAHOOCHEE RIVER FRONT

CREATING A PUBLIC SPACE FOR THE CITY OF ATLANTA

KENNESAW STATE UNIVERSITY
THESIS 2022

SAMANTHA MANDERS

**Chattahoochee River Front: Creating a Public Space for the City
of Atlanta
Standing Peachtree**

Thesis Proposal is Presented to the
Faculty of the Department of Architecture
College of Architecture and Construction Management

Ermal Shpuza, PhD, Primary Advisor

and,

Dr. Arash Soleimani, Thesis Coordinator
Kathryn Bedette, Interim Chair of Department

By

Samantha Manders

In partial fulfillment of the requirements for the Degree
Bachelor of Architecture

Kennesaw State University
Marietta, Georgia

May 2022

TABLE OF CONTENTS

0 1

INTRODUCTION

Abstract

Thesis Intent

Thesis Statement

Objective

0 2

RESEARCH

The Design of Space
William Whyte

How to Turn a Place Around
Project for Public Space

**Flow Through Time:
A History of The Lower Chatta-
hoochee**
Lynn Willoughby

Think Indegneous
Doug Goodfeather

0 3

PRECEDENT

Reedy River
Greenville, SC

San Antonio Riverwalk
San Antonio, Texas

RiverCity Gothenburg
Gothenburg, Sweden

Asah River Front
Okayama, Japan

0 4

DESIGN PROCESS

Current Site Condition

Arterial Pathways

Building Topology

0 5

DESIGN SYNTHESIS

Master Plan

Arterial Bridges Rendering

Building Typology

Lover's Island Render

**Standing Peachtree Memorial
Park Render**

0 6

BIBLIOGRAPHY

Books and Literature Cited

Online Resources Cited

Figures Listed



CHAPTER ONE

INTRODUCTION

ABSTRACT



The city of Atlanta lacks public spaces. Atlanta is characterized by many high-rise buildings, and a bare urban fabric that is accessed by automobile-oriented roads rather than pedestrian streets. Dense city centers such as Buckhead, Midtown, and Downtown, lacks proper public places that support social cohesion.

While the city is renowned for its green spaces and the tree canopy, much of the public space is dedicated as green parks rather than plazas as extension of the street network. When the development of Atlanta began, it was designed as a railroad city. This took the focus off its natural course of emerging as a river city. With its proximity to the Chattahoochee River, it's surprising that it remains nonexistent. Cities like Richmond, San Antonio, and Greenville, have all developed around the river and have created vibrant places for their people. Water is often a wonderful asset for urban life as indicated by successful water features incorporated in spaces like Centennial Park and Piedmont Park. How can Atlanta reinvent its interface with the river and how can we bring water back to the public spaces? The thesis tackles this question by proposing the extension of a public space at the intersection of the major and historical arterial road connecting Atlanta to Marietta with to Chattahoochee River. The site also coincides with an important historical layer of the city: the location of one the most important Creek native American villages in north Georgia.

This project proposes the design of a new public space which brings together lessons from best practice examples across the world with a thorough analysis of the site both from the physical standpoint and the socio-economic needs. The project views the intervention as a catalyst that will draw further development and growth in the area. Given the expansive segment of the Chattahoochee across the north and north-east metro area, the thesis suggests planning and design principles that can be applied to the revamping of public space along the river in the future.



Photo 01
WEST END
PC: Curbed Atlanta

THESIS INTENT

CURRENT RIVER CONDITIONS

WHY IS ATLANTA NOT A THRIVING RIVER CITY?

After the removal of the Native Americans in the early 1800s, white Americans of European descent began to move into these new territories and build new cities and profit from the natural resources. Around this time the railroad development began which turned the city of Atlanta into a transportation hub. With the focus of new cities shifted from developing around major water arteries, they formed around the railroad.



TRANSFORM A RIVERFRONT

HOW CAN WE CREATE A RIVERFRONT DEVELOPMENT THAT TRANSCENDS THE CURRENT LACK OF CONDITIONS TO A FLOURISHING PLENTITUDE OF ACTIVITY WHILE MAINTAINING SUSTAINABLE PRACTICES?

My thesis project will investigate the Chattahoochee River in its current state to address the lack of connectivity, access, and activity through conscious design and architecture theory to transform into a populated multi-reed space layered with waterfront 'beaches' to converging

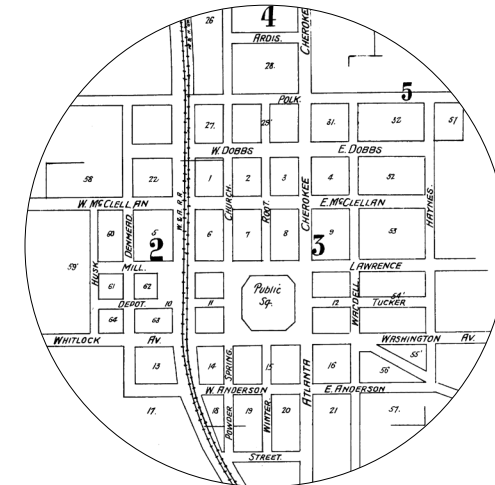

CREATE A PUBLIC SPACE

THESIS STATEMENT

The city of Atlanta is a place that lacks public spaces. The boundaries within downtown are highly populated with Highrise buildings, streets, and concrete in various forms. We truly lack gathering space for people to freely commute by foot or bike that is completely safe from the dangers of a motorized vehicle.

When the development of Atlanta began, it was designed as a railroad city which took focus off its natural course of emerging as a river city. With its proximity to the Chattahoochee River its surprising to how it remains nonexistent. This project will create a public space for the city that will improve on the urban condition through defining of the characteristics that make a river city and implementing it around the Chattahoochee to design a place for metro Atlanta.

OBJECTIVE

RIVERFRONT PRECEDENT STUDIES

Analyze thriving riverfronts to further comprehend how the river and city context stitch together in the urban topol-

MACRO AND MICRO CONTEXT

Think about the city context on a micro to macro level to understand the metro environment

MAJOR ARTERIES OF TRANSPORTATION

Address multiple forms of transportation that move along and around the river to show short-distance and long-distance movement to maximize the amount of people who can visit the site.

NATURE VERSUS BROWN FIELD

Understand the surrounding landscape from nature to development and find ways to create a smooth transition

ITERATIONS OF DESIGN

Consider multiple impacts that the new development can have to see which program is best suited for the area.

MATERIALITY

Think about the types of structure and what materials are most suitable for bridge design in the suburban area.



Photo 02
CHATAHOOCHEE
PC: ATLANTA TRAILS



CHAPTER TWO

RESEARCH

WILLIAM WHYTE/ THE DESIGN OF SPACE

William Whyte worked on The Street Life Project to develop ideas and what makes a public space popular in activity. Through much research, the study discovered that some plazas attracted lots of people while others did not. Points that made a great space included people, location, sun exposure, beauty, and seating. To start, to draw people in the space must have:

POPULATION

A decent flow of people.



LOCATION

Location was an important factor since it should be a short walk from the office as well as in the heart of downtown.



NATURAL LIGHT

Sun exposure and beauty was important but did not explain the differences in popularity of plazas.

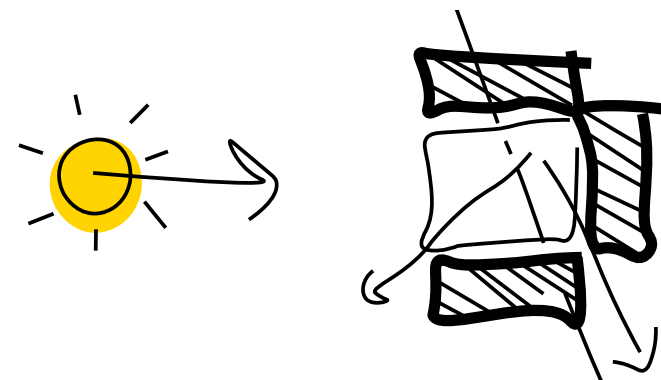

SEATING

People tend to sit most where there are places to sit. That's why a popular plaza must have a variety of seating from benches, swings, to short ledges, and stairs.

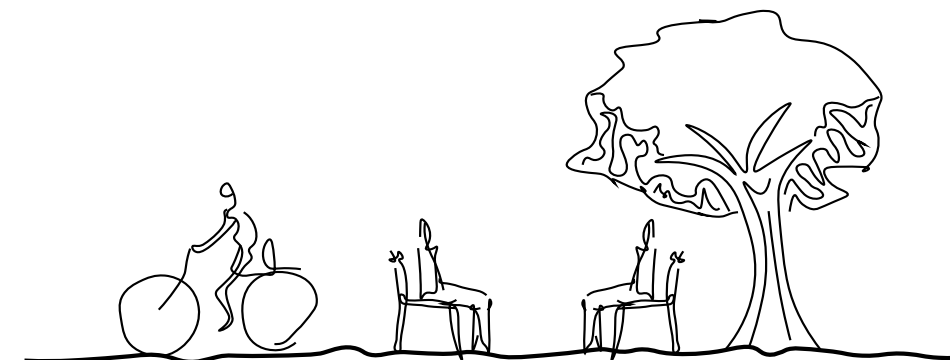

HOW TO TURN A PLACE AROUND/ PROJECT FOR PUBLIC SPACE

WHAT MAKE A PLACE GREAT?

Neighborhoods and cities have become even more homogenous in time with similar stores, streets dominated by traffic, and small towns. With everyone driving a car, walking seems to have become a lost. Through much research, a Project for Public Space has developed characteristics for a public space through sociability, uses and activities, access and linkage, as well as comfort and charm. The figure below breaks those categories down even further.

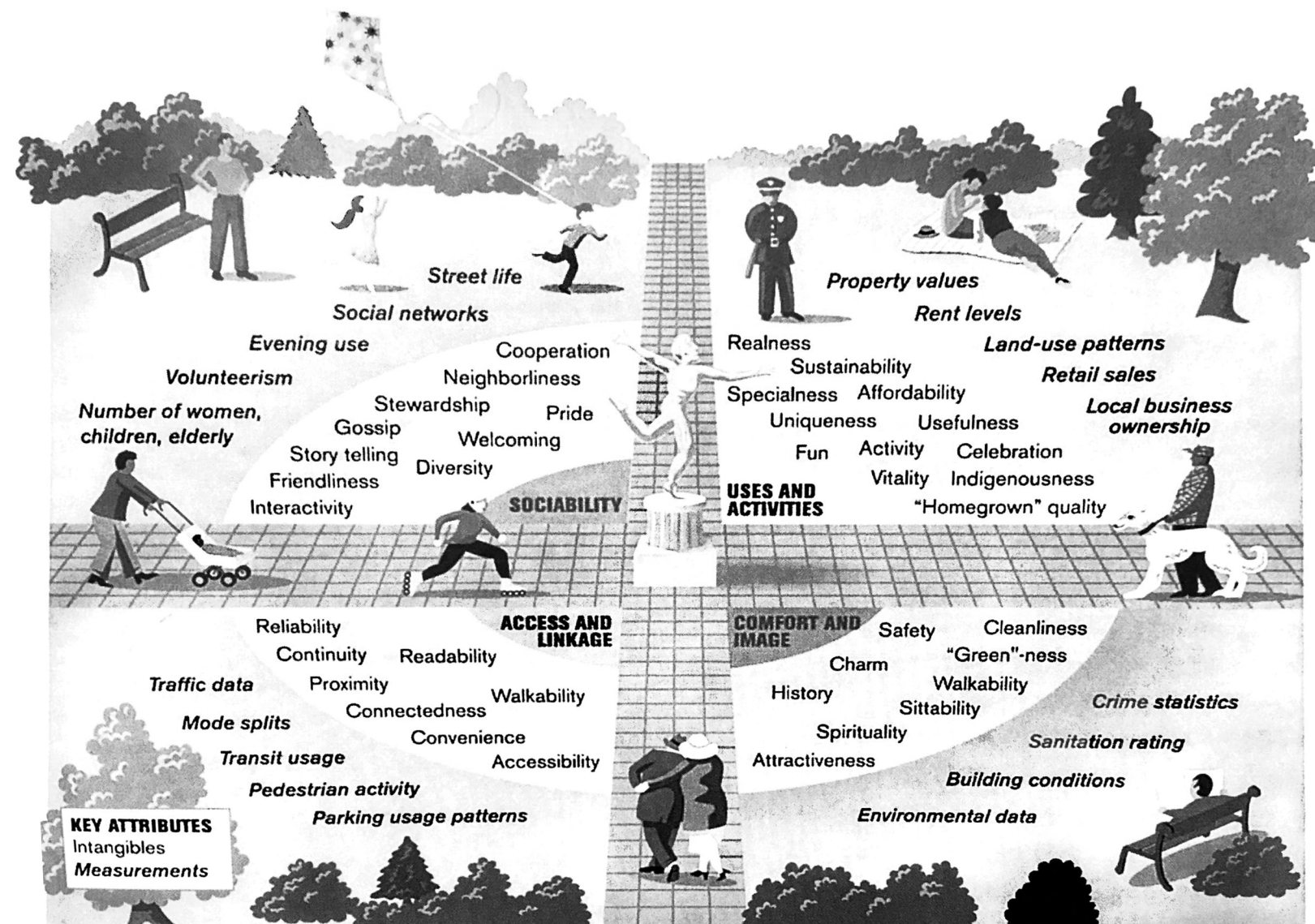
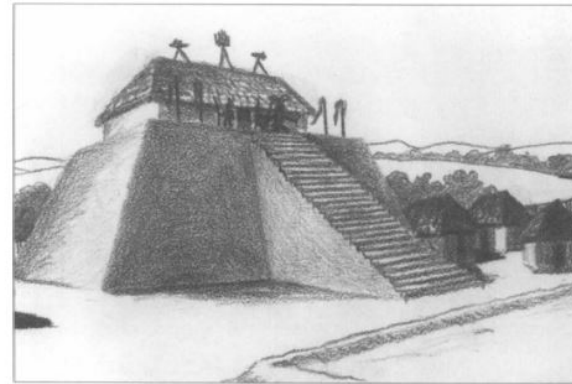
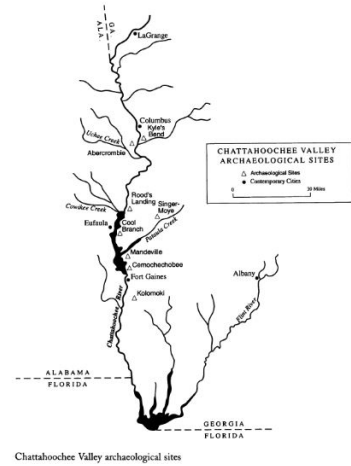
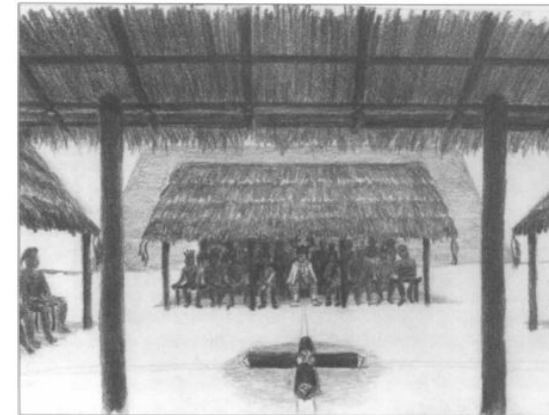

Photo 03
WHAT MAKES A SUCCESSFUL PLACE?
PC: PROJECT FOR PUBLIC SPACE

PEOPLE OF THE CHATTAHOOCHEE RIVER VALLEY



Drawing of a Mississippian-period platform mound by Cheryl Mann Hardin. Modern-day artist's conception. *Courtesy of William W. Winn and the Historic Chattahoochee Commission.*



Drawing of a Creek square ground by Cheryl Mann Hardin. Modern-day artist's conception. *Courtesy of William W. Winn and the Historic Chattahoochee Commission.*

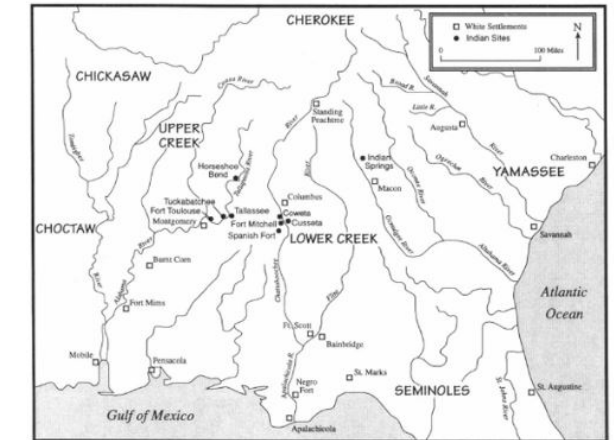

Indian sites and white settlements

The people who lived in the Chattahoochee Valley between 8,000 and 1,000 B.C. were hunters and gatherers. They followed the food sources with the seasons

Chattahoochee people began to place significance on the burial of the dead. They Also lived in harmony with nature.

Called Mississippian because it was related to the large mound complexes of this era found along the Mississippi River valley

Refugee natives moved into the Chatahoochee River Valley. The diverse people were often unrelated to each other and even spoke different languages. Yet they formed an alliance and exchanged ideas.

8,000B.C.- 1,000 B.C.

1,000 B.C.- 1000 A.D.

1,000 A.D.- 1540 A.D.

8,000B.C.- 1,000 B.C.

THE ANCIENTS

THE WOODLANDS

MISSISSIPPIAN

MUSKOGEE

PEOPLE OF STANDING PEACHTREE

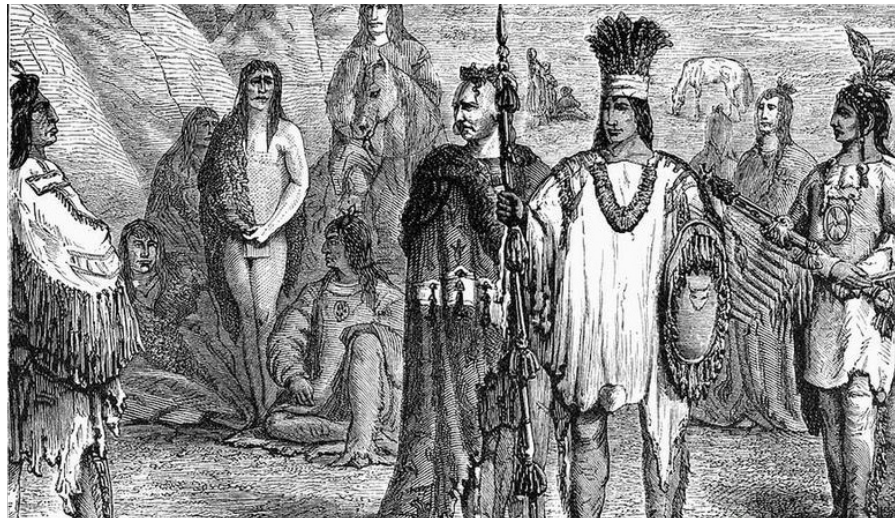

This area know as Standing Peachtree was the home of a Creek village.

The Creek village which was situated at a high point near the mouth of Peachtree Creek offered vital trading opportunities between tribes and later with the colonies.

During the war of 1812 the Creek nation who sided with the British and the Cherokee sided with Georgians. In the summer of 1813, the Governor of Georgia sought to reinforce the border of Georgia against the Creeks. He sent soldiers to push forward 30 or 40 miles beyond the frontier to Standing Peachtree. There they began constructing Fort Peachtree.



On July 14, 1814 the fort represented the first non-Native settlement in present-day Atlanta.

Its closeness to the river facilitated supplying forts with ammunition and goods during the war. Hostilities continued between the Native American and the Georgians.

Later on Atlanta formed its first post office on April 5, 1825 at Standing Peachtree. For nearly two centuries nothing much changed at Standing Peachtree. The fort and post office were eventually abandoned and later the Atlanta Waterworks company set up shop on the grounds, pulling from the swift flowing waters of the Chattahoochee.



As the city of Atlanta formed, it was becoming an economic development. Many projects for the city were carried out by the state government like the Georgia railroad system. The state of Georgia designed for the southern terminus to reside on the south bank of the Chattahoochee River and many private developments of railroads were encouraged to help the growth of the rail road.



CHAPTER THREE

DESIGN PROCESS

PRECEDENT STUDIES

FALLS PARK ON THE REEDY RIVER GREENVILLE, SC



34.8445 N, 82.4012 W

32-acre park

Located in the historic west end of the city, this crown jewel is a 32-acre oasis park with striking features like the Liberty Bridge and Reedy River Falls. Along this attractive landscapes are public gardens, a series of winding pedestrian paths, outdoor amphitheater, and a 22 mile stretch of bike path. Surrounding this space is some of the best shops, restaurants, boutiques, breweries in the city of Greenville. The destination makes a great place for families to grow and people to travel.

ARTERIES

Primary- Main St.
Secondary- E Broad St.
Tertiary- Falls St.

BRIDGES

Eugenia Dukes Bridge
Liberty Bridge

TRAILS

Swamp Rabbit Trail

PARKS AND GARDENS

Linky Stone Park
Falls Park
Pedrick s Garden
Rose Society Garden

LANDMARKS

Camperdown Mill
Medusa Tree
River Lodge

ARTS

Greenville Theater
Center Stage
Museum of Art
Bob Jones Art Gallery

RESTURANTS

Spill the Bean
Stellas Brasserie
Grill Marks
Hare and Field

SHOPS

Beija-Flor Jeans
Custard Botique
Coleman Collection

Photo 11
FALLS PARK
PC: GREENVILLE.GOV

**SAN ANTONIO RIVERWALK
SAN ANTONIO, TX**



29.4241 N, 98.4936 W

15 Miles

The San Antonio River flows through the city with pedestrian pathways winding around it. It sits one level down from the vehicular street giving it freedom for people to roam safely. Many iconic bridges pass over as you walk along the sidewalk lined with shops and restaurants. The path leads to many tourist destinations in the city like the Alamo and Southbank mall making it an idea destination for anyone.

ARTERIES

Primary- I-37
Secondary- Market St.
Tertiary- E Nueva St.

BRIDGES

Navaro Bridge
Alamo Bridge

TRAILS

San Antonio Riverwalk

PARKS AND GARDENS

Commanders House Park
Yanaguana Garden
Travis Park

LANDMARKS

The Alamo
Plaza de Las Islas Canarias
Love Lock Bridge

ARTS

Briscoe Western Art Museum
Ruby City
Majestic Theatre

RESTURANTS

Casa Rio
Boudro's on the
Riverwalk

SHOPS

Shops at River center
South Bank

Photo 12
SAN ANTONIO RIVERWALK
PC: THE SAN ANTONIO RIVERWALK

PRECEDENT STUDIES

Göta älv
GOTHENBURG SWEDEN

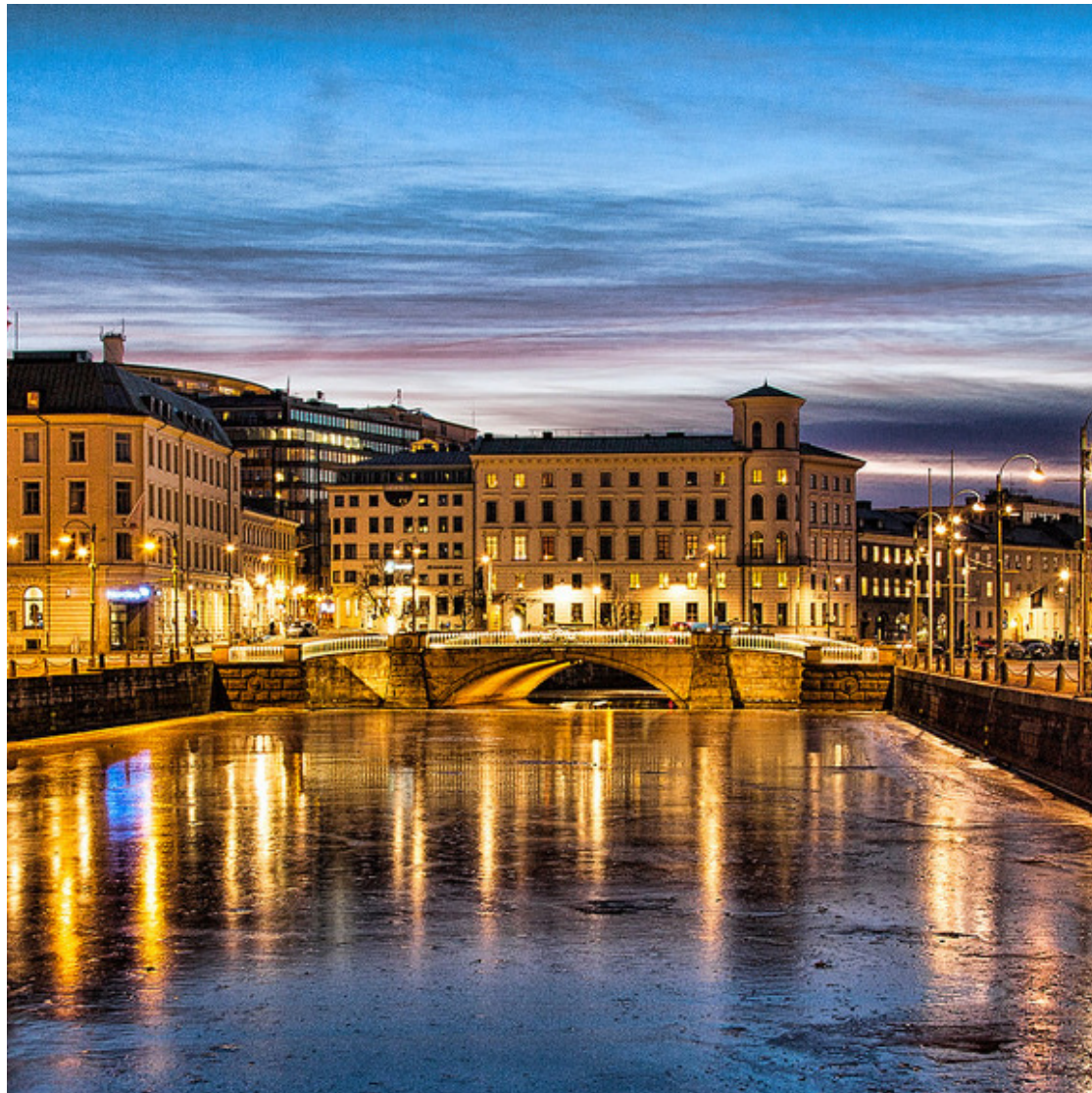

57.7089 N, 11.9746 E

As the second largest city in Sweden, Gothenburg is a thriving river city that provides walkable destination to its people. It is filled with many parks like the Kungsparken which is 32-acres and built around the 1800s by the Garden Society of Gothenburg. This project adds to the cities rich history that can also be seen through its wide breadth of architecture with the predominantly Neo-classic style.

ARTERIES

Primary- Hisingsbron
Secondary- Norra Sjöfarten
Tertiary- Burggrevegatan

BRIDGES

Hisingsbron Bridge
Alvsborgsbron Bridge
Angeredsbron Bridge

TRAILS

Gullbergs Strandgata
Marieholmsgatan

PARKS AND GARDENS

Redbergsparken
Ostra kyrkogården
Apslatten

LANDMARKS

Nya Varvet
Slottsberget
Skansen Kronan

ARTS

Gothenburg Museum
Museum of Art
Goteborgsoperan (Opera House)

RESTURANTS

Strommingsluckan
Tvakanten
Brautigam's

SHOPS

Vallgatan 12
Nordiska Kompaniet

Photo 13
GOTHENBURG
PC: VISIT SWEDEN

**ASAH RIVER FRONT
OKAYAMA, JAPAN**



34.6555 N, 133.9198 E

Okayama is the capital city of Okayama Prefecture in the Chugoku region of Japan. Its culture, architecture, art, and history go way back centuries. This city took a natural course of developing around the river and serves a destination for parks and gardens for the people to enjoy.

ARTERIES

Momotaro-odori St.
Joka-suji

BRIDGES

Tsurmi-bashi Bridge
Nakahara Bridge

TRAILS

Chugoku Nature Trail
Tatsunokuchi Green Shower Forest
Trail

PARKS AND GARDENS

Okayama Korakuen
Okayama Forest Park
Ujo Park

LANDMARKS

Kinojo Castle Ruins
Okayama Castle
Enyo-tei House

ARTS

Prefectural Museum of Art

RESTURANTS

Momo-no-Hana
Kamon S Okonomiyaki
Teppan Ku-Ya okayama

SHOPS

Omotecho Shopping Street
Sun Station Terrace Okayama

Photo 14
ASAH RIVER FRONT
PC: CHUSHIKOKU AND TOKYO



CHAPTER FOUR

DESIGN PROCESS

CURRENT SITE CONDITIONS

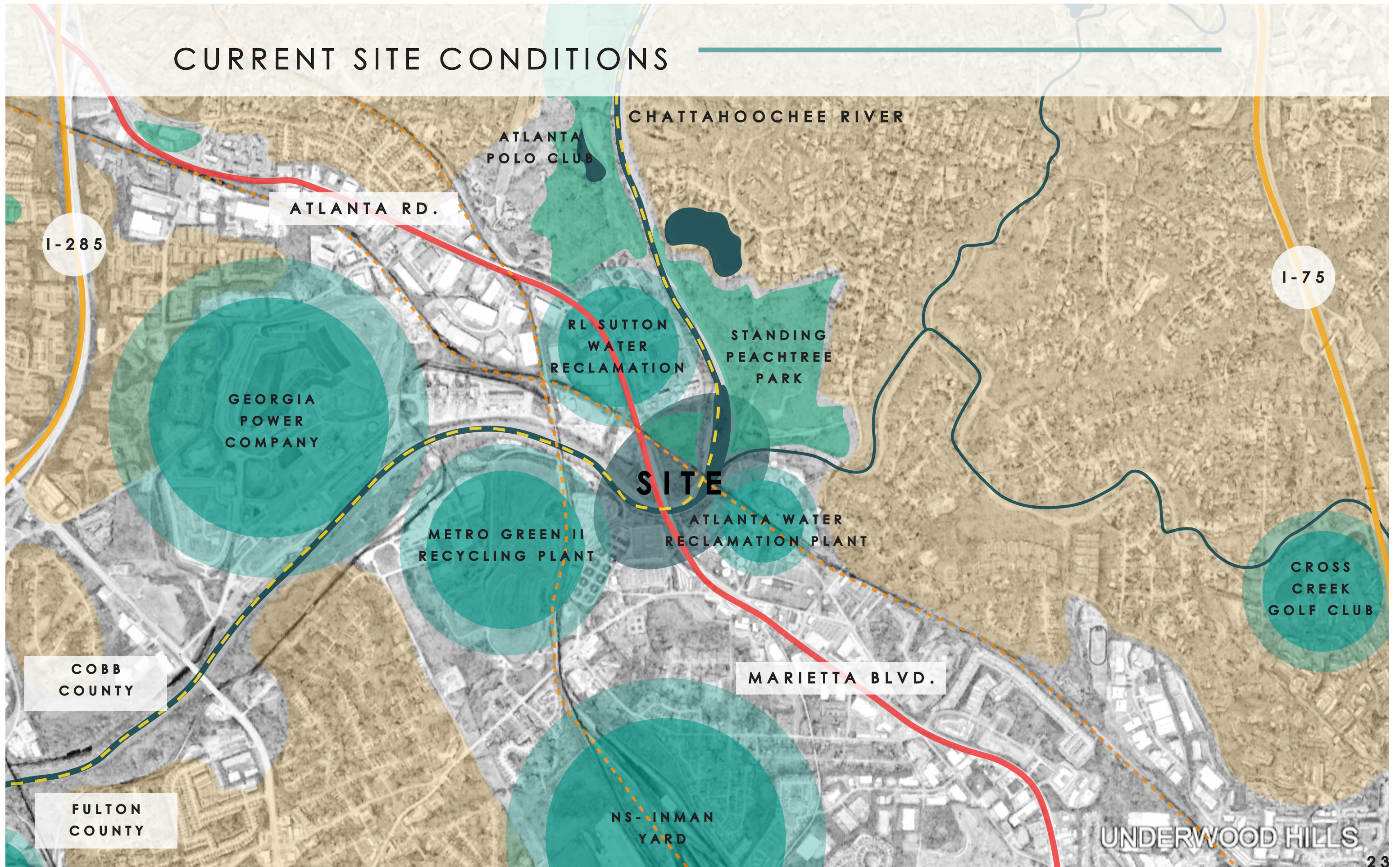



STANDING PEACHTREE PARK



ATLANTA WATER RECLAMATION PLANT



NS- INMAN TRAIN YARD



ATLANT/ MARIETTA BRIDGE



GEORGIA POWER



RL SUTTON WATER

Photo 15, 16, 17, 18, 19, 20
STANDING PEACHTREE SITE
PC: GOOGLE MAPS

ARTERIAL PATHWAYS

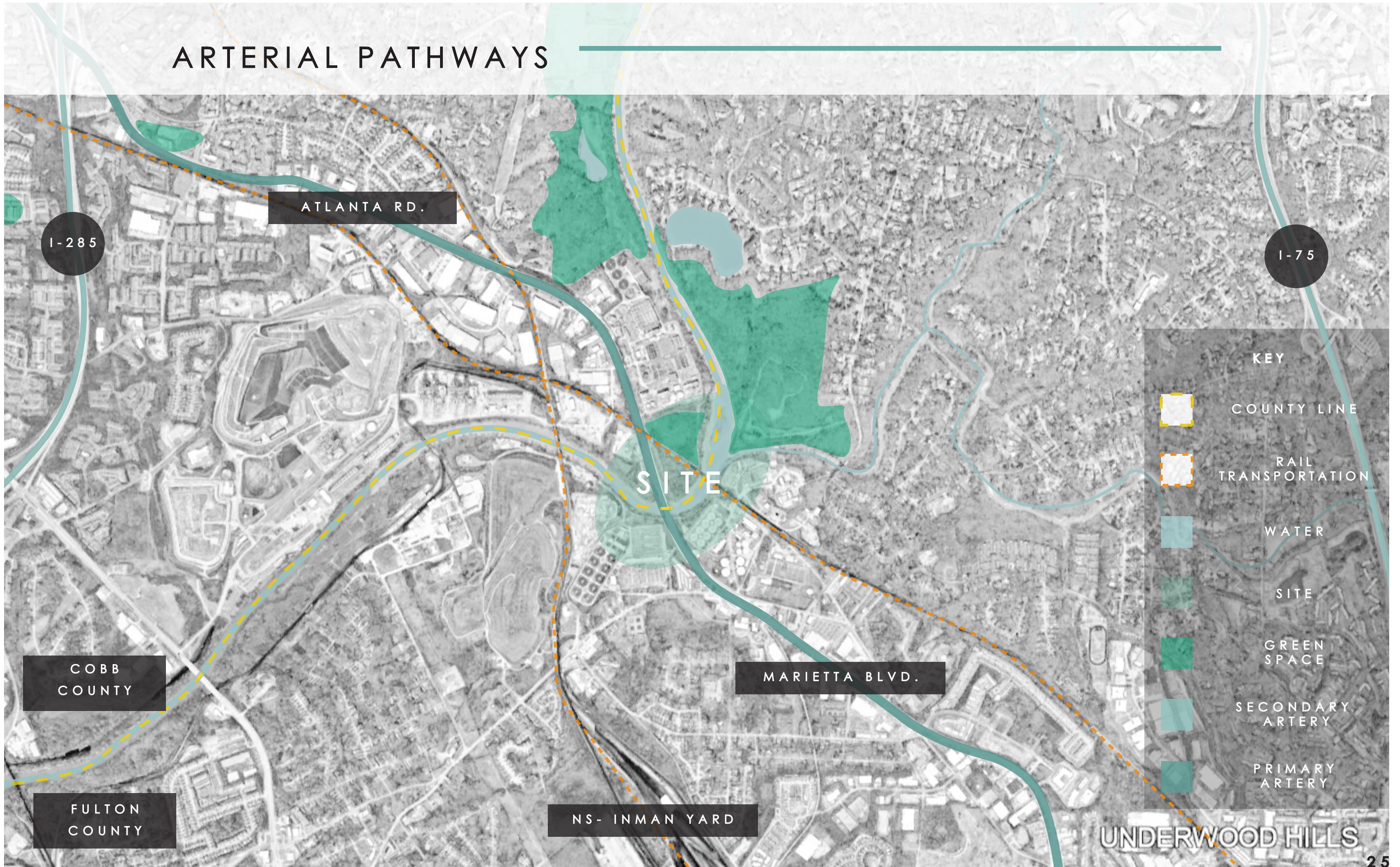

UNDERWOOD HILLS

BUILDING TYPOLOGY

SAN ANTONIO, TX

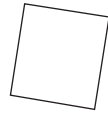

Morrison Apartments

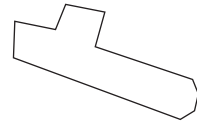

Granada Homes Inc.

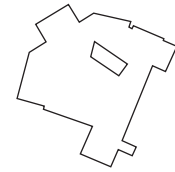

Hotel Contessa

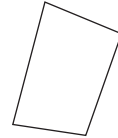

Homewood Suites by Hilton
San Antonio-Riverwalk

APARTMENTS

HOTEL

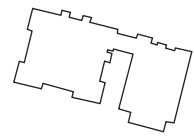

Briscoe Western Art Museum

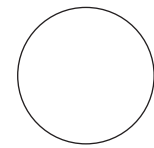

La Orilla Del Rio Ballroom

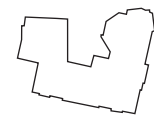

La Orilla Del Rio Ballroom

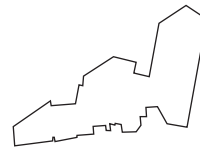

South Bank Shopping Mall

ENTERTAINMENT

COMMERCIAL

GREENVILLE, SC

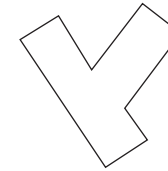

Rivers Edge

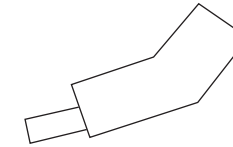

RiverWalk Apartments

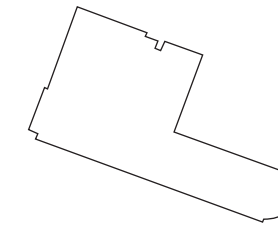

Courtyard by Marriott Green-
ville Downtown

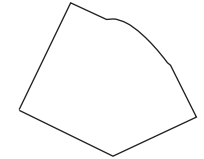

RiverWalk Apartments

APARTMENTS

HOTEL

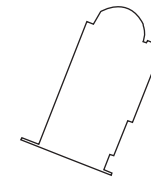

Gunter Theatre

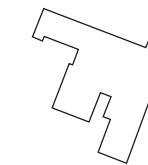

Huguenot Mill and Loft

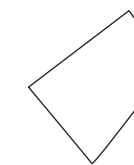

550 S Main St.

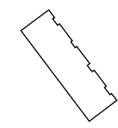

154 Riverplace

ENTERTAINMENT

COMMERCIAL

GOTHENBURG, SWEDEN



Apartments at Hotel Riverton



Design Apartments

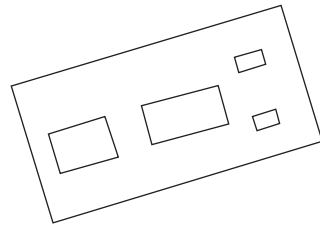

Radisson Blu Scandinavia Hotel

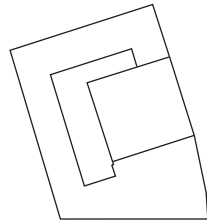

Clarion Hotel Post

APARTMENTS

HOTEL

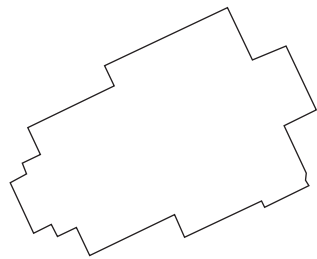

Royal Swedish Opera

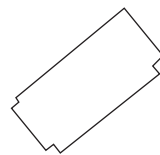

Grand Theater

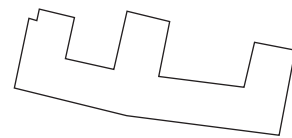

Nordstan

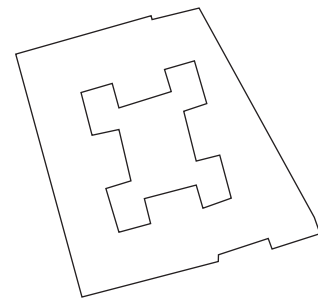

Arkaden

ENTERTAINMENT

COMMERCIAL



CHAPTER FIVE

DESIGN SYNTHESIS

MASTER PLAN



FOOD HALL



Direct entry to main artery
 Food Hall serves cuisine of all types of cultures
 Shops, offices, apartments, and parking.
 Open space between the food hall and river
 Pathway for bikes and walkers to freely move

FARMERS MARKET



HAND CRAFTED ITEMS
 FARM FRESH
 FOOD

MIXED USE



SHOPS OFFICES
 RESTURANTS HOTELS
 APARTMENTS

BLOSSOM WALK



Viewers encompass themselves with the view of the river whiles being surrounded by blossoming trees to create a deeper connection with nature.

LOVER'S ISLAND



Lovers Island is a destination for couples to come to enjoy several small gardens that surround a gazebo built for proposals, marriages, and building strong memories with one another.

PAINTED ROCK BRIDGE



Painted Rock Bridge is the main artery that links Marietta to Atlanta. The bridge center allows for traffic while the exterior has a boardwalks for pedestrians to freely move around and view of the river.

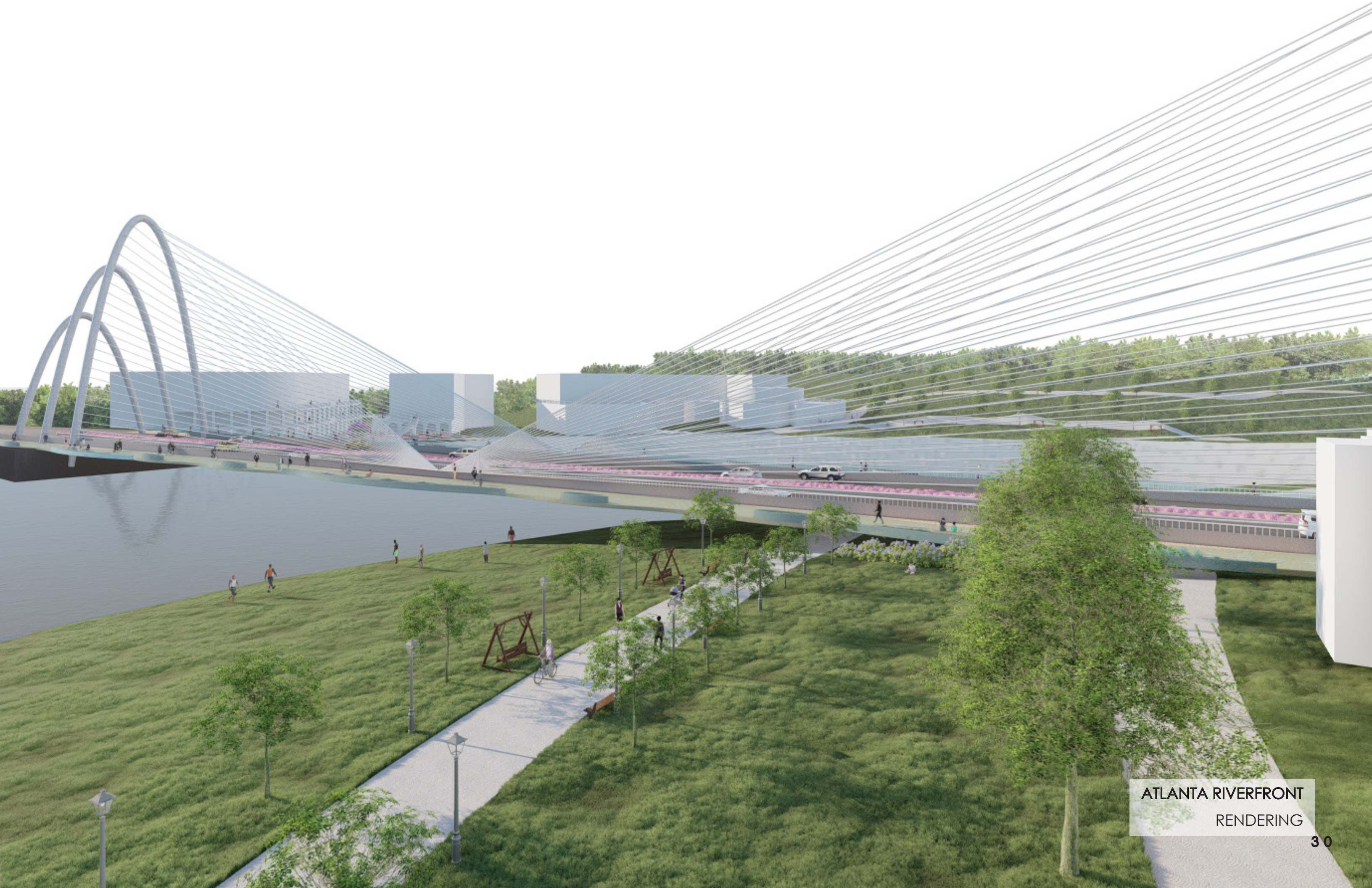

ATLANTA RIVERFRONT
RENDERING

BUILDING TYPOLOGY

SNAKE

FORM: LARGE LINEAR VOLUME (MULTIDIRECTIONAL)
SIGNIFIES: AIR RIGHTS OF LINCOLN TUNNEL ACCESS
PROGRAM: OFFICE – RESIDENTIAL – LOFTS – SERVICE – COMMERCIAL

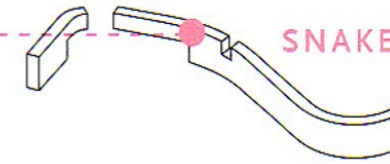

SNAKE [Mo3]

NOODLES

FORM: LINEAR VOLUMES
SIGNIFIES: CONNECTIONS
PROGRAM: OFFICE – RESIDENTIAL – INSTITUTIONAL

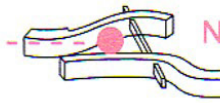

NOODLES [Mo2]

Photo 01
BUILDING TYPOLOGY
 PC: Combinatory Urbanism

FARMERS MARKET

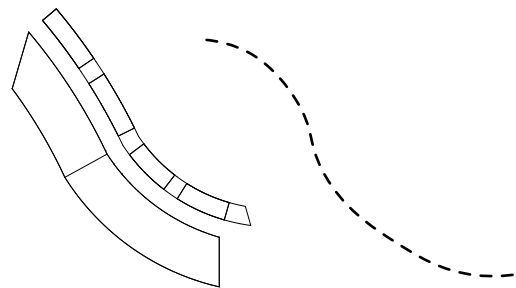

Snake

FOOD HALL

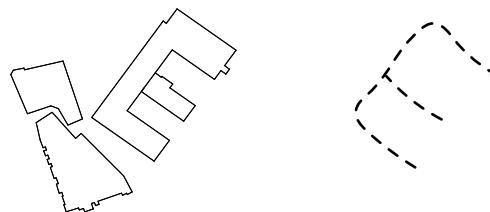

Snake

MIXED USE GALLERY

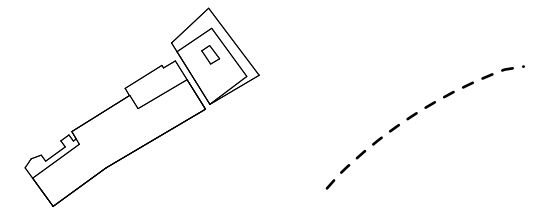

Snake

COMMERCIAL/ HOTEL

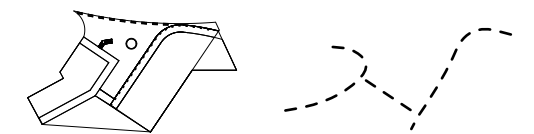

Noodle

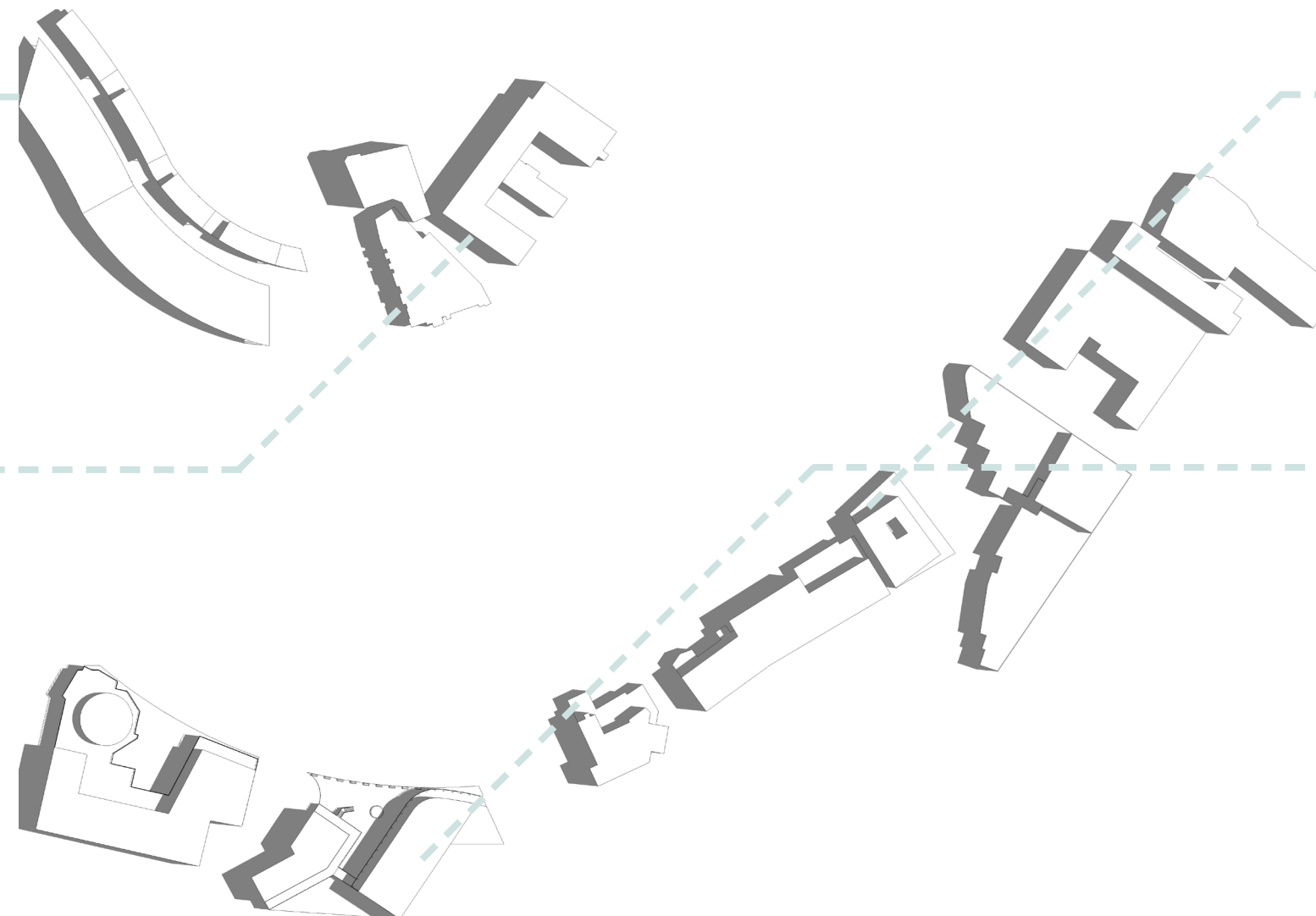



PAINTED ROCK BRIDGE
RENDERING



LOVERS ISLAND
RENDERING



STANDING PEACHTREE MEMORIAL PARK
RENDERING

PRESENTATION BOARDS

CHATTAHOOCHEE RIVER FRONT

CREATING A PUBLIC SPACE FOR THE CITY OF ATLANTA

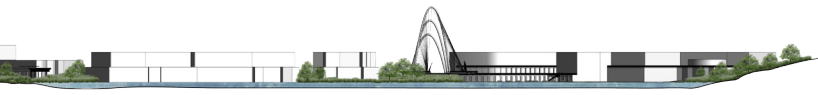

THESES INTENT

CURRENT RIVER CONDITIONS

TRANSFORM A RIVERFRONT

CREATE A PUBLIC SPACE

WHY IS ATLANTA NOT A THRIVING RIVER CITY?

HOW CAN WE CREATE A RIVER FRONT DEVELOPMENT THAT TRANSCENDS THE CURRENT LACK OF CONDITIONS TO A FLOURISHING PLENTITUDE OF ACTIVITY WHILE MAINTAINING SUSTAINABLE PRACTICES?

WHEN THE DEVELOPMENT OF ATLANTA BEGAN, IT WAS DESIGNED AS A RAILROAD CITY WHICH LOOKS OFF ITS NATURAL COURSE OF EMERGING AS A RIVER CITY. WITH ITS PROXIMITY TO THE CHATTAHOOCHEE RIVER IT'S SURPRISING HOW IT REMAINS NON-RIVER. THIS PROJECT WILL CREATE A PUBLIC SPACE FOR THE CITY THAT WILL IMPROVE ON THE EXISTING CONDITIONS THROUGH DETERMINING THE CHARACTERISTICS THAT MAKE A RIVER CITY AND IMPLEMENTING IT AROUND THE CHATTAHOOCHEE TO DESIGN A PLACE FOR METRO ATLANTA.

OBJECTIVE

- RIVERFRONT PRECEDENT STUDIES**
- MACRO AND MICRO CONTEXT**
- MAJOR ARTERIES OF TRANSPORTATION**
- NATURE VERSUS BROWN FIELD**
- ITERATIONS OF DESIGN**
- MATERIALITY**

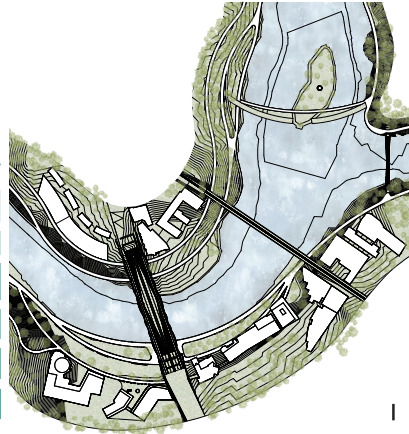

DENSIFYING ATLANTA/ ELLEN DUNHAM JONES

REVERSE SPRAWL:

WE NEED TO PLAN MUCH MORE INTENTIONALLY AT THE METROPOLITAN SCALE

WE NEED TO TARGET AREAS THAT NEED TO BE REGENERATED, WHERE SHOULD WE BE REDEVELOPING, AND WHERE WE SHOULD BE ENCOURAGING RE-INHABILITATION

INCREASE TRAVEL ON ALL MAJOR RAIL AND ROAD CORRIDORS

THE SECOND CHALLENGE IS TO IMPROVE THE ARCHITECTURAL DESIGN QUALITY OF THE RETROFIT

SITE SELECTION

AFTER OBSERVING SEVERAL SITES ALONG THE CHATTAHOOCHEE, THE STANDING PEACHTREE SITE WAS SELECTED FOR THE RIVER'S LOCATION IS ALIGNED WITH ITS RICH HISTORY AMONG THE INDIGENOUS PEOPLE WHO USE TO LIVE BY THE RIVER ALONG WITH THE DESCENDANTS OF THE COLONIST WHOSE FOUNDATION LAYED DEVELOPMENT. THESE TWO WERE LENGTHS OF HISTORY CROSS AT THIS SITE WITH THE REPRESENTATION OF THE RAIL ROAD CROSSING THE RIVER AND THE HISTORIC VALUE OF THE STANDING PEACHTREE LOCATION.

PEOPLE OF THE CHATTAHOOCHEE RIVER VALLEY

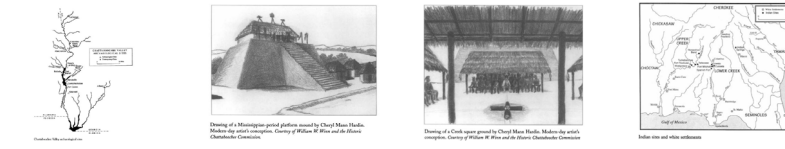

The people who lived in the Chattahoochee Valley between 8,000 and 1,000 B.C. were hunters and gatherers. They followed the food sources with the seasons.

Chattahoochee people began to place significance on the burial of the dead. They also lived in harmony with nature.

Called Mississippian because it was related to the large mound complexes of the area found along the Mississippi River valley.

Refugee natives moved into the Chattahoochee River Valley. The diverse people were often unrelated to each other and even spoke different languages. Yet they formed an alliance and exchanged ideas.

PEOPLE OF STANDING PEACHTREE



This area known as Standing Peachtree was the home of a Creek village.

On July 18, 1814 the fort represented the first non-Native settlement in present-day Atlanta.

Atlanta was effectively an economic development project controlled by state government. The State of Georgia built a railroad — and still owns it to this day — and located from its southern terminus would be on the south bank of the Chattahoochee River in the middle Piedmont region. At the time, privately owned railroads were then encouraged to build to that terminus, which at the time was a thorough and place.

WILLIAM WHYTE/ THE DESIGN OF SPACE

William Whyte worked on *The Street Life Project* to develop ideas and what makes a public space popular in activity. Through much research, the study discovered that some places attracted lots of people while others did not. Points that make a great space included people, location, sun exposure, beauty, and seating. To start, to draw people in the space must have:

- POPULATION:** A decent flow of people.
- LOCATION:** Location was an important factor since it should be a short walk from the office as well as in the heart of downtown.
- NATURAL LIGHT:** Sun exposure and beauty was important but did not explain the differences in popularity of plazas.
- SEATING:** People tend to sit most where there are places to sit. That's why a popular plaza must have a variety of seating from benches, swings, to short ledges, and stairs.

PROJECT FOR PUBLIC SPACE/ HOW TO TURN A PLACE AROUND

WHY PLACES ARE IMPORTANT TO CITIES

WHAT MAKE A GOOD PLACES

PRINCIPALS OF CREATING PLACES

- The Community is the Expert
- Create a Place, Not a Design
- Look for Partners
- You Can See a Lot Just by Observing
- Have a Vision
- Start with the Patrons: Lighter, Quicker, Cheaper
- Triangulate
- They Always Say "It Can't Be Done"
- Farm Supports Function
- Money is Not the Issue
- You Are Never Finished

PRECEDENT STUDIES

FALLS PARK ON THE REEDY RIVER GREENVILLE, SC

34.8448° N, 82.4012° W
32-acre park

Located in the historic west end of the city, this crown jewel is a 32-acre oasis park with striking features like the Liberty Bridge and Reedy River Falls. Along this attractive landscape are public gardens, a series of winding pedestrian paths, outdoor amphitheater, and a 22 mile stretch of bike path. Surrounding this space is some of the best shops, restaurants, boutiques, breweries in the city of Greenville. The destination makes a great place for families to grow and people to travel.

ARTERIES	BRIDGES	TRAILS	PARKS AND GARDENS
Primary- Main St. Secondary- E Broad St. Tertiary- E 11th St.	Eugenia Dukes Bridge Liberty Bridge	Swamp Rabbit Trail	Lilky Stone Park Falls Park Piedrick's Garden Rose Society Garden
LANDMARKS	ARTS	RESTURANTS	SHOPS
Camperdown Mill Medusa Tree River Lodge	Greenville Theater Center Stage Museum of Art Bob Jones Art Gallery	SPill the Bean Stellas Southern Brasserie Grill Marks Hare and Field	Bejo-Flor Jeans Custard Rollup Coleman Collection

SAN ANTONIO RIVERWALK SAN ANTONIO, TX

29.4241° N, 98.4936° W
16 Miles

Downtown San Antonio is proud of their world-renowned river park. The San Antonio river flows through the city with pedestrian pathways winding around it. It sits one level down from the automobile street giving it freedom for people to roam freely. Many iconic bridges pass over as you walk along the sidewalk lined with shops and restaurants. The path leads to many tourist destinations in the city. Every spring, the city gathers for the annual springtime Fiesta San Antonio to watch flower floats that float down the river.

ARTERIES	BRIDGES	TRAILS	PARKS AND GARDENS
Primary- I-37 Secondary- Market St. Tertiary- E Nueva St.	Navarro Bridge Alamo Bridge	San Antonio Riverwalk	Commanders House Park Yanaguana Garden Travis Park
LANDMARKS	ARTS	RESTURANTS	SHOPS
The Alamo Plaza de Las Lajas Conalitas Love Lock Bridge	Bracco Western Art Museum Ruby City Majestic Theatre	Caia Rio Boudoir's on the Riverwalk	Shops at River center South Bank

Göta älv GOTHEBURG SWEDEN

57.7089° N, 11.9746° E

As the second largest city in Sweden, Gothenburg is a thriving river city that provides walkable destination to its people. It is filled with many parks like the Kongärdsparken which is 22 acres and built around the 1800s and the Garden Society of Gothenburg, a park and horticultural garden which was founded in 1842. The city is rich in history that can also be seen through its wide breadth of architecture which predominantly shows Neo-classical.

ARTERIES	BRIDGES	TRAILS	PARKS AND GARDENS
Primary- Hisingsbron Secondary- Norra Sjöparten Tertiary- Kungälvregion	Hisingsbron Bridge Älvsborgsbron Bridge Ängersdälsbron Bridge	Gulibergs Strandgata Marieholmsgatan	Rindögsparken Östra kyrkogården Agnatullen
LANDMARKS	ARTS	RESTURANTS	SHOPS
Nya Varvet Sjöfartsmuseet Skansen Frönan	Gothenburg Museum Museum of Art Göteborgsoperan (Opera House)	Strömmingsluckan Tvåtorften Isbjörngården	Valigatan 12 Nordiska Kompaniet

ASAHI RIVER FRONT OKAYAMA, JAPAN

34.6555° N, 133.9198° E

Okayama is the capital city of Okayama Prefecture in the Chūgoku region of Japan. Its culture, architecture, art, and history go way back centuries. This city took a natural course of developing around the river and serves a destination for parks and gardens for the people to enjoy.

ARTERIES	BRIDGES	TRAILS	PARKS AND GARDENS
Manataro-odori St. Joko-ujii	Tsurumi-bashi Bridge Nakamura Bridge	Chugoku Nature Trail Tatsunokuchi Green Shower Forest Trail	Okayama Karatsumi Okayama Forest Park Ujo Park
LANDMARKS	ARTS	RESTURANTS	SHOPS
Etnoja Castle Ruins Okayama Castle Enyo-kei House	Prefectural Museum of Art	Mama-no-Hana Kamon 3 Okonomiyaki Teppan Ku-Ya okayama	Omotecho Shopping Street Sun Station Terrace Okayama

PUBLIC SPACE RENDERINGS

MARIETTA BLVD./ ATL RD BRIDGE

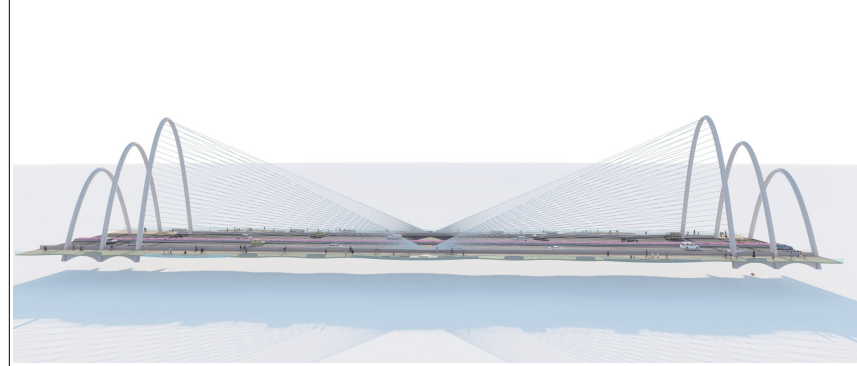

PEDESTRIAN BRIDGE



PEDESTRIAN BRIDGE



PUBLIC SPACE RENDERINGS

LOVERS ISLAND



STANDING PEACHTREE MEMORIAL PARK



FLEA MARKET



B I B L I O G R A P H Y

BIBLIOGRAPHY

ANNOTATED BIBLIOGRAPHY/ BOOK AND LITERATURE

FLOW THROUGH TIME: A HISTORY OF THE LOWER CHATTAHOOCHEE RIVER

LYNN WILLOUGHBY

WILLOUGHBY, LYNN. Flowing Through Time: A History of the Lower Chattahoochee River. University Alabama Press, 1999.

HOW TO TURN A PLACE AROUND. A HANDBOOK FOR CREATING SUCCESSFUL PUBLIC SPACES

KATHLEEN MADDEN

MADDEN, KATHLEEN. How to Turn a Place Around A Handbook for Creating Successful Public Spaces. Project for Public Spaces. 2000.

WALKABLE CITY: HOW DOWNTOWN CAN SAVE AMERICA, ONE STEP AT A TIME

JEFF SPECK

SPECK, JEFF. Walkable City: How Downtown Can Save America, One Step at a Time. PICADOR, 2013.

THE RIVERKEEPER'S GUIDE TO THE CHATTAHOOCHEE

FRED BROWN

BROWN, FRED. The Riverkeeper's Guide to the Chattahoochee. CI Pub. 2007.

THINK INDIGENOUS: NATIVE AMERICAN SPIRITUALITY FOR A MODERN WORLD

DOUG GOOD FEATHER

GOOD FEATHER, DOUG. Think Indigenous: Native American Spirituality for a Modern World. Hay House Inc., 2021.

RETROFITTING SUBURBIA: URBAN DESIGN SOLUTIONS FOR REDESIGNING SUBURBS

ELLEN DUNHAM-JONES

DUNHAM-JONES, ELLEN. Retrofitting Suburbia: Urban Design Solutions for Redesigning Suburbs. Wiley, 2011.

THE ARCHITECTURAL LEGACY OF THE LOWER CHATTAHOOCHEE VALLEY IN ALABAMA AND GEORGIA

D. GREGORY JEANE

JEANE, GREGORY. The Architectural Legacy of the Lower Chattahoochee Valley in Alabama and Georgia. Historic Chattahoochee Commission. 1978.

ANGLO-INDIAN DIPLOMACY ON THE SOUTHERN FRONTIER

JOHN JURICEK

JURICEK, JOHN. Colonial Georgia and the Creeks : Anglo-Indian Diplomacy on the Southern Frontier. University Press of Florida, 2010.

WEB BIBLIOGRAPHY/ ONLINE RESOURCES

SAUNT, CLAUDIO. "Creek Indians" Aug 25, 2020. <https://www.georgiaencyclopedia.org/articles/history-archaeology/creek-indians/>

The Columbus Museum "The Chattahoochee: A River of History" August 13, 2006. <https://www.tfaoi.org/aa/6aa/6aa369.htm>.

WILLOUGHBY, LYNN. "Chattahoochee River" Jul 18, 2003. <https://www.georgiaencyclopedia.org/articles/geography-environment/chattahoochee-river/#:~:text=The%20Creeks%20named%20the%20river,marked%E2%80%9D%20or%20%E2%80%9Cflowered.%E2%80%9D&text=By%20treaty%2C%20the%20Creeks%20gradually,of%20the%20Chattahoochee%20by%201825.>

SPECK, JEFF. September 2013. "The walkable city" <https://www.jeffspeck.com/>.

"The Mighty Chattahoochee" <https://www.chattahoocheeriverconservancy.org/chattahoochee-river.html>.

HOLEYWELL, RYAN. "What Makes a Great City? Great Public Spaces. And These 6 Rules" October 3, 2016. <https://kinder.rice.edu/2016/10/03/what-makes-a-great-city-great-public-spaces.>

"Retrofitting Suburbia" <https://retrofitingsuburbia.com/>.

Project for Public Space. "What Makes a Successful Place?" <https://www.pps.org/article/grplacefeat.>

IMAGE INDEX

Photo 01
WEST END
PC: Curbed Atlanta
<https://atlanta.curbed.com/>

Photo 11
FALLS PARK
PC: GREENVILLE.GOV
<https://www.greenvillesc.gov/>

Photo 02
CHATTAHOOCHEE
PC: ATLANTA TRAILS
<https://www.atlantatrails.com/>

Photo 12
SAN ANTONIO RIVERWALK
PC: THE SAN ANTONIO RIVERWALK
<https://www.thesanantonioriverwalk.com/>

Photo 03
WHAT MAKES A SUCCESSFUL PLACE?
PC: PROJECT FOR PUBLIC SPACE
<https://www.pps.org/>

Photo 13
GOTHENBURG
PC: VISIT SWEEDEN
<https://visitsweden.com/>

Photo 04, 05, 06, 07
NATIVE AMERICAN HISTORY
PC: FLOW THROUGH TIME
<https://www.georgiaencyclopedia.org/>

Photo 14
ASAH RIVER FRONT
PC: CHUSHIKOKU AND TOKYO
<https://visitjapan-vegetarian.com/>

Photo 08, 09, 10
ATLANTA HISTORY
PC: BUCKHEAD
<https://www.buckhead.com/>

Photo 15, 16, 17, 18, 19, 20
STANDING PEACHTREE SITE
PC: GOOGLE MAPS
<https://www.google.com/maps/>

A T L A N T A

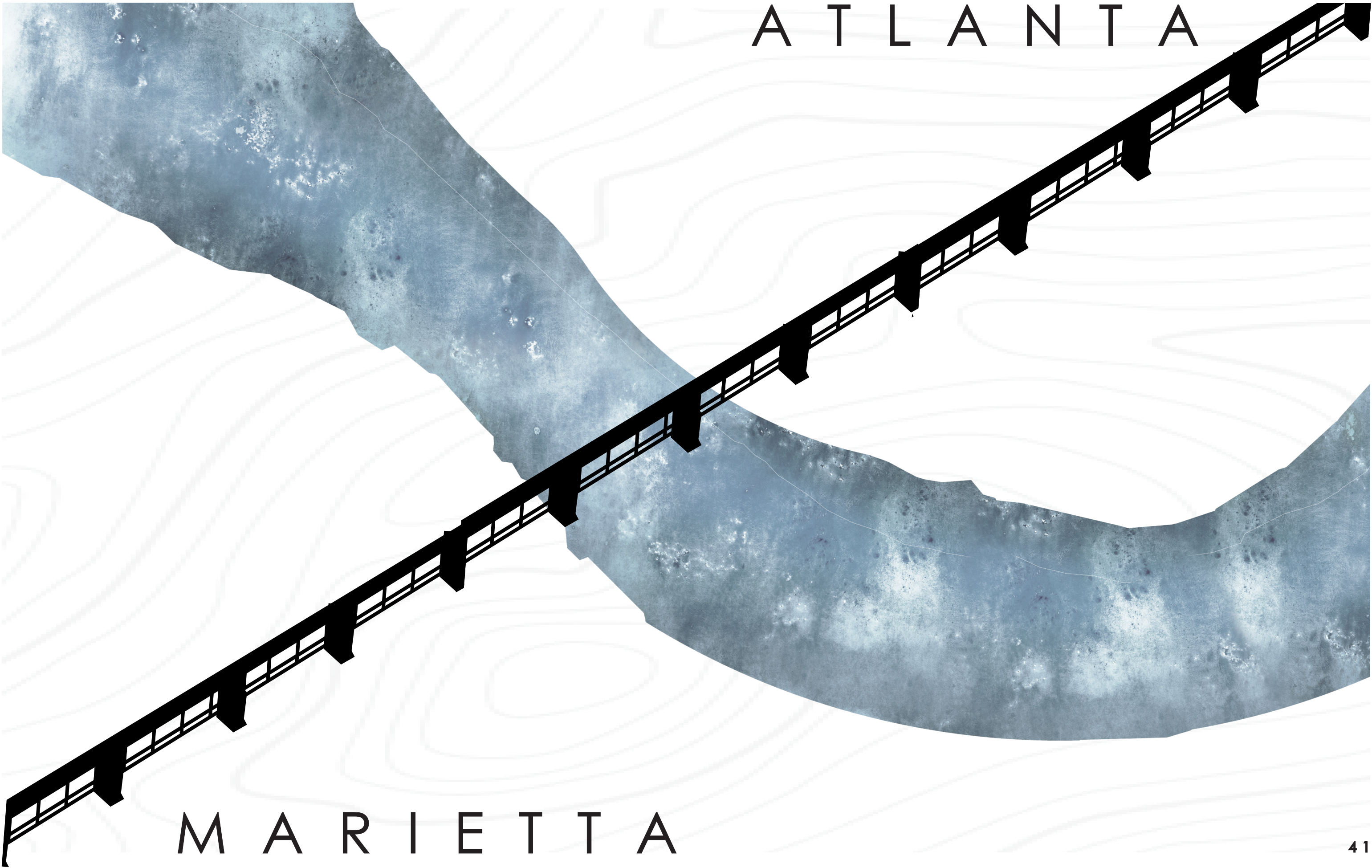

M A R I E T T A