



Western Michigan University  
ScholarWorks at WMU

---

Legacy Scout Tickets from Pure Oil Company

---

8-20-2021

**MGRRE\_PureOilScoutTickets\_Alger, Charles M et  
al\_1\_21123109820000**

MGRRE

*Western Michigan University*

Follow this and additional works at: <https://scholarworks.wmich.edu/pure>



Part of the Geology Commons

---

#### **WMU ScholarWorks Citation**

MGRRE, "MGRRE\_PureOilScoutTickets\_Alger, Charles M et al\_1\_21123109820000" (2021). *Legacy Scout Tickets from Pure Oil Company*. 7658.

<https://scholarworks.wmich.edu/pure/7658>

This Document is brought to you for free and open access via ScholarWorks at WMU. It has been accepted for inclusion in Legacy Scout Tickets from Pure Oil Company by an authorized administrator of ScholarWorks at WMU. See the National Digital Catalogue - Science Base Catalogue for more collections submitted by MGRRE.



---

**MGRRE\_PureOilScoutTickets\_Alger, Charles M et al\_1\_21123109820000**

API 21123109820000

Permit Number 10982

Lease Name Alger, Charles M et al

Well Number 1

County Newaygo

Township 14N

Range 11W

Section 8

2021 DEQ or Pure co\_name Mid Michigan Gas Storage Company

Pure Number 179

Latitude 43.623805

Longitude -85.656822

THE PURE OIL COMPANY

LOCATION REPORT

Date August 16, 1944 A.F.E. No. Charles M. Alger et al  
 Division Mich. Producing District \_\_\_\_\_ Lease Chas. M. Alger, et al  
 Acres \_\_\_\_\_ Lease No. \_\_\_\_\_ Elevation \_\_\_\_\_ Well No. 1 (Serial No. 179)  
 Quadrangle C NW Sec. 8 Twp. 14 N Rge. 11 W Twp. Goodwell  
 Survey \_\_\_\_\_ County Newaygo State Michigan  
 Operator Mich. Cons. Gas Co. & Cities Service Oil Co. Map Goodwell township - Newaygo Co.  
320 1320 Feet from North Line of Lease Oil Co.

“ “ East “ “ “  
 “ “ South “ “ “  
1320 1320 “ “ West “ 1/4 “  
1320 1320 Feet from North Line of Section  
 “ “ East “ “ “  
 “ “ South “ “ “  
1320 1320 “ “ West “ “ “

LEGEND

- ☀ Gas Well
- Oil Well
- ☀ Gas - Distillate Well
- ⊙ or ○ Dry Hole
- Dry Showing Oil
- Location
- ☀ Dry Showing Gas
- ⊙ Abandoned Location
- ☀ or ☀ Abandoned Gas Well
- or ● Abandoned Oil Well
- or ○ Input Well

*Low*

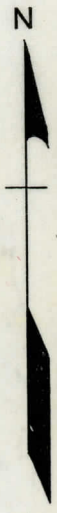
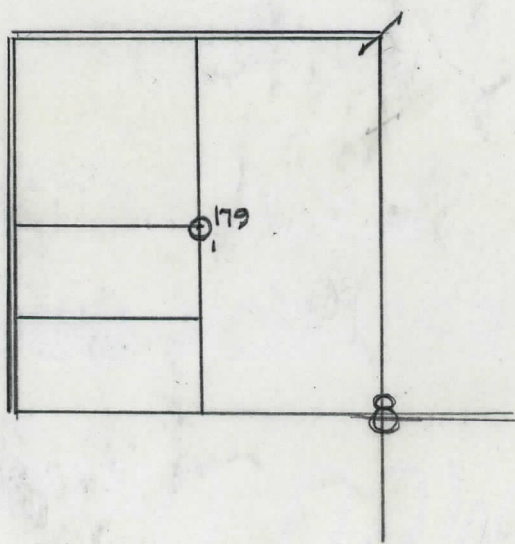

Scale \_\_\_\_\_

Remarks: \_\_\_\_\_  
 \_\_\_\_\_  
 \_\_\_\_\_

Submitted by RN Civil Engineer Approved by \_\_\_\_\_ Division Manager  
 Approved by \_\_\_\_\_ Vice-President - General Manager

LOCATION REPORT

COMPLETION RECORD OF WELLS DRILLED BY OTHER OPERATORS

Michigan Producing Division

T.P.D.  
(2)

Date September 7, 1944 No. 179  
 State Mich. County Newaygo ~~XXXX~~ Twp. Goodwell Sec. 8 Twp. 14 N Rge. 11 W  
 Well No. 1 (Serial No.) ~~(XXXXXX)~~ 179 Farm Chas. M. Alger, et al Acres \_\_\_\_\_  
 Operator Mich. Consolidated Gas Co. - Information secured ~~XXXX~~ By Scouting Department  
Cities Service Oil Co.  
 Date well started 8-31-44 Date well completed 9-5-44 Elevation 1063.3

PRODUCTION BOARD

1st 24 hours natural 10,100,000 Cu. Ft.  
 2nd 24 hours natural \_\_\_\_\_  
 Date of shot \_\_\_\_\_ No. of quarts \_\_\_\_\_ From \_\_\_\_\_ to \_\_\_\_\_ From \_\_\_\_\_ to \_\_\_\_\_  
 Date of acid \_\_\_\_\_ No. of gallons \_\_\_\_\_  
 1st 24 hours after acid shot \_\_\_\_\_  
 2nd 24 hours after acid shot \_\_\_\_\_

FORMATION AND CASING RECORD

Formation	Top	Bottom	Top Pay	Bottom Pay	Remarks	Casing	
						Size	Set at
Brown Dolomite	1042	(+22)		(93)		8-5/8"	231
Mich. Stray	1136	(-72)	1137	1140		5-3/16"	1134
			1142	1153			
Total Depth		1153	(-89)				

Remarks \_\_\_\_\_  
 \_\_\_\_\_  
 \_\_\_\_\_

Signed D. C. Shackelford