



Western Michigan University  
ScholarWorks at WMU

---

Legacy Scout Tickets from Pure Oil Company

---

8-20-2021

**MGRRE\_PureOilScoutTickets\_Jones, William  
M.\_1\_21117035690000**

MGRRE  
*Western Michigan University*

Follow this and additional works at: <https://scholarworks.wmich.edu/pure>



Part of the Geology Commons

---

#### **WMU ScholarWorks Citation**

MGRRE, "MGRRE\_PureOilScoutTickets\_Jones, William M.\_1\_21117035690000" (2021). *Legacy Scout Tickets from Pure Oil Company*. 6550.  
<https://scholarworks.wmich.edu/pure/6550>

This Document is brought to you for free and open access via ScholarWorks at WMU. It has been accepted for inclusion in Legacy Scout Tickets from Pure Oil Company by an authorized administrator of ScholarWorks at WMU. See the National Digital Catalogue - Science Base Catalogue for more collections submitted by MGRRE.



---

**MGRRE\_PureOilScoutTickets\_Jones, William M.\_1\_21117035690000**

API 21117035690000

Permit Number 3569

Lease Name Jones, William M.

Well Number 1

County Montcalm

Township 12N

Range 07W

Section 11

2021 DEQ or Pure co\_name Wolverine Natural Gas Company

Pure Number 459

Latitude 43.43884

Longitude -85.12191



DATE September 24, 1936 THE PURE OIL COMPANY Serial No. 459  
 Date July 18, 1942 LOCATION REPORT A.F.E. No. \_\_\_\_\_  
 Division Mich. Producing District \_\_\_\_\_ Lease William Jones  
 Acres \_\_\_\_\_ Lease No. \_\_\_\_\_ Elevation \_\_\_\_\_ Well No. 1  
 Quadrangle C SW SW ~~XXXX~~ Sec. 11 Twp. 12 N Rge. 7 W ~~XXXX~~ Twp. Belvidere  
 Survey \_\_\_\_\_ County Montcalm State Michigan  
 Operator Wolverine Natural Gas Corp. Map Belvidere Township, Montcalm County

\_\_\_\_ Feet North of South Line of Lease  
 " East " West " " "  
 " South " North " " "  
 " West " East " " "  
 \_\_\_\_ Feet North of South Line of Section  
 " East " West " " "  
 " South " North " " "  
 " West " East " " "

**LEGEND**

- Location
- ☀ Gas Well
- Oil Well
- ⊘ or ○ Dry Hole
- or ● Dry Showing Oil
- ☀ Dry Showing Gas
- ⊘ Abandoned Location
- ☀ or ☀ Abandoned Gas Well
- or ● Abandoned Oil Well

Plugged and abandoned 6-8-42.  
 Total Depth 1250'.



Remarks: \_\_\_\_\_  
 \_\_\_\_\_  
 \_\_\_\_\_  
 \_\_\_\_\_

Submitted by \_\_\_\_\_ Civil Engineer Approved by \_\_\_\_\_ Division Manager  
 Approved by \_\_\_\_\_ Vice-President - General Manager



STATE Michigan COUNTY Montcalm DIST. Belvidere SEC. 11 TOWN 12 N. RANGE 7 W.

WELL No. 1 (SERIAL No. 459) FARM William Jones ACRES \_\_\_\_\_

NAME OF STREAM OR WATERS \_\_\_\_\_ QUADRANGLE C-SW-SW  
C SW SW

OPERATOR Wolverine Natural Gas Corporation Map Belvidere Township, Montcalm County

660 660 Feet from North Line of Farm

660 660 " " East " " "

" " South " " "

" " West " " "

Feet from North Line of Section

" " East " " "

660 660 " " South " " "

660 660 " " West " " "

*July 46 ✓*  
*84-461-9-21-36*

- LEGEND**
- LOCATION
  - ⊕ RIG
  - ⊕ DRILLING
  - ☀ GAS WELL
  - OIL WELL
  - ⬮ SMALL OIL WELL
  - ⊙ DRY HOLE
  - ⬮ DRY SHOWING OIL
  - ☀ DRY SHOWING GAS
  - ⊙ ABANDONED LOCATION
  - ☀ ABANDONED GAS WELL
  - ⬮ ABANDONED OIL WELL

NOTE: Below make tracing from map, (when no map is obtainable make sketch) showing farm, center of section, this location with measurements and also wells, dry holes, or other locations in the vicinity of this location.

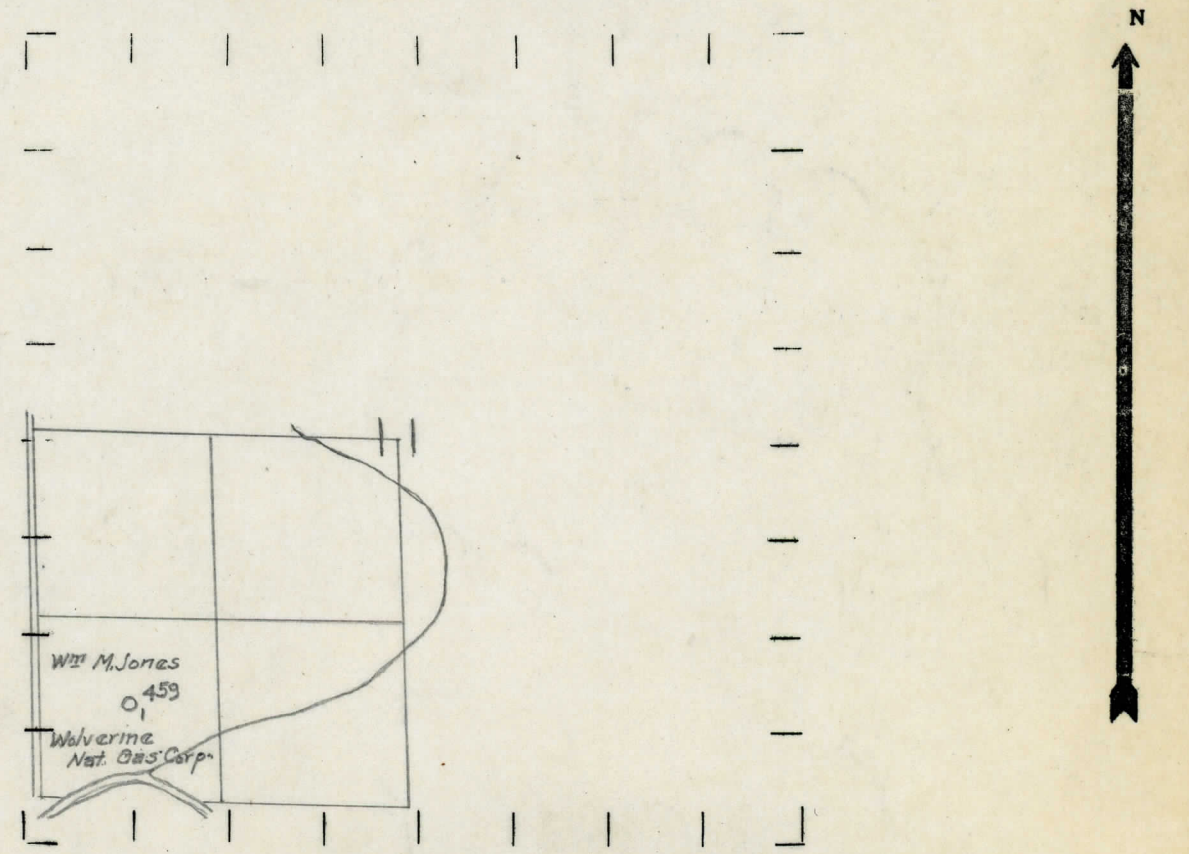

REMARKS: \_\_\_\_\_  
 \_\_\_\_\_  
 \_\_\_\_\_

SIGNED \_\_\_\_\_  
 Superintendent or Foreman.



