

Kean University

## Kean Digital Learning Commons

---

Liberty Hall Collection 1780s

Liberty Hall Collection

---

10-31-1785

### Memorandum and Survey about Wolf Harbour Lands, October 31, 1785

Jonathan Crane

Follow this and additional works at: [https://digitalcommons.kean.edu/lhc\\_1780s](https://digitalcommons.kean.edu/lhc_1780s)

---

#### Recommended Citation

Crane, Jonathan. *Memorandum and Survey about Wolf Harbour Lands, October 31, 1785*. Manuscript. From Special Collections Research Library and Archives, Kean University, *Liberty Hall Collection 1780s*. [https://digitalcommons.kean.edu/lhc\\_1780s/71](https://digitalcommons.kean.edu/lhc_1780s/71)

This Manuscript is brought to you for free and open access by the Liberty Hall Collection at Kean Digital Learning Commons. It has been accepted for inclusion in Liberty Hall Collection 1780s by an authorized administrator of Kean Digital Learning Commons. For more information, please contact [learningcommons@kean.edu](mailto:learningcommons@kean.edu).

31<sup>st</sup> Octobr 1785-

Went to New Ark to see the three Tracts at Wolf Harbour - They were shown to me by old Mr. Heady who lives abt one mile  $\frac{1}{4}$  from New Ark on the Mountain Road and near the Lands -

N<sup>o</sup> 2. is the first Tract on the left hand side of the Road, leading from New Ark to the Mountains - Mr. Heady informed me that about half of this Tract next the Road is in possession of ~~Ben~~ Benjamin Coe, it has been planted this year with In<sup>dian</sup> Corn, & is in June - and the other half <sup>in the rear is</sup> in possession of old Samuel Allen who lives opposite nearly to Mr. Boudinots.

I called on old Mr. Allen, & asked him if he was inclined to purchase he answered that the Land was his own - That his Father & Grandfather had <sup>upward of</sup> been in Possession of it 80 Years, and he wanted no better Title - I called twice on Coe, but he was from home - I hear he talks the same Language w<sup>th</sup> Allen.

N<sup>o</sup> 1. is the Tract on the left hand of the Swamp, after you pass the Wolf Harbour - David Ogden <sup>of this</sup> sold 12 Acres in front on the road - In the rear of wh. is a piece of this Tract formerly in possession of Sam<sup>l</sup>. Nutman whose Execution -

Executors sold it to Jonathan Sears of Newark  
who lives where Jabez Harrison formerly lived  
nearly opposite Mr. Boudinots - Saw Sears -  
he says that he bought the Land last Spring -  
from the Ex<sup>rs</sup> of Sam<sup>l</sup> Nutman - for £80: that  
it is as much as the Land is worth - that he  
shall claim under Prittens right, & will not  
purchase again, but will defend any suit  
brought against him - Nutman of Elizab<sup>th</sup> Town  
leather Brecker maker is one of the Ex<sup>rs</sup> of Sam<sup>l</sup>  
Nutman de<sup>d</sup> -

Old Mr. Heady informed me  
that he was in possession of Nutmans piece since  
his death - & sold the possession to Jonathan Sears  
last Spring for £12: which he now refuses to  
pay -

Part of this Lot, which was in Possession of Prodyon  
has been purchased by Elisha Boudinot - and  
abt 10 Acres of the Lot whereon there is a  
Peach Orchard has been purchased by Samuel  
Hay, the Surveyor at Newark -

Novemb<sup>r</sup> 1<sup>st</sup> Saw Hay's who says he has paid 30/ per acre  
for

for the Land, he is not willing to purchase at present, but chuses to wait until he sees whether any of the others can be dispossessed he however says if Ejectments are brought agst any of the Present Possessors that he will not join them. to defend the Suit.

31<sup>st</sup> October. Called on Sam<sup>l</sup> Pennington who says that he will not give any thing for our Title that he and his Ancestors have been in possession of the Land since the Year 1690, odd. That he shall claim it under the Concessions of the General Proprietors to his Ancestor, who was to have 100. Acres in New Ark. that they never had more than the Lot he lives on, in New Ark & the piece of Woodland at Wolf Harbour both of whi. will not amount to one hundred Acres - That we may bring an Ejectment, when ever we will, & that he will defend it.

31<sup>st</sup> October 1705  
Memorandum abt.  
Wolf Harbour Lands.

---

9,401  
 4,900  
 34,435  
 30,485  
 7,900  
 187,021 / 435 Ave,

11,9  
 7,9  
 1071  
 833  
 9,401

17,5  
 2,8  
 1400  
 320  
 4,900

48,5  
 7,1  
 485  
 3395  
 34,435

33,5  
 9,1  
 335  
 3015  
 30,485

13  
 6  
 7,8

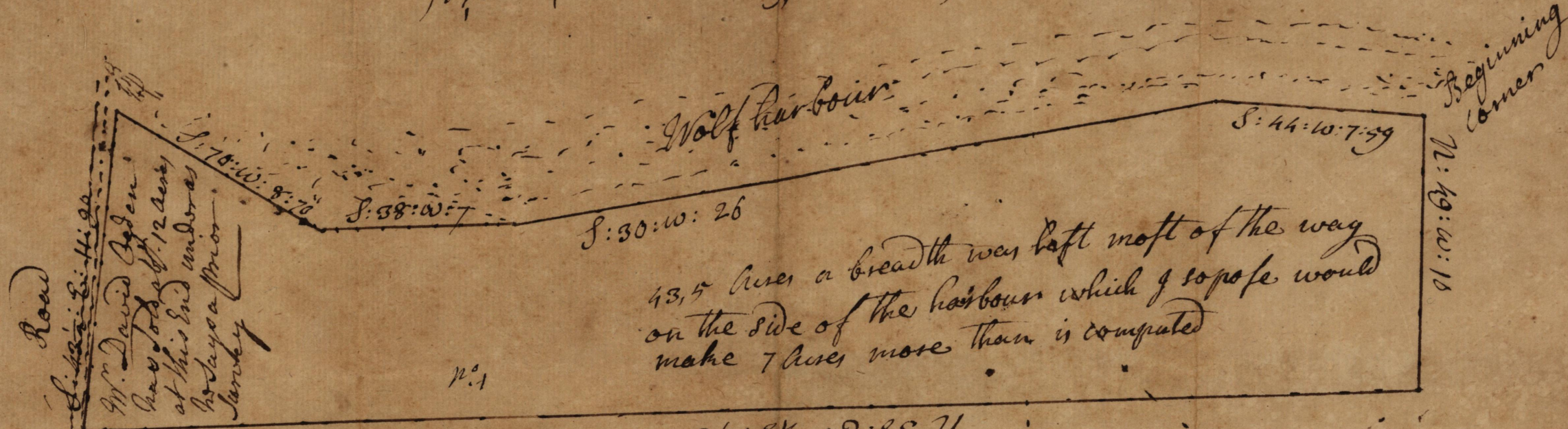

Done by a Scale  
 of 400 & 80 Links  
 to an inch

Jonathan Crane

05: 84 : 3: 88 U

Survey on proprietors right

23,8  
 10,2  
 ---  
 476  
 2380  
 ---  
 24,276

244  
 10  
 ---  
 2440

24338

1676



Done by a Scale of 10 Ch.  
 to an inch