

2-22-2021

Shovel Test Pit Paperwork of Transect 21 from Penny (8BR158)

Lauren Lehman
University of Central Florida

Amara Williams
University of Central Florida

Megan McCauley
University of Central Florida

Find similar works at: <https://stars.library.ucf.edu/penny-surveys>
University of Central Florida Libraries <http://library.ucf.edu>

This STP Paperwork is brought to you for free and open access by the Penny Site (8BR158) at STARS. It has been accepted for inclusion in Penny Site Survey by an authorized administrator of STARS. For more information, please contact STARS@ucf.edu.

Recommended Citation

Lehman, Lauren; Williams, Amara; and McCauley, Megan, "Shovel Test Pit Paperwork of Transect 21 from Penny (8BR158)" (2021). *Penny Site Survey*. 16.
<https://stars.library.ucf.edu/penny-surveys/16>

SHOVEL TEST FORM

Project Name: CCAMP5
 Site Name and #: PEAWY 8 BR158
 Transect No. 21 Shovel Test No: 1 Size: 50cm² Date: 02/22/2021
 Excavators: LL, AW Recorded by: Megan McCauley

EXCAVATION METHODS:

Soil Screened? Yes No Screening Method: Water Dry Mesh Size: 1/16" 1/8" 1/4"

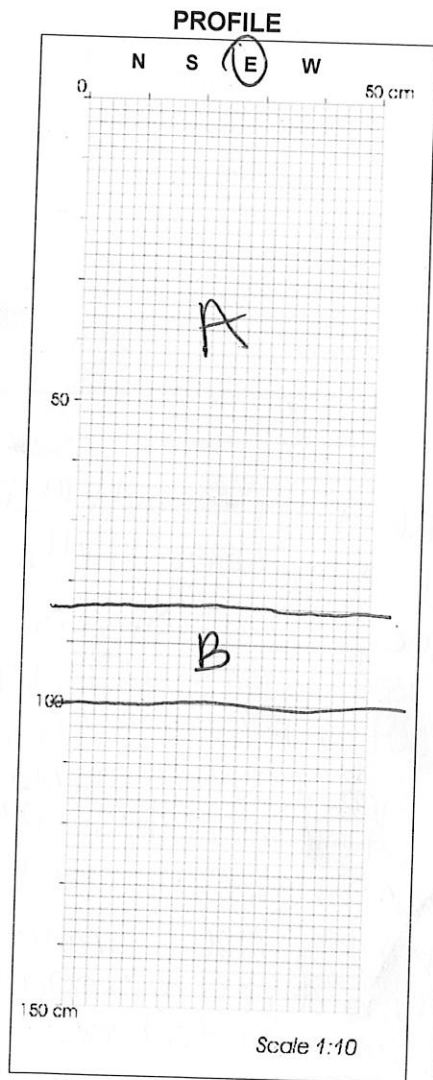

STRATIGRAPHY			
Zone	Depth (cmbs)	Munsell	Description
A	0-84	7.5Yr 2.5/1	black damp, sandy; roots
B	84-100	10Yr 3/2	Very dark grayish brown Same texture; less rooty
C			
D			
E			
F			
G			
H			
I			
J			

ARTIFACTS:

Yes No FS Number: _____ Total Number of Bags: 1
 Cultural Zone: Approx. Depth of First Artifact: 15 cmbs Approx. Depth of Last Artifact: 100 cmbs
 Artifacts Density: Increases with depth Decreases with depth Same NA

Artifacts Distribution: Evenly distributed Concentrated in one of more areas/levels NA

Description: one animal tooth found, small pieces of charcoal found, small piece of possible animal remains

ARTIFACT CONTENT:

- Prehistoric Ceramics
- Lithics
- Shell
- Modified Shell
- Faunal Remains
- Charcoal
- Modified Faunal Remains
- Human Remains
- Metal
- Glass
- Historic Ceramics
- Masonry
- Bead
- Coin
- Bottle
- Fired Clay/daub
- Other: Animal Remains

Description: Animal tooth found, small pieces of charcoal, along with small pieces of bone.

FEATURES:

- Yes No
- Depth Below Surface: _____ Size: _____ cm
- Possible Post Mold
- Hearth
- Burial
- Trash Pit
- Well
- Cistern
- Foundation
- Artifact Concentration
- Living Floor
- Charcoal Concentration
- Midden
- Soil Discoloration
- Other: _____
- Unknown at this time

Description: _____

SPECIAL SAMPLES:

- Yes No
- Special Sample Number: _____
- C14
- Flotation
- Pollen
- Sediment/Soil
- Other _____

Description: _____

NOTES: Oriented East/West; on East side of the mound (at bottom).

W/in first shovel; Calcium Carbonate found, small curly shell, small roots at the top; small piece of charcoal found; turtle carapace found at around 15 cmbs. STP is very rooty, therefore soil being brought up is rooty; many calcium concentrations being found. Soil is dark grey. Small pieces of charcoal being found. STP is very rooty at the bottom making it hard to get clean walls; found small bone and animal tooth found at 17 cmbs. Small snail shells & small pieces of charcoal found; more calcium deposits, small pieces of possible bone, and small pieces of charcoal found. Soil color changed to tanish-grey at 89 cmbs. More charcoal being found; more calcium deposits found, but mostly roots being found. ~~found at 100 cmbs~~ possible fish palate found. Animal at 100 cmbs

Crew Chief's Review & Approval: _____

Principal Investigator's Approval: _____

SHOVEL TEST FORM

Project Name: Clamps
 Site Name and #: Penny BB2 158
 Transect No. 21 Shovel Test No: 2 Size: 50cm² Date: 02/22/2021
 Excavators: U, AW Recorded by: Megan McAuley

EXCAVATION METHODS:

Soil Screened? Yes No Screening Method: Water Dry Mesh Size: 1/16" 1/8" 1/4"

PROFILE

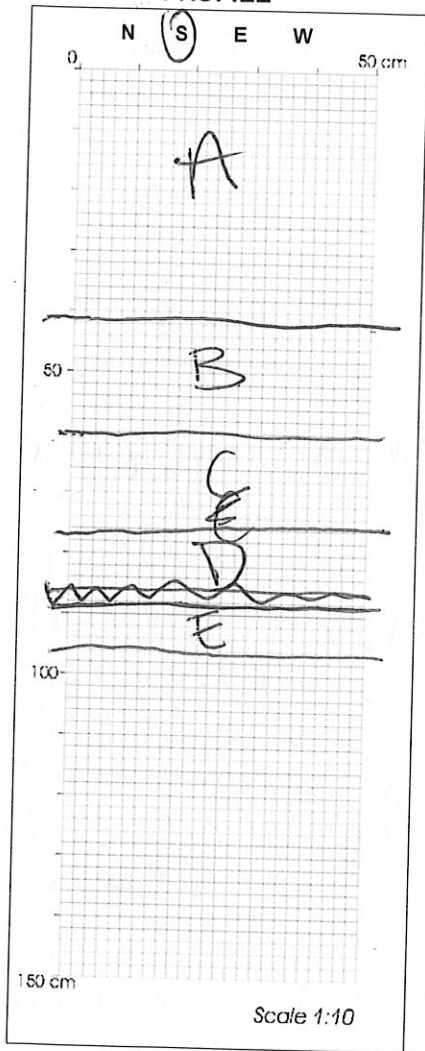

STRATIGRAPHY

Zone	Depth (cmbs)	Munsell	Description
A	0-41	2.5YR 2.5/1	reddish black top soil; rooty
B	41-60	10YR 2/2	very dark brown gritty soil
C	60-76	10YR 3/2	very dark grayish brown gritty / shelly / moist
D	76-89	10YR 4/2	dark grayish brown sandy, shell fragments
E	89-96	2.5Y 5/3	light olive brown CONCRETION level
F			
G			
H			
I			
J			

ARTIFACTS:

Yes No FS Number: _____ Total Number of Bags: 1

Cultural Zone: Approx. Depth of First Artifact: 0 cmbs Approx. Depth of Last Artifact: 88 cmbs

Artifacts Density: Increases with depth Decreases with depth Same NA

Artifacts Distribution: Evenly distributed Concentrated in one of more areas/levels NA

Description: pottery sherd found in first shovel full
Multiple pottery sherd / sherdettes found, as well
shell, one small & fish vertebrae found, conch shell found (large)

ARTIFACT CONTENT:

- Prehistoric Ceramics Lithics Shell Modified Shell Faunal Remains Charcoal
- Modified Faunal Remains Human Remains Metal Glass Historic Ceramics Masonry
- Bead Coin Bottle Fired Clay/daub Other: _____

Description: pottery sherds/sherdettes found, one small fish vertebral
~~vertebral~~ vertebrae found, 2 conch shells found

FEATURES:

- Yes No Depth Below Surface: _____ Size: _____ cm
- Possible Post Mold Hearth Burial Trash Pit Well Cistern Foundation
- Artifact Concentration Living Floor Charcoal Concentration Midden Soil Discoloration
- Other: _____ Unknown at this time

Description: _____

SPECIAL SAMPLES:

- Yes No Special Sample Number: _____
- C14 Flotation Pollen Sediment/Soil Other _____

Description: _____

NOTES: Oriented East/West; on ~~east~~ ^{North} ~~west~~ side of mound (at bottom)
 large pottery sherd in first shovel full (0 cmbs); large pieces of shell collected. Soil consists of ~~small~~ roots; dark grey in color. "Carriacou" shell collected. Soil is difficult to screen, more rock than soil, possible pottery sherds found at 48 cmbs. More pottery sherdettes at 55 cmbs. Soil change at 75 cmbs → to light brown fish vertebral + pottery sherdettes found at ~~soil~~ soil change; moist soil; another soil to shell layer w/ more moist soil → lots of shell inclusion at 88 cmbs. another soil change at 94 cmbs → grey, crummy soil; large conical shell pulled from stp. hit "bleach" sand. Soil gets more organic as you get toward the top. Barber found that pottery found was from two periods of human activities ~~Barber~~ called at 96 cmbs.

Crew Chief's Review & Approval: _____

Principal Investigator's Approval: _____

SHOVEL TEST FORM

Project Name: CCamps
 Site Name and #: Penny OBR 15B
 Transect No. 21 Shovel Test No: 3 Size: 50cm² Date: 02/22/2021
 Excavators: LL, AW Recorded by: Megan McCauley

EXCAVATION METHODS:

Soil Screened? Yes No Screening Method: Water Dry Mesh Size: 1/16" 1/8" 1/4"

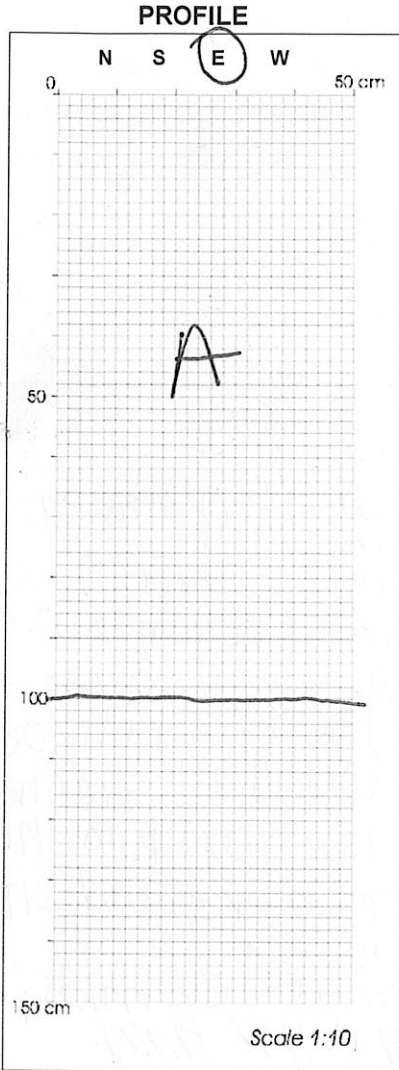

STRATIGRAPHY

Zone	Depth (cmbs)	Munsell	Description
A	0-100	7.5Yr 2.5/1	black wetish sand
B			
C			
D			
E			
F			
G			
H			
I			
J			

ARTIFACTS:

Yes No

FS Number: _____ Total Number of Bags: 1

Cultural Zone: _____ Approx. Depth of First Artifact: 0 cmbs Approx. Depth of Last Artifact: 84 cmbs

Artifacts Density: Increases with depth Decreases with depth Same NA

Artifacts Distribution: Evenly distributed Concentrated in one of more areas/levels NA

Description: Multiple pottery sherds, possible bead, faunal bones found; Stopped at 84 cmbs; bead was last thing found

ARTIFACT CONTENT:

- Prehistoric Ceramics Lithics Shell Modified Shell Faunal Remains Charcoal
- Modified Faunal Remains Human Remains Metal Glass Historic Ceramics Masonry
- Bead Coin Bottle Fired Clay/Daub Other: _____

possible

Description: pottery sherd letters found, many shells, possible bead, faunal bones

FEATURES:

- Yes No Depth Below Surface: _____ Size: _____ cm
- Possible Post Mold Hearth Burial Trash Pit Well Cistern Foundation
- Artifact Concentration Living Floor Charcoal Concentration Midden Soil Discoloration
- Other: _____ Unknown at this time

Description: _____

SPECIAL SAMPLES:

- Yes No Special Sample Number: _____
- C14 Flotation Pollen Sediment/Soil Other _____

Description: _____

NOTES: Oriented East/West; Stp on top ~~no~~ of the mound.

Soil is dark grey in color

Donox shell, bivalve shell, turtle shell found at surface layer (at 0cmbs); Barber found intact possible prehistoric Spanish "something". large pieces of shell being found. Soil is full of roots. concentrations being found. Shell being bagged. Snails, shell, possible bone being found at 30cmbs. more being collected at this stp, than at the other stp on the 15. pottery ~~sherd~~ found at 30cmbs; possible bone found at 48cmbs. faunal bone found along with more shell at 53cmbs; stp sherd letters ^{small} charcoal found ^{faunal}

Very rooty. roots cut w/ root cutters multiple times. lunch taken at 12:07. back at 12:58. Soil heavily rooted; shell and roots being found in the screen. fish palate and fauna remains found at 64cmbs, possible pottery and small bone found at 72cmbs; less roots after 72cmbs; in East corner/wall, hitting hard concretion ~~hard~~ - white in color. No soil color change well occurred; roots, ~~was~~ possible bead (bagged), shell being found at

Crew Chief's Review & Approval: _____

Principal Investigator's Approval: _____

84 cmbs. small pieces of charcoal still being found. AW is finding possible evidence of burning ~~was~~ w/ charcoal presence (more appearing) ~~was~~ hard sediments only being found in last shovel full. called at 100cmbs

SHOVEL TEST FORM

Project Name: Clamps
 Site Name and #: penny BBR 158 auger form
 Transect No. 21 Shovel Test No: 5 Size: 50cm² Date: 02/22/2021
 Excavators: LL, AW Recorded by: Megan McCauley

EXCAVATION METHODS:

Soil Screened? Yes No Screening Method: Water Dry Mesh Size: 1/16" 1/8" 1/4"

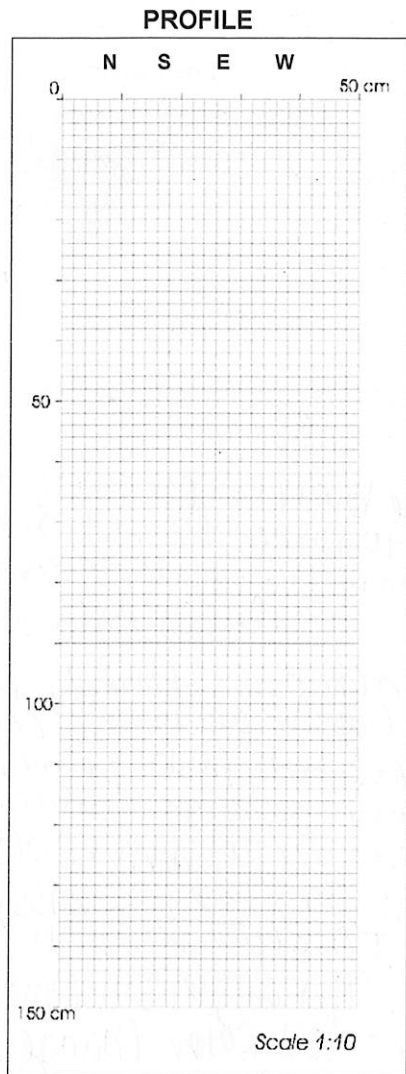

STRATIGRAPHY

Zone	Depth (cmbs)	Munsell	Description
A			
B			
C			
D			
E			
F			
G			
H			
I			
J			

ARTIFACTS:

Yes No

FS Number: _____ Total Number of Bags: 1 *new bags started*

Cultural Zone: Approx. Depth of First Artifact: 130 cmbs Approx. Depth of Last Artifact: 223 cmbs

Artifacts Density: Increases with depth Decreases with depth Same NA

Artifacts Distribution: Evenly distributed Concentrated in one of more areas/levels NA

Description: sterile by the 11th auger bucket; pottery sherd, shell and turtle carapace / fish vertebrae

ARTIFACT CONTENT:

- Prehistoric Ceramics Lithics Shell Modified Shell Faunal Remains Charcoal
- Modified Faunal Remains Human Remains Metal Glass Historic Ceramics Masonry
- Bead Coin Bottle Fired Clay/daub Other: _____

Description: pottery shards, shell, and fish vertebrae / turtle carapace

FEATURES:

- Yes No Depth Below Surface: _____ Size: _____ cm
- Possible Post Mold Hearth Burial Trash Pit Well Cistern Foundation
- Artifact Concentration Living Floor Charcoal Concentration Midden Soil Discoloration
- Other: _____ Unknown at this time

Description: _____

SPECIAL SAMPLES:

- Yes No Special Sample Number: _____
- C14 Flotation Pollen Sediment/Soil Other _____

Description: _____

NOTES: Soil was very compact w/in the bucket portion of the auger; Dr. Barber + Dr. Broff both worked together to get soil out.

1st auger is empty; 2nd auger again is compact; full of concretions/shell; nothing of archaeological importance but less than the 1st

3rd auger is less compact; more shell and concretions found; pottery found (2 pieces) -> 130 cmbs; 4th auger, soil looser and less compact, more donax and spp and conch shell found, fish vertebrae and turtle carapace, ~~small~~ small bone found. 5th auger, sandy, more concretions - 144 cmbs; 6th auger - more shell and ~~shell~~ roots

7th auger - breaking through roots, finding shell (162 cmbs) - still darker and organic extension added to auger 104r-312

8th auger - soil is moist, wood being found still - 182 cmbs; 9th auger, still concretions, ~~wood~~ being found, nothing else of interest; 10th auger - soil color change to darker gray - black at 199 cmbs; 11th auger - pottery sherd found, more compact / more soft in texture, better sorted, 11th auger - soil color change - 223 cmbs - tanish gray / beech sand color; homogeneous

12th auger - soil color change to yellow at 235 cmbs - wet soil 104r 413 brown

13th auger - yellow sand - sterile, only sand. - 246 cmbs

Crew Chief's Review & Approval: _____

Principal Investigator's Approval: _____

14th auger - met w/ the concretion layer, small shell layer. - 260 cmbs
 black soil } 2 mm layers
 yellow soil }
 concretion layer)

Munsel - 104r
 413
 pale brown

SHOVEL TEST FORM

Project Name: Clamps
 Site Name and #: penny BR 158 auger form
 Transect No. 21 Shovel Test No: 5 Size: 50cm² Date: 02/22/2021
 Excavators: LL, AW Recorded by: Megan McCauley

EXCAVATION METHODS:

Soil Screened? Yes No Screening Method: Water Dry Mesh Size: 1/16" 1/8" 1/4"

PROFILE

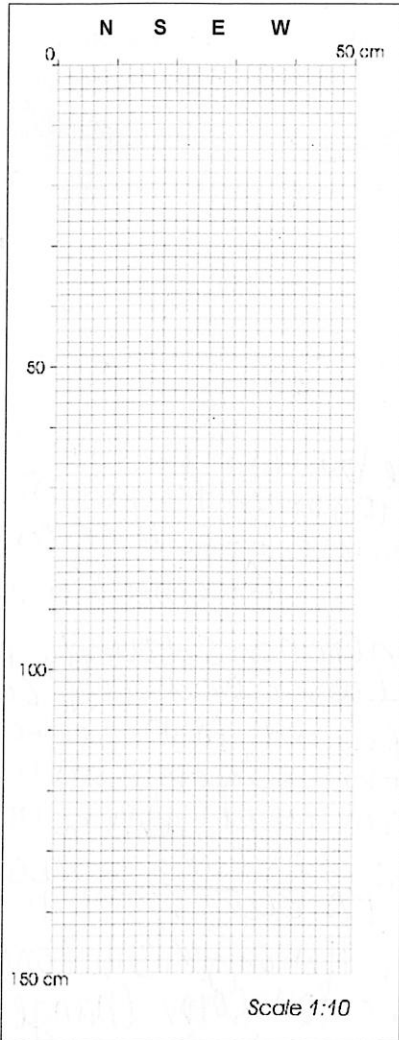

STRATIGRAPHY

Zone	Depth (cmbs)	Munsell	Description
A			
B			
C			
D			
E			
F			
G			
H			
I			
J			

ARTIFACTS:

Yes No FS Number: _____ Total Number of Bags: 1 *new bag started*

Cultural Zone: Approx. Depth of First Artifact: 130 cmbs Approx. Depth of Last Artifact: 223 cmbs

Artifacts Density: Increases with depth Decreases with depth Same NA

Artifacts Distribution: Evenly distributed Concentrated in one of more areas/levels NA

Description: sterile by the 11th auger bucket; pottery sherd, shell, and turtle carapace / fish vertebrae

ARTIFACT CONTENT:

- Prehistoric Ceramics
- Lithics
- Shell
- Modified Shell
- Faunal Remains
- Charcoal
- Modified Faunal Remains
- Human Remains
- Metal
- Glass
- Historic Ceramics
- Masonry
- Bead
- Coin
- Bottle
- Fired Clay/daub
- Other: _____

Description: pottery shards, shell, and fish vertebrae/turtle carapace

FEATURES:

- Yes No Depth Below Surface: _____ Size: _____ cm
- Possible Post Mold
- Hearth
- Burial
- Trash Pit
- Well
- Cistern
- Foundation
- Artifact Concentration
- Living Floor
- Charcoal Concentration
- Midden
- Soil Discoloration
- Other: _____
- Unknown at this time

Description: _____

SPECIAL SAMPLES:

- Yes No Special Sample Number: _____
- C14
- Flotation
- Pollen
- Sediment/Soil
- Other _____

Description: _____

NOTES: Soil was very compact w/in the bucket portion of the auger; Dr. Barber + Dr. Broff both worked together to get soil out. 1st auger is empty; 2nd auger again is compact; full of concretions/shell; nothing of archaeological importance but less than the 1st. 3rd auger is less compact; more shell and concretions found; pottery found (2 pieces) -> 130 cmbs; 4th auger, soil looser and less compact, more donax and spp and conch shell found, fish vertebrae and turtle carapace, ~~one~~ small bone found. 5th auger sandy, more concretions - 144 cmbs; 6th auger - more shell and ~~shell~~ roots. 7th auger - breaking through roots, finding shell (1 ea cmbs) - still darkened and organic extension added to auger 104r-312. 8th auger - soil is moist, wood being found still - 182 cmbs; 9th auger: still concretions, 104r-312. 10th auger - soil color change to ~~dark~~ being found, nothing else of interest; 11th auger - pottery sherd found, darker gray - black at 199 cmbs; 12th auger - pottery sherd found, more compact/more soft in texture, better sorted, 11th auger - soil color change - 223 cmbs - tanish gray/beaten sand color; homogeneous. 12th auger - soil color change to yellow at 235 cmbs - wet soil 104r 413 brown. 13th auger - yellow sand - sterile, only sand. - 246 cmbs

Crew Chief's Review & Approval: _____

Principal Investigator's Approval: _____

14th auger - met w/ the concretion layer, small shell layer. - 260 cmbs
 black soil } non layers
 yellow soil }
 concretion layer }
 Munsell 104r
 4/3
 pale brown

BBR158
PENNY SITE
CCMP 5
POSSIBLE MOUND
TRANSECT 21

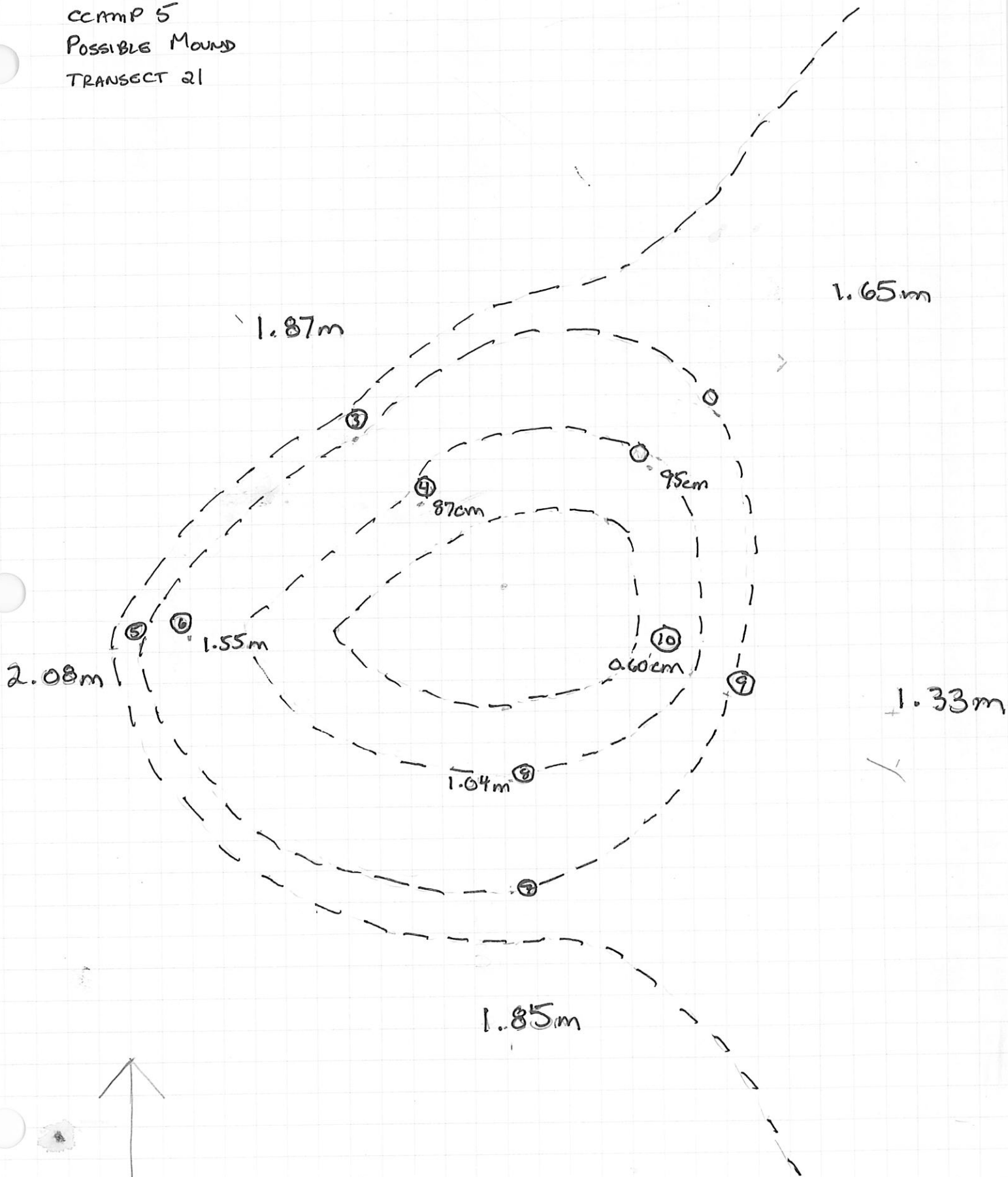

02/08/2021 Ashley Comstock
S.B.B., A.F.O., A.T.G.

பெரிய
பெரிய
பெரிய
பெரிய
பெரிய

மே.1

மே.1

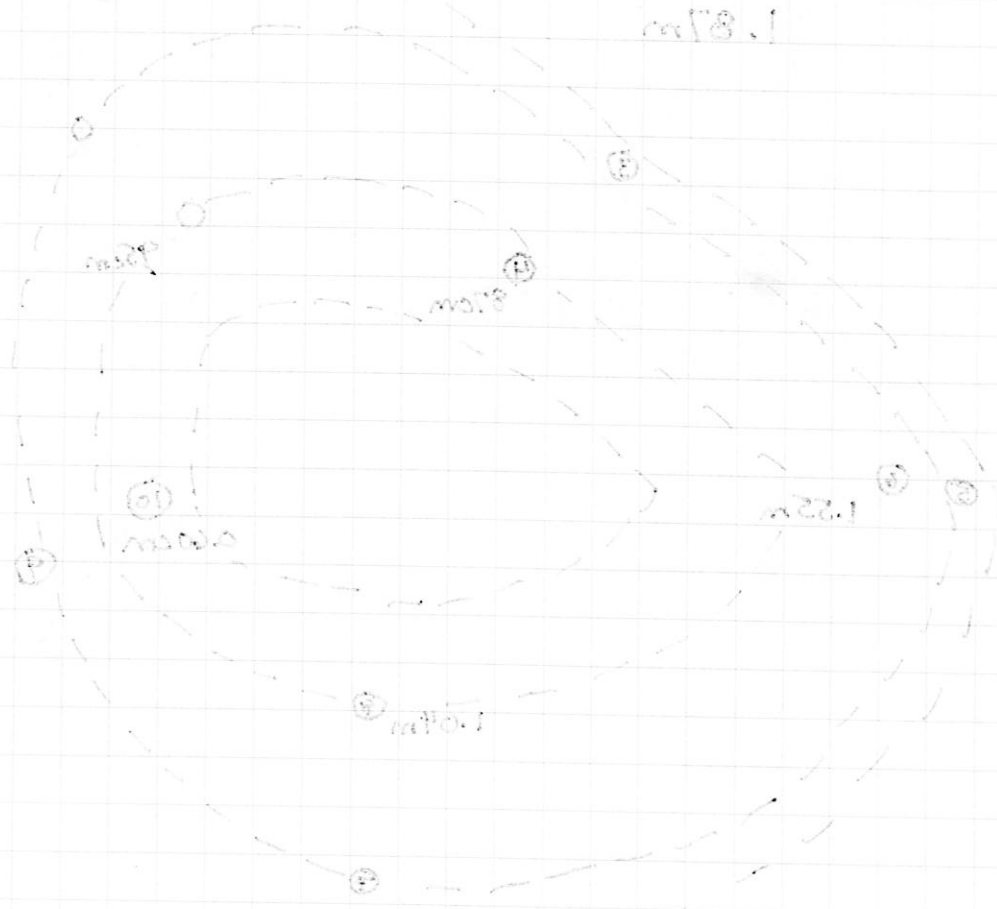

மே.1

மே.1

மே.1

T. 21

* 6° W declination *
Dr. Barber's
Compass → Disregard

Recorder: Ashley
Constable

~~Plot~~
→ 50m

* N.E = 1st m.m.
plum = distance mm. ∴

① → 5.5m

② → 1.65m vertical

③ → 3.75m midpoint topo

④ → Elevation = 95cm]

* N.E
of top
of mound

Asmuth = 59.239°

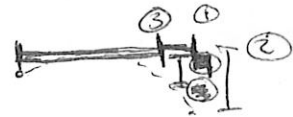

• Various types of shells,
oysters, conchs, bivalves,
some charcoal (unsure of
prehistoric)

→ 4.25m * N.W = 2nd m.m.

→ Elevation: 1.87m

→ Horiz. ∴ 2.30m

→ Vertical: 87cm] midpoint

Asmuth: 139.919°

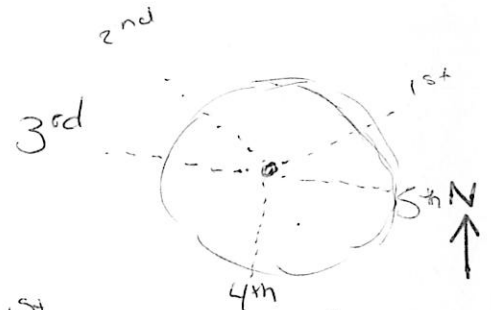

• 1st m.m. taken from the
top of mound towards
N.E (levelled)

• 2nd m.m taken from the
top of mound N.W
(levelled)

• 3rd m.m taken from the
top of mound towards
West

• 4th m.m taken from
the top of mound
towards South

• 5th m.m taken from the
top of mound towards
East

→ 7.47m

→ 2.08m vertical * S.W. 3rd m.m

→ 6.50m

→ Elevation: 1.55m] midpoint

Asmuth: 83.263°

→ 6.19m

* S. 4th m.m.

→ Elevation: 1.85m

→ 3.80m

→ Elevation: 1.04m] midpoint

Asmuth: 359.181°

* E. 5th m.m.

→ 5.08m

→ 1.33m Elevation

→ 3.28m

→ 0.60cm] midpoint

Asmuth: 295.115°

