



Western Michigan University
ScholarWorks at WMU

Legacy Scout Tickets from Pure Oil Company

8-20-2021

MGRRE_PureOilScoutTickets_MUTCH, J. O._1_21011034040000

MGRRE

Western Michigan University

Follow this and additional works at: <https://scholarworks.wmich.edu/pure>



Part of the Geology Commons

WMU ScholarWorks Citation

MGRRE, "MGRRE_PureOilScoutTickets_MUTCH, J. O._1_21011034040000" (2021). *Legacy Scout Tickets from Pure Oil Company*. 35.

<https://scholarworks.wmich.edu/pure/35>

This Document is brought to you for free and open access via ScholarWorks at WMU. It has been accepted for inclusion in Legacy Scout Tickets from Pure Oil Company by an authorized administrator of ScholarWorks at WMU. See the National Digital Catalogue - Science Base Catalogue for more collections submitted by MGRRE.



MGRRE_PureOilScoutTickets_MUTCH, J. O._1_21011034040000

API 21011034040000

Permit Number 3404

Lease Name MUTCH, J. O.

Well Number 1

County Arenac

Township 19N

Range 4E

Section 17

2021 DEQ or Pure co_name CALDWELL T F

Pure Number 40

Latitude 44.04257

Longitude -84.00857

Form 216 WELL REPORT - OUTSIDE OPERATIONS

SERIAL NO. 40

STATE Michigan ^{MSG} CO. Arenac

OPERATOR T. F. Caldwell, Inc.

FARM J. O. Mutch WELL NO. 1

TWP. Deep River S. 17 T. 19 N. 4 E

LOC. NE SE SE

WILDCAT FIELD FIELD NAME Deep River Gas

MAP NO. _____ CO-ORD. _____ ELEV. _____

STATUS Plugged and Abandoned 10-24-47

Total Depth 2948' - Plugged back to 1895'.

NORTH

DATE 11-12-47 SCOUT H.J.G.

DATE July 9, 1936

LOCATION REPORT

No. 40

STATE Michigan COUNTY Arenac DIST. Deep River TWP. Deep River SEC. 17 TOWN 18 N RANGE 4 E

WELL No. 1 (SERIAL No. 40) FARM 40 Match ACRES

NAME OF STREAM OR WATERS QUADRANGLE NE SE SE

OPERATOR T. F. Caldwell, Inc. Map Deep River Township, Arenac County

T. F. Caldwell, Inc. Feet from North Line of Farm

287 287 " " East " " "
768 768 " " South " " "
" " West " " "

Feet from North Line of Section

287 287 " " East " " "
768 768 " " South " " "
" " West " " "

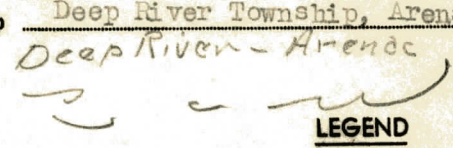

LEGEND

- O LOCATION
@ RIG
+ DRILLING
* GAS WELL
● OIL WELL
● SMALL OIL WELL
⊙ DRY HOLE
◆ DRY SHOWING OIL
⊙ DRY SHOWING GAS
⊙ ABANDONED LOCATION
* ABANDONED GAS WELL
● ABANDONED OIL WELL

NOTE: Below make tracing from map, (when no map is obtainable make sketch) showing farm, center of section, this location with measurements and also wells, dry holes, or other locations in the vicinity of this location.

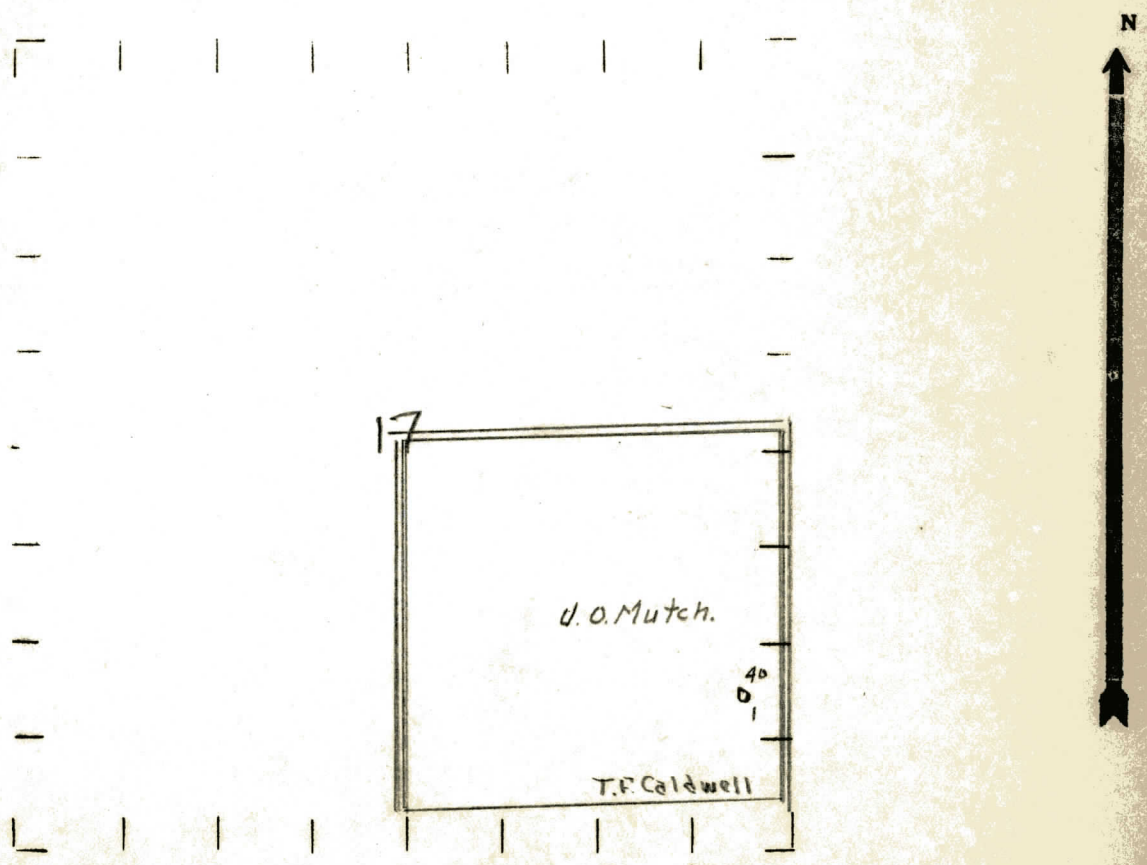

REMARKS:

SIGNED

H. L. Yeager
Superintendent or Foreman.

Michigan Producing Division

Date October 29, 1936 No. 40
 State Michigan County Arenac Dist. Deep River
 Twp. 17 Sec. 17 Twp. 19 N Rge. 4 E
 Well No. 1 (Serial No.) 40 Farm J. O. Mutch Acres _____
 Operator T. F. Caldwell, Inc. Information secured ~~from~~ by Scouting Department
 Date well started 7-19-36 Date well completed 8-29-36 Elevation 750

PRODUCTION RECORD

1st 24 hours natural Est. 100,000 cubic feet
 2nd 24 hours natural _____
 Date of shot 9-1-36 No. of quarts 60 From _____ to _____
 Date of acid 9-5-36 No. of gallons 500
 1st 24 hours after acid shot _____
 2nd 24 hours after acid shot _____

FORMATION AND CASING RECORD

Formation	Top	Bottom	Top Pay	Bottom Pay	Remarks	Casing	
						Size	Set At
Drift	0	185				10"	168
Marshall	275	365				8 1/2"	840
Red Rock	1275	1281				5-3/16"	2612
Sunbury	1415	1435					
Berea	1435	1525	1465	1483			
Antrim	1580	1956	1494	1500			
Traverse	1956						
Dundee	2761						
Total Depth		2948					
Plugged back		1895					

Remarks Show oil 1966-1968 - show oil 2078-2080-show oil 2779-show oil 2817-2825-show oil 2866-2871-show oil 2898-2945 -show salt water 2945-2948-pumped 3 bbls. oil and 3 bbls. salt water per day from Dundee - plugged back to gas in Berea.

Signed G. H. Bell

Michigan Producing Division

CORRECTED

CORRECTED

Date November 5, 1936 No. 40
 State Michigan County Arenac Dist. Deep River Sec. 17 Twp. 19 N Rge. 4 E
 Well No. 1 (Serial No.) (County No.) 40 Farm J. O. Mutch Acres _____
 Operator T. F. Caldwell, Inc. Information secured ~~xxxxx~~ Scouting Department by _____
 Date well started 7-19-36 Date well completed 8-29-36 Elevation 750

PRODUCTION RECORD

1st 24 hours natural Estimated 100,000 cubic feet
 2nd 24 hours natural _____
 Date of shot 9-1-36 No. of quarts 60 From _____ to _____ From _____ to _____
 Date of acid 9-5-36 No. of gallons 500
 shot
 1st 24 hours after acid _____
 shot
 2nd 24 hours after acid _____

FORMATION AND CASING RECORD

Formation	Top	Bottom	Top Pay	Bottom Pay	Remarks	Casing	
						Size	Set At
Drift	0	185				10"	168
Marshall	275	365				8 1/2"	840
Red Rock	1275	1281				5-3/16"	2612
Sunbury	1415	1435					
Berea	1435	1525	1465	1483			
Antrim	1580	1956	1494	1500			
Traverse	1956						
Dundee	2761						
Total Depth		2972					
Plugged back		1895					

Remarks Show oil 1966-1968-show oil 2078-2080-show oil 2779-show oil 2817-2825-show oil 2866-2871-show oil 2898-2945-show salt water 2945-2948-black water 2966-2972-filled up 250 feet. - Pumped 3 barrels oil and 3 barrels salt water per day from Dundee-plugged back to gas in Berea.

Signed G. H. Bell