

Zhou Documents

---

June 2021

## Project Proposal - Three works by Ni Haifeng

Hai-Feng NI 倪海峰

Follow this and additional works at: <https://digital.kenyon.edu/zhoudocs>

---

### Recommended Citation

NI 倪海峰, Hai-Feng, "Project Proposal - Three works by Ni Haifeng" (2021). *Zhou Documents*. 184.  
<https://digital.kenyon.edu/zhoudocs/184>

This Proposal is brought to you for free and open access by Digital Kenyon: Research, Scholarship, and Creative Exchange. It has been accepted for inclusion in Zhou Documents by an authorized administrator of Digital Kenyon: Research, Scholarship, and Creative Exchange. For more information, please contact [noltj@kenyon.edu](mailto:noltj@kenyon.edu).

Water-filled Metal Containers are hung outside of the Window. Use of them is slightly Leaking Water

TITLE: POST-ANARCHISM

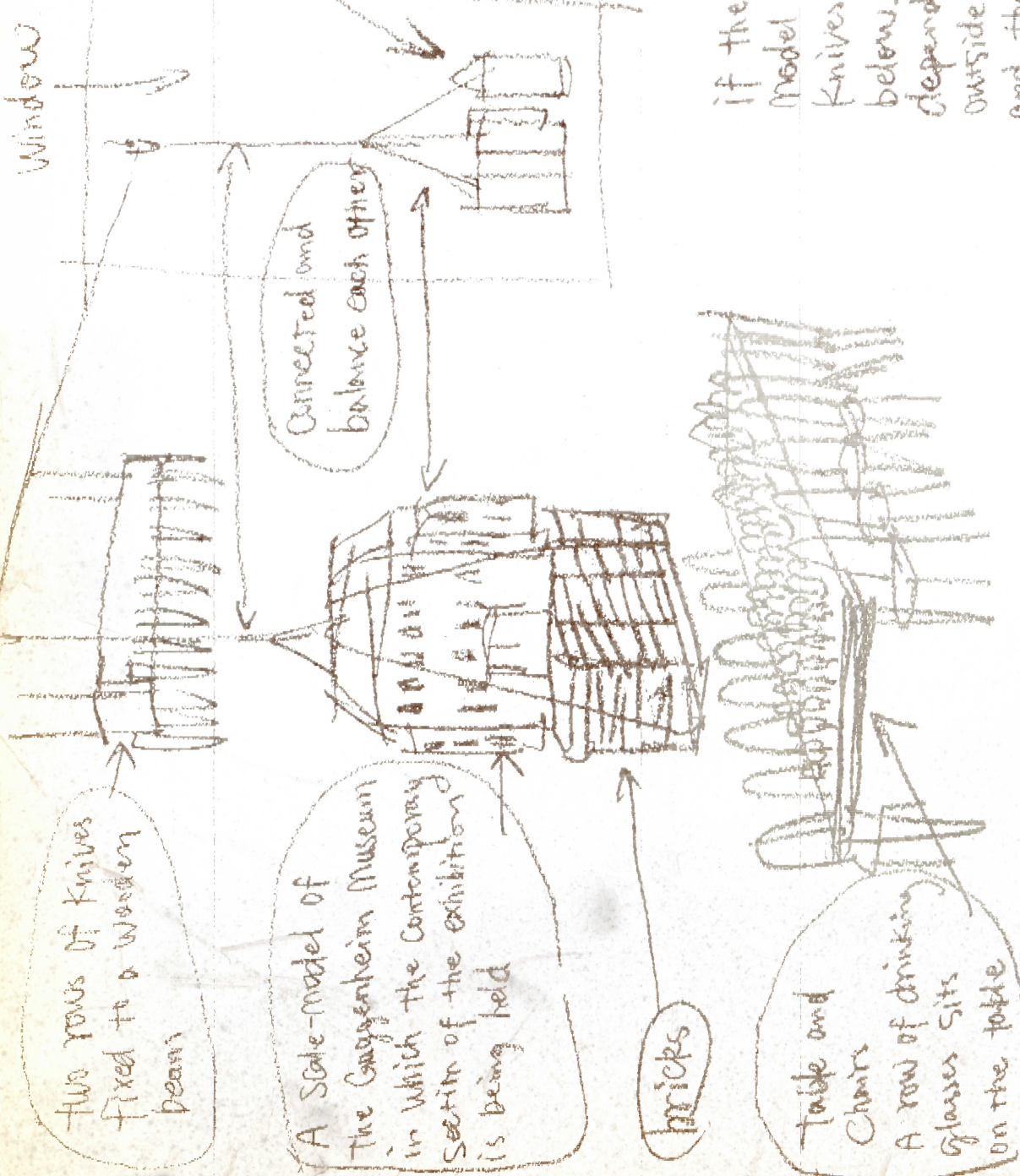

Two rows of Knives fixed to a wooden beam

A Scale-model of The Guggenheim Museum in which the Contemporary section of the exhibition is being held

bricks

Table and Chairs  
A row of drinking glasses sits on the table

Connected and balance each other

~~knives~~

knives  
— knives + table

if the balance is disrupted the Model will either be cut by the Knives above or destroy the glassware below. The position of the model depends on the Water Containers outside the exhibition space. The Leakage and the natural evaporation of the Water will cause a tendency for the model to fall. At the other hand, rain will increase the water level.

**Title: POST-ANARCHISM**

A scale-model of the Guggenheim Museum in which the contemporary section of the exhibition is being held and a number of bricks attached to it, are suspended from the ceiling nearby a window (or any kind of exit) by a rope or metal wire, leading through a construction on the ceiling. At the other end of the rope, outside the exhibition space, hangs a number of water-filled metal containers (cans or buckets). The containers can be seen both from outside and from inside the exhibition space, through the window. The model and the bricks on one side and the containers with water at the other, have the same weight and balance each other. However, one of the containers is slightly leaking.

Under the model and bricks, a dining-table and chairs are placed on the floor with a row of drinking glasses sitting on the table. Above the model, a wooden beam with knives fixed to it at both sides is attached to the ceiling. The blades are pointing at the model.

If the balance is disrupted the model will either be cut by the knives above or destroy the glassware below. The position of the model depends on the water containers outside the exhibition space. The leakage and the natural evaporation of the water will cause a tendency for the model and bricks to fall. At the other hand, rain will increase the water level in the containers.

Ni Haifeng

15.10.'96

# Title: EXODUS

Ni Hai Feng  
15/10/1996

A discarded container  
for shipping of goods.  
Position is  
horizontal



A Metal trellis-work  
construction connecting the  
container to a doorway.  
Inside the construction there  
is a trellis-work pathway  
Tilted over in an angle  
of  $5^\circ$

THE CONSTRUCTION FUNCTIONS  
AS A PORCH TO THE ENTRANCE  
OR THE EXIT OF THE EXHIBITION  
SPACE.

A wooden structure like  
the skeleton of a smashed  
down house.

Inside the structure a  
boarded pathway gives  
entry into the container.  
The pathway is tilted  
over in an angle of  $5^\circ$

Interior of the container =  
book-shelves filled with various  
kinds of goods such as parcels,  
hand luggage and items for daily  
use  
a long table on which is piled  
a great amount of the goods  
a pile of chairs is hanging from  
the ceiling of the container  
all the goods are labeled with  
numbers and mistaken  
math-formulas

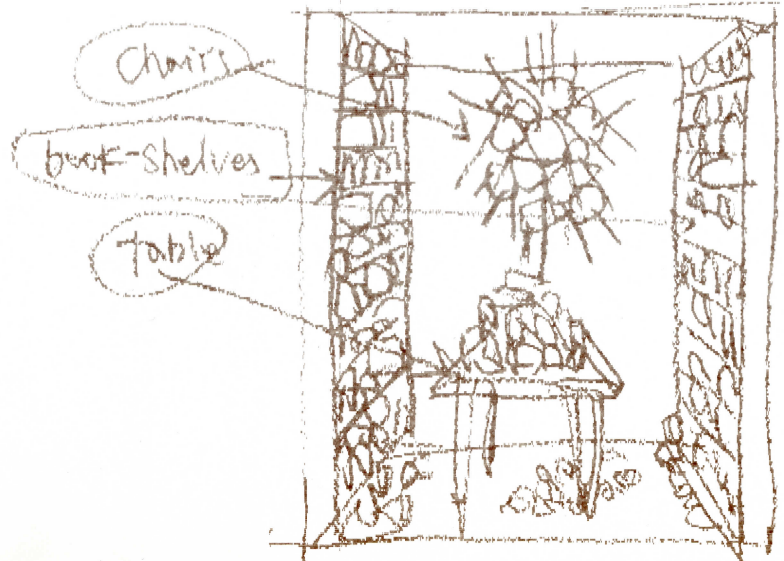

Title: EXODUS

A discarded container for the shipping of goods.  
Position is horizontal.

A wooden structure like the skeleton of a smashed down house.  
Inside the structure a boarded pathway gives entry into the container.  
The pathway is tilted over in an angle of 5 degrees.

A metal trellis-work construction connecting the container to a doorway.  
Inside the construction there is a trellis-work pathway tilted over in an angle of 5 degrees.

Interior of the container:

Bookshelves filled with various kinds of goods, such as parcels, hand luggage and items for daily use.

A long table on top of which is piled a great amount of the goods.

A bundle of chairs is hanging from the ceiling of the container.

All the goods are coated white and written over with numbers and mistaken mathematics.

The construction functions as a porch to the entrance or the exit of the exhibition space.

Ni Haifeng

15.10.'96

ITEL =  
CENTRAL  
CONFIRMATION

Haifeng  
15.10.1996

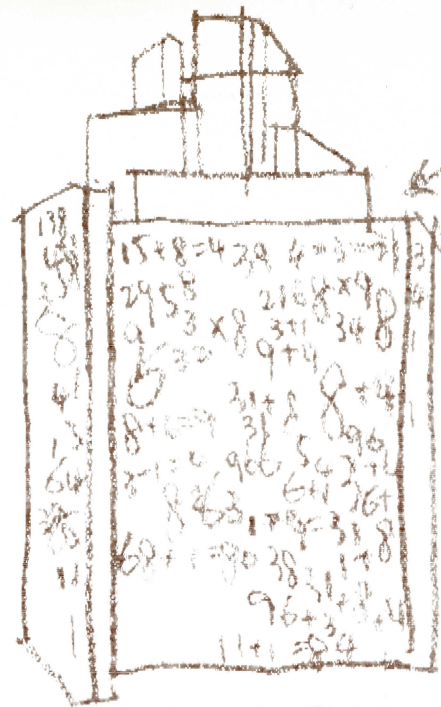

LABYRINTH WITH  
WALLS ARE COVERED  
WITH NUMBERS  
AND MISTAKEN  
MATHEMATICS

AT THE CENTRE OF THE LABYRINTH =  
~~AS~~ A CABIN FOR AUTOMATIC  
PHOTO SERVICE AS ONE CAN FIND  
IN f.i. A TRAINSTATION

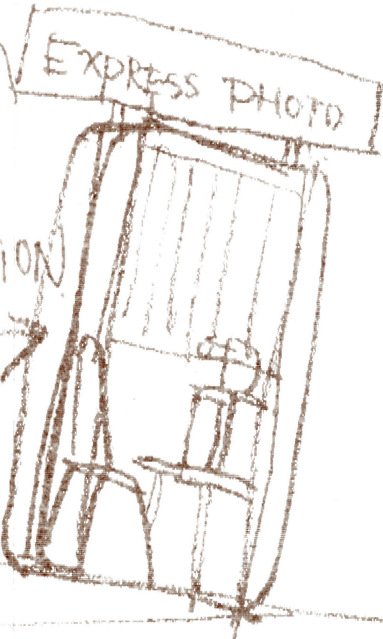

INSTEAD OF A  
CAMERA - A VIDEO-  
CAMERA AND MONITOR

5°



LAYOUT

THE PORTRAIT OF THE VIEWER  
WHO SITS DOWN IN FRONT OF  
THE VIDEO-CAMERA WILL BE  
SHOWN ON THE MONITOR  
WRITTEN OVER WITH  
NUMBERS AND MISTAKEN  
MATHEMATICS. (THROUGH  
THE WORKING OF A CERTAIN  
SOFTWARE PROGRAMM



Title: CENTRAL CONFIRMATION

Labyrinth with walls covered with numbers and mistaken mathematics.

At the center of the labyrinth.

A cabin for automatic photo service as one can find in f.i. a train station.

Instead of a camera a video camera and monitor.

The portrait of the viewer who sits down in front of the video camera will be shown on the monitor, written over with numbers and mistaken mathematics (through the working of a certain software programm)

Ni Haifeng

15.10.'96