



Sveriges lantbruksuniversitet  
Swedish University of Agricultural Sciences

Department of Urban  
and Rural Development

# A Competitor's Reflections

Master's thesis' Appendix: *Retain. Restore and Revive*

Swedish University of Agricultural Sciences

Department of Urban and Rural Development, Division of Landscape Architecture, Uppsala

*Appendix title:* Retain, Restore and Revive

© 2015 Arvid Wedlin, arvid.wedlin@gmail.com

Master's thesis Appendix

*Master's thesis' title in English:* A Competitor's Reflections - Reflections about competing in an international architectural competition: LE:NOTRE Student Competition - (RE)Discovering the Emerald Necklace of Colentina

*Examensarbetets titel på svenska:* En tävlandes reflektioner - Reflektioner om att tävla i en internationell arkitektävling: LE:NOTRE Student Competition - (ÅTER)Upptäcka Colentinas Pärlband

EX0504 Degree Project in Landscape Architecture, 30 HEC

Uppsala, Sweden, 2015

*Original format:* A1

*Online publication of this work:* <http://epsilon.slu>

## RETAIN, RESTORE AND REVIVE - THE EMERALD NECKLACE OF COLENTINA

Competition submission in LE:NOTRE Student Competition

Arvid Wedlin



**BRIEF AND OVERVIEW**  
 For the purpose of water supply, irrigation, fishing and primary leisure, the Colentina river was reconstructed into an emerald necklace of artificial lakes during the 20th century. Now, many years later it's more of a barrier that divides the metropolitan area of Ilfov and Bucharest into two and separates the periphery from the city. Colentina needs to RETAIN its values, RESTORE its purpose and REVIVE into a social meeting area for activity and recreation - both for tourists and Bucharesters.

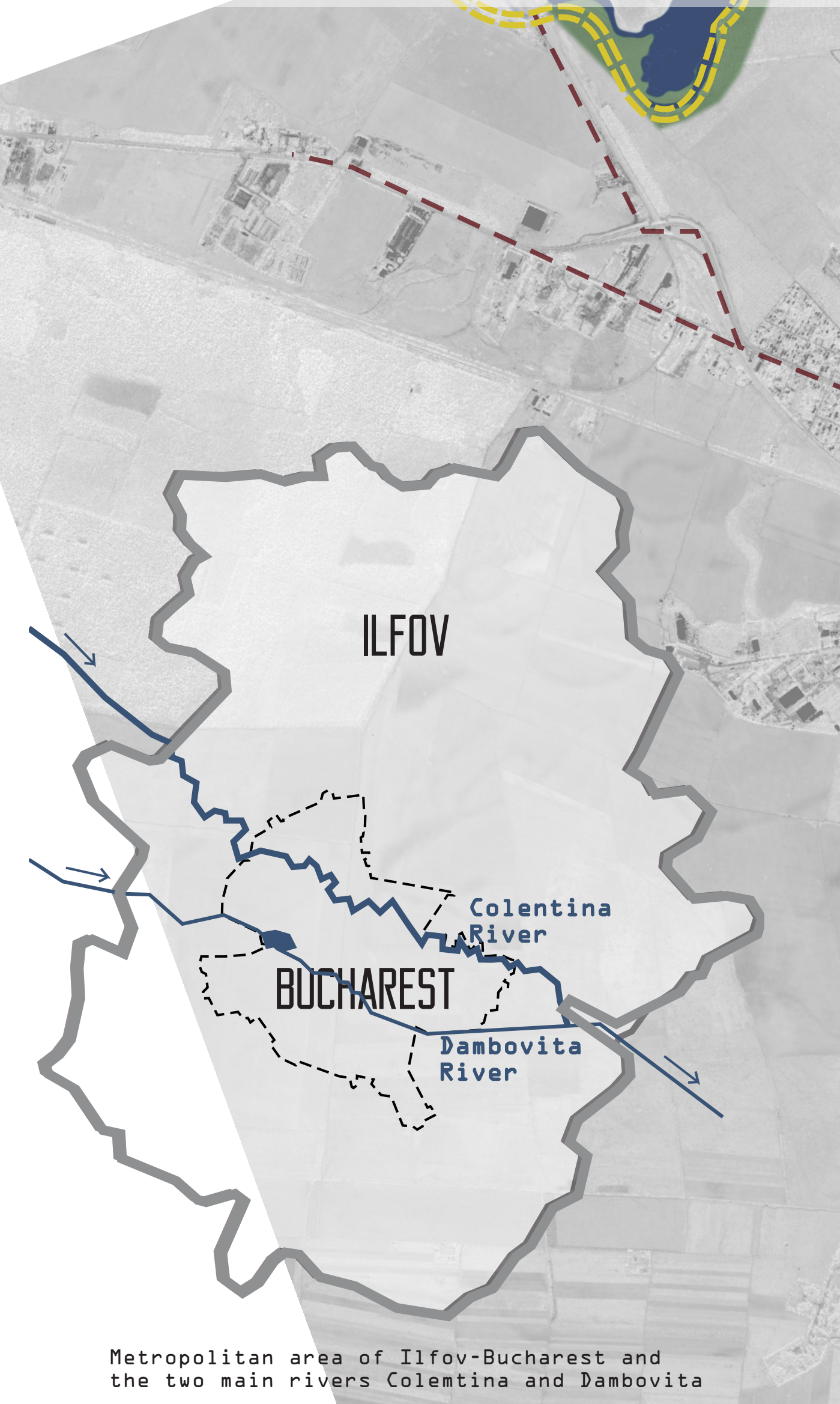

RETAIN the quite rural character and RESTORE the shorelines by making them accessible. REVIVE the area with the pathway that connects the two sides of the lake.

RETAIN the forest on western shore. RESTORE and REVIVE the eastern shore with the pathway through a park or vegetation area near water and provide vistas over the lake.

RETAIN the biological values in the wetlands to the west, RESTORE the green spaces and REVIVE with the accessible pathways, new park areas by the lake and a new multi-center.

RESTORE the sport facilities and park area on the southern shore. REVIVE with new parks on the north side, making water accessible. New Bridge connects north and south side of the lake.

RESTORE the green spaces and valuable areas and monuments. Use existing paths for the pathway. Possibly REVIVE with a new iconic bridge to connect and allow easy access from public transportation.

RESTORE the north shore and half the peninsula with green spaces connecting west and east. REVIVE with the pathway as a boardwalk by the water, passing public transportation.

RESTORE the urban character of the peninsula. RESTORE and REVIVE eastern shore with the pathway and a park for higher connectivity. Provide vistas of the city and visual values of the lake.

RESTORE and REVIVE the shorelines with green spaces and corridors for recreation and activity. Also RESTORE the sport facilities in the south. Pathway provides vistas of the surroundings.

RETAIN the rural character around Lacul Cernica and REVIVE by making the southern shore accessible through the pathway in the wild nature.

RETAIN the valuable parks in the south and plumbuita park. RESTORE the small island and the north shore with green spaces. REVIVE by the pathway passing landmarks and valuable areas. Bridge and connect with the periphery in the north.

RESTORE the green spaces around the shores. REVIVE the island to allow island characteristics, viewing the lake surrounded by it. Bridge the canal to connect with public transportation.

RESTORE the existing green spaces on the southern shore. REVIVE the peninsulas on the south with new parks and green corridors and the pathway connecting Dobroesti with Fundeni.

RETAIN the forest on the north shore and the park in the south. REVIVE the northern shore. New iconic bridge and Recreation Center connects the periphery with the city, enables urban development and increases land value.

RETAIN the forest on the north shore and the park in the south. REVIVE the northern shore. New iconic bridge and Recreation Center connects the periphery with the city, enables urban development and increases land value.

RETAIN the forest on the north shore and the park in the south. REVIVE the northern shore. New iconic bridge and Recreation Center connects the periphery with the city, enables urban development and increases land value.

RETAIN the forest on the north shore and the park in the south. REVIVE the northern shore. New iconic bridge and Recreation Center connects the periphery with the city, enables urban development and increases land value.

RETAIN the forest on the north shore and the park in the south. REVIVE the northern shore. New iconic bridge and Recreation Center connects the periphery with the city, enables urban development and increases land value.

RETAIN the forest on the north shore and the park in the south. REVIVE the northern shore. New iconic bridge and Recreation Center connects the periphery with the city, enables urban development and increases land value.

RETAIN the forest on the north shore and the park in the south. REVIVE the northern shore. New iconic bridge and Recreation Center connects the periphery with the city, enables urban development and increases land value.

RETAIN the forest on the north shore and the park in the south. REVIVE the northern shore. New iconic bridge and Recreation Center connects the periphery with the city, enables urban development and increases land value.

RETAIN the forest on the north shore and the park in the south. REVIVE the northern shore. New iconic bridge and Recreation Center connects the periphery with the city, enables urban development and increases land value.

LANDSCAPE CONCEPT OF COLENTINA

The original planner Caranfil's intentions were that the lakes would serve for water supply, irrigation, fishing and primary recreation. This landscape concept of Colentina is based on the history of the lakes and their intended purpose and meaning.

This concept will RETAIN, RESTORE AND REVIVE the intentional purpose. In the vision, Colentina and the area around will turn into a sustainable, well-used place, connected by green infrastructure and sustainable circulation for social activity and recreation.

The vision is to:  
 - RETAIN the valuable areas and monuments.  
 - RESTORE the vacant lands and available shores into accessible, green spaces with higher biological, ecological and recreational values  
 - REVIVE the area to a social meeting area with new values for sustainable tourism and recreation.

The concept builds upon 3 layers:  
 BLUE - WATER  
 GREEN - GREEN INFRASTRUCTURE  
 YELLOW - IDENTITY AND TOURISM

BLUE - WATER

Colentina river  
 Meaning of water  
 Visual aspects  
 Physical aspects

Ecosystem services  
 Restoration actions  
 Biodiversity

The Emerald Necklace of Colentina is important for Bucharest. As it divides the metropolitan area of Bucharest-Ilfov into north and south, it gives people the opportunity to be close to water and obtain what it has to offer, both visually and physically. Visually, the water enables vistas and views of the area around. Physically, it opens up the city and creates a clear boarder.

GREEN - GREEN INFRASTRUCTURE

Nature  
 Park  
 Green spaces  
 Recreation  
 Activity

Health  
 Connectivity  
 Enhanced microclimate  
 Biological/ecological aspects  
 Ecosystem services

Lakes and green infrastructure together create biological and ecological opportunities. Public green spaces near the lakes, make the water accessible for everyone and allows an open space between urban tissues in the area. The green spaces also include health benefits and a higher quality of life, as the vegetation also cleans air, suppresses temperature differences, enables shadow and cooler conditions, protects from noise

YELLOW - IDENTITY AND TOURISM

Identity  
 Connectivity  
 Tourism  
 Holistic area  
 Social aspects

Pathway  
 Ecotourism  
 Pedestrians/cyclists  
 Sustainable infrastructure  
 Bridges/Nodes

To revive Colentina, a new identity is added - a pathway for pedestrians and cyclists, connecting the entire necklace and making it holistic. The pathway will be a tourist attraction, highlighting Colentina and making the area unique and memorable. The pathway enables movement and activity along the shores of Colentina, passing existing monuments, sport facilities, parks, nature and other valuable areas. It's an area for ecotourism where people and nature unite, as well as a place for recreation including activities and social meetings, connecting both periphery and city with the landscape. The pathway also serves as a sustainable traffic link in the city's infrastructure, allowing circulation free from motor vehicles and yet at the same time bridging the physical barrier of water thus uniting people and different urban areas, creating new nodes.





# RETAIN, RESTORE AND REVIVE THE EMERALD NECKLACE OF COLENTINA

SUSTAINABLE TOURISM AND RECREATION



SCALE 1:5 000/A1

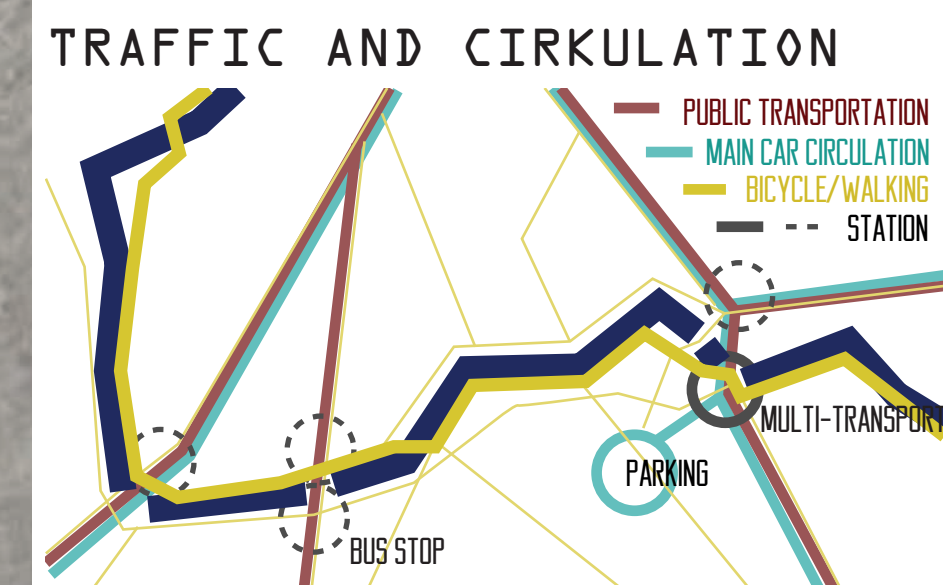

**TRAFFIC AND CIRCULATION**  
Sustainable traffic. Cyclists, pedestrians and public transportation prior cars.

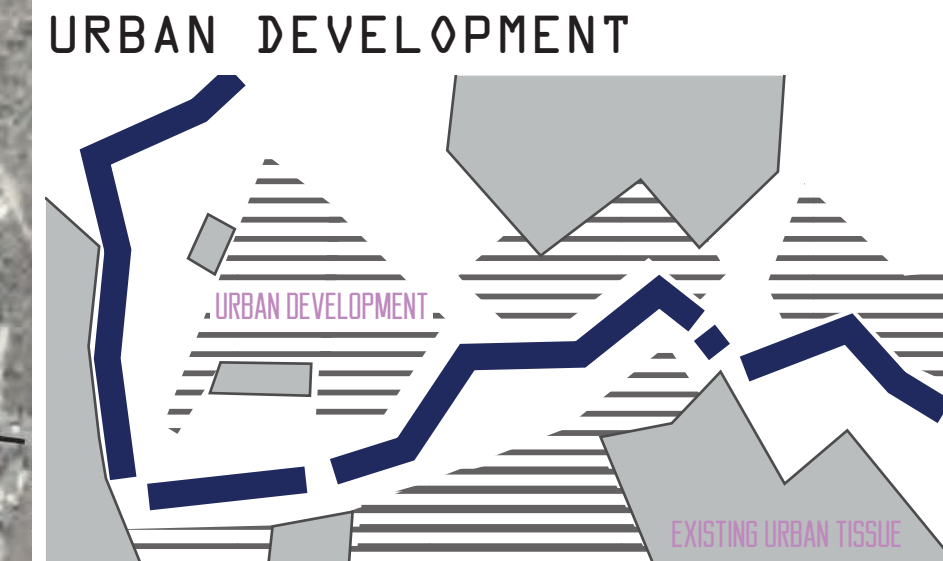

**URBAN DEVELOPMENT**  
Integrate and join existing and new urban tissues.

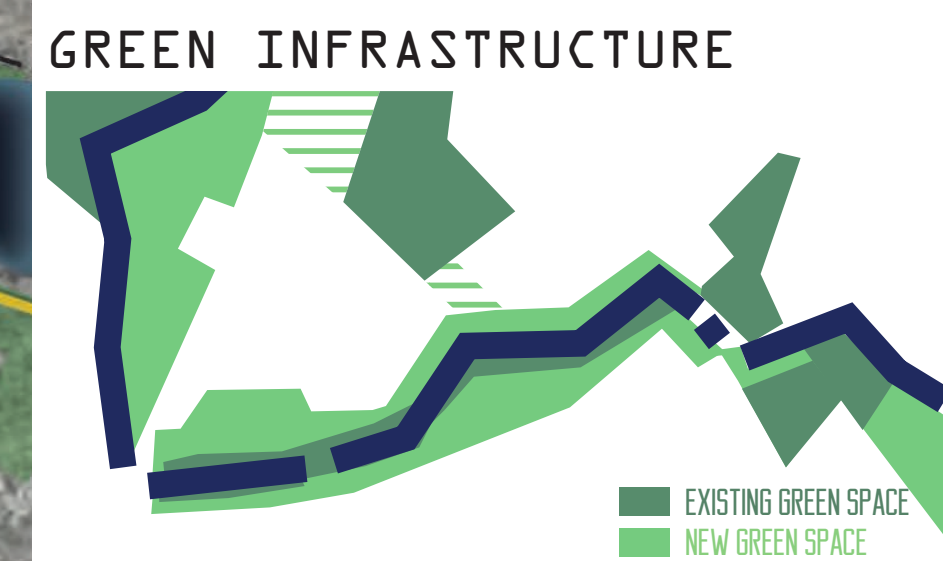

**GREEN INFRASTRUCTURE**  
Great connectivity along the lakes and possibly in a 2nd corridor.

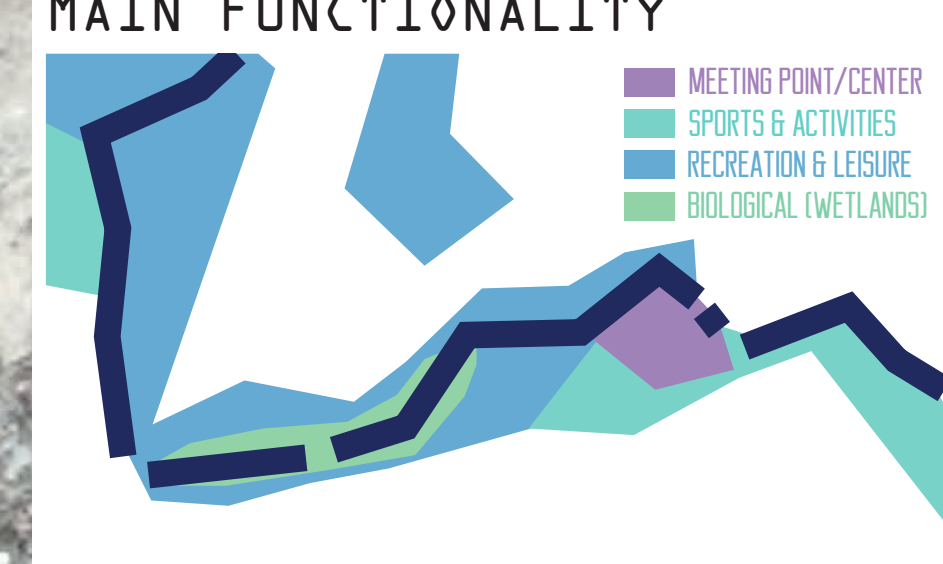

**MAIN FUNCTIONALITY**  
Main functions around Straulesti. The meeting point is also a place for recreation and activities.

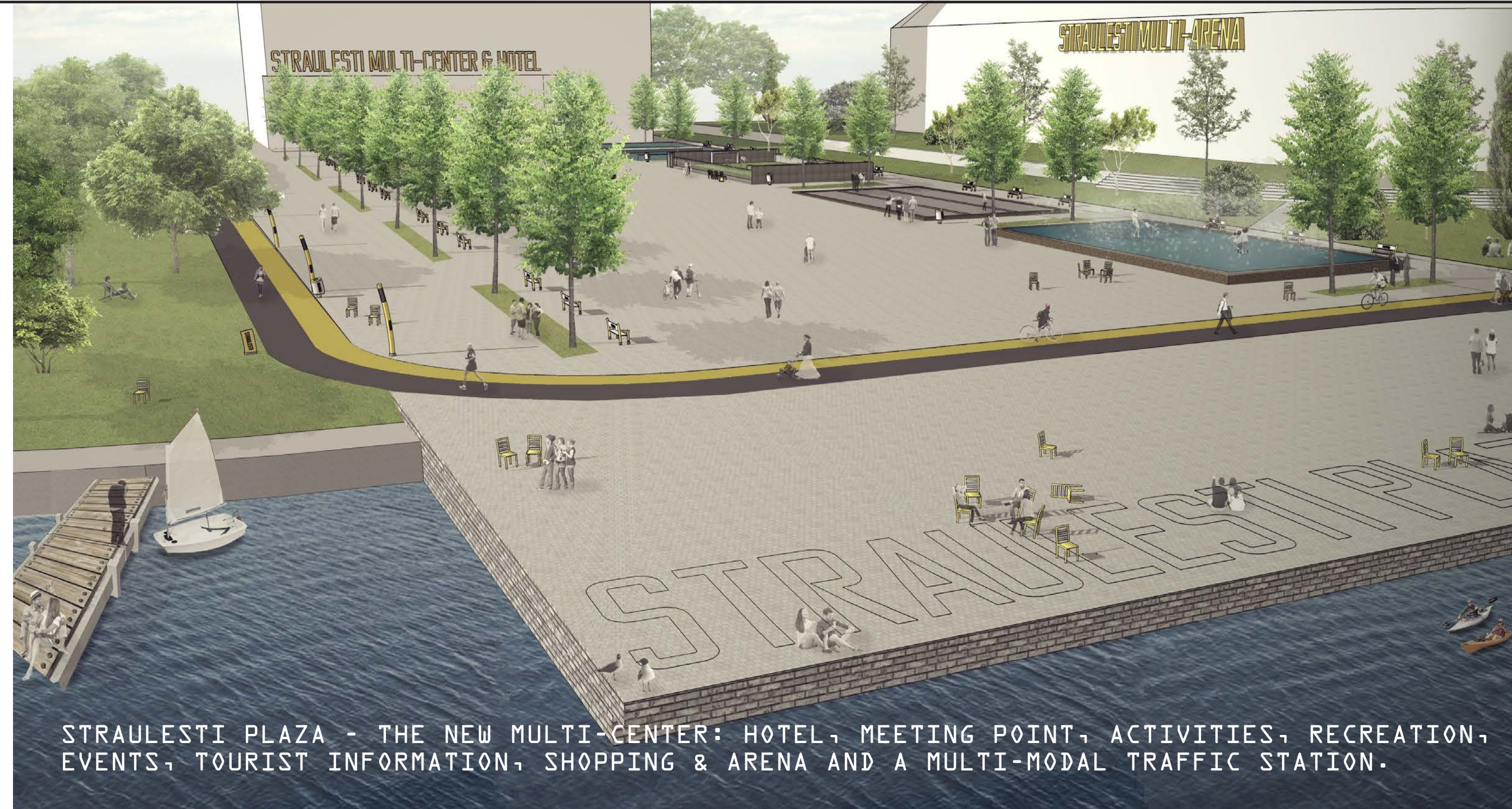

STRAULESTI PLAZA - THE NEW MULTI-CENTER: HOTEL, MEETING POINT, ACTIVITIES, RECREATION, EVENTS, TOURIST INFORMATION, SHOPPING & ARENA AND A MULTI-MODAL TRAFFIC STATION.

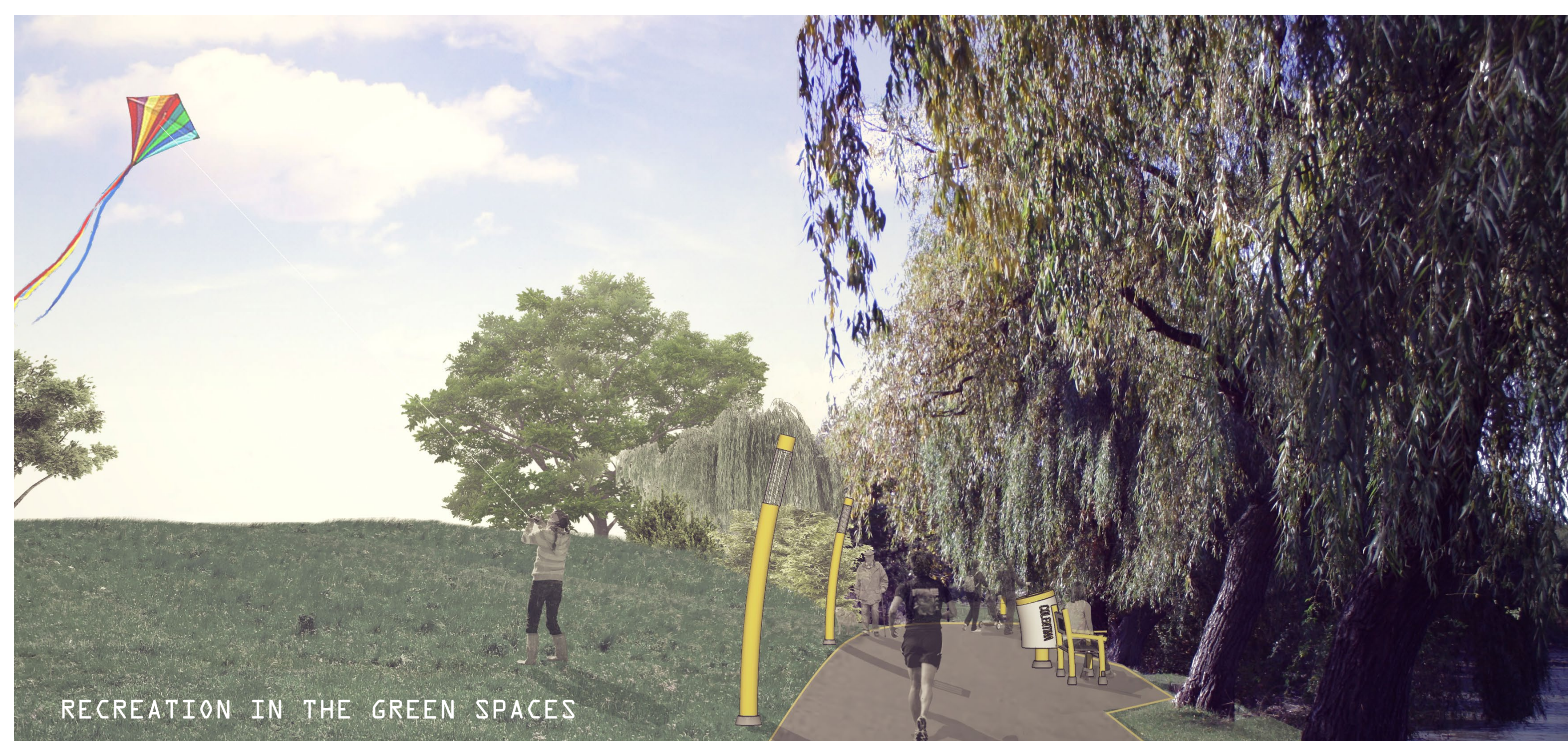

RECREATION IN THE GREEN SPACES

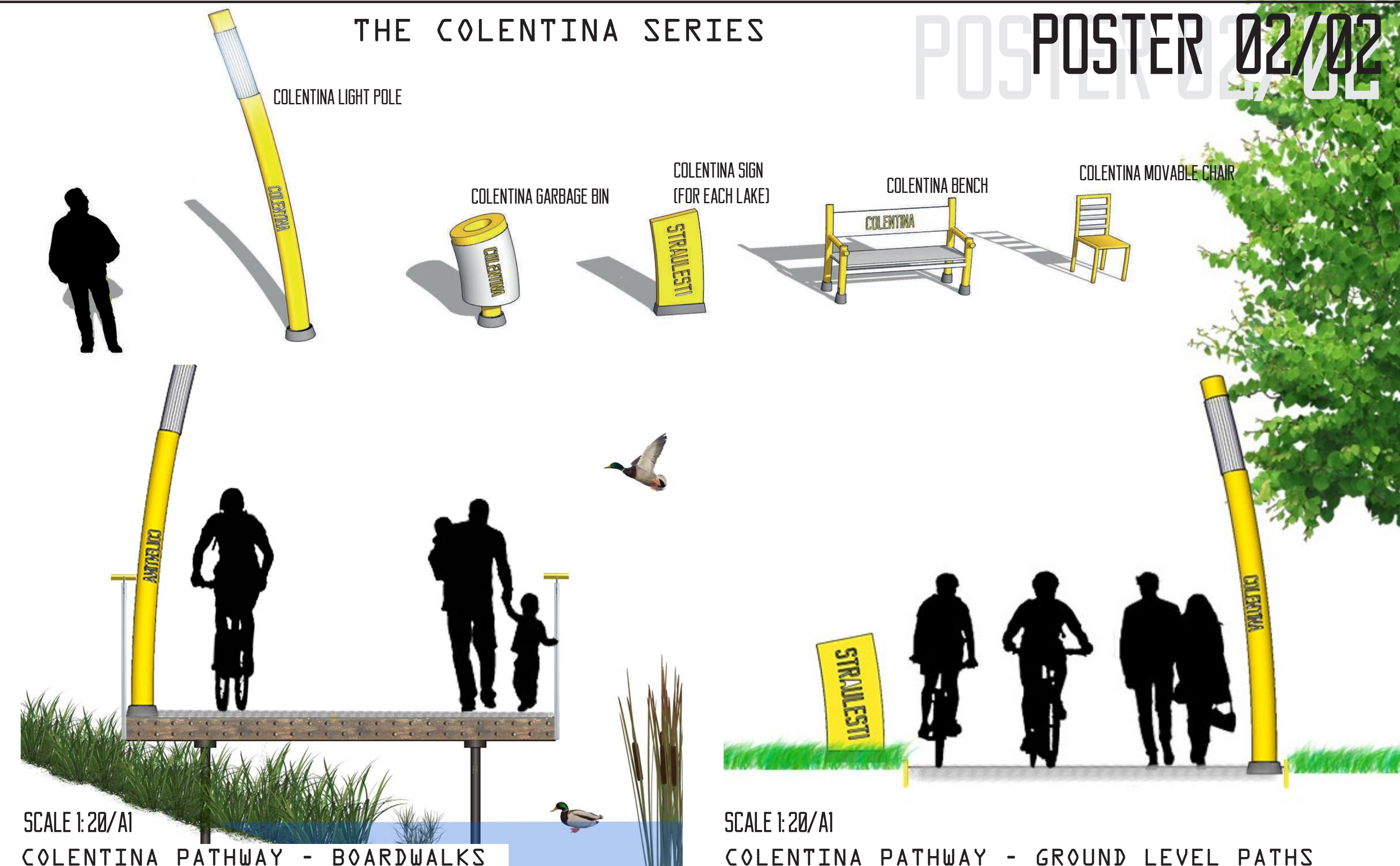

SCALE 1:20/A1  
COLENTINA PATHWAY - BOARDWALKS

SCALE 1:20/A1  
COLENTINA PATHWAY - GROUND LEVEL PATHS



EXPERIENCE NATURE



COLENTINA PATHWAY BY NIGHT

## SPATIAL CONCEPT OF STRAULESTI

Sustainable Tourism and Recreation is the spatial concept of the detailing area of Lacul Straulesti as it applies to the overall concept of RETAIN, RESTORE and REVIVE.

Straulesti and the area around the lake should be a place involving the city, the periphery, the people and the nature.

The area will be RESTORED by creating new parks and green spaces and a place far from the vacant and idle site that Straulesti lake is today.

Existing values will be RETAINED and enhanced, offering leisure and activities.

Straulesti will also be REVIVED, adding new values to increase the experiences of the area, with new tourist attractions and a new places for people to meet, interact, unite as well as get involved with each other and the nature in a sustainable way.

The reconstruction will reclaim the lake, offering the people a diverse scenery of both existing and new valuable nature and modern, active urban areas.

## LACUL STRAULESTI

Lacul Straulesti is located at the western part of the necklace of lakes - in both Bucharest and Ilfov - between Lacul Chitila and Lacul Grivita. It's located in the periphery, yet well connected to the city by public transportation (metro planned).

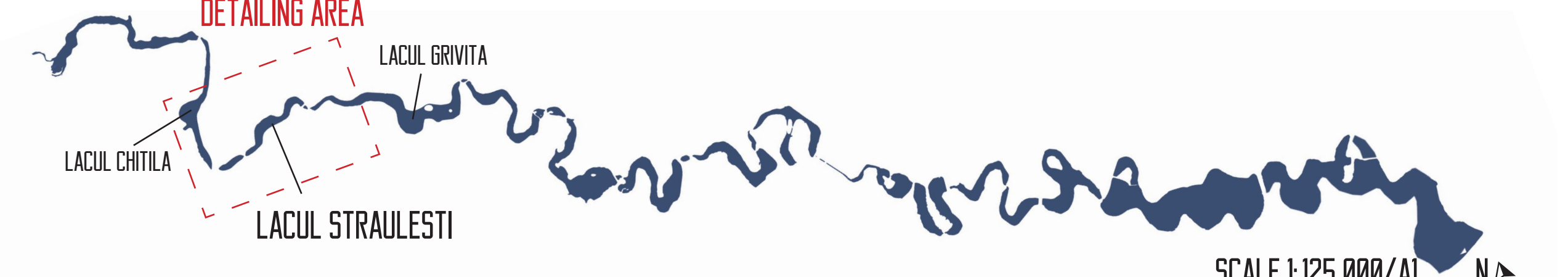

SCALE 1:125 000/A1

Values of Straulesti, existing and new:

- Wetlands in the western part
- Good water quality and potential accessible shores
- Green spaces and biodiversity (existing and new)
- Straulesti plaza and multi-center (planned)
- New recreation and activity areas
- Colentina pathway, identity and tourism

## SUSTAINABLE TOURISM AND RECREATION

Lacul Straulesti has a lot to offer for the tourists and Bucharesters in recreation, activities and sports.

At the Straulesti plaza, spontaneous and organized activities like marketing, tennis, soccer, boule and water play can take place. It's a sustainable place that will appeal to people of all ages. The hotel offers tourists a place to stay and the main floor could offer cafés, stores and a tourist information and recreation center.

The accessible shoreline around the entire lake allows people to get close to water and enjoy it. Fishing, swimming and sailing all

are activities possible at Lacul Straulesti. All green spaces are accessible and perfect spaces for things like a walk or a jog in the park, play and picnic in the grass or just exploring the wildlife or what nature has to offer. The biologically and ecologically valuable nature, like the wetlands, are great places for ecotourism. The wetlands were not planned, yet their value will be conserved as a natural environment, where awareness and respect is shown for nature. Ecotourists can get involved and educated while nature benefits from being conserved and biodiverse.

## COLENTINA PATHWAY

The Colentina Pathway enables the activity and recreation areas around Straulesti and Colentina. The identity of the pathway is enhanced by the Colentina Series, a series of furniture and objects, uniting the pathway and making it easy to follow. The yellow light poles make the path available day and night leading the cyclists and pedestrians on a safe path along the lakes. Signs placed at the beginning of each lake facilitates orientation. Moveable chairs allow people to find their own places to relax and interact, giving Bucharesters and tourists the power to influence the area. The Colentina

series increase the holistic experience and highlights Colentina even more. The Colentina Series markets Colentina locally and possibly globally, making Colentina a trademark and the pathway becomes a tourist attraction of its own. The ground level pathways are thus revived with the Colentina series, without making too much impact on the existing paths. Closer to water or sensitive areas the pathway is instead a boardwalk, allowing people to move safely without disturbing nature or risking accidents. It also makes people view and experience the lakes and nature of Colentina fully.