

2-6-1919

Plan of Gardens and First Floor Chateau Pathe

A. D. Jewell

Follow this and additional works at: https://corescholar.libraries.wright.edu/special_ms53_ephemera



Part of the [History Commons](#)

Repository Citation

Jewell , A. D. (1919). *Plan of Gardens and First Floor Chateau Pathe.* .

This Book is brought to you for free and open access by the Fred F. Marshall Papers (MS-53) at CORE Scholar. It has been accepted for inclusion in Fred F. Marshall Ephemera by an authorized administrator of CORE Scholar. For more information, please contact corescholar@www.libraries.wright.edu, library-corescholar@wright.edu.

PLAN OF GARDENS AND FIRST FLOOR, OF CHATEAU PATHE

20, Rue de la Villa, Vincennes, Seine, France

Drawn February 6, 1919

by Cpl. A. D. Jewell

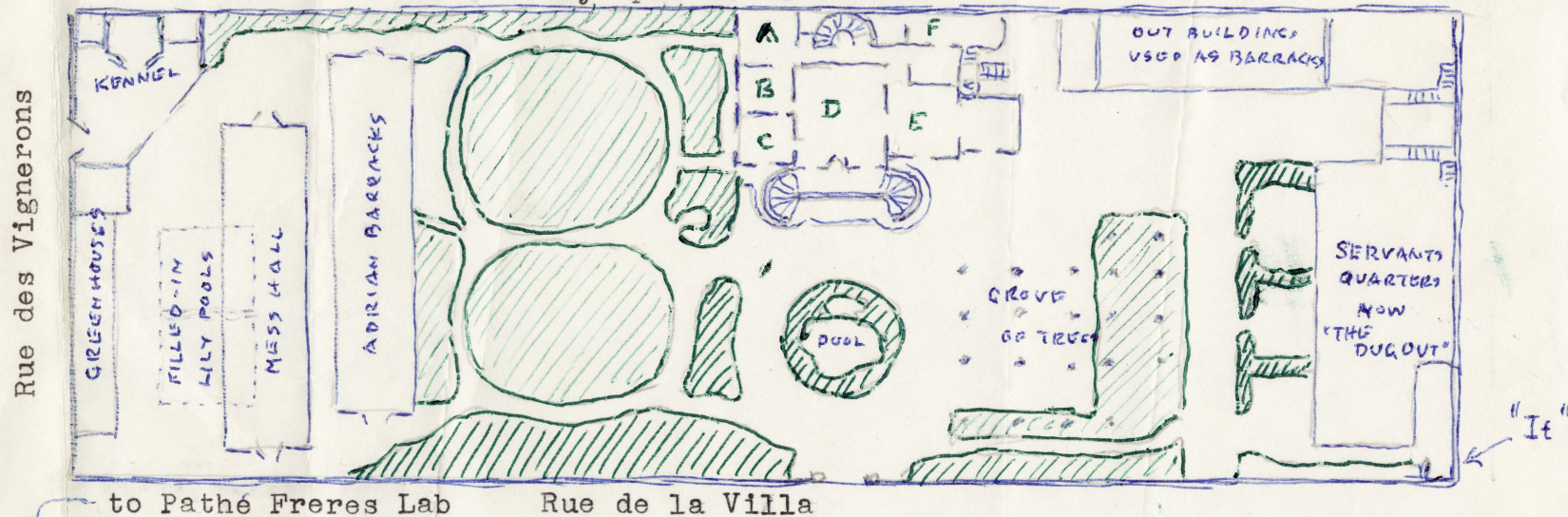

- A. Company Commander's office
- B. Surgeon's office
- C. Canteen
- D. Recreation Rm (old mess rm)
- E. Billiard Rm (old mess rm.)