

NEA PAPHOS

CYPRUS

NEA PAPHOS

SEASON 2003

Wiktor Andrzej Daszewski, Henryk Meyza,
Ewdoksia Papuci-Władyka, Stanisław Medeksza

The 2003 season had as its aim the examination of 53 trenches excavated in preparation for a roofing project commissioned by the Cyprus Government to protect the remains of the so-called Villa of Theseus and the House of Aion, uncovered in earlier Polish excavations.¹⁾ The trial pits, 2 by 2 m and 1.5 m deep in principle, were excavated under the supervision of the Department of Antiquities of Cyprus between January and August 2003. In 27 cases, the trenches were extended because initial excavations had exposed structures prohibiting the use of these locations under planned roof supports, but had left some hope that a suitable spot could be found immediately nearby. During a study campaign in September 2003,²⁾ the Polish mission documented the trenches and examined the collected finds. The present report presents the results and interpretation of this work. As no other publication of this data is scheduled, it was deemed essential to discuss it in more detail than a preliminary report normally admits.

1) The project is part of the Archaeological Park of Nea Paphos. Six trenches had been excavated in December 2002, the resources having been supplied by the Department of Antiquities of Cyprus. At the Department's request, H. Meyza supervised this work, cf. *PAM XIV Reports 2002* (2003), 255-261. The remaining 47 trenches and necessary extensions were dug under the supervision of the Department, the finds being collected on the whole from arbitrary layers each 0.5 m thick.

2) The study season was carried out between September 3 and October 4, 2003. The mission was directed by Prof. Dr. W.A. Daszewski, and included: Prof. Dr. Ewdoksia Papuci-Władyka; Mrs. Iwona Zych and Mr. Henryk Meyza, archaeologists; Prof. Dr. Stanisław Medeksza, architect; and Mrs. Elżbieta Daszewska in a private capacity.

LOCATION OF THE TRENCHES

The first project design called for supports to be placed in three rows in and along the three wings of VT³⁾ and in two rows around HA, the grid roof structure being independent for each of the wings and the house. The modular distance between supports was 14.4 m (maximum 18.0 m). The outer row was situated immediately outside the structures to be sheltered, i.e., inside the Hellenistic and Roman houses to the south (*Fig. 1*), in the outer courtyard on the west, in the Late Roman street to the east and in street B, south of HA. Inside the peristyle, the supports were to be placed along the east, south and west porticoes. The northern limit of the roof was defined by structures of the Early Roman villa underlying the northwestern part and the edge of the excavation in HA. The eastern end of the HA extension did not coincide with the uncovered remains, leaving several floor mosaics (in R.17, R.20 and R.22) unprotected. The same was true of a group of mosaics in HH, immediately south of VT (R.1-3, R.10). In the three wings of the Roman villa an effort was made to limit the number of supports wherever structurally possible, hence the single supports in the

east and west wings. Their number was also reduced in the south wing where a central support K 9/10 was designed at the eastern end. On the other hand, designing four separate roof structures resulted in the doubling of supports where the west and south wings and the south and east wings of the villa met, making them only 5.74 m apart. Another junction was necessary between HA and the east wing of VT, where the distance between the rows of supports measured 7.8 m.

A critical review of this roofing project, presented separately by the Department of Antiquities and the Polish Archaeological Mission, led to it being dropped. A new architectural design of the shelter was prepared, covering a wider area of the ancient remains; it will require more roof supports, but the pits excavated under these supports will be smaller. The project was approved by the relevant authorities in 2004.

The trenches were designated from A 3 to Δ 14 and from H 3 to Λ 11 using letters of the Greek alphabet and Arabic numerals (all height measurements are related to the datum level at the door between vestibule R.69 and atrium 71-72, if not stated otherwise).

VILLA OF THESEUS TRENCHES IN THE WEST WING

A (*alpha*) 3

Trench situated north of tower 80. Close to the bottom, two floor layers 0.2 m apart (lower one situated at 0.75 m below the datum) and a robbed-out N-S stone wall in the west part.

The upper of these floors corresponds to the pebble floors encountered previously to the north and east of the tower (trench of 1994) and found to precede its construction. The floors date to the 1st century BC.⁴⁾

3) The following abbreviations have been used throughout the text of this report to designate architectural complexes excavated by the Polish Mission: VT = Villa of Theseus, HA = House of Aion, HH = Hellenistic House, ERH = Early Roman House, RH = Roman House, NEH = Northeast House, R = room(s).

4) W.A. Daszewski, "Fouilles de Nea Paphos (Mission polonaise)" in: V. Karageorghis, "Chronique des fouilles et découvertes archéologiques à Chypre en 1977", *BCH* 102 (1978), 928; id., "Nea Paphos 1977", *EtTrav* XII (1983), 311; id., "Nea Paphos 1994", *PAM VI Reports* 1994 (1995), 72-74.

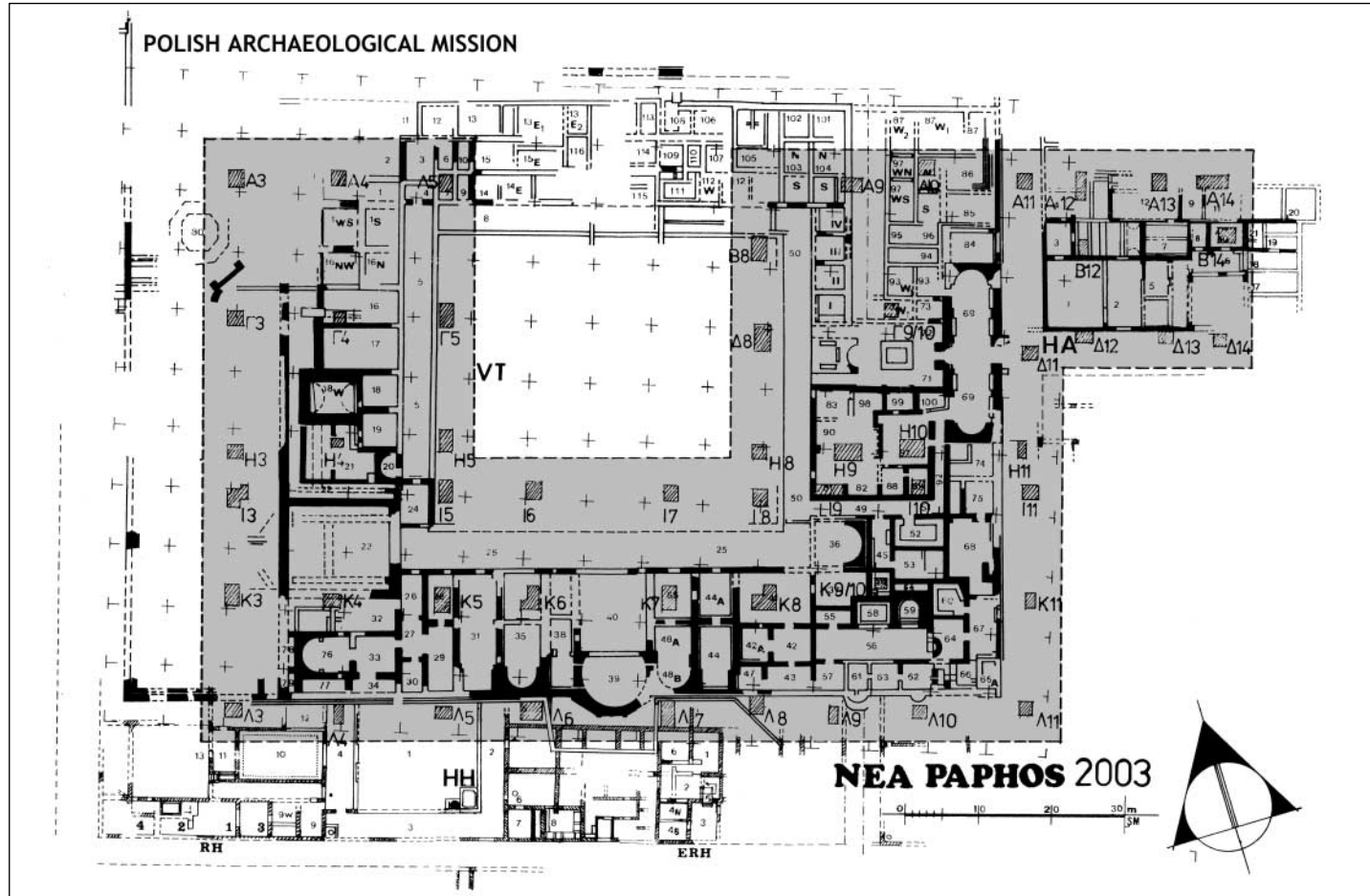

Fig. 1. General plan of excavations with the 2002-2003 trenches marked and the span of the proposed shelter roof (according to the first design (Drawing S. Medeksza et al.))

A 4

Trench west of the west wall of R.1 and R.2 of VT. The E-W wall foundation running across the trench is the continuation of a wall that separated R.1 from R.2; it is situated 0.1 m below what seems to be a lime floor at 0.54 m over the datum.

A 5

Trench in the north part of VT R.7. Only the east wall of R.7 was cleared down to the bottom of the foundation, showing that it reached 1.1 m down from the preserved top (cf. earlier trial pits in R.8 (TP 3/66) and R.6 (TP 9/66)).⁵⁾ Finds were collected from three arbitrary layers, all of which were found to contain Roman ceramics, although the lowest showed a predominance of Late Hellenistic sherds. Below the foundations of the Late Roman period, the walls and floor of earlier structures were recorded at c. 1.5 m below the datum.

Γ (*gamma*) 3

Trench south of tower 80. Only one N-S wall built of masonry blocks, each 0.8 m long, was found at 0.61 m below the datum in the west part, close to the bottom of the trench. Lamps of Roman date were found there (1-1.5 m below surface). The wall may belong to the same structures that were uncovered southeast of the tower in 1977/78 and 1987; a well discovered there had yielded a coin of Antoninus Pius.⁶⁾

Γ 4

Trench situated in the southwestern part of VT R.16. The big E-W wall built of dark brown stones running under this room was between 1.15 and 1.3 m wide. South of it, there was a compact layer of colored plaster found 0.72 m below the datum.⁷⁾ The wall should be dated after the end of the 1st - beginning of the 2nd century AD.

Γ 5

Trench in the peristyle courtyard of VT, opposite R.16, limited on the west by the stylobate of the west portico. The southern section corresponds to the north curb of street B; the northern reveals a wall, which appears to be a continuation of one that bordered an internal court with a well belonging to a house north of this street, under VT R.16. Finally, in the eastern section there are two phases of a wall or superimposed walls separated by floors. There are traces of four successive floors, the lowest of which is at 1.03 m below the datum and appears to run below both the curb and the north wall's leveling course. The lowest of the four arbitrary layers excavated here contained a pottery deposit set close to the stylobate. The deposit mostly consisted of Late Hellenistic pottery, but the latest pieces were Cypriot Sigillata (CS) form P37, which should be dated to the end of the 1st century BC at the earliest⁸⁾ and some second century AD

5) W.A. Daszewski, "A preliminary report on the excavations of the Polish archaeological mission at Kato (Nea) Paphos in 1966 and 1967", *RDAC* 1968, 51; J. Młynarczyk, *Nea Paphos in the Hellenistic Period, Nea Paphos III* (Warsaw 1990), 185, 188f, fig. 23.

6) W.A. Daszewski, "Fouilles de Nea Paphos (Mission polonaise)", in V. Karageorghis, "Chronique des fouilles et découvertes archéologiques à Chypre en 1976", *BCH* 101 (1977), 772, fig. 108; id., "Fouilles de Nea Paphos (Mission polonaise)", in: V. Karageorghis, "Chronique des fouilles et découvertes archéologiques à Chypre en 1978", *BCH* 103 (1979), 714; W.A. Daszewski, Z. Sztetyło, "La région de Maloutena avant la construction de la Villa de Thésée", *RDAC* 1988(2), 202, Pl. LX:1.

7) W.A. Daszewski, "Fouilles de Maloutena", in: V. Karageorghis, "Chronique des fouilles et découvertes archéologiques à Chypre en 1988", *BCH* 113 (1989), 832, fig. 118 (erroneously as fig. 119; in the text another mistake, attributing a 12th-14th century date to the large wall.

8) J. Lund, "The ontogenesis of Cypriot Sigillata", *Acta Hyperborea* 9 (2002), 195, fig. 8. 9.

Roman sherds. The topmost layer contained, among other, Late Roman Cypriot Red Slip wares, type K3B (H9B).⁹⁾

H (*betalita*) 3

Trench situated in the western backyard of VT, west and northwest of trench 6/87, west of VT R.21. The only discernible wall runs E-W at the bottom of the trench, continuing one uncovered in trench 6/87.¹⁰⁾ On both sides of this robbed-out wall there are two floor levels, the upper one at 0.81 m below the datum, the other 20 cm below the first, covered with crushed plaster on the side north of the wall and small pebbles to the south of it. In trench 6/87, floor fragments to the south of this wall contained nothing but Late Hellenistic pottery, including early Eastern Sigillata A (ESA) pieces. The latest fragment from the layer under this was that of a Lamboglia 2 amphora;¹¹⁾ otherwise only Hellenistic Color Coated and Black Glazed pieces were recovered. A small fragment of Italian Sigillata Consp 3:1.2 was found in the fill below the top level of the preserved part of this wall.¹²⁾

H 4

Trench situated in the center of VT R.21, immediately south of the northern pier of the arch, was not excavated further after

a large block (wall?) was uncovered 0.1 m below the surface reached in the previous excavations.¹³⁾

H 5

Trench in the peristyle courtyard of VT, opposite the northern half of R.20 (exedra). The trench runs for 3 m along the stylobate of the west portico. In the southern end, there is a finely made leveling course of an E-W wall, 0.53 m wide at -0.37 m below the datum. A block (another wall?), 0.5 m wide, runs off from this wall to the south. In the southeastern corner, there are traces of a tank collecting water from a downspout, the tank connected with a discharge channel, suggesting that this is one of the corners of a courtyard. North of the wall, a series of seven superimposed floors can be observed in the section, but only the uppermost one seems to be related to the leveling course described above. Two earlier floors are clearly cut by the foundation of this wall, while some of the lower ones may have been related to the foundation itself, probably multiple-phased. The lowest floor covers the entire excavated surface at a depth 1.28 m below the datum. Not much pottery was collected from this trench, but the finds from the lowest two layers (3-4) seem to belong to the Early Hellenistic period.

9) H. Meyza, *Roman Table Wares Produced in Cyprus (Cypriot Red Slip Ware 4th-7th c. AD)*, unpublished doctoral thesis (Warsaw 2004), 56-57, Pl.19:K3.2.

10) W.A. Daszewski, "La Villa de Thésée et la Maison d'Aion (Mission polonaise)", in: V. Karageorghis, "Chronique des fouilles et découvertes archéologiques à Chypre en 1987", *BCH* 112 (1988), 836.

11) M.T. Cipriano and M.-B. Carre, "Production et typologie des amphores sur la côte adriatique d'Italie", in: Amphores romaines et histoire économique: dix ans de recherche, *CollEFR* 114 (Rome 1989), 80-85; compare presence of other Republican amphorae: type Dressel 1C, cf. W.A. Daszewski, "Nea Paphos (mission polonaise)" in: V. Karageorghis, "Chronique des fouilles et découvertes archéologiques à Chypre en 1986", *BCH* 111 (1987), 688, fig. 41; id. "Nea Paphos 1986", *EtTrav* XVI (1992), 313f, fig. 14; E. Papuci-Władyka, *Nea Pafos, studia nad ceramiką hellenistyczną z polskich wykopalisk (1965-1991)* (Kraków 1995), 76, 125, pls. 22:136.

12) E. Ertlinger et al., *Conspectus formarum terrae sigillatae italico modo confectae* (Bonn 1990), 56, Taf. 3.

13) W.A. Daszewski, "Fouilles de Nea Paphos (mission polonaise)" in: V. Karageorghis, "Chronique des fouilles et découvertes archéologiques à Chypre en 1984", *BCH* 109 (1985), 953f, figs. 117, 122. This room is still described as 19W in the text, but on the plan it is already marked as 21.

VILLA OF THESEUS TRENCHES IN THE SOUTH WING

I (*iota*) 3

Trench in the western backyard of VT, west and southwest of trench 5/87, west of VT R.22.¹⁴⁾ Two parallel N-S walls or foundations were encountered; both were built of irregular, head-sized stones. The east wall, 0.48 m wide, delimits a plastered floor, recorded at 1.09 m below the datum and known already from trench 5/87. A discharge (?) channel cuts at an angle through the lower part of this floor in trench 5/87, suggesting an unroofed space. The wall is preserved to a height of 0.42 m above the floor and its eastern face is plastered. The other wall or foundation is just 0.15 m further west; it is 0.7 m wide and stands slightly higher. Uncertain traces of two floors were also uncovered, one at 0.85 m below the datum, west of the wider wall, and the other above this wall, corresponding to a floor level found east of an N-S wall in trench 5/87. Finds from the lowest layer (1.0 to 1.5 m below the surface) include 2nd-century-AD CS form P 30(?) and a foot of a pinched-handle amphora Mau 27/28.¹⁵⁾ In trench 5/87, finds in the fill immediately above the courtyard (?) floor included a similar amphora fragment. It should be noted that the strata at the northern end in both trenches had been disturbed by a deep modern pit.

I 5

Trench in the peristyle courtyard of VT, in its southwestern corner. It is 2.9 m long (N-S) and delimited by walls on three sides. Of the latest wall seen in the south section and believed to be later than the east wall of

R.24, only a disturbed foundation remains. The east wall is in much better condition, 0.6 m of it rising above the foundation leveling course recorded at 0.65 m below the datum. This wall cuts a lime floor (at 1.0 m below the datum), which is related to the third wall, revealed in the northern section. There are traces of plaster on this last wall and its visible part reached 1 m above the floor. Its foundation was not uncovered. Under the latest south wall, there is a large pit filled with pottery and intercalated lenticular ash layers. This is probably construction fill of R.24 or perhaps the preceding structures belonging to the first phase of VT. Down to c. 1 m below the surface, the pottery is from the late 1st-early 2nd century AD. The underlying layer (i.e. below the lime floor?) seems to be dated by a CS form P20 to the 1st century BC.

I 6

Trench in the peristyle courtyard of VT, close to the southern stylobate, opposite R. 35. There were no visible structures found apart from two stones in the northeastern corner of this trench, possibly belonging to the E-W wall. Pottery found 1 m and deeper under the surface includes Roman amphorae.

I 7

Another trench in the peristyle courtyard of VT, close to the southern stylobate, opposite R.65. Running across the center is an N-S wall built of small stones, preserved 0.5 m above the foundation leveling course,

14) Daszewski, *BCH* 112, 1988, loc. cit. This is the trench with the murex deposit.

15) J. Lund, "The 'Pinched-handle' transport amphorae as evidence of the wine trade of Roman Cyprus", in: *Acts of the IIIrd International Congress of Cypriot Studies*, vol. 1 (Nicosia 2000), 565-571.

which is at 0.61 m below the datum. Level with the top of the foundation there are traces of a pebble (?) floor. The trench was excavated below that floor only west of the wall. The strata below this floor seem to correspond to a layer 1-1.5 m below the surface, containing fragments of CS forms P12 and P40, dated to the late 1st – early 2nd century AD.

I 9

Partly excavated in December 2002, the trench was deepened as well as extended 2 m to the west in 2003.¹⁶⁾ The wall dividing R.81 and R.82 of VT, constituting the east section of this trench, was found to have a shallow foundation, in spite of the fact that it seems to continue the line of the east curb of the Hellenistic-Early Roman street 9. Below the foundation, at 1.04 m below the datum, more rubble (another

foundation) stretches E-W in the northern part of this trench. Another possible disturbed N-S wall foundation, noted at 0.5 m below the datum, was found in the western part of this trench. Three more floors were found below this, the lowest one at 1.48 m below the datum.

I 10

The trench occupies most of R.89. On its eastern side, at 0.38 m below the datum, a foundation leveling layer of an N-S wall, 0.5 m wide, was found, built of large blocks of stone (largest 1.0 m long); along its east edge there was a row of smaller stones above it (*Fig. 2*). Traces of a corresponding floor are to be seen at the same level in the north and west sections. Below there extends fill with charcoal and traces of burning, particularly above the lower blocks. One of them, set N-S at 0.93 m



*Fig. 2. Trench I 10, seen from the south
(Photo W.A. Daszewski)*

16) Meyza, *PAM XIV*, op. cit., 259.

below the datum, 0.6 m wide, is particularly large and its full length, exceeding 1.5 m, is unknown. Some 0.5 m from its north end there is a round hole, 0.3 m in diameter and 0.15 m deep; it may have been the setting of some large vessel or the pivot nest of a very heavy door. East of it, there are large irregular stones. The upper fill, corresponding to the eastern N-S wall, contains Roman pottery, including single fragments of CS form P8 and a Plain Ware basin rim, which can be dated to the 2nd-3rd century AD. Below, there is little characteristic pottery; the identified fragments are of Hellenistic date.



Fig. 3. Trench K 3, seen from the north
(Photo W.A. Daszewski)

17) Młynarczyk, op. cit., 173; S. Medeksza, "Willa Tezeusza w Nea Pafos na Cyprze: powstanie i fazy rozwoju", in: *Cypr w badaniach polskich*, ed. W.A. Daszewski, H. Meyza (Warszawa 1996), ill. 3.

18) W.A. Daszewski, "Fouilles de la Maison de Thésée et de la Maison d'Aion", in: V. Karageorgis "Chronique des fouilles et découvertes archéologiques à Chypre en 1985", *BCH* 110 (1986), 860; Młynarczyk, op. cit., 173, n. 35.

I 11

Trench situated 2.3 m east of the eastern wall of the VT, opposite R.75. The eastern half of the trench is occupied by loosely arranged stones, their top at a height varying between 0.84 m and 1.12 m below the datum; they may have formed the foundation of an N-S wall.

TRENCHES K (*kappa*) 3-11

All situated on the axis of the Hellenistic E-W street (known as A), investigated already in several trial pits in R.32 (trenches 3/70, 3/85 and 8/85), R.35 (5/83), R.37 (trench S.37/75), R.38 (TP 38NE/78), R.40 (S.40/75) and outside the east wall of VT, in trench 7/83.¹⁷⁾ Some of these old trial pits were cleared and extended during the 2003 excavations. Generally, based on an analysis of the trench sections, there were 3 or 4 street surfaces overlying the covering of the central drain.

K 3

The trench was situated in the western enclosure of VT, west and southwest of trench 8/85 and west of R.32.¹⁸⁾ Extended to 3 m in length (N-S), the trench revealed a section of the northern curb-wall and the drain of street A (Fig. 3). The curb-wall stands here to a height of 0.73 m above the foundation-leveling course. Its western part was robbed out down to the foundation (at 0.57 m below the datum). It was built of regular blocks, the longest being more than 0.87 m in length. Three courses have been preserved at the most. The leveling course protrudes 0.05 m or less. At a distance of 1.1 m to the south of the wall, large slabs covering the drain were found, disturbed but still resting upon the channel trough at

1.06 m below the datum. Long stones between the drain and the wall in the east section probably belonged to the discharge channel (but running horizontally? at 0.86 m below the datum) from the edifice to the north. In the lower part of the western section, there appears the stony fill of a pit (most probably due to the robbed-out curb wall in this part) or a loosely filled foundation trench. Traces of street surfaces are best visible over the drain, but faint layers occur also above the transverse block (channel?). A layer of crushed, but restorable pottery, solely Hellenistic, appears level with the drain. At 1.0-1.5 m below the surface, the layer included some Roman amphora sherds, including a Mau 27/28 foot. It seems that these could come from the robbing pit in the western part of the trench. There are three street surfaces over the rubble immediately over the drain covering, between 0.26 m and 0.4 m above the drain. At 0.5 m above it (corresponding to the top of the first course of the curb wall), another brown clayey level can be observed in the southwestern and southeastern trench corners; a compact layer of crushed plaster above it is witness to the destruction of the building. At almost the same level on the northern side of the curb wall, a lime floor was uncovered. This floor and the curb wall probably belonged to the same building as the walls covered with painted plaster unearthed in 1969 and the following years under structure 23 belonging to VT.¹⁹⁾

K 4

The trench partly in the old pit 3/85.²⁰⁾ Several more covering slabs of the drain in street A were unearthed.

K 5

The trench enlarged northward, now 3.3 m long. Another section of the northern curb of street A and the drain were uncovered. Another greenish clayey surface was traced in R.28, just below the surface exposed in 1968.²¹⁾ Approximately 0.35 m further down, there is the leveling course of the curb, built of masonry blocks 0.79-0.89 m long set crosswise, lying upon a c. 1-m wide fill foundation. Departing from the curb is another wall with a similar leveling course, c. 0.07-0.14 m lower down, built of smaller blocks, 0.59 m long. To the south, at least 1.12 m away, there are large slabs, 0.91 m long, covering the drain under the street. Most of them were found disturbed.

The edge of the channel trough was recorded at 0.72 m below the datum. There are three street surfaces, two of them related to the curb, the third apparently cut by this wall, but extending immediately over the slabs covering the drain. Level with the edge of the trough yet another lime floor set with small stones was found. It was cut both by the curb foundation and the channel, and therefore must be earlier still. Finds were few, and only from the level 0.5-1.0 m below the surface, probably below the curb leveling course. The pottery is Hellenistic to early Roman, and includes, among other, the foot of a big ESA lagynos and a Rhodian stamp EΠΙ ΙΕ/ΡΩΝΟC (121 BC),²²⁾ i.e., belonging to the late phase of the 2nd century BC.

K 6

This trench cleared the old trench 5/83.²³⁾ Limited additions and corrections are necessary, but the overall interpretation re-

19) W.A. Daszewski, "Polish excavations at Kato (Nea) Paphos", *RDAC* 1970, 118, 133, Pl. XIX:3.

20) Daszewski, *BCH* 110 (1986), 860; Młynarczyk, op. cit., 173, n. 35.

21) Daszewski, *RDAC* 1970, op. cit., 123f, Pl. XXI:2.

22) G. Finkielsztein, *Chronologie détaillée et révisée des éponymes amphoriques rhodiens, de 270 à 108 av. J.-C. environ. Premier bilan*, *BAR* 1990 (Oxford 2001), Tables 12.2, 21.

23) Młynarczyk, op. cit., 173.

mains unchanged. The northern curb of street A and the drain were located (Fig. 4). Another channel directing sewage under the curb to the street drain was now found. This earlier channel, at least in the house to the north, was covered with slabs, the top of which measured 0.14 m below the datum. The later channel had an outlet cut in the lower edge of the curb, while the earlier one was low enough to make it unnecessary. *In situ* slabs covering the drain were also found at 0.44 m below the datum.

K 7

Trench in R.65, enlarged to 3.5 m N-S, excavated under a plastered floor on a cobble bedding. In the south part of this pit,



Fig. 4. Trench K 6, seen from the south (Photo W.A. Daszewski)

two earlier floors of R.65 were found, 0.09 m and 0.18 m respectively below the last floor. Below a leveling layer 0.2 m thick, containing small stones and crushed plaster, the northern curb of street A (with a foundation leveling course up to 0.9 m wide) was brought to light at 0.18 m above the datum in the northern part. It was built of large but partly irregular blocks, and its upper surface was partly covered with gypsum mortar. South of it (0.95 m), the covering of a drain made of large slabs c. 0.5 m wide and 0.65-0.75 m long was uncovered at 0.34 m below the datum. In the eastern section, four successive street surfaces were visible, the lowermost almost level with the drain covering. Some 0.3 m below this, another floor made of gray clayey soil was cut in its southern part by the trough of a drain, the top of which is at 0.67 m below the datum. Of the two layers discerned, the upper one was dated to the late 1st or early 2nd century AD by a CS form P12, Roman amphorae of late Rhodian and pseudo-Koan types, and the lower one to the 1st century AD by an Eastern Sigillata B base fragment, and the foot of a micaceous water jar.

K 8

Trench excavated in VT R.41 in December 2002,²⁴⁾ presently enlarged 1.3 m to the east and extended to 3.4 m (N-S) in the eastern end. The N-S wall was found to stand on large slabs covering the drain of street A at 0.03 m above the datum. The channel itself was not excavated, and only its northern edge was uncovered at 0.49 m below the datum. The curb of the street was found 1.3 m to the north of it, its top at 0.24 m below the datum. In the eastern section, two oblong blocks seem to belong to a side channel discharging into the drain.

24) Meyza, PAM XIV, op. cit., 257-259, fig. 1.

It should be noted that although the channel bottom itself could not be measured, measurements taken of the top of the trough confirmed a general fall of the drain toward the west. No street levels were observed in the sections.

K 11

Trench situated 3.2 m east of the eastern wall of VT, opposite the northern part of R.67 and the entrance to the baths, practically adjoining trench 7/83.²⁵⁾ The only recorded feature is a sequence of street A surfaces. The top two levels, crushed stones and thick sand respectively, at 0.46 m and 0.55 m below the datum, were probably only leveled; they may belong to a Late Roman N-S street. Following below are four lime surfaces, of which the uppermost (0.69 m below the datum) and the third are best visible. The bottommost surface at 1.19 m below the datum seems to be limited to the east half of the trench and lies immediately on red clayey, possibly virgin soil. The lowest floor appears to correspond to a layer of lime plaster (6a) recorded in trench 7/83, while the third floor from the top corresponds to floor I of 7/83. The explanation for the absence of a drain given by Młynarczyk²⁶⁾ seems to be principally correct, but it is more likely that the southeastern end of VT was simply at a local water divide. No finds were registered from trench K11.

Λ (*lambda*) 3

Trench between R.11 of the HH and the south wall of the western enclosure of VT. The sections show rubble similar to that found in HH R.11, including large

masonry blocks with painted decoration on plaster. In the north section, the trench adjoins the south wall of VT, built of small stones at a high level (1.07 m above the datum). At the bottom of the trench, two superimposed floors were found, corresponding to the floor level of HH R.11. The latest potsherd coming from the lower layer, recorded 1.0-1.5 m below the surface, was a Mau 27/28 amphora dated to the second half of the 1st century AD at the earliest.

Λ 4

Trench in the western portico (4) of the HH peristyle court. Wall foundations define it on three sides: on the west, the foundation of stairs leading to R.10 and R.12 with a leveling course at 0.08 m below the datum, on the north and east, two interlocked walls standing directly on top of an early floor at 0.65 m below the datum. The northern of these two walls continues the north wall of R.12. The eastern one at its southern end stands on a rubble layer above this floor at 0.14 m above the datum. This wall continues along the entire portico (its top is largely visible). A similar trial pit made between these walls slightly further south (in trench 1/93) had yielded 1st-century BC pottery, but possibly also Early Roman amphorae in the top layer.²⁷⁾ The present finds from Λ 4 confirmed this with the layer 0.5-1.0 m below the portico surface containing a few Roman finds of 1st/2nd century date (Beirut amphorae, CS form P18 (?); late Rhodian amphora handle). In the next layer (1.0-1.5 m), the pottery was Hellenistic, and rather of the middle of the period at that. Indeed, all the finds from the south-

25) Młynarczyk, op. cit., 173f; Papuci-Władyka, op. cit., 174-179.

26) Młynarczyk, op. cit., 174f.

27) W.A. Daszewski, "Nea Paphos 1993", *PAM V. Reports 1993* (1994), 102f; id. "Kato Paphos", in: D. Christou, "Chronique des fouilles et découvertes archéologiques à Chypre en 1993", *BCH* 118 (1994), 681.

ward extension were of this date. The bedrock in trench 1/93 was higher, hence the floor found there between the east and west walls was only c. 0.7 m below the portico surface.

Λ 5

Trench dug in the HH peristyle, against the outer mantle of the south wall of VT, opposite R.29. Low in the eastern and western sections, there are two walls, running parallel N-S at a distance of 1.48 m. The only floor, for which there is evidence that it is related to these walls, is the one at the bottom of the trench, at 0.76 m below the datum. In the north-eastern corner of the trench, traces of three more floors were preserved, but these do not make contact with the east wall, which with its at least two courses is better preserved here. It is interesting to note that the lowest floor is separated from the ones above by a layer of murex shells, and the middle floor contains thin layers of burnt matter. Above, up to 0.57 m below the courtyard surface, a rubble layer covers the early structures, and above it, the fill contains only small stones and pottery, apart from a single large block in the southwestern corner.²⁸⁾ The last layer may be connected with a courtyard garden, which was established here in the 1st century AD. The finds from the rubble layer, i.e., 0.5-1.0 m from the surface of courtyard 1, yielded a fragment of micaeous water-jar and some ribbed cooking pots, both Early Roman (related to garden fill or perhaps from the stone-robbing trench). The level of the walls and floors yielded Hellenistic pottery exclusively.

Λ 6

Trench extended E-W. At 0.9 m below the floor of HH R.5 (0.19 m above the datum), there is an N-S wall, 0.47 m wide and preserved 0.40 m above its foundation leveling course, which extends westward (the soil at its edge being soft). East of the wall only one floor was found just below the wall top. On its west, however, there is a sequence of three floors and a probable level of dismantling with little stones and a cutting leading to the top of the wall and through the last lime floor. Intercalated layers of ash appear between the underlying floors. In the north-eastern part, a pit cut from the level of last floor and adjoining the wall yielded a collection of lead moulding waste (lead flow channels). Between these floors, three coin mould slabs were found,²⁹⁾ one of them very unusual, reused for an uncertain purpose. Other traces of metallurgical activity in this area were found in different layers: fragments of crucibles, pieces of bronze slag, including large chunks (mainly on floor levels), and a deformed bottom of a lead vessel. The whole complex of floors is dated by finds of Late Hellenistic pottery including ESA forms 2 and 22 and Rhodian amphora stamps. Above these floors, the finds seem to be of slightly later date, e.g. CS form P22 (?) and the neck of a jug of this ware. These may be intrusive, however, from an N-S wall robbing pit or even from the construction trench of the VT south mantle wall.

Λ 7

Trench situated between the southern wall of VT opposite R.48B and the northern wall of R.6 in ERH, the trench measures 3.15 m (N-S). Its west side is bordered by

28) Cf. note 23, *PAM* V, op. cit., 103-105.

29) For other finds of the kind from the Polish excavations, cf. W.A. Daszewski, "Uwagi na temat produkcji monet w okresie ptolemejskim i wczesnocesarskim na terenie Pafos i Aleksandrii" in: *Starożytna Aleksandria w badaniach polskich*, ed. M.-L. Bernhard (Warszawa 1977), 147-160; id., "Polish excavations at Kato (Nea) Paphos in 1970 and 1971", *RDAC* 1972, 232; id., "Les fouilles polonaises à Nea Paphos 1972-1975. Rapport préliminaire", *RDAC* 1976, 217.

a Byzantine wall, which was founded on the rubble of a collapsed ERH wall. Below that collapsed wall, the whole trench is filled with clean soil down to 1.15 m and a loose gray layer down to 1.5 m (at 0.48 m below the datum). It is only at this level that structures appear: a gray clayey floor in the southwestern trench corner with a porous black lava slab. The finds from the second layer (i.e., probably still in the clean-soil fill) are Late Hellenistic, from the 1st century BC. The fine wares included ESA base form 22 or 23 and a gouged wall, probably of form 19. The latest piece may be a Roman (pseudo) Koan amphora handle.

A 10

Trench situated immediately south of the semicircular basin in the south wall of R.62 in the VT baths. An N-S wall of reused stones appeared under the basin foundation (i.e., heating chamber under it); it was 0.5 m wide and it constituted the eastern section of this trench. The foundation-leveling course (at 1.81 m below the datum) projected west. There are no clear traces of a floor corresponding to this wall, and the bottom of the trench, c. 0.5 m below (at 2.32 m below the datum), consisted of large irregular stones, possibly bedrock.

VILLA OF THESEUS TRENCHES IN THE EAST WING

The H (*betalita*) series of trenches runs across the service complex of the Villa at a distance of barely 5.74 m away from trenches I 8-11.

H 9

Trench situated in the northern part of R.81 and R.82 (trench H 8 was excavated in December 2002).³⁰⁾ Once this trench was extended to the west, an N-S wall was discovered in the middle of it. The wall with its wide (0.67 m) leveling course was identified as the west curb of the Hellenistic-Early Roman street 9 (with top at 0.31 m below the datum), over which the east part of VT was built. The leveling layer consists of a regular row of large masonry slabs and a less regular clustering of medium stones on its west side. West of the curb, a clay-lined cylindrical bin was found;³¹⁾ only its southern part was

uncovered. In the southern section the foundation of a wall running west from the curb appeared. The top of the foundation was 0.2 m below the curb top, and originally the leveling course must have been even with the curb. This would correspond to the partition walls dividing Late Hellenistic/Early Roman R.I-IV in the northern part of street 9. The trench east of the curb wall was dug to a depth of 1.3 m below the surface of R.82 and revealed a succession of street levels cut by an N-S ancient trench. Over this trench, in a gray-brown layer, a terracotta pipe (diameter 0.17 m) is visible in the south section. Four street surfaces of pure gray clayey soil could be observed at depths of 0.72, 0.77, 1.0, 1.2 m respectively below the floor of R.82. These layers were separated by reddish soil mixed with crushed plaster. A layer of heavy red clay appeared at 1.3 m below the

30) Meyza, *PAM* XIV, op. cit., 261, fig. 1.

31) Called a pithos in W.A. Daszewski, "Fouilles de Nea Paphos (Mission polonaise)", in: V. Karageorgis "Chronique des fouilles et découvertes archéologiques à Chypre en 1980", *BCH* 105 (1981), fig. 73; for present opinion, id., "Nea Paphos 1991", *RDAC* 1992, 251-253, Pl. LXXXVIII:3. E. Papuci-Władyka, op. cit., 212-218, has published the contents of one of these bins in some detail.

floor of R.82 (1.43 m below the datum). Pottery found in the top layer in the eastern part contained few characteristic sherds, but a base of Plain White bowl seems to be Roman from the 2nd century AD. This would confirm the dating of the latest use of street 9 in its northern end.³²⁾

H 10

Most of the structures uncovered in trench H 10 (*Fig. 5*) had been brought to light already in trench 11/83.³³⁾ The old trench was extended in both directions, achieving a length of 3 m, but it was in the eastern extension that an N-S wall was discovered with top at 1.44 m below the datum and



Fig. 5. Trench H 10, seen from the west; in the foreground, a cistern shaft uncovered in (Photo W.A. Daszewski)

a pebble floor just above it. The only find of interest is a polished stone axe, suggesting the occupation of this area in remote antiquity, probably in the Chalcolithic period, confirming finds of flint blades in 1983.

H 11

Trench situated in an N-S Late Roman street, but with no street levels in evidence. The trench was limited to 1.2 m (N-S), and the only structure encountered was an E-W wall near the trench bottom (at 1.11 m below the datum), partly visible in the northern section. The latest pottery from the lowest layer, 1.0-1.5 m below the surface, is a Mau 27/28 amphora fragment (dated to the late 1st century AD at the earliest).

Δ (*delta*) 8

Trench in the peristyle courtyard of VT, opposite the northern corridor leading west from atrium 71-72. The southern end of the trench, which was extended to 3.1 m in length, overlapped the earlier trench 1/80.³⁴⁾ Occupying the northern part is a lime (?) pavement on a bedding of fist-sized stones at 0.61 m below the datum. This floor may have been related to the E-W wall from trench 1/80; however, the wall and pipe uncovered in 1980 seem now to have gone without notice.

Δ 11

Trench situated just in front of the main entrance to VT. Two hydraulic installations were uncovered (*Fig. 6*). Close below the surface, at 0.33-0.37 m below the datum, there was a clay pipe (with differing diameters of particular sections – 0.2 m for two pieces and 0.17 m for three others) running from the southeast down under the gate portico. Two of the narrower

32) W.A. Daszewski and Z. Sztetyłło, *RDAC* 1988, op. cit., 200; Młynarczyk, op. cit, 170.

33) W.A. Daszewski et al., "Fouilles polonaises à Kato Paphos. Chantier de Maloutena", *RDAC* 1984, 301.

34) Daszewski, *BCH* 105, 1981, 1005, id., "Nea Paphos 1978-1980", *EtTrav* XIV (1990), 428, fig. 20.

segments had inspection holes. Further down, at 1.03 m below the datum, the slabs covering an E-W channel in street B were found. Most of the covering slabs (0.59 x 0.43 x 0.1 m at the largest) were disturbed and the channel was partly filled. The fill reaches 1.4 m below the top of the covering slabs. Above the ruined channel covering a stony fill occurs, perhaps from an earlier trench (?).

Γ (*gamma*) 9-10

Trench excavated in December 2002, subsequently extended northward by 0.9 m in the eastern part and 0.5 m and less in the western part. A continuation of the east curb of the Hellenistic-Early Roman street 9 was found with corresponding floors east of it.³⁵⁾

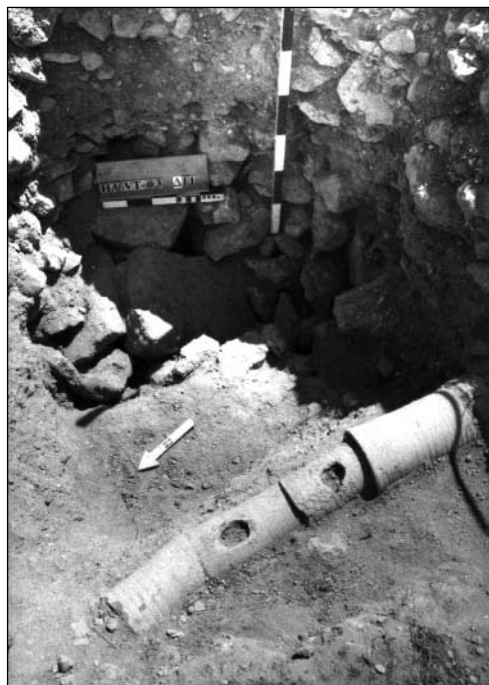

Fig. 6. Trench Δ 11, seen from the northwest (Photo W.A. Daszewski)

B (*beta/vita*) 8

Trench in the northeastern corner of the VT peristyle courtyard, enlarged southward to measure 3.5 m in length. Immediately below a reconstructed wall closing the north side of the court, in the southeastern corner of two walls, the remains of a round well or cistern mouth were found at 0.21 m below the datum. It may belong to a cistern fed from a basin to the north with an input hole to the northwest. The N-S wall seems to continue the west wall of the basin. This wall reveals two phases of construction, the later one related to the E-W wall forming the corner. The earlier phase, running south from the corner, in its southern part has three courses preserved above the foundation leveling at 0.44 m below the datum. In the northern part of the trench, the lowest layer (1.0-1.5 m below the surface) contained a sherd of Italian sigillata with a *planta paedis* stamp; in the southern extension, the lowest layer seems to be slightly earlier, with the latest pieces being a Late Hellenistic/Early Roman Red Slip jug and a Gaza amphora. An interesting group of fragments of a decorated appliqué of a brazier belong to an earlier phase.

A 9

Trench in the eastern part of VT R.104S, enlarged 1.5 m to the east. Running down the middle was the foundation, 1.0 m wide, of the western curb of the Hellenistic-Early Roman street 9; on top of it there appeared two slabs forming an "L" at 0.57 m below the datum. On its west side, a corner of two plastered walls was uncovered, forming the northern and western sections of this part of the trench. Below (0.34 m) the plaster on these walls, south of the plastered area, there is a hard lime floor at 1.25 m below the datum. A band of soil 0.08 m thick

35) Meyza, PAM XIV, op. cit., n. 8, 9.

separates the floor and the west (N-S) wall (which seems to cut through the floor). This floor is limited to the southern half of this trench (or was also cut on the north side). The walls continue down without a leveling course and in the northeastern corner created by the street curb and the E-W (northern) wall, there is a rectangular well reaching at least 1.91 m below the datum. No wellhead is preserved; only medium blocks forming its sides are visible at 1.69 m below the datum (Fig. 7). The well leads at the uncovered level to a carefully built crossing under the curb. At present two widely differing interpretations of this structure are possible. The well either was used to discharge into the street drain or may have collected rainwater from

a stone downspout on the eastern side of the curb wall (preserved upper edge at 1.68 m below the datum, but which may continue slabs set in an "L" on top of the foundation found over 1 m above). On the other side of the curb, at least five street levels are visible, the uppermost even with the curb-leveling course and with a terracotta pipe (N-S) with a diameter of 0.22 m. These levels consist either of lime and crushed stones or of red clay. Only one pottery group, from the western part of level 1, was registered. Apart from one doubtful piece, it included pottery dating to the 1st century BC (ESA Hayes form 23, a lagynos, Color Coated Ware).

A 10

Trench situated at the meeting point of R.97N, R.97WN and R.97WS, enlarged 1 m to east and north, into R.97N. The southern part of R.97N was found to be the spot of an approximately square well, measuring 0.87 by 0.82 m. The walls are built of relatively small stones and provided with footholds on the eastern and southern (?) sides. The well was excavated to a depth of 0.7 m from its top at which point a large, vertically set slab blocked further exploration. Forming the eastern section of the trench was an N-S wall, dividing R.97N and R.97WN. It has a foundation-leveling course, 0.62 m wide, made of long, well-cut masonry slabs. At this level, there are only faint traces of two superimposed floors in the eastern section. The center of the trench was occupied by a large pit, filled with burnt matter and ashes in the northwestern corner; it descended 0.7 m below the leveling course of the N-S wall. The remains excavated below this belong to an earlier phase, with an N-S wall beneath the eastern section and four floor levels. The earliest floor constitutes the bottom of the trench at



Fig. 7. Trench A 9, seen from the west; at the bottom of the well, a channel crossing the curb foundation (Photo W.A. Daszewski)

1.55 m below the datum. It is the only one to be related with any certainty to the early N-S wall with preserved thick plaster coating. The next floor, 0.15 m higher up, may have belonged to a later phase of this structure. Both extend only to a line 0.5 m distant from the northern edge of the wellhead. The N-S wall also discontinues after another 0.12 m southward. The following two floors, at 0.42 m and 0.5 m above the preserved floor, can be seen in the trench section extending over the plastered wall. Finds from the first layer in the southwestern part of the initial trench included amphorae of types Mau 27/28 and Kapitän II,³⁶⁾ and should be later than the 2nd century AD. The layer below contained a large corroded bronze coin, probably Ptolemaic, and a Knidian Gray Ware handle dating to the 1st century BC.

A 11

Trench in the Late Roman street between VT and HA, opposite VT R.86. It was situated in the corner of the Hellenistic walls, visible after removing the tumble of the House of Aion and the Northeastern House. Once a street surface and underlying fill were removed, at 0.52 m below the datum, another E-W wall was found 0.75 m to the north. All the walls were c. 0.5 m thick. The east and south walls had their foundation leveling courses at approximately the same height, that is, 0.9 m below the datum. They also seem to be interconnected and a poorly visible gray floor visible in the western section at 0.65 m below the wall top belonged probably to the construction level (?). The main level corresponds to a threshold in the N-S wall, situated just north of trench A 11.

Another E-W wall ran asymmetrically with respect to the threshold, just 0.6 m to the north. The entire N-S wall is preserved on a slightly higher level than the E-W one and probably acted as a curb for the Late Roman street. Inside trench A 11, possibly in a pit dug in the corner of these walls, an assemblage of vessels was found (*Fig. 8*). The deposit consisted of a somewhat damaged cooking pot with a lid, the latter made of a Color Coated Ware bowl with inturned rim datable to c. 40-10 BC³⁷⁾ and a second cooking pot placed over these two. The upper pot was broken. In the corresponding layer, apart from a number of



Fig. 8. Trench A 11, deposit of cooking pots and an inturned-rim bowl used as a lid, seen from the north (Photo W.A. Daszewski)

36) K.W. Slane, *Amphoras – Used and Reused – at Corinth*, in: *Transport Amphorae and Trade in the Eastern Mediterranean*, ed. J. Eiring and J. Lund (Aarhus 2004), 364f., n. 15.

37) J.W. Hayes, *Paphos III: The Hellenistic and Roman Pottery* (Nicosia 1991), 150, fig. LIII:42, A 42.

Hellenistic fragments and a complete open lamp, sherds indicated Roman use, including a micaceous pseudo-Koan [?] amphora *en cloche*.³⁸⁾ The northern E-W wall had its foundation leveling course c. 0.5 m below the other two walls and was cut by the N-S wall. It was built of irregular stones and leveled before the main

phase of use of the other walls. The finds from 0.5 m under the street level included exclusively Middle and Early Hellenistic pottery, and Early Hellenistic under 1.0 m. The earliest material should provide the date for the early E-W wall. There is a possibility that this wall corresponds to another wall found in trench A 12.

TRENCHES AROUND THE HOUSE OF AION

Δ (*delta*) 12

Trench dug in street B between the south wall of HA R.1 and the retaining wall of the HA trench. It was situated in a spot, where the foundation-leveling course of this wall was cut to accommodate the downspout. An open channel leading steeply from the wall of HA to the drain in street B was found. The upper surfaces of street B were disturbed during the building of the modern shelter over the HA mosaic floors. Very well preserved street levels, at least four superimposed ones, are found in the southwestern corner of the trench. A red-clay layer, probably related to the exploitation of the street drain, was encountered at 1.8 m below the datum. The finds below the top layer (going down from 0.5 m) contained largely early Hellenistic pottery.

Δ 13

This trench in street B uncovered almost the same area as excavated in trench 6/85, displaced just 0.5 m to the west and going down deeper.³⁹⁾

Δ 14

Next trench in street B along the south wall of HA, south of R.16. It contained no

recognizable structures. The rubble in the southwestern corner with voids may be all that remains of the covering of the channel in street B.

B 12

Excavated in HA R.13, in the southern part of its western compartment, under the level uncovered in trench HA 1/85. A similar pit was excavated in the northern part of this and in the next compartments to the east in 1984 (trench 3E).⁴⁰⁾ The strata was evidently formed as fill sloping northward by 0.8 m and slightly to the east. The level of the lowest layer, red virgin clay, is at 2.68 m below the datum.

B 14

Trench in the middle of HA R.10, initially L-shaped around a pithos in the southwestern corner, was extended 1 m to both the north and the east. Stony fill with Early Roman pottery occurred in a large pit, 1 m deep, cut down to red virgin clay in the northwestern part of the trench, starting 0.4 m under the floor of R.10. Outside the pit, at least four superimposed lime or calcarenite floors with intercalated red soil were identified. The uppermost floor cor-

38) J.-Y. Empereur and M. Picon, "Les régions de production d'amphores imperiales en Méditerranée orientale", in: *Amphores romaines et histoire économique: dix ans de recherche* (Rome 1989), 231f, fig. 5.

39) Daszewski, *BCH* 110, op. cit., 861; id., *Nea Paphos* 1985, *EtTrav* XVI (1992), 299, fig. 10.

40) Daszewski "Fouilles de Nea Paphos (Mission polonaise)", in V. Karageorghis, "Chronique des fouilles et découvertes archéologiques à Chypre en 1984", *BCH* 109 (1985), 954; B. Lichocka and H. Meyza, "Seismic events and the evidence of coins and pottery. The case of destruction of the House of Aion in Paphos", *EtTrav* XIX (2001), 157-160, fig. 5.

responds to the top of the great pit. The floors in the eastern and western sections ended abruptly at one vertical cut, which seems to precede and be unrelated to the great stone-filled pit discussed above. At this point, the red virgin soil had been excavated deeper, down to the present bottom of the trench at 1.4 m depth, but a level of small stones corresponds to its level elsewhere. The fill north and above is homogeneous up to the level of the uppermost floor. Perhaps it was made for the purpose of constructing a massive structure that was dismantled from the later pit. The latest piece of evidence from the lowermost layer was an African Red Slip Ware plate F 67 decorated in style A I/II, datable to c. AD 360-420.⁴¹⁾ This, and other less obviously dating fragments suggest that the great pit was dug in Late Roman times, probably just before the storage and liquid-processing installation was established in R.10.⁴²⁾ A majority of the pottery was Hellenistic and it is tempting to see in its finds from the floor levels in the southern part of this trench.

A 12

Trench situated in and north of NEH R.4, against a wall dividing the room and the corridor to its east. The trench is only 1.3 m wide (E-W) but enlarged southward to measure 3.7 m in length. Two E-W walls were found and possible remains of a third, dismantled. In the northern section a late wall is to be observed, corresponding to a similar one found in trench HA 1/95.⁴³⁾ Another wall is situated at a lower level more (0.45 m) to the south, with remains of a doorjamb and a threshold at 0.87 m below

the datum. This wall corresponds to the earlier wall in trench A 11, as well as eastwards, a wall closing the corridor. The door must have been blocked, since there are stones placed on the threshold and otherwise the door would have to be less than 0.6 m wide. This wall was built in a trench, which seems to cut two floors, the upper at 0.9 m below the datum. The upper floor probably corresponds to the earlier phase of the wall with door. In front of the threshold, there is a small strip of floor at a slightly higher level, possibly simply closing the pit. A trench, 1.5 m south of the wall with door, cuts these floors. It is filled loosely with stones, being what remains of a third, robbed out E-W wall. Finds from the bottom layer (below the upper floor cut by the E-W wall) included Roman pottery (amphorae of type Mau 27/28 of the late 1st century AD at the earliest and Kapitän II of the late 2nd century AD at the earliest).

A 13

Trench north of NEH R.12E, on the south side connected to the old trench HA1/90W (*Fig. 9*).⁴⁴⁾ The southern, northern and eastern sections of this trench consisted of walls. The southern E-W wall continued a wall (dismantled) found in trench HA 1/95.⁴⁵⁾ Another one appeared 1.65 m to the north, at 0.65 m above the datum, corresponding to the north (late) wall in the same trench (and similarly almost without foundation). Both were superimposed on an N-S wall, constituting the eastern section. The southern E-W wall had a narrow leveling layer of flat blocks 0.2 m thick. Double vertical blocks on the east probably

41) J.W. Hayes, *Late Roman Pottery* (London 1972), 112-116, 218, pl. XII B right.

42) Lichočka and Meyza, *op. cit.*, 163-166, 183, 188f, 197-199, fig. 8, 9: 2-3, 14.

43) W.A. Daszewski, "Nea Paphos Excavations 1995", *PAM VII, Reports 1995* (1996), 99; Lichočka and Meyza, *op. cit.*, 178, fig. 3:9, 4:11.

44) Lichočka and Meyza, *op. cit.*, 172-176, fig. 10, 11:1-6, 8-9; E. Papuci-Władyka, "Nea Pafos, studia ...", *op. cit.*, 86-93, fig. 5.

45) Cf. note 37.

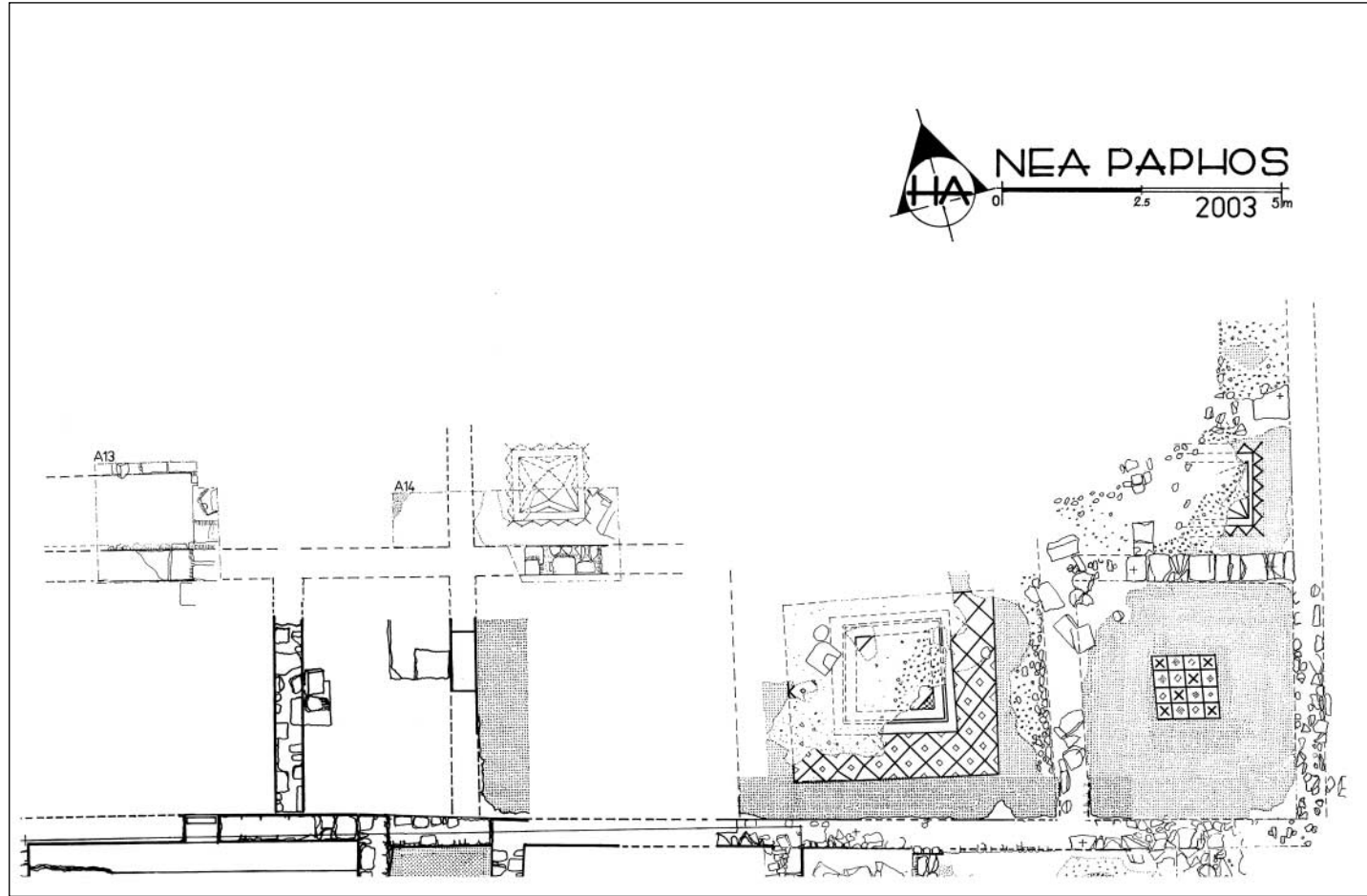

Fig. 9. Plan of the eastern part of the Northeastern House
(Drawing S. Medeksza)

formed a doorjamb, an interpretation supported by finding outside these a large thick slab 0.47x0.47x0.28 m with a square hole for a wooden jamb. Features, which may reflect two construction phases, appear in the N-S wall, the lower two courses built with gypsum mortar reaching to 0.1 m above the datum. West of the preserved stretch of the northern E-W wall in the northern and eastern sections, there occurs a 3-cm thick lime floor (I) at the datum level. This floor is connected with the E-W wall, and over it are blocks arranged vertically and in quite good order, as in a folded wall. Floor I seems to have preceded the southern E-W wall, or at least its last phase, as it is cut along its leveling course. Under this floor, 0.56 m below, there is another floor (II) made of greenish-gray clay. Both the south and the east walls cut through this floor; in the former case, the fill along the wall is soft. In the case of the

N-S wall, another lower floor level was encountered running up to a wall bonded with gypsum mortar.

Several (eight) large blocks, probably from the excavated tumble (above floor I) were left around the trench. One of these is a large column or cippus with a hole for an axial dowel and traces of base mouldings, remade into an approximately rectangular pillar 0.77 m high and 0.43 by 0.4 m in plan.

A 14

Trench situated north of NEH R.9 and R.11W (cf. *Fig. 9*).⁴⁶ An E-W wall, 0.51 m wide and plastered on the northern side, dividing these rooms from two newly found ones, was uncovered against the southern section.

North of it, approximately at the datum level, a mosaic floor connected with the E-W wall was found (*Fig. 10*). It was



*Fig. 10. Mosaic in trench A 14, seen from the north
(Photo W.A. Daszewski)*

46) Lichočka and Meyza, op. cit., 150, 169f, fig. 1.

decorated with a geometric panel against a gray background, of which most of the southern half has been uncovered. The central square is encircled by a single row of serrated white triangles, plain band of nine dark gray cubes and a double white fillet. In the middle, a tangent four-pointed white star is found around a violet square. Single small white-violet saw-tooth patterns of triangles are found near

the star. The west edge of the mosaic seems to have been set against a robbed-out N-S wall, west of which extended another mosaic floor, damaged at the accessible edge, but visible close to the section. The damaged mosaic is situated 0.3 m above the better preserved one. The southern wall of the new rooms is robbed-out in its western part. No finds were registered from the fill above the mosaics.