

6-15-2012

ENG 3970/5997

Suzie Park
Eastern Illinois University

Charles Wharram
Eastern Illinois University

Follow this and additional works at: http://thekeep.eiu.edu/english_syllabi_summer2012



Part of the [English Language and Literature Commons](#)

Recommended Citation

Park, Suzie and Wharram, Charles, "ENG 3970/5997" (2012). *Summer 2012*. 13.
http://thekeep.eiu.edu/english_syllabi_summer2012/13

This Article is brought to you for free and open access by the 2012 at The Keep. It has been accepted for inclusion in Summer 2012 by an authorized administrator of The Keep. For more information, please contact tabruns@eiu.edu.

3970/5997

English 3970/5997

Study Abroad: English Gothic Landscapes

Harlaxton Manor, Grantham, England
Professors Suzie Park and Charles Wharram

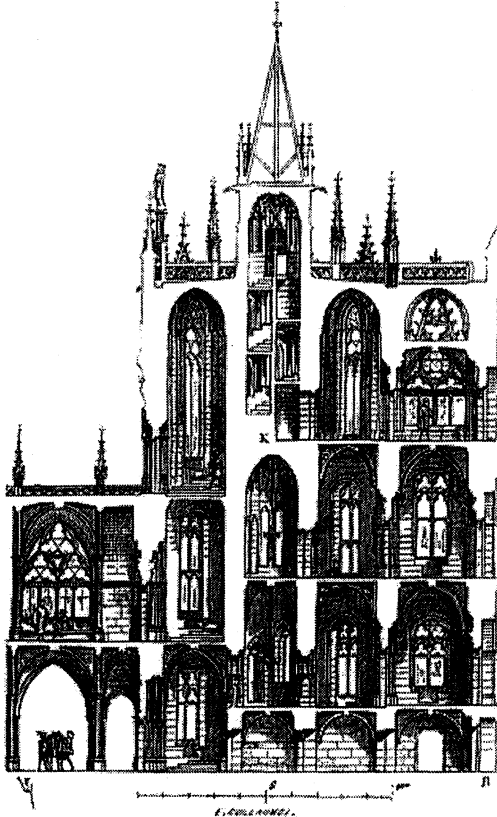

Class: 9:00 am - 12:00 pm

Summer 2012: June 4 – July 6

TRAVEL ITINERARY and SYLLABUS

WEEK 1

Su June 3: American Air flight #54 depart Chicago O'Hare 6:05pm for Manchester International (7 hours 45 minutes)

M June 4: arrive Manchester 7:50am; charter coach to Harlaxton Manor; Manor orientation

Tu June 5: Class—Jane Austen, *Pride and Prejudice*, and S.T. Coleridge, *Rime of the Ancient Mariner*

W June 6: Charter coach to Stamford (Burghley House); Cambridge (Ghost Tour and punting)

Th June 7: Class—Austen, *Pride and Prejudice*

F June 8: Charter coach to Bakewell, Derbyshire; walk to Chatsworth House

Sa-Su June 9-10: Independent study/travel

WEEK 2

M June 11: Class—Wordsworth and Coleridge, *Lyrical Ballads*

Tu June 12: Class—Wordsworth and Coleridge, *Lyrical Ballads*

Midday: Charter coach to Lake District, with overnight accommodations in Windermere

W June 13: visits to Dove Cottage, Wordsworth Museum, Rydal Mount; fells walk OR ferry to Beatrix Potter home

Th June 14: Return from Lake District after lunch

F-Su June 15-17: Independent study/travel



WEEK 3

M June 18: Class—Horace Walpole, *The Castle of Otranto*

Midday: Charter Coach to Lincoln Cathedral and Lincoln Castle tour

Tu June 19: Class—Walpole, *The Castle of Otranto*; select "gothic" poetry (course reader), plus Walpole on Shakespeare

W June 20 (LONDON DAY TRIP): Charter coach to London—London Bridge walking tour, Tate Gallery of Modern Art, Strawberry Hill (Twickenham, opens 14:00), The Globe (evening play to be announced)

Th-Su June 21-24: Independent study/travel

WEEK 4

M June 25: Class—Byron, *Don Juan*, Cantos 14-16 (course reader)

Tu June 26: Class—poems/ballads on Robin Hood (Keats, Hunt, Peacock, Scott) (course reader)

W June 27: Charter coach to Newstead Abbey and Nottingham (Robin Hood Tour)

Th June 28: Class—Bram Stoker, *Dracula* (selection); 2-5 p.m. class— J. K. Rowling, *Harry Potter and the Sorcerer's Stone*

Friday-Saturday June 28-June 30: Independent study/travel

WEEK 5

SUNDAY July 1: Charter coach to Goathland, steam train (used in *Harry Potter* film) to Whitby; visit Whitby Abbey (*Dracula*), ghost tour; overnight in Goathland, Yorkshire Moors

M July 2: depart Goathland, go to Alnwick (pronounced "annick") Castle (the setting for Hogwarts School in *Harry Potter*), Northumberland

Tu July 3: depart Alnwick; go to York, tour York Minster and city

W July 4: Return to Harlaxton; Fourth of July celebration at Harlaxton

Th July 5: Reading Day

F July 6: Coach to airport; Depart Manchester International American Air flight #55 10:40am to Chicago O'Hare arriving 1:10pm (8 hours 30 minutes)

Required Texts:

Austen, Jane. *Pride and Prejudice*. (Norton Critical Edition of 2000 preferred.)

Rowling, J. K. *Harry Potter and the Sorcerer's Stone*. Bloomsbury Publishing, 2001.

Walpole, Horace. *The Castle of Otranto: A Gothic Story*. Oxford: Oxford University Press, 2009.

Wordsworth, William, and S. T. Coleridge. *Lyrical Ballads and Other Poems*. Hertfordshire: Wordsworth Editions, 2003.

Course reader

Grading and Requirements:

Participation in class discussions and group travel—20%

Brief writing assignments—50%

Final Exam—30%



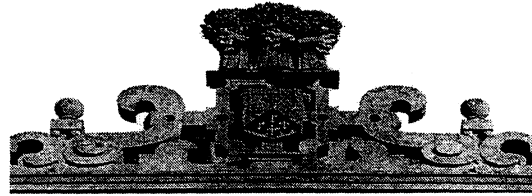

HARLAXTON COLLEGE
British Campus of the University of Evansville

EASTERN ILLINOIS UNIVERSITY
ENGLISH GROUP

2012
ITINERARY

ARRIVE: MONDAY, 4 JUNE
DEPART HARLAXTON:
FRIDAY, 6 JULY

Group Leaders:
Dr Suzie Park, and
Dr Charles Wharram

Total Nos. tbc

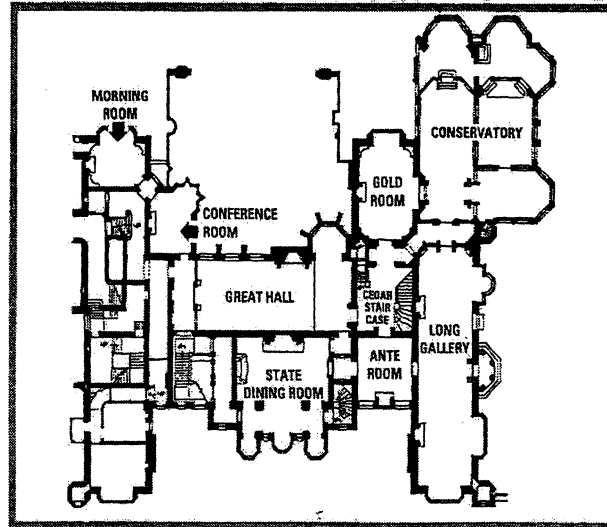

Harlaxton meals are served daily as follows:
Breakfast: (Mon-Fri) 7.30am - 8.30am
(Sat-Sun) 7.30am - 9.00am
Lunch: (Mon-Sat) 11.45am - 1.00pm
Sun (Brunch) 11.30am - 1.00pm
Evening Meal: 5.30pm - 7.00pm

Eastern Illinois University
Monday, 4 June-Friday, 6 July 2012
Total Nos. tbc

Monday, 4 June

A C Williams coach to collect from
 Manchester airport (tbc)
 Transfer to Harlaxton
 Lunch/refreshments on arrival
 Orientation
 Evening meal

Tuesday, 5 June

Class: 9:00am - 12 noon
 Lunch and evening meal
 7:00pm guided tour of Harlaxton Manor

Wednesday, 6 June (packed lunch)

9:30am A C Williams coach to **Burghley House** for
 10:30am guided tour, afterwards on to **Cambridge**
 and an evening walking/punting ghost tour
 Evening meal in Cambridge (*own arrangements*)
 Return late to Harlaxton

Thursday, 7 June

Class: 9:00am - 12 noon
 Lunch and evening meal

Friday, 8 June (packed lunch)

8:30am A C Williams coach to **Bakewell**,
 Derbyshire and walk to **Chatsworth House**
 Return to Harlaxton for evening meal

Saturday and Sunday, 9 & 10 June

Student independent travel, return to Harlaxton for
 Evening meal on Sunday

Monday, 11 June

Class: 9:00am - 12 noon
 Lunch and evening meal

Tuesday-Thursday, 12, 13 & 14 June

Class: 9:00am - 12 noon
 1:00pm A C Williams coach to the **Lake District** and
 Two overnights at the Burnside Hotel, Windermere
 7:00pm Group dinner at the hotel

Wednesday, 13 June

Visits to **Dove Cottage and Wordsworth Museum**
 and **Rydal Mount**
Optional Fell walk/ ferry to Beatrix Potter
 (*own arrangements*)

Thursday, 14 June

Depart Lake District for return to Harlaxton for evening
 meal

Friday-Sunday, 15, 16 & 17 June

Student independent travel, returning to Harlaxton for
 Evening meal on Sunday

Monday, 18 June

Class: 9:00am - 12 noon
 Lunch
 1:00pm A C Williams coach to **Lincoln** and tour of
Lincoln Cathedral
 Return to Harlaxton for evening meal

Tuesday, 19 June

Class: 9:00am -12 noon
 Lunch and evening meal

Wednesday, 20 June (packed lunch)

8:00am A C Williams coach to **London** and visits to
 Tate Modern and London Bridge walking tour
Afternoon tour Strawberry Hill
 Evening performance at Shakespeare's Globe Theatre
 Return late to Harlaxton

Thursday-Sunday, 21, 22, 23 & 24 June

Student independent travel, return to Harlaxton for
 evening meal on Sunday

Monday and Tuesday, 25 & 26 June

Class: 9:00am - 12 noon
 Lunch and evening meal

Wednesday, 27 June (packed lunch)

9:00am A C Williams coach to **Nottingham** (Robin Hood
 tour) and visit to **Newstead Abbey**
 Return to Harlaxton for evening meal

Thursday, 28 June

Class: 9:00am - 12 noon
 Lunch and evening meal

Friday-Saturday, 29, & 30 June

Student independent travel, returning to Harlaxton
 For evening meal on Sunday

Sunday-Wednesday, 1, 2 & 3 July (packed lunch)

EARLY BREAKFAST

7:30am A C Williams coach to **Whitby** and one
 overnight at the Mallyan Spout Hotel, Goathland
 Steam train to Whitby
 Visit **Whitby Abbey** and ghost walk

Monday, 2 July

Depart Goathland for **Alnwick** and one overnight at
 The White Swan Hotel
 Tour of **Alnwick Castle**

Tuesday, 3 July

Depart Alnwick for return to Harlaxton for evening meal.

Wednesday, 4 July

Class: 9:00am-12 noon
 Lunch
 6:00pm Harlaxton 4th July celebration held in the
 State Rooms, Conservatory and Gardens

Thursday, 5 July

Reading day
 Lunch and evening meal

Friday,

Depart Harlaxton A C Williams coach for
 Manchester airport (details tbc)



AIR

03 JUN 2012 ▶ 06 JUL 2012 TRIP TO MANCHESTER UK, UNITED KINGDOM

PREPARED FOR
SUZIE PARK



SUZI DAVIS TRAVEL/AMERICAN EXPRESS
TRAVEL@SUZIDAVIS.COM
WWW.SUZIDAVIS.COM
TRAVEL@SUZIDAVIS.COM

RESERVATION CODE HSYJVS
AIRLINE RESERVATION CODE HSYJVS (AA)

✈ DEPARTURE: SUNDAY 03 JUN ▶ ARRIVAL: MONDAY 04 JUN
Please verify flight times prior to departure

AMERICAN AIRLINES AA 0054 Duration: 07hr(s) :45min(s)	ORD CHICAGO OHARE, IL	MAN ▶ MANCHESTER UK, UNITED KINGDOM	Aircraft: BOEING 757 JET Distance (in Miles): 3817 Stop(s): 0
	Departing At: 6:05pm (Sun, Jun 3) Terminal: TERMINAL 3	Arriving At: 7:50am (Mon, Jun 4) Terminal: TERMINAL 3	

Passenger Name:	Seats:	Class:	Status:	Meals:
» SUZIE PARK	Check-In Required	Economy	Confirmed	Dinner, Continental Breakfast

✈ DEPARTURE: FRIDAY 06 JUL Please verify flight times prior to departure

AMERICAN AIRLINES AA 0055 Duration: 08hr(s) :30min(s)	MAN MANCHESTER UK, UNITED KINGDOM	ORD ▶ CHICAGO OHARE, IL	Aircraft: BOEING 757 JET Distance (in Miles): 3817 Stop(s): 0
	Departing At: 10:40am Terminal: TERMINAL 3	Arriving At: 1:10pm Terminal: TERMINAL 5 INTERNATIONAL	

Passenger Name:	Seats:	Class:	Status:	Meals:
» SUZIE PARK	Check-In Required	Economy	Confirmed	Lunch, Snack

OTHER: SATURDAY 06 OCT

OTHER Status: Confirmed	CMI CHAMPAIGN, IL	\$1,320 plus taxes + fuel surcharges
	Information: SERVICE FEE	

SUZI DAVIS TRAVEL/AMERICAN EXPRESS
WWW.SUZIDAVIS.COM
TRAVEL@SUZIDAVIS.COM

TRAVEL@SUZIDAVIS.COM

DEPART: JUNE 3 CHICAGO TO MAN

RETURN: JULY 6 MANCHESTER TO CHIC

Estimated Student Budget

English, Dr. Dana Ringuette

English Literary Landscapes**Payment Information:**

Amounts in **RED** are estimated costs that will be billed to your EIU student account. Amounts in **BLUE** are estimated costs that you will pay to third parties. Actual total cost will depend on your personal preferences and planning, as well as your spending habits.

Financial Aid/Scholarships available for use on this program:

- > Federal Financial Aid (loans, grants, etc.)
- > Private Financial Aid (loans)
- > EIU Study Abroad Scholarships
- > National Study Abroad Scholarships

Number of Weeks: 5
Semester: Summer 2012
Credits: 6
Program Type: Faculty-led

See the study abroad website for the most current, up-to-date scholarship information.

Category	Amount	Notes
Program Fee:	\$4,390.61	Includes: Airfare, local transportation, lodging, meals, health insurance and course excursions.
EIU Tuition:	\$1,434.00	ESTIMATED at \$239/cr (Fall 2009 entry). For your actual tuition rate, visit: http://www.eiu.edu/~finaid/cost.php
EIU Fees:	\$540.00	est. \$90/cr. EIU administrative fees
Airfare:	\$0.00	Included in Program Fee
Room:	\$0.00	Included in Program Fee
Meals:	\$0.00	Included in Program Fee
Books:	\$0.00	N/A
Local Travel:	\$0.00	Included in Program Fee
Passport:	\$135.00	See website for how to get a passport
Pictures:	\$10.00	Passport photos (~\$7-10/set of photos)
Immunizations:	\$0.00	if up to date
Spending/Misc.	\$400.00	\$100/week
Visa:	\$0.00	Not necessary for short-term tourism for US citizens
Total:	\$6,909.61	

Cost worksheet updated: 12/6/2011

