

2016-05-22

James Joyce Run: Good Puzzle Would be Cross Dublin Without Passing a Pub

Barry Sheehan

Technological University Dublin, barry.sheehan@tudublin.ie

Follow this and additional works at: <https://arrow.tudublin.ie/desigpart>

 Part of the [Architectural History and Criticism Commons](#), [Historic Preservation and Conservation Commons](#), [Interactive Arts Commons](#), [Modern Art and Architecture Commons](#), [Modern Literature Commons](#), [Other Architecture Commons](#), and the [Urban, Community and Regional Planning Commons](#)

Recommended Citation

Sheehan, B. (2016) James Joyce Run: Good puzzle would be cross Dublin without passing a pub, www.jj21k.com. doi:10.21427/D7H891

This Article is brought to you for free and open access by the Design and Printing at ARROW@TU Dublin. It has been accepted for inclusion in Academic Articles by an authorized administrator of ARROW@TU Dublin. For more information, please contact yvonne.desmond@tudublin.ie, arrow.admin@tudublin.ie, brian.widdis@tudublin.ie.



This work is licensed under a [Creative Commons Attribution-Noncommercial-Share Alike 3.0 License](#)

— James Joyce 21k

Discover Dublin by Running and Reading

[About](#) [jj21k](#) [The Blog](#) [Publications](#) [Bibliography](#) [Me](#) [Resources](#)

May 22, 2016

Good puzzle would be cross Dublin without passing a pub



5 St. Peter's Road, formerly 7 St. Peter's Terrace, Cabra

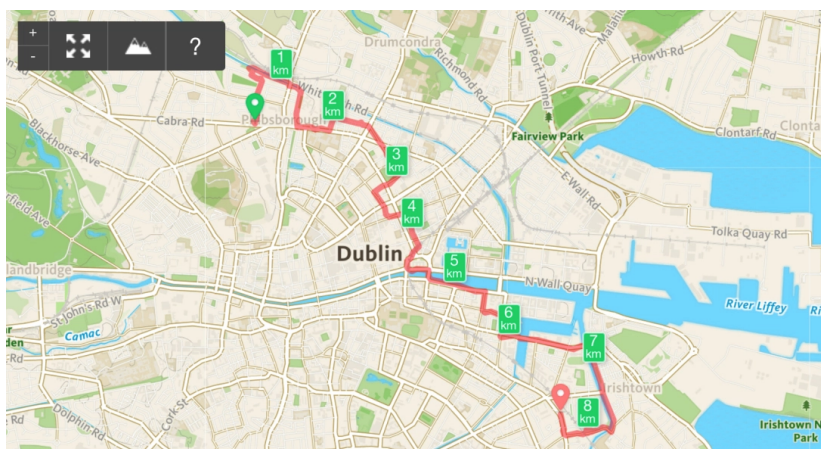

Pub Puzzle Route Map on <http://www.runkeeper.com>

Good puzzle would be cross Dublin without passing a pub. Save it they can't.

James Joyce, *Ulysses* (p. 48).

Leopold Bloom posed his famous puzzle in the novel *Ulysses* as he wandered out to buy a kidney for his breakfast on the 16th June 1904.

Can you cross Dublin without passing a pub? Can you cross it now? Could you cross it in 1904?

In June 2011 Computer Programmer Rory McCann used computers to solve the puzzle. He plotted the locations of the existing public houses and he used algorithms to avoid them. To solve the puzzle, he set rules, and you can read about his solution here.

Rules

I decided to solve the same puzzle, but choosing a journey that Joyce or Leopold Bloom would likely have made and using my own set of rules.

Rule One: Relevancy

The first rule is that the route has to have some relevancy to the writings of James Joyce, and or his actual life in Dublin. This rule pretty much defines all the runs in these blog posts.

I very quickly decided to try to find a route from 5 St.Peter's Road in Cabra, the Joyce family home on 1904, on the north-west side of the city to 60 Shelbourne Road on the south-east side. I am interested in the Joyce family's financial decline and its associations with their moving steadily northward through Dublin. As soon as he got a chance, James Joyce moved directly south from the family home to Shelbourne Road.

Rule Two: Cross Dublin

The second rule is that you actually have to cross Dublin. Skirting the edges of the city is not good enough. Starting outside the city and passing through the centre is ideal.

It would be relatively simple to skirt the city, keeping to the canal or city edges. I decided to run through it. This presents problems as the centre of Dublin has a lot of pubs.

Rule Three: Don't Pass a Pub

The most fundamental of rules. Passing a pub would be defined as passing by an entrance door to a public house, either on the same side, or on the opposite side of the street.

I decided that although Hotels, Wine Bars and Off Licences are places you can get a drink, they do not count as they are not public houses. I decided to try to avoid them anyway.

Armed with a set off rules I began my game.

The Solution

The general solution did not take long to figure out. The details did. I made a lot of trial runs and some walks, and at least one false start. I discovered pubs along the way, all of which had to be avoided and led to some contortions of the route, but the route is largely linear and directly links the two points. Bloom undergoes a lot more diverse wanderings and covers more distance on the 16th June 1904.

In devising the route the first thing to avoid is nearly all corners. To paraphrase an old joke, Why did Ireland never win the World Cup? Because every time they got a corner they opened a pub. You cannot avoid all corners, but you can avoid large junctions such as the main one in Phibsborough.

Route Notes

In the route descriptions I have used present day street names. It was very common for names of streets and house numbers to be changed in Dublin. I have noted several in the text.

I have used various Thom's directories for historical information. Thom's produce an almanac every year with information on residents and businesses in Dublin, amongst other facts. Generally I used the Thom's of 1905, as its publication date is December 31st 1904, and its contents reflect locations in 1904. The directories are available to read in the Dublin City Library and Archive, 138-144 Pearse Street, Dublin 2. D02 HE37.

I have referred to Roger Norburn's *A James Joyce Chronology* for key dates.

In the descriptions below I have made reference to present day and historic Ordnance Survey digital maps on <http://www.osi.ie> and maps.osi.ie. I have referred to the Historic Map 25 inch set from 1888 – 1913, which show the layout of the city that most closely matches the layout of 16th June 1904. Google Street View and Apple Maps are useful tools.

Nothing compares to going out and seeing the city on foot.

County Dublin

In 1904, addresses in Phibsborough are listed in the County Dublin Directory. The 1908 directory notes that Phibsborough has been amalgamated with the City of Dublin and in 1909 the streets of Phibsborough are listed in the City of Dublin Street Directory.

So the run begins outside of Dublin, as defined in 1904.

You can see the present day map of the area on maps.osi.ie [here](#)

You can see the Historic Map 25 inch (1888-1913) map on maps.osi.ie [here](#)

The Start: 5 Saint Peter's Road, formerly 7 Saint Peter's Terrace Cabra (North)

The Joyce family moved to 7 St. Peter's Terrace Cabra on October 24th 1902. Norburn (p. 12)

Thom's directory of 1903 (p.1738), 1904 (p.743) and 1905 (p.1799) list a John Joyce, James's father as living at 7 St. Peter's Terrace Cabra.

In the 1906 edition of Thom's there is no St. Peter's Terrace, as it appears to have been amalgamated into the listing for St. Peter's Road. And there is no John Joyce living on the road.

We depart, as did James Joyce, in our case heading north.

Shandon Street (North) and Shandon Park (West)

Neither Shandon Street nor Shandon Park appear in the 1904 and 1905 editions of Thom's and were most likely open fields. The first houses of Shandon Road can be seen in the 25 inch Ordnance Survey Map (1888 – 1913), with the first listings beginning in Thom's of 1915.

The open land is probably the location where "*He drives his beasts above Cabra*" from the poem *Tilly* is set. You can see a blog post about the poem [here](#).

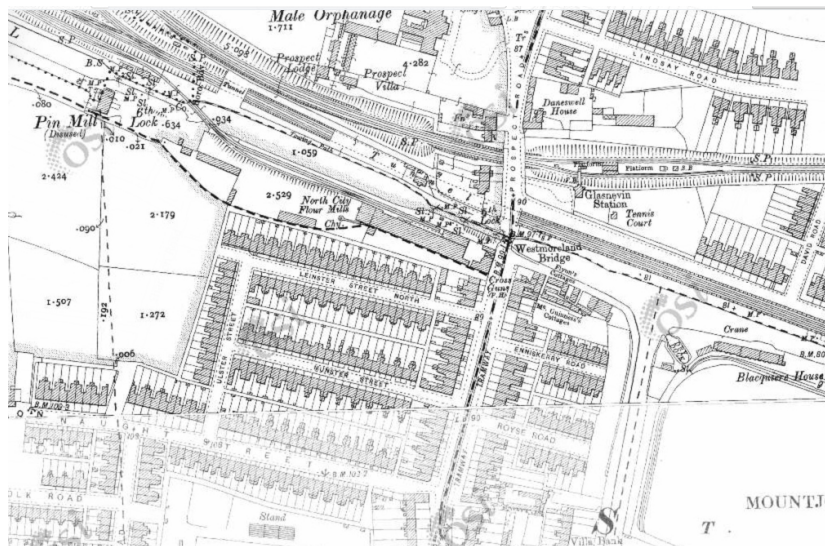

1888-2013 Map showing open fields north of St. Peter's Terrace

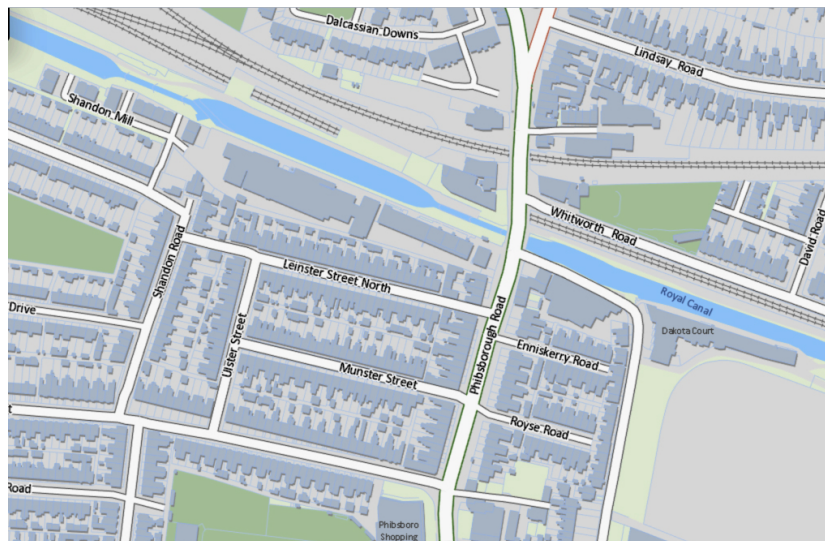

Present day may showing developed lands north of St. Peter's Road

The Royal Canal Towpath (East)

A short distance to the north of Shandon Park is the Royal Canal Towpath, accessed through a laneway and a small park.

The Royal Canal Towpath to Royal Canal Bank (East)

The route goes east along the Royal Canal partly because it is pleasant but also to avoid Smith's pub on Phibsborough Road. The surroundings are little changed from 1904.

It crosses Phibsborough Road at Cross Gunn's Bridge, crossing Paddy Dignam's funeral route, close to its end at Glasnevin Cemetery.

Royal Canal Bank to the North Circular Road (South)

There is a major change when Royal Canal Bank turns south. The canal has been filled in and is now a road. Bloom would have had to cross the canal at Blacquiere Bridge on the North Circular Road. So the route follows the line of the former canal before turning east on North Circular Road.

North Circular Road (East)

This is a busy road with commercial activity and it may be that there was a pub in this location in 1904. Thom's of 1904 lists a butcher a chemist and a draper amongst others, but as far as I can see, no public house (p.1606).

Much of the layout of roads is the same as in 1904 and the route passes the rear of the original Mater Hospital. Bloom could have easily come this way from his house on nearby Eccles Street.

Glengarriff Parade (North)

The route turns into Glengarriff Parade, passing close to another of Joyce's residences, 32 Glengarriff Parade. Just as 7 Saint Peter's Terrace became 5 Saint Peter's Road. 32 Glengarriff Parade is now 10 Glengarriff Parade. The route passes both houses.

Karl Whitney writes amusingly about this and all of Joyce's Dublin residences in his book *Hidden Dublin, Adventures and Explorations in Dublin*.

Inisfallen Parade (East)

Inisfallen Parade is a long straight road that runs down to Dorset Street. Thom's has little to say about it. *89 small houses* (p.1568).

Belvidere Road and Belvedere Place (South East)

Crossing Dorset Street you continue along Belvidere Road. The more common Dublin spelling is Belvedere. The Ordnance Survey have Belvidere Road leading to Belvidere Place on both the modern and historical mapping, whereas Google Maps have Belvidere Road leading to Belvedere Place, as do the street signs. Apple Maps have Belvedere Road leading to Belvedere Place. Thom's lists Belvidere-place and Belvidere-Road. Things get more confusing as gaelige, where Belvedere is spelt Belbidír, Belvidír and Belbhidir as you can see in the photographs below.

It's not just *Finnegans Wake* that plays with language.







Time to move on.

Joyce went to the nearby Belvedere College and does not mention Belvedere Road or Belvedere Place in his texts. But it is known that he did visit the house of David Sheehy M.P., whose wife approaches the very reverend John Conmee S. J. on Mountjoy Square in the *Wandering Rocks* episode of *Ulysses* (p.180). David Sheehy and a Miss Sheehy, elocutionist, are listed in Thom's as living in the house at 2 Belvidere-Place (p.1470).

Mountjoy Square East (South East)

The route passes the junction of Mountjoy Square East with Fitzgibbon Street, where Joyce lived in 14 Fitzgibbon Street, now number 34, and past the site of the postbox that Fr. Conmee gets Master Brunny Lynam to post the letter into in *Ulysses* (p.181). The postbox is no longer there. The postbox is listed as a *Pillar Letter-Box* in Thom's (p.1470), and it can be seen as a dot on the ordnance survey map of the time.

Vivien Igoe in *James Joyce's Dublin Houses & Nora Barnacle's Galway* (p.50,51) writes of the meeting between Fr. Conmee and John Joyce on the corner of the square, leading to Joyce studying in Belvedere College without having to pay fees.

The meeting is fictionalised in *A Portrait of an Artist as a Young Man* (p.62)

- *I walked bang into him, said Mr Dedalus for the fourth time, just at the corner of the square.*
- *Then I suppose, said Mrs Dedalus, he will be able to arrange it. I mean about Belvedere.*
- *Of course he will, said Mr Dedalus. Don't I tell you he's provincial of the order now?*
- *I never liked the idea of sending him to the christian brothers myself, said Mrs Dedalus.*
- *Christian brothers be damned! said Mr Dedalus. Is it with Paddy Stink and Mickey Mud? No, let him stick to the jesuits in God's name since he began with them. They'll be of service to him in after years. Those are the fellows that can get you a position.*
- *And they're a very rich order, aren't they, Simon?*
- *Rather. They live well, I tell you. You saw their table at Clongowes. Fed up, by God, like gamecocks.*

Mountjoy Square South and Greville Street (South West)

As the route moves into Greville Street it crosses over the route that Bloom and Stephen Daedalus traveled on their way northwards to 7 Eccles Street after their trip to the cabmans shelter in

the *Eumaeus* episode of *Ulysses*.

Thom's lists *D'Oli*, *Eugene Jermon*, *family grocer and wine merchant* (p.1558) as being located on the corner of Hill Street and Greville Street, but again, not necessarily a public house and not listed separately as such in Thom's.

Hill Street and Cumberland Street North (South East)

In Hill Street the run passes the tower of Little St. George's, the bells from which were moved from Hill Street to the new St. George's in Hardwick Place.

The bells are heard pealing repeatedly *Heigho, heigho*, in *Ulysses*. They are heard by Bloom in the morning and by Stephen Daedalus and Bloom on the doorstep of 7 Eccles Street (p.578) when they return after their adventures in Nighttown, where the bells form one of the characters in the *Circe* episode (p.384).



Little St. George's, Hill Street

We cross Parnell Street, which in 1904 was Great Britain Street North and go directly into North Cumberland Street.

There are no pubs on these corners today, nor as far as I can see in Thom's, in 1904.

Sean McDermott Street Upper (North East)

Sean Mac Dermott Street was originally Upper Gloucester Street, renamed like many streets after Irish patriots. The route heads north east again along the street, before crossing Gardiner Street and continuing to Gloucester Place Lower.

Gloucester Place Lower (South East)

The route is now in one of the areas of the city that has most changed the most since Joyce's time in Dublin. We are in the former Nighttown, prominently featured in the *Circe* episode of *Ulysses*. A haven of brothels and slums, largely obliterated, replaced by Corporation houses and offices.

Railway Street (South West)

Railway Street was originally Tyrone Street Lower, where Bella Cohen the brothel keeper lived at number 82. She lived at the eastern side of Tyrone Street Lower, towards Buckingham Street. We head in the opposite direction towards Mabbot Lane.

If we continued straight on we would be in James Joyce Street, formerly Mabbot Street.

Mabbot Lane and Moland Place (South East)

The centre of Dublin is a concentration of pubs, so to avoid many of them the route goes down Mabbot Lane going by a series of lanes towards the back of the Custom House. Thom's lists carriage builders and stores as the laneway's main uses in 1904 (p.1585).

Moland Place is not listed separately in Thom's, but the intersection with Talbot street is. there were no pubs here in 1904. It is at the southern end of Moland Place that the route comes closest to a pub. It runs down the side of one, but the gable end of the pub has no entrance or windows onto Moland Place.

Frenchman's Lane (South West)

This lane takes the route back to Gardiner Street, passing under the Loopline Railway Bridge for the first time. Thom's lists Frenchman's Lane as being free of Public Houses, though a wine bar has recently opened up, a few evenings a week.

Beresford Place (South)

The route goes south and to the western side of the Customs House, passing where Stephen and Bloom begin their walk back to 7 Eccles Street, passing Gumley minding stones for the Corporation in *Ulysses* (p. 112, 539).

Custom House Quay (East)

We pass under a different section of the Loopline Bridge passing the former site of the cabman's shelter from the *Eumaeus* episode of *Ulysses*.

In Joyce's time the Loopline Bridge was the most easterly bridge on the River Liffey with downstream crossings happening by Ferry. Bridge crossings with concentrated footfalls attract even more pubs and it is necessary to run east along the front of the Custom House and cross by the Matt Talbot bridge to avoid them.

Matt Talbot Bridge (South)

Up until this point the route layout has been on roads and paths that existed in 1904. But we now cross over a new bridge. This proves that this route could not have been used by Bloom in 1904.

We cross over Anna Livia Plurabelle.

City Quay and Sir John Rogerson's Quay (East)

The new development at City Quay has changed much of the street layout and the route has to go along the quays to avoid pubs placed in and around it.

**By lorries along sir John Rogerson's quay Mr Bloom walked soberly, past Windmill lane, Leask's the linseed crusher, the postal telegraph office. Could have given that address too. And past the sailors' home. He turned from the morning noises of the quayside and walked through Lime street. Ulysses (p.58)*

Lime Street (South)

As Bloom turns southwards from the quays into Lime Street, so do we.

Hanover Street East (East)

Bloom goes west at this point, but we go east, heading towards Ringsend Village.

Macken Street (South)

We turn south into Macken Street, formerly Great Clarence Street.

Pearse Street and Ringsend Road (East)

We turn eastwards along Pearse Street, formerly Great Brunswick Street, heading to Ringsend, in the opposite direction to Paddy Dignam's funeral procession in *Ulysses*.

Fitzwilliam Quay (South)

Thom's lists Ringsend (p.1833) as being in the County Dublin Directory, so having crossed over the bridge we have finally crossed Dublin.

The route turns south just before Tunney's pub, now the Oarsman, in Ringsend Village. Tunney's is mentioned several times in *Ulysses*, as a grocer's frequented by Gerty MacDowell (p.291) and a pub favoured by Paddy Dignam (p.207).

The route passes the field where the boys have *An Encounter in Dubliners* and past the plaque on the wall commemorating the Swan River, mentioned in *Finnegans Wake*. You can read more about this section in a previous blog post [here](#)

Newbridge Avenue and Lansdowne Road (West)

At this point the route is close to where Paddy Dignam's funeral departed for Glasnevin, from 8 Newbridge Avenue, which is a short distance to the east. We go in the opposite direction along Lansdowne Road.

We are now back in the city with Shelbourne Road and Lansdowne Road listed as such in Thom's.

The end: Shelbourne Road (North)

The last turn is north onto Shelbourne Road, finishing shortly thereafter, to the endpoint at number 60, identified, as is the house on St. Peter's Terrace, with a commemorative plaque.

Joyce rented a room from a Mrs. McKernan where he lived here from April to August 1904, departing to stay briefly at 35 Strand Road (Norburn p.20) on the night of 16th June 1904, the day on which *Ulysses* is set.

The Problem with the Solution

The solution only works in the present day. Whilst it generally follows a route available in 1904, it crosses a bridge that was not in existence and passes some locations where pubs were almost certainly present at that time.

The route does not pass any present day pubs, but it does pass a wine bar. The wine bar only opens three nights a week and is hardly a public house. Anyway it's my game, and to an extent, these are my rules.

The 1904 Solution

I have not solved the puzzle for the time in which it was set, 1904. It can possibly be solved for 1904, but not by using this route. The following establishments were located along the route and are listed in the 1905 Thom's Directory.

"Fogarty, P., grocer, tea, wine and spirit merchant" at number 35 Hill Street (p.1550).

"McEvoy, Michael, wine merchant and bonder of whiskey" at number 13, North Gloucester Street (p.1551).

"Smyth, Patrick, grocer and spirit merchant" at number 24 City Quay.(p.1499)

But are they public houses? Thom's lists the following categories of alcohol vendors separately:

Spirit Dealers

Taverns and Inns

Vintners and Publicans

Wine and Spirit Merchants

It is difficult to know the exact difference between all of the categories. But Davy Byrne's, perhaps the most famous Public House in *Ulysses* is listed as David Byrne, a wine and spirit merchant under the listing for Duke Street (p.1526) . He also appears in the wine and spirit dealers lists. So a wine and spirit dealer can be a public house.

P. Fogarty of Hill Street and Smyth of City Quay do not appear in any of the alcohol vendor categories. But Michael McEvoy of North Gloucester Street appears as a wine merchant and bonder of whiskey. His premises are located on a corner and it was probably a busy public house.

DUBLIN AND SUBURBS TRADES' DIRECTORY.

Vintners and Publicans.

(See also *Wine and Spirit Merchants, and Taverns.*)

Behan, John, 1 Crane lane, and 80 and 81 Dame street
 Bolger and Co. 45 Sackville street, lower
 Bolger, Mrs. Kate, 1 King street, south, and 141 Stephen's green, west
 Bowe, James, 15 William st. 31 Fleet street, and 42 Stephen street
 Brady, P. 48 Tyrone street, lower
 Burke, D. 2 King street, south
 Butler, James, 1 Mountpleasant, old
 Byrne, James, 21 Cork st. & 28 Ardeest.
 Clarke, T. & J. 1 Parkgate street
 Collins, James, 28 Fleet street, and Dundrum
 Corry, John J. 1 Fownes's street
 Cosgrave, P. 1 & 2 Chancery place and 36 Charles street
 Cunningham, Mrs. 16 Parkgate street
 Darcy, Myles, 1 Newport street
 Donohoe, Mrs. 20 Earl street, south
 Doyle, John, 66 & 160 Phibsborough rd.
 Doyle, P. J. 152 Church street, old
 Dooley, Owen, 10 and 11 Hill street
 Drongoolle, Jane, 80 Chancery street
 Dwyer, Thomas, 1 and 2 Townsend street
 Fagan Brothers, 212 Britain street, gt.
 Farrell, James. 112 Marlborough street
 Fitzpatrick, Thomas, 66 Britain street, great
 Flanagan, Michael, 1 Strand st. great
 Garvey, Thomas, 7 Stoneybatter
 Gethings, Thomas, 50 Britain st. great
 Gilligan, Thomas, 27 Hill street
 Hatch, Joseph, 27 Dolphin's barn lane
 Healy, James, 19 Constitution hill
 Hickey, Miss Kate, 1 Arran quay
 Higgins, Elizabeth, 1 Usher's quay, and 15 Bridge street, lower
 Kavanagh, Patrick, 21 Tyrone street, lower, and 11 North Strand road
 Kealy and Co. 9 Abbey street, lower
 Keegan, Wm. 26 George's street, lower, Kingstown
 Lee, Thomas, 11 Abbey street, lower
 Lenehan, Michael, 79 Prussia street, and 120 and 121 Church street
 Lysaght, J. T. 29 Chamber street
 McCarthy, John, 48 Meath street
 McNevin, G. 1 Dolphin's barn
 Manning, T. J. 41 Abbey street, upper, 18 Liffey street lr., and 67 George's street, upper, Kingstown
 Maxwell, John, 12 Stoneybatter
 Meagher, Philip, 4 Earl street, north
 McGowan, John, 39 William street
 Nolan, W. J. 8 Fownes street
 O'Hara, Peter, 103 Dorset street, upper
 O'Neill, A. 4 Ellis's quay
 O'Neill, Patrick, 1 Henry street
 O'Reilly, Philip, 58 Bolton street
 O'Reilly, Thomas, 21 George's quay
 Rowe, A. 2 George's street, great, south
 Ryan, J. and M. 34 Charlotte street
 Smith, Joseph, 20 George's quay
 Stapleton, Ellen, 1 Sarsfield quay
 Walsh, Joseph, 1 Commons street
 Whelan, W. 1 Crane street

Washing Machine Agents.

Edmundson and Co. 33 Capel street, and 1 Nassau street
 Hughes, Brothers, 23 Dawson street
 Kennan & Sons, 13 to 21 Fishamble st.
 Maguire and Gatchell (Ltd.) 7, 10 and 15 Dawson street

Waste Paper Dealers.

Cassidy, B. 10 Britain lane
 Irwin, Samuel, & Son, 121 Abbey st. up

Watch and Clock Makers

(See also *Jewellers.*)

Anderson, Michael, 30 Parliament street
 Armstrong, R. 25 Amiens street
 Brunner, Charles, 24 William street
 Bryant, W. & Co. 7 Ormond quay, up.
 Carr, Mrs. 80 Capel street
 Carty, William, 1 Duke street
 Chancellor and Son, 7 Grafton street and 55 Sackville street, lower
 Clare, William, 19 Nassau street
 Dobbyn and Son, 65 Dame street
 Donegan, Patrick, 32 Dame street
 Doull, Alexander, & Co. (wholesale) 11 Rosemount road, North Circular road
 Farley, H. 88A Britain street, great
 Fischer, Joseph, 11 Talbot street
 Footwengler, Adrian, 9 Augier street
 Forster, Charles, 72 Britain street, great
 Frengley Brothers, 5 Crow street
 Ganter, Adolph. 14 Essex quay and 63 George's street, great, south
 Gaskin & Co. 42 Fleet street
 Gerty, Henry and Son, 46 Dawson street
 Gordon, Ed. 16 Mary street
 Goyer, Thomas, 30 Wellington quay
 Hopkins and Hopkins, 1 Sackville street, lower
 Hug, Wm. 14 Anne street, south
 Jameson, John, and Sons, 87 Grafton street
 Jennings, M. 38 Henry street
 Johnson, Edmond (Ltd.) 94 Grafton st. and 46 Wicklow street
 Lodbetter, Albert E. 21 Essex quay
 Lennon, Patrick, 20 Wellington quay
 Lessware, Joseph, 4 Pitt street
 M'Dowell, Brothers, 27 Henry street and 10 George's street, great, south
 M'Dowell, John, 3 Sackville street, up.
 M'Guinness, Wm. 30 Wellington quay
 M'Kenna, Thomas, 14 Crow street
 Morton, John, 31 and 32 Nassau street
 Moulang, Joseph, 4 Aston's quay
 Racine & Co. 33 Nassau street
 Redmond, L. 60 George's street, south, and 96 Gardiner street, lower
 Reis, Charles S. and Co. 68 Grafton st. and 11 Sackville street, lower
 Rock, Alfred, 141 Capel street
 Ryan, J. R. and Co. 14 College green
 Sexton, Charles, 36 Lower Sackville st.
 Sexton, Walter, 118 Grafton street
 Sigwart, D. 38 Augier street
 Smith, George R. 26 Temple lane
 Tyrer, John, 5 Crampton court
 Walsh, R. 30 Parliament street
 Waterhouse and Co. 25 Dame street
 Waters, Wm. 2 George's street, upper
 Kingstown

Jones and Sons, Poyntz, S. R. a
 The India-rub
 Telegraph Co
 street
 Willeken Pap
 Commercial t

Weight

Coster, Johnsto
 works, 16 Or
 Edmundson's
 gineering Co
 street, and 1
 Maguire and G
 Dawson stree
 7 Dawson str
 Newman, Josep

Wh

Bestick, James
 south .

Whiskey

Price, Sons, &

Window

Burke, E. F. a
 works, South
 Millar and B
 street
 O'Hara, Franci

Window

42 Great Brun

Wine

(See also *Sp*)

Wine and

Allingham, J.
 Andrews & Co
 Ashford, Mrs.
 Bagots, Hutto
 street
 Barrett, Wm. C
 great
 Bebe, John, &
 39 Camden
 Regge, Thoma
 walk
 Begg, Joseph,
 Behan, Denis,
 Behan, J. 80 a
 Bergin, Danie
 17 North St
 Berney, Patri
 Bewley and D

Thom's 1904 Vintners and Publicans List

Some of these obstacles can be overcome by minor route changes. The puzzle will not be solved until you can prove that Dublin could be crossed without passing a pub in 1904, something that is the subject of my further research. My initial conclusions are that Bloom was probably right, you couldn't cross Dublin without passing a pub.

But as has been noted, why bother? A simple solution to cross Dublin without passing a pub is simply to go into all of them.

References cited

Igoe, V. (2006) *James Joyce's Dublin Houses and Nora Barnacle's Galway*. Dublin, Ireland: Lilliput Press.

Joyce, J. (1998) *Ulysses*. Edited by Hans Walter Gabler, Wolfhard Steppe, and Claus Melchior. Afterward by Michael Gordon edn. New York, United States: Vintage Books.

Joyce, J. (2007) *A Portrait of the Artist as a Young Man, Authoritative Text, Backgrounds and Contexts Criticism*. Edited by John Paul Riquelme, Hans Walter Gabler, and Walter Hettche. New York, United States: Norton, W. W. & Company.

Norburn, R. (2004) *A James Joyce Chronology*. London, United Kingdom: Palgrave Macmillan.

Thom's & Co. (Limited) (1902) *Thom's Official Directory of the United Kingdom of Great Britain and Ireland for the Year 1903*. Dublin, Ireland: Alex. Thom's & Co. (Limited)

Thom's & Co. (Limited) (1903) *Thom's Official Directory of the United Kingdom of Great Britain and Ireland for the Year 1904*. Dublin, Ireland: Alex. Thom's & Co. (Limited)

Thom's & Co. (Limited) (1904) *Thom's Official Directory of the United Kingdom of Great Britain and Ireland for the Year 1905*. Dublin, Ireland: Alex. Thom's & Co. (Limited)

Whitney, K. (2014) *Hidden City: Adventures and Explorations in Dublin*. Dublin, Ireland: Penguin Ireland.

<http://www.kindle-maps.com/blog/how-to-walk-across-dublin-without-passing-a-pub-full-publess-route-here.html>. Accessed May 16th, 2016

<http://maps.osi.ie/publicviewer/#V2,578432,756724,0,10>. Accessed May 16th, 2016

Bibliography

There is a longer bibliography of background material [here](#)

Research

You can see more on my research output on the Dublin Institute of Technology repository Arrow, [here](#)

[Click here to see the route details on Runkeeper](#)