

13th International Conference of Eastern Asia Society for Transportation Studies (EASTS)



EASTS 2019

SEPTEMBER 9 - 12 | COLOMBO | SRI LANKA

"Redesigning Transport & Logistics for the Rise of Asia"



9th - 12th September 2019 | Waters Edge, Battaramulla

Organized By



EASTS

Hosted By

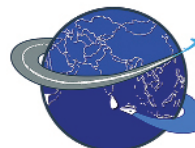

SLSTL

Sri Lanka Society of Transport and Logistics

**13th International Conference of the
Eastern Asia Society for Transportation Studies (EASTS)
EASTS 2019**

“Redesigning Transport & Logistics for the Rise of Asia”

Jointly organized by the
Sri Lanka Society of Transport and Logistics (SLSTL)

9th - 12th September 2019
Waters Edge, Battaramulla, Sri Lanka

Welcome message from Professor Amal S. Kumarage

It is with great pleasure I welcome all participants who are gathered for the 13th International Conference of EASTS. We are encouraged that over 500 participants from 29 countries have registered this year, in spite of the incidents of 21st April in Colombo, earlier this year.

The Sri Lanka Society of Transport and Logistics (SLSTL) is honoured to host this important event in the calendar of the Asian transport academia and research events. I trust that the efforts of our Conference Committee will bear fruit to ensure a successful conference and a pleasant and memorable time in Sri Lanka, during which we hope you will take time to visit the many places of interest in the country.

Prof. Amal S. Kumarage
President - Sri Lanka Society of Transport and Logistics (SLSTL)

Welcome message from Professor Tetsuo Yai, President of the Eastern Asia Society for Transportation Studies (EASTS)

Dear Participants,

It is my great pleasure to welcome you to the 13th International Conference of Eastern Asia Society for Transportation Studies held at Waters Edge in Colombo, Sri Lanka between 9th and 12th of September, 2019. Two years has passed since our last conference in Ho Chi Minh City. Thank you for returning to most valuable and informative opportunities of EASTS.

EASTS was founded in November 1994 with 13 countries/regions (domestic societies) in Eastern Asia. Now, we have 19 domestic societies including SLSTL (the Sri Lanka Society of Transport and Logistics). The primary objective of EASTS is to foster and support excellence in transportation research and practice.

Under the objectives, EASTS is organizing biennial International Conferences. Since the 1st Conference held in Manila, Philippines in 1995, 12 conferences have been held in EASTS area and provided great opportunities to enrich participants' professional knowledge.

Please enjoy a variety of discussions on the future of transport and a memorable pleasant stay with EASTS.

I'd like to take this opportunity to extend my deepest thanks and warmest congratulations to SLSTL for their magnificent efforts to hold our 13th conference in Colombo this year.

Dr. Tetsuo Yai,
President of EASTS
Vice President and Professor of Tokyo Institute of Technology

Welcome Message from ISC Chairperson

Dear Honorable Members of the EASTS and Participants,

On behalf of the International Scientific Committee for 2019 EASTS Conference, I would like to warmly welcome all of the participants to the 13th EASTS Conference to be held in Sri Lanka on September 9 to 12. Since the 1st Conference in Manila in 1995, the conferences of the EASTS have been getting stronger and stronger, as more participants are attending and more papers are presented. The EASTS is now firmly established as the unique academic society of transport research and practice in Asia.

The 13th EASTS Conference in Sri Lanka is well prepared and to be organized by the devoted efforts of the Sri Lanka Society of Transport & Logistics and believed to be another successful conference in the history of the EASTS. In the Conference, about 454 reviewed and non-reviewed papers are to be presented and EASTS Best Paper Awards will be given to a maximum 10 papers. Papers reviewed, selected and presented in the Conference are to be published in the form of ATS, Journal of EASTS and Selected Proceedings after the Conference.

I strongly trust that this upcoming conference will provide various ideas and insights for better transport service and development in Asia. I, as the Chairperson of ISC, would like to say that all the sessions programmed in this conference would be very beneficial and useful for your research information and innovative ideas for better transport infrastructure and system. I look forward to seeing all of you soon in Sri Lanka.

Dr. Jaehak Oh
Chairperson of International Scientific Committee
President of Korea Transport Institute

AGENDA - Opening Ceremony

- | | |
|-------------------------|--|
| 8.00 a.m. - 9.00 a.m. | Registration
Arrival of Chief Guest, Guest of Honour and Other Guests |
| 9.00 a.m. - 9.15 a.m. | Traditional Lighting of the Oil Lamp |
| 9.15 a.m. - 9.20 a.m. | National Anthem |
| 9.20 a.m. - 9.30 a.m. | Welcome Address (SLSTL)
Eng. (Dr.) T. Sivakumar
Vice President
Sri Lanka Society of Transport and Logistics (SLSTL) |
| 9.30 a.m. - 9.40 a.m. | Welcome Address (EASTS)
Prof. Tetsuo Yai
President
Eastern Asia Society for Transportation Studies (EASTS) |
| 9.40 a.m. - 9.50 a.m. | Address by National Advisory Committee (NAC) Chairman
Mr. Sunil Hettiarachchi
Secretary
Ministry of Highways & Road Development and
Petroleum Resources Development |
| 9.50 a.m. - 10.10 a.m. | Cultural Presentation |
| 10.10 a.m. - 10.30 a.m. | Address by Guest of Honour
Prof. Mohan Munasinghe
Founder Chairman
Munasinghe Inst. of Development (MIND) and MIND Group |
| 10.30 a.m. - 11.00 a.m. | Address by Chief Guest
Dr. Indrajit Coomaraswamy
Governor
Central Bank of Sri Lanka |
| 11.00 a.m. - 11.30 a.m. | Networking and Refreshments |
| 11.30 a.m. - 12.00 p.m. | Keynote Address - I <u>Plenary Session</u>
<i>"Pedestrian Planning in Hong Kong"</i>
Ir Prof. William H.K. Lam
Chair Professor
Department of Civil and Environmental Engineering
The Hong Kong Polytechnic University |
| 12.00 p.m. - 12.30 p.m. | Keynote Address - II
<i>"Managing Motorization in Middle Income Countries"</i>
Prof. Amal S. Kumarage
Department of Transport & Logistics Management
University of Moratuwa
President, Sri Lanka Society of Transport and Logistics (SLSTL)
Vice President, Eastern Asia Society for Transportation Studies (EASTS) |
| 12.30 p.m. - 2.00 p.m. | Lunch |

SPEAKER Profile

Guest of Honour

Prof. Mohan Munasinghe

Founder Chairman
Munasinghe Inst. of Development (MIND) and
MIND Group



Prof. Mohan Munasinghe is Founder Chairman of the Munasinghe Inst. of Development (MIND) and MIND Group, Colombo. He is Vice Chair of the UN Intergovernmental Panel on Climate Change (IPCC-AR4), who shared the 2007 Nobel Prize for Peace. He also received the title of Officer of the National Order of the Legion of Honour in 2017 - the highest French decoration bestowed on him by the President of France; the Deshamanya award in 2019 – the highest Sri Lankan decoration bestowed on him by the President of Sri Lanka for distinguished service of a highly meritorious nature to the nation; and many other world awards. He is Chairman, Presidential Expert Commission on Sustainable Sri Lanka 2030 Vision; and Honorary Senior Advisor to the Government of Sri Lanka

Formerly, he served as Senior Energy Advisor to the President of Sri Lanka; Advisor to United States President's Council on Environmental Quality; and Senior Advisor/Manager, World Bank. He was also Director-General of Sustainable Consumption Institute, Manchester University, UK; Chancellor of International Water Academy, Oslo; and Board Member of Green Cross International, Geneva. He has served as expert advisor/consultant to many world bodies.

He has earned post-graduate degrees in engineering, physics and development economics from Cambridge University (UK), MIT (USA), and McGill and Concordia Universities (Canada), as well as several honorary doctorates (*honoris causa*).

After working over 45 years in the international arena, he is recognized as a leading expert on sustainable development, climate change, energy and environment. He is especially known for having developed at the 1992 UN Rio Earth Summit, the Sustainable framework that applies trans-disciplinary thinking to make development more sustainable, for describing the balanced inclusive green growth (BIGG) path to sustainability followed by many countries, and for proposing the novel idea of Millennium Consumption Goals which has been incorporated into the UN sustainable development goals. He has had direct field experience in climate change, disaster management, economics, environment, energy, telecommunications, transport, urban infrastructure, and water resources projects, worldwide. He has won many international research prizes and authored over 110 books and 350 technical papers. He is Fellow of several international Academies of Science, and editorial board member of over a dozen journals.

He is a keen sportsman and honorary Vice Patron of the Sri Lanka Tennis Association. He has represented Sri Lanka (Juniors) and Cambridge University in tennis and won a number of Sri Lanka National and other titles. His interests include swimming, wind surfing, chess, bridge, amateur astronomy, saxophone playing, judo, tai-chi, and meditation.

SPEAKER Profile

Chief Guest

Dr. Indrajit Coomaraswamy

Governor
Central Bank of Sri Lanka



Dr. Indrajit Coomaraswamy has been the Governor of Central Bank of Sri Lanka since July 4, 2016. Dr. Coomaraswamy has 30 years of experience in policy making and providing economic advisory services, on both macro-economic and structural issues at National and Intergovernmental levels. He served as Director of Economic Affairs at the Commonwealth Secretariat. He was an official in the Central Bank of Sri Lanka from 1974 to 1989. Dr Coomaraswamy worked in the Economic Research, Statistics and in Bank Supervision Departments of the Central Bank of Sri Lanka. Dr Coomaraswamy served Ministry of Finance and Planning from 1981 to 1989 on secondment.

He was reemployed by the Commonwealth Secretariat from 1990-2008. During that time, he held senior positions, such as Director, Economic Affairs Division and Deputy-Director, Secretary-General's Office. He served subsequently as the Interim Director, Social Transformation Programme Division, Commonwealth Secretariat in 2010. Dr Coomaraswamy was involved in advising the Hon Prime Minister and the Hon Minister of Economic Reform, Science and Technology, Sri Lanka on negotiating with Bretton Woods Institutions and other major donors and on matters relating to macroeconomics and structural reforms.

Dr Coomaraswamy served as a Director of Sarvodaya Development Finance Limited. He also served as a Non-Executive Independent Director at Tokyo Cement Company (Lanka) PLC from March 2011 to July 3, 2016. He served as an Independent Non-Executive Director of John Keells Holdings PLC from February 2011 to July 2016 and as a Director of Pathfinder. Dr. Coomaraswamy obtained his B.A. (Hon) and Masters in Economics from the Cambridge University of UK in 1972 and subsequently obtained a Doctorate from the University of Sussex in 1981. He has represented and led Sri Lanka National Rugby team. He led Sri Lanka National Rugby team 1974 in Rugby Asiad. Dr Coomaraswamy also played first class Cricket in Sri Lanka.

Dr Coomaraswamy received the "Central Bank Governor of the Year" award in South Asia for the year 2017. Dr Indrajit Coomaraswamy, Governor of the Central Bank was conferred the title of "Deshamanya" by His Excellency the President on 19th August, 2019.

SPEAKER Profile

Ir Prof William H.K. Lam

Chair Professor

Department of Civil and Environmental Engineering

The Hong Kong Polytechnic University

E-mail: william.lam@polyu.edu.hk

Website: www.cee.polyu.edu.hk/~cehklam



Ir Prof. William H.K. Lam is a Chair Professor of Civil & Transportation Engineering and has been the Head of the Civil & Environmental Engineering Department, The Hong Kong Polytechnic University from 2013 to 2019. He is also an Honorary Professor at the Institute for Transport and Logistics Studies, The University of Sydney, Australia since 2015. Ir Prof. Lam has over 35-year professional experience in research and practice for planning and design of transport infrastructures. He is the founding Editor-in-Chief of the SCI Journal – *Transportmetrica* and is now one of the Co-Editors-in-Chief of *Transportmetrica A: Transport Science* (<https://www.tandfonline.com/toc/ttra21/current>). He is also the Convenor of the International Adviso-

ry Committee of the International Symposium on Transportation and Traffic Theory (<https://isttt23.sciencesconf.org/>). He has been the President of the Hong Kong Society for Transportation Studies (www.hksts.org) from 1996 to 2019. Ir Prof. Lam is the author of more than 300 Web of Science journal and conference proceedings papers together with 70 consultancy reports. His research interests include transport network modeling and infrastructure planning, travel demand forecasts and risk assessment, ITS technology and planning, public transport and pedestrian studies.

SPEAKER Profile

Prof. Amal S. Kumarage

Department of Transport & Logistics Management
University of Moratuwa
President, Sri Lanka Society of Transport and Logistics (SLSTL)
Vice President, Eastern Asia Society for Transportation Studies (EASTS)



Amal Kumarage is a Senior Professor at the Department of Transport & Logistics Management at the University of Moratuwa. He holds a Civil Engineering degree from the University of Moratuwa and a PhD in Transport Planning & Engineering from the University of Calgary. He is also a Chartered Engineer; Fellow and former Chairman of the Chartered Institute of Logistics & Transport where he also held the post of an International Vice President.

He has published extensively in transport planning, public transport, traffic engineering, road safety, transport project appraisal, and urban transport. He has served as advisor to several ministries in the Government

of Sri Lanka as well as the Maldives. He has served as a World Bank and ADB consultant both in Sri Lanka and many other Asian countries. As an Administrator he has served four times as the Chairman of the National Transport Commission and on several other statutory boards over a period of 20 years. He has been instrumental in implementing several projects and programs in the transport sector. He is currently engaged in promoting public transport, sustainable urban development and safe travel.

Abstract of Keynote Address “Pedestrian Planning in Hong Kong”

Various pedestrian models and advanced techniques have been developed in Hong Kong for design of pedestrian facilities and level of service analysis with taking account of the local pedestrian flow characteristics and the bi-directional flow effects. This presentation will give an overview of development of various applications and practice for pedestrian planning in Hong Kong together with future potential applications. It will cover various studies on pedestrian flow characteristics, bi-directional flow effects, level of service for different pedestrian facilities and simulation models for design of pedestrian facilities. Demonstration projects for promotion of non-motorized mode in Hong Kong will also be discussed.

Ir Prof William H.K. Lam

Chair Professor

Department of Civil and Environmental Engineering

The Hong Kong Polytechnic University

E-mail: william.lam@polyu.edu.hk

Website: www.cee.polyu.edu.hk/~cehklam

Abstract of Keynote Address “Managing Motorization in Middle Income Countries”

The motor vehicle has been the one of the most influential inventions that changed the world in the 20th century. The Information Technology revolution that started towards the end of that century appears to be the primary driver of change in the 21st Century, as did the Industrial Revolution in the 19th century etc. Currently there are an estimated 1.4 billion vehicles globally averaging just under one per household. Motor Vehicle ownership is often used as an indicator of economic prosperity and prestige and therefore driven by powerful political, social intentions and business interests promoting a large global automotive industry.

Many studies have been carried out in an attempt to understand the rapid growth of motor vehicles. Most of these have concluded that it is closely related to economic growth of a city or country. Analysis of trends of vehicle growth across different countries over the last four to five decades has shown that the Vehicle Ownership Rate (VOR) can be forecasted using a Gompertz function with GDP per capita as the independent variable. In early applications of this theory, it was deemed that all developing countries would follow this curve reaching a Saturation Level of over 800 vehicles per 1000 persons. However, more recent work has determined that countries have their own trends and are likely to reach different saturation levels. However, traffic congestion, road fatalities and issues of urban land use have imposed serious restrictions to such unbridled income driven growth in motor vehicle ownership.

This research examines the theory that countries and cities should determine their own sustainable levels of motorization based primarily on population density in their efforts to pursue sustainable development efforts. The case of motorization of around 40 countries that have been classified as High Income countries by the World Bank have been used to identify the levels of motorization that enabled them to reach such development status. It has been determined that in general while low population density countries use a high level of private vehicles, high population density countries have used the opposite policy to reach high income status. Thus both strategies of managing mobility and motorization are successful in their respective contexts. There are also many countries in between these extremes that can be classified by the trends they demonstrate. A generalization of such in to four trends for analytical purposes leads to the conclusion that transport policy, regulatory measures, fiscal measures, can make significant impacts in a country in the long term to prevent reaching unsustainable levels of motorization that could seriously impeded economic growth and even lead to contributing towards a middle income trap where life style led demand for motorization will not enable the provision of the rapid requirement for increase in road infrastructure.

With the baby boomers who were enamored by private vehicles now driving less and with the youth able to build urban lifestyles without owning a private vehicle, the advent of IT and smart technology into improved mobility, the ability of developing countries to intervene in managing vehicle growth within sustainable levels has become even more realistic. This research while setting out the parameters for determining such levels of sustainability also venture to identify the different instruments including improving public and para transit that have been or can be used to achieve such levels.

Prof. Amal S. Kumarage

Department of Transport & Logistics Management (University of Moratuwa)

President, Sri Lanka Society of Transport and Logistics (SLSTL)

Vice President, Eastern Asia Society for Transportation Studies (EASTS)

Conference Main Programme

Day and Time	Venue	Grand Ballroom 2/3		Grand Ballroom 1/3		Albatross	Eagle	Olu	Nelum	Manel	View	Falsetto	Link	Lobby	Orchid Garden
		B2/F3	B2/F3	B2/F1	B2/F2										
EASTS 2019 - Day 1 (9th Sep)															
	Building	B1 (Front Reception)													
	Floor	B2/F3	B2/F3	B2/F1	B2/F2	B1/FG	B1/FG	B1/FG	B1/FG	B1/FG	B1/F1	B1/F2			
	Capacity	950 (banquet)		150	300	70	200	70	300	70	300	40			
07:30 - 09:00	Registrations														
09:00 - 11:00	Opening Ceremony														
11:00 - 13:00	Preliminary Sessions														
13:00 - 14:00	Lunch														
14:00 - 15:30	Technical Sessions - 1			10.11	20.11	30.11	40.11	70.11	100.11						
15:30 - 16:00	Tea/Coffee Break														
16:00 - 17:30	Technical Sessions - 2			50.11	90.11	100.21	110.41	120.11	80.23						
18:00 - onwards	Gala Dinner														
EASTS 2019 - Day 2 (10th Sep)															
09:00 - 10:30	Technical Sessions - 3		10.51	30.12	60.11	70.31	90.21	100.12			R4TLI				
10:30 - 11:00	Tea/Coffee Break														
11:00 - 13:00	Technical Sessions - 4		10.12	20.51	40.31	70.51	100.22	110.42			R4TLI				
13:00 - 14:00	Lunch														
14:00 - 15:30	Technical Sessions - 5			10.13	30.31	70.41	80.22	90.31			R4TLI				
15:30 - 16:00	Tea/Coffee Break														
16:00 - 17:30	Technical Sessions - 6			20.31	50.21	100.41	120.21	130.11			R4TLI				
EASTS 2019 - Day 3 (11th Sep)															
09:00 - 10:30	Technical Sessions - 7		10.14	20.71	30.13	40.12	50.41	100.13	200.32						
10:30 - 11:00	Tea/Coffee Break														
11:00 - 13:00	Technical Sessions - 8		10.71	70.71	80.21	90.81	110.31	130.21	70.52						
13:00 - 14:00	Lunch														
14:00 - 15:30	Technical Sessions - 9			10.42	30.32	70.32	100.23	60.21	120.12						
15:30 - 16:00	Tea/Coffee Break														
16:00 - 17:30	Closing Session														
6:00 p.m. onwards	Farewell Party														

Slot	Session Name	Venue	Day	Time	Note	Remark
-5	Poster Session (5)	LINK	9/11/2019	14:00 - 16:00		
-4	Poster Session (4)	LINK	9/11/2019	09:00 - 12:00		
-3	Poster Session (3)	LINK	9/10/2019	14:00 - 17:00		
-2	Poster Session (2)	LINK	9/10/2019	09:00 - 12:00		
-1	Poster Session (1)	LINK	9/9/2019	14:00 - 17:00		
10.11	Asia-Specific Issues (1)	Albatross	9/9/2019	14:00 - 15:30		
10.12	Asia-Specific Issues (2)	Grand Ballroom 1/3	9/10/2019	11:00 - 13:00		
10.13	Asia-Specific Issues (3)	Albatross	9/10/2019	14:00 - 15:30		
10.14	Asia-Specific Issues (4)	Grand Ballroom 1/3	9/11/2019	09:00 - 10:30		
10.41	Survey and Data Collection (1)	Grand Ballroom 1/3	9/10/2019	16:00 - 17:30		
10.42	Survey and Data Collection (2)	Albatross	9/11/2019	14:00 - 15:30		
10.51	Transportation and Natural Disasters (1)	Grand Ballroom 1/3	9/10/2019	09:00 - 10:30		
10.71	Others (1)	Grand Ballroom 1/3	9/11/2019	11:00 - 13:00		
20.11	Pricing (1)	Eagle	9/9/2019	14:00 - 15:30		
20.31	Project Evaluation (1)	Albatross	9/10/2019	16:00 - 17:30		
20.51	TDM Policy and Mobility Management (1)	Albatross	9/10/2019	11:00 - 13:00		
20.71	Sustainable Transportation Policy (1)	Albatross	9/11/2019	09:00 - 10:30		
30.11	Travel Behavior Analysis (1)	Olu	9/9/2019	14:00 - 15:30		
30.12	Travel Behavior Analysis (2)	Albatross	9/10/2019	09:00 - 10:30		
30.13	Travel Behavior Analysis (3)	Eagle	9/11/2019	09:00 - 10:30		
30.31	Network Analysis and Traffic Assignment (1)	Eagle	9/10/2019	14:00 - 15:30		
30.32	Network Analysis and Traffic Assignment (2)	Eagle	9/11/2019	14:00 - 15:30		
40.11	Logistics and Freight Transportation Policy (1)	Nelum	9/9/2019	14:00 - 15:30		
40.12	Logistics and Freight Transportation Policy (2)	Olu	9/11/2019	09:00 - 10:30		
40.31	City Logistics (1)	Eagle	9/10/2019	11:00 - 13:00		
50.11	Urban and Regional Planning (1)	Albatross	9/9/2019	16:00 - 17:30		
50.21	Land Use and Spatial Analysis (1)	Eagle	9/10/2019	16:00 - 17:30		
50.41	Tourism and Leisure Activities (1)	Nelum	9/11/2019	09:00 - 10:30		
60.11	Transportation and Environment (1)	Eagle	9/10/2019	09:00 - 10:30		
60.21	Climate Change and Transportation (1)	Manel	9/11/2019	14:00 - 15:30		
70.11	Intercity Railway (1)	Manel	9/9/2019	14:00 - 15:30		
70.31	Bus and BRT (Bus Rapid Transit) (1)	Olu	9/10/2019	09:00 - 10:30		
70.32	Bus and BRT (Bus Rapid Transit) (2)	Olu	9/11/2019	14:00 - 15:30		
70.41	Minibus and Paratransit (1)	Olu	9/10/2019	14:00 - 15:30		
70.51	Pedestrian and Bicycle (1)	Olu	9/10/2019	11:00 - 13:00		
70.52	Pedestrian and Bicycle (2)	View	9/11/2019	11:00 - 13:00		
70.71	Transit and Urban/Regional Development (1)	Albatross	9/11/2019	11:00 - 13:00		
80.21	Pavements (1)	Eagle	9/11/2019	11:00 - 13:00		
80.22	Pavements (2)	Nelum	9/10/2019	14:00 - 15:30		
80.23	Pavements (3)	View	9/9/2019	16:00 - 17:30		
90.11	Modeling of Vehicle Maneuvers and Drivers (1)	Eagle	9/9/2019	16:00 - 17:30		
90.21	Traffic Flow Analysis (1)	Nelum	9/10/2019	09:00 - 10:30		
90.31	Highway Capacity and Quality of Service (1)	Manel	9/10/2019	14:00 - 15:30		
90.81	ITS (1)	Olu	9/11/2019	11:00 - 13:00		
100.11	Accident Analysis (1)	View	9/9/2019	14:00 - 15:30		
100.12	Accident Analysis (2)	Manel	9/10/2019	09:00 - 10:30		
100.13	Accident Analysis (3)	Manel	9/11/2019	09:00 - 10:30		
100.21	Driving Behavior and Safety (1)	Olu	9/9/2019	16:00 - 17:30		
100.22	Driving Behavior and Safety (2)	Nelum	9/10/2019	11:00 - 13:00		
100.23	Driving Behavior and Safety (3)	Nelum	9/11/2019	14:00 - 15:30		
100.41	Evaluation on Safety Measures (1)	Olu	9/10/2019	16:00 - 17:30		
110.31	Airport Planning, Engineering, and Management (1)	Nelum	9/11/2019	11:00 - 13:00		
110.41	Operation and Management of Air/Water Transportation (1)	Nelum	9/9/2019	16:00 - 17:30		
110.42	Operation and Management of Air/Water Transportation (2)	Manel	9/10/2019	11:00 - 13:00		
120.11	Emerging Technology (C-ITS/Autonomous/IoT) (1)	Manel	9/9/2019	16:00 - 17:30		
120.12	Emerging Technology (C-ITS/Autonomous/IoT) (2)	View	9/11/2019	14:00 - 15:30		
120.21	New Transport Industry (Car-Sharing/Carpool/Bike-Sharing/Uber/Personal Mobility) (1)	Nelum	9/10/2019	16:00 - 17:30		
130.11	Engineering, Technology, and Design (1)	Manel	9/10/2019	16:00 - 17:30		
130.21	Policy, Planning and Management (1)	Manel	9/11/2019	11:00 - 13:00		
200.259	Institutions for Railway Development in Asian Cities (IRDAC) (IRG) Special Speakers	Grand Ballroom 2/3	9/10/2019	09:00 - 10:30	IRG-26-2014	Special Session (ISC-SP-1)
200.26	Institutions for Railway Development in Asian Cities (IRDAC) (IRG)	Grand Ballroom 2/3	9/10/2019	11:00 - 13:00	IRG-26-2014	Special Session (ISC-SP-1)
200.281	Motorcycle, Motor Scooter, Motorbike Ownership and Use in South East Asia Cities (IRG) (1)	Falsetto	9/11/2019	09:00 - 10:30	IRG-28-2015	
200.282	Motorcycle, Motor Scooter, Motorbike Ownership and Use in South East Asia Cities (IRG) (2)	Falsetto	9/11/2019	11:00 - 13:00	IRG-28-2015	
200.29	Gender and Transport Nexus: Achieving A More Equitable and Inclusive Society (IRG)	Falsetto	9/10/2019	16:00 - 17:30	IRG-29-2016	
200.3	Entry Point of Mobility Management Measures in Asia (IRG)	Falsetto	9/9/2019	16:00 - 17:30	IRG-30-2017	
200.31	Better Mobility in New Town: Preparing for Self-Contained Neighborhood in Asia (IRG)	Falsetto	9/11/2019	14:00 - 15:30	IRG-31-2017	
200.32	Logistics Network and Variety in Asian Context: Globalization and Localization (IRG)	View	9/11/2019	09:00 - 10:30	IRG-32-2017	
212	Special Session (ISC-SP-2) : Transport Connectivity in Asia	Grand Ballroom 2/3	9/10/2019	16:00 - 17:30		Special Session (ISC-SP-2)
213	Special Session (SEC-SP-1) : TBD	Grand Ballroom 2/3	9/11/2019	09:00 - 10:30		
214	Special Session (SEC-SP-2) : TBD	Grand Ballroom 2/3	9/11/2019	11:00 - 13:00		

EASTS 2019

Sessions (Technical-Oral, ISC special session)

Session Name	10.11 Asia-Specific Issues (1)	2019-09-09 14:00-15:30	Venue : Albatross	Chair: Dr. Dinh Van Hiep
Manuscript No. Article Title				Presenter
PP2190	Carpooling: A Step to Reduce Traffic Congestion in Sri Lanka			Amila Kanchana Sandaruwan
PP2192	Cross-Cultural Differences in Aberrant Driving Behaviors: Comparison of Japanese, Chinese, and Vietnamese Drivers			Blawal Hussain
PP2199	How Does Improving Rural Roads Motivate People to Own Travel Modes? Findings from Rural Cambodia			Rika Idei
PP2204	Implementation of Motorcycle-related Policies in Vietnam: More Failures and Less Successes			Dinh Van Hiep
PP2711	Road Transport and Poverty Alleviation			Sharad K. SHRESTHA
Session Name	20.11 Pricing (1)	2019-09-09 14:00-15:30	Venue : Eagle	Chair: Dr. Ludfi Djakfar
Manuscript No. Article Title				Presenter
PP2229	A Study of IC Card Systems within Japanese Urban Railway Lines: Considering the Integration of Transportation Services			SHOSAKU HIGASHINO
PP2234	Development of Toll Road Pricing Strategy			Ludfi Djakfar
PP2258	Willingness to Pay Analysis on TransJava Corridor Toll Road			Andyka Kusuma
PP2720	Estimation for high-speed railway fare considering marginal cost and demand			Jonghoon LEE
Session Name	30.11 Travel Behavior Analysis (1)	2019-09-09 14:00-15:30	Venue : Olu	Chair: Dr. Shalini Rankavat
Manuscript No. Article Title				Presenter
PP2270	Development of an Activity-Based Model System for Tokyo Metropolitan Urban Rail Planning			Daisuke Fukuda
PP2286	Consciousness Analysis on Travel Behavior and Intention of People in Mainland China			Kota Tanaka
PP2299	Understanding Activity Pattern by Household Composition in Tokyo Metropolitan Area for Long Term Urban Railway Planning			Naoki Okunobo
PP2588	PEDESTRIANS CROSSING BEHAVIOR IN DELHI, INDIA			shalini rankavat
PP2595	A Comparative Assessment between the Simultaneous and Sequential Maximum Likelihood Estimation Approaches for the Frank Copula-Based Joint Model of Vehicle Type Ownership and Usage in Metro Manila			Monorom Rith
Session Name	40.11 Logistics and Freight Transportation Policy (1)	2019-09-09 14:00-15:30	Venue : Nelum	Chair: Dr. Cheng-Chieh Chen
Manuscript No. Article Title				Presenter
PP2307	A Robust Optimization Model for Proactive Resilience Strategies in Express Logistics			Cheng-Chieh Chen
PP2313	Characterization of Truck Traffic in Metro Manila			Riches Bacero
PP2316	Integrating Sustainability in Supply Chain Network Design			Rajali Maharajan
PP2317	Modeling Modal Choice Behavior and Inter-regional Freight Transport Value-of-Time (VOT) Considering the Flexible Choice Set Structure of Inter-regional Freight Transport in Japan			Al Hanz Seiji Basa Lidasan
PP2321	Sustainability of Hokkaido Logistics Network by the Strategic Choice Approach			Subaru Shimizu
Session Name	70.11 Intercity Railway (1)	2019-09-09 14:00 - 15:30	Venue : Manel	Chair: Dr. Ryusuke Takeuchi
Manuscript No. Article Title				Presenter
PP2259	A Population Analysis for Regional Railway Commercial Sustainability			Ryusuke TAKEUCHI
PP2613	International Comparison of Capacity Design for Urban Railway Station's Passenger Facilities - Diversity in Value Judgment in Standards and Practices: Past and Future -			Kosuke Yamamoto
PP2672	Study for Integrating Urban Rail and Urban/Regional Development			Takehiro Kawahashi
PP2705	Role of Microscale Built Environment Factors on Perceived Walk Accessibility to Metro Stations: A Case of Delhi Metro			G R Bivina
Session Name	100.11 Accident Analysis (1)	2019-09-09 14:00 - 15:30	Venue : View	Chair: Dr. Kyuok Kim
Manuscript No. Article Title				Presenter
PP2429	Risk Analysis of Rural Four Lane Divided Highway Based on Risk Index Determination By Road Safety Audit			Ayush Sharad Dhankute
PP2486	Analysis of the Safety Performance of Drainage Pavement focusing on Pavement Age			Celso Luis Fernando
PP2496	Development of Crash Prediction Model for Signalized Intersections in India Using Bayesian Inference			Madhumita Paul
PP2513	Mining Characteristics of Speeding and Red Light Running Violations Using Association Rules			Yuan Wei Wu
Session Name	50.11 Urban and Regional Planning (1)	2019-09-09 16:00 - 17:30	Venue : Albatross	Chair: Dr. Jose Regin F. REGIDOR
Manuscript No. Article Title				Presenter
PP2330	Analysis of Regional Environments Where People Certified as Requiring Nursing Care Live in Super Aging Society			Yuma Morisaki
PP2331	Analytical and Qualitative Analysis with a Pedestrian Utilization Model of Footbridges in Cagayan de Oro City, Philippines			Jefferson Jr. Ramos Vallente
PP2332	Application of Complete Streets Concept on the Central Business District of Tacloban City Focused on Urban Bikeway Design			Jose Regin F. REGIDOR
PP2342	Possibility of Regional Revitalization through Collaboration between Roadside Stations and Neighborhood Stores			Takao Takahashi
PP2688	Transportation Planning Support Systems for Small Towns in the Developing World: A Turnkey Model Approach			Vipul Modi
PP2708	OPTIMAL LOCATION OF ADMINISTRATIVE CENTER: A CASE STUDY OF PROVINCE NO. 1, NEPAL			Sailesh Acharya
Session Name	80.23 Pavements (3)	2019-09-09 16:00 - 17:30	Venue : View	Chair: Dr. Niranga Amarasingha
Manuscript No. Article Title				Presenter
PP2418	A Study on Engineering Properties of Carbide Lime Modified Asphalt Concrete Mixes			Jayvant Choudhary
PP2419	Analyze the cause of highway landslide constructed over the sandy area affected by underground water and treatment design solution			Tien Phung Manh
PP2421	Durability Performance of Asphalt Concrete Wearing Course Using Marble Waste as Filler			Rani Bastari Alkam
PP2424	In Service Performance of Permeable Friction Course Incorporating Basic Oxygen Furnace Slag as Coarse Aggregate			Jian-Shiuh Chen
PP2430	Smartphone Applications for Pavement Roughness Computation of Sri Lankan Roadways			D.Y. GALAGODA
Session Name	90.11 Modeling of Vehicle Maneuvers and Drivers (1)	2019-09-09 16:00 - 17:30	Venue : Eagle	Chair: Dr. Ankit Gupta
Manuscript No. Article Title				Presenter
PP2196	Estimating Critical Gap at Roundabout under Mixed Traffic Conditions in Sri Lanka			Amila Kanchana Sandaruwan
PP2442	Driver Behavior Analysis under Heterogeneous Traffic Conditions			Vibhanshu Singh
PP2690	Effectiveness of analysis using precipitation intensity by radar on expressway			Mitsuhiro Hattori
PP2707	Investigating Minimum Passing Slight Distance of Two-lane Two-way Roads in Sri Lanka			Badnur M. SHIHAM
Session Name	100.21 Driving Behavior and Safety (1)	2019-09-09 16:00 - 17:30	Venue : Olu	Chair: Dr. Kumar Molugaram
Manuscript No. Article Title				Presenter
PP2451	Exploratory Study in Calibrating the Politeness Factor of MOBIL			Jebus Edrei Taguiam
PP2464	Red Box Motorcycle Evaluation at Signalized Intersection in Denpasar Bali			Agah Muhammad Mulyadi
PP2476	Two-Wheeler Rider Behavioral Modeling of Literate Youth on Urban Roads			Kumar Molugaram
PP2493	Countermeasures for Enhancing Road Traffic Safety for Motorcycle Users in Vietnam: Findings from The Focus Groups and In-Depth Interviews Studies			Man Dinh Vinh Nguyen
PP2498	Effect of Driver Behaviour Parameters on Vehicular Conflict at Unsignalized Intersections using micro-simulation			Digvijay S. Pawar
Session Name	110.41 Operation and Management of Air/Water Transportation (1)	2019-09-09 16:00 - 17:30	Venue : Nelum	Chair: Dr. Daniel L. MABAZZA
Manuscript No. Article Title				Presenter
PP2531	Connectivity Developments in Air Transport Networks at Primary Asian Airports			Hidenobu Matsumoto
PP2536	How to Establish West Japan-ASEAN RORO Ship Route?: Based on Network Analysis			Jun KIMATA
PP2542	The Low-Cost Carrier (LCC) in Southeast Asia: Towards new distance and aircraft patterns			Daniel Ligeralde Mabazza
Session Name	120.11 Emerging Technology (C-ITS/Autonomous/IoT) (1)	2019-09-09 16:00 - 17:30	Venue : Manel	Chair: Dr. Ryusuke Abe

Manuscript No. Article Title		Presenter
PP2462	Predictive intelligence: A neural network learning system for traffic condition prediction and monitoring on freeways	Rusul Abduljabbar
PP2544	Attitude and Usage Intention of Highschool Students Toward Electric Two-Wheeled Vehicles in Hanoi City	Thuy Thu Trinh
PP2680	UNDERSTANDING TRAVEL TO WORK ATTRIBUTES USING MOBILE NETWORK BIG DATA	N.K.Bhagya Jeevanthi
PP2709	A Survey on AI use in Japanese Transportation Sector: Current Practice and Policy Challenges	Ryosuke Abe
Session Name	200.3 Entry Point of Mobility Management Measures in Asia (IRG-30-2017)	2019-09-09 16:00 - 17:30 Venue : Falsetto
Manuscript No. Article Title		Presenter
PP2236	Empirical Analysis of the Effects of Implementing Mobility Management at Inadequately Mass Transit Developed Area -A Case of Bandung, Indonesia	Taiyo Ishikawa
PP2239	Feasibility Analysis of Mobility Management in Hanoi and Ho Chi Minh City, Vietnam	Kota Kimura
Session Name	10.51 Transportation and Natural Disasters (1)	2019-09-10 09:00 - 10:30 Venue : Grand Ballroom 1/3
Manuscript No. Article Title		Chair: Dr. Kazuyuki TAKADA
PP2195	Earthquake Evacuation Choice Model Based on the Stated Preference Approach for Residents in Surigao City, Philippines	Presenter Sherwin Roy San Pablo Calumba
PP2202	Impact of Rainfall Condition on Traffic Operation of Urban Road Network	piyapong suwanno
PP2205	Influence of Artificial Evacuation Mound Placement on Residents' Consciousness of Tsunami Evacuation	Kazuyuki Takada
PP2240	From Superstatistics of Hubs of efforts to Assertions of Values: The Emergence of the Response-receptive Dynamical Economy Theory	Bahram Mojarabi
PP2641	Long-term Development Policy of JICA on Cross-border Logistics Infrastructure in Indo-Pacific Region	Naoki Otani
Session Name	30.12 Travel Behavior Analysis (2)	2019-09-10 09:00 - 10:30 Venue : Albatross
Manuscript No. Article Title		Chair: Dr. Truong Thi My Thanh
PP2263	Analysis of tourist travel behavior and recommendation for active transport encouragement strategies, the case of Hue city	Presenter Truong Thi My Thanh
PP2265	Changes in Travel Behaviors of Life Stage Relative to Period and Generation	Shota KAWAKAMI
PP2272	Estimation of Mode Shift using Revealed Preference (RP) Technique for Hyderabad Metro Rail (HMR)	Vidhya DURSHANPALLI
PP2274	Factors Influencing the Travel Time Perception of Cyclists: A case study of a Residential Campus	Bharat Kumar A V A
PP2689	Modeling drivers' parking lot choice behaviors in motorcycle dependent cities: Case of Ho Chi Minh City	Hoang Phuc Hai
Session Name	60.11 Transportation and Environment (1)	2019-09-10 09:00 - 10:30 Venue : Eagle
Manuscript No. Article Title		Chair: Dr. Seung Kook Wu
PP2217	Simulation of Metro Manila Public Transportation Network under Flooded Conditions	Presenter Raymund Paolo Bilò Abad
PP2291	SUSTAINABLE MOBILITY TARGET: RELATIONSHIPS BETWEEN AGE-GENDER WITH PERCEPTIONS AND ATTITUDES OF CAR USERS	FAZILATULAILI ALI
PP2354	A Method to Reflect Distance Decay Effects on Land Use Regression Model	Youngkook Kim
PP2356	Analysis of Factors to Cause Hokkaido Sika Deer Vehicle Collisions using Poisson Regression Model - Case Study of National Route 44 in Hokkaido, Japan -	Tomoki Washio
PP2357	Determining Hydrogen Filling Station Allocation Strategies in Tainan City, Taiwan	Tzu-Chang Lee
Session Name	70.31 Bus and BRT (Bus Rapid Transit) (1)	2019-09-10 09:00 - 10:30 Venue : Olu
Manuscript No. Article Title		Chair: Dr. Tetsuhiro ISHIZAKA
PP2233	Cost Saving Effect and Resident Satisfaction of Community Bus Replacement Service Provided by Taxi	Presenter Hideki KATO
PP2251	Premium Point to Point (P2P) Bus Service System: An Initial Assessment of Current Routes in Metro Manila	Paolo Ian Casipit Lucero
PP2366	A Preliminary Study of Traffic Impacts Due to Operational Improvement of Bus Rapid Transit in Bangkok Using Microscopic Traffic Simulation	Anousone Sisoutham
PP2377	Analyzing Route Segment Performance Based on Multiple Indicators Using DEA: A Case Study on Ahmedabad BRT	Anand Kakarla
PP2386	Evaluating Operational Performance of City Bus Transit Service Using TCQSM Guidelines: A Case Study of Surat City	Nandan Dawda
Session Name	90.21 Traffic Flow Analysis (1)	2019-09-10 09:00 - 10:30 Venue : Nelum
Manuscript No. Article Title		Chair: Dr. Ashish Dhamaniya
PP2208	Modification of SIDRA Model for Capacity Estimation of Urban Roundabouts under Mixed Traffic Condition in Sri Lanka	Presenter Tharuka Karunarathne
PP2434	A Study on the Characteristics of MFD determined by Probe Data	Stephanie GITURU
PP2453	Impact of Snowfall and Road Structure on Travel Speed in Winter in Niigata prefecture, Japan	Jun Ito
PP2459	Modeling Traffic flow along four lane dual carriageway roads in Kandy	Umesh Ashen Lowe
PP2470	Study on Acceleration and Deceleration Characteristics of Vehicles Influenced by Crossing Pedestrians at Urban Midblock Sections	Hareshkumar Dahyabhai Golakiya
Session Name	100.12 Accident Analysis (2)	2019-09-10 09:00 - 10:30 Venue : Manel
Manuscript No. Article Title		Chair: Prof. Shin Hyoung PARK
PP2478	A Comprehensive Study on Identification of Risk Factors for Fatal Pedestrian Crashes at Urban Intersections in a Developing Country	Presenter Dipnjan Mukherjee
PP2519	Road traffic accident analysis and identification of hazardous zones for highway	Moe Thet Thet Aye
PP2638	Performance Evaluation of Machine Learning Algorithm for Crash Risk Prediction	MINJI KANG
PP2639	Development of Effect Analysis Techniques for Installation of Jaywalking Prevention Facility using Cluster Analysis and Empirical Bayes Method	Yong Woo PARK
PP2686	Motorcycle Traffic Accident Analysis and Motorcycle Risky Driving Behavior Survey in Taiwan	King Wah CHAN
Session Name	200.26 Institutions for Railway Development in Asian Cities (IRDAC) (IRG-26-2014)	2019-09-10 09:00 - 10:30 Venue : Grand Ballroom 2/3
Manuscript No. Article Title		ISC Special Session
PP2626	The Key Issues for the Urban Railway in Asian Mega City	Presenter Shigeru Morichi
PP2606	Comparative Financial Analysis of PPP Urban Railway Projects in Asian Mega Cities	Shigeru Morichi
PP2606	Urban rail transit PPPs: Lessons from China	Shengchuan ZHAO
PP2627	New PPP Methods to Share the Risk in Korea	Sungwon LEE
PP2252	Risk Analysis of PPP Urban Railway Projects in Asia	Hidetoshi Matsushita
Session Name	10.12 Asia-Specific Issues (2)	2019-09-10 11:00 - 13:00 Venue : Grand Ballroom 1/3
Manuscript No. Article Title		Chair: Dr. Sigon Kim
PP2206	Measuring Heterogeneity in Pedestrian Satisfaction of Existing Facilities in Urban India – A Tale of Three Cities	Presenter Arkopal K Goswami
PP2212	Redesigning the Interiors of Public Buses in Dhaka City: Exploring the Gender based Perceptions and Preferences	Sharmin SULTANA
PP2216	Service Quality of Public Buses Perceived by Female Commuters in a Developing City	Tanzila Islam
PP2300	Variability in Behavior Regularities of Bus Users based on Long-Term Smart Card Data Analysis	Pai-Hsien Hung
PP2591	Identification of Transportation Mode and Transit Behaviour from Mobile CDRs Data: A Case of Yangon City	Daw Kyaing
PP2660	Estimating Willingness to Pay for Non-Market Services of Sightseeing Trains	Sigon Kim
Session Name	20.51 TDM Policy and Mobility Management (1)	2019-09-10 11:00 - 13:00 Venue : Albatross
Manuscript No. Article Title		Chair: Dr. YoungJong Kwon
PP2242	Implementing Stage-Based Models of Behavioral Change as Menu-Based Intervention	Presenter Varsolo Sunio
PP2244	Initiatives to boost investment and address policy issues that would further develop the supply chain and enhance the competitiveness of the logistics service providers in the Philippines	Enrico Basilio
PP2246	Merger Forms and Welfare: Evidence from the U.S. Airline Industry	Ryohei Yamamoto
PP2353	Transit Oriented Development (TOD) in Dhaka: Opportunities and Challenges for (Re)development around Stations	AFSANA HAQUE
PP2411	Single Rail Train Dispatch Time Optimization Under Static Demand and Fixed Train Capacity	Virgilio Ma. E. Ramos Jr.
Session Name	40.31 City Logistics (1)	2019-09-10 11:00 - 13:00 Venue : Eagle
Manuscript No. Article Title		Chair: Dr. Ching-Jung Ting
		Presenter

EASTS 2019

PP2306	A Novel Recombination approach to solve Prize Collecting Vehicle Routing Problem	Ching-Jung TING	
PP2309	A UCT-Based Approach for Traveling Salesman Problem with Drone	Anh Minh Nguyen	
PP2311	Analysis of the Demand-Side Characteristics of Mumbai Dabbawala Service	Yu-Ting Hsu	
PP2315	Geographical dimension of e-commerce logistics facilities in Tokyo Metropolitan Region, Japan	Chathura Kovida De Silva	
PP2322	The Risk of Inland Waterway Transport During the Logistics Growth Period of Ayutthaya Province of Thailand	Kanisa Rungjang	
Session Name	70.51 Pedestrian and Bicycle (1)	2019-09-10 11:00 - 13:00 Venue : Olu	Chair: Dr. Kiichiro HATOYAMA
Manuscript No.	Article Title	Presenter	
PP2182	A Proposal and its Effectivity of a Tsunami Evacuation Guidance System Considering Visitors' Preference	Kyohei Ichinose	
PP2198	Factors Affecting on Implementation of Bicycle Sharing System in Major City Areas in Sri Lanka	Tharuka Karunarathne	
PP2269	Determining the Impacts of Pedestrian Facility Improvements on Mode Choice of Car Users: A Case Study of the Ortigas Center	Edgardo Jr Aguilar Brillón	
PP2394	How Far People Can Walk to Access Metro? A Study of Access Trip Characteristics of Delhi Metro Users	Akshay Gupta	
PP2396	Identification of factors towards contributing frequency of walking to access urban rail transit station	Mohd Farid Jaafar Sidek	
PP2553	Exploring Cyclist Flow Patterns at Signalized Crossing: Perspective of Cyclist-Pedestrian Conflict Analysis	Yu-Ting Hsu	
Session Name	100.22 Driving Behavior and Safety (2)	2019-09-10 11:00 - 13:00 Venue : Nelum	Chair: Dr. Hiroshi Kobayashi
Manuscript No.	Article Title	Presenter	
PP2209	Motorcycle Helmet in Vietnam: Why Success? A Study on the Lessons from Implementation Process	Dinh Van Hiep	
PP2501	Evaluating the Effects of Road Hump on Speed and Noise Level at a University Setting	NUR ASIAH MUSTAFA	
PP2514	Mobile Phone Use at Un-signalized Mid-block Pedestrian Crossings in Sri Lanka	Hansini M.H. Egodawatta	
PP2522	Study on Differences in Situational Awareness Between Elderly and Middle-aged Drivers in a Level 2 Automated Vehicle and in a Non-Automated Vehicle	SHUHEI WADA	
PP2529	Visibility Assessment of Pro-beam Road Light on the Test Track	Toru Hagiwara	
PP2657	Experiment on Desirable Structures for Two-step Crossing System that Supports Safe Crossing of Pedestrians	Hiroshi KOBAYASHI	
Session Name	110.42 Operation and Management of Air/Water Transportation (2)	2019-09-10 11:00 - 13:00 Venue : Manel	Chair: Dr. Zijian GUO
Manuscript No.	Article Title	Presenter	
PP2537	Research on Simulation and Optimization of Ship Lock Scheduling Based on Rapid Arrange Algorithm	Zhen Cao	
PP2540	The Impact of Flexible Berthing Scheme on Navigation in One-way Channel with Multi-junction	Zhenxuan Chen	
PP2632	Analysis of flight operations and capacity constraints at Bandaranaika International Airport (BIA)	Anuja Fernando	
PP2633	Passenger attitudes to Airline service quality and expectations	Anuja Fernando	
PP2637	Contribution of Maritime Logistics Developments to the network connectivity of Ports	Surandika Rupasinghe	
Session Name	200.26 Institutions for Railway Development in Asian Cities (IRDAC) (IRG-26-2014)	2019-09-10 11:00 - 13:00 Venue : Grand Ballroom 2/3	ISC Special Session
Manuscript No.	Article Title	Presenter	
PP2624	Current of Southeast Asia urban transportation	Kunio KAWAKAMI	
PP2621	The Current State of Bangkok Mass Transit System	pichai taneerananon	
Panel Discussion	Prof. Dr. Shigeru Morichi (Japan, Former EASTS chairman) Prof. Dr. Pichai Taneerananon (Thailand, Vice-president of EASTS) Prof. Dr. Shengchuan ZHAO (China, Dalian University of Technology) Dr. Jaehak OH (Korea, Chairperson of EASTS ISC) Dr. Surya Raj Acharya (Nepal, Tribhuvan University)		
Session Name	10.13 Asia-Specific Issues (3)	2019-09-10 14:00 - 15:30 Venue : Albatross	Chair: Dr. Tri Basuki Joewono
Manuscript No.	Article Title	Presenter	
PP2221	Traffic Culture of Motorcycle Users in Vietnam: A Study for Evaluation after 10 Years of Official Deployment	Dinh Van Hiep	
PP2223	Twitter to Transport: Geo-Spatial Sentiment Analysis of Traffic Tweets to Discover People's Feelings for Urban Transportation Issues	Narayan Chaturvedi	
PP2231	A Systematic Approach to Identify Congestion Charging	Thillaiampalam SIVAKUMAR	
PP2301	Why do shoppers keep making trip for online shopping? Learning from evidence in Bandung, Indonesia	Tri Basuki Joewono	
PP2378	Assessing and Improving Schedule Reliability of Bus Route under Mixed Traffic Environment	Chepuri Akhilesh	
Session Name	30.31 Network Analysis and Traffic Assignment (1)	2019-09-10 14:00 - 15:30 Venue : Eagle	Chair: Dr. Thillaiampalam SIVAKUMAR
Manuscript No.	Article Title	Presenter	
PP2268	Demand Estimation of a New Light Rail Transit in a Tourist City Considering the Change in Population Distribution -A Case Study for Kanazawa City, Japan-	Eiki TAKASUGI	
PP2281	Modified Greedy Algorithm for Game-Theoretic Traffic Assignment	John Justine Villar	
PP2289	Semi-dynamic Markovian path flow estimator considering the inconsistencies of traffic counts	Hiroshi Shimamoto	
PP2628	Issues Related with Census Based Traffic Analysis Zone (TAZ) Delineation in Statewide Traffic Demand Models (STDM) in Sri Lanka	Thillaiampalam SIVAKUMAR	
Session Name	70.41 Minibus and Paratransit (1)	2019-09-10 14:00 - 15:30 Venue : Olu	Chair: Dr. Kunihiro Kishi
Manuscript No.	Article Title	Presenter	
PP2347	Study of the Effect of Promoting Shopping through An Alliance between Community Café and Public Transportation	Kunihiro Kishi	
PP2410	Service Quality Analysis for Online-taxi: A Case Study of Malang City, Indonesia	Achmad Wicaksono	
PP2600	Low-income working women's perception on Paratransit Service Quality: A Structural Equation Model (SEM) Approach for Dhaka city	Farzana Rahman	
Session Name	80.22 Pavements (2)	2019-09-10 14:00 - 15:30 Venue : Nelum	Chair: Dr. Terrance Mohanaraj Rengarasu
Manuscript No.	Article Title	Presenter	
PP2420	Development of Automatic Concrete Cracks Detection System Using Average Shifted Mesh	Takahiro MIMANI	
PP2431	Suitability of coal bottom ash and carbonized rice husk in hot mix asphalt	Terrance Mohanaraj Rengarasu	
PP2433	Utilization Analysis of On-street Parking Facility in Carmen Public Market, Cagayan De Oro City, Philippines	Anabel Abugaa Abuzo	
PP2617	Parking Study and Willingness to Pay for Vehicle Parking: The Case in Iligan City, Philippines	METODIA MAQUILING TRINIDAD	
PP2618	Parking Adequacy around Wet Market, Iligan City	KENNY B. CANTILA	
Session Name	90.31 Highway Capacity and Quality of Service (1)	2019-09-10 14:00 - 15:30 Venue : Manel	Chair: Dr. Subhadip Biswas
Manuscript No.	Article Title	Presenter	
PP2435	Analysis of Level of Service for Manually Operated Tollbooths under Mixed Traffic Scenario	Yogeshwar V. Navandar	
PP2456	JEEPNEY UTILIZATION AND RE-ROUTING ANALYSIS FOR COGON PUBLIC MARKET, CAGAYAN DE ORO CITY, PHILIPPINES	Anabel Abugaa Abuzo	
PP2461	Performance Evaluation of Undivided Streets: A Clustering-based Approach	Subhadip Biswas	
PP2477	Whether Weather Matters to Traffic Flow in an Expressway	Hanzel Naval Mejia	
PP2584	Determinant of the Level of Service (LOS) of the Arterial Roads in Vigan City, Ilocos Sur, Philippines	FRANKLYN TINAZA AMISTAD	
Session Name	10.41 Survey and Data Collection (1)	2019-09-10 16:00 - 17:30 Venue : Grand Ballroom 1/3	Chair: Dr. Tissa Urala Liyanage
Manuscript No.	Article Title	Presenter	
PP2191	Comparison of Crossing Speed Variation of Pedestrians at Signalized Crosswalks with and without Countdown Displays	Tharuka Karunarathne	
PP2197	ESTIMATION OF PEDESTRIAN FLOW BASED ON WIFI DATA AND VIDEO CAMERAS	Nikolai Alekseev	
PP2282	Optimization of Bus Stop Allocation & Time Scheduling Using Bus GPS Data	thet htun aung	
PP2287	Review of Previous Master Plan Studies and Implication for Improvement on Travel Surveys and Demand Forecasting Methods in Developing Countries	Sadayuki Yagi	
PP2647	Travel Behaviour of Public Transport Passenger at Kandy City under Unplanned Terminal Setup	Krishani Perera	

Session Name	20.31 Project Evaluation (1)	2019-09-10 16:00 - 17:30 Venue : Albatross	Chair: Dr. Cheng-Min Feng
Manuscript No. Article Title			Presenter
PP2250	Preliminary Study on Transit-Induced Residential Gentrification in Nagoya, Japan		Isha Wang
PP2267	A Study on the Barriers of the Thai Government for Development of High Speed Rail Project		Kittipong Tissayakorn
PP2574	Financial analysis and recommendations for the sustainability of toll road projects		Truong Thi My Thanh
PP2560	Formulating an Investment, Management and Operation Model for Developing Multimodal Transport Terminals in Sri Lanka		Nimesha Indika
PP2696	Risk Analysis of PPP in Kaohsiung MRT project		CHENG-MIN FENG
Session Name	50.21 Land Use and Spatial Analysis (1)	2019-09-10 16:00 - 17:30 Venue : Eagle	Chair: Dr. Amilia Buddhika Jayasinghe
Manuscript No. Article Title			Presenter
PP2326	Accessibility Assessment of Cities Based On Network Analysis and Centrality		Kalpna L. D. C. H. N.
PP2338	Identification and Classification of Land Use Types in Yangon City by Using Mobile Call Detail Records (CDRs) Data		Thiri Aung
PP2340	Impact of Land Use Type over Pedestrian Flow Characteristics for Skywalk Facilities in Mumbai, India		Akhilesh Kumar Maurya
PP2343	Proposal on Integrated Bus Planning Sites for Mandalay City		Supu Thu
PP2345	Road Network Centrality based Model to Simulate Population Distribution		Nima TENZIN
Session Name	100.41 Evaluation on Safety Measures (1)	2019-09-10 16:00 - 17:30 Venue : Olu	Chair: Dr. Mursheda Rahman
Manuscript No. Article Title			Presenter
PP2200	Human Factor And Safety Culture In Vietnamese Urban Railway		Tuan Anh Luong
PP2365	A Nationwide Road Safety Education Initiative Among Children: Is It Workable, Scalable and Replicable?		kulanthayan KC Mani
PP2413	To Walk or Not To Walk: Pedestrians' Perception on the Structure of Sidewalk		Numerma Nazneen
PP2502	Evaluating the Effects of Road Hump on The Speed of Vehicles in An Institutional Environment		NUR NAJIAH AZHANI ROSLI
PP2516	Predicting Individual Vehicle Speed Profile of Urban Residential Streets where a Single Hump is Present Considering the Road Geometric Features		Mursheda Rahman
Session Name	120.21 New Transport Industry (Car-Sharing/Carpool/Bike-Sharing/Uber/Personal Mobility) (1)	2019-09-10 16:00 - 17:30 Venue : Nelum	Chair: Dr. Pradeepa Jayaratne
Manuscript No. Article Title			Presenter
PP2382	Assessment of Transportation Network Vehicle Services from the Drivers' Perspective		Jose Regin F. REGIDOR
PP2559	Impacts of an Economic Incentive for Intercity Peer-to-Peer Ride-Sharing in Sparsely Populated Areas		Azarel Chamorro Obra
PP2573	Bicycle Hire Scheme (BHS): Is it Possible to Implement in Dhaka City?		M. Shafiq Ur Rahman
PP2585	Evaluate and Identify the Factors Impact on Selecting a Mobile App-Based Taxi service in Sri Lanka (Users' Perspective)		Nimeshika Thilakaratne
PP2679	Opportunities and Challenges: How Bike Sharing System is Promoting Cycling as a Mode of Transportation in Penang		Nadhrak Kadir
Session Name	130.11 Engineering, Technology, and Design (1)	2019-09-10 16:00 - 17:30 Venue : Manel	Chair: Dr. Simniah Karuppiah Navaratnarajah
Manuscript No. Article Title			Presenter
PP2409	Resilient element attached under the concrete sleepers to improve the rail track performances		Simniah Karuppiah Navaratnarajah
PP2528	Traffic Sign Detection Using Convolutional Neural Networks		Dung Ngoc Bui
PP2548	Modeling of Track Longitudinal Level Irregularity Based on High Frequency Measured Data		Takeshi Nomura
PP2575	The Features of Shinkansen System and Infrastructures Japanese Engineers Challenging in Recent Three Decades		Hitoshi ASAMI
Session Name	200.29 Gender and Transport Nexus: Achieving A More Equitable and Inclusive Society (IRG-29-2016)	2019-09-10 16:00 - 17:30 Venue : Falsetto	
Manuscript No. Article Title			Presenter
PP2215	Role of Female-Only Bus Services in Promoting Social Inclusion: A Case Study of Lahore, Pakistan		MUHAMMAD AHMAD AL-RASHID
PP2678	Gender Mainstreaming in Public Transport Operation in Sri Lanka for Better Economic Returns		Namal RALAPANAWA
Session Name	10.14 Asia-Specific Issues (4)	2019-09-11 09:00 - 10:30 Venue : Grand Ballroom 1/3	Chair: Dr. Ranja Bandyopadhyaya
Manuscript No. Article Title			Presenter
PP2458	Modeling Optimal Mode Share of Paratransits using VISSIM for Congested One-Way Traffic Urban Roads		Ranja Bandyopadhyaya
PP2468	Service Time Variation Analysis at Manually Operated Toll Plazas under Mixed Traffic conditions in India		Chintaman Bari
PP2469	Statistical Distribution Analysis of Clearance Time at Manually Operated Toll Plazas under Mixed Traffic Conditions		Mahindra Deshmukh
PP2582	Predictors of Aberrant Driving Behaviors of Pakistani Drivers by using Proportional Odds (PO) model		Muhammad Hussain
PP2599	Designing a discrete choice experiment for application to transport developing country: An empirical study of alternate routes prior to the construction of a new bridge.		Monita Yessy Beatrix WAMBRAUW
Session Name	20.71 Sustainable Transportation Policy (1)	2019-09-11 09:00 - 10:30 Venue : Albatross	Chair: Dr. Masria Mustafa
Manuscript No. Article Title			Presenter
PP2211	Participation of the Communities' Physical Contribution for Developing Rural Traffic Infrastructure of Dong Nai Province, Vietnam		Dinh Tuan Hai
PP2247	Modeling of Traffic Impact Analysis (TIA) with System Approach and GIS Integration		Ponnurangam Palani
PP2248	National Transport Policy in Malaysia – from the Time of Independence until Today		Masria Mustafa
PP2256	Travel Experience and Multitasking of Toll Road Users in Jakarta Metropolitan Area, Indonesia: An Investigation for Passenger of Private Car, Taxi, and Ride-sourcing		Muhamad Rizki
PP2596	Formulation of a Methodology for Land Transport Costing and Pricing		Pavithra Madushani Kumari
PP2593	Modelling Railway Station Access Mode Choice Behaviour and Rail Travel Demand		Li Meng
Session Name	30.13 Travel Behavior Analysis (3)	2019-09-11 09:00 - 10:30 Venue : Eagle	Chair: Dr. Akhilesh Kumar Maurya
Manuscript No. Article Title			Presenter
PP2275	Identification of Priority Attributes Influencing the Choice of Plug-in Hybrid Electric Vehicle in Indian Megacities		Bhargab Maitra
PP2285	R Programming Language Written for Estimation of the Integrated Multinomial Logit-Linear Regression Model Based on a Copula Approach: A Technical Article		Monorom Rith
PP2295	The parents' role in school mode choice for their children: A case study in Guwahati		Dr. Akhilesh Kumar Maurya
PP2367	A Review on an Emerging New Mode of Transport: The Shared Dockless Electric Scooter		Narith Saum
PP2561	Explore the Decision Behavior of Departure Time Based on Butterfly Model: A Case Study of Freeway No. 5 in Taiwan		Yu-Kai Huang
Session Name	40.12 Logistics and Freight Transportation Policy (2)	2019-09-11 09:00 - 10:30 Venue : Olu	Chair: Dr. Tsung-Sheng Chang
Manuscript No. Article Title			Presenter
PP2312	Analysis on Cross-Border Transport Logistics of Coal Export		DELGERNASAN Mishig
PP2577	Competitive Location and Design Problem between Two Different Types of Retail Stores		Tsung-Sheng Chang
PP2578	Competitive/Complementary Relationships and Concentration among Indian Container Ports		Chathumi Ayanthi Kavirathna
PP2713	Selection Of Acacia Wood Suppliers At XYZ Furniture Using The Promethee Method		Nurlaela Kumala Kumala Dewi
Session Name	50.41 Tourism and Leisure Activities (1)	2019-09-11 09:00 - 10:30 Venue : Nelum	Chair: Dr. Leksmono Suryo Putranto
Manuscript No. Article Title			Presenter
PP2337	Foreign Tourists' Aggressive Driving Behavior in the Eyes of Bali Local Resident		Nicholas Marpaung
PP2341	Lessons Learned from Developing R3A toward Implementing Tourism Policy for Thailand's Upcoming Challenges: A Case Study on Private Car Tourism		Sumalee - Sukdanont
PP2348	The Characteristics Long Holiday Travel of Eid Al-Fitr in Indonesia		Leksmono Suryo Putranto
PP2351	The Interactive Creation of Local Identity in Tourist Visiting Cities: A Comparative study of Nara, Bologna, and Santa Barbara		nakano hiroyuki

PP2630	Leisure Activities and Subjective Well-being of University Students in Mongolia		Oyun-Erdene Shirendev
Session Name	100.13 Accident Analysis (3)	2019-09-11 09:00 - 10:30 Venue : Manel	Chair: Dr. Do Duy DINH
Manuscript No. Article Title			Presenter
PP2482	A systems-based approach to identify influential factors of a downgrade truck collision caused by a brake failure in Vietnam		Do Duy DINH
PP2504	Exploring the Utilization of Crash Data from Waze and Twitter for Official National Crash Database		Varsolo Sunio
PP2655	Comparative Analysis of the Effect of Expressway Speed Limit on Traffic Crashes		Dong Uk Kim
Session Name	200.281 Motorcycle, Motor Scooter, Motorbike Ownership and Use in South East Asia Cities (1) (IRG-28-2015)	2019-09-11 09:00 - 10:30 Venue : Falsetto	
Manuscript No. Article Title			Presenter
PP2186	An evaluation of motorcycle ownership in Ho Chi Minh city		TRAN VU TU
PP2226	Vehicle Ownership Comparison between Ho Chi Minh city and Bangkok		TRAN VU TU
PP2543	App-based Motorcycle Ridesharing Services in Dhaka City: Female Users' Opinions and Perception		M. Shafiq Ur Rahman
PP2597	Vehicle Ownership Trends in Ho Chi Minh city and Bangkok		TRAN VU TU
Session Name	200.32 Logistics Network and Variety in Asian Context: Globalization and Localization (IRG-32-2017)	2019-09-11 09:00 - 10:30 Venue : View	
Manuscript No. Article Title			Presenter
PP2562	Widening narrow alleys to enhance response efficiency for fire emergency from the perspective of urban roadway network analysis		Yu-Ting Hsu
PP2631	Measuring Impacts of Japanese "Modal-Shift" Policy on International Container Cargo Flow by using Intermodal Network Assignment Model with Cabotage Constraint		Ryuichi SHIBASAKI
Session Name	Application of Travel Behavior Analysis and Demand Modeling Approaches for Solving Transportation Problems	2019-09-11 09:00 - 10:30 Venue : Grand Ballroom 2/3	
Special Session	Prof. Bhargab Maitra Prof. Hironori Kato		
Session Name	10.71 Others (1)	2019-09-11 11:00 - 13:00 Venue : Grand Ballroom 1/3	Chair: Dr. Sungwon Lee
Manuscript No. Article Title			Presenter
PP2339	Impact of International and Domestic Flights to/from Japanese Local Airports on Overnight Stays of Foreign Visitors in Japan: An Analysis		Tetsuo Shimizu
PP2471	The Comparison Between ARIMA and Long Short-term Memory for Highway Traffic Flow Prediction		XINGWEI LIU
PP2506	Factors Influencing Pedestrian Signal Violations: A Case Study from Kolkata, India		Dipanjana Mukherjee
PP2525	Study on the Feasibility of Cross Sector Cooperation Approach towards Road Traffic Safety		MURUNGI ELIZABETH MWEBESA
PP2535	Examining Safety Performance at Sea: Malaysian Seafarers' Perspective		SUZANNA RAZALI CHAN
PP2712	Fourth Industrial Revolution and Transport: Implications for Transport Behavior		Sungwon Lee
Session Name	70.52 Pedestrian and Bicycle (2)	2019-09-11 11:00 - 13:00 Venue : View	Chair: Dr. Yoongho Ahn
Manuscript No. Article Title			Presenter
PP2389	Evaluation of Walking Environment around Urban Railway Stations in Bangkok and Consideration of Improvement Plan		Atsushi FUKUDA
PP2390	Exploring the Factors Influencing Bicycle Use in a Medium-Sized City: the Case of Iloilo City, Philippines		Jerilee Pachoco Cameña
PP2398	Modelling of Pedestrian Sign Location in a Large Transport Hub		Yoongho Ahn
PP2612	Psychological factors on bicycle commute and strategies to accelerate the adoption of cycling for transportation		Liya Yang
PP2673	Changes in Subjective and Objective Comfort for Pedestrians and Cyclists After Road-Space Reallocation : A Case Study of Midosuji, Osaka		Nagahiro YOSHIDA
Session Name	70.71 Transit and Urban/Regional Development (1)	2019-09-11 11:00 - 13:00 Venue : Albatross	Chair: Dr. YoungJong Kwon
Manuscript No. Article Title			Presenter
PP2224	Understanding of Population Difference between Railway Lines in Tokyo Metropolitan Area		Takayoshi Tsuchiya
PP2372	An Approach to Distinguish Destination from the Alighting Stop based on Fare Data		Mona Mosallanejad
PP2407	Possibility of Transit Oriented Development at Asian Small Sized City from View Point of Citizen's Acceptability		Tetsuhiro ISHIZAKA
PP2629	Impacts of Chinese High-Speed Rail on Urban Economic Agglomeration: based on the heterogeneity of industry types and city types		SIQI WAN
Session Name	80.21 Pavements (1)	2019-09-11 11:00 - 13:00 Venue : Eagle	Chair: Dr. Ghim Ping Ong
Manuscript No. Article Title			Presenter
PP2416	A Decision Making Framework for Condition Evaluation of Airfield Pavements using Non-Destructive Testing		Ajit Pratap Singh
PP2425	Mechanical Properties of Modified HMA Containing Polyethylene Terephthalate fibers as binder additive and Carbonized Wood Particles as fine Aggregate Replacement		Nishanthini Jegatheesan
PP2426	Pareto Optimisation Approach for Functional Design of Pervious Pavements Using Numerical Modelling		Ghim Ping Ong
PP2427	Pulverized Ceramic Tile Waste as Potential Mineral Filler in Hot Mix Asphalt		Ma Bernadeth Borleo Lim
Session Name	90.81 ITS (1)	2019-09-11 11:00 - 13:00 Venue : Olu	Chair: Dr. Toru Hagiwara
Manuscript No. Article Title			Presenter
PP2447	Evaluation of Merging Behavior of Connected and Automated Vehicles at On-ramps		Toru Hagiwara
PP2448	Evaluation of Traffic Collision Risk and CO2 Emission Reduction under Providing Accelerator-off Indication to Multiple Vehicles		Shogo Ishiguro
PP2474	Transition and Problem of Probe Data Research in the Field of Road Transportation in Japan		Yoichiro Kataya
PP2475	Travel Time Information on Urban Roadways for Advanced Travelers Information System Using Data from Bluetooth MAC Scanners		Porntep Puangprakhon
PP2551	Considering Better Highway ETC System: Comparison between Japan and Taiwan		PO-HSING TSENG
Session Name	110.31 Airport Planning, Engineering, and Management (1)	2019-09-11 11:00 - 13:00 Venue : Nelum	Chair: Dr. Suling Li
Manuscript No. Article Title			Presenter
PP2532	Effects of Incentive Policy on Maritime Stakeholders in Japanese Local Ports		Hoshi Tagawa
PP2534	Estimation of Delay Time and Actual Turnaround Time for Departure Flight from Penghu Airport		SUILING LI
PP2634	Introduction about business model of investment in the cargo sector at the airport		Daisuke SASAOKA
PP2642	Analysis and Characterization of Domestic Air Travel Delay of Low-Cost Airlines at NAI Terminal 4		Teddy Lopez Omilig
PP2649	Study on the Fairness of Shift Scheduling for Airline Ground Staff		SUILING LI
PP2716	Simulation Analysis of Airport Capacity for Disaster Relief Activities		QINGQI WANG
Session Name	130.21 Policy, Planning and Management (1)	2019-09-11 11:00 - 13:00 Venue : Manel	Chair: Dr. Sunkyoung Choi
Manuscript No. Article Title			Presenter
PP2547	Level of Service and Walkability Analysis of Pedestrian Facility of Public Markets in Cagayan de Oro City Philippines		Anabel Abugaa Abuzo
PP2552	Exploring Holiday Trip Patterns on Freeways Based on Electronic Toll Collection Data		Yu-Ting Hsu
PP2622	Sustainable Transport Development in Nepal: Perspective, Preparedness and Action		Indra P TIWARI
PP2699	Comparative Empirical Study on Disaster Prevention Consciousness and Intended Evacuation Behavior of Inbound Tourists and Japanese		Sunkyoung Choi
PP2706	AN ASSESSMENT OF THE PEDESTRIANIZATION SCHEME IN THE HERITAGE CITY OF VIGAN, PHILIPPINES		FRANKLYN TINAZA AMISTAD
PP2722	Lessons Learned and Implications from Tsubasa bridge of Cambodia supported by Japan's Grant Aid Assistance		Yukihiko Koizumi
Session Name	200.282 Motorcycle, Motor Scooter, Motorbike Ownership and Use in South East Asia Cities (2) (IRG-28-2015)	2019-09-11 11:00 - 13:00 Venue : Falsetto	
Manuscript No. Article Title			Presenter

PP2616	How Vehicle Ownership Affects the Noise Pollution – A Study Case in Ho Chi Minh city	TRAN VU TU
PP2619	The Relationship Between Traffic Proportion, Vehicle Ownership and Dust Particle Concentration in Ho Chi Minh city	Linh Thanh TRINH
PP2644	The relationship between Vehicle Ownership and household income in Ho Chi Minh city	Anh Minh Nguyen
PP2219	Study on the Operational and Usage Characteristics of Motorcycle Taxis in Metro Manila	Glenn Simon Dayrit Latonero

Session Name	10.42 Survey and Data Collection (2)	2019-09-11 14:00 - 15:30 Venue : Albatross	Chair: Dr. Rattanaporn Kasemsri
Manuscript No.	Article Title		Presenter
PP2180	A Mobile Application Survey in Bangkok Metropolitan Region		Masaru Komori
PP2210	Origin-Destination Trip Pattern Representative by using Bluetooth Data Collection on the Arterial Road Network, Bangkok, Thailand		RATTANAPORN KASEMSRI
Session Name	30.32 Network Analysis and Traffic Assignment (2)	2019-09-11 14:00 - 15:30 Venue : Eagle	Chair: Dr. John Justine Villar
Manuscript No.	Article Title		Presenter
PP2296	Traffic Flow Prediction Using Micro-Simulator with Multiple Information		Faysal Ibna Rahman
PP2571	Sequential Intermediate Destination Approach to Route Choice Set Generation		Mel Francis Eden
PP2572	Discrete Optimization for Path Generation Using Parallel Computing		Anjilo CARIGMA
PP2640	Study on the Analysis of the Effect of Traffic Management Plan for Bridge Blockage following Earthquake Outbreak		HyunSu PARK
Session Name	60.21 Climate Change and Transportation (1)	2019-09-11 14:00 - 15:30 Venue : Manel	Chair: Dr. Trinh Van Chinh
Manuscript No.	Article Title		Presenter
PP2360	Estimation of CO2 Emission in Context of Urban Transportation for City Surat in India		Nimit Palsanawala
PP2362	REDUCING URBAN POLLUTION, ELECTRIC VEHICLES SHOULD BE DEVELOPED		Trinh VAN CHINH
Session Name	70.32 Bus and BRT (Bus Rapid Transit) (2)	2019-09-11 14:00 - 15:30 Venue : Olu	Chair: Dr. Mohibullah Rahmat
Manuscript No.	Article Title		Presenter
PP2388	Evaluation of Public Transportation Mode Choice with Passenger Satisfaction: A Case Study of the Semi-Luxury Bus Service on the Panadura-Kandy Route in Sri Lanka		Chamila Tharangani Danthanarayana
PP2392	Factors Affecting the Willingness of Paratransit Drivers to Join Regular Bus System		Mohibullah Rahmat
PP2400	Investigating Satisfaction and Its Determinants of BRT-Lite Services in Indonesian Cities		Martina Cecilia Adriana
PP2412	Socio-Economic Factors and Modelling of Transit Buses in the Eastbound Terminal of Cagayan de Oro City, Philippines		Jefferson Jr. Ramos Vallente
Session Name	100.23 Driving Behavior and Safety (3)	2019-09-11 14:00 - 15:30 Venue : Nelum	Chair: Dr. Shakil Mohammad Rifaat
Manuscript No.	Article Title		Presenter
PP2492	Characterization of Motorcycle Usage in Asia in aid of Motorcycle Road Safety Policy Framework Formulation: The Case of Metro Manila		Hussein S. LIDASAN
PP2499	Effect of Fatigue on Traffic Law Violation of Bus Drivers in context of Developing Countries		Shakil Mohammad Rifaat
PP2508	Impact of Cell Phone Use on Driver Performance in Delhi		Abhaya Jha
PP2515	Motorbike Drivers Perspective On Wearing of Helmet In Hyderabad Metropolitan City, India		Ramesh Adepu
PP2623	Make Thai Roads Safer with the Safe System Approach		Narabodee Salatoom
Session Name	120.12 Emerging Technology (C-ITS/Autonomous/IoT) (2)	2019-09-11 14:00 - 15:30 Venue : View	Chair: Dr. Sudarmanto Budi Nugroho
Manuscript No.	Article Title		Presenter
PP2541	Adoption and Utilization of Ride-Hailing Apps in Phnom Penh		Veng Kheang PHUN
PP2556	Examining Travel Time Variability and Reliability on an Urban Arterial Road Using Wi-Fi Detections- A Case Study		Ninad Gore
PP2557	Exploring Route Choice Behavior Using Wi-Fi Based Derived Travel Time		SHRINIWAS Shrikant ARKATKAR
PP2569	Online Shopping Behavior and Its Impact on Residential Waste		Sudarmanto Budi Nugroho
PP2682	Effect of App Based Cab Services on Travel Patterns and Modal Split in Indian Cities		Udit Jain
Session Name	200.31 Better Mobility in New Town: Preparing for Self-Contained Neighborhood in Asia (IRG-31-2017)	2019-09-11 14:00 - 15:30 Venue : Falsetto	
Manuscript No.	Article Title		Presenter
PP2550	Exploring Factors Impact on Self-Containment Level of New Towns: A Comparison Study in Hanoi and Surabaya		Hong Thi Anh NGUYEN
PP2697	Route Choice Behavior in a Newtown in Japan Using a Link-based Recursive Logit Model		Canh Xuan DO

EASTS 2019

Technical Session (Poster)

Manuscript No.	Article Title	Session (slot) Name	Poster Session (1)	2019-09-09	14:00 - 17:00	Venue: LINK	Presenter
PP2183	A Relook at the Pollution Certification for In-use Vehicles in India and Way Forward						Bhargab Maitra
PP2185	An Analysis of Disaster Risk of Emergency Transport Road Using the Reachability Analysis						Shuji Osawa
PP2187	Analysis of Life Satisfaction in Slum Rehabilitation Housing Projects: A Decision Tree Approach						April Ann Tigulo
PP2189	Behavior Analysis of the People Having Difficulty in Going Home in Tokyo Metropolitan Area -the 2011 off the Pacific Coast of Tohoku Earthquake-						Makoto FUJII
PP2194	Development of an IOT System for Traffic Analysis Purposes from Capturing MAC Address Based Data						Dang Minh Tan
PP2201	Identification and Evaluation of Key Determinants of Two-Wheeler Ownership Model in the Context of Developing Countries: A Case Study of Pune City, India						Prasanta Sahu
PP2213	Review of Road Safety Strategies in ASEAN Countries						Tran Minh Tu
PP2222	Traffic Signal Coordination: A Review of Familiar Practices and Research Needs For Developing Countries						Bhargab Maitra
PP2227	A Comparative Analysis on Residents' Paying Willingness for On-Road Public Transport Services Based on Option Price						Xun ZHENG
PP2228	A Decision Framework for Defining TOD to an Indian city						PHANI KUMAR PATNALA
PP2232	COMPARATIVE ANALYSIS OF PRESS COVERAGE ON PUBLIC WORKS IN JAPAN AND THE UNITED STATES						Taiga Sakamoto
PP2237	E-tricycle Pilot Testing at UP Diliman						Ernesto Abaya
PP2238	Evaluation of Sustainability Assessment Practices in Mega Transport Infrastructure Projects in Sri Lanka: Special Reference to Expressway Projects						M.M.N.C. BANDARA
PP2253	Speech Styles of Public Officers in a Question and Answer Session at a Public Meeting of a Transportation Project: Evaluation by the Young Generation						Shintaro TERABE
PP2255	The Application of Gradient Boost Machine and Local Interpretable Model-agnostic Explanations in Examining the Travel Multi-mode Choice, the Case Study of Jakarta City, Indonesia						Tran Vinh Ha
PP2257	Use of Social and Economic Factors for Ranking Pavement Maintenance and Rehabilitation Projects						Sarala GUNATHILAKA
PP2261	Analysis of Maintenance Activities among Child-rearing Households in the Tokyo Metropolitan Area						Ryoji ISHII
PP2266	Data Quality Analysis of Interregional Travel Demand by Extracting Travel Patterns through A Matrix Decomposition Method						Canh Xuan DO
PP2276	Identification of Transportation Mode and Transit Analysis from Mobile CDRs Data: A Case of Yangon City						Kyaing
PP2277	Incorporating Covariance Heterogeneity into Two-level Nested Logit: An Application to a Cooperative Ride System for Elderly People in Rural Areas of Aging Population, Japan						Tien Dung Chu
PP2278	Investigating the Association of Individual and Neighborhood Characteristics with Travel Time: Empirical Evidences from Mumbai, India						Arnab Jana
PP2284	Pedestrian Behavior in Various Type of Settlements in Yogyakarta City						Ni Luh Putu Hendiliana Dewi
PP2293	Taxi Customers Travel Behavior Analysis for Allocation of Taxi Stands in Yangon City						Moe Myint Mo
PP2297	Travel Behavior Pattern in Yogyakarta Urbanized Area: How Does the Characteristics of Its Trip Pattern Related to Socio-Demographics and Urban Form?						Mutiastari Kurnia Devi
PP2298	Trip Chaining Behaviour of Fast Growing Metropolitan City- Surat						N. VASUDEVAN
PP2336	Estimation of Intercity Travel Pattern and Impact on Yangon-Pathwin Road between Ayeyarwady Region and Yangon Region Using Call Detail Record						Nan Thazin Khine Oo
PP2444	Effect of Side Friction Parameter on Urban Road Traffic: Under Mixed Traffic Scenario						Ritvik Chauhan
PP2568	Multi Stakeholder Engagement for Translating Policy Research into Practical Actions on Low Carbon Transport						Sudarmanto Budi Nugroho
PP2587	Estimation of Travel Time Using Wi-Fi Probe Request Data in Mixed Traffic						Md. Shahin
PP2620	Acceptance of Electric Carsharing System in the Developing Urban Areas: Young People's Behavior						Vanduy TRAN
PP2663	Application of Mobile bigdata to Identify Travel Pattern of South Korea						Jonghak Kim
PP2698	Forecasting Mode Choice of Private Car and Transport Network Vehicle Service Users Considering the Metro Manila Bus Rapid Transit - Line 1						Jose Alfonso Maria C. Cua
PP2717	A Model for Predicting Pedestrian Intersection Crossing Volumes: A Case of Taipei						I-I, Wei & Lin-Hung Chen
PP2719	A Study on the Impact of Introducing the Transfer Discount System to Public Transportation and Taxi for Building the Integrated Mobility System						Hunyoung Jung, Jongju Ha

Manuscript No.	Article Title	Session (slot) Name	Poster Session (2)	2019-09-10	09:00 - 12:00	Venue: LINK	Presenter
PP2181	A new approach to estimate lens distortion on the camera						Anh Tuan NGUYEN
PP2230	A study on effect of subsidy on location choice of multi-unit firms						Ryuichi Tani
PP2260	Accessibility-based Network Design Model Considering Induced Travel Demands						Prof. William H. K. Lam
PP2273	Estimation of Travel Time Reduction Benefit Considering the Travel Time Reliability in an Autonomous Vehicle Prevailed Road Network						Sho Nitta
PP2279	Mode Choice Behavior with Urban Railway System in Asian Developing Countries - the Case of Yangon						Takayoshi FUTOSE
PP2280	Modeling Economy-Traffic Relationship for Inter-regional Highway in India: A Case Study						Gaurang Joshi
PP2302	A Budget Allocation Optimization Model in Developing a Sustainable Regional Freight Transportation System						Cheng-Chieh Chen
PP2303	A Comparative Analysis in Modal Choice for Electronics Products from Thailand to Singapore						Cheng-Hsien Hsieh
PP2304	A Model to Estimate Freight Movement in Urban Context Originated by Wholesaler Segments						Duminda BANDARA
PP2305	A Comparative Study about the Selection of Optimal Locations for Large-scale Supermarkets; Related to Western Province, Sri Lanka.						P.N.P. Wijayawardana
PP2310	An Impact of Decentralized Small Scale Industry on Intra-City Freight Trips in developing nation						Chetan Patel
PP2314	Comparing the Clustering Enterprises Using K-means and Expectation Maximization						Naranbaatar
PP2318	Prediction of Virtual Enterprise and Supply Chain Agility Relation and Their Effect on Business Performance						Ariunbayar SAMDANTSOODOL
PP2323	Transition in Freight Movement in Jakarta Metropolitan Area Over the Years						Deo Nobel
PP2324	Urban multimodal sustainable transport: An environmental assessment of cargo bikes in Rio de Janeiro city						Amanda Fernandes Ferreira
PP2327	An Analysis on Inbound Tourists' Perceptions on Travel Destination -A Case Study in Sendai, Tohoku, Japan						Tetsuya KIYOHASHI
PP2328	An analysis on the Economic Impact of Cruise Port of Call in Japan						Nami Yanagihara
PP2329	An overview of Vietnam Water-city typology by quantity of identification elements and the adverse long-term effects by rising sea-level						Le Dai Duong
PP2333	Association between Facility Location Agglomeration and Car Dependency: A Case of Japanese Cities						Maya Safira
PP2334	Association Rule Mining Based Exploring Travel Patterns in Wide Tourism Area using Wi-Fi Package Sensing Survey						Tosporn ARREERAS
PP2344	RBF Network Assessing Development of Downscaling Method for The Hourly Population Inflow: Case Study of Sapporo City Area						Kota OKUMURA
PP2346	Spatial Analysis of the Relationship between Residential Property Value and Accessibility in Jakarta						Hana Afifah Amini
PP2349	The effects of Land Use Characteristics on Passenger Ridership of Rail-based Transit Oriented Development in Kuala Lumpur						Fatahsha Amira
PP2350	The Impact of Railway Networks on Residential Land Values within Transit-Oriented Development Areas						Salsabila Panji Arum
PP2352	Tourist Trip Design Problem considering Fatigue						Taewhan KO
PP2355	A Study on the Methodology of Analyzing the Air Quality Improvement Effects of Transport Policies						Jin-seok Hahn
PP2358	Development of Tyre-Pavement Interaction Noise Prediction Models for Different Modes and Different Pavements						Anukesh CH

PP2361	Feasibility Study on Application of Particulate Filter on Engines Run with High-Sulphur Diesel			Bayarsuren Badarch
PP2380	ASSESSING SPATIAL ACCESSIBILITY TO BUS STOPS IN AN URBAN ROAD CORRIDOR USING GIS			Thakshal Bandara Ekanayake
PP2385	Economic Perspective in Railway Network Design: A Review Article			Manik Mondal
PP2401	Modeling Joint Activity-Travel Patterns in Pedestrian Networks with Possibility of Using Wi-Fi Data			William H.K. LAM
PP2473	Traffic Flow Management at Intersections to Reduce the Congestion based on Link Transmission Model			Ruotian Tang
PP2579	Vehicle Routing Model for Milk Run Delivery of Fresh Produce The Case of a 3PL Company Catering Supermarkets			Hashini Kodippili
PP2594	Comparative Study on Fuel Consumption for City Buses			Bayarsuren Badarch
PP2645	A Study on Aging and the Spatiotemporal Distribution of New Town Developments			Masataka MIYAKI
PP2658	The Effect of Underpass Construction for the Pedestrian Accessibility to Waterfront Park			Kwang-hwa Ko
	Session (slot) Name	Poster Session (3)	2019-09-10 14:00 - 17:00	Venue: LINK
Manuscript No.	Article Title			Presenter
PP2243	Income-based Fare Orientation in Urban Public Transportation Services in Developing Countries: A case study in Hanoi, Vietnam			Hong Thi Anh NGUYEN
PP2271	Estimating Heterogeneous Value of time for an Integrated Transport between Passenger and Goods: A Case study in a Japanese Rural area			Haewon Namgung
PP2292	Sustainable Public Transport planning for university campus: Assessment of Public Utility Jeepney routes inside the UP Diliman campus			sheila flor javier
PP2294	Temporal and Spatial Pattern of Shared Bike Trips --- An Empirical Study of New York City			Lei GONG
PP2364	A Measurement System of Vibration Discomfort in Cycling by using Simple Prove Bicycle with Action Camera			Takumi ASADA
PP2370	A Study on Mobility Solution of Physically Challenged People from Stakeholder's Perspective			Soumik Nafis Sadeek
PP2371	A Systemic Dispatching Process with OpenStreetMap for Improving Rehabilitation Bus Dispatching Problems			Chih-Peng Chu
PP2373	Agent Simulation for Evaluation of Reduction Measures of Urban Railway Delays with Large Passenger Demand			Wataru Kobayashi
PP2375	Analysis of Usage of Park and Bus Ride by Motorcycle in Hanoi -A Case Study of YEN NGHIA Station-			Hiroki KIKUCHI
PP2376	An Empirical Analysis on Determinants of General Trains in Korea			Dr. Jang Wook Kim
PP2387	Evaluating Pedestrian Safety at Unprotected Mid-Block Crossings Under Mixed Traffic Conditions			Avinash
PP2399	INTEGRATION OF TRANSIT DEMAND FOR BUS ROUTE DESIGN IN ULAANBAATAR			Erdenebat Batzorig
PP2402	Network Data Envelopment Analysis (NDEA)-Based Bus Route Performance Measurement: A Pilot Study			Khac-Duong Tran
PP2403	On the Transportation Factors Affecting Motion Sickness during Travel in context of Developing Countries			Soumik Nafis Sadeek
PP2404	Optimizing Bus Service based on Trip Chaining Demand Estimated by Cellular Data			Yu-Chium Chiou
PP2405	Paratransit Origin-Destination Measurement Based on Wi-Fi Scanner Survey in Makassar City, Indonesia			Arief Hidayat
PP2408	Quality of Bicycle Sharing Scheme: A Study of Obike in University Malaya Campus			Muhammad Wafi Nazri bin Ibrahim
PP2415	Online Shared Taxi as Substitute for Personal Transport in Indonesian Cities			Sudarmanto Budi Nugroho
PP2417	A Parking Study at Malabe Campus, SLIIT			B. Gihan Anuradha BOMBUWALA
PP2432	Suitability of Demolished Concrete Waste in Hot Mix Asphalt Concrete for Local Roads in Sri Lanka			Kasun Wimalasena
PP2564	Re-orientation of Para-Transit When Confronted by Mass Transit System: An approach through user's and operator's perception			N Vasudevan
PP2570	Awareness Raising and Engaging High School Students in Transforming Public Bus A case study in Semarang City, Indonesia -			Sudarmanto Budi Nugroho
PP2581	Gender influences on the perceived user satisfaction of public bus transport in Sri Lanka: Applying conjoint analysis to evaluate the relative importance of influential attributes			Ganga Nirosha Samarasekera
PP2614	Korea's Pedestrian Safety Policy, Present and Way to Better Future			Seung Kook Wu
PP2636	Analysis Of The Los Baños Transportation Network Jeepney Operations In Laguna, Philippines			Peejeh Sahagun
PP2646	Analysis of Female Students' Travel Mode Choice: A Multinomial Approach			Jyoti Mandhani
PP2656	A NEW APPROACH FOR UPGRADATION OF HEAVILY TRAFFICKED ROADS			chandana kori
PP2662	Estimation of the Economic Impact Caused by Interaction between Different Activities in HSR Corridors : An Experimental Concept for the Business Interaction and its Application			Kyungtaek Kim
PP2664	The Optimization in Operation for Intercity Wheelchair-enabled-Bus: for Transportation and Welfare Policies in Korea			Hyung Jun Kim
PP2674	Failure Rate or Saturation level? Answering a Complex Question by Reviewing Bus Rapid Transit Capacity Models			Ankit Kathuria
PP2683	RAMS for Indian SMART Cities: Worst first to Preserve first			Bhavesh Jain
PP2685	Behavior Analysis on Last One-Mile Connectivity by Providing Auto-rickshaw Feeder Service and Navigation in India			Tetsuhiro ISHIZAKA
PP2692	Clarification of the characteristics of Auto-rickshaw passengers in Ahmedabad			xin guo
PP2721	Simulating the logistics in Ulaanbaatar by the 'City Logistics' principles			Unursaikhan Dambadorj
	Session (slot) Name	Poster Session (4)	2019-09-11 09:00 - 12:00	Venue: LINK
Manuscript No.	Article Title			Presenter
PP2225	Utilization Model and Route Analysis of Motorelas in Cagayan de Oro City, Philippines			Anabel Abugaa Abuzo
PP2406	Pedestrian Crossing Behavior at Three Urban Signalized Intersections in Colombo			Niranga Amarasingha
PP2436	Analytical and micro-simulation models for investigating vehicle-class specific gap acceptance behavior at urban intersections with non-lane based traffic operations			Bhargab Maitra
PP2437	Assessing the Relationship between Perceived Waiting Time and Level of Service at Signalized Intersection under Heterogeneous Traffic Condition			DARSHANA OTHAYOTH
PP2446	Evaluation and improvement of coordinated traffic signal for one-way arterial road in urban area in Hanoi City			Hieu Van Mai
PP2449	Experience of Automatic Traffic Data Collection for Development of Adjustment Factors in Colombo Suburban			R.W. AHAMED
PP2452	Impact of the Degree of Data Aggregation on the Travel Time Measurement-based Studies			Jaehyun So
PP2455	Issues in Estimating Saturation Flow Rate at Signalized Intersections in Japan			Eri Aoyama
PP2457	Modeling Driver Acceleration Behaviour at Signalized Intersection under Mixed Traffic Environment			Satyajit Mondal
PP2465	Replicating Driving Behavior Under Heterogeneous Non-Lane-Based Traffic Environment: A Supervised Machine Learning Based Methodology			Narayana raju
PP2467	Roundabout Entry Capacity Estimation Under Heterogeneous Traffic Conditions			Asir Khan
PP2480	A Study on Foreign Drivers' Deceleration Behavior and Traffic Accident Risk in Japanese Popular Sightseeing Region			Kento Yoh
PP2484	Analysing Motorcycle Injuries using A Latent Class Binomial Logit Model			Dewa Made Priyantha Wedagama
PP2485	Analysis of Road Accident in Hanoi, Vietnam			Can Xuan VUONG
PP2489	Cause of Wrong Way Driving on Expressway by the Classification of its Pattern			Hidekatsu HAMAOKA
PP2494	Crash Severity Analysis Through Nonparametric Machine Learning Methods - A Case Study from State Highways in India			Sudipa Chatterjee
PP2495	Development of A Methodological Framework to Identify Risk of Road Traffic Crashes in Indian Metro Cities Using Police Recorded Crash Data			Dipanjan Mukherjee
PP2500	Enhancement of Road Safety in the University of the Philippines Diliman Campus through Effective Data Management			April Nadal Dela Cruz
PP2503	Evaluation of Pedestrian Satisfaction Level at Signalized intersections in Perspective of Pedestrian Fatality Risk: an Experience in Kolkata City, India			Dipanjan Mukherjee
PP2505	Factors Affecting the Severity of Accident Analysis Severities in Cold and Snowy Area by Using Ordered Probit Model			Satoshi Hyodo
PP2510	Investigating Pedestrian Perceptions towards Road Infrastructure and Facilities in Denpasar, the Capital City in Bali, using Discrete Choice Analysis			Dewa Made Priyantha Wedagama
PP2511	Investigation of Traffic Conflicts at Unsignalized Intersection for Reckoning Crash Probability Under Mixed Traffic Conditions			Ninad Gore

EASTS 2019

PP2512	Investigation on Risk Factors Influencing Crash Occurrence in Urban Context: A Case Study of Hyderabad, India	Bandhan Bandhu Majumdar
PP2518	Modeling Time-of-Day Distribution of Freeway Crash Frequency by using Functional Data Analysis	Yu-Chiun Chiou
PP2521	Safety Assessment of Urban Un-Signalized Intersections Using Conflict Analysis Technique	Dipanjan Mukherjee
PP2527	The Feasibility Study of Determining Blackspots	Bayarsaikhan Bayasgalan
PP2563	Relation between Driver's Anxiety and Unsafe Conditions - Risk Assessment of Potential Traffic Accidents –	Kaito Yoshimura
PP2567	Influencing Factors on Severity of Motorcycle Rear End Collisions in Thailand	Lahiru Welagedara
PP2589	Using Survival Theory to Investigate the Characteristics of Violation and Accident Occurrence of Motorcyclist and Car Driver	Hsin-Hsuan Wu
PP2604	Setting the Priorities for the Development of Transport Big Data Platform for Mutually Cooperative Sharing and Utilization of Data Using Delphi Method and Analytic Hierarchy Process	Jongwoo Lee
PP2609	A Trial of OD Traffic Volume Estimation through the Fusion of Various Types of Traffic Data and CO2 Emissions Estimation by Microsimulation	Keisuke YOSHIOKA
PP2650	Selection of Accident Frequency Area through Accident Cost Analysis	Jung-Beom LEE
PP2651	Freeway Traffic State Prediction Using Multi-Step Long Short-Term Memory Network	Doosun Hong
PP2652	A Development of A Deep Reinforcement Learning Based Freeway Congestion Relieving Strategy Algorithm	Dongju Ka
PP2670	Application of the Queuing Theory for Traffic Flow at Intersection in Heterogenous Traffic Condition	Masiyuddin Nasiruddin Khan
PP2691	Effectiveness of Passengers' Behaviours on Current Fare Collection Type with Dwell Time for Circular Bus Lines in CBD Area of Yangon, Myanmar	MYAT PHYO HAN
PP2718	Exploiting the potential of truck digital tachograph data	Seokjoo Lee

Manuscript No.	Session (slot) Name	Poster Session (5)	2019-09-11	14:00 - 17:00	Venue: LINK
		Article Title			Presenter
PP2193		Development of a Road Recovery Model Considering Road Usage Frequency of Emergency Paths in a Large-Scale Disaster			Jun Sakamoto
PP2203		Impacts of Transport and Land-use Adaptation Policies on Flood Risk in Middle-sized City Analyzed by System Dynamics Model: A Case Study of Ubon Ratchathani, Thailand			Hiroki KIKUCHI
PP2245		Measuring an airport transfer dependency on neighbor hubs			Yu-Chun Chang
PP2249		Preliminary Study of Acceptability of Additional Cost for Mobility Services When Using Autonomous Vehicles			Yasuhide Nishihori
PP2359		Estimation of CO2 Emission from Passenger Cars and Its Factor Decomposition: Case Study for Tokyo Metropolitan Area and Kagawa Prefecture			Masanobu Kii
PP2454		Investigating signal violations in mixed traffic in Hanoi City			Hieu Van Mai
PP2466		Research on Driver Identification Method Applying Machine Learning on Driving Behavior at Intersections			Kota Miyauchi
PP2481		A Study on Incentives to Encourage Driving License Holders to Return their Driving License			Takeshi Hirose
PP2491		Attitudes of Educational Institutes Bus Drivers: A Case of University of Nizwa in Oman			Muhammad Ashraf Javid
PP2497		Effect of Attentional Disengagement on Driver Inattention While Driving on Expressway			Hirotoishi SHIRAYANAGI
PP2507		Impact Analysis of Speed Humps on Indian Roads			Ravi Kiran Korra
PP2517		Red Light Running Violations of Four Intersections in Colombo Suburban			M. N. Mohammed Ilhaam
PP2520		Road traffic safety campaign in Ulaanbaatar			Erdenetuya Amgalan
PP2526		Survival Analysis of Accident Occurrence After Traffic Violation			Ming-Wei Chang
PP2530		Capacity Analysis of Ship Tugging Operations in A Large Container Port			Qiang Meng
PP2533		Estimation of Delay Causes of Arrival Flights Considering Delay Propagation in Japanese Domestic Air Transport Network			terumitsu hirata
PP2538		Simulation Analysis of the Conflicts among the International Departure Flights from Asian Region over Pacific Oceanic Airspace			terumitsu hirata
PP2546		Enabling Sustainable Urban Transportation in Mongolia for 2030: Policy and Institutional Perspective			Erdenechimeg Eldev-ochir
PP2549		Traffic Management during a Big Sport Event: A Case Study in Kolkata City			Bhargab Maitra
PP2554		Autonomous Vehicle as a future mode of transport in India: Analyzing the perception, opportunities and hurdles			Arnab Jana
PP2558		Impact of Ride-hailing Apps on Traditional LAMAT Services in Asian developing Cities: The Phnom Penh Case			Veng Kheang PHUN
PP2590		Comprehensive Countermeasures for the Improvement of Traffic Safety in Tunnel Areas			Seungjun Lee
PP2592		Multimodal Intercity Network Manageable on the Collected Fare --- Optimization Model Approach ---			Makoto Okumura
PP2598		A Study on the improvement of the Driving Simulation Scenario for High Risk Driver's Evaluation and Training			Seongyong PARK
PP2601		Assessing ride sharing service based on users opinion in Dhaka city			Farzana Rahman
PP2635		Development of a Route Choice Model Considering Traffic Accident Risk and the Effects of Providing Risk Information			TOMOFUMI SHIOTA
PP2653		Estimating Peak Time and Weather Effects on Taxi-hailing Service Searching Time Using Survival Model			Yeonwoo Jung
PP2654		Consciousness on Strategies and Implementation Program of Hanoi Traffic Safety Masterplan			Byung-doo JUNG
PP2661		A Study on the Improvement of Reliability of Estimated Traffic Flow Data through ADAS			Hoe Kyoung Kim
PP2681		Evaluation of Pedestrian's Perceptions on Crossing Facilities in Oman			Muhammad Ashraf Javid
PP2702		Current Situation of Bridge Management System in Thailand			Chatthep Chittayawong
PP2704		A population-based case-control study of the effect of sun glare on pedestrian fatalities in Taiwan			Shang Ku Chen

Transportation

Shuttle buses would depart from the following hotels (Hilton Colombo, Taj Samudra, Omega Regency, Jetwing Colombo Seven, Galadari, The Kingsbury, Cinnamon Lakeside) to the conference venue each morning at 7.30am. There will be conference representatives at the lobby of these hotels from 7.15am onwards next to a conference banner to help you out. Please show them a printed copy or copy on your phone of your registration sheet. If you have already paid for the conference, you will be provided a lanyard by our representative. At the conference you can directly collect the conference pack and proceed to the venue. If you haven't paid or attending as an accompanying person, you will have to proceed directly to the information desk to collect your lanyard.

There will be shuttle buses from the conference venue back to your hotels as follows:

- On Monday 9th -at 11.00am, 2.00pm and 4.00pm. For the Gala Dinner, a shuttle bus will originate from the aforesaid hotels at 5.00pm. Those who plan to join this are requested to inform the information helpline provided with the conference information pack.
- On Tuesday 10th – at 1.00 pm, 2.00 pm and 4.00 pm
- On Wednesday 11th at 1.00 pm, 2.00 pm and 4.00 pm. For those attending the Farewell Party , a shuttle bus will originate from the aforesaid hotels at 5.00pm. Those who plan to join this are requested to inform the information helpline provided

with the conference information pack.

Shuttle buses will depart back to hotels after the conference on each day.

If you miss the shuttle buses or staying at a different location, you may have to find your own way to the conference location. Uber and several other ride hailing apps are in operations in Sri Lanka (PickMe, SLT muve, etc.). It usually costs around USD 3.50 per trip on a taxi from Colombo Central Business District to the conference venue. The fare would be even cheaper if you were to use a tuk-tuk.

If you have any queries, feel free to contact the information helpline that will be provided to you with the conference information pack when you arrive at the conference venue.

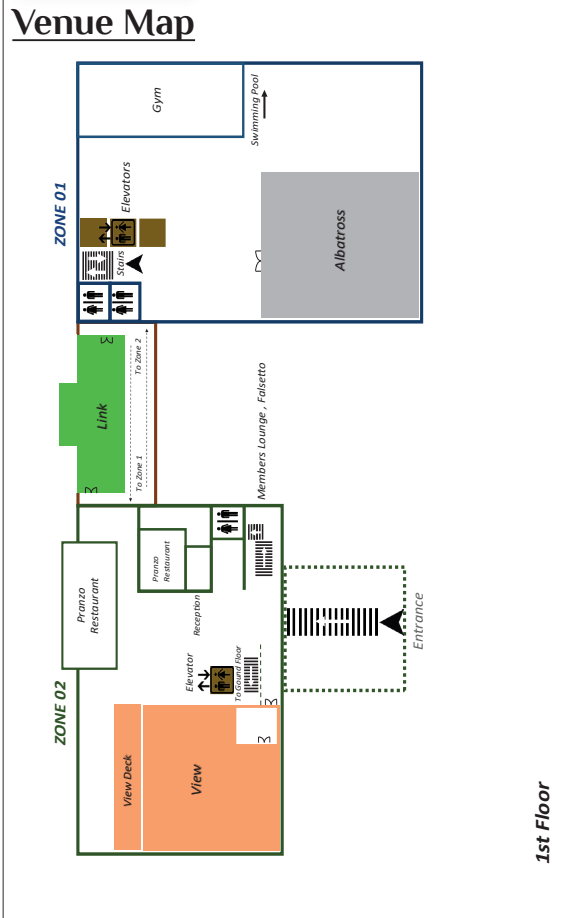

RATU 2019

EASTS 2019

1st Floor

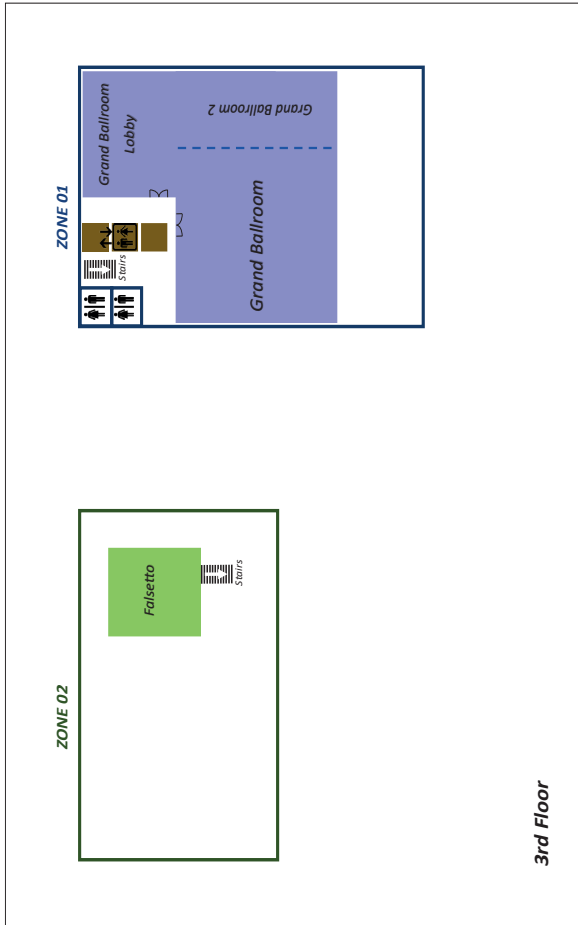

RATU 2019

EASTS 2019

3rd Floor

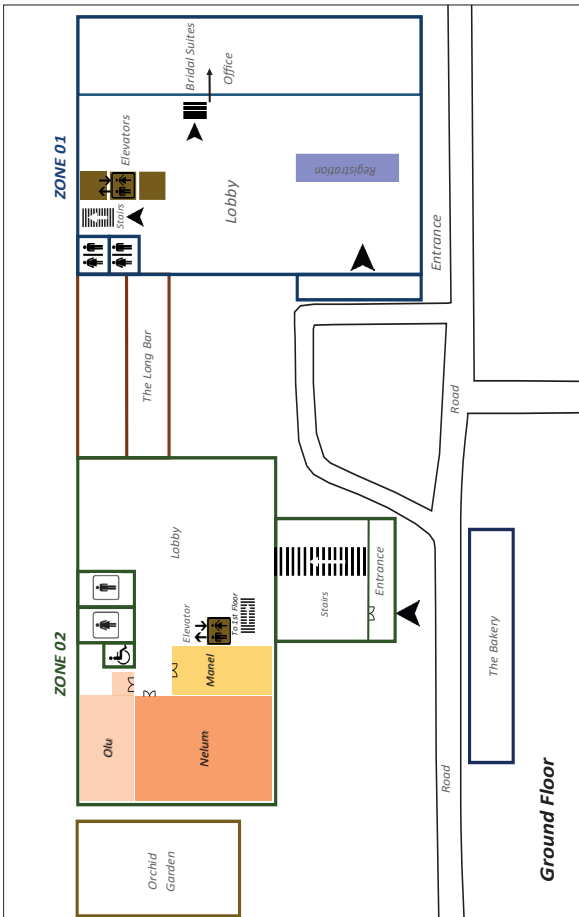

RATU 2019

EASTS 2019

Ground Floor

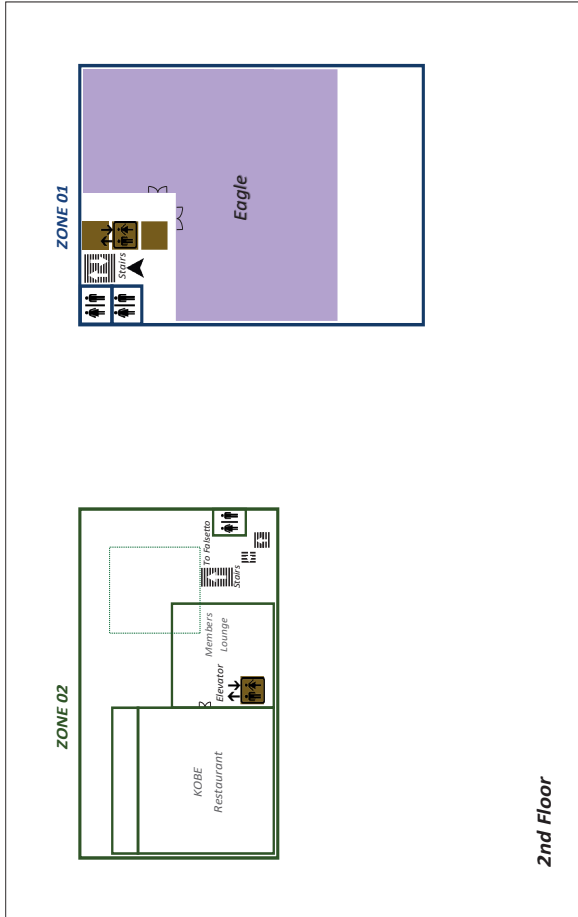

RATU 2019

EASTS 2019

2nd Floor



Technical Tours Details

EASTS 2019, Sri Lanka

www.slstl.lk/easts2019

Summary



Locations

7 Locations



Date

September 12th
Thursday

7 Technical Tours.

- Advantis 3PL Plus Logistics City, Kelaniya Distribution Center, Kelaniya
- Advantis 3PL Plus Logistics City, Advantis Logistics City, Kotugoda
- John Keells Logistics 3PL Facility, Seeduwa
- LAUGFS Terminals, Hambantota
- Port of Colombo
- Spectra Depot Facility, Welisara
- Outer Circular Highway Project - Phase 3



Summary of Technical Tours

7 Technical Tours have been organized by the conference committee of EASTS, 2019. The 7 locations consists of Sri Lanka's leading transport and logistics service providers. Out of the 7 technical tours, conference participants can choose any one as their preference. There are capacity constraint for each facility visit. Therefore, the allocation of persons for each technical tour will be based on first come, first serve basis.

[Click here to register for the technical tours](#)



1. Advantis 3PL Plus Logistics City, Kelaniya Distribution Center, Kelaniya



Location

408A,
Nungamugoda,
Kelaniya.

[Visit Location on Google maps](#)



Maximum Persons Allocated

30

Tour Schedule

- 0900Hrs – Depart Colombo
- 0945Hrs – Arrive at the Facility
- 1130Hrs – Proceed to the Kelaniya Temple
- 1145Hrs – Arrive and Visit the Temple
- 1230Hrs – Proceed to Colombo
- 1330Hrs – Drop-off

[Visit Kelaniya Temple Website for more details](#)



Summary of the Facility

As a leading logistical services provider Advantis 3PL Plus established itself as one of the largest corporates to offer logistics in Sri Lanka with a presence spread across South Asia, we are well positioned to cater to all the logistics needs. Kelaniya Distribution Center offers third party logistics and Warehousing services.

[Visit Advantis Website for more details](#)



2. Advantis 3PL Plus Logistics City, Advantis Logistics City, Kotugoda



Location

193, Minuwangoda Road, Kotugoda.

[Visit Location on Google maps](#)



Maximum Persons Allocated

30

Tour Schedule

0900Hrs – Depart Colombo
 1000Hrs – Arrive at the Facility
 1130Hrs – Proceed to the Kelaniya Temple
 1215Hrs – Arrive and Visit the Temple
 1300Hrs – Proceed to Colombo
 1330Hrs – Drop-off

[Visit Kelaniya Temple Website for more details](#)



Summary of the Facility

Leading logistical services provider Advantis 3PL Plus expanded their operations by Opening the Advantis 3PL Plus Logistics city at Kotugoda, Sri Lanka in December 2018. This 330,000 sqft. facility counts as Sri Lanka's largest warehouse with 38,000 pallets positions which will hold upto 55,000 CBM with the operation capacity of 75 docks, in the 1st phase would be leveraged to suite of best-in-class technologies and product handling methods with focus on automation and digitization. With the completion of phase 2 of the Advantis 3PL Plus Logistics City the facility would have 500,000 sqft. The new Logistics city is designed to cater to any Industry vertical, and serve as a logistics hub meeting the fast-changing needs of brands and retailers across the globe.

[Visit Advantis Website for more details](#)



3. John Keells Logistics 3PL Facility, Seeduwa



Location

Seeduwa Rd, Negombo

[Visit Location on Google maps](#)



Maximum Persons Allocated

40

Tour Schedule

0900Hrs – Depart Colombo
 1000Hrs – Arrive at the Facility
 1130Hrs – Proceed to the Kelaniya Temple
 1215Hrs – Arrive and Visit the Temple
 1300Hrs – Proceed to Colombo
 1330Hrs – Drop-off

[Visit Kelaniya Temple Website for more details](#)



Summary of the Facility

John Keells Logistics (JKLL) is a premier 3PL solutions provider with service expertise spanning across multiple industry verticals. With several state-of-the-art logistic centers located within proximity to major highways, industrial parks, city centers and ports; complimented with an extensive fleet of transport vehicles.

Seeduwa Facility is a 70,000 sqfts facility with Supported by modern Warehouse & Transportation management systems, paperless RDT infrastructure and cutting edge digitization solutions, we are able to service logistics needs of our clients under one roof; using the most cost effective, transparent and operationally efficient processes & system which cater for Lubricants, Chemicals and Apparels. [Visit JKLL Website for more details](#)



4. LAUGFS Terminals, Hambantota



Location

Karagan Lewaya, Hambantota

[Visit Location on Google maps](#)



Maximum Persons Allocated

40

Tour Schedule

0600Hrs – Depart Colombo (with self-provided, packed breakfast from respective hotels)
 1100Hrs – Arrive at the Facility
 1300Hrs – Lunch at Red Beach Cafe, Tangalle at a cost of USD 15 per person (approx.) (self-provided)
 1430Hrs – Proceed to Galle
 1700Hrs – Arrive and Walking Tour
 1800Hrs – Proceed to Colombo
 2000Hrs – Drop-off

[TripAdvisor Review on Red Beach Cafe](#)



Summary of the Facility

LAUGFS Terminals Ltd. owns and operates the largest LPG Transshipment Terminal in South Asia with a 30,000 MT storage facility located at Hambantota International Port. With plans underway for capacity to be extended to 45,000MT, the state-of-the-art LPG terminal will support LAUGFS's rapid expansion plans to become an integrated regional LPG player in the Indian Ocean Rim area.

Hambantota port has dedicated two jetties for oil, gas and petroleum business. LAUGFS' storage facility is located 3 km from the jetty connected by a pipeline. LAUGFS Hambantota facility can receive and store refrigerated propane and butane separately or in mixed form, via very large gas carriers and pressurized vessels. [Visit Laugfs Gas Website for more details](#)



5. Port of Colombo



Location

19, Chaithya Rd, Colombo 01

[Visit Location on Google maps](#)



Maximum Persons Allocated

45

Tour Schedule

0900Hrs – Depart Colombo
 0930Hrs – Arrive at the Facility
 1100Hrs – Exit Port & Drive Around the City of Colombo
 1200Hrs – Visit Asokaramaya Buddhist Temple
 1300Hrs – Proceed to Drop-off Point
 1330Hrs – Drop-off

[TripAdvisor Review on Asokaramaya Temple](#)

Summary of the Facility

Considered the largest and busiest port of Sri Lanka as well as in South Asia, the Port of Colombo in Sri Lanka serves as an important terminal in Asia due to its strategic location in the Indian Ocean.

The Colombo Port is primarily a container port. In 2018, it handled about 7 million TEU of containerized cargo. In addition to containers the port handles dry and liquid bulk, liquefied gas, Ro-Ro, passengers, steel and breakbulk cargo. There are also shipyard facilities for military vessels.

[Visit Port of Colombo Website for more details](#)

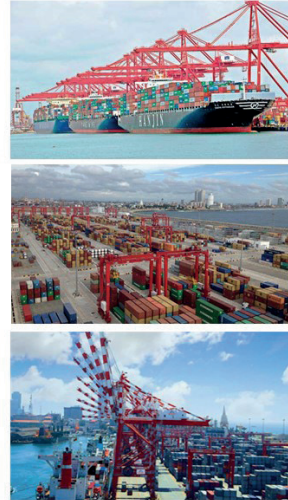

6. Spectra Depot Facility, Welisara



Location

No. 3001/MU125, Muthurajawela Industrial Zone, Welisara.

[Visit Location on Google maps](#)



Maximum Persons Allocated

90

Tour Schedule

0900Hrs – Depart Colombo
 1000Hrs – Arrive at the Facility
 1130Hrs – Proceed to the Kelaniya Temple
 1215Hrs – Arrive and Visit the Temple
 1300Hrs – Proceed to Colombo
 1330Hrs – Drop-off

[Visit Kelaniya Temple Website for more details](#)

Summary of the Facility

Spectra Logistics (Pvt) Ltd (“Spectra”) is a joint venture between Hemas Transportation and GAC Logistics. The partnership brings together two well-established companies with extensive track record in providing and managing a diverse and comprehensive range of logistics & supply chain related services in Sri Lanka and many parts of the world.

Spectra Depot Facility in Welisara consists of a storage capacity of 5500 TEUs with 9 acres. It has 3 container handlers with 7 high stacking and one 45 Tonne reach stacker. The facility also has a fully automated water purification plant. Furthermore, a fully equipped repair facility is there along with 50 Supply points being available for PTI or Laden Reefer Container storage.

[Visit Spectra Logistics Website for more details](#)



7. Outer Circular Highway Project - Phase 3



Location

Kerawalapitiya & Kadawatha Interchanges

[Visit Location on Google maps](#)



Maximum Persons Allocated

60

Tour Schedule

0900Hrs - Depart Colombo
 0945Hrs - Arrive at the Kerawalapitiya Interchange, Visit & Proceed to the Kadawatha Interchange
 1130Hrs - Proceed to the Kelaniya Temple
 1145Hrs - Arrive and Visit the Temple
 1230Hrs - Proceed to Colombo
 1330Hrs - Drop-off

[Visit Kelaniya Temple Website for more details](#)

Summary of the Facility

Outer Circular Highway Project - Phase 3 is an express way construction project funded by EXIM Bank of China & the government of Sri Lanka. The total length is 9.63 km and the road width is 24.5 m. The project commenced in January, 2016 and expected to be finished in December, 2019. The technical tour includes two interchanges, Kerawalapitiya and Kadawatha.

[Visit Road Development Authority website for more details](#)



EASTS 2019

Sri Lanka Society of Transport and Logistics (SLSTL)

The SLSTL was formed in 2014 as a network of those who have obtained post graduate research degrees in transport and logistics and are actively engaged in professional and research work in the respective areas of specialization. It currently has a membership of 60 and has, from its inception held the annual Research for Transport and Logistics Industry (R4TLI) conference, to which researchers from other EASTS member countries are invited. This year, SLSTL hopes to publish a journal titled “The Journal of South Asian Logistics and Transport (J-SALT)”. The SLSTL is also engaged in running seminars on important topics, as well as promoting best practices in transport.

Notes

We Plan and Lead Development of Sri Lanka and the World

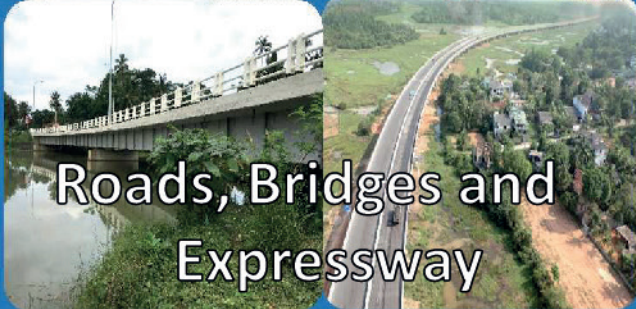

Roads, Bridges and Expressway

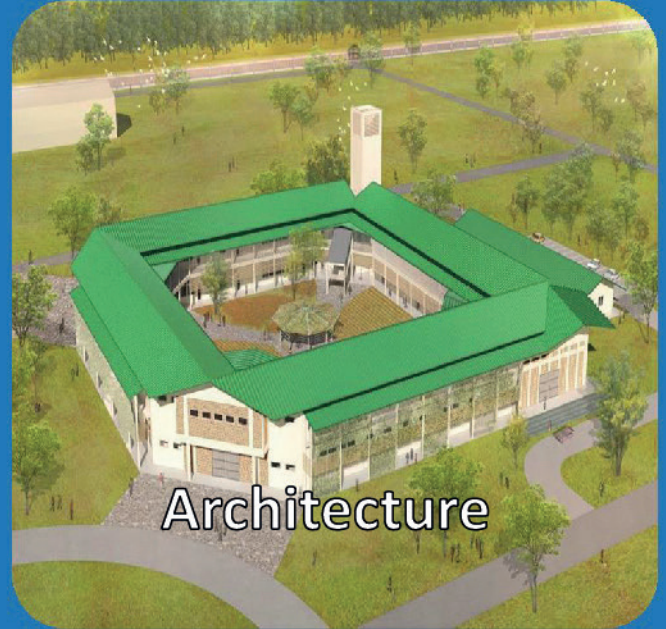

Architecture



Disaster Recovery and Resilience



Public Transport (Urban/National Railway, MMC)

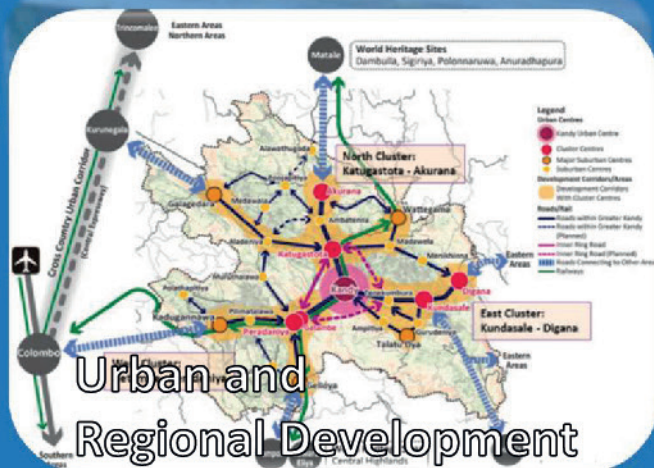

Urban and Regional Development



Agriculture and Forestry

Full service across a wide range of sectors. For more detail, visit our website, www.ocglobal.jp



ORIENTAL CONSULTANTS GLOBAL
Global Consulting for Sustainable Development



SRI LANKA
CONVENTION BUREAU



ORIENTAL CONSULTANTS GLOBAL

Silver Sponsor



CINEC
CAMPUS

Exclusive Research Partner

You're our world



Official Airline Partner

Jetwing
EVENTS
SRI LANKA

Logistics Partner



Audio Visual Partner