

8-17-2017

NEBRASKA STATE DATA CENTER – 28th Annual Data Users Conference: Schedule

Nebraska State Data Center

Follow this and additional works at: https://digitalcommons.unomaha.edu/datausers_reference_2017

NEBRASKA STATE DATA CENTER – 28th Annual Data Users Conference
August 16, 2017: CPACS Building – University of Nebraska at Omaha Dodge Campus

7:30 a.m.	REGISTRATION		Entrance
8:30 a.m.	WELCOME	<i>Jerry Deichert and David Drozd</i> Center for Public Affairs Research, UNO	Auditorium Room 101
9:00 a.m. Concurrent Sessions	Social Determinants of Health and Health Data Panel	<i>Carol Gilbert (CityMatCH), Athena Ramos (UNMC), Tom Rauner (Dept. of Health/Human Services), David Drozd</i>	Commons 132 and 132D
	Census Overview: Basics, ACS, and Estimates	<i>Jerry Deichert</i> Center for Public Affairs Research, UNO	Auditorium Room 101
	Intermediate FactFinder Computer Training (30 people)	<i>David Schuler</i> U.S. Census Bureau (Chicago)	Room 126
10:00 p.m.	BREAK		
10:15 a.m. Plenary Session	Census Product and 2020 Census Update	<i>Dominic Beamer (Census Bureau–DC), Blanca Ramirez-Salazar and Jim Castagneri (Census Bureau–Denver), David Schuler</i>	Auditorium Room 101
	Local Employment Dynamics and Job-to-Job Explorer	<i>Earlene Dowell</i> U.S. Census Bureau (Washington, DC)	
Noon Lunch with facilitated discussions	Informal Networking Lunch	<i>Robert Blair, UNO facilitates</i>	Commons 132
	Crime Data & Criminal Justice	<i>Maja Kotlaja, UNO</i>	Room 117
	2020 Census Partnerships	<i>Blanca Ramirez-Salazar, Census Bureau</i>	Room 121
	Local Update of Census Addresses (LUCA)	<i>Jim Castagneri, Census Bureau</i>	Room 125
	Poverty-what do we do about it?	<i>Cliff Holley, University of Mississippi</i>	Room 222
	Poverty-what is it?	<i>Jerry Deichert, UNO</i>	Room 223
1:00 p.m. Concurrent Sessions	Demographics 101 and Applied Demography	<i>Cliff Holley</i> Center for Population Studies (University, MS)	Auditorium Room 101
	Local Employment Dynamics Computer Training (30 people)	<i>Earlene Dowell</i> U.S. Census Bureau (Washington, DC)	Room 126
2:00 p.m.	BREAK		
2:15 p.m. Concurrent Sessions	Trends and Factors Affecting Housing Panel Discussion	<i>David Drozd, Randy Cantrell (Rural Futures Institute), Willie Barney (The Empowerment Network)</i>	Commons 132 and 132D
	ACS Select Population Profiles and Analyzing Data by Race	<i>Lissette Aliaga-Linares</i> CPAR and Department of Sociology, UNO	Auditorium Room 101
	Basic/Beginner FactFinder Computer Training (30 people)	<i>David Schuler</i> U.S. Census Bureau (Chicago)	Room 126
3:15 p.m.	BREAK		
3:30 p.m. Final Sessions	State/Local Population Trends: Data Visualization Focus	<i>Jerry Deichert and David Drozd</i> Center for Public Affairs Research, UNO	Auditorium Room 101
	Visualizing Data with Tableau Computer Training (30 people)	<i>Melanie Kiper</i> Center for Public Affairs Research, UNO	Room 126

North Entrance into the CPACS building

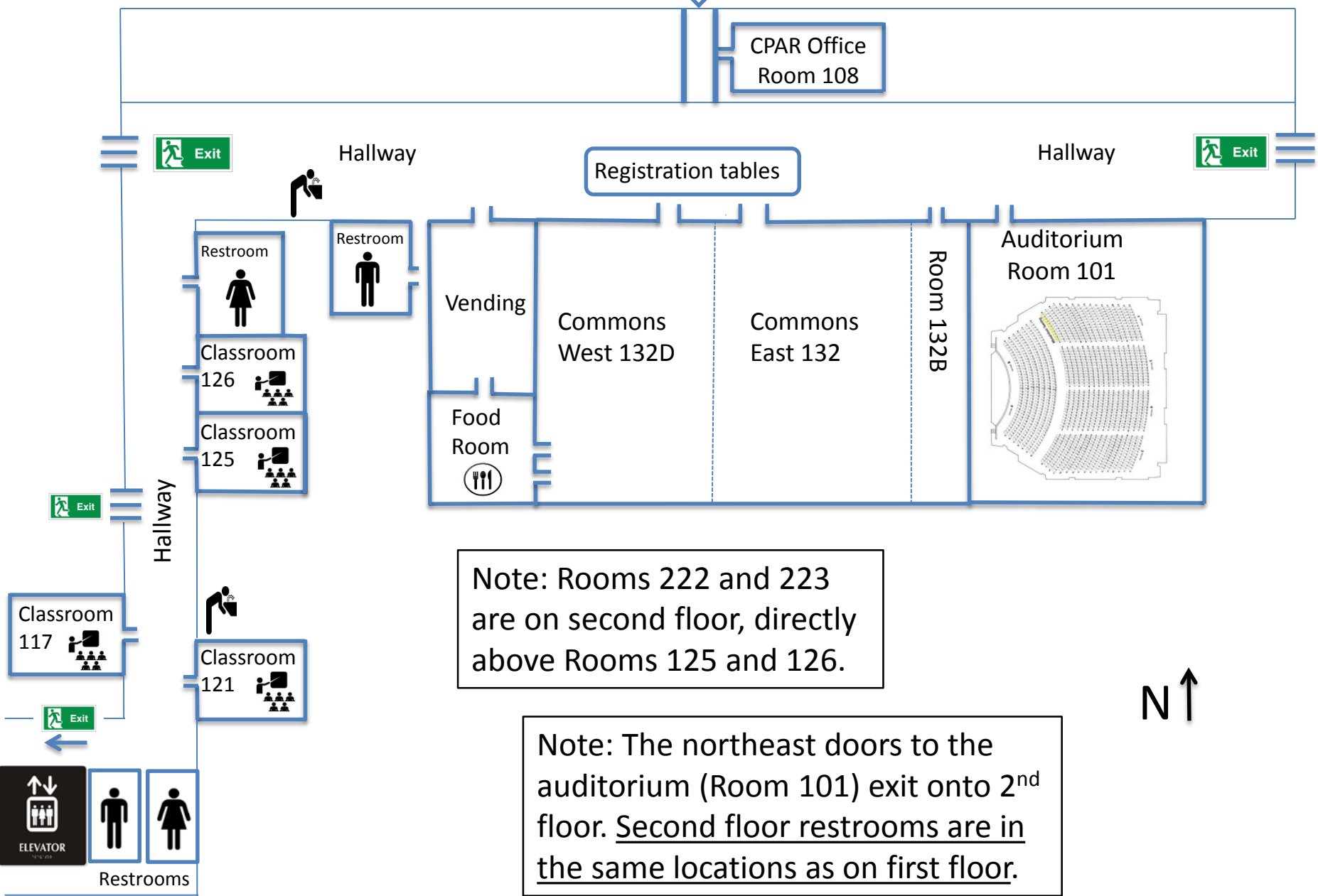

Note: Rooms 222 and 223 are on second floor, directly above Rooms 125 and 126.

Note: The northeast doors to the auditorium (Room 101) exit onto 2nd floor. Second floor restrooms are in the same locations as on first floor.

2017 Nebraska Data Users Conference Session Descriptions

- A. sessions are considered advanced or specialized sessions.
- B. sessions are considered basic/beginner sessions.
- C. sessions are hands-on computer training sessions (30 seats: must have ticket to attend).

9:00 A.M. Concurrent Sessions

A. Social Determinants of Health and Health Data Panel – A newer and expanding area of research is how socio-economic characteristics like income and education levels influence health outcomes. It has been said that your zip code is more important to your well-being than your genetic code. Local and national studies have shown correlations between higher poverty leading to lower life expectancy. Hear a panel of experts describe the health data of interest and how Census data tie into this important field of study.

B. Census Overview: Basics, American Community Survey, and Estimates – Unfamiliar with Census data or first time attending the conference? No problem – start your day with this session designed for beginners or as a refresher to bring you up to speed. We will cover census concepts such as race versus ethnicity, geographic types, when to use data from each major census program, data accuracy versus timeliness tradeoffs, various data products designed to meet specific needs, and how population estimates are valuable now that we're moving further away from the 2010 Census year.

C. Intermediate Level FactFinder Computer Training [limited to 30 people who pre-registered]

10:15 A.M. Plenary Sessions

Census Data Product & 2020 Update / Local Employment Dynamics – All attend this session.

Noon Lunch Discussions

A. 2020 Census Partnerships – The 2020 Census is a major effort that requires all households to participate. However, some are hesitant or unwilling to return their form or fill it out online. Partnerships and trusted voices are needed to ease any fears and motivate people to respond, especially for “hard to count” groups such as new immigrants, refugees, those with low incomes, and those with language difficulties. Discuss ways we can work together, leverage local resources, and create a positive buzz about the census that will rightfully count every local resident. Facilitated by Blanca Ramirez-Salazar, Denver Regional Census Office.

B. Crime Data and Criminal Justice – Crime data are somewhat outside the purview of the Census Bureau, but they are key to neighborhood stability and safety. See FBI-based trends in crime statistics, which may differ overall from specific events that are covered in depth by the news. Learn about statistics kept by local police departments and put in your two cents on the criminal justice topic and what is effective in fighting crime. Facilitated by Maja Kotlaja, UNO School of Criminology and Criminal Justice.

C. Local Update of Census Addresses (LUCA) Discussion – LUCA is an important program that aids localities in achieving their best census count possible. Local address lists including new developments of streets and housing are often more update-to-date than the Census Master Address File. By comparing local records to the master file appropriate additions or deletions can be made. If you're in city government, especially planning or building departments, we encourage you to come to this discussion and participate in this program, as well as the Boundary and Annexation Survey that Jim will describe. Facilitated by Jim Castagneri, Denver Regional Census Office.

D. Fighting Poverty and Building Wealth – Even as the economy has rebounded after the recession, poverty levels have remained stubbornly high. Discuss the factors impacting poverty and what can be done to improve socio-economic status. Moving beyond poverty and becoming homeowners or attaining other assets will be a topic in the conversation. Facilitated by Jerry Deichert, University of Nebraska Omaha and Cliff Holley, University of Mississippi.

E. Informal Networking Lunch. Facilitated by Robert Blair, UNO School of Public Administration.

1:00 P.M. Concurrent Sessions

A & B. Demographics 101 and Applied Demography – While the Census Bureau provides a wealth of demographic data, do we always know what it means or how to best utilize it? This session will emphasize basic and focused areas of analysis on items like aging, disparities by race and ethnicity, how homeownership impacts neighborhood characteristics, and how household formation and relationships are changing. Come to this session to gain the tools you need to analyze simple and complex demographic changes that are effecting the work you do or the populations you serve.

C. Local Employment Dynamics Computer Training [limited to 30 people who pre-registered]

2:15 P.M. Concurrent Sessions

A. Trends and Factors Affecting Housing Panel Discussion – The housing market has come back with a vengeance in metro parts of Nebraska. Demographics play an important part in the reason why. This session will discuss the consumer lifecycle and how renting and rental unit construction boomed since the economic downturn as the large segment of millennials were at ages where people are most apt to rent. Now millennials are pushing into ages where marriage and children lead to home ownership, which will support the housing market as demand increases. Our panelists will discuss these and other factors that impact housing in both urban and rural parts of the state, including how to use data to frame a development or redevelopment project, and the challenges in nonmetro areas regarding the age and quality of housing stock.

B. ACS Select Population Profiles and Analyzing Data by Race – In 2011 the Census Bureau released a special set of tabulations that showed common statistics by race and ethnicity, ancestry, and country of birth for the 2006-2010 timeframe. This special product provided more detail than was available otherwise. For example, standard tables often only list a category for “Subsaharan African” but these tables listed figures specifically for those from the country of Somalia or listing a Sudanese ancestry. The Census Bureau plans to release updated tabulations for the 2011-2015 timeframe over the summer. Learn about how to access and utilize these powerful tables that provide information you won’t find elsewhere. Initial findings and other aspects of how to best analyze figures by race will be discussed.

C. Basic/Beginner Level FactFinder Computer Training [limited to 30 people who pre-registered]

3:30 P.M. Concurrent Session

A & B. Nebraska State and Local Population Trends – A final popular session will present the latest population trends and quantify changes over time. How the population is aging and becoming more diverse will be covered. Find out which counties and cities are gaining population at the fastest rates since 2010. A special focus will be given to options groups have when displaying data, and why we display data with specific types of graphs or tables to “tell the story” to an audience.

C. Visualizing Data using Tableau Computer Training [limited to 30 people who pre-registered]