

RESEARCH

Open Access



Open source 3D printable replacement parts for the WHO insecticide susceptibility bioassay system

Sean Tomlinson^{1*}, Henrietta Carrington Yates¹, Ambrose Oruni^{1,2}, Harun Njoroge^{1,3}, David Weetman¹, Martin J. Donnelly¹ and Arjen E Van't Hof¹

Abstract

Background: Malaria vector control and research rely heavily on monitoring mosquito populations for the development of resistance to public health insecticides. One standard method for determining resistance in adult mosquito populations is the World Health Organization test (WHO bioassay). The WHO bioassay kit consists of several acrylic pieces that are assembled into a unit. Parts of the kit commonly break, reducing the capacity of insectaries to carry out resistance profiling. Since there is at present only a single supplier for the test kits, replacement parts can be hard to procure in a timely fashion.

Methods: Using computer-aided design software and widely available polylactic acid (PLA) filament as a printing material, we 3D designed and printed replacement parts for the WHO bioassay system. We conducted a comparison experiment between original WHO bioassay kits and 3D printed kits to assess congruence between results. The comparison experiment was performed on two Kenyan laboratory strains of *Anopheles gambiae* (s.s.), Kilifi and Mbita. Student's t-tests were used to assess significant differences between tube types. Finally, we exposed the PLA filament to common solutions used with the bioassay kit.

Results: We were able to design and print functional replacements for each piece of the WHO bioassay kit. Replacement parts are functionally identical to and interchangeable with original WHO bioassay parts. We note no significant difference in mortality results obtained from PLA printed tubes and WHO acrylic tubes. Additionally, we observed no degradation of PLA in response to prolonged exposure times of commonly used cleaning solutions.

Conclusions: Our designs can be used to produce replacement parts for the WHO bioassay kit in any facility with a 3D printer, which are becoming increasingly widespread. 3D printing technologies can affordably and rapidly address equipment shortages and be used to develop bespoke equipment in laboratories.

Keywords: 3D printing, WHO bioassay, Mosquito profiling, Insecticide resistance

Background

Malaria remains a critical public health problem across sub-Saharan Africa, with vector control—a vital part of efforts to control and eradicate malaria—relying heavily on efficacious insecticides [1]. Widespread and emerging resistance poses a significant threat to public health

and is reflected by increased efforts to understand and characterize the distribution of resistant mosquito populations and associated genetic variants across endemic regions of Africa [2, 3].

The World Health Organization insecticide susceptibility test (WHO bioassay) is a standard method implemented to assess resistance in adult mosquito populations. During this test, mosquitoes are held in one of two tubes (Fig. 1a), either lined with untreated paper (control) or insecticide-impregnated paper (exposure) held in place with spring clips (Fig. 1c). Both tubes are

*Correspondence: sean.tomlinson@lstm.ac.uk

¹ Department of Vector Biology, Liverpool School of Tropical Medicine, Liverpool, UK

Full list of author information is available at the end of the article



separated by a slide unit (Fig. 1e) and slide (Fig. 1f), while the ends of the tubes are capped with a screen mesh (Fig. 1b) and a screw cap (Fig. 1a). Mosquitoes are held in the insecticide tube for one hour, and the percentage mortality of exposed mosquitoes 24 hours post-exposure is a measurement for insecticide susceptibility [4]. A single experimental unit for the WHO bioassay kit is comprised of two mesh screens, two screw caps, two tubes, four spring clips, one slide unit, one slide (Fig. 1).

Certain parts of the WHO bioassay kit are more liable to become worn, damaged or lost, causing a reduced capacity of insectaries to conduct bioassays. Most notably, in our experience, the mesh screen can become easily lost or damaged during cleaning. The slide unit is subject to friction from the slide and when combined with the gradual weakening of the chemical bond through repeated uses and washes, frequently splits. Spring clips are often lost during washing procedures. Test kit distribution is coordinated by the Vector Control Research Unit, Universiti Sains Malaysia, Penang, Malaysia. A single kit costs US\$78 at the time of publication. Long shipping times and associated costs mean that replacing lost or damaged parts can become economically or logistically unviable. To address these problems, we used computer-aided design software to produce 3D printable versions of the parts that comprise the WHO bioassay kit.

Accurate, reliable and affordable (US\$200–1000) 3D printing technologies are now commercially available. The most common 3D printer form utilizes a Cartesian axis system to control the deposition of molten plastic filament onto a print surface, in a process called fused filament fabrication (FFF). Many different plastics and materials can be used for 3D printing, such as polylactic acid (PLA), acrylonitrile butadiene styrene (ABS), nylon, polyethylene terephthalate glycol (PET-G) and polycarbonate. PLA is an easy plastic to 3D print, is widely available and is suitable for use in most laboratory plastic equipment. Indeed, 3D printing technologies are increasingly being used in research settings [5]. The glass transition temperature of PLA is 60–65 °C with a melting temperature of ~180 °C, meaning in cold or low-temperature settings PLA is thermally stable.

Here, we present 3D printable replacement parts for the WHO bioassay kit which print without the need for tools or glue, and which interface with existing WHO bioassay parts. We discuss the design challenges, modifications from existing WHO bioassay kits and files needed to print replacement parts for the WHO bioassay kit.

Methods

Designing 3D models

We used SketchUp (Trimble Inc., Sunnyvale CA, USA, free for a personal license, US\$55/year for Education

Licence) and OpenSCAD (Marius Kintel, Openscad.org, Toronto, Canada, free) to create the 3D model files in the stereolithography (STL) format needed to enable 3D printing of parts. Some parts were technically difficult or impossible to directly replicate using current FFF 3D-printing. In these cases, we modified the existing design to allow printing, while retaining the same physical function.

Support material is plastic printed alongside the desired part to prevent necessary plastic overhangs from dropping below their intended position. This support material is printed in such a way that it is easily detached from the finished piece; however, its inclusion leads to longer print times and higher plastic consumption. Around the circumference of the tube, two rims are present to provide a positive stop for when the tubes are fully inserted into the slide unit. On the original WHO bioassay tube, these rims are squared on the edges, replicating this feature would require support material during printing. To reduce print time, plastic consumption and potential interference with tube threads, the outer geometry of the rim was changed to triangular. This geometry can be printed without any lower support while retaining the function of the original part.

The slide unit has an internal section into which the slide sits. This geometry is complex; indeed, the original part is manufactured in two halves and chemically bonded together. The concept for this project required that the entire system be 3D printable, to increase accessibility and use. To be practically printable, this part needed adapting for 3D printing. Like the WHO bioassay slide unit, we created two halves and developed a method of bonding the pieces together. We designed a sliding clip method of joining two screw flanges of the slide unit. Two halves of the slide unit are printed with the addition of arrow-like notches on each side; these interface with a sliding lock clip that mechanically locks the two halves together and creates a gap for the gate to slide through (Fig. 1g, h and i).

On the inside of the slide unit are two friction nodules (Fig. 1h) that retain the slide in either the closed or open position, preventing the slide from falling out of the slide unit during handling. To address this, we designed the whole slide unit to include front clips that retain the friction nodules. These changes now necessitate some assembly of the slide unit once printed. However, the slide unit has been designed to allow hand-assembly without the need for tools. Despite the changes to this part of the WHO bioassay kit and the increase in physical size, the mechanical function remains the same.

The mesh screen used at the end of the tubes is manufactured from a flexible material that allows it to have no border. In our prototyping, we found that printed mesh

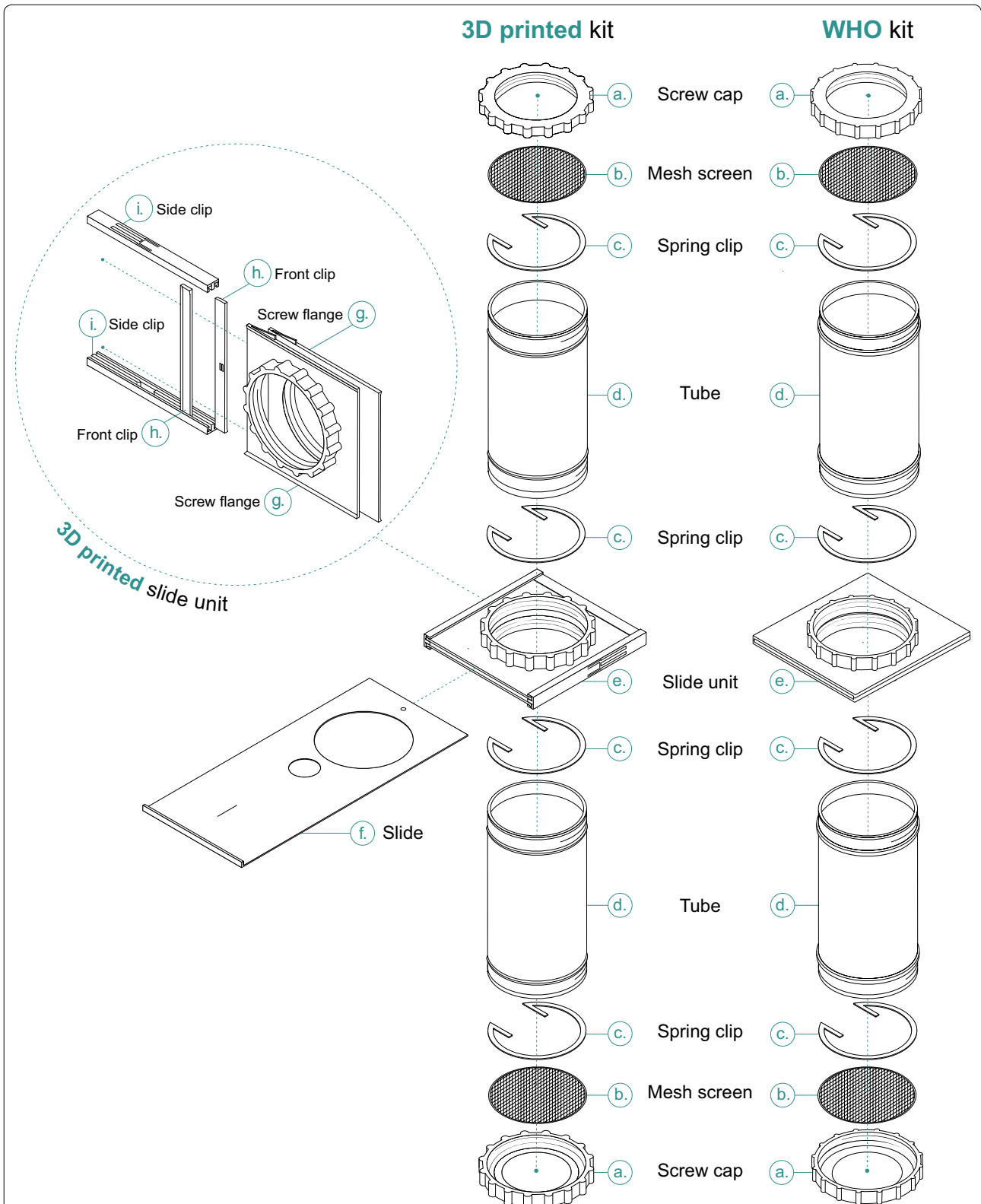

Fig. 1 World Health Organisation bioassay kit and equivalent 3D printed parts. Cutaway shows the assembly of the 3D printed version of the slide unit. For illustration purposes, the WHO bioassay slide has been omitted but is visually identical to f



Fig. 2 Photograph of WHO bioassay parts (left) and equivalent 3D printed parts (right). E and H are used to denote the exposure and holding sides, respectively, whereas on the WHO bioassay parts red and green dots/lines are used

screens were too weak to be handled when printed without a border. Therefore, a 3 mm border was added to the CAD version of the mesh; this does not extend past the lip of the screw cap, retaining the same function as the original.

3D printing

3D printing was carried out on an Original Prusa i3 MK3 and an MK3S (Prusa Research, Prague, Czechia, £699) modified with a BuildTak print surface (<https://www.buildtak.eu/>), using white 1.75 mm PLA filament (ZIRO3D, Shenzhen, China, £14.99/kg). Designed CAD models were exported as STL files. STL files must be converted to machine instructions following the G-code standard to be processed by 3D printers. This conversion process is called slicing. The STL model files were sliced using Cura 3.3.1 (Ultimaker, Utrecht, The Netherlands) with the following key slicer settings: 100% infill, two shells/perimeters, 0.15 mm layer height.

Reliably and efficiently 3D printing transparent objects is technically difficult with commercially available 3D printers and typically results in a cloudy translucent finish. During prototyping, we identified that bright white filament, though not transparent, provides enough contrast for mosquitoes to be easily counted while viewing through the mesh screen. Commercially available WHO bioassay tubes use a green and red dot to denote both the holding and exposure side of the bioassay kit, respectively. We used a permanent marker to label the corresponding printed parts with an 'E' (exposure) and 'H' (holding) (Fig. 2).

Bioassay testing

To ensure that the 3D printed tubes performed in a similar manner to the acrylic tubes we performed susceptibility testing using standard 4% WHO diagnostic dose of dichlorodiphenyltrichloroethane (DDT) insecticide on two Kenyan laboratory strains of *Anopheles gambiae* (*s.s.*) (Kilifi and Mbita). DDT was chosen to match specimen availability. Kilifi and Mbita samples were freely available at the time of experiments. These strains are partially resistant to DDT, meaning we expect to see mortality less than 100%, allowing clear observation of the effect of PLA on mosquito mortality, if any individual tube had a mortality of 100%.

Batches of ~25 3–5-day-old female mosquitoes, were exposed in each tube. The number of replicate exposures was as follows: Kilifi WHO tubes ($n=10$), Kilifi 3D tubes ($n=11$), Mbita WHO tubes ($n=7$), Mbita 3D tubes ($n=7$). Exposures were carried out in tandem for both 3D printed and WHO bioassay kits. The total number of exposures were performed over separate days to allow adult females to reach the correct age for exposure. Each exposure tube was paired with a corresponding (3D printed or WHO) control tube. WHO guidelines require at least four replicates; specimen availability allowed us to exceed this minimum. Percentage mortality was recorded after a holding period of 24-hours. We used a Student's t-test to compare the mean between standard WHO tubes and 3D printed tubes. All graphic visualizations and statistical analyses were performed using R, data and R code for analyses and figure generation are provided (Additional file 1: Table S1; Additional file 2: Text S1).

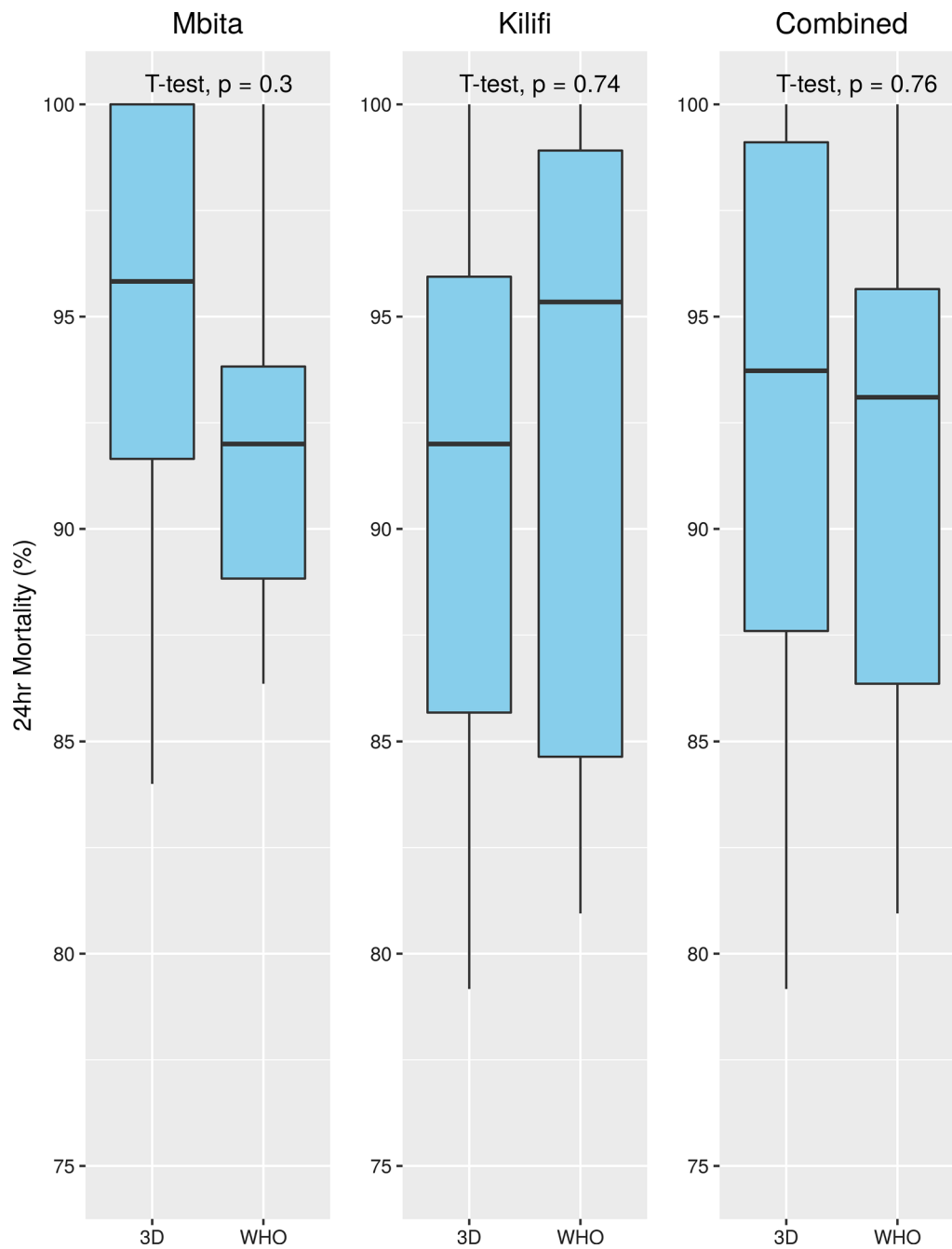

Fig. 3 Bioassay results comparing mortality between the WHO bioassay kit and 3D printed kit for Mbita, Kilifi and their combined results. A Student's t-test was used to compare means for each test. Kilifi WHO tubes ($n = 10$); Kilifi 3D tubes ($n = 11$), Mbita WHO tubes ($n = 7$), Mbita 3D tubes ($n = 7$). Each tube contained ~25 3–5-day-old female mosquitoes

An additional experiment to assess insecticide retention and absorption into PLA was performed. The Kisumu strain of mosquito are susceptible to DDT, therefore we exposed ~25 3–5-day-old female Kisumu mosquitoes to cleaned WHO and 3D printed tubes that previously held 4% DDT for a standard exposure. This experiment was performed in triplicate for both WHO bioassay tubes and 3D printed

tubes. Mortality was recorded at 1-hour and mosquitoes were moved to a paper holding cup. The mosquitoes were fed on sugar and the 24-hour mortality was recorded.

Mosquito rearing was conducted at the Liverpool School of Tropical Medicine insectaries, following standard operating procedures. The Mbita strain was collected at Mbita Point, Kenya in 1999, and has been maintained

as a laboratory strain since this time. The Kilifi strain was collected in Kilifi County, Kenya in 2012. The colony is maintained by both the Liverpool School of Tropical Medicine and Kenya Medical Research Institute.

PLA reactivity with bioassay solutions

To assess whether the PLA would interact with solutions that are commonly used during the bioassay protocol, we exposed printed PLA parts to 4 different solutions to observe any degradation of the plastic. (i) Cotton pads soaked with 10% sucrose solution, typically used to feed mosquitoes during the recovery period, were placed on six mesh screens for seven days. Cotton pads were soaked daily with fresh 10% sucrose solution to replace evaporated solution. (ii) Four slides were submerged in 3% Rely+On Virkon (Lanxess, Cologne, Germany) for five days. (iii) Four slides were submerged in 5% Decon 90 (Decon Laboratories Ltd., Hove, England) for five days. (iv) Six screw caps were submerged in 70% ethanol for five days.

Results

3D printing

Printed parts interface as expected with current WHO bioassay parts, allowing any configuration of 3D printed and WHO parts to be assembled together. The printed kits assembled easily without the need for additional tools. CAD and STL files produced are available at <https://github.com/SeanTomlinson30/3D-Printable-WHO-Bioassay-Parts>.

Bioassay testing

Bioassays with 4% DDT using the Mbita and Kilifi strains showed no significant difference mortality after 24 hours, for measurements between 3D printed and WHO bioassay kits (Fig. 3). We observed that mosquitoes can sugar feed through the 3D printed mesh screens. We did not observe any mortality in control tubes for either 3D printed or WHO bioassay tubes. We did not observe any visual signs of residue or insecticide retention on the ridged surface of the PLA after washing the parts. All Kisumu mosquitoes exposed to cleaned WHO bioassay and 3D printed tubes survived the 1-hour exposure and all survived to 24-hours post-exposure.

PLA reactivity with bioassay solutions

After exposure to 10% sucrose, 70% ethanol, 3% Rely+On Virkon (Lanxess) and 5% Decon 90 (Decon Laboratories Ltd.), we observed no signs of degradation of the PLA strength, tensibility, surface color or size.

Discussion

We have developed, and provide here, printable versions of all pieces that compose a WHO bioassay kit. We see the primary use case for these parts as a replacement

library for missing and damaged parts of an original WHO bioassay kit. Bioassay data for DDT exposure indicate no significant difference between 3D printed and WHO bioassay kits; although, other insecticides/strain combinations may react differently when interacting with 3D printed materials. We acknowledge the need to further test and validate 3D printed alternatives to the WHO bioassay kit, extending the tested insecticides to include pyrethroids, organophosphates and carbamates, the four main classes of public health insecticide.

Anecdotally, in our insectaries, we find that the most in-demand 3D printed replacement parts are the slide unit and mesh screen, with tubes being the most durable parts and least likely to be needed. The design challenges of 3D printing the WHO bioassay kit necessitated some changes to the geometry of individual parts. Most notably, to retain all functionality, the 3D printable slide unit had to be printed as six individual pieces that are assembled. In addition to showing no functional differences during operation and manual handling, because the 3D printed slide unit does not use chemical bonding, it is more durable to general wear and less likely to become damaged, in terms of splitting. Though, we do note that when using PLA as a 3D printing material, operators must be cognizant of the effect of hot temperatures causing material deformation.

Conclusions

We present files that allow printing of all parts of the WHO bioassay kit. To achieve this, we replicated existing parts in CAD software, modifying and adapting the designs where necessary to permit 3D printing. The printed parts work with standard WHO bioassay kits and in the case of full 3D printed kits, produce results not significantly different from standard WHO bioassay kits. 3D printing in laboratory environments has become more achievable thanks to the continued reduction in costs and developments in 3D printing technologies. Through the distribution of the 3D printable laboratory equipment, researchers can maintain testing capacity, reduce costs and adapt apparatus for bespoke purposes.

Supplementary information

Supplementary information accompanies this paper at <https://doi.org/10.1186/s13071-019-3789-9>.

Additional file 1: Table S1. Bioassay mortality data for WHO vs 3D printed kits with both Mbita and Kilifi stains.

Additional file 2: Text S1. Figure and statistics generation script.

Abbreviations

ABS: acrylonitrile butadiene styrene; CAD: computer-aided design; DDT: dichlorodiphenyltrichloroethane; FFF: fused filament fabrication; PET-G:

polyethylene terephthalate glycol; PLA: polylactic acid; STL: stereolithography; WHO: World Health Organisation.

Acknowledgments

We are grateful to Manuela Bernardi, who illustrated Fig. 1. We also would like to thank Giorgio Praulins for providing example WHO bioassay parts for the CAD modelling process.

Authors' contributions

ST, AVH and MJD designed the study. ST and AVH designed the CAD models and 3D printed the parts. DW, HN and AO helped design the assays. AO carried out the assays. HCY performed initial prototype testing. ST and HCY performed the absorption assay ST wrote the manuscript. All authors read and approved the final manuscript.

Funding

This work was supported by the Medical Research Council United Kingdom (MR/P02520X/1), and the National Institute of Allergy and Infectious Diseases ([NIAID] R01-AI116811). The content is solely the responsibility of the authors and does not necessarily represent the official views of the NIAID or National Institutes of Health (NIH). ST is supported by an MRC doctoral training programme studentship (1855159).

Availability of data and materials

The CAD and STL files produced are in the supplementary materials and are available at <https://github.com/SeanTomlinson30/3D-Printable-WHO-Bioassay-Parts>. Bioassay data and analyses scripts are provided in Additional files 1 and 2.

Ethics approval and consent to participate

Not applicable.

Consent for publication

Not applicable.

Competing interests

The authors declare that they have no competing interests.

Author details

¹ Department of Vector Biology, Liverpool School of Tropical Medicine, Liverpool, UK. ² College of Veterinary Medicine, Animal Resources & Biosecurity, Makerere University, Kampala, Uganda. ³ Department of Biochemistry, Jomo Kenyatta University of Agriculture and Technology, Nairobi, Kenya.

Received: 12 September 2019 Accepted: 4 November 2019

Published online: 14 November 2019

References

1. Bhatt S, Weiss DJ, Cameron E, Bisanzio D, Mappin B, Dalrymple U, et al. The effect of malaria control on *Plasmodium falciparum* in Africa between 2000 and 2015. *Nature*. 2015;526:207–11.
2. The Anopheles gambiae 1000 Genomes Consortium. Genetic diversity of the African malaria vector *Anopheles gambiae*. *Nature*. 2017;552:96–100.
3. Lucas ER, Miles A, Harding NJ, Clarkson CS, Lawniczak MKN, Kwiatkowski DP, et al. Whole-genome sequencing reveals high complexity of copy number variation at insecticide resistance loci in malaria mosquitoes. *Genome Res*. 2019;29:1250–61.
4. WHO. Test procedures for insecticide resistance monitoring in malaria vector mosquitoes. Geneva: World Health Organisation; 2016.
5. Witmer K, Sherrard-Smith E, Straschil U, Tunnicliff M, Baum J, Delves M. An inexpensive open source 3D-printed membrane feeder for human malaria transmission studies. *Malar J*. 2018;17:282.

Publisher's Note

Springer Nature remains neutral with regard to jurisdictional claims in published maps and institutional affiliations.