

INTAKE ANALYSIS ON FOUR-STROKE ENGINE USING CFD

A. M. Mohd Shafie^{1, a}, Musthafah M. T.^{1, b}, M. S. Ali^{1, c}, Rosli A. Bakar^{2, d}

¹Faculty of Mechanical Engineering, Universiti Teknikal Malaysia Melaka,
Hang Tuah Jaya,
76100 Durian Tunggal Melaka, Malaysia

*Email: amientk@gmail.com

²Faculty of Mechanical Engineering, Universiti Malaysia Pahang,
26600 Pekan, Pahang, Malaysia

[aamientk@gmail.com](mailto:amientk@gmail.com), [bmusthafah@utem.edu.my](mailto:musthafah@utem.edu.my), [csyahir9610@gmail.com](mailto:syahir9610@gmail.com),
[drosli@ump.edu.my](mailto:rosli@ump.edu.my)

ABSTRACT

Flow pattern is vital to ensure that the engine can produce high performance with the presence of swirl and tumble inside the cylinder. In this paper, the simulation of air is simulated in the software to predict the flow pattern using the steady state pressure based solver at two different planes in the engine domain. The domain used for the simulation is based on the actual engine parameters. Using the commercial CFD solver ANSYS FLUENT, the CFD simulation is run under five different piston positions and seven different engine speeds. Note that in this simulation, only intake strokes are simulated. The results show the velocity of the flow is high during the sweep as the intake stroke takes place. This situation is believed to produce more swirl and tumble during the compression hence enhancing the burning rate in entire region of the clearance volume.

Keywords: CFD; fluent; in-cylinder flow; intake flow; Meshing.

INTRODUCTION

Engine is used to propel the vehicle by converting the chemical energy to mechanical motion. Reciprocating Engine with four-stroke cycle consists of intake stroke, compression stroke, expansion stroke and exhaust stroke. At the stages of intake and compression stroke, it is the most influential part to dictate the flow pattern and structure of air entering and exiting the swept volume. Air flow for the internal combustion engine is generally in turbulent flow as the speed of the internal combustion engines is high (panday and bidesh, 2012). This turbulent flow is excluded when the flow goes through crevices volume as it will diminish the turbulence near the wall. Domain used in the simulation is based on the engine used by Ammar et al. (2014) for engine dynamometer with 3.36 kW of power. Typically, turbulence kinetic energy and turbulence kinematic viscosity are the benchmark to measure the turbulence with compressible flow in the cylinder (Pandey and Bidesh, 2012).

CFD is the most promising tool to foretell the flow structure and pattern of the air inside the engine cylinder and provides the details of the tumble and swirl in the cylinder. Furthermore, the velocity profile as well as pressure within the domain for given boundary condition can be obtained completely (Kumar et al, 2013; Stefano et al. 2013). Flow development and decay in the cylinder is usually analyzed with stable

turbulence models such k-epsilon and RNG in the CFD. Stefano et al. (2013) stated that instead of using the simple model, it is recommended to use more refined model such as Large Eddy Simulation (LES) or Detached Eddy Simulation (DES). On the other hand, for a better RANS modelling, it is recommended to use Reynolds Stress and K-omega SST with enough resolution for near wall flow. Stefano et al. (2013) stated that in recent years, the Large Eddy Simulation (LES) or Detached Eddy Simulation (DES) were used in application of flows in the internal combustion engine. Flow in the cylinder of the engine inherently decisive for the combustion performance of the engine (Hemant and Saurish, 2013).

During the intake stroke and compression stroke, creating a vortical flow motion which is swirl and/or tumble is indispensable not only to have a fast burning rate but also high mixing process with the air inside the engine cylinder. It is due to single properly defined vortical structure is more stable than other large scale in-cylinder flow (Bari and Idris, 2013; Panday and Bidesh 2012). Swirl is air movement in the cylinder about the cylinder axis while tumble is a movement of air in direction of upside to downside or conversely that circles at perpendicular axis to the engine cylinder. Hence, during combustion it generates higher turbulence and faster flame-front propagation (Hemat and Saurish, 2013). Besides, suitable value of swirl will improve the fuel efficiency hence the duration of the combustion can be abbreviated. Panday and Bidesh (2012) claimed that 4% from burning time loss is one of the primary lose in spark ignition engine which its occurrence resulting from finite time of combustion. Increasing the degree of swirl leads to increase of the turbulence intensity inside the cylinder and this situation can eliminate the loss from burning time. Higher turbulence intensity produces more stable ignition process and faster flame propagation particularly in lean-burn combustion.

SIMULATION SETUP

Computational Domain

The domain was created according to the actual engine as illustrated in Figure 1 with the specifications shown in the Table 1 which is then drawn in CAD Software, CATIA P3 V5R20. A comprehensive study was conducted by comparing the physical model with computational model in order to minimize the modeling error with fewer number of iteration (Kumar et al, 2013). Figure 2 shows the domain that is imported to the ANSYS workbench. In order to simulate the domain, mesh was generated in the ANSYS-Mesh to divide the domain into a small size. Automatic mesh generation was used for the entire domain. Quality of mesh is important to the accuracy of the result.

Table 1. Specification of engine used.

Engine type	Robin EY20-3, 0.5 HP
Max. Power (HP/rpm)	5/4000
Max. Torque (kgm/rpm)	0.96/2800
Bore × Stroke (mm)	67.4 × 52
Intake air	Naturally aspirated
Type of Piston Head	Flat
Compression Ratio	6.3
Inlet Diameter (mm)	26
Outlet Diameter (mm)	21

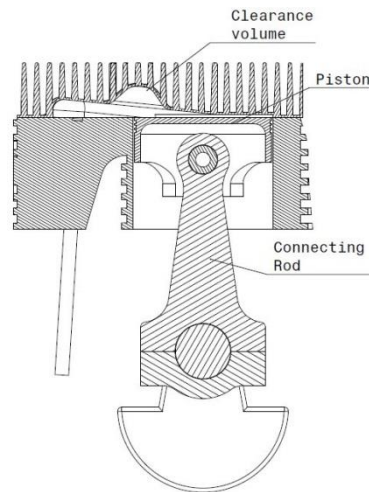

Figure 1: Clearance volume of the in-cylinder engine

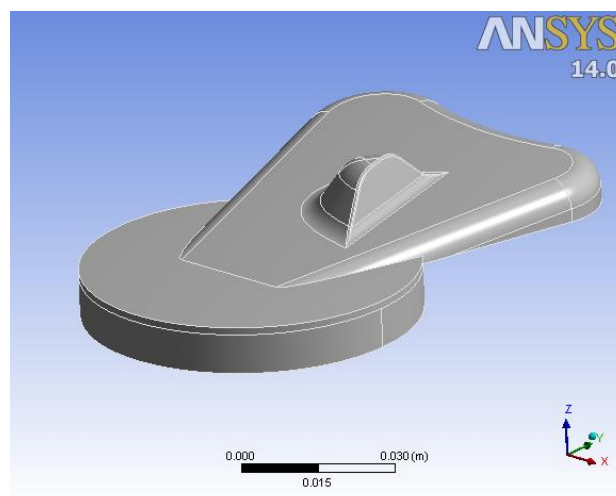

Figure 2: Imported domain in ANSYS workbench

Figure 3(a) shows the complete cycle of a four-stroke engine. The position of the engine are varied with 9° , 18° , 27° , 36° , and 45° after top dead center. Furthermore, the simulation is run at various speed with increment of 500 rpm starting at 1500 rpm and ending at 4500 rpm. Note that the shape of the cylinder head is flat in shape.

The mesh quality needs to comply with mesh metric of maximum skewness below 0.98 and the maximum orthogonal quality with approach to one. Mesh skewness is vital to control because it will affect not only the convergence but also the result of the simulation. The domain shown in Figure 3(b) illustrated the cut-view with the piston located 45° after top dead center and it was in a good quality of mesh with maximum skewness of 0.968 and orthogonality of 0.996. The elements for the domain are 148852 of tetrahedron element.

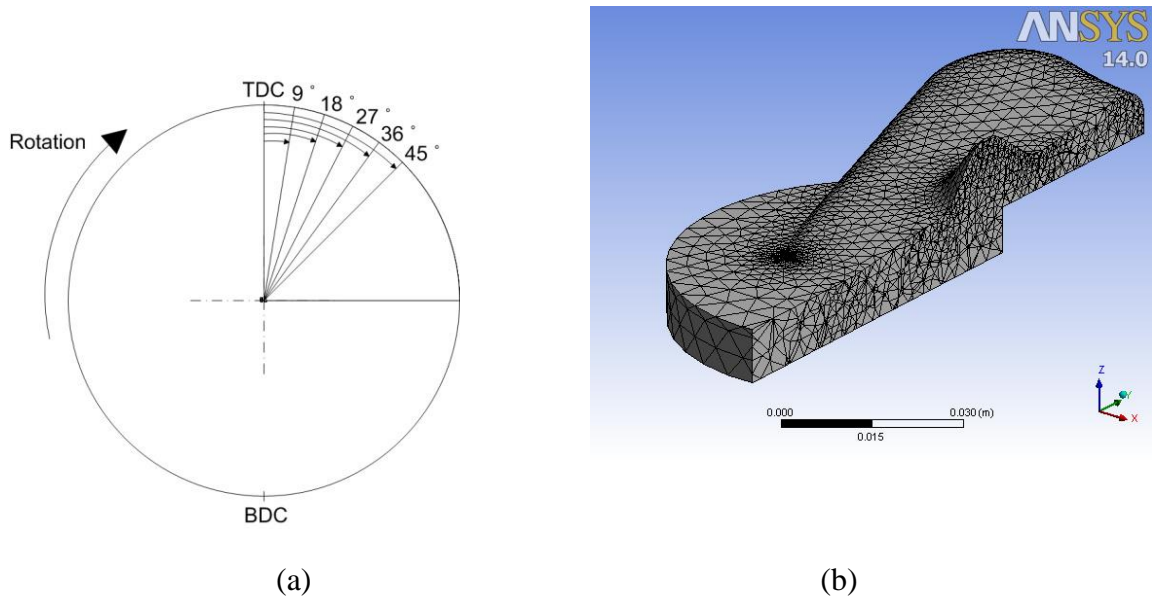

Figure 3. (a) Complete cycle; (b) Cut-view of the clearance volume of engine

Numerical Strategy

The compressible Navier-Stoke equations of momentum, continuity and energy were used to solve the flow simulation in ANSYS FLUENT. The generalization for each of governing equations have the following forms, respectively:

Mass equation

The derivation of the mass equation or known as continuity equation is based on the control volume and the equivalent differential equation is written as:

$$\frac{\partial \rho}{\partial t} + \nabla \cdot (\rho \vec{v}) = 0 \quad (1)$$

Where \vec{v} is flow velocities in x , y , and z direction for three dimensional flow case and ρ is the density of fluid used in the simulation.

Momentum equation

Momentum equation is founded from the Newton's second law of fluid motion which the body and the surface forces considered in the control volume are described as:

$$\frac{\partial(\rho U)}{\partial t} + \nabla \cdot (\rho U \times U) = -\nabla p + \nabla \cdot \tau + S_M \quad (2)$$

Where U is the flow velocity, p is the static pressure, τ is the strain rate and S_M is the momentum sources acting on the fluid. These equations are also known as the Navier-Stoke equation.

Energy equation

$$\frac{\partial(\rho h_{tot})}{\partial t} - \frac{\partial p}{\partial t} + \nabla \cdot (\rho U h_{tot}) = \nabla \cdot (\lambda \nabla T) + \nabla \cdot (U \cdot \tau) + U \cdot S_M \quad (3)$$

Where λ and h_{tot} represent the thermal conductivity and total enthalpy of the fluid. Equation (1), Equation (2) and Equation (3) were incorporated into CFD models in order to solve the simulation of the domain.

Simulation Setting

This simulation is performed in the steady state with pressure-based solver that solves the equation of energy, momentum and continuity at initial. Model of k-epsilon of realizable with Non-equilibrium wall function is used since the model is simple and stable for the initial simulation strategy to predict the flow pattern in the cylinder (Stefano et al, 2013). The purpose of using Non-equilibrium wall function is to indicate the flow near the wall as the source of the turbulence and vorticity (Kumar et al, 2013).

Pressure field is obtained using SIMPLE algorithm for pressure-velocity coupling. The discretization scheme for convective term of momentum and energy used the second order upwind scheme while the others used the first order upwind. Only two boundary condition considered in this case; velocity inlet and pressure outlet. The other region is prescribed as wall and assumed as no-slip and adiabatic. The velocity of the inlet is calculated from the continuity of the piston speed at various engine speed which

is at 1500 rpm, 2000 rpm, 2500 rpm, 3000 rpm, 3500 rpm, 4000 rpm and 4500 rpm. However, the initial gauge pressure is set as 1 atm for all engine speed. The pressure outlet is set to 0.87 Pa as referred to the GT-Power software as the pressure is low when the intake process occurs.

RESULTS AND DISCUSSION

All of the results for the simulation are illustrated based on the planes as shown in the Figure 4 consist of Plane A and Plane B to ensure the comparison is at the similar place. Plane A is illustrated as a cutaway view in the clearance volume viewed from the z-direction with the same axis as the cylinder axial axis. Meanwhile Plane B is a cutaway view viewed from x-direction. Plane A located at the bottom surface of the combustion chamber in order to monitor the velocity profile when air enters the cylinder. Plane B is placed near to the flow entering the spark plug region.

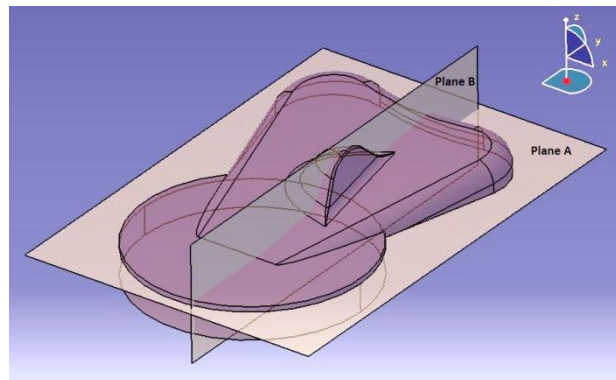

Figure 4. reference plane to be observed

Flow in the cylinder is vital for the internal combustion engine to be more efficient. Swirl and tumble flow in the cylinder are inherently decisive for the mixture to be mixed well to form homogeneous mixture in a brief time before the combustion occurs (Panday and Bidesh 2012). Figure 5 shows the flow viewed from the plane A located at the entering region of the flow from the combustion chamber to the swept volume. From the figure it clearly shows that the velocity of the flow is higher at the entering region of the flow to the swept volume segment. The flow velocity seems to be higher when air flows through the volume which has a lower cross sectional area as can be seen in the illustration of the domain. For engine speed 4500 rpm, it is clear that the air flow velocity is higher at the left side of the wall since the inlet air located more at the left side hence producing higher velocity. It is noticeable that each of the crank angle has different values of legend in the Figure 5. However the maximum value for the legend at each crank angle is based on the local value at that position. Air flow at engine speed of 4500 rpm and crank angle of 45 degree has higher velocity produced compared to the others as the inlet velocity for this circumstance is the highest. Hence, the velocity produced at this circumstance is the highest as well.

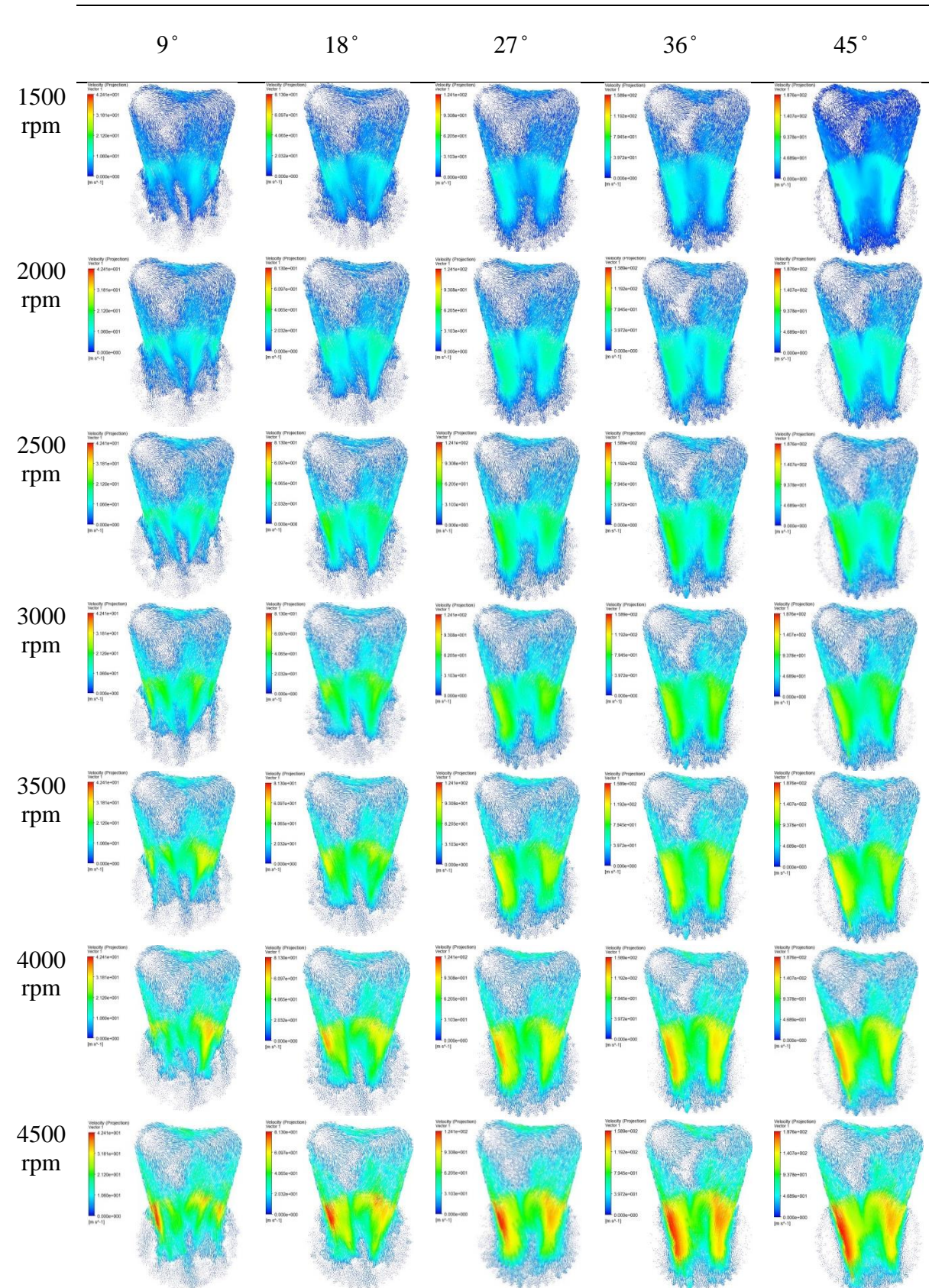

Figure 5. Flow viewed from Plane A

Figure 6 shows the view of the air flow at the Plane B located vertically with the cylinder and near the spark plug location. At this position, the flow of air produces around the spark plug can be observed. Most of the flows at this view have higher velocity at the entrance to swept volume which is cylindrical as viewed from the Plane A. From Figure 6, it shows that at the engine speed at 4500 rpm with piston located 18 degree after top dead center develops high velocity near ignition region. This can be one of the triggers of producing a tumble at the combustion chamber. Among of all boundary condition given, engine speed of 4500 rpm and crank angle of 45 degree creates highest velocity at the entrance of swept volume which is then believed to produce swirl and tumble. Hence, enhanced mixing of the fuel and air improves the engine performance. High engine speed produces high inlet air flow which helps the development of higher swirl and vice versa.

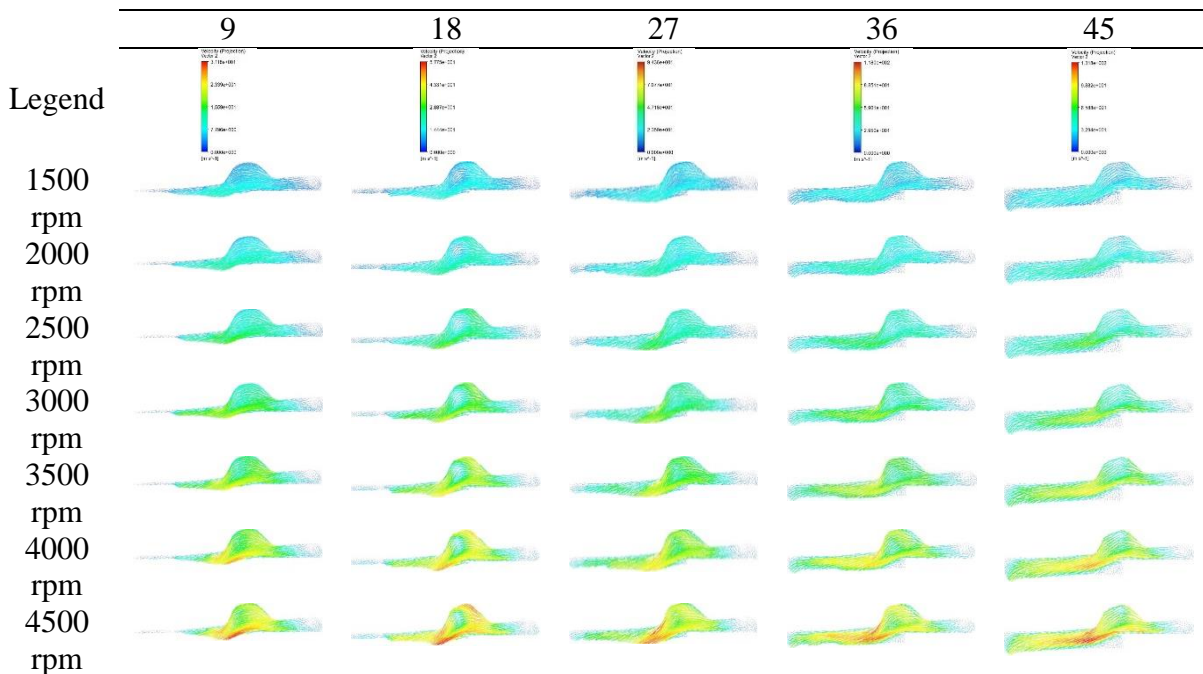

Figure 6. Flow Viewed from Plane B

CONCLUSION

This paper manifests the flow structure and pattern of air inside the swept volume for a steady state condition with desired parameters given. Presence of swirl and tumble inherently improves the combustion propagation hence increasing the performance of the engine. Result of the in-cylinder flow for the first 45 degree after top dead center shows that air flow have higher velocity when approaching the entrance of swept volume. The flow of air during the intake process dictates the tumble and swirl formation before piston moving upward to top dead center in compression process. It is foretold that the turbulence occurs at the clearance volume as the shape of squish area lead to encourage the turbulence flow for the domain. The limitation of this paper is that the simulation only simulates at the intake process and not at the compression process which can illustrate more tumble and swirl flow. For the future work, the simulation

will be performed with the presence of fuel and air to observe the mixing process occurs in the clearance volume and swept volume.

ACKNOWLEDGEMENTS

The authors are grateful to Faculty of Mechanical Engineering, Universiti Teknikal Malaysia Melaka (UTeM) for financial support in short-term grant research project no. PJP/2013/FKM(9B)/SC01227. The deepest appreciation is granted to the research center of Faculty of Mechanical Engineering (GTeV, CARE) as well as Universiti Malaysia Pahang, Professor Dato' Rosli Abu Bakar for the assistance in this project.

REFERENCES

- S. Bari & Idris Saad (2013). CFD modelling of the effect of guide vane swirl and tumble device to generate better in-cylinder air flow in a CI engine fuelled by biodiesel. *Computers & Fluid*, 84, 262-269
- Hemant Puneekar & Saurish Das (2013). Numerical simulation of subcooled nucleate boiling in cooling jacket of IC engine. *SAE Technical Paper*. 2013-01-1651
- R. F. Huang, H. S. Yang & C. -N. Yeh (2008) In-cylinder flows of a motored four-stroke engine with flat-crown and slightly concave-crown piston. *Experiment Thermal and fluid science*. 32, 1156-1167
- Vinodh Kumar B., Sivagaminathan N., Gopalakrishnan N., Scott Morton & Paul Radavich (2010). Air flow and charge motion study of engine intake port. *Proceedings of the 37th National & 4th International Conference on Fluid Mechanics and Fluid Power*, FMFP10-CR-10
- Stefano Fontanesi, Giuseppe Cicalese & Elena Severi (2013) Analysis of turbulence model effect on the characterization of the in-cylinder flow field in a HSDI diesel engine. *SAE technical paper*. 2013-01-1107
- Ammar Alfaiz M. A., Musthafah M. Tahir, Rosli A. Bakar, M. Shahir Ali, Abdul Muhaimin (2013) New design of a low cost small engine dynamometer of engine testing. *3rd International Conference and Exhibition on Sustainable Energy and Advanced Material*,
- K. M. Pandey & Bidesh Roy (2012) CFD analysis of intake valve for port petrol injection SI engine. *Global Journal of Researches in Engineering Mechanical and Mechanics Engineering*, 12(5), 12-19

Our ref : UMP.14.04/20.11/1/AL (P138)

Date : 26 May 2014

Paper ID: P138

Paper Title: INTAKE ANALYSIS ON FOUR-STROKE ENGINE USING CFD

Authors Name: A. M. Mohd Shafie, Musthafah M. T., M. S. Ali, Rosli A. Bakar

Dear Author,

Sub: Acceptance of Paper for AiGEV 2014. Kuantan, Pahang, Malaysia.

CONGRATULATIONS!

We are pleased to inform you that your paper entitled above has been reviewed and accepted for presentation at the AiGEV 2014 which will be held from 26 – 27 August 2014 at Swiss Garden Resort & Spa, Kuantan, Pahang, Malaysia.

For your information, your paper will be published in the Applied Mechanics and Materials Proceeding Journal (Trans Tech Publications) which indexed by Scopus, subject to receipt of the registration fee of the AiGEV 2014 conference. Selected papers will be published in IJAME (Scopus Indexed Journal) or JMES (UMP Journal) . The presentation will be in the form of oral presentation. It is expected that at least one of the authors will attend the conference and present the paper. Please refer to our official website <http://aigev.ump.edu.my> or email to aigev2014@gmail.com for any inquiry, details and updates.

Best wishes and looking forward to your participation in Kuantan, Pahang, Malaysia.

Thank you,

Yours sincerely,



DR. ADAM BIN ABDULLAH

Chairman,
International Conference on Automotive Innovation and Green Energy Vehicle (AiGEV 2014),
Automotive Engineering Centre (AEC),
Universiti Malaysia Pahang,
26600 Pekan,
Pahang Darul Makmur.
MALAYSIA.



PAYMENT INFORMATION

Kindly state whether you will register as **student or participant in the registration form provided.**

Please **email the payment receipt** for payment confirmation (Refer to sample attached). You may also email the copy of Local Order (LO) for payment confirmation and bring the original LO during the conference.

For Cash Deposit / Telegraphic Transfer

Please remit your payment into the following account:

Bank Name : Maybank

Beneficiary Name : BENDAHARI UMP

Account Number : 5562 3530 1457

SWIFT Code : MBBEMYKL

Bank Address : Malayan Banking Berhad Cawangan Pekan 96, Jalan Sultan Abdullah 26600 Pekan Pahang Darul Makmur

		<small>Resit ini hanya disku sah selepas dicap oleh mesin Bank atau ditandatangani oleh pegawai yang bertugas. This receipt is only valid when exemplified by the Bank's teller machine or when it bears a manual signature of an authorised official. 此存摺只有效在柜员印出或由本行柜员亲笔签署后才有效。 SIMPANAN INI TERTAKLUK KEPADA SYARAT-SYARAT BANK. THIS DEPOSIT IS SUBJECT TO BANK'S TERMS & CONDITIONS. 存款之儲蓄不受銀行條款所限。 Cheques are accepted for 'collection' only. 此支票只代收匯票。</small>		SIMPANAN DEPOSIT	No: 15160686
<small>SILA GUNA SLIP BERSEKUTAN BAGI SETAP KATEGORI SIMPANAN DAN TANGKAPAN - 1/1 SA KOTAK YANG BERKENAAN PLEASE USE SEPARATE SLIP FOR EACH CATEGORY OF DEPOSIT AND TICK (✓) ON RELEVANT BOX 請按分類填寫，只填與用項一張存摺，并在有關分類項用✓作記號。</small>				RM	SEN
<input type="checkbox"/> CEK-CEK CAWANGAN INI PROSE CHEQUES 本行支票					
<input type="checkbox"/> CEK-CEK BANK TEMPATAN LOCAL CHEQUES 本地支票					
<input type="checkbox"/> CEK-CEK TEMPAT LAIN OUTSTATION CHEQUES 外地支票					
<input type="checkbox"/> LAIN-LAIN OTHERS 其他					
<input type="checkbox"/> WANG TUNAI RINGGIT CASH 現銀			JUMLAH BERSIH NET TOTAL	XXXX 00	
Nama / Name BENDAHARI UMP		Posted By:		Checked By:	
No. Akaun / Account No. 5562 3530 1457		No. Rujukan / Reference No. / 編號 PAPER ID =???			
Keterangan Urusniaga / Tran Description 交易說明 AiGEV 2014					