

12-27-1907

## College Hall Architectural Drawing – Section Through Stairs

The New Jersey State Normal School at Montclair .

Department of Charities and Correction, Architects Office .

Follow this and additional works at: [https://digitalcommons.montclair.edu/college\\_hall](https://digitalcommons.montclair.edu/college_hall)

---

### Recommended Citation

., The New Jersey State Normal School at Montclair and ., Department of Charities and Correction, Architects Office, "College Hall Architectural Drawing – Section Through Stairs" (1907). *College Hall*. 13.  
[https://digitalcommons.montclair.edu/college\\_hall/13](https://digitalcommons.montclair.edu/college_hall/13)

This Book is brought to you for free and open access by the Architectural Drawings at Montclair State University Digital Commons. It has been accepted for inclusion in College Hall by an authorized administrator of Montclair State University Digital Commons. For more information, please contact [digitalcommons@montclair.edu](mailto:digitalcommons@montclair.edu).

X

0

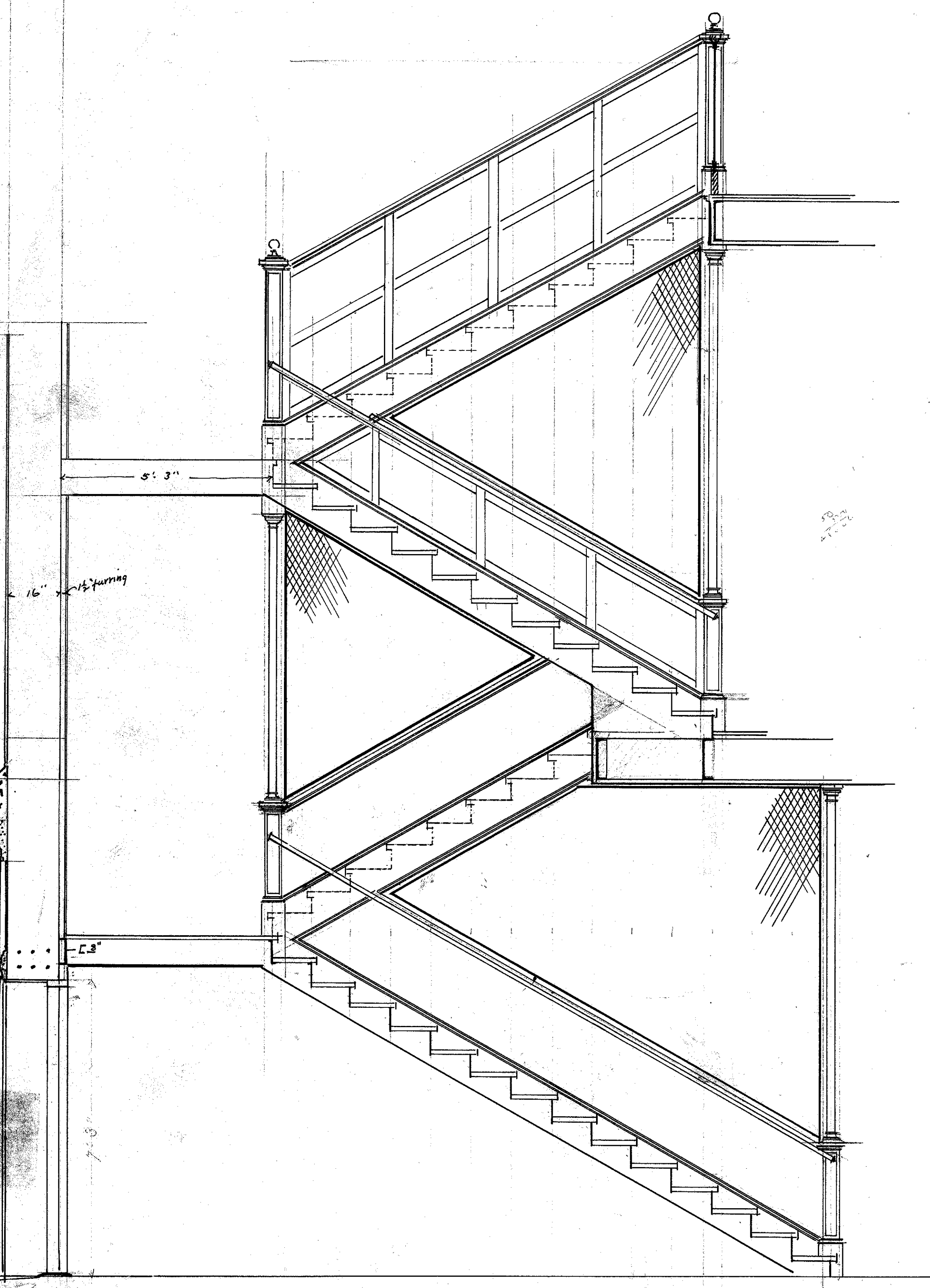

Section through West Stairs

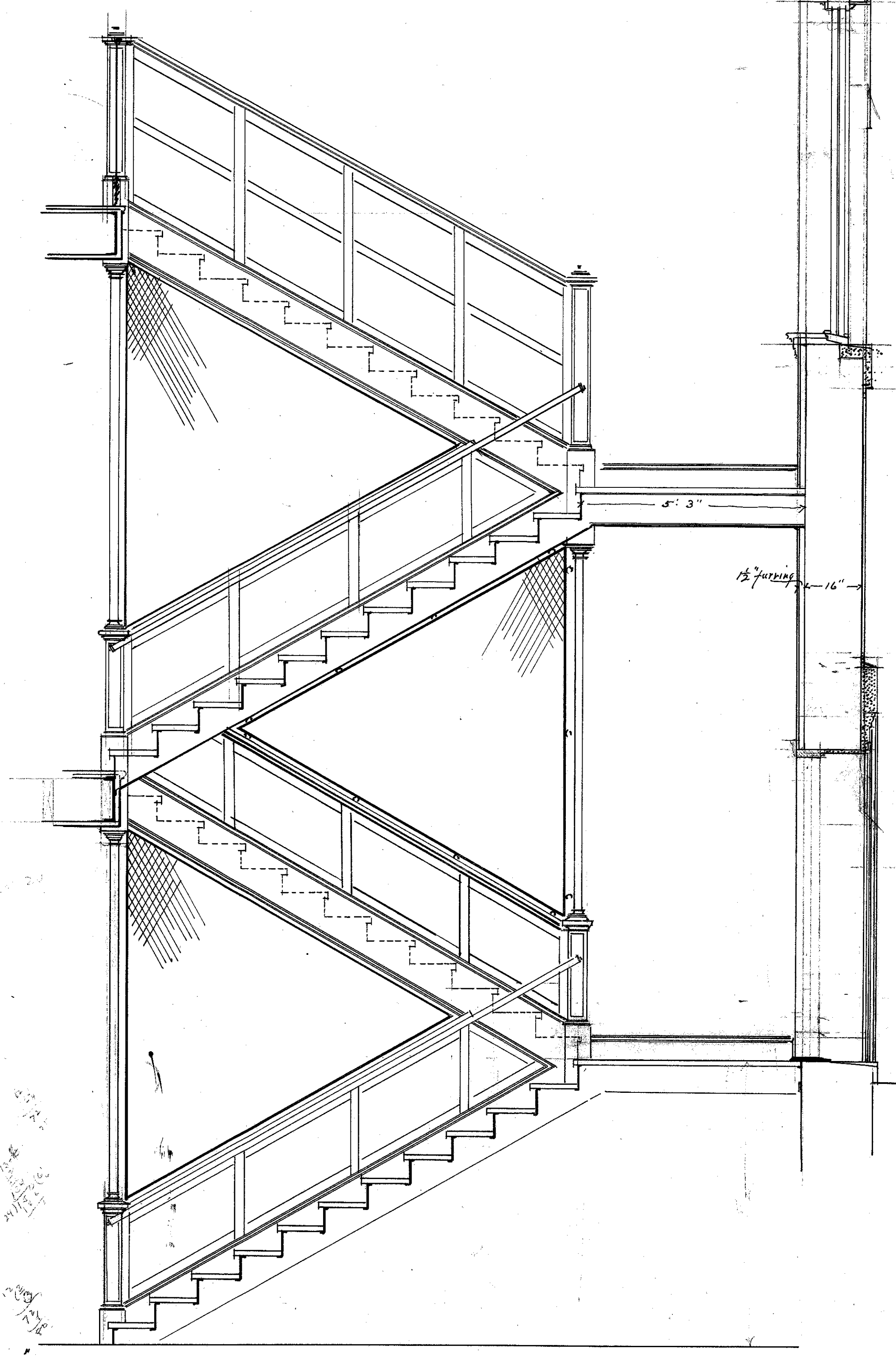

Section through East Stairs

13-Y

24/160 (6)  
1.5/2  
1/8

1/2  
3/4  
1/2  
1/4  
1/8  
1/16

23/37  
1/4  
1/8  
1/16

# 13