

12-26-1907

College Hall Architectural Drawing – Ventilators Detail

The New Jersey State Normal School at Montclair .

Department of Charities and Correction, Architects Office .

Follow this and additional works at: https://digitalcommons.montclair.edu/college_hall

Recommended Citation

., The New Jersey State Normal School at Montclair and ., Department of Charities and Correction, Architects Office, "College Hall Architectural Drawing – Ventilators Detail" (1907). *College Hall*. 12.
https://digitalcommons.montclair.edu/college_hall/12

This Book is brought to you for free and open access by the Architectural Drawings at Montclair State University Digital Commons. It has been accepted for inclusion in College Hall by an authorized administrator of Montclair State University Digital Commons. For more information, please contact digitalcommons@montclair.edu.

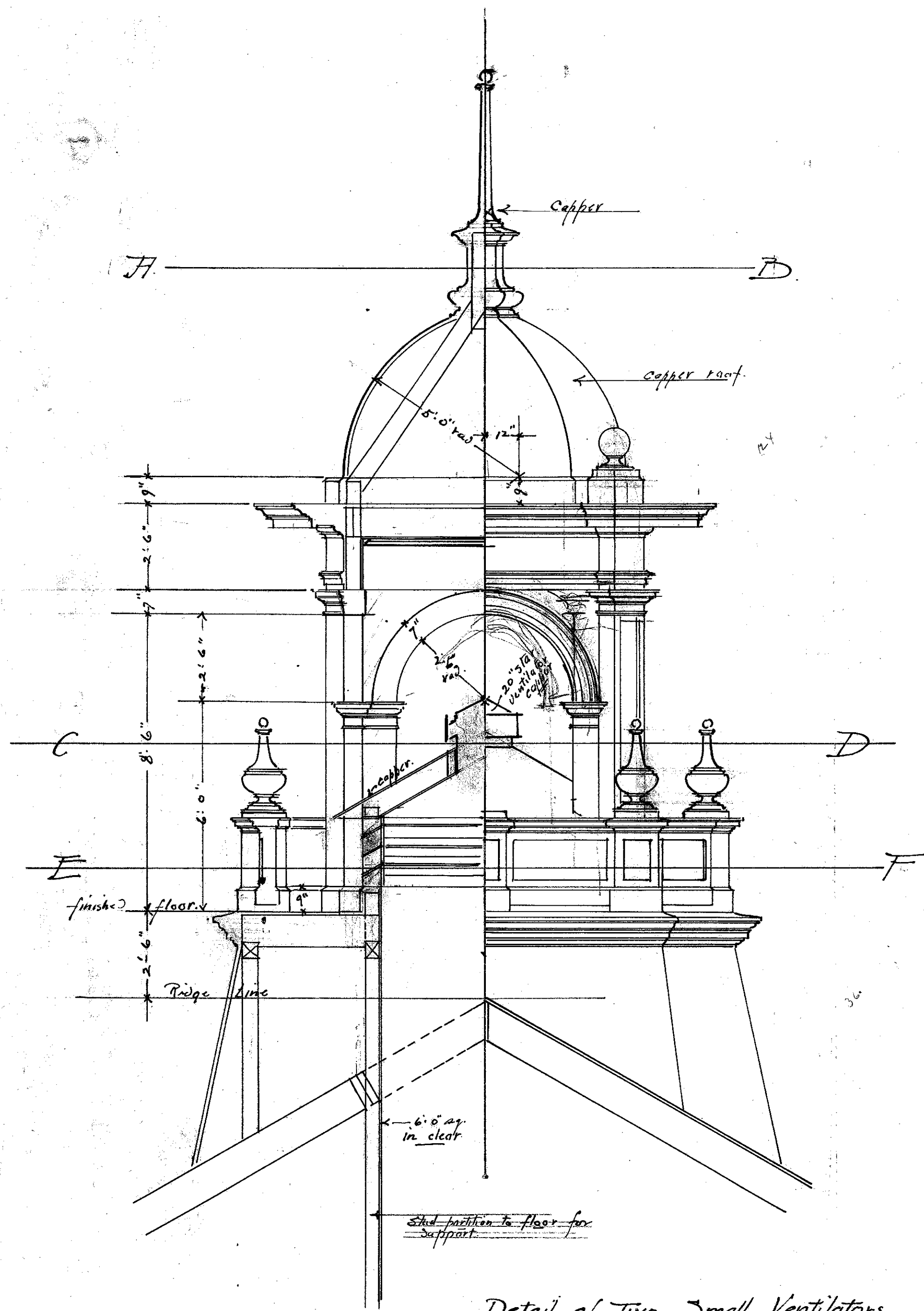

Detail of Two Small Ventilators

Note - All decks, roofs etc. to be
14oz copper. All flashings same.
All figures are given in the finish

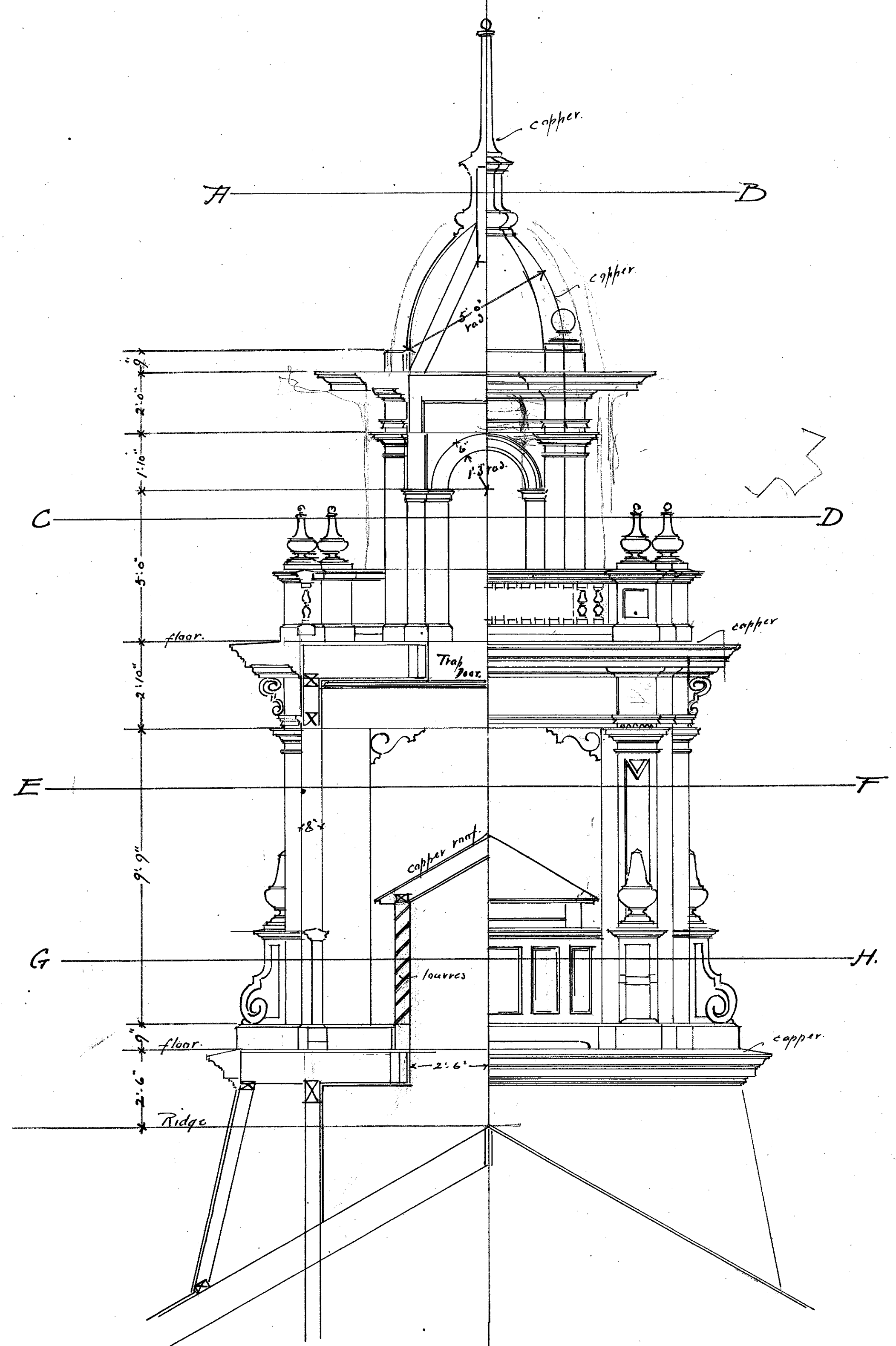

Scale 3/8" = 1'

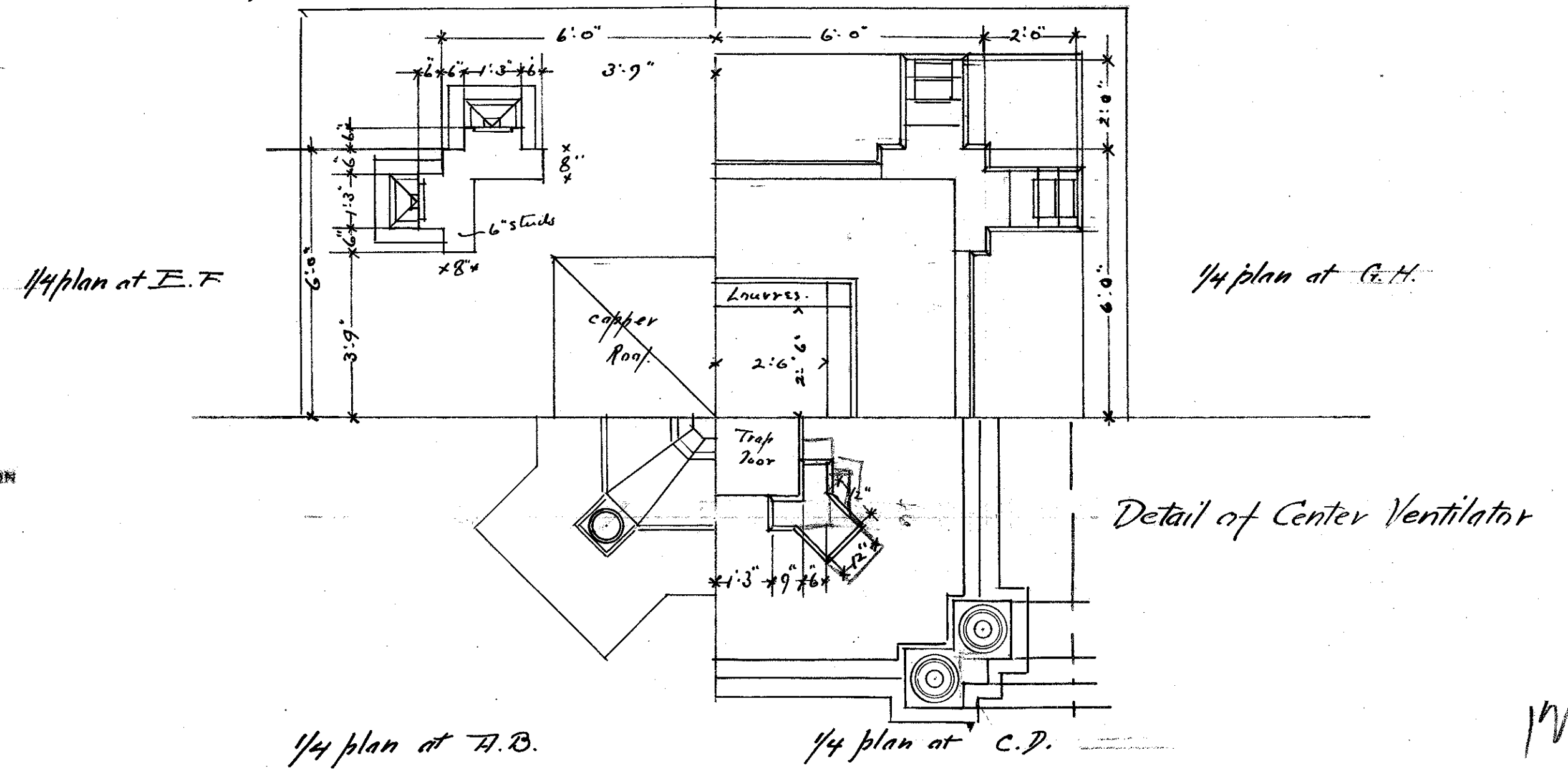
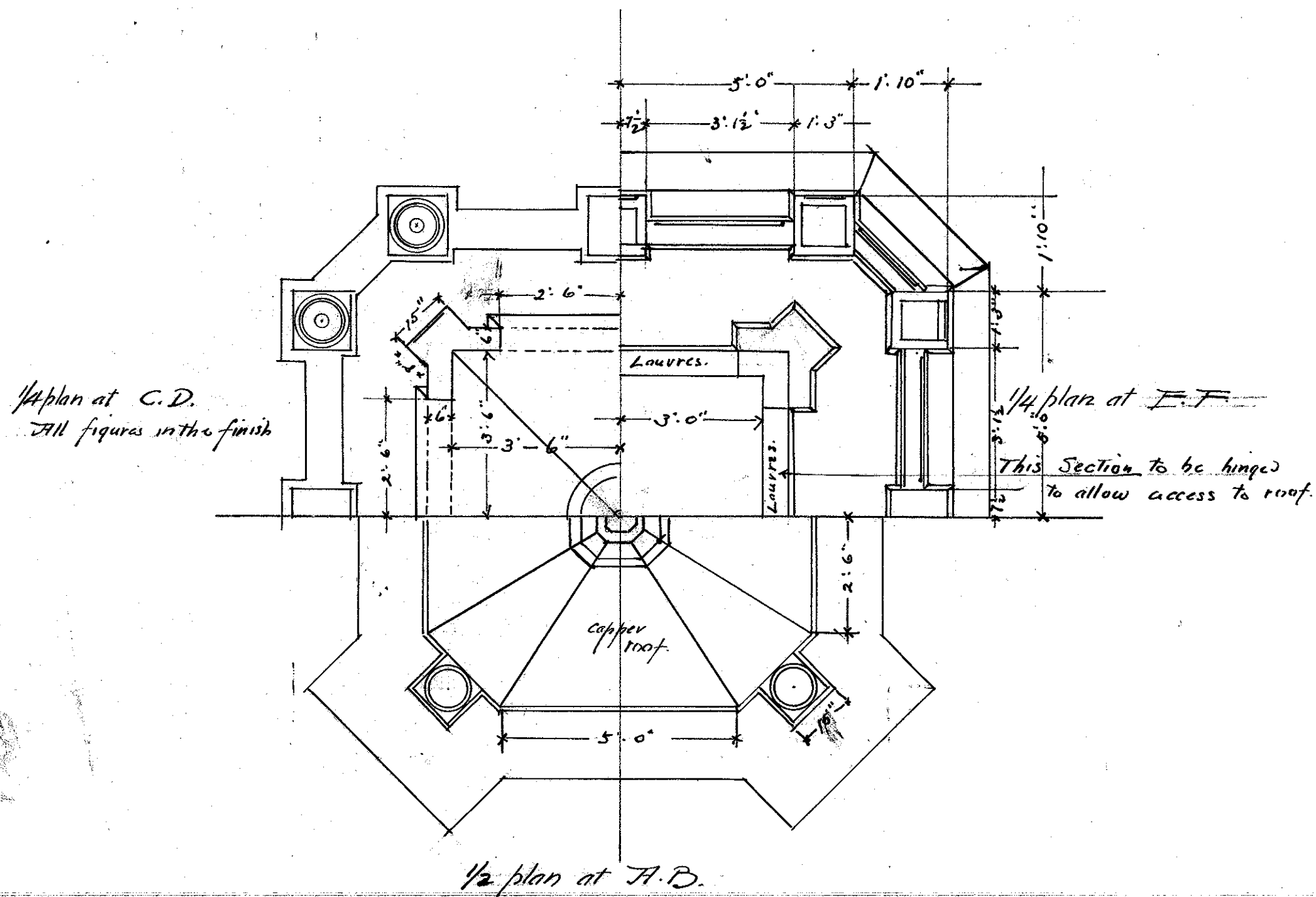

DEPARTMENT OF CHARITIES AND CORRECTION
 BUILDING State Normal School
 LOCATION Montclair Heights
 SHEET NO. 53 DRAWN BY *Quist*
 DATE Dec. 26, 1897 CHECKED BY
 ARCHITECTS OFFICE
 STATE HOUSE, TRENTON, N. J.

120 (U)