

# Sports & Culture Centre

case study  
By Emily Rosa

Copenhagen, Denmark

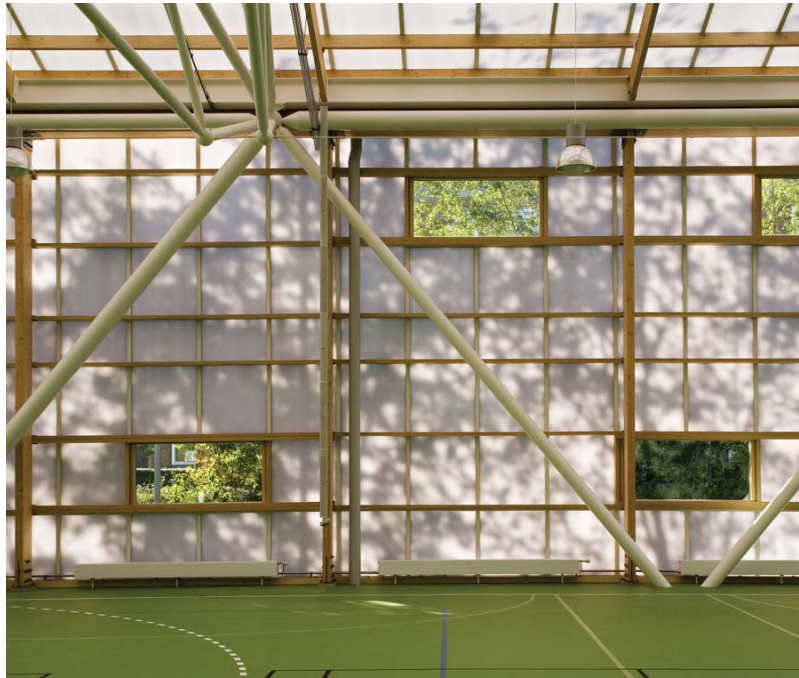

**Architect:** Dorte Mandrup Arkitekter Aps + b&k  
brandlhuber & co

**Owner:** Copenhagen Municipality / LOA

**Year of completion:** 2006

**Climate:** Marine West Coast Climate

**Material of interest:** Plastic

**Application:** Exterior

**Properties of material:** The skin is made of opalescent polycarbonate panels with a low U-value, creating optimal daylight conditions in the interior with an even distribution of light, which allows for a range of activities to take place within space, including sports or theater.

**Sources:**

<http://www.archdaily.com/6630/>