

2018

The contingent city: De-coding the possibilities of the city's sociospatial metabolism

Passia, Yota and Roupas, Panayotis

Suggested citation:

Passia, Yota and Roupas, Panayotis (2018) The contingent city: De-coding the possibilities of the city's sociospatial metabolism. In: Proceedings of RSD7, Relating Systems Thinking and Design 7, 23-26 Oct 2018, Turin, Italy. Available at <http://openresearch.ocadu.ca/id/eprint/2752/>

THE CONTINGENT CITY / Η ΕΝΔΕΧΟΜΕΝΙΚΗ ΠΟΛΗ

THE CONTINGENT CITY_4 DIMENSIONS | 253 DEGREES OF FREEDOM
De-coding the possibilities of the city's sociospatial metabolism

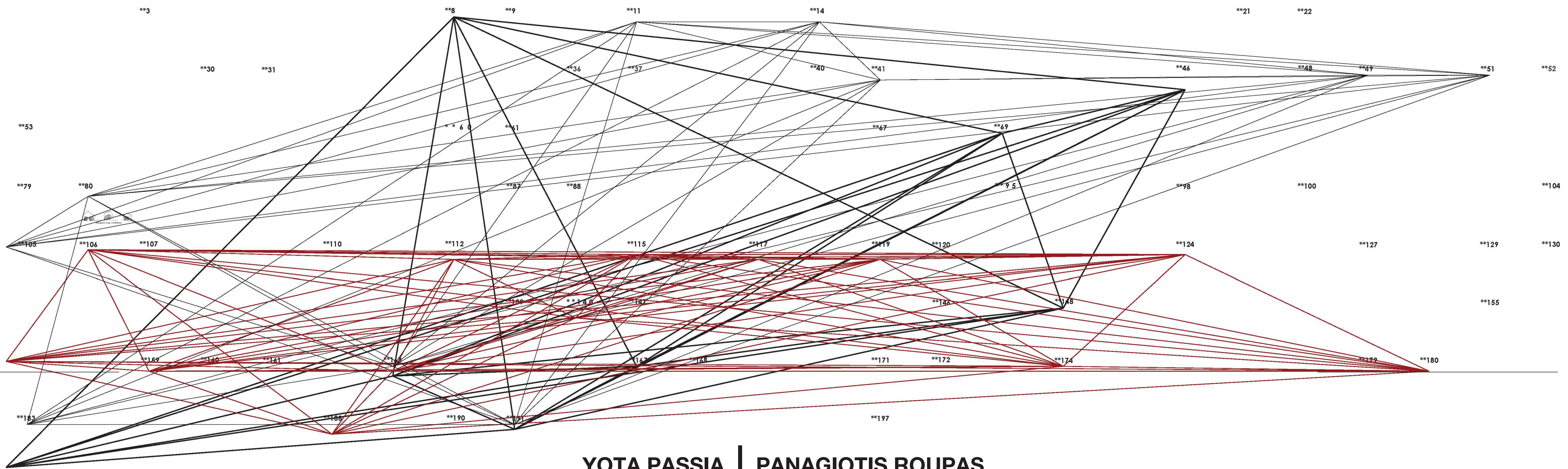

YOTA PASSIA | PANAGIOTIS ROUPAS

THE
CONTINGENT
CITY /
H
ENΔEXOMENIKH
ΠΟΛΗ

A DESIGN METHODOLOGY FOR ARCHITECTURE AND THE CITY

+

A CONCEPTUAL SCHEMA FOR ANALYZING + GENERATING URBAN AND SPATIALFORMS

A CONVERGENT PHASE OF SELECTION + A DIVERGENT PHASE OF DESIGN

DESIGN PATTERNS + A-SIGNS

PATTERNS
+ A-SIGNS



**CONVERGENT
PHASE /
ΣΥΓΚΛΕΙΣΣΕΙΣ**

A **CODE** OF DESIGN PATTERNS

DESIGN PATTERNS AS **ELEMENTARY UNITS**

PROCESS OF REPRESENTATION
PROCESS OF SELF-ORGANIZATION

PATTERNS

DESIGN PATTERN 31.PROMENADE

31 PROMENADE**



Each subculture needs a center for its public life: a place where you can go to see people, and to be seen.

Encourage the gradual formation of a promenade at the heart of every community, linking the main activity nodes, and placed centrally, so that each point in the community is within 10 minutes' walk of it. Put main points of attraction at the two ends, to keep a constant movement up and down.

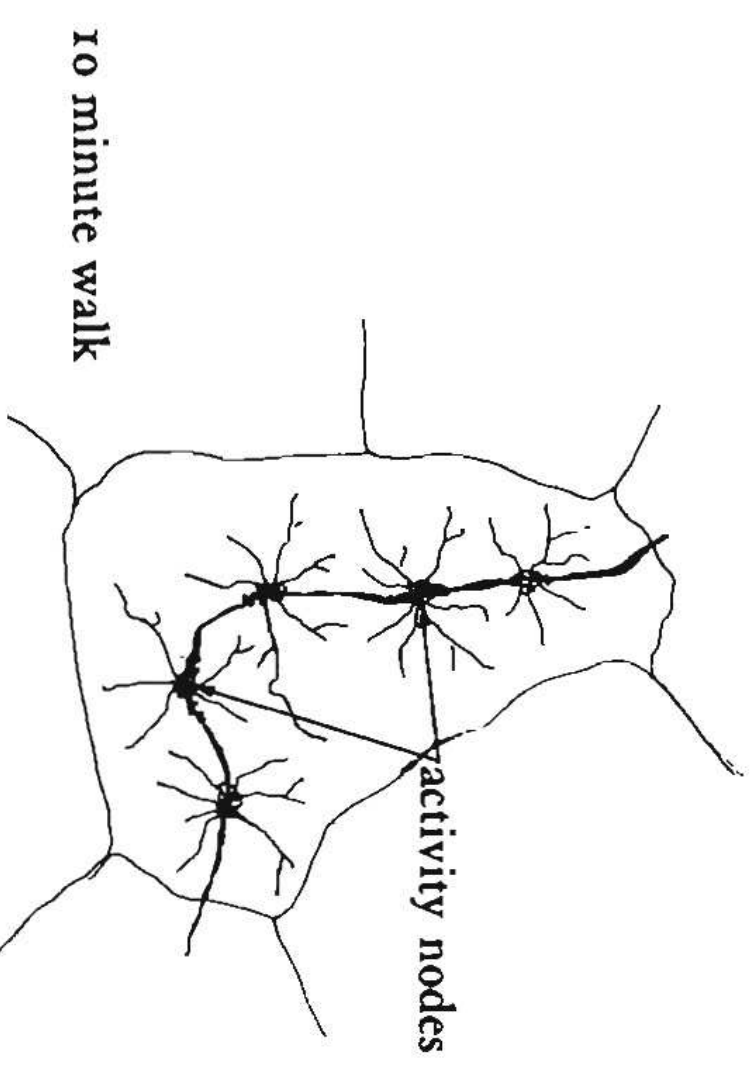

253 DESIGN PATTERNS /
253 ΠΕΔΙΑ ΣΧΕΔΙΑΣΜΟΥ

**1	2	**3	*4	5	*6	*7	**8	**9	10	**11	*12	*13	**14	*15	*16	17	*18	*19	*20	**21	**22	23	*24	*25	*26		
27	*28	*29	**30	**31	*32	*33	34	*35	**36	**37	38	39	**40	**41	*42	43	*44	45	**46	*47	**48	**49	*50	**51	**52		
**53	54	*55	*56	*57	58	*59	**60	**61	62	63	*64	65	*66	**67	*68	**69	*70	*71	*72	73	74	*75	*76	*77	*78		
**79	**80	*81	*82	*83	84	85	*86	**87	**88	*89	90	*91	*92	*93	94	**95	*96	*97	**98	*99	**100	101	*102	*103	**104		
**105	**106	**107	*108	*109	**110	*111	**112	113	*114	**115	*116	**117	*118	**119	**120	*121	*122	*123	**124	*125	126	**127	*128	**129	**130		
131	*132	133	*134	*135	*136	*137	*138	**139	**140	**141	*142	*143	*144	145	146	*147	**148	149	*150	*151	152	153	*154	**155	*156		
157	*158	**159	**160	**161	162	**163	*164	*165	*166	**167	**168	*169	*170	**171	**172	*173	**174	175	176	*177	*178	**179	**180	*181	182		
**183	*184	*185	186	187	**188	*189	**190	**191	*192	*193	194	*195	*196	**197	*198	*199	*200	201	202	203	204						

DESIGN PATTERNS 204

TOTAL 253

ALL 253

66 DESIGN PATTERNS / 66 ΠΕΔΙΑ ΣΧΕΔΙΑΣΜΟΥ

**1 	**3 		**8 	**9 		**11 	**14 			**21 	**22 									
		**30 	**31 			**36 	**37 		**40 	**41 			**46 	**48 	**49 		**51 	**52 		
**53 			**60 	**61 					**67 	**69 										
**79 	**80 					**87 	**88 				**95 		**98 	**100 				**104 		
**105 	**106 	**107 	**108 	**109 	**110 	**112 			**115 	**117 	**119 	**120 		**124 		**127 	**129 	**130 		
							**139 	**140 	**141 				**148 				**155 			
		**159 	**160 	**161 		**163 			**167 	**168 		**171 	**172 	**174 		**179 	**180 			
**183 					**188 		**190 	**191 			**197 									

DESIGN PATTERNS 66

TOTAL 253

ALL 253

**4 DIMENSIONS /
4 ΔΙΑΣΤΑΣΕΙΣ**

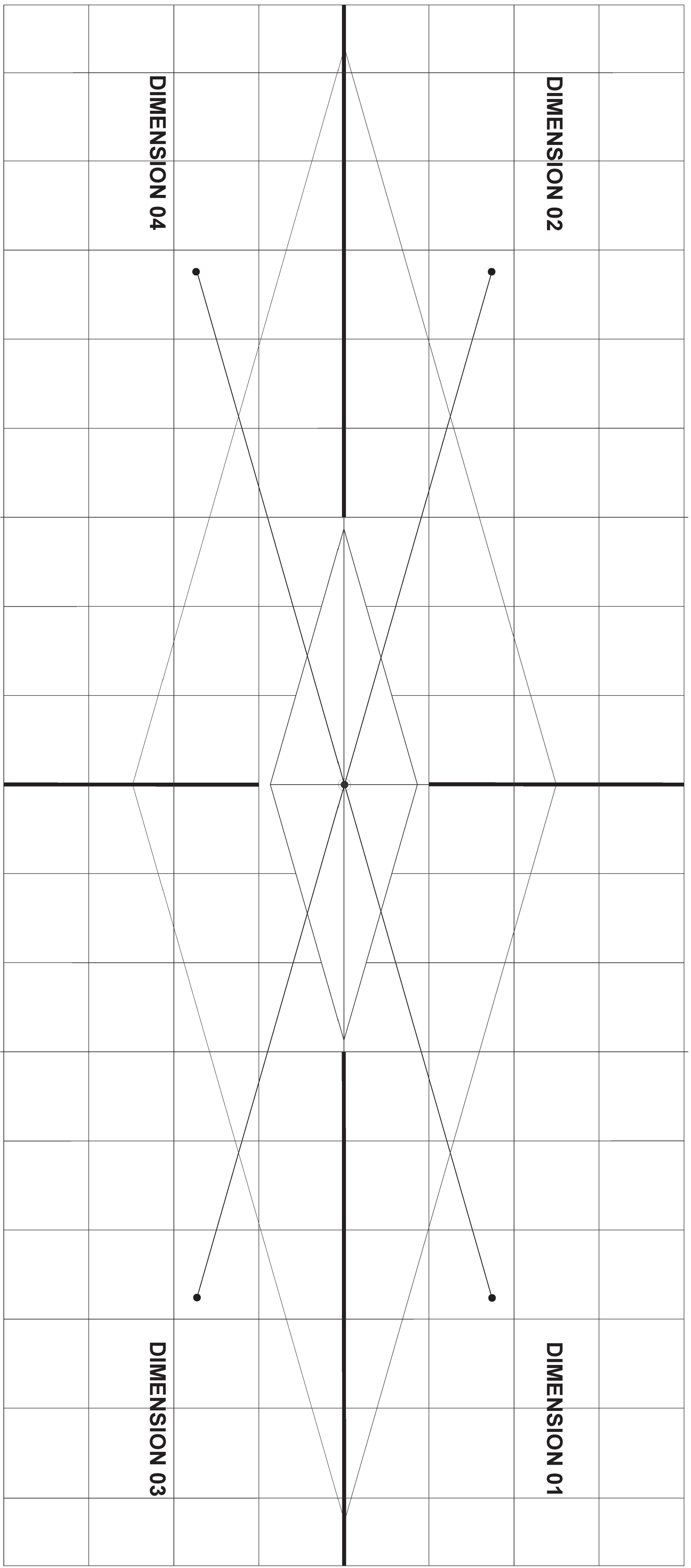

4 DIMENSIONAL DEGREES/ 4 ΒΑΘΜΟΙ ΔΙΑΣΤΑΣΕΩΝ

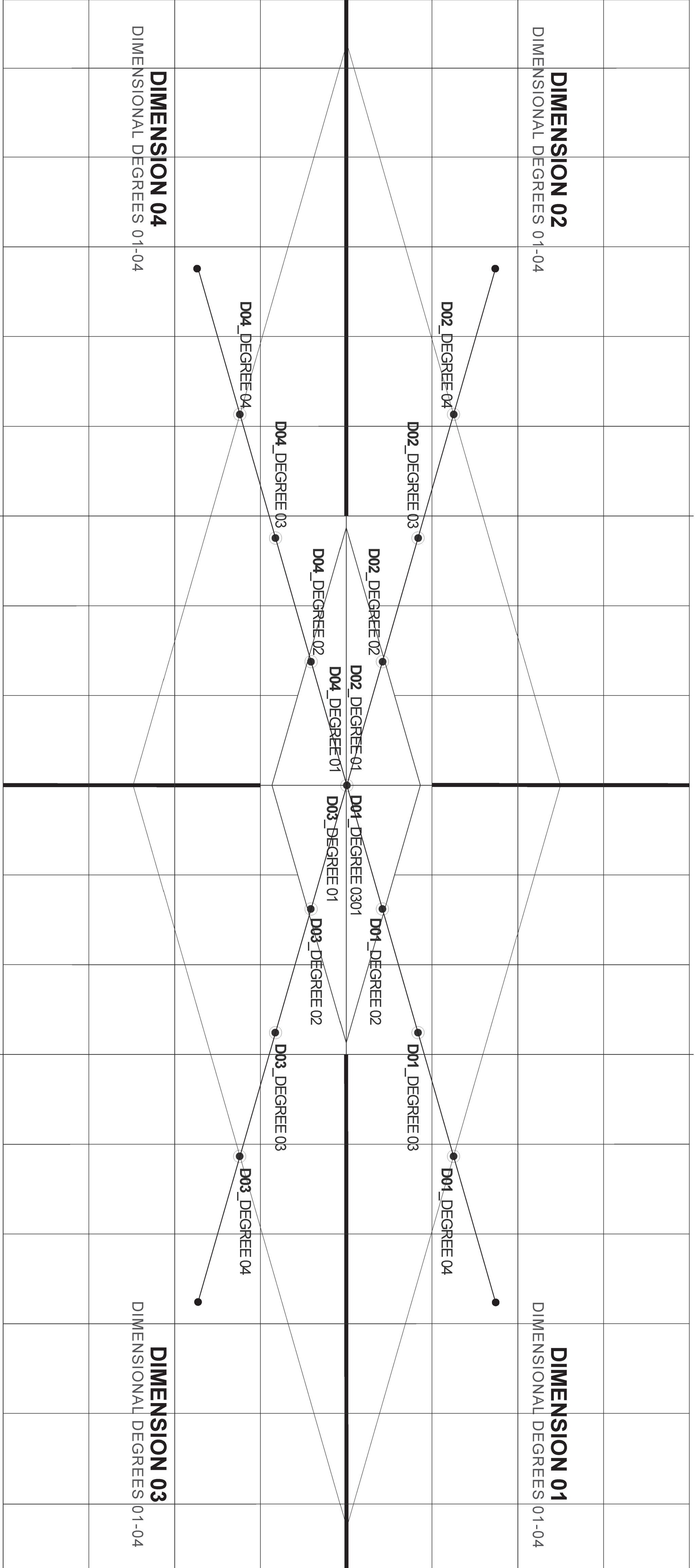

6 MICRO-SYSTEMS / 6 MIKPO-SYSTMATA

36. DEGREES OF PUBLICNESS

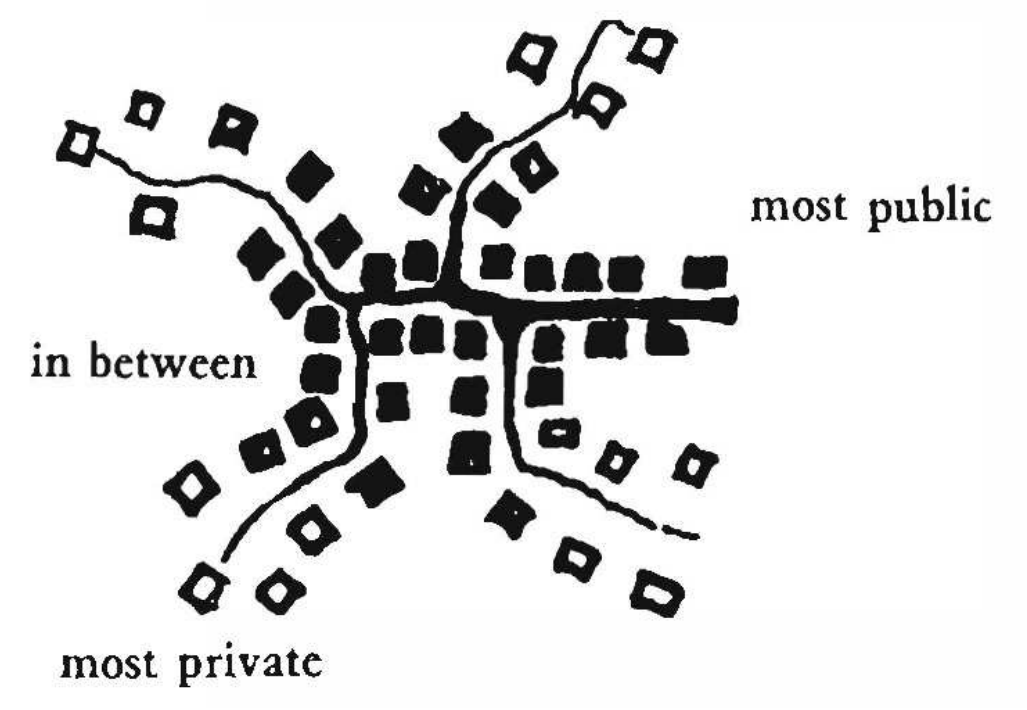

66. HOLY GROUND

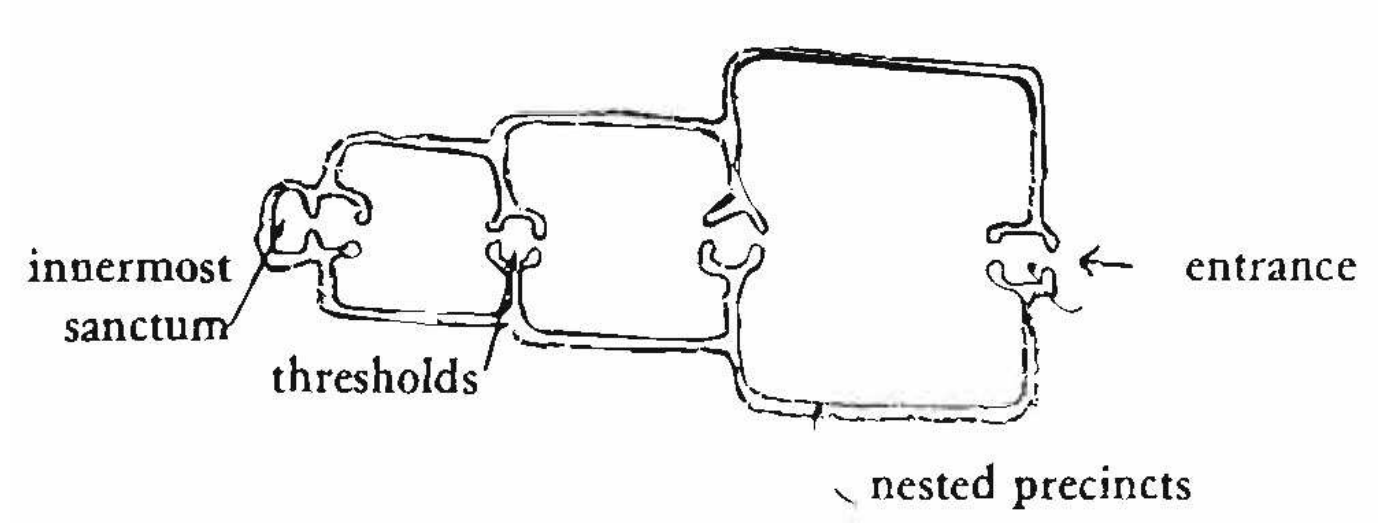

98. CIRCULATION REALMS

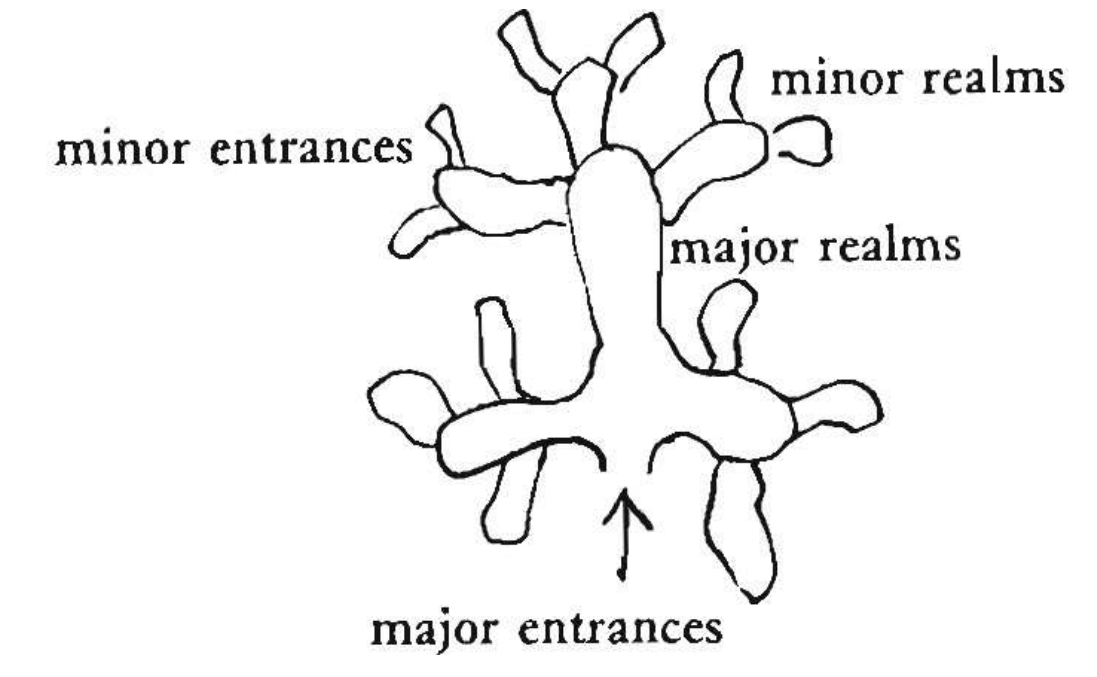

127. INTIMACY GRADIENT

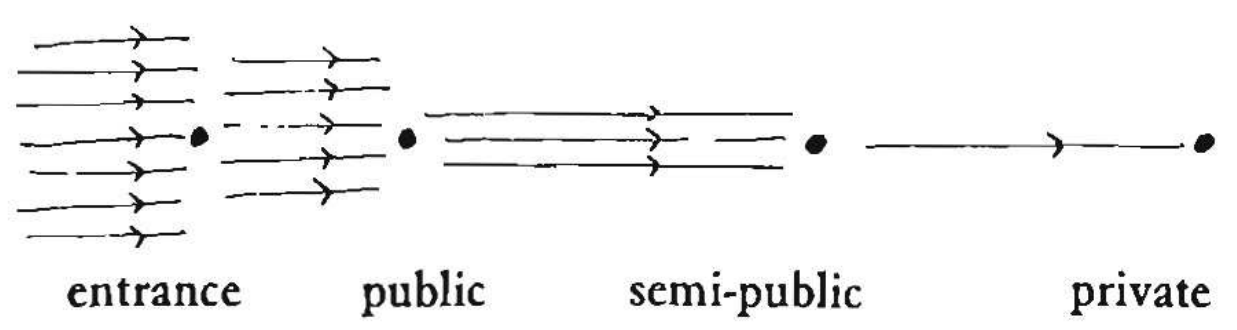

142. SEQUENCE OF SITTING SPACES

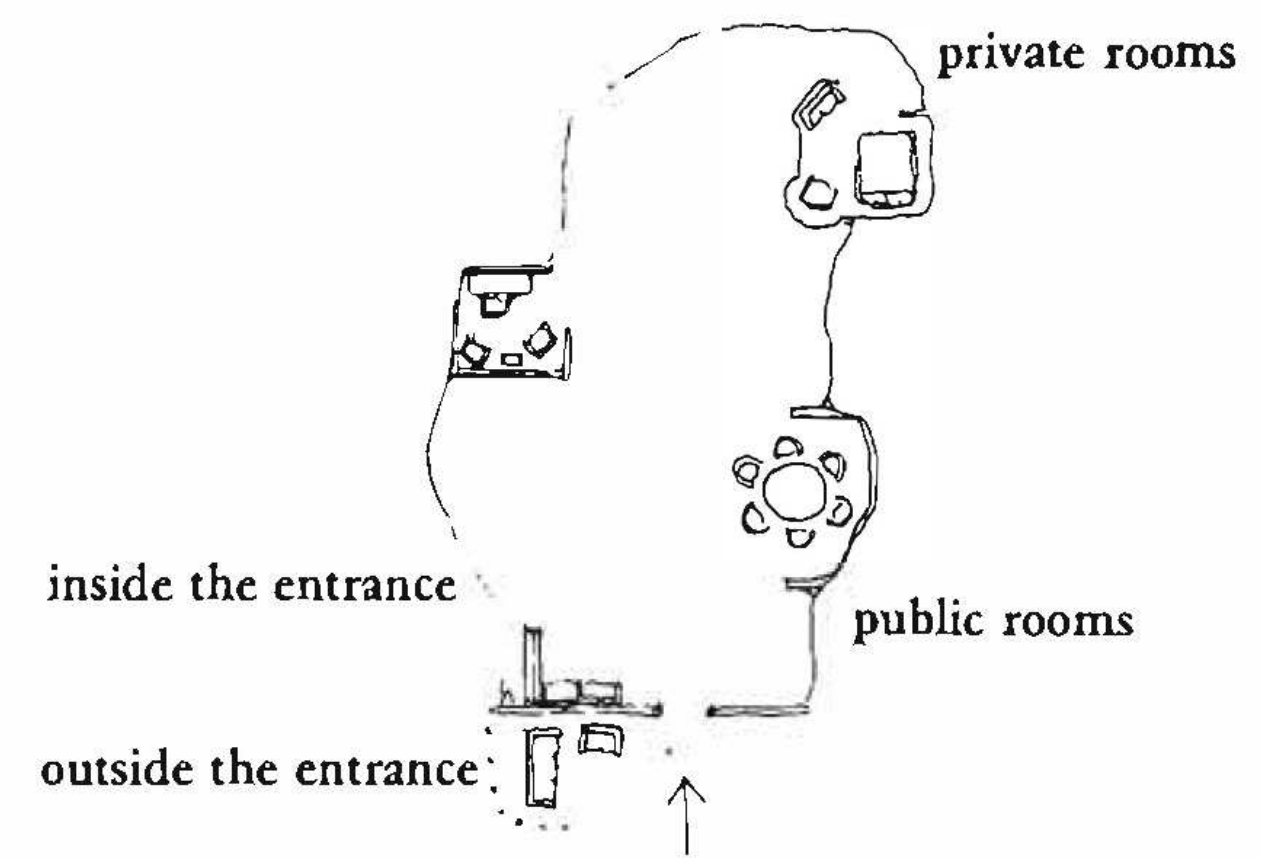

193. HALF-OPEN WALL

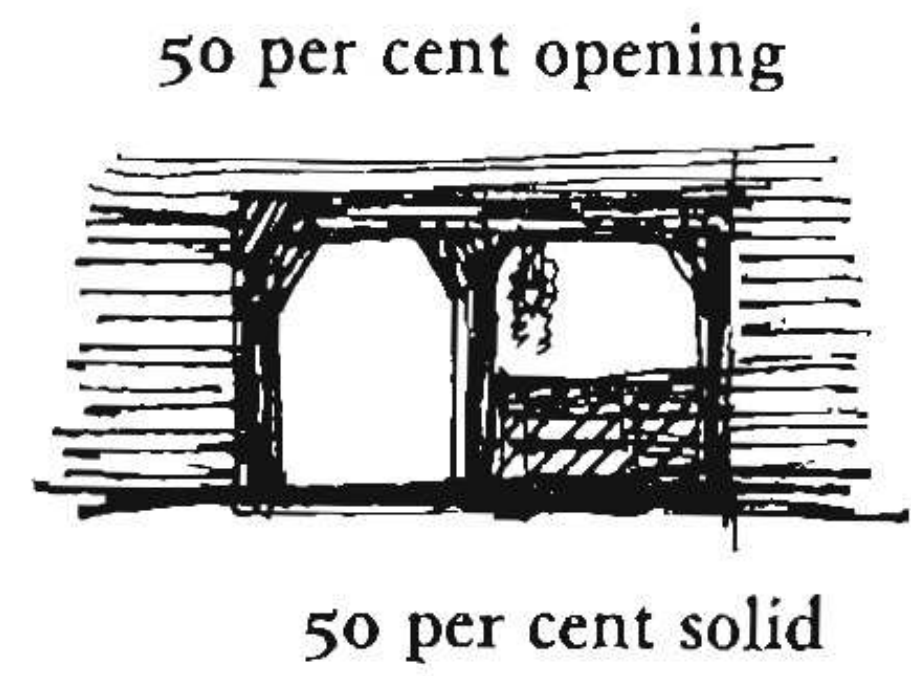

**SEMANTIC
SCALES /
ΣΗΜΑΣΙΟΛΟΓΙΚΕΣ
ΚΛΙΜΑΚΕΣ**

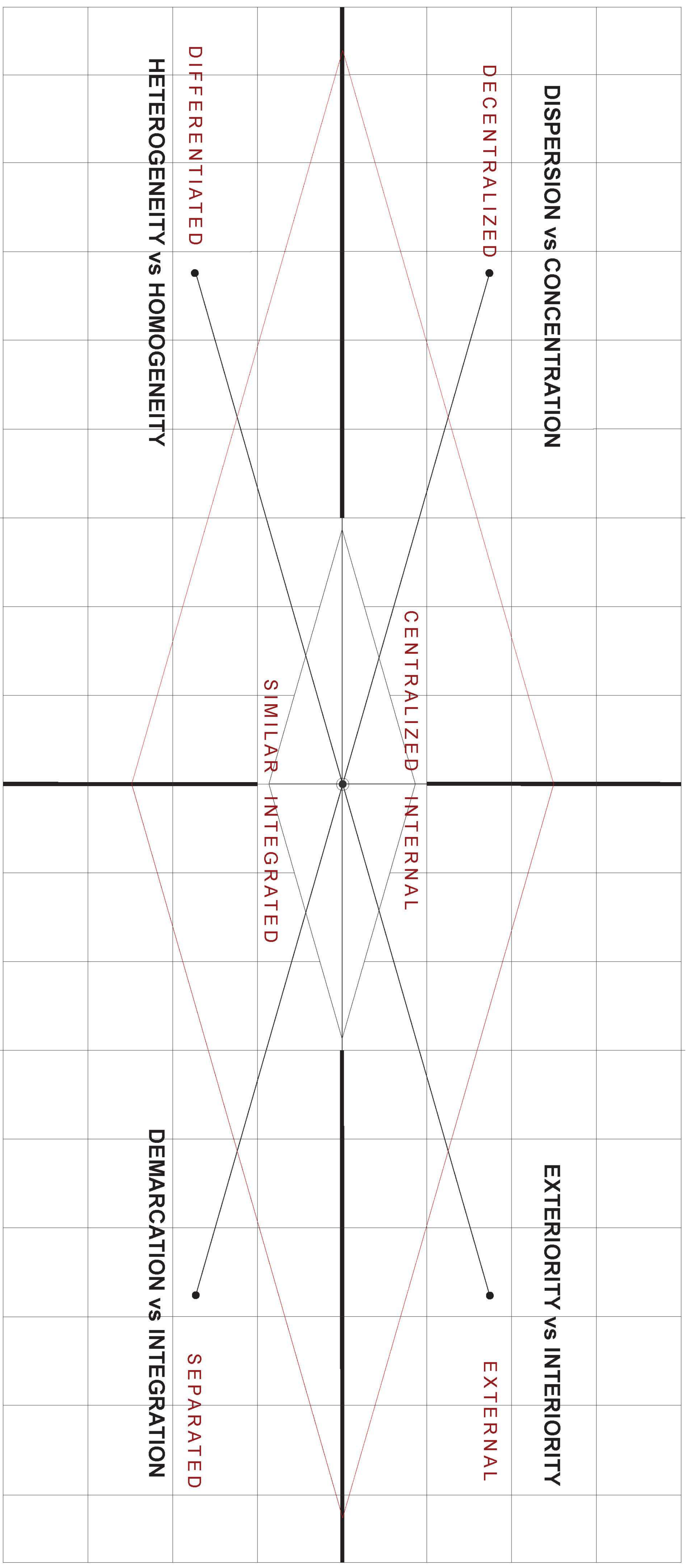

4-CRITERIA LIST / 4 ΚΡΙΤΗΡΙΑ ΟΜΟΙΩΣΗΣ

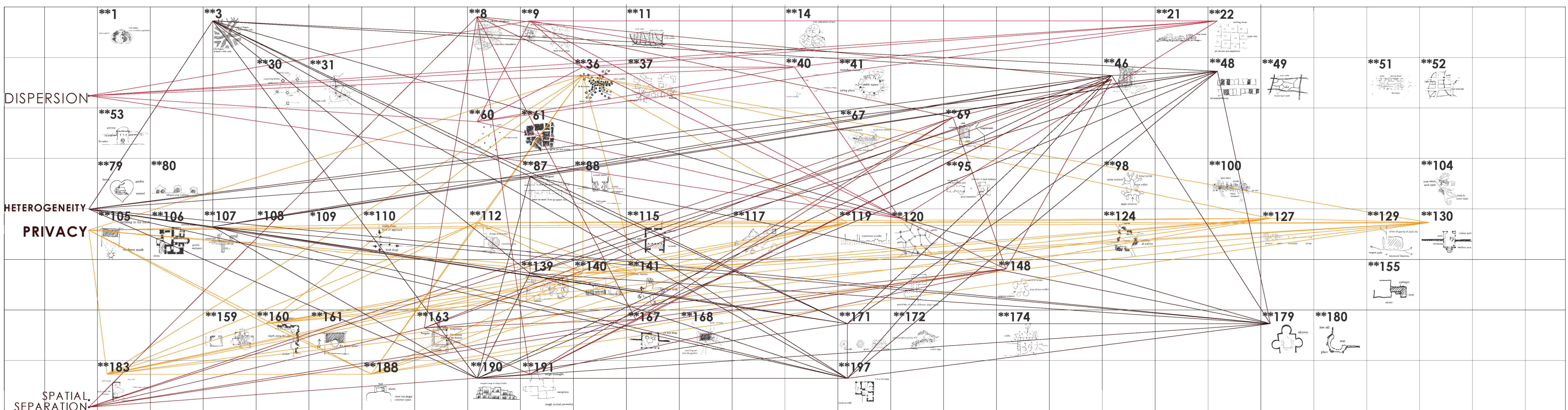

DESIGN PATTERNS 66

CRITERIA LIST 4

CRITERIA LIST DISPERSION, HETEROGENEITY, PRIVACY, SPATIAL SEPARATION

12-CRITERIA LIST /
12 ΚΡΙΤΗΡΙΑ ΟΜΟΙΩΣΗΣ

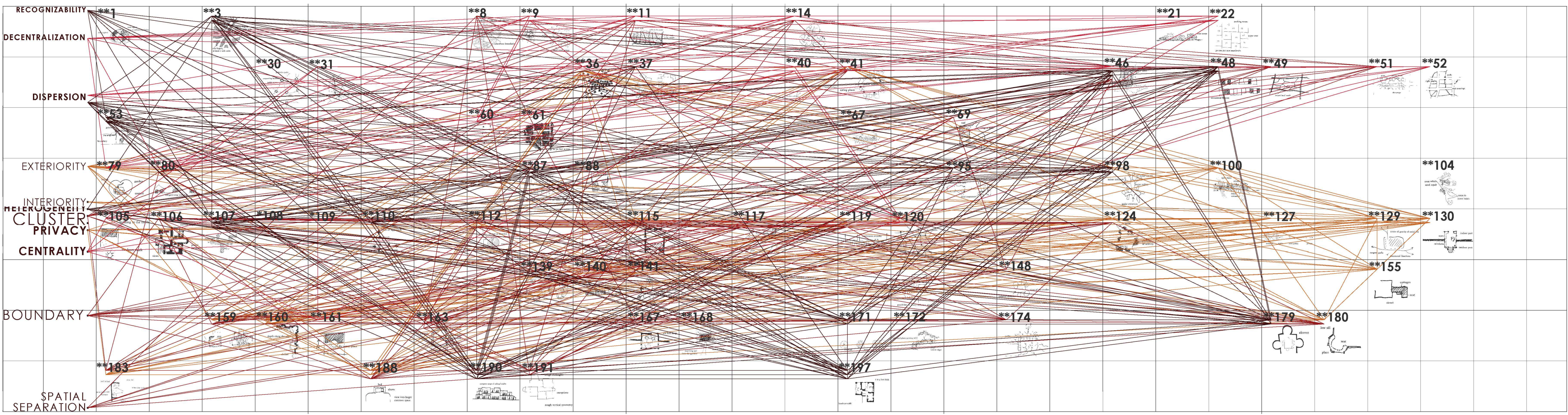

DESIGN PATTERNS 66

12-CRITERIA LIST 12

LIST RECOGNIZABILITY, DECENTRALIZATION, DISPERSION, EXTERIORITY, INTERIORITY, HETEROGENEITY, CLUSTERS, CENTRALITY, BOYNDARY, SPATIAL SEPARATION

THE CITY'S
4 DIMENSIONS /
ΟΙ 4 ΔΙΑΣΤΑΣΕΙΣ
ΤΗΣ ΠΟΛΗΣ

DISPERSION					EXTERIORITY																										
	**21		**3		**9		**40		**79		**105		**161		**120		**141		**155		**159		**160		**180		**188				
DISPERSION					EXTERIORITY																										
HETEROGENEITY										DEMARICATION																					
	**95		**87		**31		**30		**22		**61		**67		**88		**100		**104		**112		**124		**127		**140				
	**130		**129		**110		**107		**98		**148		**163		**167		**168		**172		**174		**179		**183		**191				
	**197		**190		**171		**139		**14		**41		**51		**69		**80		**106		**111		**189		**192		**193				

DIMENSIONAL "DEMES" / ΟΙ "ΔΗΜΟΙ" ΤΩΝ ΔΙΑΣΤΑΣΕΩΝ

		<p>**161 the sunny place</p> <p>**120 paths</p> <p>**141 dead end</p> <p>**155 cottages</p> <p>**159</p> <p>**160 depth along the edge</p> <p>**180 place</p> <p>**188 bed alcove</p>		
	<p>**105 building to the earth</p> <p>**79 garden control</p> <p>**60 garden</p> <p>**52 paths</p> <p>**115 dead end</p> <p>**117 street</p> <p>**119</p> <p>**124 place</p> <p>**127 place</p> <p>**140</p>	<p>**31 garden control</p> <p>**30 paths</p> <p>**22 paths</p> <p>**61 paths</p> <p>**67 paths</p> <p>**88 paths</p> <p>**100 paths</p> <p>**104 paths</p> <p>**112 paths</p>	<p>**115 dead end</p> <p>**117 street</p> <p>**119</p> <p>**124 place</p> <p>**127 place</p> <p>**140</p>	
<p>DISPERSION VS CONCENTRATION</p> <p>**9 paths</p> <p>**40 paths</p> <p>**31 paths</p> <p>**30 paths</p> <p>**22 paths</p> <p>**61 paths</p> <p>**67 paths</p> <p>**88 paths</p> <p>**100 paths</p> <p>**104 paths</p> <p>**112 paths</p>	<p>**9 paths</p> <p>**31 paths</p> <p>**30 paths</p> <p>**22 paths</p> <p>**61 paths</p> <p>**67 paths</p> <p>**88 paths</p> <p>**100 paths</p> <p>**104 paths</p> <p>**112 paths</p>	<p>**31 paths</p> <p>**30 paths</p> <p>**22 paths</p> <p>**61 paths</p> <p>**67 paths</p> <p>**88 paths</p> <p>**100 paths</p> <p>**104 paths</p> <p>**112 paths</p>	<p>**31 paths</p> <p>**30 paths</p> <p>**22 paths</p> <p>**61 paths</p> <p>**67 paths</p> <p>**88 paths</p> <p>**100 paths</p> <p>**104 paths</p> <p>**112 paths</p>	<p>EXTERIORITY VS INTERIORITY</p>
<p>HETEROGENEITY VS HOMOGENEITY</p> <p>**21 paths</p> <p>**95 paths</p> <p>**87 paths</p> <p>**53 paths</p> <p>**48 paths</p> <p>**46 paths</p> <p>**14 paths</p> <p>**41 paths</p> <p>**51 paths</p> <p>**69 paths</p> <p>**80 paths</p> <p>**106 paths</p>	<p>**21 paths</p> <p>**95 paths</p> <p>**87 paths</p> <p>**53 paths</p> <p>**48 paths</p> <p>**46 paths</p> <p>**14 paths</p> <p>**41 paths</p> <p>**51 paths</p> <p>**69 paths</p> <p>**80 paths</p> <p>**106 paths</p>	<p>**21 paths</p> <p>**95 paths</p> <p>**87 paths</p> <p>**53 paths</p> <p>**48 paths</p> <p>**46 paths</p> <p>**14 paths</p> <p>**41 paths</p> <p>**51 paths</p> <p>**69 paths</p> <p>**80 paths</p> <p>**106 paths</p>	<p>**21 paths</p> <p>**95 paths</p> <p>**87 paths</p> <p>**53 paths</p> <p>**48 paths</p> <p>**46 paths</p> <p>**14 paths</p> <p>**41 paths</p> <p>**51 paths</p> <p>**69 paths</p> <p>**80 paths</p> <p>**106 paths</p>	<p>DEMARCATON VS INTEGRATION</p>
<p>**130 paths</p> <p>**129 paths</p> <p>**110 paths</p> <p>**190 paths</p> <p>**171 paths</p> <p>**139 paths</p> <p>**148 paths</p> <p>**163 paths</p> <p>**167 paths</p> <p>**168 paths</p> <p>**172 paths</p> <p>**174 paths</p>	<p>**130 paths</p> <p>**129 paths</p> <p>**110 paths</p> <p>**190 paths</p> <p>**171 paths</p> <p>**139 paths</p> <p>**148 paths</p> <p>**163 paths</p> <p>**167 paths</p> <p>**168 paths</p> <p>**172 paths</p> <p>**174 paths</p>	<p>**130 paths</p> <p>**129 paths</p> <p>**110 paths</p> <p>**190 paths</p> <p>**171 paths</p> <p>**139 paths</p> <p>**148 paths</p> <p>**163 paths</p> <p>**167 paths</p> <p>**168 paths</p> <p>**172 paths</p> <p>**174 paths</p>	<p>**130 paths</p> <p>**129 paths</p> <p>**110 paths</p> <p>**190 paths</p> <p>**171 paths</p> <p>**139 paths</p> <p>**148 paths</p> <p>**163 paths</p> <p>**167 paths</p> <p>**168 paths</p> <p>**172 paths</p> <p>**174 paths</p>	
<p>**197 paths</p> <p>**190 paths</p> <p>**171 paths</p> <p>**139 paths</p> <p>**179 paths</p> <p>**183 paths</p> <p>**191 paths</p>	<p>**197 paths</p> <p>**190 paths</p> <p>**171 paths</p> <p>**139 paths</p> <p>**179 paths</p> <p>**183 paths</p> <p>**191 paths</p>	<p>**197 paths</p> <p>**190 paths</p> <p>**171 paths</p> <p>**139 paths</p> <p>**179 paths</p> <p>**183 paths</p> <p>**191 paths</p>	<p>**197 paths</p> <p>**190 paths</p> <p>**171 paths</p> <p>**139 paths</p> <p>**179 paths</p> <p>**183 paths</p> <p>**191 paths</p>	
<p>**197 paths</p>	<p>**197 paths</p>	<p>**197 paths</p>	<p>**197 paths</p>	

DIMENSIONAL DEGREES / ΒΑΘΜΟΙ ΔΙΑΣΤΑΣΕΩΝ

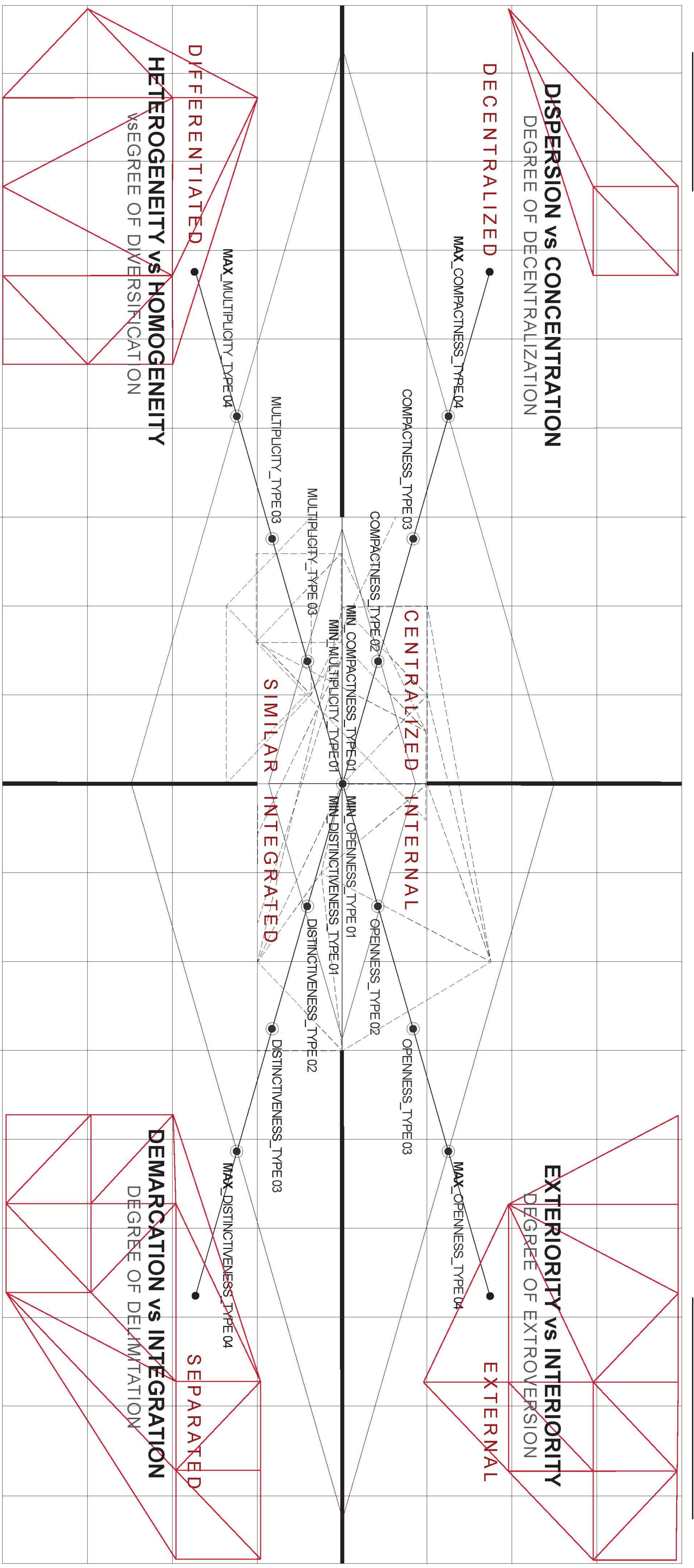



[DIVERGENT PHASE]

[ACTUAL DOMAIN]

[PROPERTIES OF FORM]

[GEOMETRIC PROPERTIES]

[MATERIAL PROPERTIES]

[QUALITATIVE PROPERTIES]

[TOWARDS]

[QUANTITY]

[MATTER]

[STRUCTURE]

[SPATIAL OBJECTS] [ASSEMBLAGES]

[relations of material and expressive components]

[processes of stabilization assemblage's identity]

[A-SIGNIFYING SIGNS] or [a-signs]

[AFFECTS]

[A]

[001] AFFILIATIONS
 [002] AMBIGUITY
 [003] ANTIGRAVITY
 [004] APPLIED SIGN
 [005] AURAL CONTINUITY
 [006] AMORPHOUS

[B]

[007] BLACK-STUFF
 [008] BLANKNESS
 [009] BLURINESS
 [010] BORROWED LANDSCAPES
 [011] BOX-WITHIN_BOX

[C]

[012] CAMOUFLAGE
 [013] CARTESIAN GRID
 [014] CINEMATIC TECHNIQUES
 [015] CLEAR STRUCTURE
 [016] CONNOTATION
 [017] CONTINUITY
 [018] CRITICAL MASS
 [019] CROSS PROGRAMMING

[D]

[020] DEFAMILIARIZATION
 [021] DEMATERIALISATION
 [022] DIAGRID
 [023] DIAGONALISATION
 [024] DISCONTINUOUS
 [025] DISESTABLISHING REDUCTION
 [026] DISORIENTATION
 [027] DISPOSITION
 [028] DIVERSITY

[E]

[029] ECCENTRICITY
 [030] ELASTICITY
 [031] EMERGENT GRID
 [032] EMTPINNESS
 [033] EPHEMERALITY
 [034] EXPERIMENTAL LAYERING
 [035] EXTERNAL TEXTS

[F]

[036] FACIALITY
 [037] FIGURE/GROUND
 [038] FLUID DYNAMICS
 [039] FRAGMENT
 [040] FREE-SECTION
 [041] FOLDING

[G]

[042] GAP
 [043] GRADATION OF DOMAIN
 [044] GRAPHIC PATTERNS TO GLASS

[H]

[045] HOUSE WITHIN A HOUSE

[I]

[046] IMPERMANENCE
 [047] INCONGRUENCE
 [048] INDISCERNIBILITY
 [049] INTENSIVE COHERENCE
 [050] ISOLATION

[J]**[K]**

[051] KINETIC

[L]**[M]**

[052] MASKING
 [053] MATERIALITY
 [054] MOIRRE
 [055] MUTUAL EVOCATIONS

[N]

[056] NEUTRAL ZONES
 [057] NO AXIAL ORIENTATION
 [058] NOISE

[O]

[059] OPEN ENFOLDNESS
 [060] OPENESS
 [061] ORNAMENT

[P]

[062] PERFORMATIVE FORM
 [063] PERFORMATIVE PATTERN
 [064] PLEATED
 [065] POINTING
 [066] POROSITY

[Q]**[R]**

[067] RADICAL PASSIVITY
 [068] RANDOMNESS
 [069] RESILIENCE
 [070] RYTHM

[S]

[071] SCALELESS
 [072] SECOND NATURE
 [073] SEMI-LATICCE
 [074] SEMI-PERMEABLE MEMBRANE
 [075] SEMI-SECLUSION
 [076] SEMI-TRANSPARENT
 [077] SINGLE-SURFACE TECHNIQUE
 [078] SINKING ROOM
 [079] SLIT WINDOWS
 [080] SPASM
 [081] STILLNESS
 [082] STRUCTURE VANISH
 [083] SUPERPOSITION
 [084] SUPERSATURATION
 [085] SUPERGRAPHIC

[T]

[086] TRANSPARENCY
 [087] TRANSVERSALITY

[U]

[088] USE OF SPACE vs FUNCTION
 [089] UTSUROI | FEEL TIME
 CHANGING

[V]

[090] VAGUENESS
 [091] VASTNESS
 [092] VARIATION [TEXTURE/COLOR]
 [093] VILLAGE WITHIN A HOUSE

[V]

[093] VILLAGE WITHIN A HOUSE
 [094] VISUAL DEPTH
 [095] VISUAL LIGHTNESS
 [096] VISUAL OBJECTS
 [097] VISUAL VIBRATION

[097] WEAK FORM / DEGREE ZERO
 [099] WETGRID

[W]

[100] ZERO DEGREE

[Z]



A-SIGNS 4

AFFECTS 21

PROJECTS 4

DIAGONALIZATION/ ΔΙΑΓΩΝΟΠΟΙΗΣΗ FORM • SPACE • SURFACE

1. SEDAI MEDIATHEQUE_TOYO ITO_SENDAI, JAPAN_2000
2. OMA_EURALILLE:CENTRE INTERNATIONAL D'AFFAIRES_-LILLE, FRANCE_1996
3. MVRDV_VILLA PRO_HILVERSUM, THE NETHERLANDS_1997
4. NOX_SOFTOFFICE_UK_2005

[AXIALITY]
[CONTINGENCY]
[DIAGONALITY]
[DIRECTIONALITY]
[OPENESS]
[SERIALITY]
[SYMMETRY]

AFFECTS



A-SIGNS 4

AFFECTS 21

PROJECTS 4

3. MVRDV_VILLA PRO_HILVERSUM, THE NETHERLANDS_1997

DIAGONALIZATION/
ΔΙΑΓΩΝΟΠΟΙΗΣΗ
 FORM • SPACE • SURFACE

1. SEDAI MEDIATHEQUE_TOYO ITO_SENDAI, JAPAN_2000
2. OMA_EURALILLE:CENTRE INTERNATIONAL D'AFFAIRES_-LILLE, FRANCE_1996
3. MVRDV_VILLA PRO_HILVERSUM, THE NETHERLANDS_1997
4. NOX_SOFTOFFICE_UK_2005

[AXIALITY]
 [CONTINGENCY]
[DIAGONALITY]
 [DIRECTIONALITY]
 [OPENESS]
 [SERIALITY]
 [SYMMETRY]

AFFECTS



A-SIGNS 4

AFFECTS 21

PROJECTS 4

3. MVRDV_VILLA PRO_HILVERSUM, THE NETHERLANDS_1997

AFFECTS

DIAGONALIZATION/
ΔΙΑΓΩΝΟΠΟΙΗΣΗ
FORM • SPACE • SURFACE

1. SEDAI MEDIATHEQUE_TOYO ITO_SENDAI, JAPAN_2000
2. OMA_EURALILLE:CENTRE INTERNATIONAL D'AFFAIRES_-LILLE, FRANCE_1996
3. MVRDV_VILLA PRO_HILVERSUM, THE NETHERLANDS_1997
4. NOX_SOFTOFFICE_UK_2005

[AXIALITY]
[CONTINGENCY]
[DIAGONALITY]
[DIRECTIONALITY]
[OPENESS]
[SERIALITY]
[SYMMETRY]



A-SIGNS 4

AFFECTS 21

PROJECTS 4

3. MVRDV_VILLA PRO_HILVERSUM, THE NETHERLANDS_1997

AFFECTS

DIAGONALIZATION/
ΔΙΑΓΩΝΟΠΟΙΗΣΗ
FORM•SPACE•SURFACE

1. SEDAI MEDIATHEQUE_TOYO ITO_SENDAI, JAPAN_2000
2. OMA_EURALILLE:CENTRE INTERNATIONAL D'AFFAIRES_-LILLE, FRANCE_1996
3. MVRDV_VILLA PRO_HILVERSUM, THE NETHERLANDS_1997
4. NOX_SOFTOFFICE_UK_2005

[AXIALITY]
[CONTINGENCY]
[DIAGONALITY]
[DIRECTIONALITY]
[OPENESS]
[SERIALITY]
[SYMMETRY]



A-SIGNS 4

AFFECTS 21

PROJECTS 4

3. MVRDV_VILLA PRO_HILVERSUM, THE NETHERLANDS_1997

DIAGONALIZATION/
ΔΙΑΓΩΝΟΠΟΙΗΣΗ
FORM•SPACE•SURFACE

1. SEDAI MEDIATHEQUE_TOYO ITO_SENDAI, JAPAN_2000
2. OMA_EURALILLE:CENTRE INTERNATIONAL D'AFFAIRES_-LILLE, FRANCE_1996
3. MVRDV_VILLA PRO_HILVERSUM, THE NETHERLANDS_1997
4. NOX_SOFTOFFICE_UK_2005

[AXIALITY]
[CONTINGENCY]
[DIAGONALITY]
[DIRECTIONALITY]
[OPENESS]
[SERIALITY]
[SYMMETRY]

AFFECTS



A-SIGNS 4

AFFECTS 21

PROJECTS 4

3. MVRDV_VILLA PRO_HILVERSUM, THE NETHERLANDS_1997

DIAGONALIZATION/
ΔΙΑΓΩΝΟΠΟΙΗΣΗ
FORM•SPACE•SURFACE

1. SEDAI MEDIATHEQUE_TOYO ITO_SENDAI, JAPAN_2000
2. OMA_EURALILLE:CENTRE INTERNATIONAL D'AFFAIRES_-LILLE, FRANCE_1996
3. MVRDV_VILLA PRO_HILVERSUM, THE NETHERLANDS_1997
4. NOX_SOFTOFFICE_UK_2005

[AXIALITY]
[CONTINGENCY]
[DIAGONALITY]
[DIRECTIONALITY]
[OPENESS]
[SERIALITY]
[SYMMETRY]

AFFECTS

A-SIGNS**AFFECTS****PROJECTS**LIST /
A-SIGNIFYING SIGNS

[001] AFFILIATIONS
[FO] [ST] [SC] [SP]

[AGGREGATED] [AMBIGUOUS] [AMORPHOUS]
[ASYMMETRY] [AXIALITY] [BLURINESS]
[COMPLEXITY] [CONTINGENCY]
[DIFFERENTIATED] [DISCONTINUOUS]
[DISSIPATION] [DISJUNCTION]
[DIVERSITY] [INSTABILITY] [PLEATED]
[OPENESS] [OPEN-ENDNESS] [RELIEF]
[TONALITY] [VAGUENESS] [VERTICALITY]

1.EASTREN DESIHM OFFICE_SLIT
HOUSE_SHIGA/JAPAN_2005
2.KENGO KUMA_Z58 OFFICES_SANGAI,
CHINA_2008

[002] AMBIGUITY
[FO] [ST] [SC] [SU]

[AMBIGUITY] [ASYMMETRY] [BLURINESS]
[COMPLEXITY] [CONTINGENCY]
[DEMATERIALIZED] [DISCONTINUOUS]
[DISJUNCTION] [DISORIENTATION]
[DIVERSITY] [FLEXIBILITY] [FLUIDITY]
[INSTABILITY] [VAGUENESS]

1.JUN AOKI_LOUIS VUITTON NAGOYA
STORE_2004_TOKYO, JAPAN
2.PETER EISENMAN_HOUSE II_1970_VER-
MONT, USA

[A]

[003] ANTIGRAVITY
[FO] [ST] [SC] [SU]

[DECONSTRUCTION] [DEMATERIALIZED]
[DIFFERENTIATED] [DISCONTINUOUS]
[EFFORTLESS] [INSUBSTANTIALITY]
[SCALES] [WEIGHTLESSNESS]

1.ATELIER TEKUTO_MAGRITTE HOUSE_-
JAPAN_2007

[004] APPLIED SIGN
[FO] [ST] [SC] [SU]

[AFFINITY] [AMBIGUOUS] [ASYMMETRY]
[BLURINESS] [COMPLEXITY] [CONTINGENCY]
[DIFFERENTIATION] [DISCONTINUOUS]
[DISCREPANCY] [DISORIENTATION]
[DISSIPATION] [DUPLICITY] [MODULARITY]
[MUTATION] [INTSBILITY] [VAGUNESS]

1.TOYO ITO_TAMA ART LIBRARY_JAPAN_2007

[005] AURAL CONTINUITY
[FO] [ST] [SC] [SU]

[AFFINITY] [GRADATION] [FLUIDITY]
[INSUBSTANTIALITY] [SERIALITY]
[TONALITY]

1.TOYO ITO_WHITE U HOUSE_TOKYO,
JAPAN_1976
2.JUNYA ISHIGAMI_KAIT WORKSHOP_KANAGA-
WA, JAPAN
3.SANAA_ROLEX LEARNING CENTRE_EPFL
LAUSANNE_2010
4.SOU FUJIMOTO_HOUSE NA_TOKYO,-
JAPAN_2011

[006] AMORPHOUS
[FO] [ST] [SC] [SU]

[A-CENTRICITY] [AMBIGUOUS] [ASYMME-
TRY] [BLURINESS] [COMPLEXITY] [DIF-
FERENTIATED] [DISCONTINUOUS]
[DISORIENTED] [DIVERSITY] [FLUIDITY]
[GRADATION] [MUTATION] [ANAPΛYΦOTHTA]

1.FUTURE SYSTEMS_SELFRIDGES DEPARTMENT
STORE_BIRMINGHAM, UK_2003
2.KENGO KUMA_SHIMONOSEKI-SHI KAWATANA

EXTROVERSION

[exteriority] < - - - - -> [interiority]

DELIMITATION

[demarcation] < - - - - -> [integration]

DECENTRALISATION

[concentration] < - - - - -> [dispersion]

DIVERSIFICATION

[homogeneity] < - - - - -> [heterogeneity]

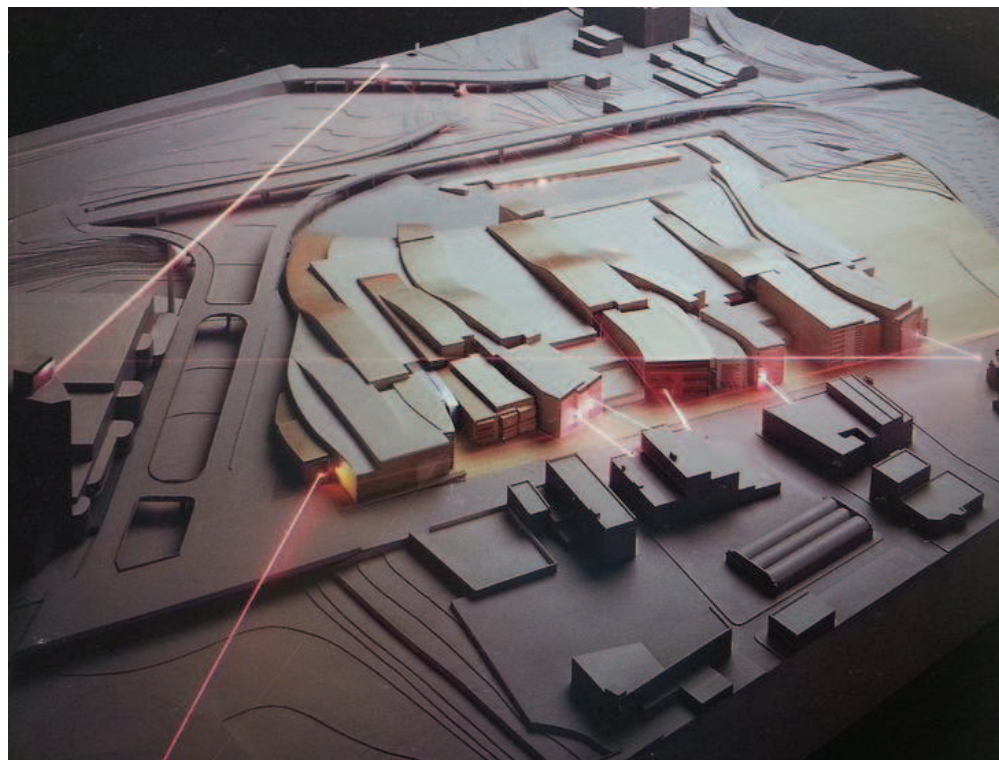

AFFILIATIONS/
 ΣΥΣΧΕΤΙΣΕΙΣ
FORM • STRUCTURE • SURFACE

1. PETER EISENMAN_GREAT COLOMBUS CONVENTION CENTER, COLOMBUS, OHIO_1990-1993 [form]
2. FRANK O. GEHRY_VITRA DESIGN MUSEUM, WEIL AM REIN, GERMANY_1989 [form]
3. SHOEI YOH_ODAWARA SPORTS COMPLEX [form]
4. SHIRRED, ZAGO_NATIONAL MUSEUM OF SCOTLAND

A-SIGNS 4

AFFECTS 21

PROJECTS 4

[AGGREGATED]
 [AMBIGUOUS]
 [AMORPHOUS]
 [ASYMMETRY]
 [AXIALITY]
 [BLURINESS]
 [COMPLEXITY]
[CONTIGENCY]
 [DIFFERENTIATED]
 [DISCONTINUOUS]
 [DISSIPATION]
 [DISJUNCTION]
 [DIVERSITY]
 [PLEATED]
 [OPENESS]
 [OPEN-ENDNESS]
 [RELIEF]
 [TONALITY]
 [INSTABILITY]
 [VAGUENESS]
 [VERTICALITY]

1. PETER EISENMAN_GREAT COLOMBUS CONVENTION CENTER, COLOMBUS, OHIO_1990-1993

AFFECTS

FORM • SPACE • SURFACE
 ΔANEIKA TOPIA
BORROWED LANDSCAPES /

1. KAZUO SHINOHARA_TANIKAWA HOUSE_NAGANO, JAPAN_1974 [L]
 2. TOYO ITO & ASSOCIATES_SENDAI MEDIATHEQUE_SENDAI, JAPAN_1998
 3. KAZUYO SEJIMA + RYUE NISHIZAWA / SANAA ZOLLVEREIN SCHOOL OF MANAGEMENT AND DESIGN_Essen, Germany_2006
 4. KENGO KUMA_Z58 OFFICES_SANGAI, CHINA_2008

[AFFINITY]
 [ALTERNATED]
 [DIVERSITY]
 [GRADATION]
[OPENESS]
 [RELIEF]
 [VAGUENESS]
 [WEIGHTLESS]

AFFECTS



.....
 9 A-SIGNS

.....
 8 AFFECTS

.....
4 PROJECTS

.....
3. KAZUYO SEJIMA + RYUE NISHIZAWA / SANAA ZOLLVEREIN SCHOOL OF MANAGEMENT AND DESIGN_ESSEN, GERMANY_2006



A-SIGNS 9

AFFECTS 31

PROJECTS 2

1. KAZUO SHONOHARA_HOUSE IN UEHARA_SHIBUYA, TOKYO_1973

FACIALITY/
ΜΕΤΩΠΙΚΟΤΗΤΑ
 FORM • SPACE • SURFACE

1. KAZUO SHONOHARA_HOUSE IN
 UEHARA_SHIBUYA, TOKYO_1973
 2. SHIN TAKAMATSU_SAPPORO_TOKYO,
 JAPAN_1989

[AFFINITY]
 [AGGREGATED]
 [AMBIGUOUS]
 [AMORPHOUS]
 [ASYMMETRIC]
 [BLURINESS]
 [COMPLEX]
 [CONTIGENT]
 [DECONSTRUCTED]
 [DIFFERENTIATED]
 [DISCONTINUOUS]
 [DISCREPANCY]
 [DISJUNCTION]
 [DISSIPATION]
 [DISORIENTATION]
 [DIVERSITY]
 [DUPLICITY]
 [FLATNESS]
 [FLUTED]
 [GRADATION]
 [PLEATED]
 [POROSITY]
 [RELIEF]
 [SCALELESS]
 [SERIALITY]
 [SOFTNESS]
 [SLENDERNESS]
 [TONALITY]
 [INSTABILITY]
 [VERTICALITY]
 [WEIGHTLESS]

AFFECTS

FORM•STRUCTURE•SURFACE
ΠΑΡΑΘΥΡΑ ΣΧΙΣΜΕΣ
SLIT OPENINGS/

1. EASTREN DESIHM
OFFICE_SLIT HOUSE_SHIGA/
JAPAN_2005
2.KENGO KUMA_Z58 OFFIC-
ES_SANGAI, CHINA_2008



[AXIALITY]
[DEMATERIALIZATION]
[DIVERSITY]
[FLUIDITY]
[GRADATION]
[INTER-CHANGEABILITY]
[POROSITY]
[SCALELESS]
[SERIALITY]
[SMOOTHNESS]
[TONALITY]
[TWO-DIMENSIONALITY]
[VERTICALITY]

AFFECTS

5 A-SIGNIFYING SIGNS

13 AFFECTS

2 PROJECTS

1. EASTERN DESIGN OFFICE_SLIT HOUSE_SHIGA/JAPAN_2005

DELIMITATION

[demarkation] <-----> [integration]



BOX_WITHIN_BOX/
 ΧΩΡΟΣ ΜΕΣΑ ΣΕ ΧΩΡΟ
 FORM • STRUCTURE • SURFACE

1. HIROMI FUJI_MARUTAKE BUILDING_TOKYO, JAPAN_1976
2. REM KOOLHAAS_ZENTUM FUR KUNST UND MEDIETECHNOLOGIE_KARLSRUHE, GERMANY_1989
3. BERNARD TSCHUMI_LE FRESNOY_TOURSOING, FRANCE_1991-1997
4. SOU FUJIMOTO ARCHITECTS_HOUSE N_OITA, JAPAN_2008

A-SIGNS	4
AFFECTS	8
PROJECTS	4

[AXIALITY]
 [COMPLEXITY]
 [DIFFERENTIATED]
 [DISJUNCTION]
[GRADATION]
 [LATTICED]
 [SCALELESS]
 [SERIALITY]

4. SOU FUJIMOTO ARCHITECTS_HOUSE N_OITA, JAPAN_2008

FORM • SPACE • SURFACE
 ΑΚΟΥΣΤΙΚΗ ΣΥΝΕΧΕΙΑ
AURAL CONTINUITY



1. TOYO ITO_WHITE U
HOUSE_TOKYO, JAPAN_1976
2. JUNYA ISHIGAMI +
ASSOCIATES_KANAGAWA
INSTITUTE OF TECHNOLOGY
KAIT WORKSHOP_KANAGAWA,
JAPAN
3. KAZUYO SEJIMA + RYUE
NISHIZAWA / SANAA_ROLEX
LEARNING CENTRE_EPFL
LAUSANNE_2010
4. SOU FUJIMOTO_HOUSE
NA_TOKYO, JAPAN_2011

.....
 3 A-SIGNS

.....
 6 AFFECTS

.....
4 PROJECTS

[AFFINITY]
 [GRADATION]
[FLUIDITY]
 [INSUBSTANTIALITY]
 [SERIALITY]
 [TONALITY]

AFFECTS

3. KAZUYO SEJIMA + RYUE NISHIZAWA / SANAA_ROLEX LEARNING CENTRE_EPFL LAUSANNE_2010



**DEMATERIALIZATION/
ΑΠΟ-ΥΛΟΠΟΙΗΣΗ
FORM • SPACE • SURFACE**

1. TOYO ITO_TOWER OF WINDS_1987_YOKOHAMA, JAPAN
2. TOYO ITO & ASSOCIATES _SENDAI, MEDIATHEQUE _SENDAI, JAPAN_1998
3. SANAA_GLASS CENTER FOR THE TOLEDO MUSEUM OF ART_USA, TOLEDO_2005
4. SANAA, STUDIO ADRIEN GARDÈRE MUSÉE DU LOUVRE-LENS. FRANCE _2012

A-SIGNS 7
AFFECTS 21
PROJECTS 4

[AMBIGUITY]
[ASYMMETRY]
[BLURINESS]
[CONTINGENCY]
[DECONSTRUCTION]
[DEMATERIALIZED]
[DISCONTINUOUS]
[DISJUNCTION]
[DISORIENTATION]
[DISSIPATION]
[GRADATION]
[LIGHTNESS]
[POROSITY]
[SCALELESS]
[SMOOTHNESS]
[TWO-DIMENSIONALITY]
[INSTABILITY]

1. TOYO ITO_TOWER OF WINDS_YOKOHAMA, JAPAN_1987

AFFECTS

FORM • SPACE • SURFACE
 ΒΑΘΜΟΣ ΜΗΔΕΝ
 ZERO DEGREE /

1. HIROMI FUJII_TODOROKI
 RESIDENCE_ICHIKAWA_-
 JAPAN_1976

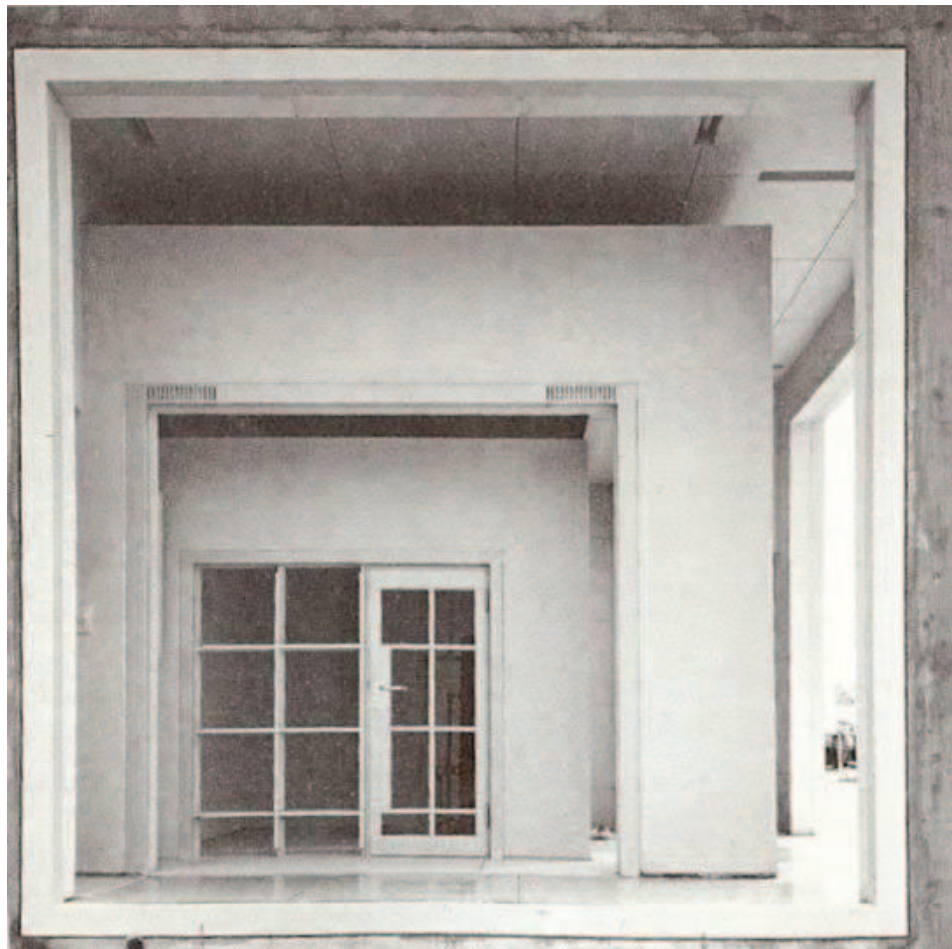

8 A-SIGNS

21 AFFECTS

2 PROJECTS

[AGGREGATION]
 [AMBIGUOUS]
 [AMORPHOUS]
 [ASYMMETRY]
 [BLURINESS]
[COMPLEXITY]
 [CONTIGENCY]
 [DECONSTRUCTION]
 [DEMATERIALIZED]
 [DIFFERENTIATED]
 [DISSIPATION]
 [DISJUNCTION]
 [DISCREPANCY]
 [DISSOLUTION]
 [DIVERSITY]
 [FLEXIBILITY]
 [MUTATION]
 [RANDOMNESS]
 [SCALELESS]
 [TWO-DIMENSIONALITY]
 [VAGUENESS]

AFFECTS

1. HIROMI FUJII_TODOROKI RESIDENCE_ICHIKAWA_JAPAN_1976

DECENTRALISATION

[concentration] <-----> [dispersion]



APPLIED SIGN/
 ΕΦΑΡΜΟΣΜΕΝΟ ΣΗΜΕΙΟ
 FORM•STRUCTURE•SURFACE

1. TOYO ITO_TAMA ART
 LIBRARY_JAPAN_2007

A-SIGNS 6

AFFECTS 17

PROJECTS 2

[AFFINITY]
 [AMBIGUOUS]
 [ASYMMETRY]
 [BLURINESS]
 [COMPLEXITY]
 [CONTIGENCY]
 [DIFFERENTIATION]
 [DISCONTINUOUS]
 [DISCREPANCY]
 [DISORIENTATION]
 [DISSIPATION]
 [DUPLICITY]
 [MODULARITY]
[MUTATION]
 [PURPOSEFULNESS]
 [INTSBILITY]
 [VAGUNESS]

1. TOYO ITO_TAMA ART LIBRARY_JAPAN_2007

AFFECTS

FORM • SPACE • SURFACE
 ΑΣΥΝΕΧΕΙΑ
 DISCONTINUITY /

1. HIROMI FUJII_MIJAJIMA
 HOUSE_TOKYO, JAPAN_1976



[A-CENTRICITY]
 [AMBIGUITY]
 [AMORPHOUS]
 [ASYMMETRY]
 [ΑΠΑΙΩΣΗ]
 [BLURINESS]
 [COMPLEXITY]
 [CONTIGENCY]
 [DECONSTRUCTION]
 [DEMATERIALISATION]
 [DIFFERENTIATION]
 [DISCONTINUITY]
 [DISCREPANCY]
 [DISJUNCTION]
 [DISORIENTATION]
 [DISSIPATION]
 [INTER-CHANGEABILITY]
 [POROUS]
 [RANDOMNESS]
 [TWO-DIMENSIONALITY]
 [VAGUENESS]

8 A-SIGNS

22 AFFECTS

1 PROJECTS

1. HIROMI FUJII_MIJAJIMA HOUSE_TOKYO, JAPAN_1976



A-SIGNS	7
AFFECTS	21
PROJECTS	3

3. SANAA_SANAA INSTALLATION AT THE MIES VAN DER ROHE PAVILION_BARCELONA, SPAIN_2008

AFFECTS

DISORIENTATION/
ΑΠΟΠΡΟΣΑΝΑΤΟΛΙΣΜΟΣ
FORM•SPACE•SURFACE

1. DILLER + SCOFIDIO_BLUR BUILDING_SWITZERLAND_2002
2. SANAA_SANAA INSTALLATION AT THE MIES VAN DER ROHE PAVILION_BARCELONA, SPAIN_2008
3. SANAA_GLASS CENTER FOR THE TOLEDO MUSEUM OF ART_TOLEDO, USA_2005

[A-CENTRICITY]
 [AMBIGUOUS]
 [AMORPHOUS]
 [ASYMMETRY]
 [BLURINESS]
 [CONTIGENCY]
 [DECONSTRUCTION]
 [DEMATERIALIZED]
 [DISJUNCTION]
 [DISSIPATION]
 [DIVERSITY]
[FLUIDITY]
 [OPENESS]
 [OPEN-ENDNESS]
 [RANDOMNESS]
 [SCALELESS]
 [INSTABILITY]
 [VAGUENESS]

FORM • SPACE • SURFACE
 ΔΙΑΣΧΙΣΤΙΚΟΤΗΤΑ
 TRANVERSALITY /

1. SHIN TAKAMATSU_ARK
 CLINIC_KYOTO, JAPAN_1983

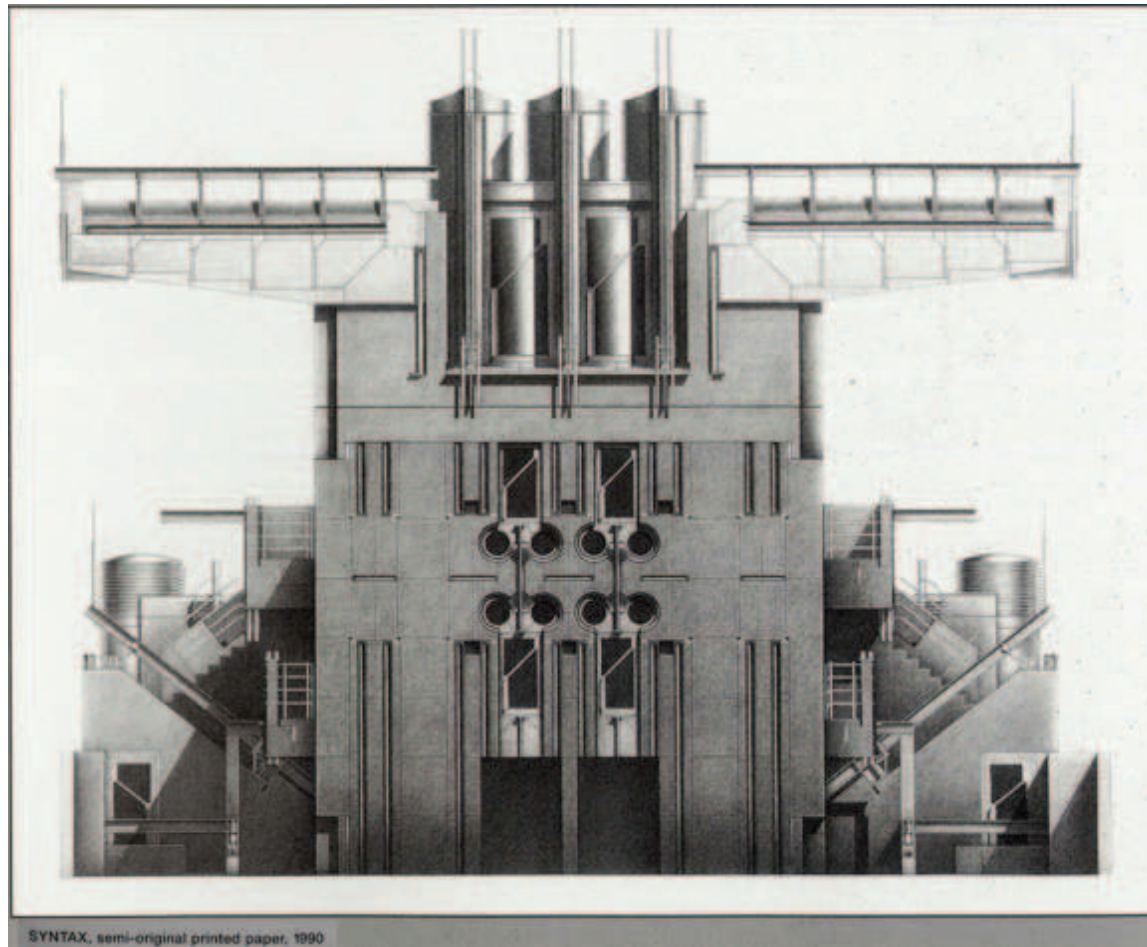

SYNTAX, semi-original printed paper, 1990

[A-CENTRICITY]
 [AFFINITY]
 [AGGREGATED]
 [AMBIGUOUS]
 [AMORPHOUS]
 [ASYMMETRY]
 [CONCENTRATION]
 [COMPLEXITY]
 [DIFFERENTIATED]
 [DISCONTINUOUS]
 [DISJUNCTION]
 [DISSIPATION]
[DIVERSITY]
 [FLEXIBILITY]
 [MUTATION]
 [RANDOMNESS]
 [SCALELESS]
 [TWO-DIMENSIONALITY]
 [VAGUENESS]

4 A-SIGNS

19 AFFECTS

1 PROJECTS

1. SHIN TAKAMATSU_ARK CLINIC_KYOTO, JAPAN_1983



C
CARTESIAN GRID/
 ΚΑΡΤΕΣΙΑΝΟΣ ΚΑΝΝΑΒΟΣ
 FORM • STRUCTURE • SUR-

1. PETER EISENMAN_-
HOUSE SERIES_1969-1989
2. SOU FUJIMOTO_-
HOUSE NA_TOKYO,
JAPAN_2011

A-SIGNS	5
AFFECTS	9
PROJECTS	2

2. SOU FUJIMOTO_HOUSE NA_TOKYO, JAPAN_2011

[AXIALITY]
 [CONTIGENCY]
 [DIAGONALITY]
[DIVERSITY]
 [FLATNESS]
 [FLEXIBILITY]
 [SCALELESS]
 [SERIALITY]
 [VERTICALITY]

AFFECTS

FORM • SPACE • SURFACE
MAYPH YAH
BLACK-STUFF /

1. AKS RUNO_THE LIBRARY OF ALEXANDRIA_CAIRO, EGYPT_1989
2. PETER EISENMAN_NAPOLI STAZIONE ALTA VELOCITÀ_NAPOLI, ITALY_2003

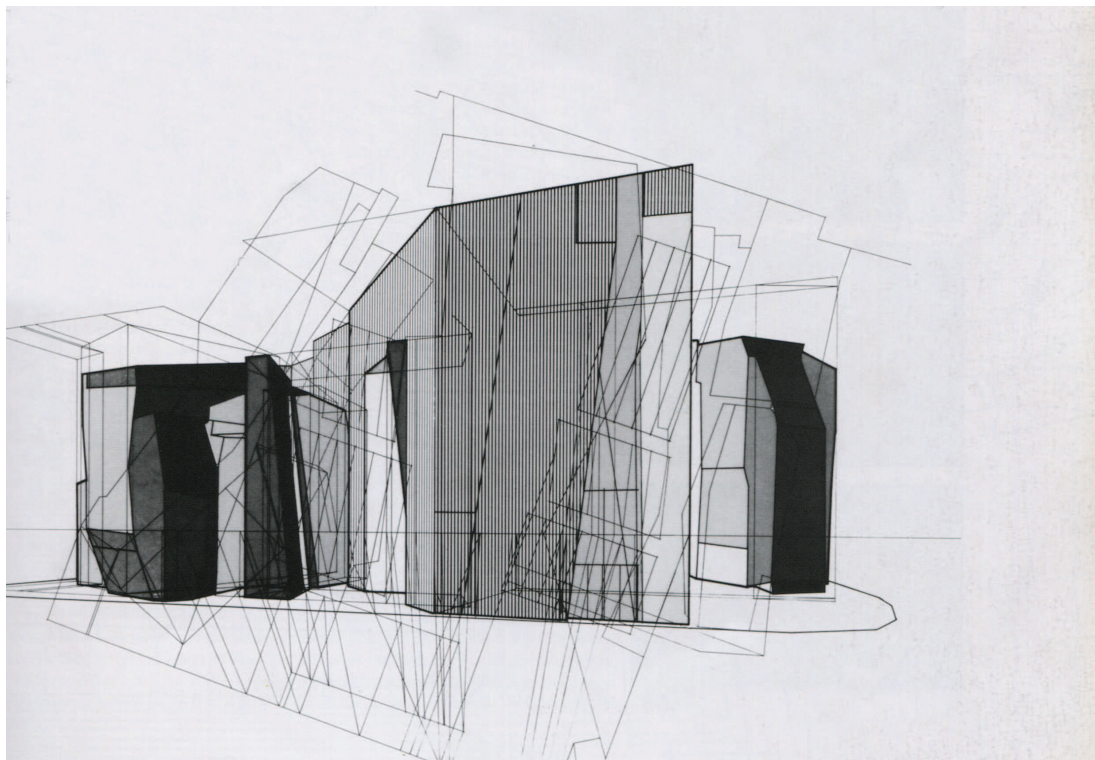

[A-CENTRICITY]
[ALTERNATED]
[AMBIGUOUS]
[AMORPHOUS]
[SYMMETRY]
[BLURINESS]
[COMPLEXITY]
[CONTIGENCY]
[DECONSTRUCTION]
[DEMATERIALIZED]
[DIFFERENTIATED]
DISCONTINUOUS
[DISCREPANCY]
[DISSIPATION]
[FLUIDITY]
[FLUTED]
[MUTATION]
[INSUBSTANTIALITY]
[SMOOTHNESS]
[INSTABILITY]
[VAGUENESS]
[WEIGHTLESSNESS]

.....
3 A-SIGNS
.....

.....
22 AFFECTS
.....

.....
2 PROJECTS
.....

1. AKS RUNO_THE LIBRARY OF ALEXANDRIA_CAIRO, EGYPT_1989



CLEAR STRUCTURE/
ΔΙΑΚΡΙΤΗ ΔΟΜΗ
 FORM•STRUCTURE•

1. TOYO ITO & ASSOCIATES
 _SENDAI MEDIATHEQUE_SENDAI,
 JAPAN_1998
2. KAZUYO SEJIMA + RYUE
 NISHIZAWA / SANAA ROLEX
 LEARNING CENTRE_EPFL
 LAUSANNE_2010
3. RYUE NISHIZAWA_TESHIMA
 ART MUSEUM_TESHIMA
 ISLAND, JAPAN_2011

A-SIGNS 7
 AFFECTS 12
PROJECTS 3

[AFFINITY]
 [ARCHING]
 [AXIALITY]
 [DIAGONALITY]
 [DISJUNCTION]
 [EFFORTLESS]
[FLATNESS]
 [LATTICED]
 [OPEN-ENDNESS]
 [PURPOSEFULNESS]
 [SERIALITY]
 [VERTICALITY]

1. TOYO ITO & ASSOCIATES _SENDAI MEDIATHEQUE_SENDAI, JAPAN_1998

AFFECTS

FORM • SPACE • SURFACE
ΔΙΑΓΩΝΙΟ ΠΛΑΓΙΩΝ
DIAGRID /



1. FOA_YOKOHAMA PORT
TERMINAL_YOKOHAMA,
JAPAN_1999
2. HERZOG AND DE
MEURON_PRADA AOYAMA
STORE_TOKYO, JAPAN_2003
3. OMA_SEATTLE LIBRARY,
SEATTLE, USA_2005
4. FOSTER AND
PARTNERS_HEARST HEADQUAR-
TERS_NEW YORK, USA_2006
5. FOSTER AND PARTNERS_30
ST.MARY AXE_LONDON, UK_2010

AXIALITY]
[CONCENTRATION]
[DIAGONALITY]
[DIRECTIONALITY]
[DISSIPATION]
[INTER-CHANGEABILITY]
[FOLDING]
[GRADATION]
[KINETIC]
[REPETITIVITY]
[SERIALITY]
[SYMMETRY]
[TRIANGULARITY]

8 A-SIGNS

13 AFFECTS

5 PROJECTS

2. HERZOG AND DE MEURON_PRADA AOYAMA STORE_TOKYO, JAPAN_2003

A-SIGNS

CATEGORY

DIMENSION

[A]

[001]	AFFILIATIONS	[FO] [ST] [SC] [SU]	[EXTROVERSION]_[EXTERIORITY vs INTERIORITY]
[002]	AMBIGUITY	[FO] [ST] [SC] [SU]	[DIVERSIFICATION]_[HOMOGENEITY vs HETEROGENEITY]
[003]	ANTIGRAVITY	[FO] [ST] [SC] [SU]	[DECENTRALIZATION]_[CONCENTRATION vs DISPERSION]
[004]	APPLIED SIGN	[FO] [ST] [SC] [SU]	[DECENTRALIZATION]_[CONCENTRATION vs DISPERSION]
[005]	AURAL CONTINUITY	[FO] [ST] [SC] [SU]	[DELIMITATION]_[DEMARCATIION vs INTEGRATION]
[006]	AMORPHOUS	[FO] [ST] [SC] [SU]	[DIVERSIFICATION]_[HOMOGENEITY vs HETEROGENEITY]

[B]

[007]	BLACK-STUFF	[FO] [ST] [SC] [SU]	[DIVERSIFICATION]_[HOMOGENEITY vs HETEROGENEITY]
[008]	BLANKNESS	[FO] [ST] [SC] [SU]	[DIVERSIFICATION]_[HOMOGENEITY vs HETEROGENEITY]
[009]	BLURINESS	[FO] [ST] [SC] [SU]	[DELIMITATION]_[DEMARCATIION vs INTEGRATION]
[010]	BORROWED LANDSCAPES	[FO] [ST] [SC] [SU]	[EXTROVERSION]_[EXTERIORITY vs INTERIORITY]
[011]	BOX-WITHIN_BOX	[FO] [ST] [SC] [SU]	[DELIMITATION]_[DEMARCATIION vs INTEGRATION]

[C]

[012]	CAMOUFLAGE	[FO] [ST] [SC] [SU]	[DIVERSIFICATION]_[HOMOGENEITY vs HETEROGENEITY]
[013]	CARTESIAN GRID	[FO] [ST] [SC] [SU]	[DIVERSIFICATION]_[HOMOGENEITY vs HETEROGENEITY]
[014]	CINEMATIC TECHNIQUES	[FO] [ST] [SC] [SU]	[DIVERSIFICATION]_[HOMOGENEITY vs HETEROGENEITY]
[015]	CLEAR STRUCTURAL STRATEGY	[FO] [ST] [SC] [SU]	[DIVERSIFICATION]_[HOMOGENEITY vs HETEROGENEITY]
[016]	CONNOTATION	[FO] [ST] [SC] [SU]	[DIVERSIFICATION]_[HOMOGENEITY vs HETEROGENEITY]
[017]	CONTINUITY	[FO] [ST] [SC] [SU]	[DELIMITATION]_[DEMARCATIION vs INTEGRATION]
[018]	CRITICAL MASS	[FO] [ST] [SC] [SU]	[DELIMITATION]_[DEMARCATIION vs INTEGRATION]
[019]	CROSS PROGRAMMING	[FO] [ST] [SC] [SU]	[DECENTRALIZATION]_[CONCENTRATION vs DISPERSION]

[D]

[020]	DEFAMILIARIZATION	[FO] [ST] [SC] [SU]	[DIVERSIFICATION]_[HOMOGENEITY vs HETEROGENEITY]
[021]	DEMATERIALISATION	[FO] [ST] [SC] [SU]	[DELIMITATION]_[DEMARCATIION vs INTEGRATION]
[022]	DIAGRID	[FO] [ST] [SC] [SU]	[DIVERSIFICATION]_[HOMOGENEITY vs HETEROGENEITY]
[023]	DIAGONALISATION	[FO] [ST] [SC] [SU]	[DELIMITATION]_[DEMARCATIION vs INTEGRATION]
[024]	DISCONTINUOUS	[FO] [ST] [SC] [SU]	[DECENTRALIZATION]_[CONCENTRATION vs DISPERSION]
[025]	DISESTABLISHING REDUCTION	[FO] [ST] [SC] [SU]	[DELIMITATION]_[DEMARCATIION vs INTEGRATION]
[026]	DISORIENTATION	[FO] [ST] [SC] [SU]	[DECENTRALIZATION]_[CONCENTRATION vs DISPERSION]
[027]	DISPOSITION	[FO] [ST] [SC] [SU]	[DELIMITATION]_[DEMARCATIION vs INTEGRATION]
[028]	DIVERSITY	[FO] [ST] [SC] [SU]	[DIVERSIFICATION]_[HOMOGENEITY vs HETEROGENEITY]

[E]

[029]	ECCENTRICITY	[FO] [ST] [SC] [SU]	[DECENTRALIZATION]_[CONCENTRATION vs DISPERSION]
[030]	ELASTICITY	[FO] [ST] [SC] [SU]	[DELIMITATION]_[DEMARCATIION vs INTEGRATION]
[031]	EMERGENT GRID	[FO] [ST] [SC] [SU]	[DIVERSIFICATION]_[HOMOGENEITY vs HETEROGENEITY]
[032]	EMTPINESS	[FO] [ST] [SC] [SU]	[DECENTRALIZATION]_[CONCENTRATION vs DISPERSION]
[033]	EPHEMERALITY	[FO] [ST] [SC] [SU]	[DIVERSIFICATION]_[HOMOGENEITY vs HETEROGENEITY]
[034]	EXPERIMENTAL LAYERING	[FO] [ST] [SC] [SU]	[DELIMITATION]_[DEMARCATIION vs INTEGRATION]
[035]	EXTERNAL TEXTS	[FO] [ST] [SC] [SU]	[DELIMITATION]_[DEMARCATIION vs INTEGRATION]

DIMENSION /
 A-SIGNIFYING SIGNS
 SORTING

A-SIGNS
CATEGORY**DIMENSION**

	A-SIGNS	CATEGORY	DIMENSION
[F]	[036] FACIALITY	[FO] [ST] [SC] [SU]	[EXTROVERSION]_[EXTERIORITY vs INTERIORITY]
	[037] FIGURE/GROUND	[FO] [ST] [SC] [SU]	[DELIMITATION]_[DEMARCATIION vs INTEGRATION]
	[038] FLUID DYNAMICS	[FO] [ST] [SC] [SU]	[DELIMITATION]_[DEMARCATIION vs INTEGRATION]
	[039] FRAGMENT	[FO] [ST] [SC] [SU]	[DECENTRALIZATION]_[CONCENTRATION vs DISPERSION]
	[040] FREE-SECTION	[FO] [ST] [SC] [SU]	[DELIMITATION]_[DEMARCATIION vs INTEGRATION]
[G]	[041] FOLDING	[FO] [ST] [SC] [SU]	[DELIMITATION]_[DEMARCATIION vs INTEGRATION]
	[042] GAP	[FO] [ST] [SC] [SU]	[DECENTRALIZATION]_[CONCENTRATION vs DISPERSION]
	[043] GRADATION OF DOMAIN	[FO] [ST] [SC] [SU]	[DELIMITATION]_[DEMARCATIION vs INTEGRATION]
[H]	[044] GRAPHIC PATTERNS TO GLASS	[FO] [ST] [SC] [SU]	[DIVERSIFICATION]_[HOMOGENEITY vs HETEROGENEITY]
	[045] HOUSE WITHIN A HOUSE	[FO] [ST] [SC] [SU]	[DIVERSIFICATION]_[HOMOGENEITY vs HETEROGENEITY]
[I]	[046] IMPERMANENCE	[FO] [ST] [SC] [SU]	[EXTROVERSION]_[EXTERIORITY vs INTERIORITY]
	[047] INCONGRUENCE	[FO] [ST] [SC] [SU]	[DIVERSIFICATION]_[HOMOGENEITY vs HETEROGENEITY]
	[048] INDISCERNIBILITY	[FO] [ST] [SC] [SU]	[EXTROVERSION]_[DEMARCATIION vs INTEGRATION]
	[049] INTENSIVE COHERENCE	[FO] [ST] [SC] [SU]	[DECENTRALIZATION]_[CONCENTRATION vs DISPERSION]
	[050] ISOLATION	[FO] [ST] [SC] [SU]	[EXTROVERSION]_[EXTERIORITY vs INTERIORITY]
[J]			
[K]	[051] KINETIC	[FO] [ST] [SC] [SU]	[DELIMITATION]_[DEMARCATIION vs INTEGRATION]
[L]			
[M]	[052] MASKING	[FO] [ST] [SC] [SU]	[DIVERSIFICATION]_[HOMOGENEITY vs HETEROGENEITY]
	[053] MATERIALITY	[FO] [ST] [SC] [SU]	[EXTROVERSION]_[EXTERIORITY vs INTERIORITY]
	[054] MOIRRE	[FO] [ST] [SC] [SU]	[DELIMITATION]_[DEMARCATIION vs INTEGRATION]
	[055] MUTUAL EVOCATIONS	[FO] [ST] [SC] [SU]	[DECENTRALIZATION]_[CONCENTRATION vs DISPERSION]
[N]	[056] NEUTRAL ZONES	[FO] [ST] [SC] [SU]	[DELIMITATION]_[DEMARCATIION vs INTEGRATION]
	[057] NO AXIAL ORIENTATION	[FO] [ST] [SC] [SU]	[DECENTRALIZATION]_[CONCENTRATION vs DISPERSION]
	[058] NOISE	[FO] [ST] [SC] [SU]	[DIVERSIFICATION]_[HOMOGENEITY vs HETEROGENEITY]
[O]	[059] OPEN ENFOLDNESS	[FO] [ST] [SC] [SU]	[EXTROVERSION]_[EXTERIORITY vs INTERIORITY]
	[060] OPENESS	[FO] [ST] [SC] [SU]	[EXTROVERSION]_[EXTERIORITY vs INTERIORITY]
	[061] ORNAMENT	[FO] [ST] [SC] [SU]	[DIVERSIFICATION]_[HOMOGENEITY vs HETEROGENEITY]
[P]	[062] PERFORMATIVE FORM	[FO] [ST] [SC] [SU]	[DELIMITATION]_[DEMARCATIION vs INTEGRATION]
	[063] PERFORMATIVE PATTERN	[FO] [ST] [SC] [SU]	[EXTROVERSION]_[EXTERIORITY vs INTERIORITY]
	[064] PLEATED	[FO] [ST] [SC] [SU]	[DIVERSIFICATION]_[DEMARCATIION vs INTEGRATION]
	[065] POINTING	[FO] [ST] [SC] [SU]	[DECENTRALIZATION]_[CONCENTRATION vs DISPERSION]
	[066] POROSITY	[FO] [ST] [SC] [SU]	[EXTROVERSION]_[EXTERIORITY vs INTERIORITY]
[Q]			
[R]	[067] RADICAL PASSIVITY	[FO] [ST] [SC] [SU]	[DIVERSIFICATION]_[HOMOGENEITY vs HETEROGENEITY]

A-SIGNS**CATEGORY****DIMENSION**

	A-SIGNS	CATEGORY	DIMENSION
[R]	[068] RANDOMNESS	[FO] [ST] [SC] [SU]	[DELIMITATION]_[DEMARCATION vs INTEGRATION]
	[069] RESILIENCE	[FO] [ST] [SC] [SU]	[DELIMITATION]_[DEMARCATION vs INTEGRATION]
	[070] RYTHM	[FO] [ST] [SC] [SU]	[DIVERSIFICATION]_[HOMOGENEITY vs HETEROGENEITY]
[S]	[071] SCALELESS	[FO] [ST] [SC] [SU]	[DIVERSIFICATION]_[HOMOGENEITY vs HETEROGENEITY]
	[072] SECOND NATURE	[FO] [ST] [SC] [SU]	[DELIMITATION]_[DEMARCATION vs INTEGRATION]
	[073] SEMI-LATICCE	[FO] [ST] [SC] [SU]	[DELIMITATION]_[DEMARCATION vs INTEGRATION]
	[074] SEMI-PERMEABLE MEMBRANE	[FO] [ST] [SC] [SU]	[DELIMITATION]_[DEMARCATION vs INTEGRATION]
	[075] SEMI-SECLUSION	[FO] [ST] [SC] [SU]	[EXTROVERSION]_[EXTERIORITY vs INTERIORITY]
	[076] SEMI-TRANSPARENT	[FO] [ST] [SC] [SU]	[EXTROVERSION]_[EXTERIORITY vs INTERIORITY]
	[077] SINGLE-SURFACE TECHNIQUE	[FO] [ST] [SC] [SU]	[DELIMITATION]_[DEMARCATION vs INTEGRATION]
	[078] SINKING ROOM	[FO] [ST] [SC] [SU]	[DELIMITATION]_[DEMARCATION vs INTEGRATION]
	[079] SLIT WINDOWS	[FO] [ST] [SC] [SU]	[EXTROVERSION]_[EXTERIORITY vs INTERIORITY]
	[080] SPASM	[FO] [ST] [SC] [SU]	[DIVERSIFICATION]_[HOMOGENEITY vs HETEROGENEITY]
	[081] STILLNESS	[FO] [ST] [SC] [SU]	[DIVERSIFICATION]_[HOMOGENEITY vs HETEROGENEITY]
	[082] STRUCTURE VANISH	[FO] [ST] [SC] [SU]	[DIVERSIFICATION]_[HOMOGENEITY vs HETEROGENEITY]
	[083] SUPERPOSITION	[FO] [ST] [SC] [SU]	[DIVERSIFICATION]_[HOMOGENEITY vs HETEROGENEITY]
	[084] SUPERSATURATION	[FO] [ST] [SC] [SU]	[DIVERSIFICATION]_[HOMOGENEITY vs HETEROGENEITY]
	[085] SUPERGRAPHIC	[FO] [ST] [SC] [SU]	[DIVERSIFICATION]_[HOMOGENEITY vs HETEROGENEITY]
[T]	[086] TRANSPARENCY	[FO] [ST] [SC] [SU]	[EXTROVERSION]_[EXTERIORITY vs INTERIORITY]
	[087] TRANSVERSALITY	[FO] [ST] [SC] [SU]	[DECENTRALIZATION]_[CONCENTRATION vs DISPERSION]
[U]	[088] USE OF SPACE vs FUNCTION	[FO] [ST] [SC] [SU]	[DIVERSIFICATION]_[HOMOGENEITY vs HETEROGENEITY]
	[089] UTSUROI FEEL TIME CHANGING	[FO] [ST] [SC] [SU]	[DELIMITATION]_[DEMARCATION vs INTEGRATION]
[V]	[090] VAGUENESS	[FO] [ST] [SC] [SU]	[DELIMITATION]_[DEMARCATION vs INTEGRATION]
	[091] VASTNESS	[FO] [ST] [SC] [SU]	[DECENTRALIZATION]_[CONCENTRATION vs DISPERSION]
	[092] VARIATION [TEXTURE/COLOR]	[FO] [ST] [SC] [SU]	[DIVERSIFICATION]_[HOMOGENEITY vs HETEROGENEITY]
	[093] VILLAGE WITHIN A HOUSE	[FO] [ST] [SC] [SU]	[DIVERSIFICATION]_[HOMOGENEITY vs HETEROGENEITY]
	[094] VISUAL DEPTH	[FO] [ST] [SC] [SU]	[DIVERSIFICATION]_[HOMOGENEITY vs HETEROGENEITY]
	[095] VISUAL LIGHTNESS	[FO] [ST] [SC] [SU]	[DELIMITATION]_[DEMARCATION vs INTEGRATION]
	[096] VISUAL OBJECTS	[FO] [ST] [SC] [SU]	[EXTROVERSION]_[EXTERIORITY vs INTERIORITY]
	[097] VISUAL VIBRATION	[FO] [ST] [SC] [SU]	[EXTROVERSION]_[EXTERIORITY vs INTERIORITY]
[W]	[097] WEAK FORM / DEGREE ZERO	[FO] [ST] [SC] [SU]	[DECENTRALIZATION]_[CONCENTRATION vs DISPERSION]
	[099] WETGRID	[FO] [ST] [SC] [SU]	[DELIMITATION]_[DEMARCATION vs INTEGRATION]
[Z]	[100] ZERO DEGREE	[FO] [ST] [SC] [SU]	[DELIMITATION]_[DEMARCATION vs INTEGRATION]

CODE /
A-SIGNS

INTEGRATION
DEGREE OF DECENTRALIZATION

EXTERIORITY
DEGREE OF EXTROVERSION

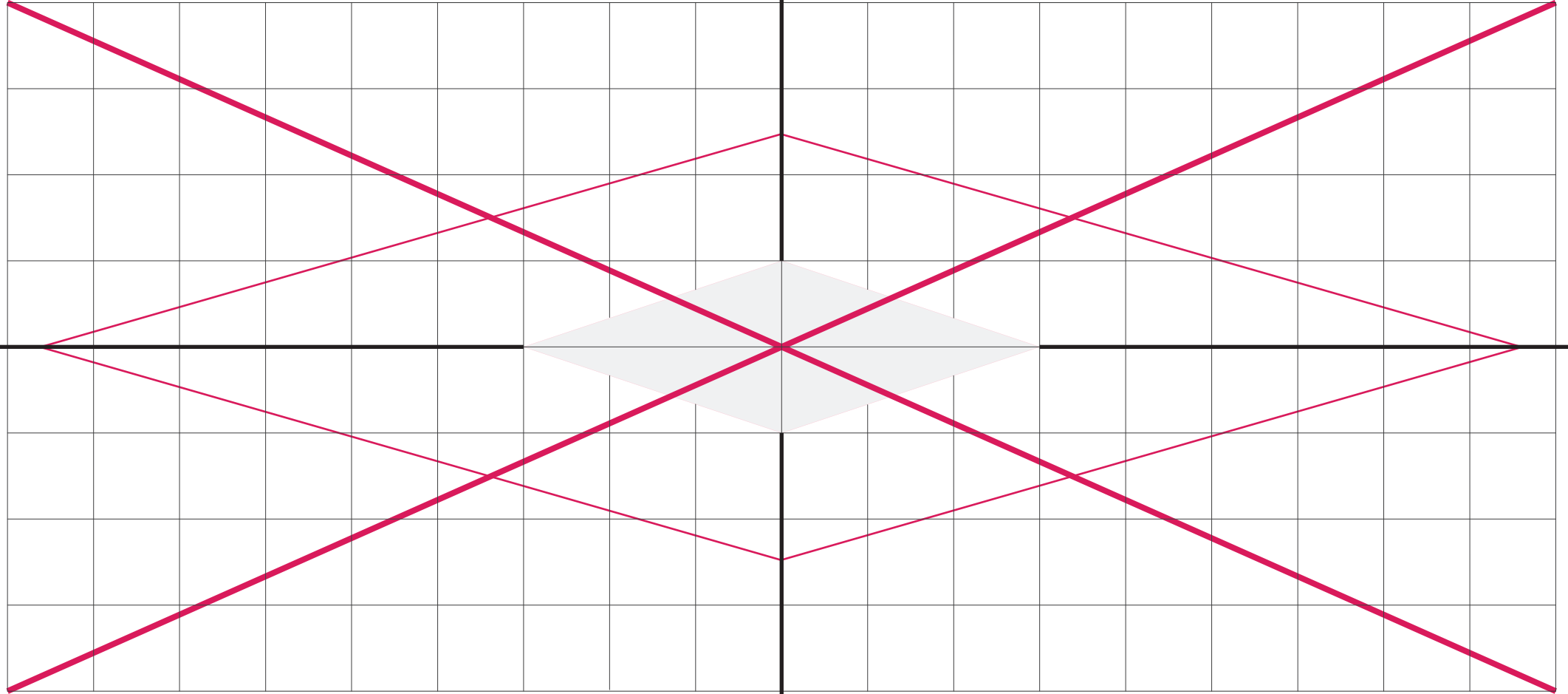

DIFFERENTIATION
DEGREE OF DIVERSIFICATION

COHESION
DEGREE OF DELIMITATION

INTEGRATION
DEGREE OF DECENTRALIZATION

EXTERIORITY
DEGREE OF EXTROVERSION

									[.098] WEAK FORM	[.096] VISUAL OBJECTS	[.097] VISUAL VIBRATION							
			[.091] VASTNESS	[.087] TRANS- VERSALITY	[.065] POINTING	[.057] NO AXIAL ORIENTA- TION	[.055] MUTUAL EVOCA- TIONS	[.049] INTENSIVE COHERENCE	[.063] PERFORMA- TIVE PATTERN	[.066] POROSITY	[.075] SEMI- SECLUSION	[.076] SEMI- TRANSPAR- ENT	[.079] SLIT OPENINGS	[.086] TRANS- PARENCY				
			[.042] GAP	[.039] FRAGMENT	[.032] EMPTINESS	[.029] ECCENTRICI- TY	[.026] DIS- ORIENTA- TION	[.024] DIS- CONTINU- OUS	[.046] IMPERMA- NENCE	[.048] INDISCERN- IBILITY	[.050] ISOLATION	[.053] MATERIALITY	[.059] OPEN ENFOLD- NESS	[.060] OPENESS				
			[.019] CROSS PROGRAM- MING	[.004] APPLIED SIGN	[.003] ANTIGRAVI- TY							[.001] AFFILIA- TIONS	[.010] BORROWED LAND- SCAPES	[.036] FACIALITY				
[.013] CARTESIAN GRID	[.012] CAMOU- FLAGE	[.008] BLANKNESS	[.007] BLACK-STUFF	[.006] AMOR- PHOUS	[.002] AMBIGUITY								[.005] AURAL CONTINUITY	[.009] BLURINESS	[.011] BOX- WITHIN-BOX	[.017] CONTINUITY	[.018] CRITICAL MASS	[.021] DEMATERI- ALISATION
[.044] GRAPHIC PATTERNS	[.033] EPHEMERALITY	[.031] EMERGENT GRID	[.028] DIVERSITY	[.022] DIAGRID	[.020] DEFAMILIAR- IZATION	[.016] CONNOTA- TION	[.015] CLEAR STRUCTURAL STRATEGY	[.014] CINEMATIC TECHNIQUES	[.023] DIAGONALI- SATION	[.025] DISESTABLIS REDUCTION	[.027] DISPOSITION	[.030] ELASTICITY	[.034] EXPERIMEN- TAL LAYERING	[.035] EXTERNAL TEXTS	[.037] FIGURE/ GROUND	[.038] FLUIDITY	[.040] FREE SECTION	
[.080] SPASM	[.071] SCALELESS	[.070] RYTHM	[.067] RADICAL PASSIVITY	[.064] PLEATED	[.061] ORNAMENT	[.058] NOISE	[.052] MASKING	[.047] INCOGRU- ENCE	[.041] FOLDING	[.043] GRADATION OF DOMAIN	[.051] KINETIC	[.054] MOIRRE	[.056] NEUTRAL ZONES	[.062] PERFORMA- TIVE FORM	[.068] RANDOM- NESS	[.069] RESILIENCE	[.072] SECOND NATURE	
[.094] VISUAL DEPTH	[.093] VILLAGE WITHIN HOUSE	[.092] VARIATION	[.088] SPACE vs. FUNTION	[.085] SUPER- GRAPHIC	[.084] SUPER- SATURATION	[.083] SUPERPOSI- TION	[.082] STRUCTURE VANISH	[.081] STILLNESS	[.073] SEMI-LATTICE	[.074] SEMI- PERMEABLE	[.077] SINGLE SURFACE	[.078] SINKING ROOM	[.089] UTSUROI	[.090] VAGUENESS	[.095] VISUAL LIGHTNESS	[.099] WEIGRID	[.100] ZERO DEGREE	

DIFFERENTIATION
DEGREE OF DIVERSIFICATION

COHESION
DEGREE OF DELIMITATION