

Proceedings of the Iowa Academy of Science

Volume 34 | Annual Issue

Article 59

1927

An Extinct Glacial Pond near Cedar Rapids, Linn County, Iowa

G. S. Dille
Coe College

C. W. Couser
Coe College

Copyright ©1927 Iowa Academy of Science, Inc.

Follow this and additional works at: <https://scholarworks.uni.edu/pias>

Recommended Citation

Dille, G. S. and Couser, C. W. (1927) "An Extinct Glacial Pond near Cedar Rapids, Linn County, Iowa," *Proceedings of the Iowa Academy of Science*, 34(1), 239-239.

Available at: <https://scholarworks.uni.edu/pias/vol34/iss1/59>

This Research is brought to you for free and open access by the Iowa Academy of Science at UNI ScholarWorks. It has been accepted for inclusion in Proceedings of the Iowa Academy of Science by an authorized editor of UNI ScholarWorks. For more information, please contact scholarworks@uni.edu.

AN EXTINCT GLACIAL POND NEAR CEDAR RAPIDS,
LINN COUNTY, IOWA

G. S. DILLE AND C. W. COUSER

The basin of an extinct glacial pond exists three miles northwest of Cedar Rapids on the east bluff of the Cedar River, in Section 8, Township 83 North, Range 7 West, near the power line of the Iowa Railway & Light Co. (See map of location).

The basin of this pond lies 160 feet above the present bed of the river and is entirely enclosed by hills of glacial or post-glacial material, chiefly loess. It lies on the farm of Mr. A. J. Hines and has been partly tiled but the bed of the pond is still marshy during rainy seasons.

A series of old water levels mark the boundary of the pond, each level being well marked on the inner face of the ridges of sandy loess surrounding the basin. The water supply at present comes from rainfall and seepage from the surrounding area. A two-foot contour interval shows the difference in the elevation, as well as the approximate heights of the old water levels.

The basin is 550 feet wide by 650 feet long. At the north end a small basin adjoins it which apparently took care of the overflow in times of heavy rainfall. At the south end head erosion has cut a medium-sized ravine back to a point where it is almost ready to tap the basin.

No outlet exists, nor any evidence that one ever existed, however, a fall of about three feet to the south indicates drainage in that direction, if at all.

Situated on the river bluffs and in the midst of glacial deposits, there can be little doubt as to its origin. It may have arisen during the retreat of the glacier, as a result of ice melting, or it may represent a depression associated with kame topography, but no kames are known near-by.

COE COLLEGE,
CEDAR RAPIDS, IOWA.

Range 7 W.

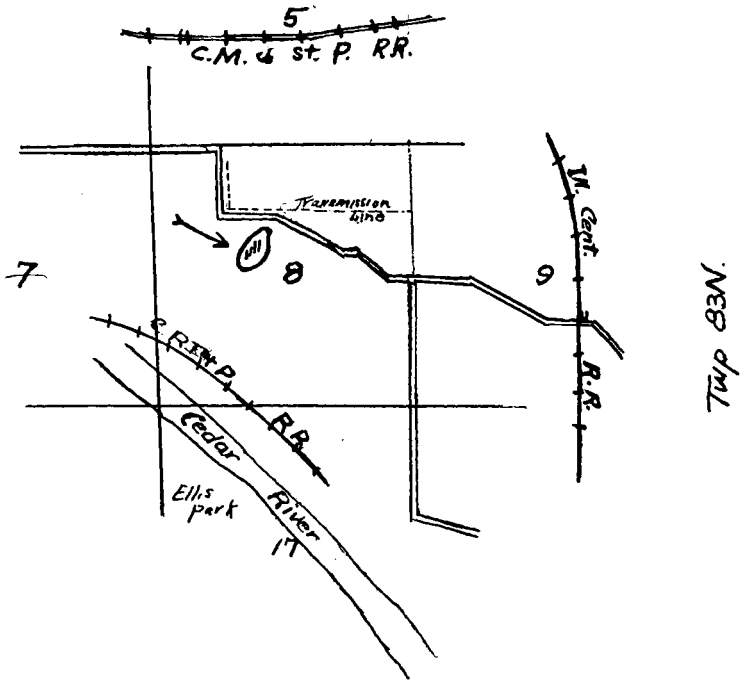

Part
CEDAR & RAPIDS TWP
LINN CO.
IOWA —

Scale 2" = 1 mile

Arrow indicates approximate location of glacial basin.

Dille and Couser: An Extinct Glacial Pond near Cedar Rapids, Linn County, Iowa

