

Wadsworth Atheneum (Hartford, CT)



A Furman Engaged Presentation
By Elizabeth Fox '16



The Museum



- ❧ Oldest operating art museum with 50,000 artworks; underwent 5-year \$33 million renovation project
- ❧ Decorative Arts: arts concerned with the design and creation of high-quality objects with historical and/or artistic significance as well as aesthetic use
- ❧ Shift from American to European Decorative Arts



Roles as Curatorial Intern

- ❧ Historical and Provenance Research
- ❧ Editing Object Checklists with label descriptions/tombs tones
- ❧ Label Writing
- ❧ Reinstallation of Objects

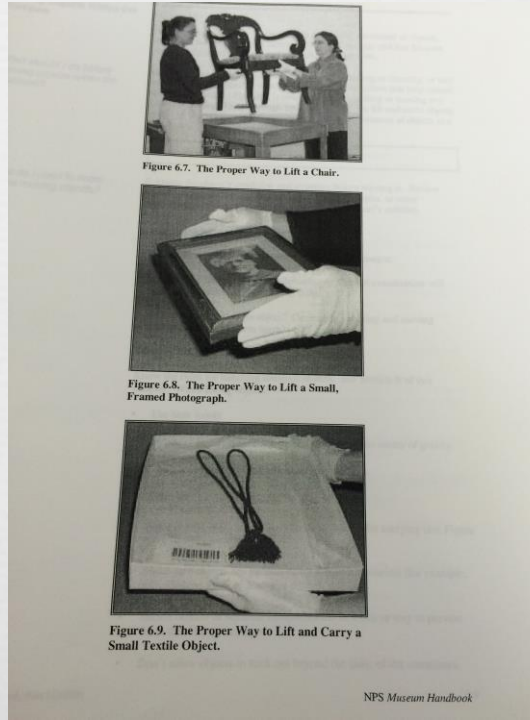

Figure 6.7. The Proper Way to Lift a Chair.

Figure 6.8. The Proper Way to Lift a Small, Framed Photograph.

Figure 6.9. The Proper Way to Lift and Carry a Small Textile Object.





Installation of objects



Curator Linda Roth hard at work!

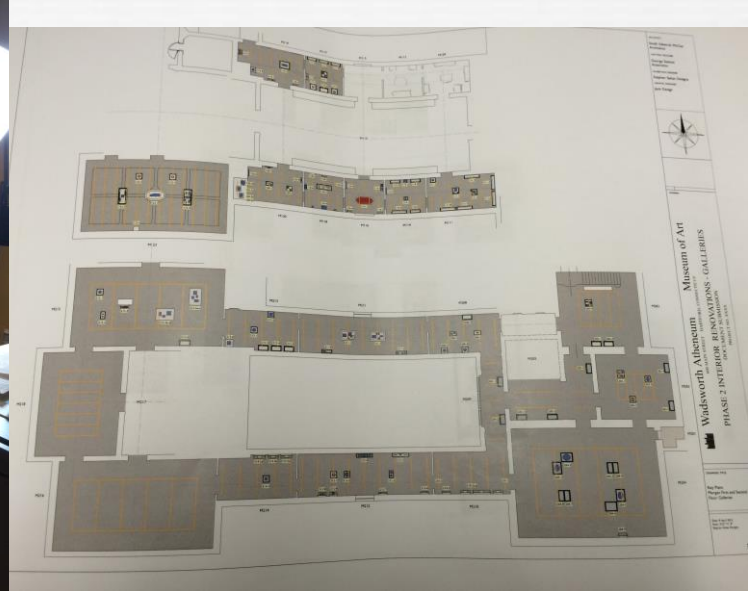

Gallery Reinstallation Blueprint (*Morgan Building*)

Objects in Storage



Packing Materials (*Tyvek, volara, tissue paper*)

Packing Objects (*observe the snakes below*)



Gallery Transformation



Morgan Great Hall (above)

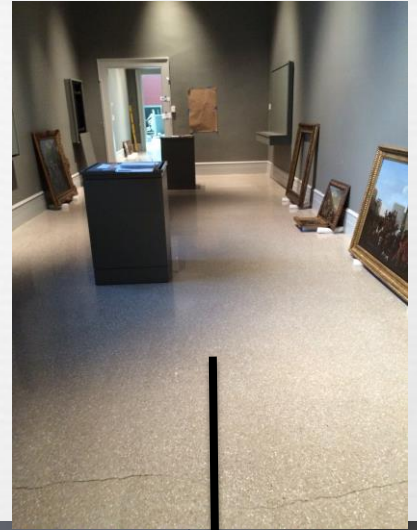

Problems and Challenges



- ∞ Disorganization of labels
- ∞ Coping with museum's old-fashioned techniques



Discoveries and Accomplishments



Wadsworth
Atheneum
Museum of Art

- ❧ 3 goals that were accomplished:
 - ❧ Gain expertise and skills in researching and handling decorative art and other genres of artworks
 - ❧ Learn how objects and artworks should be placed in an exhibition
 - ❧ Understand the overall, daily tasks required of a museum curator

- ❧ Solidified my focus of curatorship towards decorative arts