

Data Base for Deep Wells in Indiana

By PEGGY A. BASSETT *and* BRIAN D. KEITH

DEPARTMENT OF NATURAL RESOURCES
GEOLOGICAL SURVEY OCCASIONAL PAPER 46

c.3



SCIENTIFIC AND TECHNICAL STAFF OF THE GEOLOGICAL SURVEY

JOHN B. PATTON, State Geologist
MAURICE E. BIGGS, Assistant State Geologist
MARY BETH FOX, Mineral Statistician

COAL AND INDUSTRIAL MINERALS SECTION

DONALD D. CARR, Geologist and Head
CURTIS H. AULT, Geologist and Associate Head
DONALD L. EGGERT, Geologist
DENVER HARPER, Geologist
NANCY R. HASENMUELLER, Geologist
WALTER A. HASENMUELLER, Geologist
NELSON R. SHAFFER, Geologist
CHRISTOPHER R. SMITH, Geologist

DRAFTING AND PHOTOGRAPHY SECTION

WILLIAM H. MORAN, Chief Draftsman and Head
BARBARA T. HILL, Photographer
RICHARD T. HILL, Senior Geological Draftsman
ROGER L. PURCELL, Senior Geological Draftsman
KIMBERLY H. SOWDER, Geological Draftsman
WILBUR E. STALIONS, Artist-Draftsman

EDUCATIONAL SERVICES SECTION

JOHN R. HILL, Geologist and Head

GEOCHEMISTRY SECTION

R. K. LEININGER, Geochemist and Head
LOUIS V. MILLER, Coal Chemist
MARGARET V. ENNIS, Instrumental Analyst
JOSEPH G. HAILER, Geochemist/Analyst
JIM J. JOHNSON, Electronics Technician

GEOLOGY SECTION

ROBERT H. SHAVER, Paleontologist and Head
HENRY H. GRAY, Head Stratigrapher
N. K. BLEUER, Glacial Geologist
GORDON S. FRASER, Glacial Geologist
EDWIN J. HARTKE, Environmental Geologist
CARL B. REXROAD, Paleontologist

GEOPHYSICS SECTION

MAURICE E. BIGGS, Geophysicist and Head
ROBERT F. BLAKELY, Geophysicist
JOSEPH F. WHALEY, Geophysicist
SAMUEL L. RIDDLE, Driller
THOMAS CHITWOOD, Geophysical Assistant

PETROLEUM SECTION

G. L. CARPENTER, Geologist and Head
BRIAN D. KEITH, Geologist
STANLEY J. KELLER, Geologist
JOHN A. RUPP, Geologist
DAN M. SULLIVAN, Geologist
JERRY R. BURTON, Geological Assistant
JAMES T. CAZEE, Geological Assistant
SHERRY CAZEE, Geological Assistant

PUBLICATIONS SECTION

GERALD S. WOODARD, Editor and Head
PAT GERTH, Principal Records Clerk
BARBARA A. SEMERAU, Senior Records Clerk

AUTHORS OF THIS REPORT: Peggy A. Bassett was formerly a staff member in the Petroleum Section and Brian D. Keith is a geologist in the Petroleum Section of the Indiana Geological Survey, 611 North Walnut Grove, Bloomington, IN 47405.

Data Base for Deep Wells in Indiana

By PEGGY A. BASSETT *and* BRIAN D. KEITH

DEPARTMENT OF NATURAL RESOURCES
GEOLOGICAL SURVEY OCCASIONAL PAPER 46

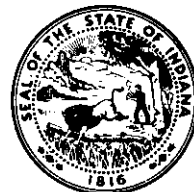

PRINTED BY AUTHORITY OF THE STATE OF INDIANA
BLOOMINGTON, INDIANA: 1984

STATE OF INDIANA
Robert D. Orr, *Governor*
DEPARTMENT OF NATURAL RESOURCES
James M. Ridenour, *Director*
GEOLOGICAL SURVEY
John B. Patton, *State Geologist*

For sale by Publications Section, Geological Survey, 611 North Walnut Grove,
Bloomington, IN 47405
Price \$7.50

Contents

	Page
Introduction	1
Wells in the data base	1
Information in the data base	1
Permit number	1
Operator-farm	1
County	1
Well locations	1
Map	1
Elevations of wells	2
Formation tops	2
Literature cited	3
Data base for deep wells in Indiana	4

Illustration

Plate 1 Map of Indiana showing locations of wells in deep-well data baseIn pocket
--	------------

Tables

	Page
Table 1 County names abbreviated in the data base	2
2 Abbreviations used in the data base for total-depth (TD) formation and formation tops	3

Data Base for Deep Wells in Indiana

By PEGGY A. BASSETT and BRIAN D. KEITH

Introduction

A part of this data base was originally compiled during research on the Trenton Limestone by Brian D. Keith. Because of increased interest by the petroleum industry in deeper subsurface units in Indiana, we have expanded the data base and made it available by publication.

This data base is a part of the computerized subsurface file of the Petroleum Section of the Indiana Geological Survey. The data base in the Petroleum Section contains pertinent information from all known records associated with petroleum-related wells in Indiana. This deep-well data base includes only wells that have penetrated the Black River Group or deeper stratigraphic units in Indiana. We intend to update the deep-well data base once a year. This updated data base will be available from the Geological Survey as an annual addendum to this report.

Wells in the Data Base

The 758 wells in this data base are wells that meet the penetration requirement and that have samples and (or) some type of geophysical log in the Petroleum Section. Wells that have only a driller's log and (or) a scout ticket have not been included because we cannot verify the formation tops from samples or logs. There are 411 wells in this latter category.

Information in the Data Base

PERMIT NUMBER

The primary identification for wells in the data base is the permit number, which is a unique five-digit identifying number assigned to each petroleum-related well in Indiana. Each new operation or change of classification of a well is assigned a new permit number. If multiple permit numbers have been assigned to a single well, only the most recently assigned permit number is listed in

the data base. Certain wells do not have permit numbers, either because they predate the permit system or because they are not petroleum-related wells (such as Indiana Geological Survey core holes). These wells have been assigned a unique six-digit number within the Petroleum Section data base that serves as a permit number.

The only exceptions to the unique number system are four wells in Dearborn County that were drilled under a single-county stratigraphic-test permit that gave all four wells the same permit number. However, the locations for these wells are all different, which should prevent confusion.

OPERATOR-FARM

Both the name of the operator and the farm name have been shortened or abbreviated to conserve space in the listing, but wells can still be identified without difficulty. The unique permit number can be used to distinguish multiple wells drilled by the same operator on the same farm. The well number used by the operator is also shown.

COUNTY

County names have been truncated to a maximum of six characters. The truncated and full names are shown in table 1. County names that have not been truncated are not listed in table 1.

WELL LOCATIONS

Only the section, township, and range for wells are listed. The quarter-section location and actual footage for a given well can be obtained directly from the records in the public files of the Petroleum Section.

MAP

Plate 1 is a map of Indiana showing the locations of all wells in the data base except for wells in certain areas where the well

Table 1. County names abbreviated in the data base

Abbreviation	County	Abbreviation	County
Bartho	Bartholomew	Jennin	Jennings
Blackf	Blackford	Johnso	Johnson
Carrol	Carroll	Kosciu	Kosciusko
Clinto	Clinton	Lagran	Lagrange
Crawfo	Crawford	Laport	LaPorte
Dearbo	Dearborn	Lawren	Lawrence
Decatu	Decatur	Madiso	Madison
Delawa	Delaware	Marsha	Marshall
Elkhar	Elkhart	Montgo	Montgomery
Fayett	Fayette	Pulask	Pulaski
Founta	Fountain	Randol	Randolph
Frankl	Franklin	St.Jos	St. Joseph
Hamilt	Hamilton	Steube	Steuben
Hancoc	Hancock	Sulliv	Sullivan
Harris	Harrison	Switze	Switzerland
Hendri	Hendricks	Tippec	Tippecanoe
Huntin	Huntington	Vermil	Vermillion
Jackso	Jackson	Washin	Washington
Jeffer	Jefferson	Whitle	Whitley

density is very high (generally greater than one well per section). Each well in the data base has a separate line number, which is plotted on the map.

ELEVATIONS OF WELLS

Ground-level elevations for all wells in the data base are listed. The kelly bushing (KB) elevation is listed for all wells for which it was used to calculate formation tops relative to sea level. In 1977 the Petroleum Section adopted the convention of using the KB elevation only when it was 7 feet or more above the ground elevation. For some gas-storage wells the KB was the datum for samples only and the ground elevation was the datum for geophysical logs. The elevations of all formation tops in the data base were calculated by using the appropriate datum.

FORMATION TOPS

The term "formation" is applied in a nonrigorous sense in the data base of the Petroleum Section to subsurface units ranging in rank from larger than system (for example, all Precambrian wells) to actual formations. These nonrigorous names fall into two

categories. Some names exactly parallel formal stratigraphic units but are terms that either are informal (such as Devonian limestone for Muscatatuck Group) or have been outdated by formal stratigraphic revision (such as Cincinnati for Maquoketa Group). Other names may be only partly parallel to a formal unit, for example, Chazyan, which is nearly parallel with the Ancell Group in northern Indiana but is only a variable amount of the lower part of the Ancell Group in southern Indiana. These names are retained in the data base of the Petroleum Section for two reasons: (1) As old terms they are familiar to, and used by, visitors to the Petroleum Section who do not use the formal stratigraphy, and (2) it is impractical to change a unit name on the thousands of pieces of information that make up the raw-data file of the Petroleum Section. Abbreviations used in the data base for total-depth (TD) formation and formation tops are shown in table 2.

Tops of Devonian limestone, the Trenton Limestone, the Eau Claire Formation, and the Mount Simon Sandstone were picked by using geophysical logs if they were available. But if

Table 2. Abbreviations used in the data base for total-depth (TD) formation and formation tops

Abbreviation	Data-base term	Formal stratigraphic equivalent
Devl	Devonian limestone	Muscatatuck Group
Genev	Geneva	Geneva Dolomite Member of the Jeffersonville Limestone
Sil	Silurian	Silurian (undifferentiated)
Lexing	Lexington	Lexington Limestone
Cin	Cincinnati	Maquoketa Group
Tren	Trenton	Trenton Limestone
Black	Black River	Black River Group
Chazya	Chazyan	Ancell Group
Knox	Knox	Knox Dolomite
Eau Cl	Eau Claire	Eau Claire Formation
Ironto	Ironton	Ironton Sandstone
Mount	Mount Simon	Mount Simon Sandstone
Precam	Precambrian	Precambrian System

logs were not available for a well, then sample tops were used. As a last resort, driller's-log tops for the Trenton were used if geophysical logs were not available and sample skips prevented using the samples to pick the Trenton top. This use of a driller's log was made because the Trenton top represents a distinct lithologic break from the overlying thick shale sequence (Maquoketa Group) to the carbonate rocks of the Trenton that is easy for drillers to recognize. Tops for the Knox Dolomite were picked by using the gamma-ray curve in the Unionport area of Randolph County as a result of the detailed study by Keller and Abdulkareem (1980). All other tops were picked from samples only.

For each formation top, both the depth and the value relative to sea level are listed. Some formation tops above the total depth

are not listed for certain wells. These tops were not picked for one of several reasons, including (1) a sample skip greater than 10 feet in thickness at the contact, (2) absence of the unit (as can be true for the Geneva Dolomite Member of the Jeffersonville Limestone), or (3) lack of lithologic distinction between units (for example, in places where both the Trenton and the Black River are dolomitized). For all wells, only tops that are Devonian limestone or older are listed.

Literature Cited

Keller, S. J., and Abdulkareem, T. F.

1980 - Post-Knox unconformity — Significance at Unionport gas-storage project and relationship to petroleum exploration in Indiana: Indiana Geol. Survey Occasional Paper 31, 19 p.

DATA BASE FOR DEEP WELLS IN INDIANA—Continued

PERMIT	OPERATOR FARM-WELL#	COUNTY	LOCATION		ELEVATION GL KB		TD	TD FORM	DEPTH-SUBSEA ELEVATIONS											
									DEV LS	GENEV	SIL	CIN	LEXING	TREN	BLACK	KNOX	EAU CL	MOUNT	PRECAM	
88	27528	NIPSCO JOHNSON #7	CASS	12	28N 1W	738	—	1400	KNOX						934 -198	1364 -626				
89	28385	NIPSCO JOHNSON #8	CASS	12	28N 1W	735	—	1417	KNOX						933 -198	1359 -629				
90	28392	NIPSCO HOUSE #2	CASS	12	28N 1W	730	—	1399	KNOX			558 172			921 -191	1108 -378	1368 -638			
91	28395	NIPSCO BOOZE #4	CASS	12	28N 1W	731	—	1400	KNOX						920 -189	1361 -630				
92	32937	NIPSCO DODT #WD-12B-K	CASS	12	28N 1W	730	—	1832	KNOX			617 113			998 -266	1180 -450	1475 -745			
93	33677	NIPSCO JOHNSON #0-85	CASS	12	28N 1W	737	751	3040	MOUNT			574 177			938 -201	1134 -383	1396 -645	2193 -1456		2789 -2052
94	23681	NIPSCO PHILLIPS #1	CASS	13	28N 1W	734	—	1388	KNOX			565 169			935 -201	1120 -386	1385 -651			
95	23449	NIPSCO HIATT #1	CASS	14	28N 1W	734	—	1382	KNOX			550 184			927 -193	1110 -376	1370 -636			
96	27001	NIPSCO WILDERMUTH #1	CASS	14	28N 1W	731	—	1381	KNOX						915 -184	1366 -635				
97	28393	NIPSCO FULTZ #1	CASS	14	28N 1W	732	—	1408	KNOX						931 -199	1372 -640				
98	29411	NIPSCO CONN #1	CASS	14	28N 1W	732	746	3010	MOUNT			550 196			920 -174	1100 -354	1380 -634	2184 -1452		2786 -2054
99	37766	NIPSCO BRIDGES #B-37	CASS	14	28N 1W	724	—	1369	KNOX			558 166			917 -193	1110 -386	1356 -632			
100	37767	NIPSCO BRIDGES #B-65	CASS	14	28N 1W	723	—	1384	KNOX						916 -193					
101	26999	NIPSCO SHAFER #1	CASS	15	28N 1W	725	—	1382	KNOX			564 161			927 -202	1144 -419	1378 -653			
102	30290	NIPSCO ULFERS #1	CASS	16	28N 1W	717	—	1445	KNOX						941 -224	1390 -673				
103	30499	NIPSCO MCVAY #1	CASS	16	28N 1W	715	—	1441	KNOX						925 -210					
104	29339	NIPSCO FINNELL #1	CASS	17	28N 1W	711	725	3091	MOUNT						925 -214	1160 -435	1382 -657	2213 -1502		2822 -2111
105	30879	NIPSCO ROWE #1	CASS	17	28N 1W	718	—	1114	BLACK			580 138			939 -221					
106	22177	NIPSCO SCHMALTZ #1	CASS	21	28N 1W	708	—	1389	KNOX			563 145			930 -222	1108 -400	1365 -657			
107	32252	NIPSCO SCHMALTZ #2	CASS	21	28N 1W	718	—	3300	MOUNT						1017 -299			2368 -1650		2970 -2252
108	24990	NIPSCO FANSLER #1	CASS	22	28N 1W	721	—	1393	KNOX						938 -217	1135 -414	1390 -669			
109	26387	NIPSCO NIPSCO #S-24	CASS	23	28N 1W	736	—	1118	BLACK						924 -188					
110	22176	NIPSCO MILLER #1	CASS	24	28N 1W	748	—	1525	KNOX			680 68			1065 -317	1255 -507	1505 -757			
111	08569	CLARK CO. OIL MCCLELLAN #1	CLARK	GR195	1N 8E	592	—	1547	KNOX			35 557	132 460	830 -238		959 -367	1528 -936			
112	11036	STOLL WATERS #1	CLARK	07	1N 9E	673	—	1400	BLACK			89 584	787 -114			920 -247				
113	11691	RUSS OIL STEWART #B-2	CLARK	18	1N 10E	491	—	1384	KNOX					535 -44		658 -167	1200 -709			
114	15198	PATTON MARTAIN #1	CLARK	01	1S 5E	600	—	1918	KNOX	386 214		467 133	644 -44				1905 -1305			
115	16042	PATTON HEYWOOD #2	CLARK	02	1S 5E	550	—	1601	BLACK	373 177		440 110	635 -85	1305 -755		1360 -810				
116	15798	PATTON HAYWOOD #1	CLARK	11	1S 5E	603	—	1675	BLACK	423 180		490 113	687 -84	1350 -747		1410 -807				

DATA BASE FOR DEEP WELLS IN INDIANA

DATA BASE FOR DEEP WELLS IN INDIANA—Continued

PERMIT	OPERATOR FARM-WELL#	COUNTY	LOCATION	ELEVATION			DEPTH-SUBSEA ELEVATIONS												
				GL	KB	TD	TD FORM	DEV	LS	GENEV	SIL	CIN	LEXING	TREN	BLACK	KNOX	EAU CL	MOUNT	PRECAM
117	00543 SMITH SCHUBNELL #1	CLARK	GR165 1S 6E	495	—	1747	KNOX	101						1011	1100	1643			
								394						-516	-605	-1148			
118	06095 LOUISVILLE CEMENT LOUISVILLE CEMENT #1	CLARK	GR131 1S 7E	465	—	1806	KNOX				225	862		987	1447				
											240	-397		-522	-982				
119	11742 RUSS OIL GARRIOTT #1	CLARK	GR53 1S 7E	569	—	1550	KNOX	18		68	215	866		992	1515				
								551		501	354	-297		-423	-946				
120	27634 INDIANA GAS ROSS #1	CLARK	GR93 1S 7E	482	—	1608	KNOX				147	808		942	1479				
											335	-326		-460	-997				
121	29919 INDIANA GAS COUCH #1	CLARK	GR113 1S 7E	542	—	1499	KNOX					845		977	1444				
												-303		-435	-902				
122	30857 INDIANA GAS GARVEY #4	CLARK	GR92 1S 7E	547	—	1492	KNOX			55	200	838		970	1435				
										492	347	-291		-423	-888				
123	31678 INDIANA GAS OGLESBY #1-S-3	CLARK	GR113 1S 7E	518	—	1650	KNOX			64	211	868		990	1472				
										454	307	-350		-472	-954				
124	32255 INDIANA GAS GARVEY #7-S-9	CLARK	GR92 1S 7E	530	—	1501	KNOX			35	187	820		955	1440				
										495	343	-290		-425	-910				
125	32301 INDIANA GAS COUCH #5-S-10	CLARK	GR113 1S 7E	514	—	1501	KNOX			50	210	828		960	1480				
										464	304	-314		-446	-966				
126	32794 INDIANA GAS COUCH #6-S-11	CLARK	GR113 1S 7E	548	—	1528	KNOX			65	210	856		990	1488				
										483	338	-308		-442	-940				
127	32815 INDIANA GAS GARVEY #8-S-12	CLARK	GR92 1S 7E	541	—	1535	KNOX			58	200	840		980	1508				
										483	341	-299		-439	-967				
128	33195 INDIANA GAS SCHLOSSER #4-S-13	CLARK	GR92 1S 7E	538	—	1401	BLACK			48	189	833		958					
										490	349	-295		-420					
129	33331 INDIANA GAS SCHLOSSER #5-S-14	CLARK	GR92 1S 7E	518	—	1468	KNOX			41	177	827		960	1460				
										477	341	-309		-442	-942				
130	33486 INDIANA GAS FRIEND #3-S-15	CLARK	GR92 1S 7E	529	—	1564	KNOX			49	196	856		985	1517				
										480	333	-327		-456	-988				
131	33687 INDIANA GAS NABB #9-S-16	CLARK	GR92 1S 7E	546	—	1220	BLACK			60	198	848		980					
										486	348	-302		-434					
132	33858 INDIANA GAS COUCH #2-S-5	CLARK	GR113 1S 7E	543	—	1525	KNOX			40	190	850		1020	1480				
										503	353	-307		-477	-937				
133	33871 INDIANA GAS NABB #6-S-8	CLARK	GR93 1S 7E	523	—	1522	KNOX			34	176	817		949	1400				
										489	347	-294		-426	-877				
134	33872 INDIANA GAS SCHLOSSER #3-S-7	CLARK	GR92 1S 7E	527	—	1569	KNOX			45	185	830		960	1519				
										482	342	-303		-433	-992				
135	03614 REAGAN LUTHER #1	CLAY	19 10N 6W	570	—	3200	CHAZYA	1549	1668	2233				2555	2712				
								-979	-1098	-1116	-1663			-1985	-2142				
136	42099 BUTTERCUP ENERGY PENSINGER #1	CLAY	32 10N 6W	595	—	6751	MOUNT	1564	1680	1705	2235			2560	2715	3230	5258	6222	
								-969	-1085	-1110	-1640			-1965	-2120	-2635	-4663	-5627	
137	18900 SHEETS FISHER #1	CLINTO	07 20N 1E	897	—	1625	CHAZYA				683			1118	1278				
											214			-221	-381				
138	24883 CONTINENTAL OIL PERREL #1	CLINTO	36 22N 1E	900	—	1603	KNOX				597			1074	1238	1594			
											303			-174	-338	-694			
139	11480 ROGGENKAMP SMITH #1	CRAWFO	11 2S 2W	546	—	2740	BLACK	1457		1580	2006			2588	2621				
								-911		-1034	-1460			-2042	-2075				
140	32638 ATKINS GRAY #2	CRAWFO	09 3S 1W	811	—	3025	BLACK	1700		1800	2190			2770	2780				
								-889		-989	-1379			-1959	-1969				
141	00190 MIDWEST DEV KEIFNER #1	DAVIES	02 2N 5W	510	—	3129	BLACK	1612		2040	2569			2979	3119				
								-1302		-1530	-2059			-2469	-2609				
142	27811 EASTERN U. S. OIL WALLACE #1	DAVIES	01 5N 5W	609	—	2849	BLACK	1600		1750	2298			2678	2818				
								-991		-1141	-1689			-2069	-2209				
143	01954 CENTRAL U.S. OIL BOBRINK #1	DEARBO	15 5N 1W	483	—	867	KNOX							340	854				
														143	-371				
144	02700 SEEVERS BRUCE #1	DEARBO	23 5N 2W	480	—	595	BLACK					140		352					
												340		128					
145	31933 O NEAL ASHBY #1	DEARBO	35 5N 2W	473	—	950	KNOX							345	930				
												343		128	-457				

DATA BASE FOR DEEP WELLS IN INDIANA—Continued

DATA BASE FOR DEEP WELLS IN INDIANA

PERMIT	OPERATOR FARM-WELL #	COUNTY	LOCATION	ELEVATION		TD	TD FORM	DEPTH-SUBSEA ELEVATIONS													
				GL	KB			DEV LS	GENEV	SIL	CIN	LEXING	TREN	BLACK	KNOX	EAU CL	MOUNT	PRECAM			
146	02390	CENTRAL U. S. OIL JOHNSON #1	DEARBO	36	5N 2W	492	—	435	BLACK					128 364		365 127					
147	19487	LYNN CLARK #1	DEARBO	10	6N 1W	802	—	1640	KNOX					463 339		690 112	1212 -410				
148	08388	REGIONAL DEV. FOX #1	DEARBO	28	6N 1W	510	—	2415	KNOX							390 120	905 -395				
149	113644	DEARBORN DEV. HORNBACK #1	DEARBO	11	6N 2W	905	—	2020	KNOX							805 100	1352 -447				
150	222886	CENTURY REALTY ACKERMAN #D13A-2716	DEARBO	03	7N 1W	905	—	821	BLACK					740 165		813 92					
151	222886	CENTURY REALTY STONE #D10A-2720	DEARBO	11	7N 1W	798	—	695	BLACK					615 183		686 112					
152	222886	CENTURY REALTY MCQUEEN #1-2788	DEARBO	12	7N 1W	572	—	486	BLACK					361 211		452 120					
153	222886	CENTURY REALTY DARE #1-2702	DEARBO	13	7N 1W	604	—	498	BLACK					402 202		490 114					
154	38443	SEEVERS, INC. SEEVERS, INC. #1	DEARBO	33	7N 2W	920	—	1067	BLACK					790 130		865 55					
155	37046	BAXTER RICHARDSON #1	DECATU	34	9N 8E	787	—	1060	BLACK							894 -107					
156	36869	INDIANA GAS RAMER #74	DECATU	12	9N 9E	903	—	1589	KNOX							870 33	960 -57	1450 -547			
157	35473	BRETT SMILEY #1	DECATU	10	10N 8E	843	—	1000	BLACK					35 808	95 748	864 -21	955 -112				
158	35671	BRETT SMILEY #15	DECATU	10	10N 8E	834	—	982	BLACK							866 -32					
159	35128	SHAWNEE OIL BRADEN #1	DECATU	11	10N 8E	862	—	1672	KNOX					110 752		875 -13	981 -119	1455 -593			
160	35472	BRETT MEYRS #14	DECATU	11	10N 8E	844	—	1000	BLACK					40 804	100 744	866 -22	960 -116				
161	35124	SHAWNEE OIL MEYER #1	DECATU	14	10N 8E	832	—	1630	KNOX					90 742		854 -22	963 -131	1435 -603			
162	35470	BRETT SMILEY #5	DECATU	14	10N 8E	831	—	982	BLACK					91 740		859 -28	960 -129				
163	35471	BRETT SMILEY #13	DECATU	14	10N 8E	828	—	980	BLACK							858 -30					
164	35122	SHAWNEE MIERS #2	DECATU	15	10N 8E	832	—	1690	KNOX					110 722		874 -42	977 -145	1450 -618			
165	35670	BRETT TEMPLTON #1	DECATU	15	10N 8E	839	—	1610	KNOX					40 799	100 739	871 -32	970 -131	1440 -601			
166	35123	SHAWNEE OIL JOHNSON #1	DECATU	22	10N 8E	822	—	1030	BLACK							866 -44	968 -146				
167	35406	BRETT KIRTMAN #4	DECATU	23	10N 8E	818	—	960	BLACK					105 713		856 -38	955 -137				
168	35213	SHAWNEE OIL CALENDER #1	DECATU	24	10N 8E	858	—	1095	BLACK							876 -18	971 -113				
169	104954	DECATUR OIL CO CLARK #...	DECATU	23	10N 10E	996	—	3055	KNOX							910 86					
170	104975	IND. GEOL. SUR. NEWPOINT #SDH-124	DECATU	08	10N 11E	942	—	949	BLACK							864 78	933 9				
171	29547	GULF OIL CORP. OSBORN #1	DECATU	33	12N 11E	1048	1061	1775	KNOX					135 926		975 86	1054 7	1529 -468			
172	31126	CARMAX IND. SLIGER #1	DEKALB	17	34N 12E	945	—	2251	BLACK	553 392		700 245	1370 -425		2035 -1090	2249 -1304					
173	22120	RUNYAN SWARTZ & LUMM #1	DEKALB	22	34N 13E	881	—	2514	KNOX	483 398		622 259	1298 -417		1991 -1110	2202 -1321	2470 -1589				
174	40517	SOUTHERN ILL INLOW #1	DEKALB	34	34N 13E	883	—	2361	BLACK	431 452		565 318	1254 -371		1944 -1061	2158 -1275					

DATA BASE FOR DEEP WELLS IN INDIANA—Continued

PERMIT	OPERATOR FARM-WELL#	COUNTY	LOCATION		ELEVATION GL KB TD TD FORM			DEPTH-SUBSEA ELEVATIONS											
								DEV LS	GENEV	SIL	CIN	LEXING	TREN	BLACK	KNOX	EAU CL	MOUNT	PRECAM	
175	17765 FERRUM OIL CO. GRAMLING #1	DEKALB	04	35N 13E	1009	—	2604	BLACK	713 296		895 114	1607 -598		2284 -1275	2514 -1505				
176	100226 DEKALB-STEUBEN OIL MILKS #1	DEKALB	05	35N 13E	995	—	2960	KNOX	698 297		888 107	1635 -640		2327 -1332		2850 -1855			
177	08853 ROMER EXP. DILLEY #1	DEKALB	06	35N 13E	987	—	2555	BLACK	678 309					2280 -1293	2497 -1510				
178	27866 NORTH AMER DRLG. CONRAD #1	DEKALB	11	35N 13E	970	983	2832	KNOX	690 293		873 110	1605 -622		2307 -1324	2540 -1557	2772 -1789			
179	24008 WARREN RIEKE #1	DEKALB	30	35N 14E	915	—	2491	BLACK	599 316		780 135	1470 -555		2173 -1258	2392 -1477				
180	17421 BALDWIN BURKHART #1	DEKALB	05	35N 15E	908	—	2551	BLACK	597 311		781 127	1556 -648		2296 -1388	2523 -1615				
181	14506 LECKLITNER SWINGLEY #1	DELAWA	11	20N 11E	991	—	1300	BLACK						970 21					
182	14652 VAN BUREN OIL CO. HOOBER #1	DELAWA	24	19N 10E	1054	—	1302	BLACK						971 83	1110 -56				
183	42637 FARRAR OIL CO. HARRIS #1	DELAWA	14	19N 11E	1044	—	2100	KNOX						1100 -56	1312 -268	1774 -730			
184	29511 HARRIS NEWMAN #1	DELAWA	07	20N 9E	912	—	1431	KNOX						909 3	1064 -152	1367 -455			
185	14443 RYAN OIL CO. KEESLING #1	DELAWA	28	20N 10E	953	—	1250	BLACK				219 734		913 40	1063 -110				
186	13346 HANLIN MURRELL #1	DELAWA	02	20N 11E	984	—	1242	BLACK						964 20	1093 -109				
187	29143 MURRAY & WIGNER COY #1	DELAWA	02	20N 11E	979	—	1775	KNOX				204 775		950 29	1100 -121	1437 -458			
188	13650 DAVIS MACDONALD #1	DELAWA	04	20N 11E	987	—	1229	BLACK						948 39	1091 -104				
189	15754 MOORE & BAGGETT MARTIN #1	DELAWA	09	20N 11E	982	—	1283	BLACK						914 68					
190	15125 MOORE & BAGGETT STOWE & CHLOE #1	DELAWA	10	20N 11E	985	—	1216	BLACK				235 750		924 61	1061 -76				
191	32168 BAGGETT & MOORE JONES #2	DELAWA	10	20N 11E	996	—	1259	BLACK						942 54					
192	42394 CARDINAL EXPLOR DRAGOO #1	DELAWA	10	20N 11E	1001	—	1237	BLACK						947 54					
193	42458 KERN KERN #3	DELAWA	10	20N 11E	992	—	1210	BLACK						929 63					
194	13618 HARRIS OIL HARRIS #1	DELAWA	11	20N 11E	1006	—	1287	BLACK				280 726		970 36	1110 -104				
195	02481 WEILDER LEEKA #1	DELAWA	13	20N 11E	1025	—	1290	BLACK				225 800		950 75	1128 -103				
196	02572 WEILDER LEEKA #2	DELAWA	13	20N 11E	1012	—	1780	KNOX						947 65	1086 -74	1342 -330			
197	13818 LECKLITNER JONES #1	DELAWA	13	20N 11E	1029	—	1310	BLACK						1000 29					
198	15569 DILLMAN DRILLING LEEKA #1	DELAWA	13	20N 11E	1020	—	1237	BLACK						950 70					
199	13821 EASTER HUFFMAN #1	DELAWA	15	20N 11E	1011	—	1244	BLACK						968 43	1101 -90				
200	15448 MOORE & BAGGETT NOEK ET AL #1	DELAWA	15	20N 11E	1005	—	1274	BLACK						964 41					
201	13791 STONE KEESLING #1	DELAWA	18	20N 11E	975	—	1218	BLACK				191 784		918 57	1059 -84				
202	16759 BAGGETT LADURON #1	DELAWA	18	20N 11E	970	—	2505	EAU CL				169 801		890 80	1025 -55	1299 -329	2489 -1519		
203	35676 KEESLING KEESLING #2	DELAWA	18	20N 11E	976	—	1227	BLACK						923 53					

DATA BASE FOR DEEP WELLS IN INDIANA—Continued

PERMIT	OPERATOR FARM-WELL #	COUNTY	LOCATION	ELEVATION		TD	TD FORM	DEPTH-SUBSEA ELEVATIONS															
				GL	KB			DEV LS	GENEV	SIL	CIN	LEXING	TREN	BLACK	KNOX	EAU CL	MOUNT	PRECAM					
233	03503	CHENAULT ET AL SCHARF #1	FLOYD	28	1S	5E	727	—	2241	KNOX	619	108	693	900	1567	1623	2107						
													34	-173	-840	-896	-1380						
234	10482	STOLL SCHERZINGER #1	FLOYD	16	3S	6E	450	—	1730	CHAZYA	169	281		380	1022		1143						
														70	-572	-693							
235	04202	ALDRIDGE-BANTA BODINE #1	FOUNTA	16	19N	8W	651	—	2417	KNOX	910	-259	988	1466		1766	1926	2327					
														-815		-1115	-1275	-1676					
236	19587	CRAWFORD GALLOWAY #1	FOUNTA	22	20N	8W	652	—	3758	IRONTO	844	-192	921	1390		1675	1844	2250					
														-738		-1023	-1192	-1598					
237	02915	FOUNTAIN OIL BILSAND #1	FOUNTA	22	20N	9W	532	—	2215	CHAZYA	818	-286		1397		1676	1832						
														-865		-1144	-1300						
238	23849	CONTINENTAL OIL KNOWLES #1	FOUNTA	32	21N	7W	648	—	2175	KNOX	721	-73	798	1265		1570	1735	2124					
														-617		-922	-1087	-1476					
239	06821	RATCLIFF YOUNG #1	FOUNTA	23	21N	8W	565	—	1788	BLACK	636	-71		752	1190		1482	1660					
														-625		-917	-1095						
240	23844	CONTINENTAL OIL SIMS #1	FOUNTA	29	22N	6W	698	—	1907	KNOX	518	180		569	1007		1330	1493	1869				
														-309		-632	-795	-1171					
241	13097	CARTER OIL CO VESTER #1	FOUNTA	33	22N	7W	520	—	1626	BLACK	454	66		522	1015		1320	1485					
														-495		-800	-965						
242	42613	FARRAR OIL CO LOSEKAMP FARMS #1	FRANKL	09	8N	1W	986	—	1804	KNOX							912	1434					
																	74	-448					
243	25996	FISHER FISHER #1	FRANKL	10	10N	11E	950	—	920	BLACK							874	913					
																	76	37					
244	29101	GULF OIL CORP. LAMPING #1	FRANKL	29	11N	12E	747	759	3470	MOUNT							720	760	1254	2931	3386		
																	39	-1	-495	-2172	-2627		
245	29100	GULF OIL CORP. LOHREY #1	FRANKL	03	11N	13E	706	717	3336	MOUNT							637	670	2786	3237			
																	80	47	-430	-2069	-2520		
246	29232	GULF OIL CORP. DENNY #1	FRANKL	08	12N	12E	948	959	1594	KNOX							58	949	1000	1472			
																	901	10	-41	-513			
247	07048	FRANKLIN COUNTY FRANKLIN COUNTY #1	FRANKL	36	12N	12E	675	—	783	BLACK							645	693					
																	30	-18					
248	33678	NIPSCO BURNS #1	FULTON	16	29N	1E	774	—	3175	MOUNT							708	1032	1205	1455	2281	2870	
																	66	-258	-431	-681	-1507	-2096	
249	29391	NIPSCO MORPHET #1	FULTON	17	29N	1E	758	—	3023	MOUNT							630	1010	1200	1440	2258	2852	
																	128	-252	-442	-682	-1500	-2094	
250	22247	NIPSCO DAILEY #1	FULTON	19	29N	1E	738	—	1428	KNOX							605	965	1165	1405			
																	133	-227	-427	-667			
251	33674	NIPSCO TODD #O-121	FULTON	19	29N	1E	735	—	3150	MOUNT							643	987	1170	1410	2242	2838	
																	92	-252	-435	-675	-1507	-2103	
252	27589	NIPSCO HENDRICKSON #1	FULTON	20	29N	1E	747	—	1428	KNOX								987	1005				
																		-240					
253	31615	NIPSCO SOMMERS #2	FULTON	20	29N	1E	740	—	3000	MOUNT							615	959	1155	1380	2192	2797	
																	125	-219	-415	-640	-1452	-2057	
254	33680	NIPSCO SOMMERS #O-44	FULTON	20	29N	1E	739	745	1408	KNOX							610	968		1385			
																	135	-223		-640			
255	32424	NIPSCO SADLER #1	FULTON	21	29N	1E	751	—	3200	MOUNT							714	1080	1254	1500	2384	2968	
																	37	-329	-503	-749	-1633	-2217	
256	36190	NIPSCO VANMETER #O-127	FULTON	21	29N	1E	742	—	3038	MOUNT							585	975	1195	1421	2196	2803	
																	147	-233	-453	-679	-1454	-2061	
257	22095	NIPSCO SOMMERS #1	FULTON	29	29N	1E	750	—	1456	KNOX							605	1005					
																	45	-255					
258	28291	NIPSCO THOMAS #2	FULTON	29	29N	1E	747	758	1411	KNOX							572	933	1125	1380			
																	186	-186	-367	-622			
259	28358	NIPSCO SOMMERS #2	FULTON	29	29N	1E	743	—	1418	KNOX							580	980	1160	1390			
																	163	-237	-417	-647			
260	31737	NIPSCO THOMAS #4	FULTON	29	29N	1E	754	—	3130	MOUNT								951	1132	1390	2176	2774	
																		-197	-378	-636	-1422	-2020	
261	31864	NIPSCO THOMAS #2	FULTON	29	29N	1E	741	755	3115	MOUNT								613	959	1128	1375	2177	2776
																		142	-204	-373	-620	-1436	-2035

DATA BASE FOR DEEP WELLS IN INDIANA—Continued

PERMIT	OPERATOR FARM-WELL#	COUNTY	LOCATION	ELEVATION			DEPTH-SUBSEA ELEVATIONS													
				GL	KB	TD	TD FORM	DEV LS	GENEV	SIL	CIN	LEXING	TREN	BLACK	KNOX	EAU CL	MOUNT	PRECAM		
262	32960	NIPSCO SOMMERS #3	FULTON	29	29N	1E	743	—	3125	MOUNT				600		993	1197	1435	2222	2812
														143		-250	-454	-992	-1479	-2069
263	33171	NIPSCO THOMAS #1	FULTON	29	29N	1E	739	744	1400	KNOX				560		947	1134	1382		
														184		-208	-390	-638		
264	33670	NIPSCO THOMAS #S-134	FULTON	29	29N	1E	746	—	3090	MOUNT						939			2176	2771
																-193			-1430	-2025
265	33671	NIPSCO THOMAS #O-124	FULTON	29	29N	1E	746	—	3117	MOUNT				578		950	1175	1402	2180	2771
														168		-204	-429	-656	-1434	-2025
266	33675	NIPSCO SOMMERS #1	FULTON	29	29N	1E	738	—	3110	MOUNT				618		953			2175	2782
														120		-215			-1437	-2044
267	36855	NIPSCO THOMAS #S-140	FULTON	29	29N	1E	745	—	3130	MOUNT				595		964	1140	1403	2166	2770
														150		-219	-395	-658	-1421	-2025
268	37762	NIPSCO THOMAS #S-146	FULTON	29	29N	1E	738	750	3090	MOUNT						953			2182	2781
																-203			-1444	-2043
269	37763	NIPSCO THOMAS #S-147	FULTON	29	29N	1E	743	756	3068	MOUNT						956			2175	2782
																-200			-1432	-2039
270	41131	NIPSCO THOMAS #S-53	FULTON	29	29N	1E	748	—	1396	KNOX						937		1366		
																-189		-618		
271	29412	NIPSCO PFEIL #1	FULTON	30	29N	1E	749	763	3061	MOUNT				612		946	1153	1398	2180	2779
														151		-197	-390	-635	-1431	-2030
272	30660	NIPSCO PFEIL #2	FULTON	30	29N	1E	748	—	2844	MOUNT						948			2183	2782
																-200			-1435	-2034
273	30661	NIPSCO PFEIL #3	FULTON	30	29N	1E	749	—	2770	EAU CL						952			2188	
																-203			-1439	
274	30939	NIPSCO PFEIL #4	FULTON	30	29N	1E	749	763	2618	EAU CL						949			2184	
																-200			-1435	
275	33676	NIPSCO DAILY #2	FULTON	30	29N	1E	739	—	3053	MOUNT				560		948	1155	1385	2185	2791
														179		-209	-416	-646	-1466	-2052
276	36117	NIPSCO DAILY #1	FULTON	30	29N	1E	740	—	1421	KNOX				575		945	1133	1369		
														165		-205	-393	-629		
277	36606	NIPSCO HASELBY #S-141	FULTON	30	29N	1E	741	—	3022	MOUNT						945			2179	2775
																-204			-1438	-2034
278	36607	NIPSCO DAILY #S-142	FULTON	30	29N	1E	739	—	3045	MOUNT						942			2186	2783
																-203			-1447	-2044
279	23517	NIPSCO LEFFEL #2	FULTON	31	29N	1E	745	—	1381	KNOX				575		952	1130	1370		
														170		-207	-385	-625		
280	23520	NIPSCO HENDEE #1	FULTON	31	29N	1E	746	—	1395	KNOX				555		940		1375		
														191		-194		-629		
281	26878	NIPSCO HASELBY #6	FULTON	31	29N	1E	749	761	1411	KNOX				590		953	1131	1380		
														171		-204	-370	-619		
282	26880	NIPSCO HASELBY #7	FULTON	31	29N	1E	746	—	1402	KNOX						954			1347	
																-208			-601	
283	26881	NIPSCO SOMMERS #3	FULTON	31	29N	1E	744	756	1399	KNOX				570		945	1122	1371		
														186		-189	-366	-615		
284	28134	NIPSCO HIATT #3	FULTON	31	29N	1E	749	—	1414	KNOX						936				
																-187				
285	28196	NIPSCO HASELBY #9	FULTON	31	29N	1E	743	—	1422	KNOX						941				
																-198				
286	31128	NIPSCO THOMAS #1	FULTON	31	29N	1E	744	—	1431	KNOX						948		1390		
																-204		-646		
287	31846	NIPSCO HASELBY #19	FULTON	31	29N	1E	746	—	3126	MOUNT				579		954	1144	1395	2185	2782
														167		-208	-398	-649	-1439	-2036
288	32999	NIPSCO HASELBY #20	FULTON	31	29N	1E	736	—	3100	MOUNT				580		925	1124	1390	2167	2766
														156		-189	-388	-654	-1431	-2030
289	33172	NIPSCO HASELBY #10	FULTON	31	29N	1E	744	—	1419	KNOX						942				
																-198				
290	33669	NIPSCO HENDEE #S-135	FULTON	31	29N	1E	746	—	3102	MOUNT						945			2177	2778
																-199			-1431	-2032

DATA BASE FOR DEEP WELLS IN INDIANA

DATA BASE FOR DEEP WELLS IN INDIANA—Continued

PERMIT	OPERATOR FARM-WELL#	COUNTY	LOCATION		ELEVATION		TD	TD FORM	DEPTH-SUBSEA ELEVATIONS													
					GL	KB			DEV LS	GENEV	SIL	CIN	LEXING	TREN	BLACK	KNOX	EAU CL	MOUNT	PRECAM			
349	14455	DOME-MINICK OIL HAYWORTH #1	HENDRI	05	14N	1W	868	—	1700	BLACK	687 181	774 94	804 64	1080 -212	1493 -625	1648 -780						
350	00891	GRIFFIN OIL CO HOBBS NURSERY #1	HENDRI	17	15N	2E	762	—	1400	BLACK	352 410	435 327	465 297	655 107	1180 -398	1320 -558						
351	30314	MORAN NUGEN #1 (ST-3)	HENRY	25	16N	10E	1081	—	1560	KNOX					915 166	1055 26	1450 -369					
352	03215	OHIO OIL CO. MAY #1	HENRY	12	16N	11E	1060	—	3664	PRECAM					869 191	1000 60	1370 -310	2800 -1740	3318 -2258	3649 -2589		
353	09710	FARMERS & BUS. OIL COBLE #1	HENRY	04	17N	9E	1052	—	1229	BLACK			321 731	1022 30	1146 -94							
354	07876	PHILLIPS HAGERMAN #1	HENRY	07	17N	10E	1036	—	1410	BLACK					960 76	1079 -43						
355	10369	TRENTON OIL CO. STEPHENS #1	HENRY	08	17N	10E	1057	—	1220	BLACK					959 98	1085 -28						
356	07825	BLUE RIVER DRLG. WINTER #1	HENRY	16	17N	10E	963	—	1535	KNOX					860 103		1470 -507					
357	10139	BLUE RIVER DRLG. FORT #1	HENRY	20	17N	10E	1061	—	1379	BLACK			230 831	954 107	1100 -39							
358	31000	HORIZON OIL INC. DRAPER #1-H	HENRY	30	17N	10E	1028	—	2090	KNOX				221 807	932 96	1070 -42	1494 -466					
359	13973	SINNOCK ITERMAN #1	HENRY	06	17N	11E	1083	—	1368	BLACK					960 123	1093 -10						
360	13974	SINNOCK MCELROY #1	HENRY	25	18N	10E	1070	—	1301	BLACK					952 118	1079 -9						
361	13972	SINNOCK SINNOCK #1	HENRY	27	18N	10E	1015	—	1261	BLACK					943 72	1070 -55						
362	14875	VAN BURNEN OIL ELAM #1	HENRY	25	19N	10E	996	—	1235	BLACK			180 816	923 73	1055 -59							
363	110555	KOKOMO GAS GREENTOWN WELL #1	HOWARD	32	24N	5E	821	—	3996	PRECAM					924 -103		1351 -530	2345 -1524	3075 -2254	3945 -3124		
364	28947	BANNISTER KEM #1	HUNTIN	01	26N	8E	814	822	1786	KNOX			375 477	984 -162	1160 -338	1473 -651						
365	35330	SIXBEY RALSTON #1	HUNTIN	02	26N	9E	820	—	1650	KNOX					988 -168	1155 -335	1396 -576					
366	34442	SCOTT KING #1	HUNTIN	17	26N	9E	838	—	1480	KNOX			370 468	982 -144	1160 -322							
367	25210	CONTINENTAL OIL DENNIS #1	HUNTIN	30	29N	10E	829	834	1636	KNOX			555 279	1187 -353	1374 -540	1625 -791						
368	34538	WHITMER SCHNEIDER #1	JACKSO	08	4N	4E	592	—	2105	KNOX	494 98	547 45	572 20	790 -198	1436 -844	1500 -908	2006 -1414					
369	03284	AETNA OIL CO TURKHORN #1	JACKSO	06	4N	5E	550	—	1503	BLACK	335 215		410 140	590 -40	1250 -700	1290 -740						
370	00344	SIOI CO. ANDERSON #1	JACKSO	11	5N	2E	843	—	2475	KNOX	815 28		909 -66	1132 -289	1754 -911	1843 -1000	2340 -1497					
371	28253	HYDRO-CARBONS INC. MOENING #1	JACKSO	09	5N	4E	535	—	2169	KNOX	384 151		440 96	634 -99	1281 -756	1370 -835	1870 -1335					
372	18871	JORDAN FLEETWOOD #1	JACKSO	36	7N	2E	561	—	1945	KNOX	431 130	500 61	532 29	738 -177	1347 -786	1440 -879	1925 -1364					
373	24960	NIPSCO ROBINSON #1	JASPER	03	29N	5W	678	—	1321	KNOX			585 93	875 -197	1045 -367	1290 -612						
374	32732	NIPSCO STEWART #1	JASPER	15	29N	5W	687	—	1393	KNOX			605 82	882 -195	1078 -391	1323 -636						
375	32760	NIPSCO OVERMYER FARMS #1	JASPER	16	29N	5W	693	—	3195	MOUNT			23 670	576 117	920 -227		1333 -640	2184 -1491	2791 -2098			
376	32904	NIPSCO ALBRECHT #1	JASPER	24	29N	5W	685	—	1097	BLACK			80 605	885 -200	1090 -405							
377	32591	RANDEK INC. HOFFMAN #1	JASPER	07	31N	6W	690	—	1203	BLACK					932 -242	1120 -430						

DATA BASE FOR DEEP WELLS IN INDIANA—Continued

PERMIT	OPERATOR FARM-WELL#	COUNTY	LOCATION		ELEVATION			DEPTH-SUBSEA ELEVATIONS									
								GL	KB	TD	TD FORM	DEV LS	GENEV	SIL	CIN	LEXING	TREN
378	29105	NIPSCO MEZYDLO #1	JASPER	06	31N	7W	673	—	3105	MOUNT	145	680	943	1126	1690	2185	2810
											528	-7	-270	-453	-1017	-1512	-2137
379	30006	NIPSCO BOZEMAN #1	JASPER	06	31N	7W	668	—	3658	MOUNT	140	619	906	1096	1325	2186	2807
											528	49	-238	-428	-657	-1518	-2139
380	26537	JASPER COUNTY SIPKEMA #1	JASPER	21	31N	7W	688	—	1275	BLACK	60	715	931	1120			
											628	-27	-243	-432			
381	03378	KORFF FORSHEY #1	JAY	13	19N	1W	1110	—	1785	KNOX			1212	1345	1759		
													-102	-235	-649		
382	43178	ORION RESOURCES CHAMP #1	JAY	02	22N	12E	969	—	1585	KNOX		223	986	1150	1515		
											746	-17	-181	-546			
383	31590	GUNDERSON KNOTE #1	JAY	10	22N	12E	959	—	1508	KNOX		210	970	1129	1405		
											749	-11	-170	-446			
384	32422	MOSES AND STEWART SODDERS #1	JAY	22	22N	12E	950	—	1490	KNOX		189	943	1109	1425		
											761	7	-156	-475			
385	00258	LARAPPAUL OIL CO. LANDAUR #1	JAY	25	22N	12E	969	—	1390	KNOX			968	1128	1313		
													1	-159	-344		
386	29674	MOSES AND STEWART FRIDDLE #1	JAY	25	22N	12E	969	—	1475	KNOX		220	976	1125	1410		
											749	-7	-156	-441			
387	30242	MOSES AND STEWART CURTS #1	JAY	25	22N	12E	965	—	1456	KNOX		220	970	1127	1401		
											745	-5	-162	-436			
388	31157	MOSES AND STEWART CURTS #2	JAY	25	22N	12E	969	—	1452	KNOX		230	969	1130	1380		
											739	0	-161	-391			
389	32724	MOSES SHRACK #1	JAY	27	22N	12E	943	—	1435	KNOX		150	917	1075	1323		
											793	26	-132	-380			
390	38325	PREMIER OIL LTD. WILLMAN #1	JAY	35	22N	12E	972	—	1635	KNOX			970	1135	1525		
													2	-163	-553		
391	15752	FLESHER PETERS #1	JAY	14	22N	13E	982	—	1398	KNOX		219	971		1370		
											772	11		-388			
392	12944	RA-JA OIL CO. ROSS #1	JAY	35	22N	13E	983	—	1415	BLACK		175	973	1123			
											808	10	-140				
393	02492	MUEHLHAUSEN MILLER #1	JAY	24	22N	14E	993	—	1395	BLACK			1070	1220			
													-77	-227			
394	39099	HAMILTON NUCKOLS #1	JAY	26	22N	14E	1063	—	1503	BLACK		260	1149	1305			
											803	-86	-242				
395	10566	RHODES PRESCOTT #1	JAY	02	22N	15E	944	—	1405	BLACK			1044	1185			
													-100	-241			
396	02574	MUEHLHAUSEN HILFICKER #1	JAY	05	22N	15E	965	—	1567	KNOX		245	1054	1204	1547		
											720	-89	-239	-582			
397	30453	HORIZON OIL INC. SMITH #1-H	JAY	06	22N	15E	944	—	2200	KNOX			1043	1204	1555		
													-99	-260	-611		
398	41658	SHRACK SHRACK #2	JAY	28	23N	12E	936	—	1664	KNOX			953	1105	1400		
													-17	-169	-464		
399	41887	ORION RESOURCES SHRACK #3	JAY	28	23N	12E	941	—	1650	KNOX			964	1132	1428		
													-23	-191	-487		
400	28649	KWIS KWIS #1	JAY	03	23N	13E	896	—	1270	BLACK			967	1120			
													-71	-224			
401	16746	KWIS KWIS #1	JAY	17	23N	13E	890	—	1455	CHAZYA		225	935	1095			
											665	-45	-205				
402	02467	GRISSELL & KWIS ANKROM #2	JAY	23	23N	13E	892	—	1312	BLACK			932	1100			
													-40	-208			
403	21305	CONTINENTAL OIL RESUR #1	JAY	31	23N	13E	922	—	3100	MOUNT		195	940	1100	1380	2476	3004
											727	-18	-178	-458	-1554	-2082	
404	13892	MILLER ZORN #1	JAY	17	23N	15E	943	—	1525	KNOX		225	1058	1220	1500		
											718	-115	-277	-557			
405	39102	KIRBY MAY #1-26	JAY	26	23N	15E	935	942	1695	KNOX		218	1038	1190	1545		
											724	-96	-248	-603			
406	30701	HORIZON OIL INC. CLINE #1-H	JAY	32	23N	15E	932	—	1614	KNOX		210	1038	1199	1511		
											722	-106	-267	-579			
407	34102	MITCHELL INC. MILLER #90-9	JAY	09	24N	12E	899	—	1723	KNOX		270	1005	1180	1513		
											629	-106	-281	-614			

DATA BASE FOR DEEP WELLS IN INDIANA

DATA BASE FOR DEEP WELLS IN INDIANA—Continued

PERMIT	OPERATOR FARM-WELL #	COUNTY	LOCATION		ELEVATION			DEPTH-SUBSEA ELEVATIONS															
					GL	KB	TD	TD FORM	DEV LS	GENEV	SIL	CIN	LEXING	TREN	BLACK	KNOX	EAU CL	MOUNT	PRECAM				
437	18677	AMBASSADOR OIL HARTMAN #1	LAGRAN	02	37N	9E	867	—	3483	EAU CL	720 147		931 -64	1550 -683		2205 -1338	2445 -1578	2695 -1828	3478 -2611				
438	21643	NIPSCO COMPTON #1	LAKE	28	32N	8W	840	—	1348	KNOX				605 35		886 -246	1080 -440	1305 -665					
439	29945	NIPSCO HAYDEN #1	LAKE	30	32N	8W	640	—	3052	MOUNT						902 -262	1100 -460	1380 -740	2189 -1549	2805 -2165			
440	02573	FOX CARSTEN #1	LAKE	05	32N	9W	682	—	2438	EAU CL				612 70		880 -198	1070 -388	1350 -668	2118 -1436				
441	02132	ELLIOTT LITTLE #1	LAKE	30	32N	9W	634	—	1315	CHAZYA						575 59	840 -206	1030 -396					
442	02082	BONDED OIL CO. WILLIAMS #1	LAKE	33	32N	9W	632	—	1665	KNOX						595 37	852 -220	1070 -438	1330 -698				
443	26840	S. I. R. CORP CORBIN-ARNOLD #1	LAKE	16	34N	7W	740	—	1370	CHAZYA	285 455		380 360	760 -20		1045 -305	1230 -490						
444	07008	SEWAGE SANITATION BURGE #1	LAKE	24	35N	9W	685	—	1250	CHAZYA				220 465		885 -200	1080 -395						
445	100349	DOME OIL CO. IND. CENT. LAND #1	LAKE	22	36N	9W	623	—	2458	MOUNT								805 -182	1217 -594	1864 -1241			
446	100351	U. S. STEEL U. S. STEEL #WD-1	LAKE	29	37N	8W	588	600	4303	MOUNT								810 -210	1037 -437	1190 -590	1838 -1238	2384 -1784	
447	112830	INLAND STEEL INLAND STEEL #WD-1	LAKE	14	37N	9W	596	608	4363	PRECAM				620 -12		791 -183		1459 -851	1810 -1202	2345 -1737	4350 -3742		
448	03727	SUPERHEATER CO. SUPERHEATER CO. #1	LAKE	32	37N	9W	586	—	1845	EAU CL				595 8		765 -179	970 -384	1200 -614	1840 -1254				
449	29734	KINGSBURY OIL BARR #1	LAPORT	17	36N	3W	808	—	1821	KNOX	418 390		557 251	1018 -210		1287 -479	1534 -726	1643 -835					
450	26845	TEXAS GAS TRANS OLLIS #1-2854	LAWREN	04	4N	2E	720	—	2591	KNOX	711 9			1093 -373		1708 -988							
451	10749	REGIONAL DEV. LEWIS #1	LAWREN	34	4N	2W	810	—	2555	BLACK	1356 -546			1490 -680	1870 -1060		2392 -1582	2510 -1700					
452	29066	TEXAS GAS TRANS. BROWN #2614	LAWREN	20	5N	2E	791	800	6806	PRECAM	776 24	845 -45	878 -78	1145 -345		1761 -961	1843 -1043	2360 -1560	4706 -3906	5491 -4691	6650 -5850		
453	34372	COLUMBIA GAS HILL #1	LAWREN	27	5N	2E	659	668	2502	KNOX	794 -126			915 -247	1160 -492		1624 -956	1705 -1037	2215 -1547				
454	34336	COLUMBIA GAS MARTIN #1	LAWREN	12	6N	1E	562	571	2500	KNOX	768 -197	855 -284	890 -319	1180 -589		1782 -1211		2170 -1599					
455	23884	PAN AMERICAN HELTONVILLE #1-U	LAWREN	24	6N	1E	728	—	2465	CHAZYA	903 -175	1018 -290	1060 -332	1337 -609		1951 -1223	1986 -1258						
456	23985	PAN AMERICAN HELTONVILLE #2	LAWREN	24	6N	1E	725	—	2381	CHAZYA	860 -135	960 -235	999 -274	1262 -537		1814 -1089	1930 -1205						
457	23986	PAN AMERICAN HELTONVILLE #2-U	LAWREN	24	6N	1E	727	—	2330	CHAZYA	897 -170	984 -257	1061 -334	1328 -601		1786 -1059	1868 -1141						
458	40339	GOTHARDS DRILL. LAWLER #1	MADISO	29	18N	8E	933	—	1370	KNOX								910 23	1050 -117	1360 -427			
459	00253	ANDERSON COY #1	MADISO	01	19N	6E	850	—	1541	KNOX								802 48	942 -92	1236 -386			
460	30144	HARRIS FAUST #1	MADISO	13	19N	6E	869	—	1140	BLACK				220 649		830 39	978 -109						
461	34466	CARRAWAY LAWSON #1	MADISO	24	19N	6E	869	—	1433	KNOX				284 585		900 -31	1048 -179	1369 -500					
462	30000	HARRIS VASBINDER #1	MADISO	05	19N	7E	862	—	1183	BLACK								875 -13	1025 -163				
463	29537	HARRIS SIMMERMAN #1	MADISO	36	20N	6E	857	—	1350	KNOX								817 40	960 -103	1285 -428			
464	30557	HARRIS HALL #1	MADISO	29	20N	7E	868	—	1121	BLACK				246 622		820 48	957 -89						
465	29981	HARRIS LIKENS #1	MADISO	31	20N	7E	864	—	1312	KNOX				150 714		796 68	940 -76	1248 -384					

DATA BASE FOR DEEP WELLS IN INDIANA

DATA BASE FOR DEEP WELLS IN INDIANA—Continued

PERMIT	OPERATOR FARM-WELL#	COUNTY	LOCATION		ELEVATION		TD	TD FORM	DEPTH-SUBSEA ELEVATIONS													
					GL	KB			DEV LS	GENEV	SIL	CIN	LEXING	TREN	BLACK	KNOX	EAU CL	MOUNT	PRECAM			
524	36149	CITIZENS GAS TEMPLE-EASTEX #1	OWEN	12	9N	5W	598	614	2500	BLACK	1305 -691	1405 -791	1444 -830	1945 -1331	2297 -1683	2455 -1841						
525	06279	TEXAS CO. JEAN #1	OWEN	23	9N	5W	630	—	2560	BLACK	1403 -773	1528 -898	1562 -932	2000 -1370	2370 -1740	2533 -1903						
526	02265	SUN OIL CO. CHAMBERS #1	OWEN	23	10N	5W	712	—	3185	KNOX	1411 -699	1524 -812	1558 -846	1967 -1255	2341 -1629	2503 -1791	3000 -2288					
527	38716	BEARD KELLY #1	OWEN	06	11N	3W	763	—	2871	KNOX	1130 -387	1235 -472	1270 -507	1620 -857	1980 -1217	2150 -1387	2590 -1827					
528	11103	MICHEL RITTER #1	OWEN	35	11N	3W	703	—	2046	BLACK	964 -261	1075 -372	1105 -402	1445 -742	1815 -1112	1970 -1267						
529	02896	SUN OIL CO. GIBSON #1	PERRY	17	4S	1W	748	—	3534	KNOX	1754 -1006		1850 -1102	2263 -1515	2862 -2114	2867 -2119	3464 -2716					
530	02657	CENTRAL PIPE DELAISE #1	PERRY	25	4S	3W	846	—	3255	BLACK	1945 -1299		2070 -1424	2580 -1914	3130 -2484	3142 -2496						
531	24642	ULAND LEISTNER #1	PIKE	06	1S	6W	481	—	4508	CHAZYA	2421 -1940		2920 -2439	3390 -2909	3746 -3265	3905 -3424						
532	17019	INDIANA FARM BUR. SUBAR #1	PIKE	25	1S	9W	447	—	4665	BLACK	2996 -2549		3570 -3123	4141 -3694	4454 -4007	4604 -4157						
533	109287	STOLTENBERG CON. INDIANA GEN. #WD-1	PORTER	16	35N	5W	774	784	4548	PRECAM	318 466		440 344	894 -110	1131 -347	1380 -596	1498 -714	2177 -1393	2762 -1978	4533 -3749		
534	114359	PFIZER CHEMICAL #2	PORTER	16	35N	5W	774	786	4528	PRECAM				910 -124	1138 -352	1500 -1014	2164 -1398	2766 -1980	4510 -3724			
535	07874	EGELSKA EGELSKA #3	PORTER	09	36N	5W	699	—	1310	BLACK				800 -101	1051 -352	1280 -581						
536	100338	BETHLEHEM STEEL BETHLEHEM #WD-1	PORTER	28	37N	6W	613	625	4304	PRECAM	200 425		256 368	745 -120	958 -333	1175 -550	1308 -683	1959 -1346	2536 -1933	4263 -3638		
537	112983	BETHLEHEM STEEL BETHLEHEM #WD-2C	PORTER	29	37N	6W	613	624	4301	PRECAM			250 374	729 -105	938 -314	1145 -521	1355 -731	1952 -1328	2518 -1894	4265 -3641		
538	112984	BETHLEHEM STEEL BETHLEHEM #WD-1C	PORTER	30	37N	6W	613	624	3945	MOUNT			238 386	730 -106	936 -312	1150 -526	1946 -1322	2511 -1887				
539	100341	MIDWEST STEEL MIDWEST STEEL #WD-1	PORTER	25	37N	7W	603	615	4308	PRECAM			248 367	695 -80	930 -315	1150 -535	1345 -730	1928 -1313	2486 -1871	4259 -3644		
540	36605	EXXON CORP. FORD-CORBIN #1	POSEY	12	4S	14W	383	398	7500	CHAZYA	4940 -4542		5680 -5282	6209 -5811	6521 -6123	6639 -6241						
541	113208	GENERAL ELEC. GENERAL ELEC. #WD-2	POSEY	19	7S	13W	395	409	7980	KNOX	4888 -4479		6020 -5611	6472 -6063	6748 -6339	6900 -6491	7877 -7468					
542	22298	NIPSCO LEFFEL #1	PULASK	25	29N	1W	737	—	2215	EAU CL				580 157	930 -193	1137 -400	1360 -623	2195 -1458				
543	31054	NIPSCO CARPENTER #1	PULASK	25	29N	1W	734	—	1476	KNOX				655 79	972 -238	1174 -440	1393 -659					
544	33682	NIPSCO HASELBY #0-46	PULASK	25	29N	1W	735	—	3029	MOUNT				602 133	970 -235	1156 -421	1410 -675	2225 -1490	2827 -2092			
545	33643	NIPSCO SKILLEN #1	PULASK	35	29N	1W	723	—	3150	MOUNT				603 120	956 -235	1150 -427	1388 -665	2255 -1532	2645 -2122			
546	21963	NIPSCO COLEMAN #1	PULASK	36	29N	1W	724	—	1370	CHAZYA				565 159	931 -207							
547	33173	NIPSCO HASELBY #12	PULASK	36	29N	1W	737	—	1406	KNOX				572 165	939 -202	1127 -380	1373 -636					
548	38040	NIPSCO HASELBY #0-148	PULASK	36	29N	1W	733	—	3121	MOUNT					955 -222			2208 -1475	2803 -2070			
549	34025	NIPSCO GOORY #6-18	PULASK	07	29N	2W	687	—	3102	MOUNT			585 102	894 -207	1105 -418	1332 -645	2060 -1373	2678 -1991				
550	33573	NIPSCO WALSH FARMS #L-11	PULASK	15	29N	2W	704	—	3100	MOUNT				600 104	940 -236	1155 -451	1347 -643	2138 -1434	2744 -2040			
551	33504	NIPSCO HANAWALT #1	PULASK	16	29N	2W	690	—	3106	MOUNT				550 140	869 -179	1070 -380	1302 -612	2058 -1368	2667 -1977			
552	34001	NIPSCO CRIST #2	PULASK	20	29N	2W	683	—	3101	MOUNT				580 103	910 -227		1345 -662	2202 -1519	2801 -2118			

DATA BASE FOR DEEP WELLS IN INDIANA—Continued

PERMIT	OPERATOR FARM-WELL#	COUNTY	LOCATION			ELEVATION		TD	TD FORM	DEPTH-SUBSEA ELEVATIONS															
						GL	KB			DEV LS	GENEV	SIL	CIN	LEXING	TREN	BLACK	KNOX	EAU CL	MOUNT	PRECAM					
553	26953	NIPSCO WEAVER #1	PULASK	35	29N	2W	700	—	1368	KNOX				570		915	1085	1345							
														130		-215	-385	-645							
554	34079	NIPSCO LEDFORD #L-19	PULASK	21	29N	3W	687	—	3000	MOUNT				589		896						2111	2705		
														98		-209						-1424	-2018		
555	33903	NIPSCO GOBLE #L-15	PULASK	24	29N	3W	690	—	3059	MOUNT				550		872		1280				2045	2654		
														140		-182		-590				-1355	-1964		
556	33856	NIPSCO GOBLE #L-16	PULASK	25	29N	3W	685	—	3115	MOUNT				530		853	1113	1370				2028	2637		
														155		-168	-428	-685				-1343	-1952		
557	23332	CONTINENTAL OIL DAVIS #1	PULASK	26	29N	3W	680	—	1340	KNOX				548		865	1093	1293							
														132		-185	-413	-613							
558	33542	NIPSCO GOOD #2	PULASK	26	29N	3W	685	—	3151	MOUNT						846	1062					2042	2650		
																-161	-377					-1357	-1965		
559	33644	NIPSCO GOOD #L-12	PULASK	26	29N	3W	675	—	3109	MOUNT				540		837	1041	1276				2034	2540		
														135		-162	-366	-601				-1359	-1965		
560	33666	NIPSCO WHITE #L-13	PULASK	26	29N	3W	665	—	2188	EAU CL				535		856	1078	1340				2145			
														130		-191	-413	-675				-1480			
561	44761	HALL GOOD #L-14	PULASK	26	29N	3W	667	—	2746	MOUNT						838						2064	2682		
																-171						-1397	-2015		
562	33220	SANDERS LOWRY FARMS #1	PULASK	15	29N	4W	675	—	2900	MOUNT						35	590	878	1080	1343		2140	2731		
																640	85	-203	-405	-668		-1465	-2056		
563	23968	CONTINENTAL OIL PETERS #1	PULASK	10	30N	1W	718	—	1504	KNOX						651		999	1179	1425					
																67		-281	-461	-707					
564	34099	NIPSCO HINTZ #L-20	PULASK	33	30N	2W	695	—	3009	MOUNT						610		907	1134	1320		2100	2691		
																85		-212	-439	-625		-1405	-1996		
565	23946	CONTINENTAL OIL BOWEN #1	PULASK	16	31N	2W	712	—	1482	KNOX						221	706	1023	1230	1432					
																491	6	-311	-518	-720					
566	00612	WILLIAMS COOPER #1	PUTNAM	10	13N	4W	710	—	2560	KNOX	1005						1502	1855				2462			
											-430						-792	-1145	-1752						
567	11099	HAYES DRILLING NICHOLS #1	PUTNAM	17	14N	3W	810	—	2376	KNOX	936						1050	1090	1397	1764	1918	2340			
											-126						-240	-280	-587	-954	-1108	-1530			
568	00651	STANOLIND OIL WELLS #1	PUTNAM	15	14N	5W	755	—	2829	KNOX	1091						1182	1216	1559	1920	2085	2526			
											-336						-427	-461	-804	-1165	-1330	-1771			
569	31337	SOSSAMON LUMPKIN #1	RANDOL	05	18N	13E	1120	—	1572	KNOX								190	1035	1153	1555				
																		930	85	-33	-435				
570	21420	CONTINENTAL OIL JOHNTING #1	RANDOL	15	18N	14E	1159	—	2750	EAU CL									191	1109	1185	1593	2702		
																			968	50	-26	-434	-1543		
571	29158	CENTRAL IND. GAS CLARK #8-C	RANDOL	08	19N	13E	1078	—	1564	KNOX										1007			1534		
																				71			-456		
572	24835	CENTRAL IND. GAS CULLISON #9T-10	RANDOL	09	19N	13E	1124	—	1590	KNOX											1025		1487		
																					99		-363		
573	24836	CENTRAL IND. GAS CULLISON #9T-11	RANDOL	09	19N	13E	1128	—	1597	KNOX												1033			
																						95			
574	26486	CENTRAL IND. GAS CULLISON #9T-18	RANDOL	09	19N	13E	1130	—	1521	KNOX												1023		1415	
																						107		-285	
575	27967	CENTRAL IND. GAS JOHNSON #9T-32	RANDOL	09	19N	13E	1123	—	1525	CHAZYA												1032			
																						91			
576	27968	CENTRAL IND. GAS CULLISON #9T-19	RANDOL	09	19N	13E	1094	—	1486	KNOX												1002		1437	
																						92		-343	
577	27969	CENTRAL IND. GAS CULLISON #9T-20	RANDOL	09	19N	13E	1128	—	1594	KNOX												1048		1564	
																						80		-436	
578	27970	CENTRAL IND. GAS ARNOLD #9T-26	RANDOL	09	19N	13E	1107	—	1572	KNOX												1025		1550	
																						82		-443	
579	27971	CENTRAL IND. GAS CLARK #9T-21	RANDOL	09	19N	13E	1117	—	1565	KNOX												1030		1530	
																						87		-413	
580	27972	CENTRAL IND. GAS ARNOLD #9T-29	RANDOL	09	19N	13E	1120	—	1516	KNOX													197		
																						90		-35	
581	27973	CENTRAL IND. GAS JOHNSON #9T-33	RANDOL	09	19N	13E	1101	—	1497	KNOX													1011		1476
																						90		-375	

DATA BASE FOR DEEP WELLS IN INDIANA

DATA BASE FOR DEEP WELLS IN INDIANA—Continued

PERMIT	OPERATOR FARM-WELL#	COUNTY	LOCATION	ELEVATION		TD	TD FORM	DEPTH-SUBSEA ELEVATIONS												
				GL	KB			DEV LS	GENEV	SIL	CIN	LEXING	TREN	BLACK	KNOX	EAU CL	MOUNT	PRECAM		
582	27974	CENTRAL IND. GAS CLARK #9T-35	RANDOL	09	19N 13E	1098	—	1493	KNOX						1012		1478			
															86		-380			
583	27975	CENTRAL IND. GAS ARNOLD #9T-25	RANDOL	09	19N 13E	1111	—	1516	KNOX						1024		1486			
															87		-375			
584	27976	CENTRAL IND. GAS CULLISON #9T-31	RANDOL	09	19N 13E	1080	—	1545	KNOX			168			999	1132	1466			
												912			81	-52	-386			
585	27977	CENTRAL IND. GAS ARNOLD #9T-30	RANDOL	09	19N 13E	1079	—	1475	KNOX						987		1438			
															92		-359			
586	27978	CENTRAL IND. GAS ARNOLD #9T-27	RANDOL	09	19N 13E	1122	—	1518	KNOX						1024		1455			
															98		-333			
587	27979	CENTRAL IND. GAS ARNOLD #9T-28	RANDOL	09	19N 13E	1098	—	1495	KNOX						1008		1487			
															90		-369			
588	27980	CENTRAL IND. GAS WATSON #9T-24	RANDOL	09	19N 13E	1121	—	1528	KNOX						1033		1517			
															88		-396			
589	27981	CENTRAL IND. GAS WATSON #9T-23	RANDOL	09	19N 13E	1121	—	1517	KNOX						1032		1481			
															89		-360			
590	27982	CENTRAL IND. GAS CLARK #9T-22	RANDOL	09	19N 13E	1077	—	1473	KNOX						983		1430			
															94		-353			
591	28276	CENTRAL IND. GAS WATSON #9T-38	RANDOL	09	19N 13E	1120	—	1586	KNOX						1032		1484			
															88		-364			
592	28277	CENTRAL IND. GAS WATSON #9T-39	RANDOL	09	19N 13E	1120	—	1583	KNOX						1028		1508			
															92		-368			
593	28442	CENTRAL IND. GAS JOHNSON #9T-40	RANDOL	09	19N 13E	1138	—	1597	KNOX						1060		1586			
															78		-448			
594	28443	CENTRAL IND. GAS SLACK #9G	RANDOL	09	19N 13E	1118	—	1625	KNOX						1039		1542			
															79		-424			
595	28444	CENTRAL IND. GAS JOHNSON #9T-34	RANDOL	09	19N 13E	1126	—	1525	KNOX						1041		1514			
															85		-388			
596	29160	CENTRAL IND. GAS LEWIS #9-L	RANDOL	09	19N 13E	1095	—	1581	KNOX						1008	1127	1528			
															87	-32	-433			
597	29162	CENTRAL IND. GAS CULLISON #9-M	RANDOL	09	19N 13E	1087	—	1584	KNOX						1023	1153	1558			
															64	-66	-471			
598	31389	CENTRAL IND. GAS JOHNSON #9T-56	RANDOL	09	19N 13E	1099	—	1609	KNOX						1000		1402			
															99		-303			
599	33635	CENTRAL IND. GAS WATSON #9T-14	RANDOL	09	19N 13E	1120	—	1599	KNOX			179			1037	1158	1548			
												941			83	-38	-428			
600	33646	CENTRAL IND. GAS CULLISON #9T-13	RANDOL	09	19N 13E	1099	—	1567	KNOX						1029		1522			
															70		-423			
601	33636	CENTRAL IND. GAS WASSON #10T-15	RANDOL	10	19N 13E	1130	—	1617	KNOX						1054	1185	1576			
															76	-55	-446			
602	25577	CENTRAL IND. GAS WATSON #16T-16	RANDOL	16	19N 13E	1132	—	1603	KNOX						1045	1174	1520			
															87	-42	-368			
603	30421	CENTRAL IND. GAS EDWARDS #16T-52	RANDOL	16	19N 13E	1146	—	3352	MOUNT			235			1076	1194	1603	2692	3265	
												911			70	-48	-457	-1546	2119	
604	33634	CENTRAL IND. GAS WILLIAMS #16T-17	RANDOL	16	19N 13E	1086	—	1580	KNOX						1005		1506			
															81		-420			
605	33637	CENTRAL IND. GAS CENTRAL IND. GAS #1	RANDOL	16	19N 13E	1104	—	1972	KNOX						1023	1137	1502			
															81	-33	-398			
606	30407	CENTRAL IND. GAS HOLWAGER #17T-51	RANDOL	17	19N 13E	1115	—	1523	KNOX						1034	1156	1493			
															81	-41	-378			
607	30500	CENTRAL IND. GAS HOLWAGER #17T-53	RANDOL	17	19N 13E	1095	—	1522	KNOX			200			1003	1132	1493			
												895			92	-37	-398			
608	30527	CENTRAL IND. GAS HOLWAGER #17T-54	RANDOL	17	19N 13E	1106	—	1578	KNOX			205			1017	1135	1465			
												901			89	-29	-359			
609	30548	CENTRAL IND. GAS HOLWAGER #17T-55	RANDOL	17	19N 13E	1122	—	1557	KNOX			235			1034	1153	1505			
												887			88	-31	-383			
610	33638	CENTRAL IND. GAS SAGE #17T-12	RANDOL	17	19N 13E	1129	—	1622	KNOX						1057		1580			
															72		-451			

DATA BASE FOR DEEP WELLS IN INDIANA—Continued

PERMIT	OPERATOR FARM-WELL#	COUNTY	LOCATION	ELEVATION GL KB TD TD FORM			DEPTH-SUBSEA ELEVATIONS													
							DEV	LS	GENEV	SIL	CIN	LEXING	TREN	BLACK	KNOX	EAU CL	MOUNT	PRECAM		
611	22687	CENTRAL IND. GAS HAYNES #20T-2	RANDOL	20	19N	13E	1121	—	1647	KNOX				245 876	1036 85	1150 -29	1529 -408			
612	28258	CENTRAL IND. GAS HAYNES #20T-36	RANDOL	20	19N	13E	1151	—	1550	KNOX					1053 98		1511 -360			
613	28409	CENTRAL IND. GAS HAYNES #20T-41	RANDOL	20	19N	13E	1144	—	1538	KNOX					1048 96	1171 -27	1479 -335			
614	29300	CENTRAL IND. GAS HAYNES #20T-43	RANDOL	20	19N	13E	1134	—	1530	KNOX					1042 92		1497 -363			
615	29301	CENTRAL IND. GAS HAYNES #20T-44	RANDOL	20	19N	13E	1142	—	1535	KNOX					1040 102		1493 -351			
616	29379	CENTRAL IND. GAS HAYNES #20T-45	RANDOL	20	19N	13E	1154	—	1588	KNOX					1061 93		1538 -384			
617	33633	CENTRAL IND. GAS HAYNES #20T-48	RANDOL	20	19N	13E	1149	—	3358	MOUNT				268 881	1052 97	1195 -46	1518 -369	2689 -1540	3270 -2121	
618	30356	CENTRAL IND. GAS MYERS #21T-50	RANDOL	21	19N	13E	1120	—	1560	KNOX				190 930	1032 88	1145 -25	1470 -350			
619	30360	CENTRAL IND. GAS KABEL #20T-49	RANDOL	22	19N	13E	1166	—	1604	KNOX				250 916	1084 82	1203 -37	1579 -413			
620	29163	CENTRAL IND. GAS HARPER #29-A	RANDOL	29	19N	13E	1146	—	1353	BLACK					1060 86					
621	28275	CENTRAL IND. GAS BENTZ #30T-37	RANDOL	30	19N	13E	1142	—	1561	KNOX					1019 123	1138 4	1444 -302			
622	31352	ZAVOICO WELCH #1	RANDOL	05	19N	15E	1162	1170	1875	KNOX				260 910	1170 0	1264 -94	1683 -513			
623	14192	TAMBLYN JONES #1	RANDOL	05	20N	12E	1004	—	1296	BLACK				200 804	975 29	1120 -116				
624	14138	FITCHETT RACER #2	RANDOL	09	20N	12E	1008	—	1207	BLACK				202 806	938 70	1072 -64				
625	13658	COOPER BLACKBURN #1	RANDOL	10	20N	12E	1025	—	1240	BLACK				240 785	983 42	1090 -65				
626	13864	ADAMS MEEKS #1	RANDOL	16	20N	12E	1015	—	1284	BLACK					969 46					
627	13746	CALDERWOOD KRAMER #1	RANDOL	21	20N	12E	1023	—	1271	BLACK				210 813	976 47	1108 -85				
628	14214	DILLMAN DRILLING MILLER AND SHAW #1	RANDOL	06	20N	13E	1011	—	1265	BLACK					954 57	1085 -74				
629	14749	DILLMAN DRILLING MILLS #1	RANDOL	30	20N	13E	1038	—	1370	BLACK				190 848	973 65	1100 -62				
630	01849	SEIP WARD #1	RANDOL	10	20N	14E	1073	—	1360	BLACK					1055 18	1173 -100				
631	30922	ZAVOICO TIBBETTS #1	RANDOL	19	20N	15E	1108	—	2310	KNOX					220 888	1118 -10	1220 -112	1664 -556		
632	31351	ZAVOICO HARRIS #1	RANDOL	29	20N	15E	1125	—	2038	KNOX				220 905	1129 -4	1228 -103	1572 -447			
633	31891	ZAVOICO FRAZIER #2	RANDOL	29	20N	15E	1126	—	1672	KNOX				235 891	1141 -15	1233 -107	1608 -482			
634	31758	ZAVOICO FRAZIER #1	RANDOL	32	20N	15E	1135	—	1694	KNOX				235 900	1132 3	1226 -91	1617 -482			
635	32093	ZAVOICO PEACOCK #1	RANDOL	32	20N	15E	1142	—	1606	KNOX					1142 0	1242 -100				
636	00559	GODWIN AND MUNAY ST. JOHN #1	RANDOL	08	21N	12E	938	—	1276	BLACK				150 788	892 46	1062 -124				
637	16469	STANLEY LUDWICK #1	RANDOL	10	21N	12E	943	—	1430	KNOX				175 768	932 11	1075 -132	1405 -462			
638	15968	HICKMAN BYE #1	RANDOL	12	21N	12E	961	—	1261	BLACK				160 801	930 31	1085 -124				
639	14583	FLESHER FLESHER #2	RANDOL	16	21N	12E	961	—	1370	BLACK				120 841	928 33	1065 -104				

DATA BASE FOR DEEP WELLS IN INDIANA

DATA BASE FOR DEEP WELLS IN INDIANA—Continued

PERMIT	OPERATOR FARM-WELL#	COUNTY	LOCATION	ELEVATION		TD	TD FORM	DEPTH-SUBSEA ELEVATIONS																
				GL	KB			DEV LS	GENEV	SIL	CIN	LEXING	TREN	BLACK	KNOX	EAU CL	MOUNT	PRECAM						
699	30793	HORIZON OIL INC. THOMPSON #1-H	WABASH	07	26N 8E	858	—	1347	BLACK						405	1022	1198							
															453	-164	-340							
700	30284	HORIZON OIL INC. EARLY #1-H	WABASH	R13	27N 6E	735	—	1475	KNOX						370	930	1110	1411						
															365	-195	-375	-676						
701	33344	H & M RECOVERY BAER #3	WABASH	R18	27N 6E	777	—	1520	KNOX						390			1379						
															387			-602						
702	22830	CLEMENS BRANE #1	WABASH	11	27N 7E	830	—	1226	BLACK						459	1035	1220							
															371	-205	-390							
703	23177	CLEMENS BUZZARD #1	WABASH	17	27N 6E	793	—	1425	KNOX						359	956	1150	1373						
															434	-163	-357	-580						
704	31233	RELIANCE OIL CO KISNER #1	WABASH	26	28N 6E	797	—	1269	BLACK						502	1057	1238							
															295	-260	-441							
705	30986	HORIZON OIL CO. STAUFFER #1-H	WABASH	06	28N 7E	799	—	1345	BLACK						540	1094	1280							
															259	-295	-481							
706	29024	ASHLAND OIL HUDSON #1	WABASH	25	29N 6E	775	787	3685	PRECAM						542	1083	1260	1459	2458	2994	3654			
															245	-296	-473	-672	-1671	-2207	-2867			
707	200005	COMINCO AMER HUDSON #CA-53	WABASH	25	29N 6E	773	—	2300	EAU CL						516	1066	1247	1444						
															257	-293	-474	-671						
708	30286	HORIZON OIL INC. BAKER #1-H	WABASH	26	29N 6E	786	—	1441	BLACK						560	1120	1304							
															226	-334	-518							
709	32290	PATLA MILLER #1	WABASH	35	29N 6E	787	—	1404	BLACK						530	1093	1278							
															257	-306	-491							
710	41578	ORION RESOURCES SMITH #1	WABASH	08	29N 7E	772	—	1740	KNOX						564	1112	1310	1568						
															208	-340	-538	-796						
711	30594	SIGNS BETTEN #1	WABASH	20	29N 7E	793	—	1338	BLACK						550	1128	1321							
															243	-335	-528							
712	30859	WHITMER DRLG. CUSTER #1	WABASH	30	29N 7E	788	—	1355	BLACK							1076	1290							
																-288	-502							
713	01372	DETRICK AND TOPF BOWMAN #1	WARREN	24	23N 10W	711	—	1730	BLACK	640		690	1187		1460	1630								
										71		21	-476		-749	-919								
714	03871	WASHINGTON COUNTY CAUBLE #1	WASHIN	10	1N 3E	788	—	2025	BLACK	947		1040	1284			1966								
										-159		-252	-496			-1178								
715	04308	WASHINGTON COUNTY ELROD #1	WASHIN	08	2N 4E	746	—	1840	BLACK	753		842				1753								
										-7		-96				-1007								
716	13376	TRI COUNTY EXPL. OWSLEY #1	WASHIN	10	3N 2E	768	—	2002	BLACK	885		1200			1904	1990								
										-117		-432			-1136	-1222								
717	00605	SEIP MCGRAW #1	WAYNE	19	13N 1W	928	—	914	BLACK						865	890								
															63	38								
718	02189	WAYNE COUNTY TAYLOR #1	WAYNE	22	13N 1W	1030	—	3330	MOUNT			26			975	1025	1500	2780	3309					
												1004			55	5	-470	-1750	-2279					
719	02448	WAYNE COUNTY MAGAW #1	WAYNE	34	13N 1W	1135	—	1276	BLACK						1073	1100								
															62	35								
720	103578	IND GEOL. SUR. COOK #SDH-57	WAYNE	12	14N 1W	1028	—	1083	BLACK			47			1018	1051								
												981			10	-23								
721	07467	GORDON DODDRIDGE #1	WAYNE	23	15N 13E	957	—	3907	PRECAM						835	896	1340	2720	3203	3435				
															122	61	-383	-1763	-2246	-2478				
722	42617	FARRAR OIL CO. BRIAR ET AL #1	WAYNE	20	16N 12E	1019	—	1732	KNOX						858	972	1396							
															161	47	-377							
723	12695	WAYNE OIL HOOVER #1	WAYNE	35	17N 12E	1022	—	1655	KNOX						907	970	1380							
															115	52	-358							
724	32105	ZAVOICO STRICKLER #1	WAYNE	20	17N 13E	1074	—	1512	KNOX						952	1054	1472							
															122	20	-398							
725	17199	MEANS BILLHEIMER #1	WAYNE	28	18N 12E	1062	—	2018	KNOX						947		1478							
															115	-416								
726	02579	FOX METZ #1	WELLS	11	25N 10E	849	—	2300	DAVIS						980	1160	1497							
															-131	-311	-648							
727	37132	BRETT SMELTZER #16-A	WELLS	11	25N 10E	841	—	1600	KNOX						967	1150	1462							
															-126	-309	-621							
728	22169	MCOLLUM & KINCAID HILES #1	WELLS	13	25N 10E	849	—	1214	BLACK						988									
															-139									

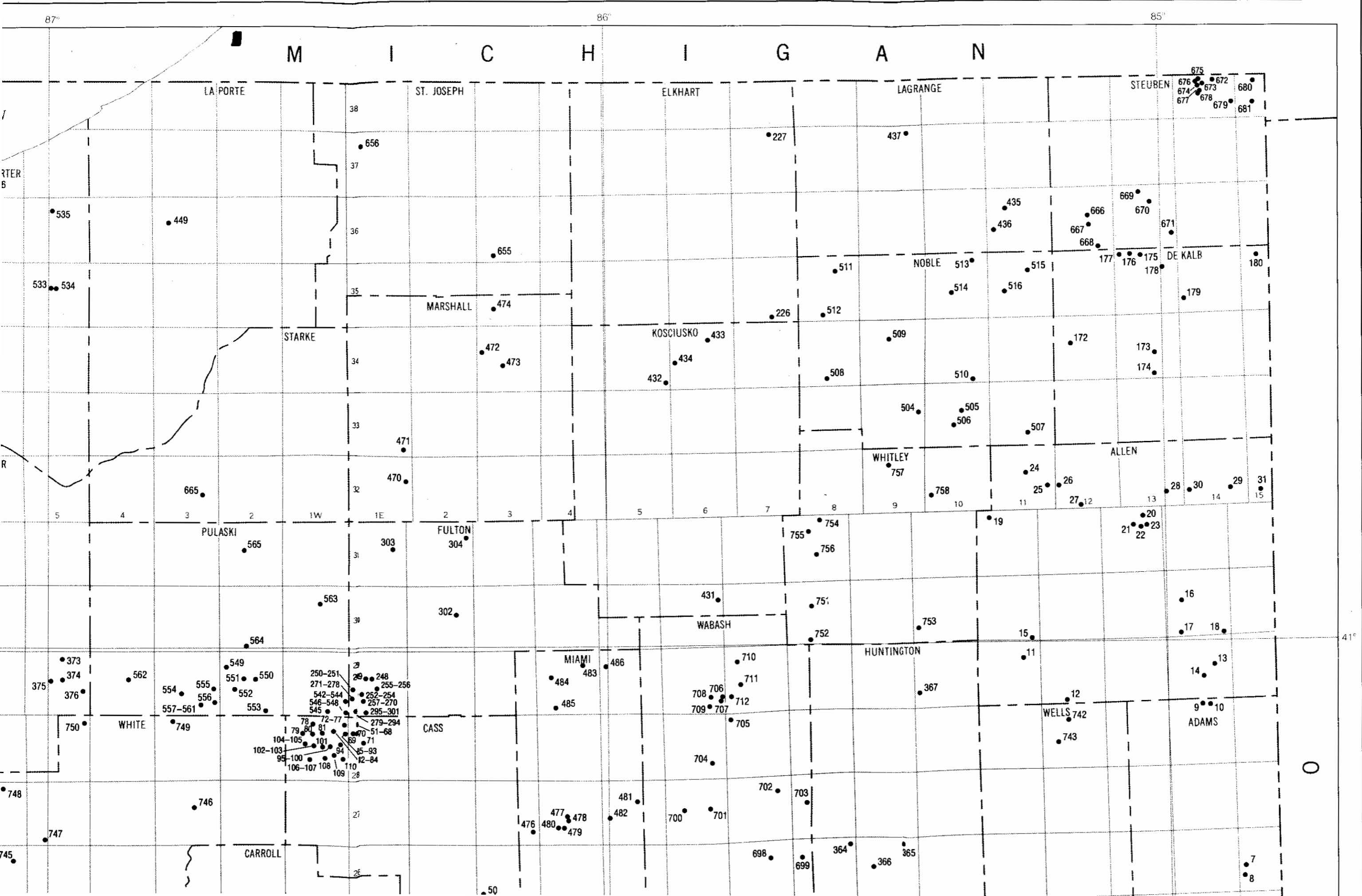

GEOLOGICAL SURVEY
JOHN B. PATTON, STATE GEOLOGIST

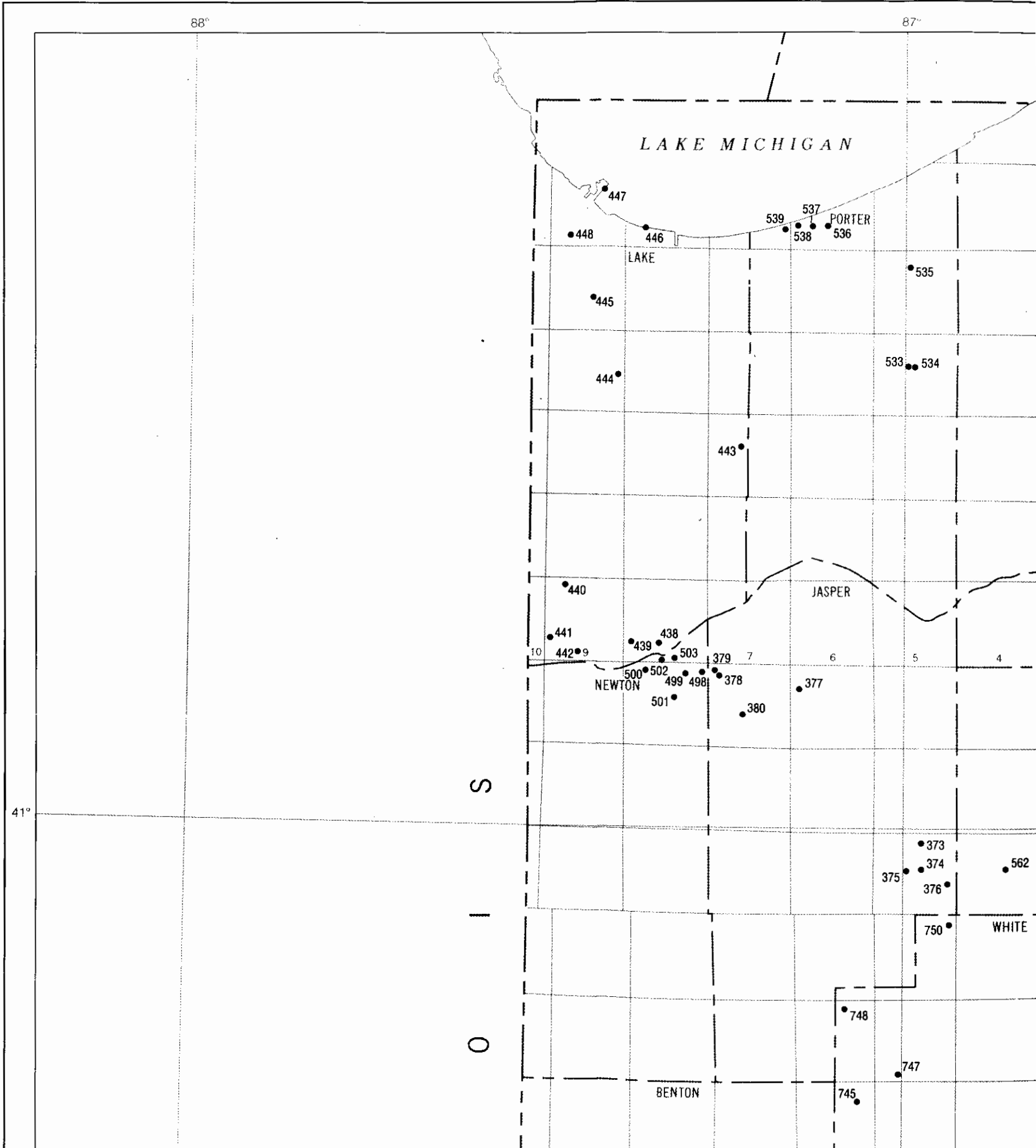

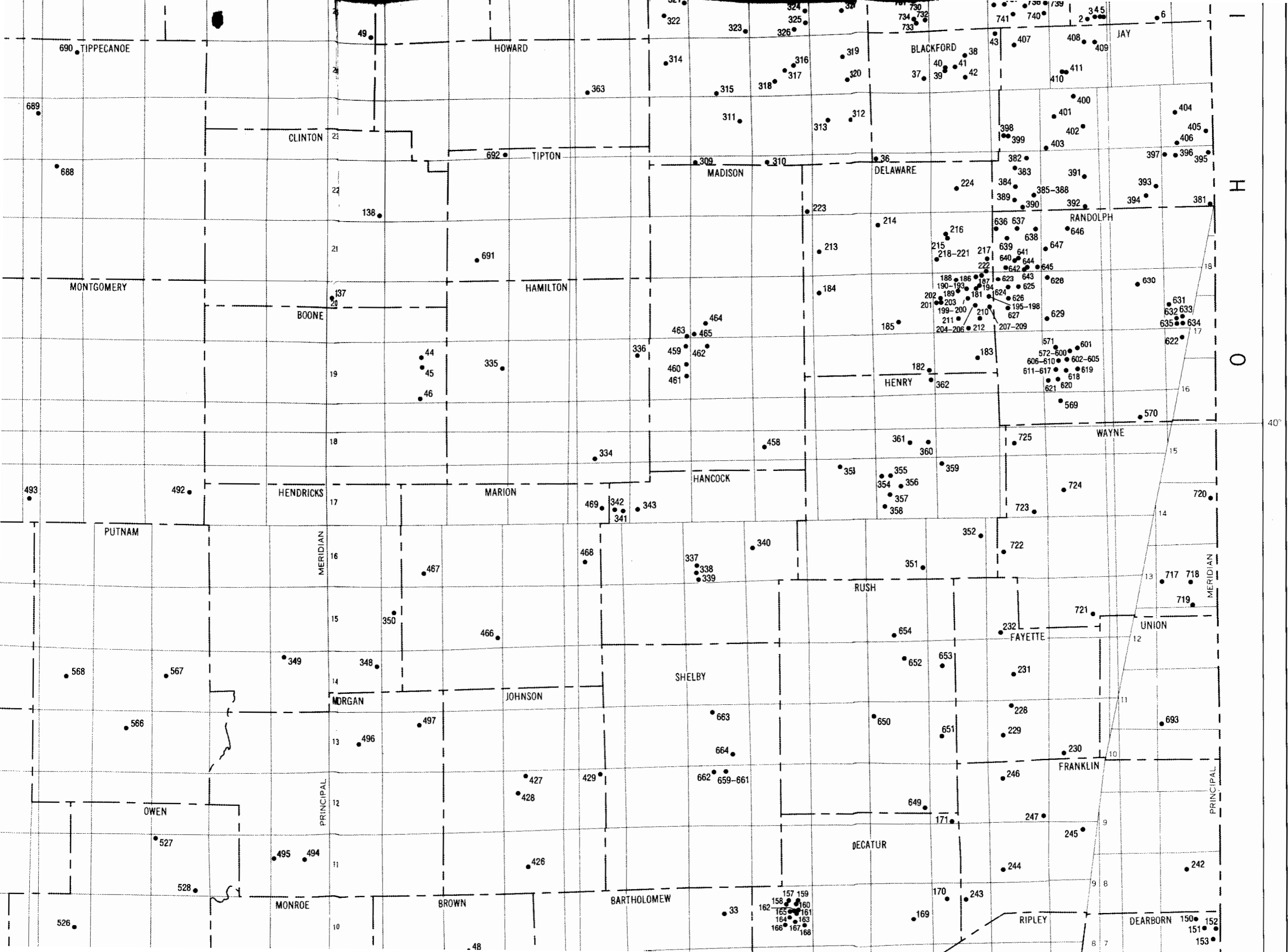

O
N
I
L
L
I

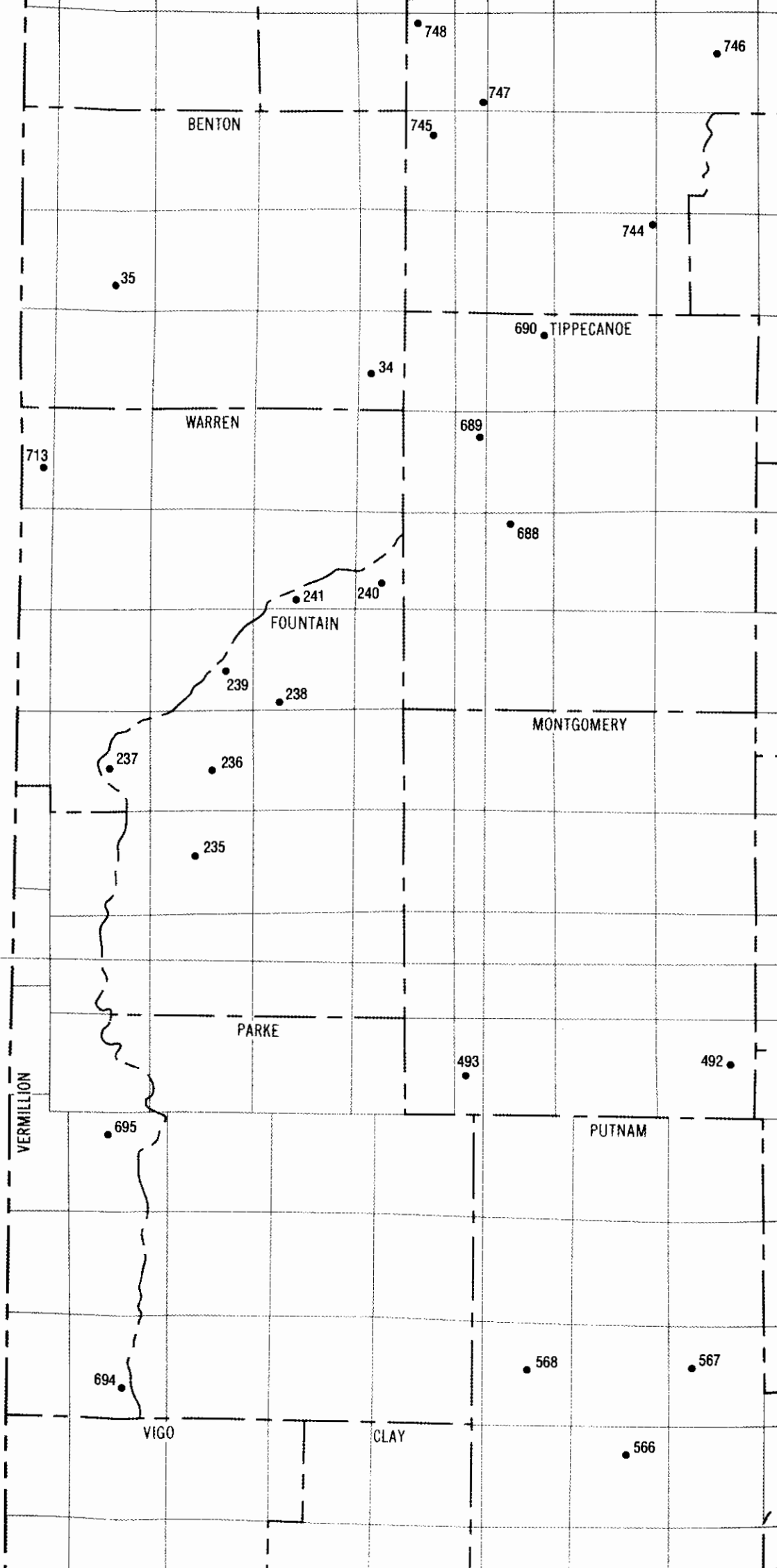

40°

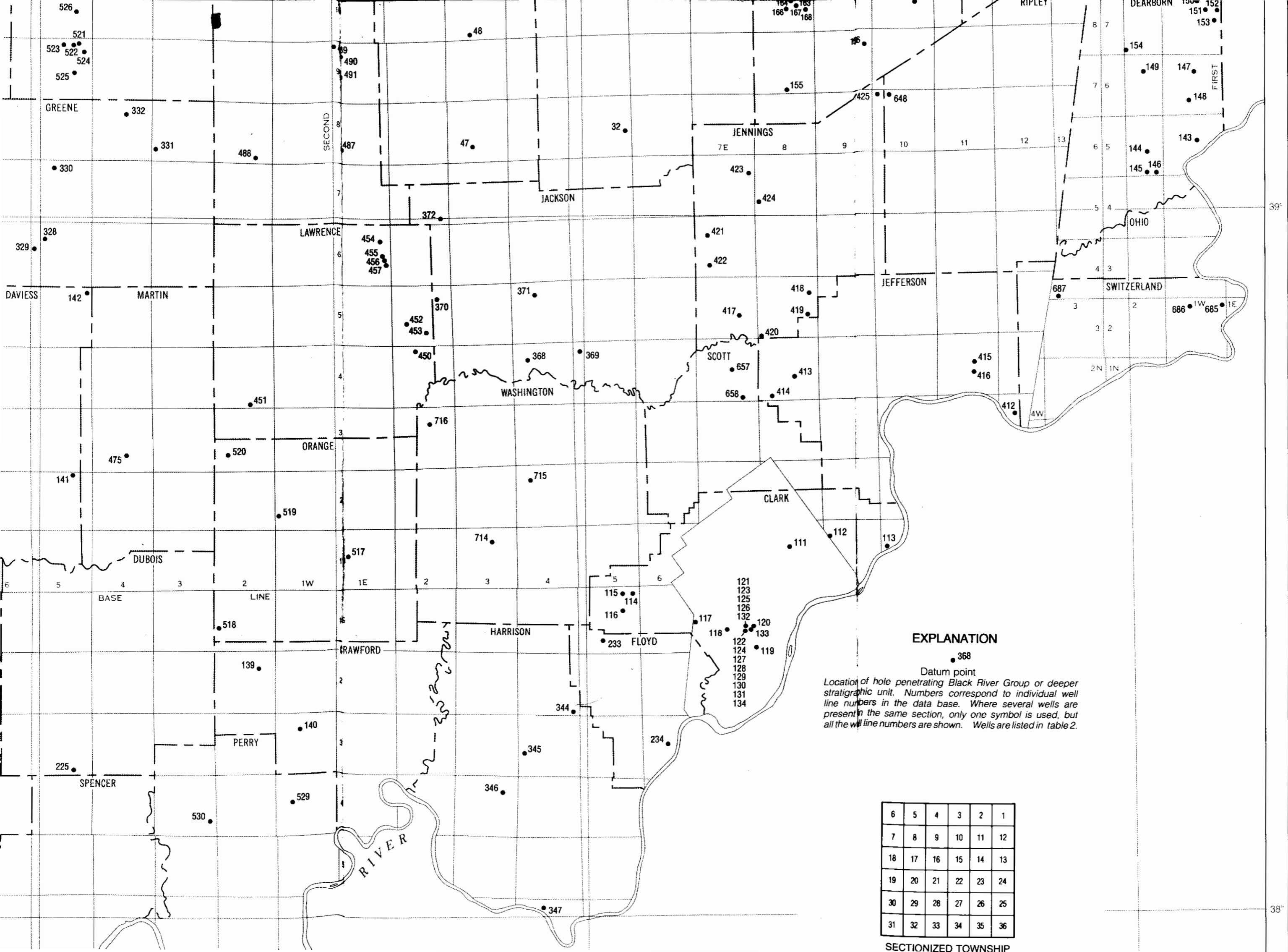

EXPLANATION

• 368
 Datum point
 Location of hole penetrating Black River Group or deeper stratigraphic unit. Numbers correspond to individual well line numbers in the data base. Where several wells are present in the same section, only one symbol is used, but all the well line numbers are shown. Wells are listed in table 2.

6	5	4	3	2	1
7	8	9	10	11	12
18	17	16	15	14	13
19	20	21	22	23	24
30	29	28	27	26	25
31	32	33	34	35	36

SECTIONIZED TOWNSHIP

39°

38°

39°

38°

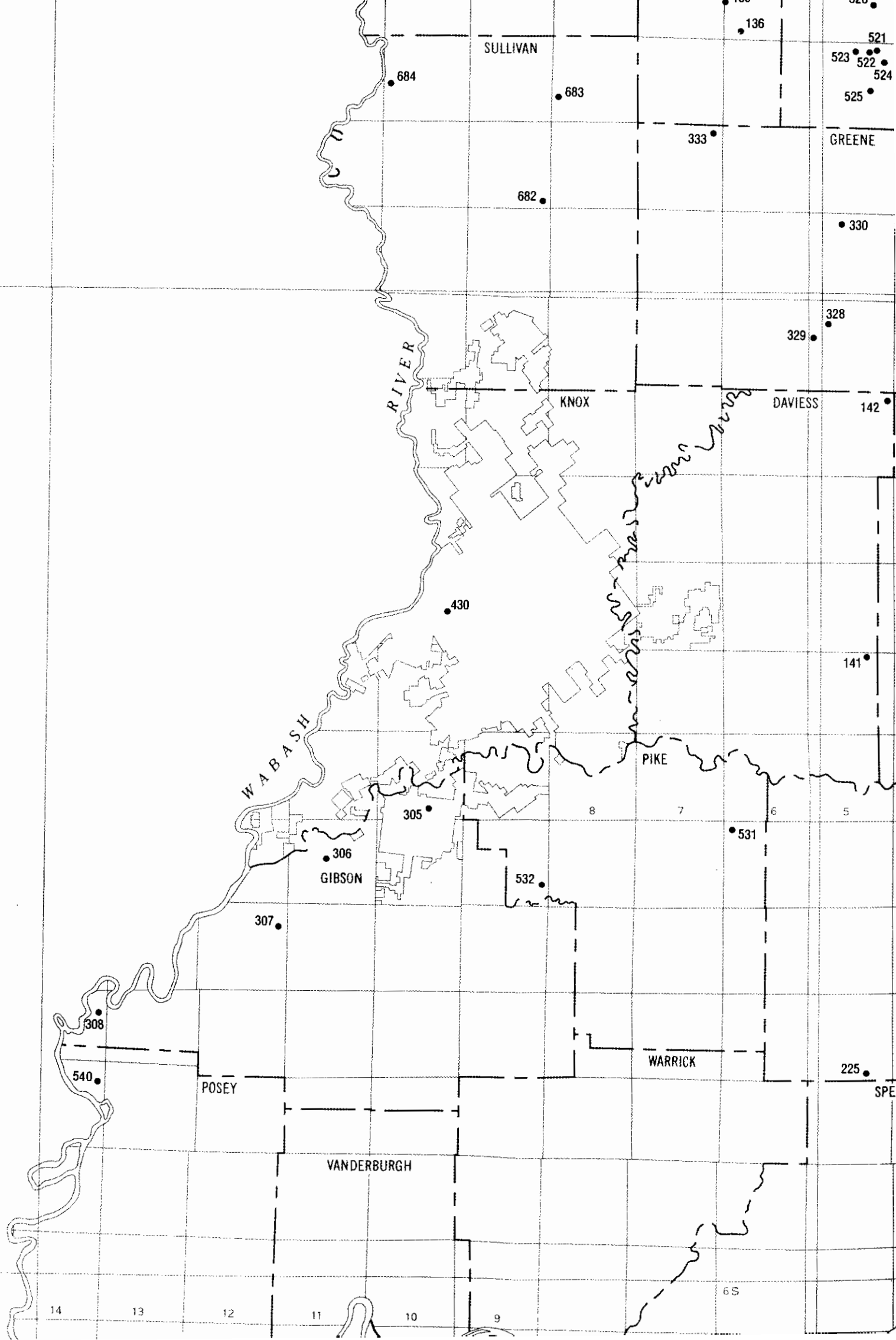

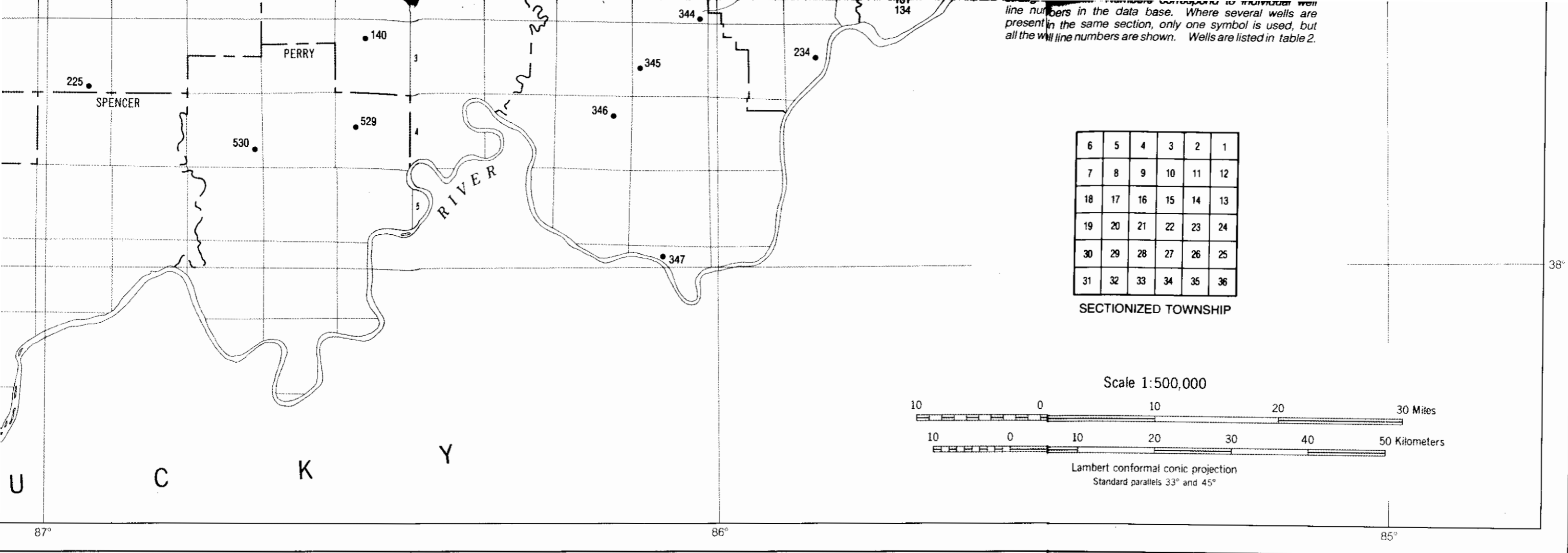

INDIANA SHOWING LOCATIONS OF WELLS IN DEEP-WELL DATA BASE

Compiled by B. D. Keith and J. T. Cazeo,
October 31, 1983

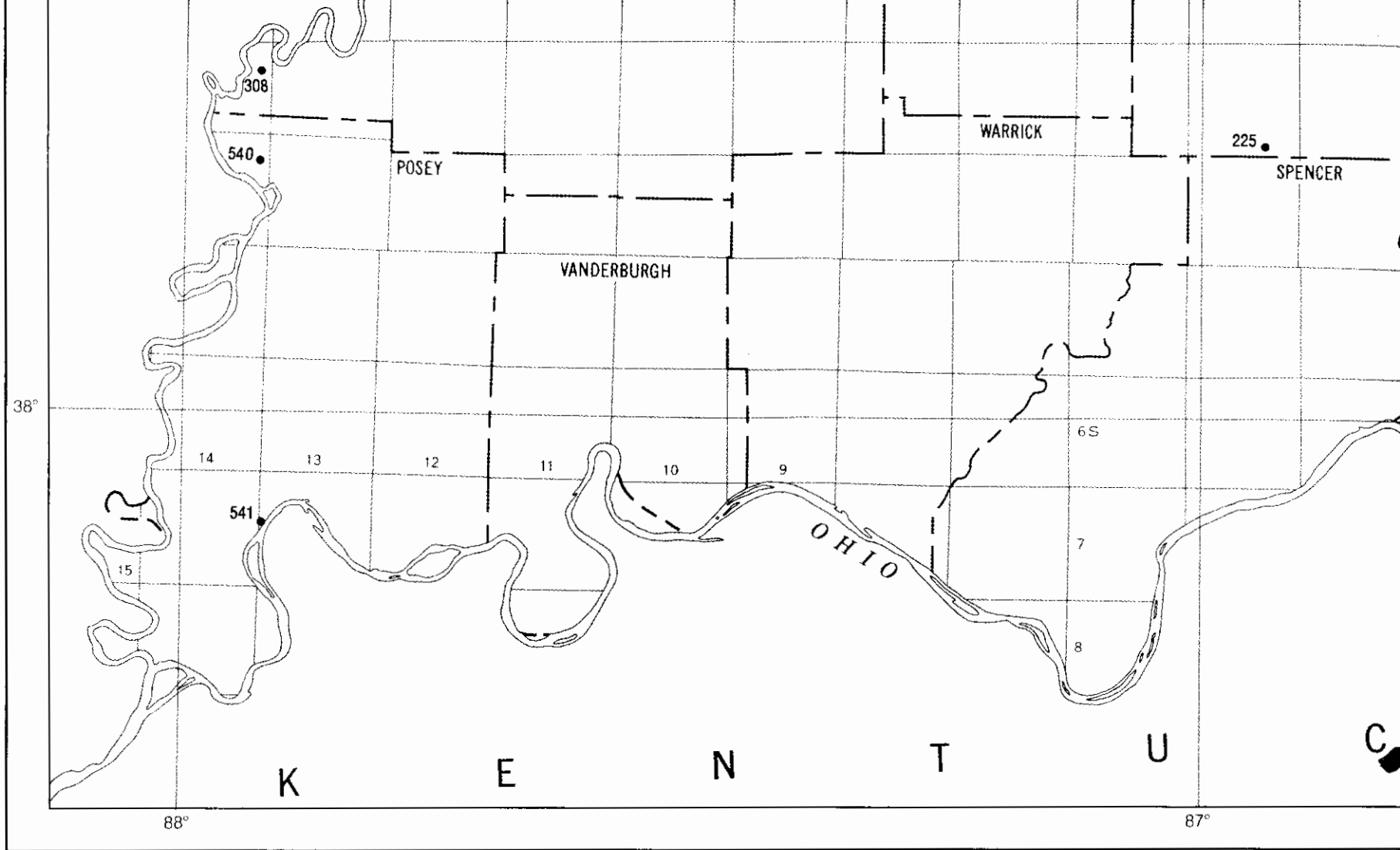

Base modified from U.S. Geological Survey
Base Map of Indiana; 1950.

MAP OF INDIANA SHOW