

1988

UA1B3/6 1988 Meeting Minutes & Reports

WKU Parking & Traffic Committee

Follow this and additional works at: https://digitalcommons.wku.edu/dlsc_ua_records

 Part of the [Higher Education Administration Commons](#), [Social History Commons](#), [Sociology Commons](#), [Urban, Community and Regional Planning Commons](#), and the [Urban Studies and Planning Commons](#)

Recommended Citation

WKU Parking & Traffic Committee, "UA1B3/6 1988 Meeting Minutes & Reports" (1988). *WKU Archives Records*. Paper 5787. https://digitalcommons.wku.edu/dlsc_ua_records/5787

This Article is brought to you for free and open access by TopSCHOLAR®. It has been accepted for inclusion in WKU Archives Records by an authorized administrator of TopSCHOLAR®. For more information, please contact topscholar@wku.edu.



WESTERN KENTUCKY UNIVERSITY

BOWLING GREEN, KENTUCKY 42101

Office of Physical Plant
and Facilities Management

MEMO TO: President Kern Alexander

FROM: *Kemble F. Johnson*
Mr. Kemble F. Johnson, Administrator
Physical Plant and Facilities Management

DATE: July 07, 1988

SUBJECT: Traffic and Parking Committee Recommendations

At a special meeting on April 27, 1988, the Traffic and Parking Committee made several recommendations, some of which have already been passed on to you. (see attached)

The additional recommendations which are attached required drawings for clarification. The areas involve both additional parking and safety. They are as follows:

1. Science and Technology Hall Lot

The suggested change is for safety purposes. The first drawing shows the lot as it exists today; the second shows the modifications as proposed.

The existing lot is accessed by way of a narrow drive at the end of Science and Technology Hall. The drive is used for two-way traffic although it is only one lane wide. It also serves as a walkway which is heavily used by faculty, staff and students during class changes.

The entrance to the drive is frequently blocked by traffic on 15th Street or by vehicles leaving the lot. This causes a back up of traffic on 15th Street and on out into State Street in both directions. Fortunately, there has been only one serious accident at this location but the potential exists for injury to pedestrians as well as damage to vehicles.

To alleviate this situation, the Committee recommends that a connector drive be built to connect the parking lot behind Diddle Hall and the Science and Technology Lot, making a one-way entrance to Science and Technology and a one-way exit from the lot to 15th Street. This would cut the vehicular traffic in half on the narrow drive and eliminate the back up of traffic on 15th Street and State Streets.

The cost estimate for the connector drive is \$2,967.00.

2. Snell Hall Lot

The suggested change is for additional parking. The first drawing shows the drive as it exists today; the second shows the modifications as proposed.

As you know, the Ogden campus is one of the most critical areas for parking on campus. Some relief in this area is desperately needed.

The existing lot has 41 parking spaces. At the north end of the lot there are three (3) trees: one (1) walnut and two (2) elms, all volunteer. We receive numerous complaints yearly about walnuts falling on cars and causing dents. The two (2) elms will eventually die of Dutch Elm Disease. We have been losing several elms each year to the disease. If we remove the three (3) trees and re-plant three (3) more desirable species, we would expand the lot by 25-35 spaces as shown on the second drawing. The lot will be squared up and will look better at a cost of less than \$200 per space.

The estimated cost of the additional spaces in the Snell Hall Lot is \$4,730.00.

3. Academic Complex Entrance Drive

The suggested change is for safety purposes. The first drawing shows the drive as it exists today; the second drawing shows the modifications as proposed.

This entrance drive is the site of numerous accidents involving vehicle damage and one involving serious bodily injury. The drive is now single lane, although two vehicles can "squeeze" past each other. When a vehicle is waiting to exit the drive and go out onto Normal Drive, vehicles wanting to enter cannot because the exiting vehicle has the space blocked.

The Committee suggests that the nine (9) parallel spaces be eliminated making the drive a two-way drive and add nine (9) angled spaces on the right side of the drive as you enter. These are shown on the second drawing.

This change would cost an estimated \$2,180.00.

VIRGINIA GARRETT AVENUE

NORMAL

EAST HALL



Parcel 32 spaces \$10,000
 Parcel 22-23 \$1,500



WESTERN KENTUCKY UNIVERSITY
 BOWLING GREEN, KENTUCKY
WKU PROPERTIES
 ON NORMAL DRIVE

DATE: 2-19-05
 BY: [Signature]
 FOR: [Signature]

4. College of Education Lot

The suggested change is for additional parking. The first drawing shows the lot as it exists today; the second drawing shows the modifications as proposed.

This is another area where there is a serious shortage of parking. The existing lot has 103 spaces, the proposed expanded lot would create 44 more spaces.

At the east end of the lot there are two (2) sugar maples which were transplanted by Western Kentucky University when the building was built. To expand this lot as proposed, these two (2) trees would be removed. Replacement of these trees with either additional trees and/or shrubbery is suggested.

The change would cost an estimated \$6,000.00.

5. State Street near the Planetarium

One additional problem for which there is no drawing is the parking of public school buses on State Street near the Planetarium.

Busses frequently park along the curb from Ogden Drive on over the hill toward 14th Street, which is a no parking zone. This causes two lanes of north bound traffic on State Street to be merged into one lane, with resulting back up of traffic. Also, the loss of vision by pedestrians crossing the street is another safety consideration. Students frequently step out from between the busses into moving traffic.

Since no specific solution was evident at the time of our meeting, the Committee authorized Mr. Paul Bunch, Director of Public Safety; Mr. Claude Threlkeld, Superintendent of Landscaping; Dr. Carroll Wells, Math Department and a member of the Traffic and Parking Committee; and others from the Ogden College, to get together and work out alternate parking arrangements or spaces for these buses.

The above recommendations are passed on to you for your consideration. Any of us would be happy to meet or provide additional information as you may direct.

- NOTES:
- ① Two way traffic in one lane drive which also serves as walkway for pedestrians. HAZARDOUS
 - ② Area of congestion; traffic backups out into 15th st. and State street. HAZARDOUS

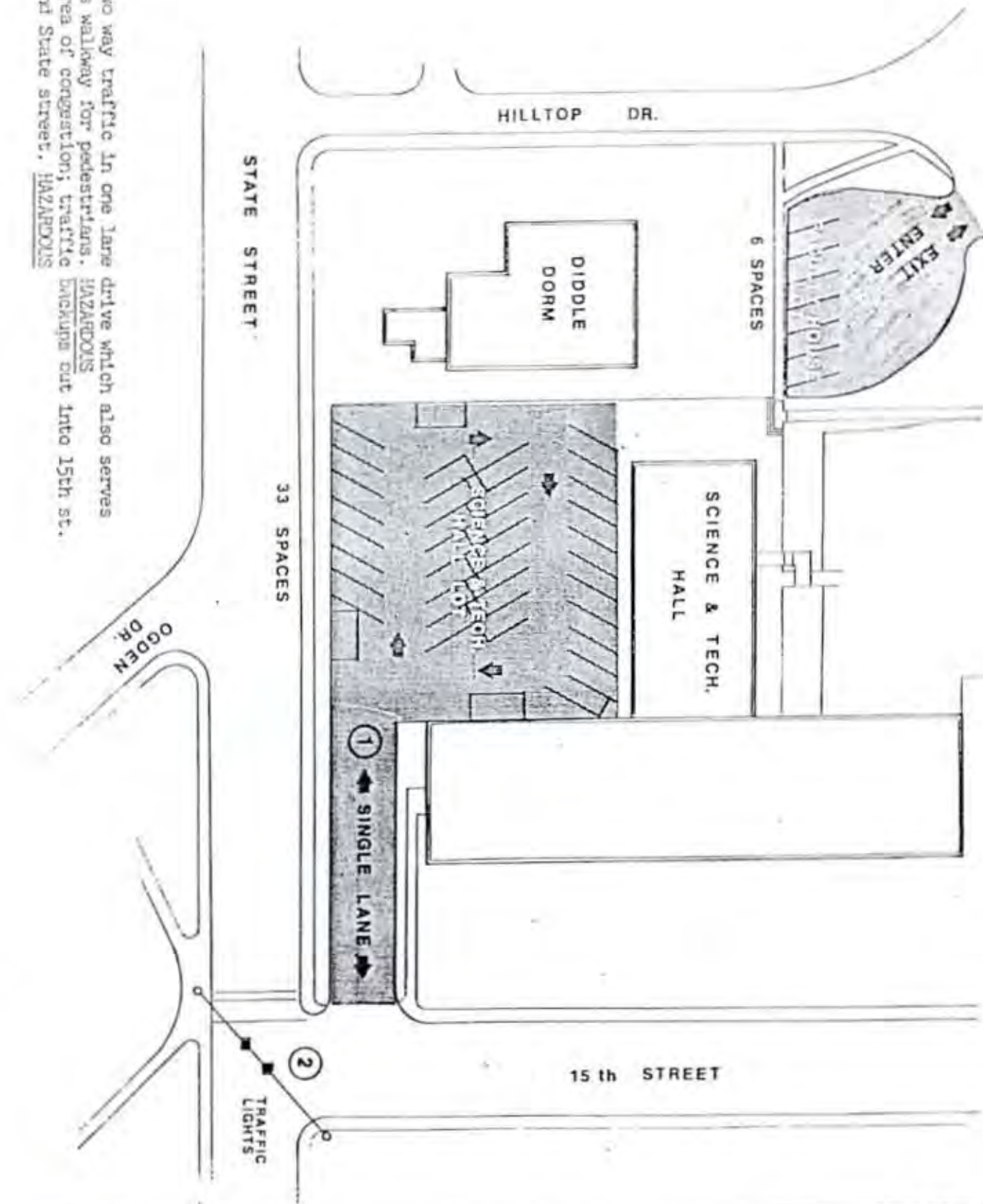

WESTERN KENTUCKY UNIVERSITY

**EXISTING ACCESS & PARKING LAYOUT AT
FACULTY HOUSE & SCIENCE & TECH. HALL**

DATE
JUNE '88
DRAWN BY
S. NEWTON
SHEET
1 OF 2

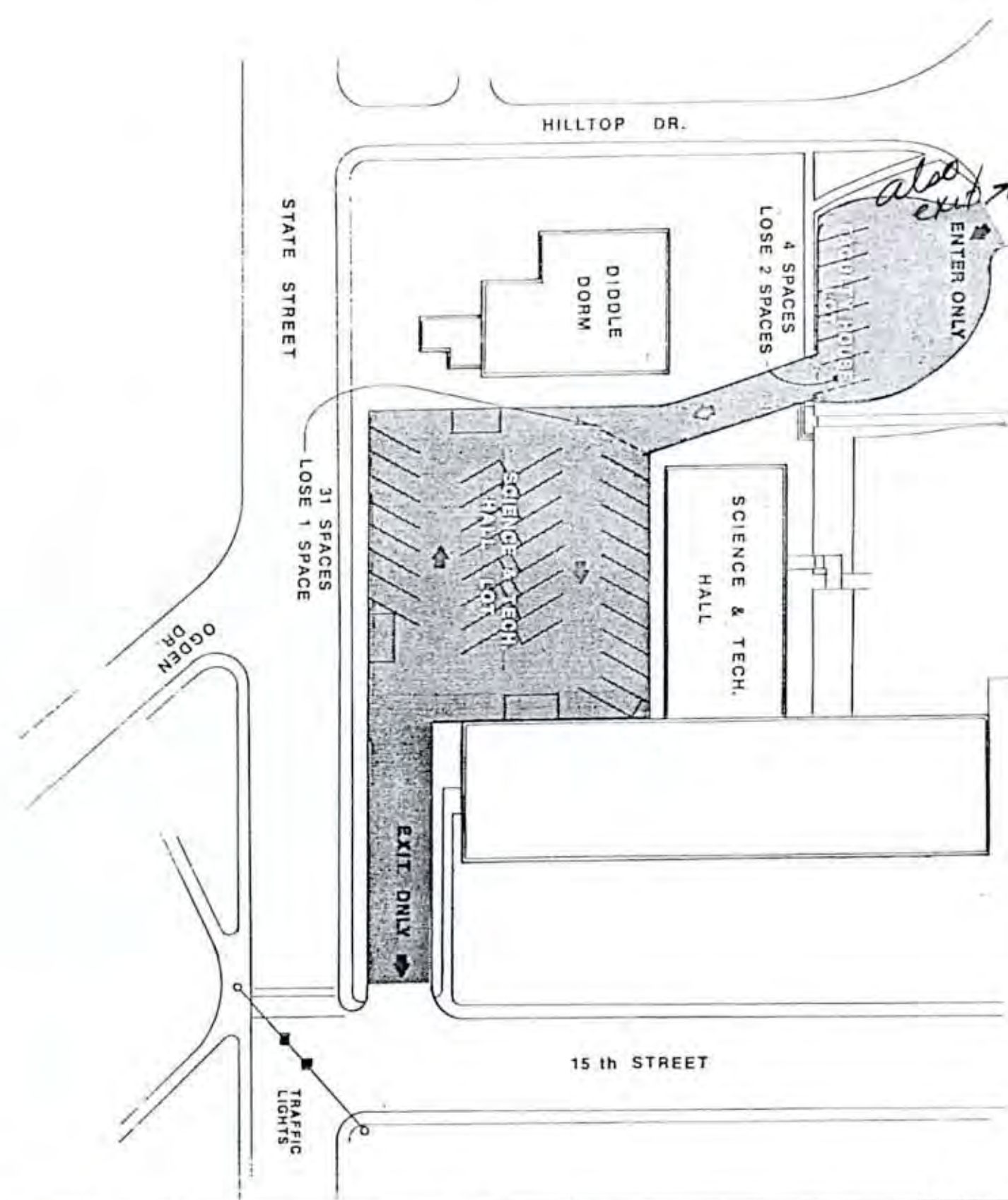

Office of Physical Plant
and Facilities Management

WESTERN KENTUCKY UNIVERSITY

**PROPOSED PARKING & ACCESS CHANGES AT
FACULTY HOUSE & SCIENCE & TECH. HALL**

DATE
JUNE '88
DRAWN BY
S. NEWTON
SHEET

2 OF 2

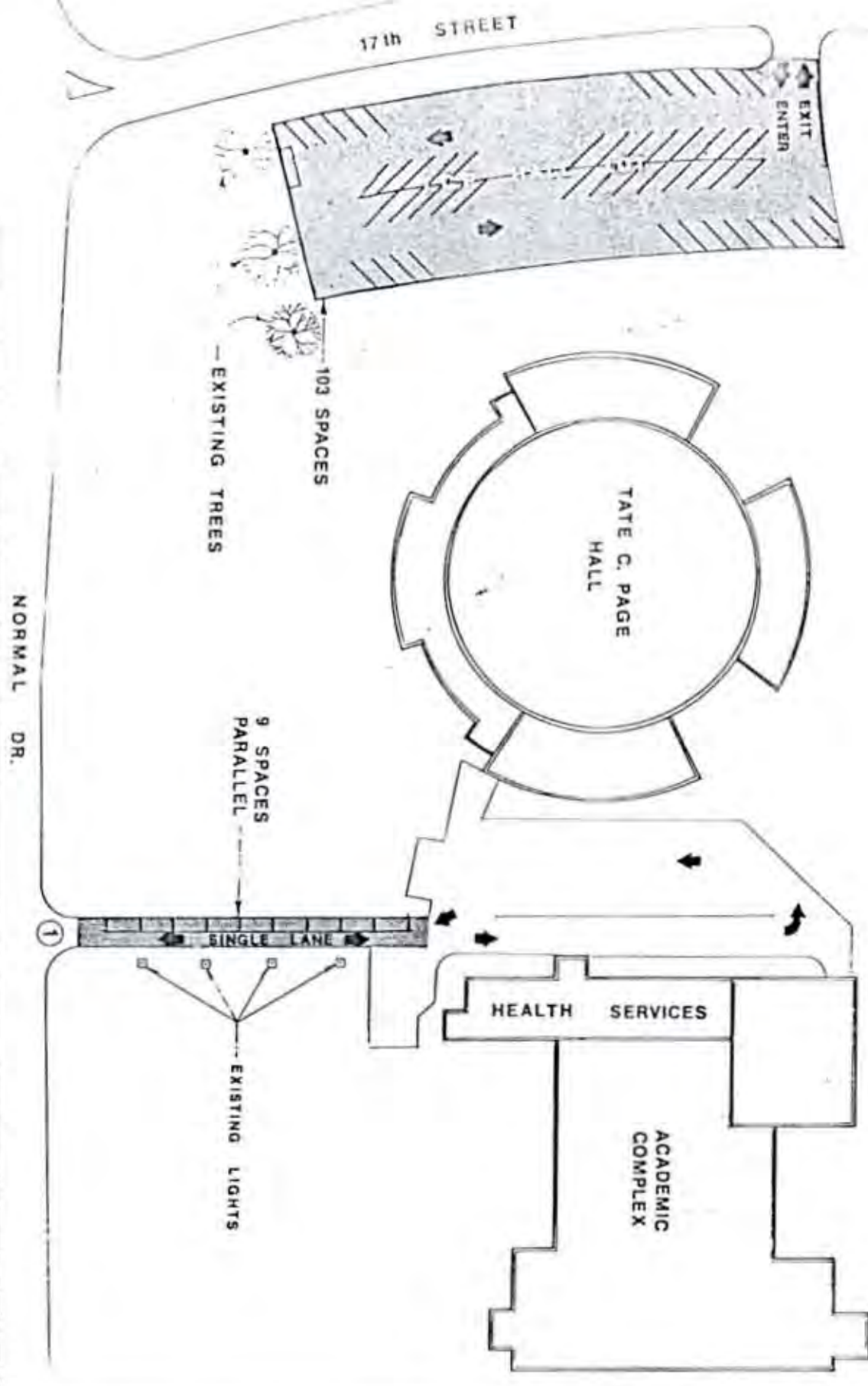

NOTE:

- ① Site of numerous traffic accidents involving property damage and one serious personal injury accident. Lane is too narrow for entering vehicles when another vehicle is waiting to exit.



Office of Physical Plant and Facilities Management

WESTERN KENTUCKY UNIVERSITY

EXISTING ACCESS & PARKING LAYOUT AT HEALTH SERVICES & T.C.P. HALL LOTS

DATE	JUNE '88
DRAWN BY	S. NEWTON
SHEET	1 OF 2

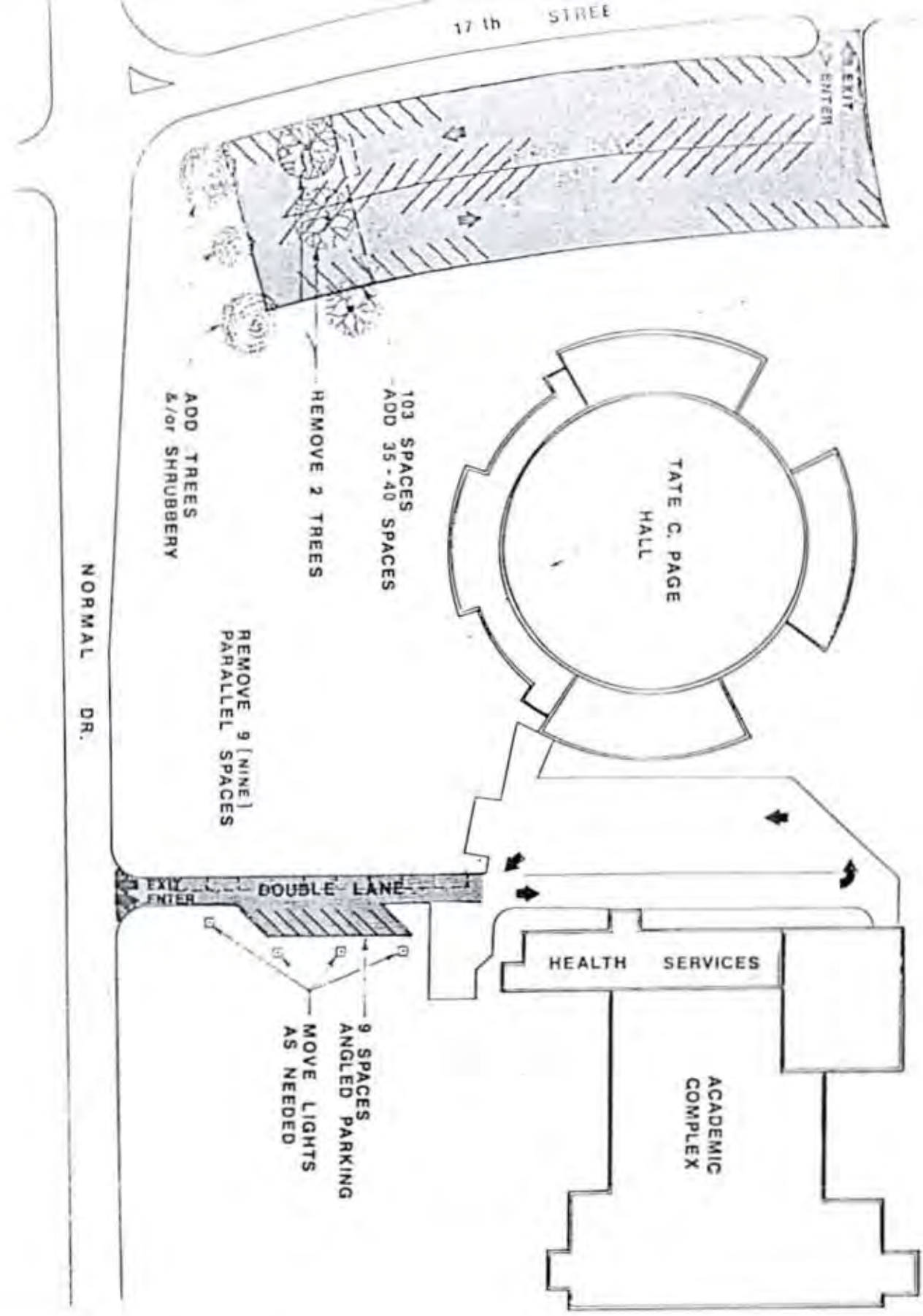

Office of Physical Plant and Facilities Management

WESTERN KENTUCKY UNIVERSITY

PROPOSED PARKING CHANGES AT HEALTH SERVICES & T.C.P. HALL LOTS

DATE
JUNE '88
DRAWN BY
S NEWTON
SHEET
2 OF 2

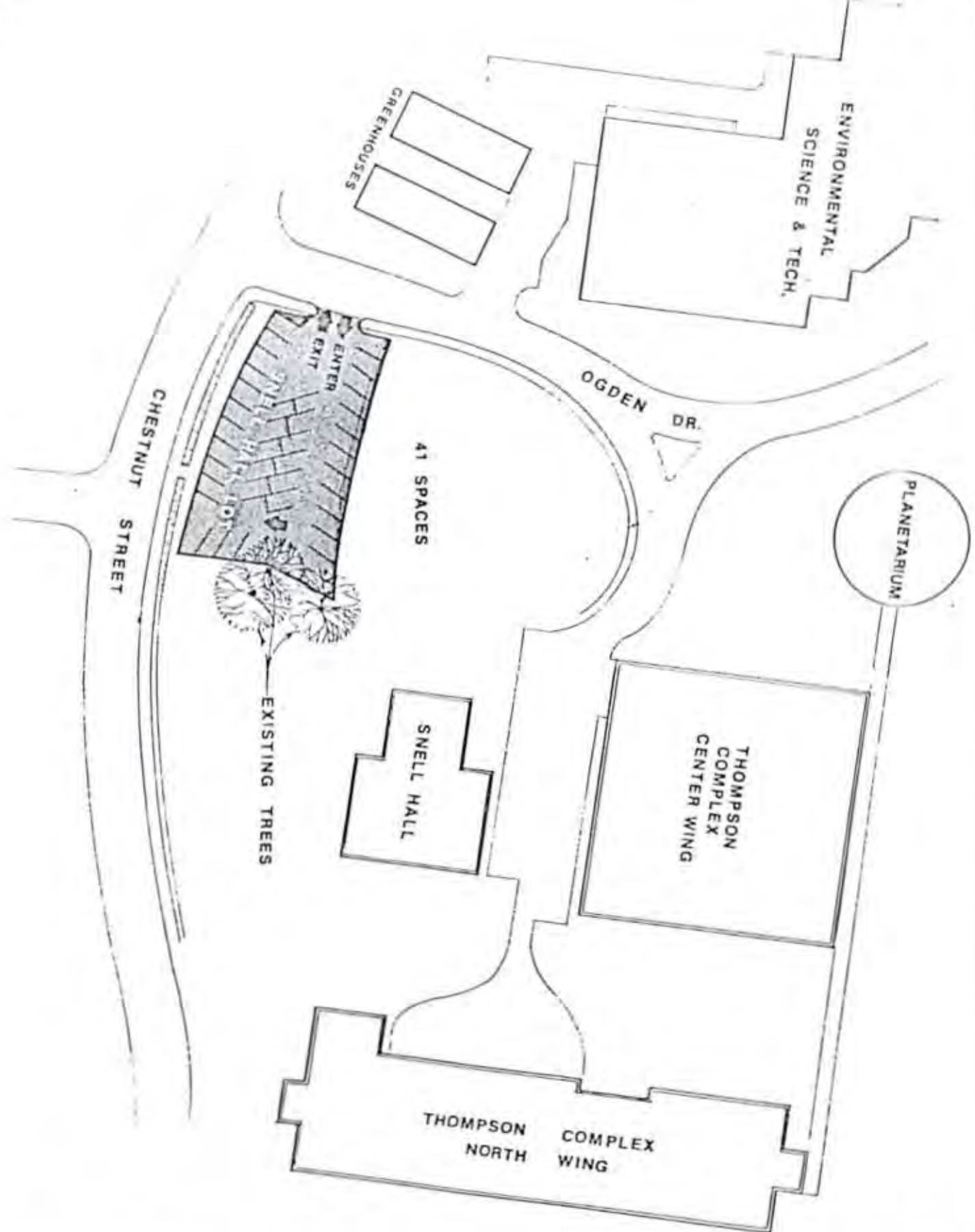

Office of Physical Plant
and Facilities Management

WESTERN KENTUCKY UNIVERSITY

**EXISTING ACCESS & PARKING LAYOUT AT
SNELL HALL LOT**

DATE
JUNE '88
DRAWN BY
S. NEWTON
SHEET

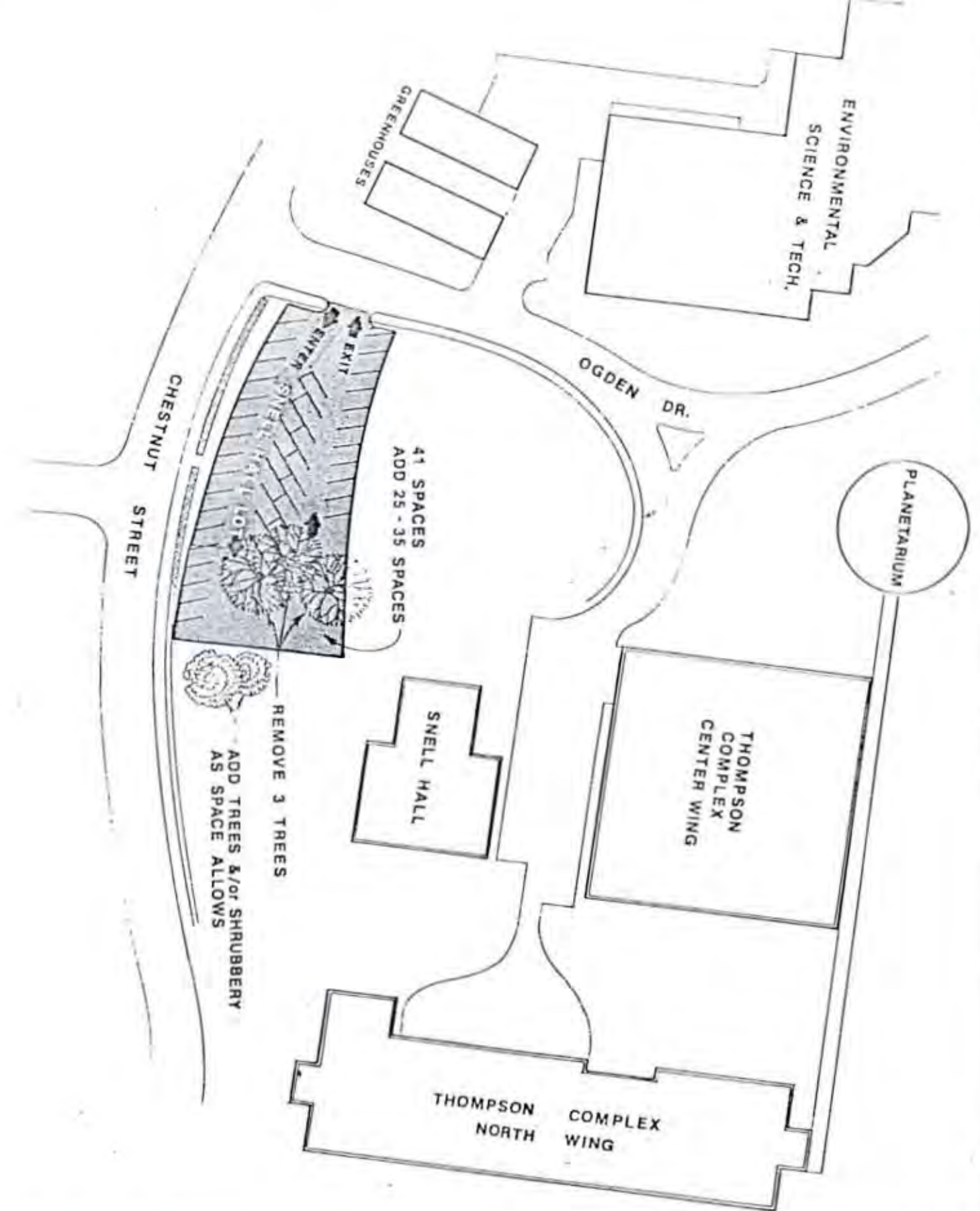

Office of Physical Plant
and Facilities Management

WESTERN KENTUCKY UNIVERSITY

PROPOSED PARKING CHANGES AT
SNELL HALL LOT

DATE
JUNE '88
DRAWN BY
S. NEWTON
SHEET

2 OF 2

Aug 16 11 35 AM '88
August 16, 1988

PT Comm folder

MEMORANDUM TO: Dr. Kern Alexander
President

FROM: Mr. Howard E. Bailey *HB*
Dean of Student Life

SUBJECT: Additional Parking Spaces

Western Kentucky University, over the past four or five years, has made several positive gestures to strengthen our relationship with the local and regional community. In addition to our increasing enrollment, we are continually developing additional programs to better serve the community which brings more non-university citizens onto the campus.

While there are many positive attributes to a favorable relationship with the surrounding areas, our present parking situation is beginning to cause people to avoid participating in campus programs. Naturally, the problem is also becoming more critical for our students, faculty, and staff. I assure you that all of us treasure our beautiful campus and look upon it as a major asset, yet we realize that additional parking is very much in need.

It is our opinion that under the close supervision of the Parking and Traffic Committee and the Physical Plant additional parking could be created in a manner that would detract little, if any, from the natural beauty of Western's campus.

Your serious consideration in this matter would be deeply appreciated.

HEB:clm