

Townshend Hall

Herrick Archives Number 087

A. IDENTIFICATION & LOCATION

1. Name

1.1 Officially named "Townshend Hall" by Board of Trustees on May 19, 1896 in honor of Dr. Norton S. Townshend.

1.2 Alternate names noted:

Prior to official naming, the building was referred to as the "Agricultural Building."
The original drawings, which were prepared after the official naming, carry the name "Townshend Memorial Hall. "

See Addenda Nos. 3, 6, 9, 11

2. Location

2.1 Located at 1885 Neil Avenue. See map below.

2.2 For greater detail, see Sheet 96 in the book of campus maps in the University Archives.

See Addendum No. 2

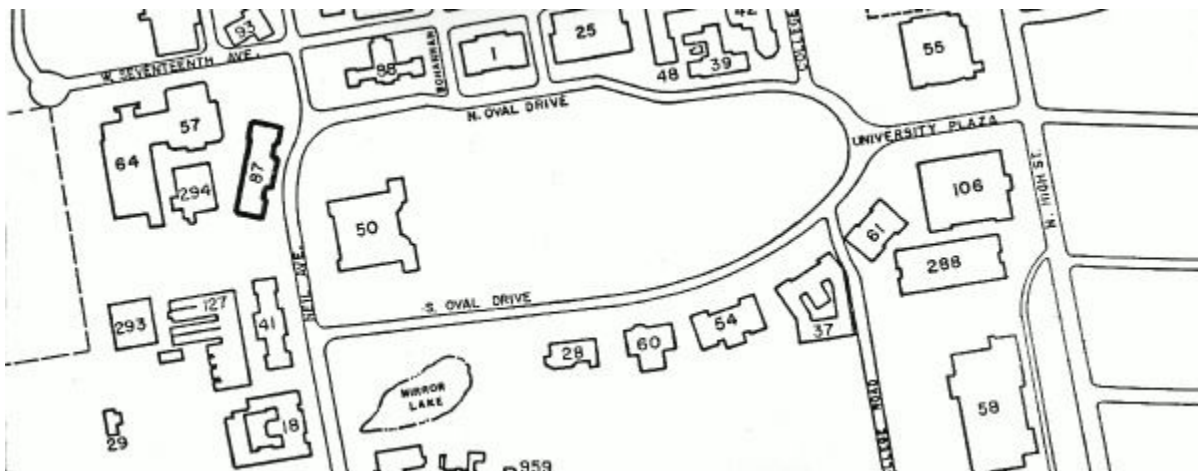

For identification of other buildings shown, see Appendix A.

3. General Description

3.1 Type of construction:

Wood frame with gray brick exterior.

3.2 No. of stories:

Basement and two stories.

3.3 Increments of construction:

None; building has never been enlarged. Two auxiliary buildings included in the original construction have since been demolished. See sketch.

See Addendum No. 12

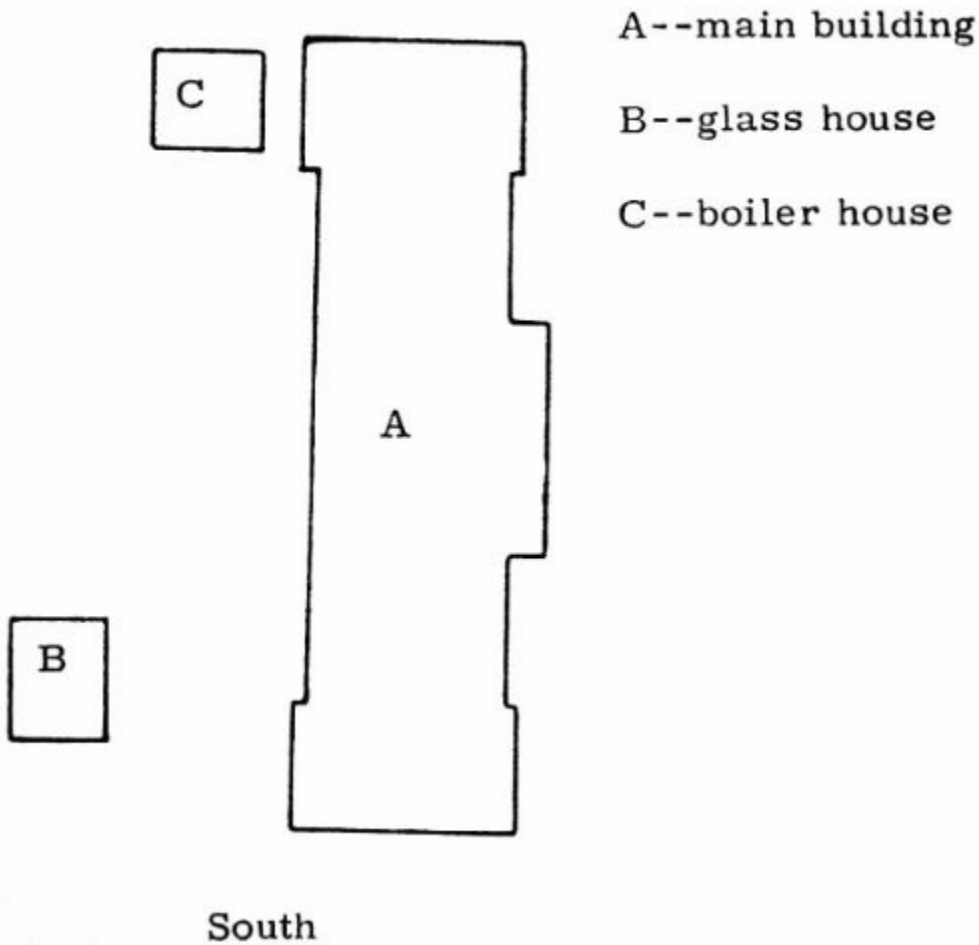

3.4 Present area of building as shown in inventory records of Division of Campus Planning:

55,029 sq. ft. gross; 34,302 sq. ft. net assignable

See Addenda Nos. 10, 12

3.5 McCracken originally reported the cubage of the building to be 970,885 cubic feet (McC 1:8A) but later changed this to 1,016,000 cubic feet (McC 4:4A). The later figure is currently used (PP).

B. PLANNING & CONSTRUCTION

1. On July 7, 1896 the Board of Trustees approved the plans and related documents prepared by Peters, Burns, & Pretzinger and authorized the solicitation of bids by contractors.
2. Bids were received on September 1, 1896 (T).
3. On September 2, 1896 the Board of Trustees awarded the contract for construction of the building to the Columbus Construction Co.
4. The contract was signed on or about September 8, 1896 (McCracken 1:143).

5. Work on the building began about the middle of September 1896 (Cope:532); work proceeded so slowly that by December the contractors were 35 days behind in their work (loc. cit.).
6. On May 5, 1897 the Board of Trustees decided to take over the work from the contractor and complete the building.
7. The building was ready for service on January 1, 1898 (McCracken 1: 144) and the architect reported the final accounts on March 3, 1898 (Cope:534).
8. The building was formally dedicated January 12, 1898 (Pollard:151).

C. GLASS HOUSE

1. The "glass house" or greenhouse was located in the orchard 60 feet west of the south end of the main building. See sketch map above. It was 40' 0-1/2" long and 30' 1" wide (A).
2. Date of demolition of this glass house has not been established. The building appears on a January 1910 map prepared by the Olmsted Bros. and on a 1911 map (Photoarchives No. X 13311). It is missing on a campus map revised in August 1913 (McCracken 2:292).

See Addendum No. 8

No photograph of the glass house has been located.

D. BOILER HOUSE

1. The boiler house was located 12 feet west of the north end of the main building. See sketch map above. It was 22' 2" wide and 30' 9" long (A).

See Addendum No. 4

2. An 1898 University Bulletin (Series 3, No. 10) indicated that this boiler house furnished steam and power for the Dairy Department and also contained refrigeration equipment.
3. According to Professor W. James Harper (Dairy Technology) this structure was in use until the Department of Dairy Technology moved to Vivian Hall (002) in late 1951 and early 1952, and was torn down shortly thereafter.
4. An Air Force aerial photograph taken October 22, 1952 does not show this building. (Photoarchives files. Photo No. 122, 801RTS, M95D, 91 SRW).
5. No photograph of the boiler house has been noted.

See Addenda Nos. 1, 3, 4

E. COST

1. The cost of the original structure was \$110,000 (McC 1:8A).
2. Except for a \$350 addition in 1921-22, there was no further capital expenditure until the building was remodeled in the late 1950's. Between July 1, 1957 and June 30, 1960 added costs of \$247,178.51 were incurred, bringing the cumulative total to \$357,528.51.

F. MISCELLANEOUS

1. Townshend Hall served as headquarters for the College of Agriculture until the new Agricultural

Administration Building (003) was completed. Townshend Hall was then extensively remodeled under contracts awarded by the Board of Trustees on January 10, 1958 (T) and completed in 1959 (A).

G. PHOTOGRAPHS

1. In Photoarchives:

X 2334--from northeast

X 2333--from east

See Addenda Nos. 1, 2, 3, 4, 12

2. Other:

Hooper: 32

McCracken 1: 143

John H. Herrick
April 19, 1972

ADDENDUM NO. 1

The boiler house appears in the top center of photograph X 2728 in Photoarchives.

John H. Herrick
September 13, 1973

ADDENDUM NO. 2

Photograph X 13929 in Photoarchives shows the boiler house levelled to the ground. The order for this photograph was dated September 11, 1952, which establishes the date of demolition.

John H. Herrick
December 17, 1973

ADDENDUM NO. 3

Alternate Names for Boiler House Department

Ice House, Dairy

Ice Machine Building

Generator House

Little Deshler (students lived on 2nd floor and called their quarters this name after the Deshler Hotel downtown)

Change of Address

Changed in June, 1975 to 1885 Neil Avenue Mall.

Photographs

The boiler house is shown in photographs X7623 in Photoarchives.

John H. Herrick
December 3, 1975

ADDENDUM NO. 4

Part D of this report indicates that the boiler house was 22'2" x 30'9". This was a two story structure.

Later photographs (e.g., x2948) show a one story addition along the full length of the west side. A 1910 small scale drawing shows that this addition was about 12 feet wide.

No record of the construction of this addition has been found. It does, however, appear on a June, 1899 as the second insert after page 154 in McCracken's first volume.

Since the original building was not completed until January, 1898, the boiler house was enlarged shortly thereafter. Or, it is possible that the size was increased on the construction drawings for the original building, and I have not been able to locate the revised drawing showing the expanded building.

See Addendum No. 5

John H. Herrick
December 20, 1977

ADDENDUM NO. 5

The Building Committee of the Board of Trustees on October 6, 1904 awarded to M.P. Street the contract for the addition to the Boiler House (William O. Thompson papers, University Archives).

This suggests that the map used by McCracken (1:154) was not correct as of June 30, 1899.

See Addendum No. 7

John H. Herrick
February 28, 1979

ADDENDUM NO. 6

Inspection of old campus maps reveals the following additional name for this building:

Engine House, Townshend Hall

John H. Herrick
November 13, 1979

ADDENDUM NO. 7

The error in McCracken's 1899 map is due to the fact that he based it on a 1906 map. See report on Map 189-09 in Herrick, [OSU Historical Maps](#).

John H. Herrick
July 31, 1980

ADDENDUM NO. 8

Revise Item C 2 relative to demolition of the Glass House to read as follows:

"Date of demolition of this glass house has not been established. The building appears on Map 191-01 issued by Olmsted Brothers in January 1910 and on Map 191-07 prepared late in 1910 (October or later). It does not appear on Map 191-09 prepared in 1912, probably in August."

Thus, it would appear that the glass house was demolished between October 1910 and August 1912.

John H. Herrick
February 18, 1981

ADDENDUM NO. 9

The following additional name for this building has been found on old campus maps:

Townshend Bldg

John H. Herrick
September 21, 1981

ADDENDUM NO. 10

This building has been extensively remodeled for use by Psychology. The Lantern reported on November 16, 1984 that the department plans to move into the remodeled space the weekend of November 17, 1984.

Revised areas will be shown in Campus Planning records as follows:

55,029 sq. ft. gross
35,800 sq. ft. net assignable

John H. Herrick
February 7, 1985

ADDENDUM NO. 11

This building is now carried in Campus Planning records as Norton Strange Townshend Hall. The official name remains "Townshend Hall."

John H. Herrick
August 26, 1986

ADDENDUM NO. 12

In connection with the renovation of this building for Psychology, two rooms were added to the west side of the building for air conditioning equipment. See sketch below.

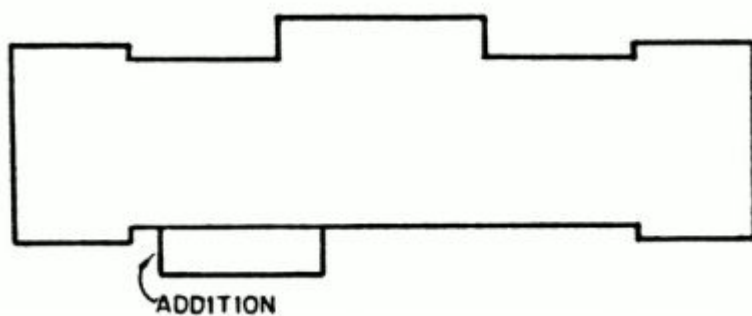

The addition is 15'2" wide by 58'8" long, and is one story in height.

Construction of the entire remodeling project began on October 3, 1983, (A) and the remodeled space was occupied during the week of November 17, 1984.

The addition is shown in Photograph X30250 in Photo Archives.

John H. Herrick
November 12, 1987