

**A Chronological and Analytical Account of Achamore Gardens, Gigha, Inner Hebrides**

**Candidate 1545817**

**Submitted in part fulfilment of the MA Garden and Landscape History**

**Institute of Historical Research**

**August 2017**

## **Acknowledgement**

I would like to thank the Isle of Gigha Trust for kind permission to use the garden archive and the many residents who patiently and kindly supported the research. I also thank Dr Barbara Simms for her steadfast guidance throughout the preparation of the dissertation.

## Contents

		<b>Pages</b>
<b>Chapter 1</b>	<b>Introduction</b>	<b>4 - 10</b>
<b>Chapter 2</b>	<b>Historiography</b>	<b>11 - 22</b>
<b>Chapter 3</b>	<b>Achamore Gardens (Pre 1944)</b>	<b>23 - 37</b>
<b>Chapter 4</b>	<b>Achamore Gardens (1944 - 1972)</b>	<b>38 - 69</b>
<b>Chapter 5</b>	<b>Achamore Community Gardens</b>	<b>70 - 79</b>
<b>Chapter 6</b>	<b>Conclusion</b>	<b>80 - 82</b>
	<b>Sources and Bibliography</b>	<b>83 - 91</b>
	<b>Appendices</b>	<b>92 - 105</b>

## Chapter 1 Introduction

### Introduction

The dissertation presents a chronological and analytical account of the creation, conservation and use of Achamore Gardens, Gigha. The island of Gigha lies 6.5 km off the west coast of the Mull of Kintyre and is 9.5 km long and 2.5 km at widest.<sup>1</sup> (Figure 1) Achamore Gardens (the Gardens) are approximately 50 acres and divided into more than 50 named gardens, e.g., the Walled, Pond, Theatre, Hospital, Elegant, Triangle, George Taylor and Malcolm Allan gardens.<sup>2</sup> The Gardens are renowned for the extensive collection of rhododendrons amassed by Colonel James Horlick (the Colonel) between 1944 and 1972. (Figure 2)

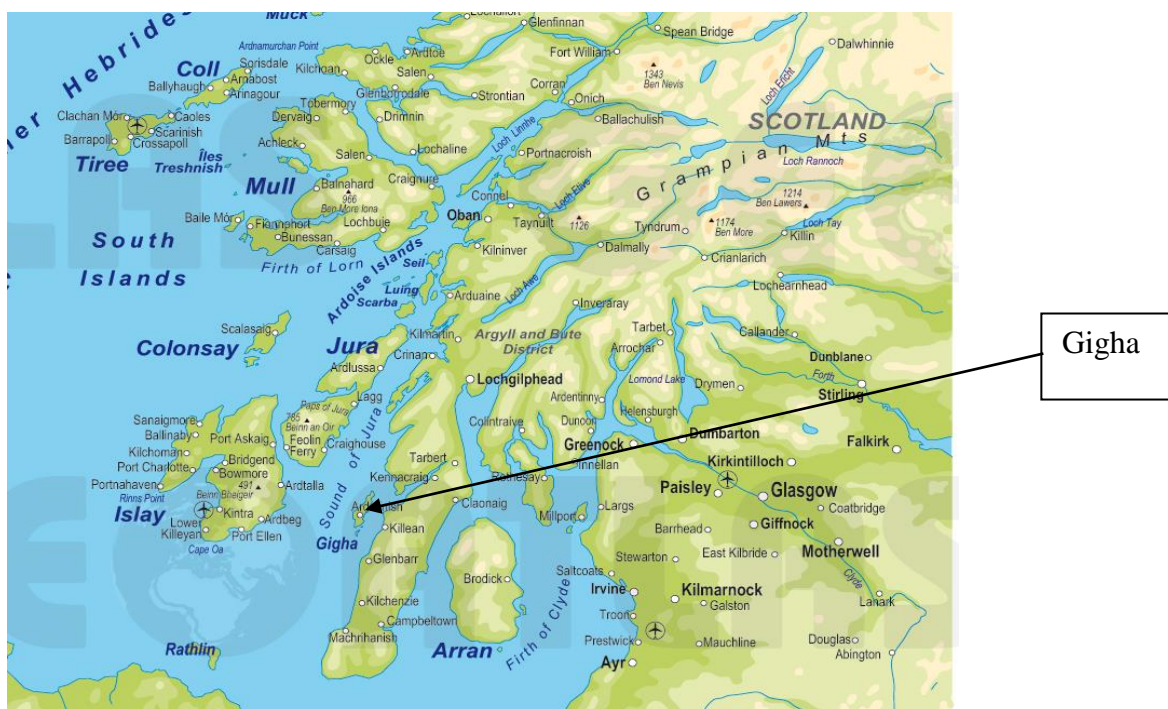

Figure 1. West of Scotland ([www.geotlas.com](http://www.geotlas.com) Accessed 26 August 2017)

<sup>1</sup> Ordnance Survey. Kintyre North. OS Explorer Map 357. Grid reference NR 643478, 55.6663, -5.7494.

<sup>2</sup>The full list of garden names in Appendix 1.



Figure 2. Achamore House and Gardens (2015) ([www.savills.co.uk](http://www.savills.co.uk). Accessed 1 August 2017)

High winds and salt spray characterise the growing conditions on Gigha. Average rainfall 114 cm per annum, mean temperature is 56 F (summer), 10 F (winter), and frosts and snow are rare. The high latitude of Gigha creates problems for plants that need high light intensities in autumn and winter. Plants that favour shade and semi-shade grow more successfully in the full sun on Gigha.<sup>3</sup> The soil conditions vary from light free draining sandy loam on the central hill, to heavier woodland soil where clay lays over rock and is frequently water-logged in winter. The soil in the Gardens is highly acid, below 4.5 pH and therefore suitable for rhododendrons, azaleas and camellias. The exceptions are the Walled Garden where many years of cultivation and liming have created neutral and fertile soil conditions.

### **Research Motivation**

The motivation of the dissertation is the analysis of the influence of land ownership on garden creation, conservation and use. In common with large tracts of land in Scotland,

---

<sup>3</sup>P. Clough, *Isle of Gigha. Achamore Garden* (National Trust for Scotland, 1970), p. 8. Peter Clough was head gardener at the Gardens between 1970 and 1974.

Gigha has historically been privately owned.<sup>4</sup> Records note that Gigha was acquired by the Scarlett family in the 19<sup>th</sup> century and used as a hunting estate until sold again into private ownership in 1917.<sup>5</sup> In 1944 Gigha was purchased by the Colonel and remained in his possession until his death in 1972. Then followed a series of transfers of private ownership until 2002 when the establishment of the Scottish Parliament (1999) heralded the introduction of legislation to enable communities to exercise a right to buy land privately owned land on which they were situated.<sup>6</sup>

In 2002 the resident community on Gigha established the Isle of Gigha Heritage Trust (IGHT) to buy the island for £4 million. Included in the purchase of Gigha was Achamore House and Gardens. Soon after purchasing Gigha, IGHT created separate legal titles for Achamore House and the Gardens. Achamore House was sold to a private buyer in order to raise capital to repay part of the debt incurred to buy the island and the Gardens were retained in community ownership. Since 2002 the Gardens have been managed by IGHT and volunteers.<sup>7</sup> In 2016 a separate organization, the Achamore Gardens Trust (AGT), was created to conserve and develop the Gardens.

---

<sup>4</sup> A. Wightman, *Who Owns Scotland* (Canongate, 1997).

<sup>5</sup> Clough, *Isle of Gigha*.

<sup>6</sup> Land Reform (Scotland) Act. 2003. Established the Community Right to Buy which enables communities throughout Scotland to register an interest in land and the opportunity to buy that land when it comes up for sale. <http://www.gov.scot/Topics/farmingrural/Rural/rural-land/right-to-buy/Community> Accessed 1 August 2017.

<sup>7</sup> *Historic Environment Scotland Gardens and Designed Landscape Inventory* (1989). AGT.

## **Research Aims**

The aims of the dissertation are to:

1. Establish the chronological development of Achamore Gardens
2. Explain the influences of Kitty Lloyd-Jones and James Russell on the designed landscape of Achamore Gardens
3. Critically evaluate the interplay between land ownership and garden creation, conservation and use

## **Analytical Framing of the Research**

Three principal analytical themes frame the research:

**Chronology of Achamore Gardens** The Garden archive contains private correspondence, seed orders and invoices, formal plans and plant lists from approximately 1900. The primary data in the garden archive and material from other sources was analysed to compile a chronology of the creation of the Gardens.

**Twentieth century garden design** Information about the Gardens attributes the design to Kitty Lloyd-Jones<sup>8</sup> Yet there is no formal connection between her and the designed landscape of the Gardens. The analysis of primary data presented in this dissertation provides robust evidence to attribute the designed landscape of the Gardens to James Russell.

**Land ownership and garden creation, conservation and use** Originally in private ownership the Gardens were used to accommodate the interests of the owners in hunting (the Scarlett family) and developing an island garden (the Colonel). The bequest of the plant collection to the National Trust for Scotland (NTS) (1962) was instrumental in conserving the

---

<sup>8</sup> C. Czerkawksa, *The Way it Was. The History of Gigha* (Birlinn, 2016).

plant collection and community ownership of Gigha (2002) is linked to conserving and developing other uses for the Gardens. The primary data was analysed to critically evaluate the impact of land ownership on garden creation, conservation and use.

## **Research Methods**

In 2008 IGHT acquired from David Wagg, the Colonel's grandson, a large quantity of letters, papers, diaries, photographs and slides relating to the Gardens. This collection comprises the Gardens archive and, although it has been catalogued by IGHT, not yet been analysed.

## **Site visits**

First site visit June 2016.

- a. Accessed the Gardens archive held by AGT – essentially 8 boxes of documents, slides and several photograph albums. The primary data was analysed to compile a chronology of the development and design of the Gardens
- b. Make copies of documents and photographs relating to the Gardens
- c. Interviewed residents and recorded their memories of the Gardens

Second site visit June 2017.

- a. Further investigation of the Gardens archive
- b. As part of the Island Tales series, the author delivered a presentation to the residents of Gigha about the history of the Gardens<sup>9</sup>
- c. Interviewed more residents and recorded their memories of the Gardens

---

<sup>9</sup> H. Haugh, *Colonel Sir James Horlick: One Man and his Gardens*. Presentation to AGT. June 2017.



## **Oral history interviews**

Oral history interviews are a potentially rich source of data in garden history. Since many residents of Gigha have lived on the island for most of their lives, they had memories of the Colonel, and attending events, e.g., the school annual sports day, and playing in the Gardens. Two informants had also worked in the Gardens. Their memories of the Gardens were recorded and analysed for insights into the history of the Gardens.

## **Contributions**

The research makes three contributions to garden history:

1. The dissertation presents the first chronological account of the development of the Gardens. Secondary and primary data was analysed to construct a timeline of the Gardens. Commencing with the purchase of the Gigha by the Scarlett family in the 19<sup>th</sup> century and concluding with the establishment of AGT (2016), the influence of different land ownership regimes on the Gardens are explained.
2. Examination of the influences of Kitty Lloyd-Jones and James Russell on the designed landscape of the Gardens. Prior to the analysis presented in this dissertation the design of the Gardens had been attributed to Lloyd-Jones.<sup>10</sup> From my analysis of documents in the archive I present evidence that the designed landscape is attributable to Russell.
3. Consideration of the implications of private and community land ownership on garden creation, conservation and use.

---

<sup>10</sup> See for example <http://www.parksandgardens.org/places-and-people/site/31/history>

## **Conclusion**

This chapter has introduced the context, aims, research methods and contributions of the dissertation. The remainder of the dissertation is presented in five chapters. Chapter 2 presents the historiography of the research context. Chapters 3, 4 and 5 analyse primary data to document the creation, conservation and use of the Gardens during three distinct time periods. The conclusion to the dissertation, Chapter 6, discusses the contributions of the research to garden and landscape history and suggestions for future research.

## Chapter 2 Historiography

### Introduction

The designed landscape of the Gardens is described as a 50 acre, mid to late 20<sup>th</sup> century woodland garden with a renowned collection of *Rhododendron*, *Azalea*, *Pieris*, *Enkianthus*, *Magnolia* and subtropical trees and shrubs.<sup>11</sup> The historiography situates the history of the Gardens in the politically and socially contested context of land ownership in Scotland, as well as explicating the influence of two 20<sup>th</sup> century garden and landscape designers on the designed landscape of the Gardens.

### The Inner Hebrides

The group of the islands known as the Inner and Outer Hebrides lie to the west of Scotland and are accessible either by boat or air. The island of Gigha is classified as one of the small islands in the Inner Hebrides. The small islands are thinly populated and the generally poor soils and frequent storms limit the range of trees, shrubs and plants that thrive. For some people the idea of owning an island as an attractive proposition and for approximately two centuries Scotland's islands and estates have been bought and sold by, often, absentee landlords.<sup>12</sup> The prosperity of an island community depended on the wealth, whims and wishes of the owner(s) and many suffered from underinvestment and harsh management by the local agent (the Factor). These influences all feature in the history of the Gardens.

### Victorian and Edwardian Shooting Estates in Scotland

---

<sup>11</sup>Clough, *Isle of Gigha*, p. 8.

<sup>12</sup>J. Hunter, *From the Low Tide of the Sea to the Highest Mountain Tops. Community Ownership of Land in the Highlands and Islands of Scotland* (Islands Book Trust, 2012).

Field sports, such as deer shooting, game stalking and salmon fishing have been popular pastimes in England, Scotland and Ireland for hundreds of years. The 18<sup>th</sup> century Game Laws imposed a property ownership qualification on field sports participation and thus, effectively denied all but country gentlemen the right to shoot game, and even to own a gun.<sup>13</sup> Highland estates in Scotland were let, sold and managed specifically for field sports.<sup>14</sup> The natural and physical properties of the land in this way became cultural landscapes in that land use was organized, planted and farmed in order to better suit the demands of field sports.

The popularity of field sports with the English in Scotland was boosted in 1852 when Queen Victoria purchased the Balmoral estate in the Highlands. To emulate the Royal family, many industrialists and businessmen, especially from southern England, used their wealth to acquire the status symbol of Scottish country house estate.<sup>15</sup> The field sports were refined in the 19<sup>th</sup> century in terms of etiquette and to reassure privilege and patronage. From the mid-1800 onwards weekend shooting parties became a very fashionable leisure pursuit. Pheasant and wild game hunting were known as the ‘sport of kings’ because of their popularity with royalty and the aristocracy.<sup>16</sup> These field sports were socially and culturally exclusive because of the necessity to be either a landowner, or an associate of a landowner, to participate in them. (Figure 3)

---

<sup>13</sup> See for example: The Black Act. 1723. The Night Poaching Act. 1828. The Game Act. 1831. Also, M. Hoffman, ‘Why community ownership? Understanding land reform in Scotland’, *Land Use Policy*, 31 (2013), pp. 289-297.

<sup>14</sup> G. Jarvie and L. Jackson, ‘Deer forests, sporting estates and the aristocracy’, *The Sports Historian*, 18 (1998), pp. 24-54.

<sup>15</sup> P. Higgins, L. Jackson and G. Jarvie, *Deer Forests, Sporting Estates and the Aristocracy. Some Preliminary Observations*. Scottish Centre Research papers in Sport, Leisure and Society (1997).

<sup>16</sup> Sport of kings also includes falconry and (more recently) horseracing. *Oxford Dictionary of Phrase and Fable* (Oxford University Press, 2006)



Figure 3. Deer Stalking in Scotland. Getting Ready by Arthur Fitzwilliam Tate. 1851.  
<http://www.tate.org.uk/art/artworks/bateman-highland-scene-t03210> Accessed 1 August 2017)

### **The New Aristocrats**

The history of the English aristocracy lies in the close protection of entry into land owning by either inheritance and/or marriage. Although in the Victorian and Edwardian period wealth could be accumulated through commerce and trade, this was insufficient to gain social acceptance by the aristocracy. However, owning and managing a country estate is expensive and by the turn of the 20<sup>th</sup> century many of the established aristocratic landowners were beginning to find it hard to fund the increasing expenditure needed to maintain their estates.<sup>17</sup> The profligate spending of some family members, high cost of maintaining country houses and estates, and successive increase in land taxes prompted impoverished aristocratic families to rethink how to best manage their property portfolios.

One strategy to secure funding to support the country estate was to turn to the new wealthy for marriage partners. A second strategy was to sell land and estates that could no longer be maintained. At the same time, the newly wealthy who had benefited from investments in

---

<sup>17</sup> J. Uglow, *A Little History of British Gardening* (Chatto and Windus, 2004), p. 191.

commerce and industry sought to acquire status and prestige by adopting the educational, career and social customs of the aristocracy.<sup>18</sup> For example, estates in Sussex were sold to city men, e.g., Nymans was sold to the banker Ludwig Messel in 1890.<sup>19</sup> In Scotland, Gigha was put on the market by the owners, the Scarlett family, in 1911 for the first time in one hundred years. The designed landscape of the Gardens up to the early 20<sup>th</sup> century is considered in chapter 3.

### **Gardens and Gardeners in the early Twentieth Century**

Between the 1920s and 1930s many large houses and estates were bought and sold as the impact of World War I, the death of male heirs on the front line, and economic turbulence meant that the fortunes of many aristocratic families were further depleted.<sup>20</sup> The new land and estate owners needed advice on how to manage their estates and create what would be considered a garden of fashionable good taste. The new profession of garden designer thus came into being in the early 20<sup>th</sup> century.

### **Kitty Lloyd-Jones (1898-1978)**

At the beginning of the 20<sup>th</sup> century employment prospects for women were limited and gardening, horticulture, nursing and teaching were about the only female careers deemed to be socially acceptable. Kitty Lloyd-Jones had obtained a first class in practical gardening at the Royal Botanic Society (Regents Park) and studied horticulture at the University of

---

<sup>18</sup> The customs of the aristocracy were typically public schooling, e.g., Eton or Harrow; a degree from either Oxford or Cambridge University; and then a career in the army and politics.

<sup>19</sup> Uglow, *A Little History*.

<sup>20</sup> R. Berger, 'Kitty Lloyd-Jones. Lady gardener and nursery woman', *Garden History*, 25 (1997), pp. 107-116.

Reading where she was awarded the 1924 college prize.<sup>21</sup> She studied for a further year at the University of Reading and obtained a National Diploma of Horticulture in 1925. Despite her qualifications, Lloyd-Jones's first employment was a holiday job to teach gardening to the daughter of the Lord and Lady Balfour. This led to her meeting Lady Gladstone (Lady Balfour's sister), and being given accommodation in a cottage on the Gladstone estate and running a nursery at Little Munden.<sup>22</sup> Between 1925 and 1930 Lloyd-Jones was active in the Royal Horticultural Society (RHS) and Chelsea Flower Show and contributed a chapter to a new book on Modern Garden Craft.<sup>23</sup>

Lloyd-Jones's first gardening commission was to design a large curved border for Lady Gladstone at Dane End House (Hertfordshire). From this many other commissions followed from Lady Gladstone's friends and she was able to establish a business providing garden advice to owners of large houses and gardens.<sup>24</sup> Her modus operandi was to establish a base at the home of her client, where she would be treated as a house guest, and spend a few days producing a design and plan for the client's garden. This would be followed by explaining the design and plan to the gardeners and then returning every few weeks to oversee and manage progress. During residence with a client she would use the client's house writing paper to correspond with friends and other clients.<sup>25</sup>

---

<sup>21</sup> Ibid.

<sup>22</sup> Ibid.

<sup>23</sup> K. Lloyd-Jones, Reprint. *The Modern Flower Garden. 2. The Herbaceous Border – with Chapters on Planning and Arrangement* (Read Books Ltd, 2013).

<sup>24</sup> Berger, 'Kitty Lloyd-Jones'.

<sup>25</sup> Ibid.

The style of Lloyd-Jones's designed gardens can be interpreted from the book chapter and the few plans and documents that exist.<sup>26</sup> The key features of her garden designs appear to be: natural planting; deep borders, grass pathways and a tall backdrop; bulbs and annuals for colour; discrete garden rooms; and distinct colour combinations to promote effects, e.g., blue, white, pink and grey for peace. In addition to her garden advisory service Lloyd-Jones also was committed to improving plant varieties specifically herbaceous plants such as delphiniums, hellebores, irises and old roses. She also became an expert on rhododendrons, shrubs and roses.<sup>27</sup> Lloyd-Jones's knowledge of rhododendrons would later be useful in her work with the Colonel.

### **James Philip Cuming Russell (1920-1996)**

James Russell was a 20<sup>th</sup> century horticulturalist and, in common with Lloyd-Jones, designed gardens for an elite circle of private, high profile clients. Although he had not been professionally trained in horticulture he designed gardens for more than 50 years and created more than 200 gardens.<sup>28</sup>

Russell was educated at Eton College and in 1935 won the Harmsworth Memorial Prize for botanical drawing. At the outbreak of World War II he forfeited his place to read botany at Cambridge University and joined the Hertfordshire Yeomanry. Invalided out in 1942 he worked for the family firm, Sunningdale Nurseries (SN), Berkshire, which his father and cousin had bought in 1939 from Sir Hubert Longman. SN was famous for its large collection

---

<sup>26</sup> Letters, garden plans and planting lists survive from Lloyd-Jones to Lady Bearsted, Upton House, Warwickshire. National Trust.

<sup>27</sup> Berger, 'Kitty Lloyd-Jones'.

<sup>28</sup> K. Legg, *James Russell. The Archive of James Russell, Garden Designer, Deposited at the Borthwick Institute, University of York* (University of York, 2003).



of rhododendrons but was by 1939 deemed to be derelict. Russell worked closely with the nursery and business manager, Graham Stuart Thomas, and SN prospered. His plant favourites were large shrubs, especially rhododendrons, and woodland plants and trees.<sup>29</sup>

Alongside his work at SN, Russell undertook design and consultancy work for private and corporate clients in the United Kingdom (UK) and around the world. His first commission was for Lord Hastings in 1950 (Seaton Delaval Hall, Northumberland) and this was followed by many notable clients, e.g., Baron Howard of Henderskelfe (Castle Howard, Yorkshire), Lord (Gavin) Astor of Hever (Edenbridge, Kent), the Earl of Carnarvon, the Duchess of Westminster (Eaton Hall, Cheshire), Sir Nicholas Nuttall (Nassau) and Lady Wimbourne (Normandy). His corporate clients included Arup Associates (Basingstoke), Wiggins Teape, Trebor (Colchester) and Seiyo Corporation (Japan) as well as Horlicks.<sup>30</sup>

Essentially a private man, most of his clients were either friends from Eton or members of a small and elite social circle. After selling SN in 1968 to Waterers, Russell retired to the Castle Howard estate and, taking most of the remaining SN stock, created a series of ornamental gardens. He travelled extensively to collect plants and visit clients; published two books (*Old Garden Roses*<sup>31</sup> and *Rhododendrons at Sunningdale*<sup>32</sup>), was awarded the RHS

---

<sup>29</sup>A. Hellyer, 'Great British garden makers: James Russell 1920-1996', *Country Life*, March 20 (2010) [www.countrylife.co.uk](http://www.countrylife.co.uk)

<sup>30</sup> Letter from Russell to the Colonel (6 February 1957). "I have also been over to the factory at Slough, as you very kindly recommended us to plant roses there. The soil looks excellent, and it should be quite an easy task to carry out. As far as access to the beds is concerned, I suggested instead of grass paths, an 18" paved path, as I think it would be so much easier to keep, and also, if a lot of people from the factory are walking and smelling the roses, there would be very little grass left in a very short time". Further letters from Russell to the Colonel 20 June and 13 August 1957 refer to Russell visiting the factory to check on the roses. AGT.

<sup>31</sup> J.P.C. Russell and S. Sitwell, *Old Garden Roses. Part 1* (1955); J.P.C Russell and W. Blunt, *Old Garden Roses. Part 2* (1955).

Gold Veitch Medal (1981) and the RHS Victoria Medal of Honour (1988). He retired to Fife in 1992.<sup>33</sup> The influence of Lloyd-Jones and Russell on the designed landscape of the Gardens is examined in Chapter 4.

### **The Changing Landscape of Land Ownership in Scotland**

The careers of garden designers, such as Lloyd-Jones and Russell described above, progressed hand in hand with the private ownership of grand houses and country estates, typically but not exclusively, in the UK. More critically, land ownership in Scotland (predominantly by the English) is associated with a long history of dispossession, enclosure and privatization of rights to land associated with both the Highland Clearances of the 18<sup>th</sup> and 19<sup>th</sup> centuries.<sup>34</sup> The process of dispossession is built on the private property regime which institutionalizes exclusive, absolute and alienable private property rights.<sup>35</sup> Grounded in the historic social and cultural power differences between the English and the indigenous Scots, land that had been traditionally collectively owned by the indigenous population, was taken into private ownership by the aristocracy and wealthy.<sup>36</sup>

Community-centred land reform has been a long running theme in debates concerning the skewed ownership of land in Scotland in which<sup>37</sup> most privately owned land is held by a

---

<sup>32</sup> J.P.C. Russell, *Rhododendrons at Sunningdale* (1960).

<sup>33</sup> Legg, *James Russell*.

<sup>34</sup> F. Mackenzie, *Places of Possibility. Property, Nature and Community Land Ownership* (Wiley Blackwell, 2014).

<sup>35</sup> E. Ostrom, *Governing the Commons* (Cambridge University Press, 1990).

<sup>36</sup> Mackenzie, *Places of Possibility*, p. 20.

<sup>37</sup> Hoffman, 'Why community ownership?' Mackenzie, *Places of Possibility*.

small percentage of landlords<sup>38</sup> – a legacy of the longevity of feudal tenure.<sup>39</sup> The subject of increasing public debate in the late 20<sup>th</sup> century, land reform in Scotland was sought in order to put land regulation and control into the hands of the indigenous Scots.<sup>40</sup> In addition collective memories recorded injustices at the hands of absentee landlords, estate factors, and the trading of land in the global property market.<sup>41</sup> Late 20<sup>th</sup> century land reform in Scotland, rather than breaking up the large private estates into smaller parcels of land, aimed to keep the estates whole while transferring ownership of them to local communities.<sup>42</sup>

The revolution in land reform commenced with the purchase of the North Lochinver Estate by the Assynt crofters in 1993.<sup>43</sup> The Land Reform (Scotland) Act 2003<sup>44</sup> set in place mechanisms to promote community land ownership. In turn the newly established Community Land Trusts faced the same challenges as the former impoverished aristocrats: how to make the land which was now in community ownership profitable.

Areas of community-owned land are spaces where people act together at the most local level while seeking to engage, through collective action, with individual and community

---

<sup>38</sup> A. Wightman, *The Poor had no Lawyers. Who owns Scotland (and how they got it)* (Birlinn, 2010).

<sup>39</sup> R. McMorran, A.J. Scott and M.F. Price, 'Reconstructing sustainability: Community land ownership in the Outer Hebrides, Scotland', *International Journal of the Commons*, 4 (2014), pp. 319-344.

<sup>40</sup> J. Hunter, *The Making of a Crofting Community* (John Donald, 1976). T.A. Croft, 'Conservation charity land ownership in Scotland', *Scottish Geographical Journal*, 120 (2004), pp. 71-82.

<sup>41</sup> Wightman, *The Poor had no Lawyers*. Mackenzie, *Places of Possibility*.

<sup>42</sup> Hoffman, 'Why community ownership?'

<sup>43</sup> Mackenzie, *Places of Possibility*.

<sup>44</sup> Land Reform (Scotland) Act (2003).

development.<sup>45</sup> Community land ownership has emerged as an important mechanism to challenge the dominance of traditional power structures, such as those embedded in the private ownership of country estates.<sup>46</sup> Community land ownership and management has in turn been linked to increasing community empowerment, control and deeper social engagement since, in taking ownership of the land, communities had the opportunity to reconnect to the land on which there was long-standing and historically-deep common claim.<sup>47</sup>

Land that is community owned is intimately bound to the meaning of ‘community’ - a philosophical and social concept connected to making sense of the major 18<sup>th</sup> century societal shift from premodern to modern society.<sup>48</sup> As economies and societies transitioned from reliance on agriculture to industrial production, the concept of community was invoked to describe a way of life that was at the point of vanishing. The modern meaning of community refers to a group of people who share a neighbourhood proximity, a consciously chosen affinity (religion), or shared life circumstance.<sup>49</sup>

---

<sup>45</sup> J. Atkinson, ‘The seeds of change: The new place of gardens in contemporary Utopia’, *Utopian Studies*, 18 (2007), pp. 237-260. C. Nettle, *Community Gardening as Social Action* (Ashgate, 2014), p. 3.

<sup>46</sup> R. Ghose and M. Pettygrove, 2014. ‘Actors and networks in urban community garden development’, *Geoforum*, 53 (2014), pp 93-103. M.B. Pudup, ‘It takes a garden: Cultivating citizen-subjects in organized garden projects’, *Geoforum* 39 (2008), pp. 1228-1240.

<sup>47</sup>Hunter, *The Making of a Crofting Community*.

<sup>48</sup> C. Calhoun, ‘Community: Toward a variable conceptualization for comparative research’, *Social History*, 5 (1980), pp. 105-129.

<sup>49</sup> Pudup, ‘It takes a garden’.

While the relationship between place and community is ambiguous and contested,<sup>50</sup> community continues to be an idealized concept which is an “imagined but powerful discursive reality with material consequences too important to be ignored”.<sup>51</sup> In relation to community land ownership, community organizing is invoked as an ecological route to empowerment and the reversal of community decline.<sup>52</sup>

In Scotland in 1995 there were 258 privately-owned estates (larger than 10 000 acres) and this fell to 246 estates by 2012.<sup>53</sup> Of the 12 estates, six estates were taken into community ownership. This significant change in land ownership is attributed to the acquisition of land by community organizations, and in some cases conservation bodies, e.g., Royal Society for Protection of Birds. The site of most of the expansion of community and conservation body owned land has been in the west Highlands and Islands, e.g., Gigha, Eigg and parts of Harris and South Uist.

The concentration of private land ownership in Scotland in the hands of the English aristocracy survived for more than 300 hundred years. Yet land tenure systems are socially constructed and can only survive for as long as society continues to maintain them. The Highland Clearances made real the damaging effects that dispossession had on peoples’ lives

---

<sup>50</sup> H. Kurtz, ‘Differentiating multiple meanings of garden and community’, *Urban Geography*, 22 (2001), pp. 656-670.

<sup>51</sup>G. Rose, ‘Imagining Poplar in the 1920s: Contested concepts of community’, *Journal of Historical Geography*, 16 (1990), pp. 425-437.

<sup>52</sup>Hunter, *From the Low Tide*. R. McMorran, A.J. Scott and M.F. Price, ‘Reconstructing sustainability: participant experiences of community land tenure in North West Scotland’, *Journal of Rural Studies*, 33 (2014), pp. 20-31. P.W. Speer and J. Hughey, ‘Community organizing: An ecological route to empowerment and power’, *American Journal of Community Psychology*, 23 (1995), pp. 729-748. M.A. Zimmerman and J. Rappaport, ‘Citizen participation, perceived control and psychological empowerment’, *American Journal of Community Psychology*, 16 (1988), pp. 725-750.

<sup>53</sup> Whiteman, *Who owns Scotland*.

yet it was not until the 21<sup>st</sup> century that new laws were enacted to offer communities the right to buy land that had been formerly in private ownership. Community ownership however, does not resolve the challenge of how to make the land profitable. How community ownership of the Gardens has influenced garden conservation and use is explored in Chapter 5.

### **Conclusion**

This chapter has presented the context of the dissertation in which land ownership influences land use. The next three chapters present a chronological and analytical account of the development of the Gardens from a private hunting estate to community owned Gardens.

## Chapter 3 Achamore Gardens (Pre-1944)

### Introduction

This chapter compiles information about the ownership of Gigha from the early 10<sup>th</sup> century to 1944 when it was acquired by the Colonel. Information about the ownership of Gigha is difficult to substantiate prior to 1865 and hence the analysis for this period relies on old maps and plans held by the National Library for Scotland. Information relating to the Gardens between 1865 and 1944 employs information from the National Library of Scotland and documents in the Garden Archive.

### Early History of Gigha

Historically the island of Gigha belonged to the Clan MacNeill, relinquished to the Clan Macdonalds in 1554 and returned to the MacNeill in the 17<sup>th</sup> century.<sup>54</sup> The first map to show Gigha (as Gegay) is the *Scotiae tabula* (1580);<sup>55</sup> subsequent maps note Gigay<sup>56</sup>, Gega<sup>57</sup> and Giaga.<sup>58</sup> On all these maps Gigha is marked as a small irregular shaped island to the west of the Argyll peninsula and marked with only the name of the island. The first description of

---

<sup>54</sup> W.H. Lizars, Map of the Highlands of Scotland denoting the districts or counties inhabited by the Highland clans (1882). <http://maps.nls.uk/scotland/rec/864> Accessed 1 August 2017.

<sup>55</sup> A. Ortelius. *Scotiea tabula* (1580) <http://maps.nls.uk/scotland/rec/128> Accessed 1 August 2017.

<sup>56</sup> J. Sudbury and G. Humbell, *The Kingdome of Scotlande* performed by John Speed (1610/1629) <http://maps.nls.uk/scotland/rec/134> Accessed 1 August 2017.

<sup>57</sup> J. Jansson, *Lorna, Knapdalia, Cantire, Jura, Ila, Glota et Buthe insulae* (1659) <http://maps.nls.uk/scotland/rec/138> Accessed 1 August 2017.

<sup>58</sup> J. Cowley and R.W. Seale, *A new map of North Britain and the Islands there belong. Scotland* (1734) <http://maps.nls.uk/scotland/rec/166> Accessed 1 August 2017.

Gigha (1703) notes “The isle affords no wood of any kind, but a few bushes of juniper on the little hills”.<sup>59</sup> The first map to show the name Achamore (as Achmore) is dated 1824.<sup>60</sup>

### **James William Scarlett**

The MacNeills sold Gigha for £49 000 to James William Scarlett in 1865,<sup>61</sup> the second cousin of William Frederik Scarlett, 3<sup>rd</sup> Baron Arbinger. On purchase Gigha was virtually treeless and the planting of the mixed near to the woodland is attributed to them. The woodland now laying to the north and south of the house and was largely planted between 1859 and 1869.<sup>62</sup> The initial aim was to provide shelter for game cover as the estate was primarily used for hunting, shooting and fishing. The Ordnance Survey Map (1882) shows Achamore House (but no indication of the current Walled garden nor the South Drive). (Figure 4).

---

<sup>59</sup> M. Martin, *The Isle of Gigha* (1703).

<sup>60</sup> J. Thompson and W. Johnstone, *John Thomson’s Atlas of Scotland 1832. Northern part of Argyll Shire, Southern Part. Bottom section* (1824) <http://maps.nls.uk/atlas/thomson/506.html> Accessed 1 August 2017.

<sup>61</sup> Although reported online the date of sale is uncertain. An interview with Alastair MacLean (June 2017) gave the date as mid 1820s.

<sup>62</sup> Colonel Horlick, Presentation to the RHS when describing the policies at Achamore states: “These woods were planted some 85 to 75 years ago” (1964). AGT.





Figure 4. The Achamore Estate, Gigha (1882). Ordnance Survey one inch to the mile first edition. 1856-1891. Maps of Scotland. Sheet 20. Killean. <http://maps.nls.uk/view/74488605> (Accessed 1 August 2017)

The Ordnance Survey map (1896) depicts Achamore House and gardens. The main approach to the house is by a long, curved drive (North Drive) and to the south of the house is a second drive (South Drive) and Home Farm. (Figure 5).



Figure 5. The Achamore Estate (1896). Ordnance Survey. Second edition. 1885-1890. One inch to the mile maps of Scotland. Sheet 20. <http://maps.nls.uk/view/74488606> (Accessed 1 August 2017)

The Ordnance Survey Name Book (1878)<sup>63</sup> describes Achamore House as:

A good sized modern dwelling house the summer residence of Mr Scarlett, proprietor of the island of Gigha. It is situated about half a mile south of the church, has a good sized garden attached and a small portion of ornamental ground.

Three photographs of the first Achamore House (pre-1884) show the house, the island and parts of the Gardens. Figure 6 shows the house, the Mound (flag pole) and confirm the lack of trees to the rear of the estate. Figure 7 shows a small hedge of trees west of the house and the relative openness of the estate to the island. Figure 8, also from the west, shows a stone staircase up to the rear of the house and some tree planting in the Gardens and on the ridge.

<sup>63</sup> Ordnance Survey, First edition, *Name Book* (1868-1878). <http://maps.nls.uk/> Accessed 1 August 2017.



Figure 6. Achamore House West View (Pre-1884)



Figure 7. Achamore House South West View (Pre-1884)



Figure 8. Achamore House West View with Garden (Pre-1884). Figures 6, 7 and 8 by kind permission of Don and Emma Dennis, Achamore House, Gigha.

### **William James Scarlett**

After a fire destroyed the first Achamore House, a new house was built in 1884 to a design by the Glasgow architect John Honeyman (1831-1914) and assisted by Charles Rennie Macintosh (1868-1928). A second fire in 1896 necessitated further restoration and the house was again rebuilt in 1900. The walled garden was also established by the Scarlett family and incorporates greenhouses, and vegetable and flower beds.

Two photographs from the early 20<sup>th</sup> century (estimated 1908) provide a glimpse into the Gardens. Figure 9 is a group of 20 estate employees holding brushes, horse brasses, axes and rakes. The image is said to be of employees on the estate's farm (Home Farm).<sup>64</sup> Figure 10

---

<sup>64</sup> Interview with Malcolm MacNeil, gardener at the Gardens. (June 2017).



shows three estate workers mowing the lawns at the Gardens. The lawn is to the front of the main house.



Figure 9. Achamore Estate Employees, Home Farm (Est. 1908).



Figure 10. Mowing the lawn at Achamore Gardens (Est. 1908). Figures 9 and 10 displayed in the Gigha Hotel, Gigha and used by kind permission.

### **Achamore House and Gardens 1911**

Gigha was put up for sale by the Scarlett family in 1911 and described in detail in the sale brochure.<sup>65</sup> The brochure includes a plan and several photographs of the Gardens. The photographs record the gateway to the north drive which has four ashlar gate piers with moulded caps and bosses connected by curved walls with two other piers of the same form. The gates and railings are cast iron with arrow heads and remain in situ to date (Figures 11 and 12). Just inside the gates on both sides can be found large rocks that border the entrance to the Gardens.



Figure 11. Entrance, North Drive (1911). Knight Frank and Rutley

---

<sup>65</sup> Knight Frank and Rutley, *Sales particulars for Gigha* (1911). Images taken by author with kind permission of the National Library of Scotland.



Figure 12. Entrance, North Drive (June 2016). Author.

The main approach to Achamore House is a long, gently curving drive bordered by grass, hedging and trees. The photographs from 1911 show well-stocked flower beds to the fore, trees to the rear, e.g., cordylines, shrubs, and herbaceous perennials, e.g., *Lupinus* and *Cortaderia*. The description of the Gardens in the brochure is:

The GARDEN, which is substantially walled in, is tastefully laid out, and its quaint old Herbaceous Borders are an attractive feature. It is well stocked with Fruit Trees and Bushes and contains a small Greenhouse in good order. There are comfortable cottages near the Garden for the Gardener and other servants. The POLICIES have been much improved and enlarged in recent years, and, with the MANSION HOUSE and GARDEN, cover about 63 acres, all well fenced, and laid out with much taste. About a third of the above area (situated

in close proximity to the Mansion House) consists of old PLANTATIONS intersected by numerous GRASS WALKS. The remaining, and greater portion of this area, is under thriving young mixed Plantations.<sup>66</sup>

The 1911 sale brochure contains the earliest map of the gardens (located to date). (Figure 13). The plan shows the curved North Drive from the main gate to the house which sweeps in front of the house and down the South Drive to the Southern Gate. In addition to the main South Drive are two further pathways to the house. These were necessary as “staff were not allowed to walk up the South drive”.<sup>67</sup>

The formal lawn is to the front of the house and the adjoining Walled Gardens are to the rear of the house. The policies are marked as mixed woodland and there is a small round pond, a clearing to the south of the house (later the Theatre) and a tennis green. A road to the rear of the house connects the Gardens to Home Farm.

---

<sup>66</sup> Knight, Frank and Rutley, p. 11.

<sup>67</sup> Interview with Malcolm McNeill (June 2017).



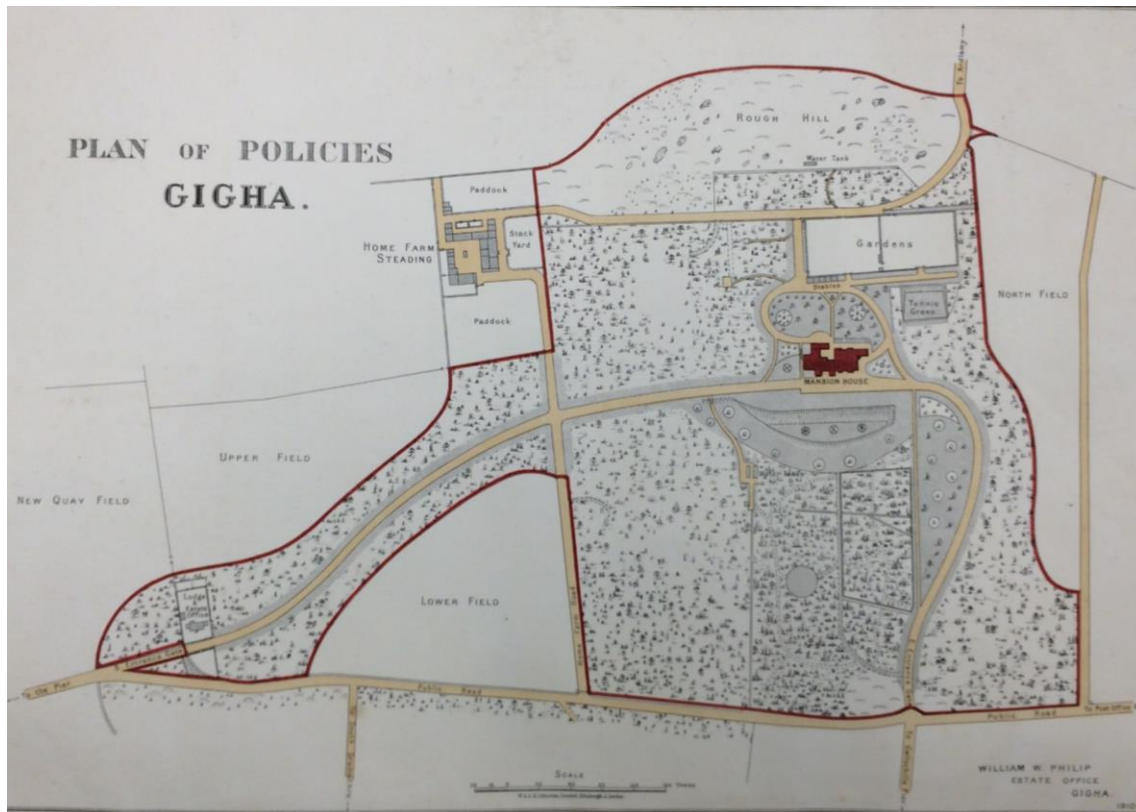

Figure 13. Plan of Policies of Gigha (1911).

The photographs (Figures 14 to 19, all from Knight Frank and Rutley) of the Gardens show a well-kept formal approach drive bordered by lawn and hedging, *Rhododendron ponticum*, *Cortaderia selloana* and *Cordyline australis*, deep herbaceous borders, stone walls and hedging. Although the garden plan and photographs show formal, well stocked and carefully maintained gardens, no accounts pre-1944 of the development of the gardens, payments to gardeners or purchase of plants have been located. Just one comment made in 1959 states that to “the south west corner of the walled garden tucked up against the wall and against the hill a vast *Camellia japonica* at least 100 years old”.<sup>68</sup>

<sup>68</sup> Colonel Horlick, ‘Growing camellias of the south west coast of Scotland’ (1964). Text for a presentation. Audience not noted. AGT.



Figure 14. South Drive to Achamore House (a).



Figure 15. South Drive to Achamore House (b).





Figure 16. Rear border.



Figure 17. Grass path and herbaceous borders (a).



Figure 18. Grass path and herbaceous borders (b).



Figure 19. Wall and hedging and gardener.



Although put for sale in 1911, Gigha was not sold until after World War 1.<sup>69</sup> In 1917 (the date is uncertain and might be 1919) Gigha was purchased by Major John Allen. In 1937 Gigha was sold to Richard and Elaine Hamer (née de Chair), daughter of Admiral Sir Dudley de Chair, former Governor of Australia. During the WWII Gigha passed to Elaine Hamer's brother, Somerset de Chair, who sold the island to the Colonel in 1944.

## **Conclusion**

This chapter has presented an illustrated chronological account of the Gardens from the earliest known maps of the island (1580) to 1911. The Gardens were part of a private country estate used in the summer by the Scarlett family; the photographs portray a well-kept estate with well stocked and tended flower beds, and carefully maintained drives and paths. The next chapter explains the creation of the Gardens after Gigha was purchased by the Colonel.

---

<sup>69</sup> Interview with Alastair MacNeil (June 2017).

## Chapter 4 Achamore Gardens (1944-1972)

### Introduction

This chapter synthesizes the influences on the designed landscape of the Gardens when owned by Colonel Sir James Horlick (the Colonel). The chapter considers first Kitty Lloyd-Jones, to whom the designed landscape has been attributed, and presents new evidence about James Russell's (Russell) contribution to the designed landscape and planting of the Gardens. The Colonel was the second son of Lord Horlick and had previously lived at Titness House and Little Paddocks (Berkshire). He married twice, had three children, and inherited the Horlick baronetcy from his nephew in 1958.<sup>70</sup>

### The Colonel and Gigha

Gigha was purchased by the Colonel to provide a place to indulge in his interest in plants and gardening, particularly rhododendrons.<sup>71</sup> His wish to find a suitable location to create a garden is attested to in a letter to Russell (1960) in which he sympathises with Russell's comparatively poor growing conditions in Surrey and shares his pleasure with his success in creating the Gardens:

Sorry to hear you had such a later winter and early spring. I cannot think why you live in such a God-forsaken country. It nearly cured me of gardening. One disappointment

---

<sup>70</sup> Miss McGill (second wife) was employed as a secretary at Horlicks Limited. Letter from Russell to the Colonel. SN. (24 February 1953). Letter addressed to Miss McGill (Secretary) at Horlicks from Russell "I have not yet had confirmation about the Pinus Contorta, but may I come to do the planting at Gigha arriving on the evening of 22<sup>nd</sup> to plant on the Monday and Tuesday, 23<sup>rd</sup> and 24<sup>th</sup> March". By June 1954 Miss McGill is living on Gigha. Letter from Russell to the Colonel annotated "JM sent P.c. 29/6/54 saying Colonel left yesterday for Baltic". SN. (24 June 1954). AGT.

<sup>71</sup>Hellyer, 'Great British garden makers'.

after another. Here the garden is the finest I have ever seen it. The nursery garden is ablaze and so are the Lindleyi, Taggianum and the bluebells.<sup>72</sup>

The Colonel lived on Gigha for the major part of the year and planted much of the content of the Gardens.<sup>73</sup> His official title was Sir James Horlick, laird of Gigha and the islets of Claro and Gigalum. The development of the Gardens was managed by the Colonel with the assistance of Malcolm Allan (head gardener from 1918 to 1970).<sup>74</sup> As a benevolent landlord he also used his experience of the family business to support the island's dairy industry. In the 1950s the Colonel also purchased and created a garden at The Timbers, Ascot, for his use when he travelled south to England.

On purchasing Gigha, the Colonel reported that “in 1944 there was only a rather derelict two-acre walled garden divided into two by a low wall – and some of the plants they contain”, and “a wood that had never been thinned and hardly had a decent tree in it”.<sup>75</sup> When describing the making of the garden he explains:

In the making of the garden I was first of all very much helped by a professional lady gardener, Miss Lloyd-Jones who had worked with me at Sunninghill during the war, and then by Mr Jim Russell of Sunningdale Nurseries, who helped me both with advice, layout of plants, and I found his knowledge invaluable.

---

<sup>72</sup> Letter from the Colonel to Russell. (9 May 1960). AGT.

<sup>73</sup> The Colonel resided at his Berkshire home for 2-3 weeks each year (initially Little Paddocks and then The Timbers) and also travelled extensively each year, e.g., to Europe, Africa, North America. AGT.

<sup>74</sup> Czerkawska, *The Way it Was*, p. 199.

<sup>75</sup> Colonel Horlick, ‘The making of Gigha Garden’. Transcript of the text of a lecture given to RHS (30 March 1964). AGT.

In a second presentation, subsequently published, the Colonel recounts how he brought plants from Little Paddocks to the Gardens. “When I came up here from the South I had high hopes and brought some 150 small plants from the large collection I had down there. I still have round about 20 to 30 out in the garden”.<sup>76</sup> In the presentation the Colonel also states:

In the early days here I had a very highly skilled professional gardener who was an excellent partner and she did clear masses of stuff out of this very big plant, rather as an apple tree pruned (three farm cart loads of branches I remember) and it certainly did flower for several years later, much to the astonishment of my gardener who had never previously seen it bloom.

### **Kitty Lloyd-Jones and the Gardens**

The professional lady gardener referred to above is Kitty Leticia Lloyd-Jones. From the late 1920s up to World War II Lloyd-Jones provided advisory services to clients in Hertfordshire, Oxfordshire and Berkshire. Entries in the Little Paddocks estate books record four payments to Lloyd-Jones (1938-1940).<sup>77</sup> In 1942 the Colonel refers to Lloyd-Jones in a letter to Lily Hill Nursery<sup>78</sup> and in 1943 he names her as “my partner” in a letter to the Colonel the Hon.

---

<sup>76</sup> Colonel Horlick, ‘Growing Camellias off the South West Coast of Scotland’ (*Rhododendron and Camellia Yearbook*, 1964). AGT.

<sup>77</sup> Little Paddocks Estate Book. Payments to Miss K. Lloyd-Jones: £13.4 (August 1938); £28.2.11 (31 October 1938); £41.2.10 (6 May 1939); and £6.1.6 (30 January 1940). AGT.

<sup>78</sup> Letter from the Colonel to Mr J R Taylor, Lily Hill Nursery, Bracknell. (30 November 1942) “As Miss Lloyd-Jones car is out of order I propose to call for the plants which I ordered from you”. AGT.



Campbell.<sup>79</sup> Further, in December 1942 Colonel Horlick nominates and pays Lloyd-Jones's subscription to the Rhododendron Association.<sup>80</sup>

In 1947 the Colonel commissioned architects Walker and Harwood to remodel Achamore House and the plans show a suite of rooms designated for Lloyd-Jones. Thus the *modus operandi* described in the historiography is borne out in the architectural drawings for remodelling of Achamore House. (Figure 20). Lloyd-Jones presence on Gigha and her active involvement in the garden is further supported by a delivery note (10.12.48) from Wm Bates Nursery, Wokingham, on which her name has been hand written. (Figure 21)

---

<sup>79</sup>Letter from the Colonel to Campbell, Auchindoune, Cawdor, Nairn (16 November, 1943) "I also asked my partner, Miss Lloyd-Jones, to include some layers of *Cotoneaster Congesta Procumbans* ... I do not know, however if she has done so or not, and she has now gone off for a day or two". AGT.

<sup>80</sup> Letter from the Rhododendron Association to the Colonel, Titness Farm (16 December 1942): "I learn with pleasure that you desire to propose Kitty Lloyd-Jones for membership of the Rhododendron Association". Letter from Rhododendron Association to the Colonel to confirm membership fee for Lloyd-Jones (29 December 1942). AGT.

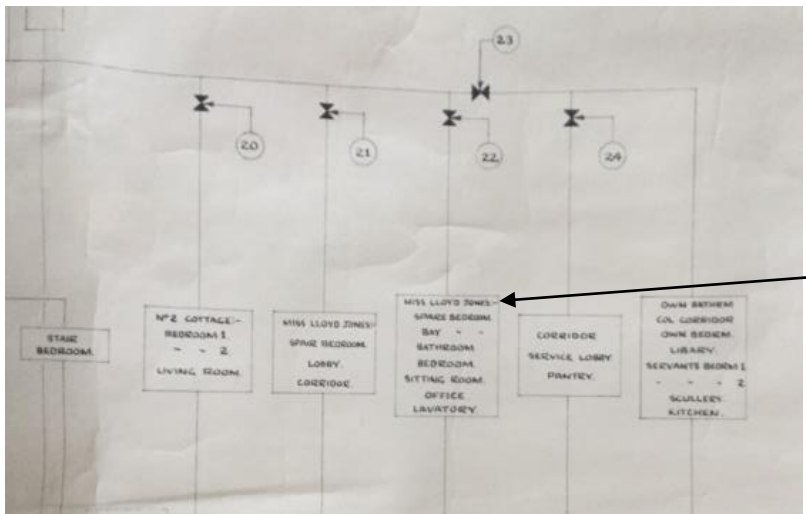

**Miss Lloyd-Jones**  
 Spare bedroom  
 Bay bedroom  
 Bathroom  
 Bedroom  
 Sitting Room  
 Office  
 Lavatory

Figure 20. Suite for Lloyd-Jones at Achamore House (1947). Plan for Achamore House. Walker and Harwood, 21 Suffolk Street, SW1. AGT.

Telephone WOKINGHAM 252.  
 Miss Lloyd Jones, Isle of Gigha, Argyll, Scotland  
 December 17th 1948

TO -  
**Wm. BATES, F.R.H.S., M.N.R.S.**  
 WINNERSH NURSERY,  
 Nr. WOKINGHAM, Berks.

CHOICE	TO	FRUIT TREES
FLOWERING		ROSES
TREES		SHRUBS
2 Large Beech	8 10/6	1 1 0
1 Small Malmeiderana		10 6
1 Hf St. Malmeiderana		10 6
1 Bush - Dr. Norton's variety		10 6
1 Hf St. - Lady Northcliffe		12 6
1 . . . spectabilis rosea plena		15 0
1 . . . canonic		7 6
1 Bush " "		2 2 0
6 Malmeiderana	07/	1 10 0
6 . . . canonic	04/	1 10 0
2 . . . Norton's variety		10 0
6 . . . Apple's Orange Pippin		1 10 0
1 Camara Burkwoodii		10 6
1 Malmeiderana (Arctic) undulata		10 6
1 . . . undulata		5 0
1 Parrotia persica		10 6
2 Anemone pulsatilla	01/6	1 1 0
1 N. . . . .		1 1 0
1 . . . . .		5 0
1 Soraythia Lynwood variety		10 6
Carried forward		16 16 0

Hand written note at top of invoice: Miss Lloyd Jones, Isle of Gigha, Argyll, Scotland  
 17 December 1948

Figure 21. Delivery note to Gigha from Winnersh Nurseries (1948). AGT.

## Creating the Gardens

The first few tasks to create the Gardens described by the Colonel were to clear the *rhododendron Ponticum*, the woods and bramble, purchase and raise new shrubs and plants for the Gardens. (Figures 22, 23 and 24)

The northern drive was flanked on both sides by three rows of 12 foot high ponticum rns., and southern drive by enormous escallonias. Ponticum invaded everywhere, and where it was not ponticum, it was occasionally very tall privet.<sup>81</sup>

Directly I bought the property I proceeded to raise cuttings from my garden at Sunninghill, and layers of rhodos and azaleas, and to hunt round for holly and tree seedlings from the little wood I possessed; and when they were ready these little plants were sent up in linen baskets, passenger train, insured, and took five days to arrive.<sup>82</sup>



Figure 22. Making Gigha garden (1952). AGT.

---

<sup>81</sup> Horlick, 'The making of Gigha garden'.

<sup>82</sup> Ibid.



Figure 23. Clearing the North Side September (1952). AGT.



Figure 24. Cutting out old ponticum (1953). AGT.

### **James Russell and the Gardens**

Prior to buying Gigha in 1944, the Colonel had purchased plants from SN for Little Paddocks. The earliest dated correspondence between the Colonel and SN is an enquiry for a catalogue in 1937.<sup>83</sup> This is followed by an order for 8 rhododendrons and a request to keep

---

<sup>83</sup> Letter from H. White to Horlick, Ardwenikie, Kinloch Laggan, Nr Kingussie, SN. (10 August 1937): “I am obliged by your esteemed enquiry and have pleasure in enclosing a copy of our catalogue”. AGT.

them until after his return from Scotland in “the middle of October”.<sup>84</sup> Further orders for Rhododendron, Acer, Pieris, were placed in October 1939.<sup>85</sup> In 1940, rhododendrons and azaleas were ordered from SN to be delivered to Little Paddocks in May<sup>86</sup>, September<sup>87</sup> and October. The October letters from SN are conversational and refer to “your telephone call” and “mention a few other items, which may be of interest”.<sup>88</sup> The letters from SN are signed by Louis Gray. The informal style of the letters suggests the start of a relationship between SN and the Colonel. The next document from SN to the Colonel is a quarterly account for £3.5 that lists *Pieris* (one) and *Rhododendron* (ten).<sup>89</sup> In April 1944 the quarterly account for rhododendrons from SN to the Colonel is £9.6.6.<sup>90</sup>

The Colonel purchased Gigha in 1944 and no correspondence with SN between 1944 and 1949 is kept in the archive. However, a letter from Russell (5 August 1949) addressed to the Colonel on Gigha describes in detail plants taken from Titness,<sup>91</sup> plants to be purchased by the Colonel (£144.8.6), and plants to be given by the Colonel to “Miss Sealey”. This letter corresponds to a hand written note by the Colonel for plants. (Figure 26). At the end of the letter Russell comments “things have improved slightly here since the rain, but the weather

---

<sup>84</sup> Letter from the Colonel to Messrs. H. White. (13 August 1937). AGT.

<sup>85</sup> List of plants headed “Bought from Sunningdale Nursery (sale). H. Wight (HW)”. (18 and 19 October, 1939) AGT.

<sup>86</sup> Letter confirmation of order for 7 rhododendrons. SN. (5 May 1940). AGT.

<sup>87</sup> Note of order placed by the Colonel with SN for 137 plants for £20 (23 September 1940). AGT.

<sup>88</sup> Letter from SN to the Colonel, Little Paddocks. (22 October, 1940). AGT.

<sup>89</sup> Quarterly Account to the Colonel. SN. (16 April 1943). AGT.

<sup>90</sup> Quarterly Account to the Colonel. SN. (15 April 1944). AGT.

<sup>91</sup> Titness House lies adjacent to Little Paddocks, Ascot.

now seems to be as hot as ever”.<sup>92</sup> The letter suggests discussion between the Colonel and Russell about Titness House and the Gardens. On August 17 (1949) Russell writes (in his own hand) to the Colonel and describes the plants he will send – he also comments on the weather.<sup>93</sup>

Quantity	Plant Name	Unit	Price
470	Pink Gumpo	6 <sup>d</sup>	11. 15. 0
125	White	6 <sup>d</sup>	3. 2. 6
50	Calceolias	6 <sup>d</sup>	1. 5. 0
30	Eddy	6 <sup>d</sup>	15. 0
3	Maples	6 <sup>d</sup>	1. 6
100	Macraetia	6 <sup>d</sup>	2. 10. 0
20	Wilson No 19	6 <sup>d</sup>	10. 0
10	No 1	6 <sup>d</sup>	25. 0
9	No 26	6 <sup>d</sup>	4. 6
10	No 5	6 <sup>d</sup>	5. 0
170	Rk Blue Diamond	1/-	8. 10. 0
690	Rk Blue Tit	1/-	34. 10. 0
130	Hino Mayo	6 <sup>d</sup>	3. 5. 0
100	Scirpus alba	6 <sup>d</sup>	2. 10. 0
250	Camellias	6/-	75. 0. 0
			<hr/> 144. 8. 6.

Figure 26. Note by the Colonel to SN (1949). AGT.

In 1951 two letters from the Colonel (24 September, 2 November) and Russell (8 November) discuss plants and the Colonel’s health. Referring to “Exbury strain Knaphill Azaleas for sale at 12/6d each” the Colonel writes:

<sup>92</sup> Letter to the Colonel from Russell. SN. (5 August 1949). AGT.

<sup>93</sup> Letter to the Colonel from Russell. NC. (17 August 1949). AGT.

I should like to have 2 dozen about 15” to 18”. I take it there will be a small reduction on that number. I should be very grateful if you would pick out specially good plants as I wish to make a big bed of them up here. I want only the red, orange and yellow shades, no pink. If possible I would like equal numbers of each. Can you arrange for these plants to be despatched by Passenger Train so as to arrive about 1<sup>st</sup> December.<sup>94</sup>

The correspondence between the Colonel and SN up to 1952 suggests that between a loyal and price-conscious customer and an obliging supplier of shrubs and plants. The subsequent correspondence however, portrays an ever-closer relationship between the two parties. Although a letter commissioning a formal plan for Gardens is not kept, the first letter of 1952 (31 May) from Russell to the Colonel promises that “the plans to follow”. (Figure 27)

I am very sorry that this letter has been such a long time and that you still have not got the plan for the wall garden. This, however, will be sent off next week. I am afraid that Chelsea is such a disorganising time with the number of people who come to see the garden that it is extremely hard to get on with any solid work. I am enclosing with this letter a list of Azaleas which you liked here the other day and also a note of Rhododendrons which you asked me to keep for you.<sup>95</sup>

---

<sup>94</sup> Letter from the Colonel to SN. (2 November 1951). AGT.

<sup>95</sup> Letter to the Colonel from Russell. SN. (31 May 1952). AGT.



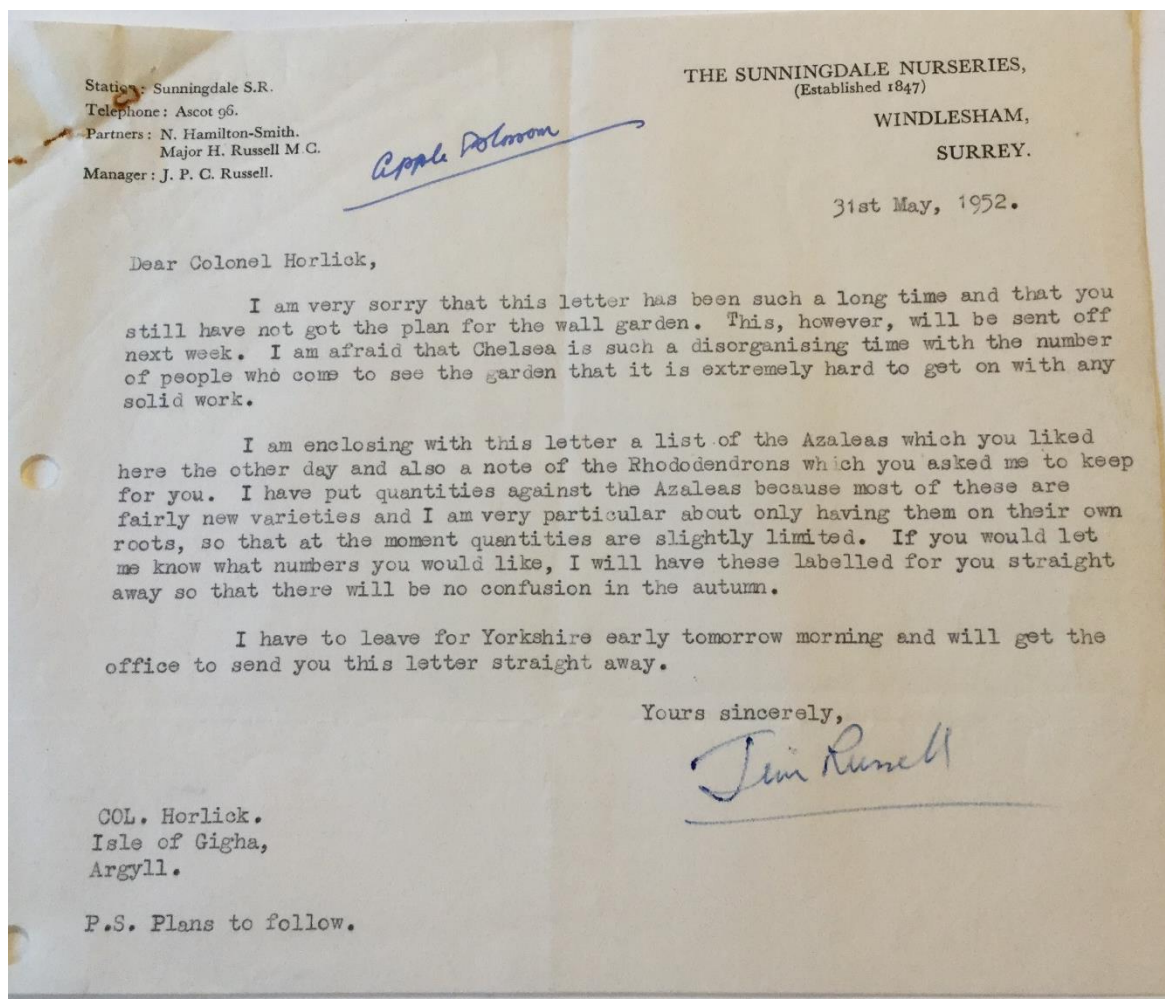

Figure 27. Letter from Russell to Horlick (1952). AGT.

Accompanying the letter are three lists of plants, prices and a description of the garden (the lists extend to 4 pages). The description proposes specific plants, where to plant them, and plant groups. Below are two short excerpts that refer explicitly to features in the Gardens and Gigha.<sup>96</sup>

For the rocks just inside the drive I would suggest on the sunny side a grouping of Rosa Richardi a particularly charming small rose from Abyssinia with single shell pink flowers with a bunch of golden stamens at the centre.

<sup>96</sup> The full text in Appendix 2.



The question of background plants in the woodland is a somewhat large one and I think would really be best considered on the ground. Perhaps with a view to spring planting ... If the royal fern *Osmunda Regalia* does not grow on Gigha then I think should be introduced in fairly considerable quantity. There is nothing quite so fine as its tall upstanding fronds in their vivid bronzy green.

In July 1952 Russell writes to thank the Colonel for his cheque and notes “I had worked out a rough scheme for the wall garden so enclose it as a matter of interest”.<sup>97</sup> Russell also repeats his offer to “discuss the underplanting in the wood with you on the ground as I think it is nearly impossible to do on paper”.<sup>98</sup> The exchange confirms that the plans must have been hand drawn as Russell comments in a post script “I am afraid I am a very poor drawer of plans, as you can see”. Although no copy of the formal plan is in the archive, it is clear from the five typed pages of a planting plan for “The Wall Garden at Gigha” attached to the letter that Russell had used specific features in the walled garden as reference points for the formal plan, e.g., “the seat marked A”, “the centre of this bed, D,” and the “centre E a large ornamental pot”.<sup>99</sup>

On July 17<sup>th</sup> Russell writes (in his own hand) from his personal address at Nursery Court (NC) that he sends a list of azaleas to the Colonel and that “I should love to come up and discuss things in August, preferably fairly near the end of that month”, and that “I can

---

<sup>97</sup> Letter from Russell to the Colonel. SN. (18 July 1952). AGT.

<sup>98</sup> Ibid.

<sup>99</sup> The Wall Garden at Gigha. Attached to letter. (July 1952). Description unsigned and undated. AGT. In Appendix 3.

certainly quote you for a quantity of ‘filling up’ azaleas at a reasonable price”.<sup>100</sup> In this letter he also mentions that “I have to go and deal with some gardens in Herefordshire, Shropshire and Staffordshire”. These are references to Russell’s visits to and commissions from many other clients, or as he later refers to them in personal correspondence to the Colonel - “my victims”.<sup>101</sup>

The much-talked about visit by Russell to Gigha however, does not come to fruition because Russell writes in August that “I am most terribly sorry to have let you down over coming to Gigha”, because of a medical problem and that “Just at the moment I am in Ayrshire hills shooting”. The letter then describes several visits to clients and ends “I am going to do some planting in the Montroses’ at Auchamn, finishing October 22<sup>nd</sup> so if I could come on to you from there it would suit very well”.<sup>102</sup> A further hand written letter from Russell, on this occasion sent from an address in Angus, seeks to set up a visit to Gigha in early October and notes that “I shall be c/o Duke of Montrose, Brodick castle, Arran from Sept 27<sup>th</sup> – Oct. 1<sup>st</sup> and at the Buchanan Arms, Dunvegen, Glasgow from Oct 1<sup>st</sup> – 3<sup>rd</sup>”.<sup>103</sup>

Writing from Inverness on October 11<sup>th</sup> I conclude that Russell has finally visited Gigha. He explains in his letter (Figures 28 and 29):

---

<sup>100</sup> Letter to the Colonel from Russell. NC. (19 July 1952). AGT.

<sup>101</sup> Letter from Russell to the Colonel. NC. (21 August, 1960). AGT.

<sup>102</sup> Letter to the Colonel from Russell. Crathes Castle, Crathes, Kincardineshire. (13 August 1952). AGT.

<sup>103</sup> Letter to the Colonel from Russell. Wellbank Cottage, Cortacky, Angus. (25 September 1952). AGT.

It was extremely kind of you to have me to stay at Gigha and I enjoyed myself enormously. As soon as I get home (about 15<sup>th</sup>) I will write at length about the garden. I really think you have got the most wonderful possibilities.<sup>104</sup>

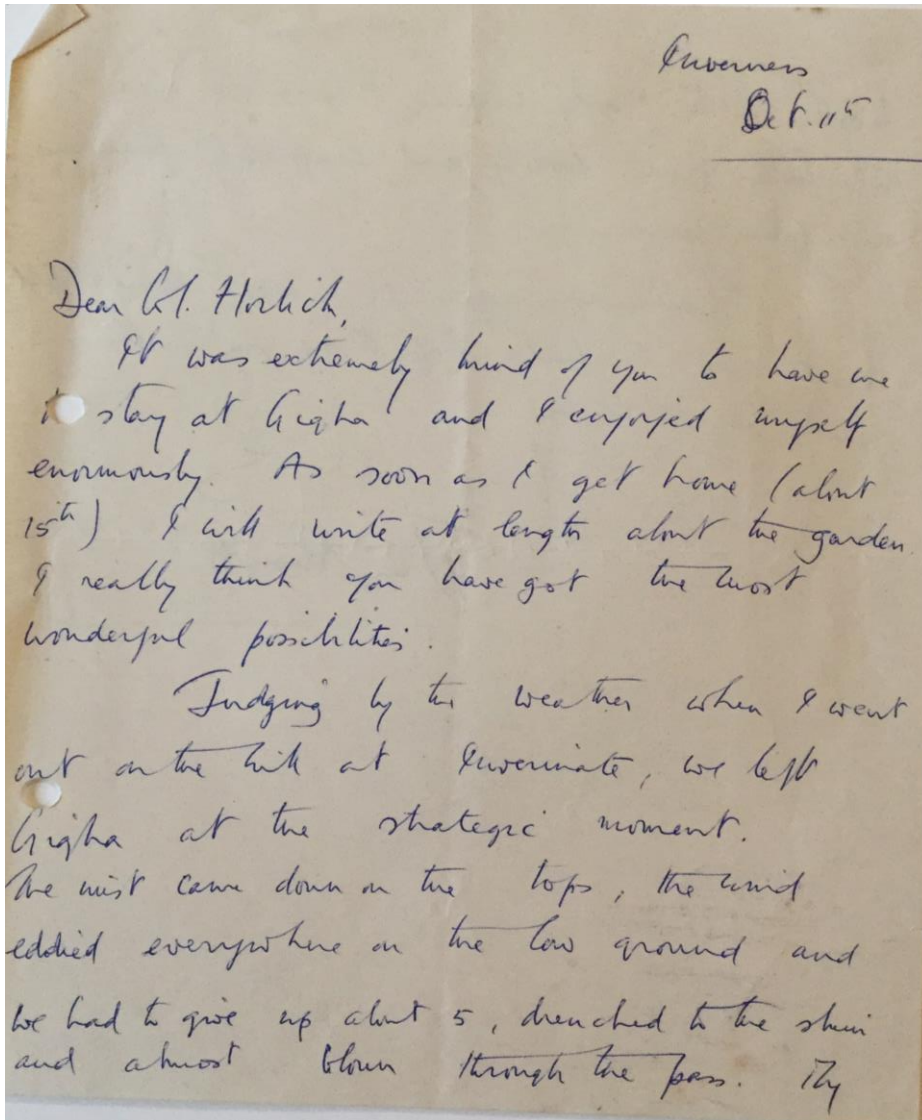

Inverness  
Oct. 11

Dear Col. Horlich,

It was extremely kind of you to have me to stay at Gigha and I enjoyed myself enormously. As soon as I get home (about 15<sup>th</sup>) I will write at length about the garden. I really think you have got the most wonderful possibilities.

Judging by the weather when I went out on the hill at Gowermote, we left Gigha at the strategic moment. The mist came down on the tops, the wind eddied everywhere on the low ground and we had to give up about 5, drenched to the skin and almost blown through the pass. By

Figure 28. Page 1 of letter confirming Russell's visit to Gigha (1952). AGT.

<sup>104</sup> Letter to the Colonel from Russell. Inverness. (11 October 1952). AGT.

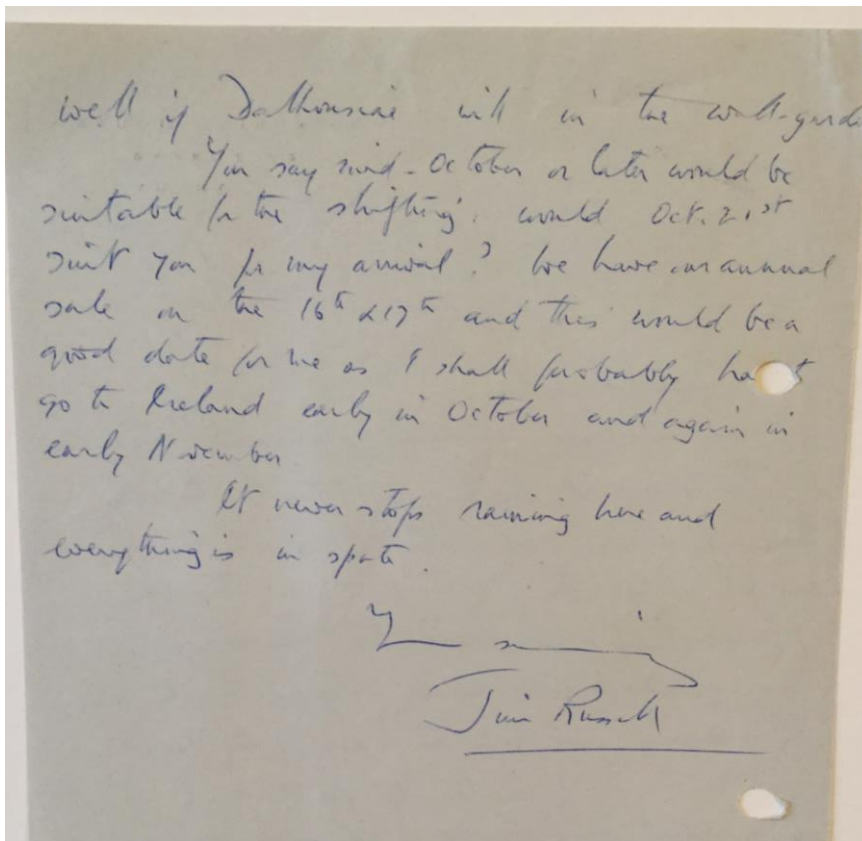

Figure 29. Page 2 of letter. AGT.

In October (1952) Russell sends a letter to the Colonel in which he proposes a planting scheme for the Gardens.<sup>105</sup> The letter commences:

I think it is easiest to consider the garden as looking from the house across the lawn. I am not going at the moment to suggest any plants for which a considerable area needs to be dug except in the case of the rocks which we looked at. The hydrangeas and other plants can quite easily be planted in holes in the woodland and should thrive under these conditions.

---

<sup>105</sup> Letter from Russell to the Colonel. SN. (31 October 1952). Three pages of description plus one plant of suggested plants (quantities and priced at £160.00). Letter in Appendix 4.

It is evident from the letter that the Colonel and Russell have walked together in the Gardens, paused at several strategic spots and discussed suitable plants. In addition, Russell makes suggestions for plants in other locations.

Facing the garden from the top terrace, there is an area to the left in front of the boiler house for which we marked the places for a number of roses. These I enclose a list of and the plants have been despatched ... I feel the whole of this area needs to be linked to continuous planting along the front of the wood. I would suggest a group on either side of the main path of leptospermum.

Crossing the central walk we enter the glade containing Rh. May day. We agreed here that the plants should be remove from the centre which is boggy with rock near the surface and this this area should be planted with Primulas. At the foot of the glade where Rh. May Day is doing so well, I would like to introduce 7 plants of Rh. Hawk v. Jarvis Bay.

The Colonel responds by letter to thank Russell for the suggestions and plants “I cannot answer the whole of it offhand, but in the main I think your suggestions excellent”.<sup>106</sup> However, the Colonel also asserts his own views about the Gardens:

As regards the glade containing May day, I don't think there is the least chance of putting in Rh. Hawk v. Jarvis Bay, the whole place is 'bung' full of May Day and am proposing to put a block here of Stranvesia for protection.

---

<sup>106</sup> Letter from the Colonel to Russell. (16 November 1952). AGT.

The exchange of letters endorses the active interest of the Colonel in his garden and expertise in discussing suitable plants and planting with Russell. Amusingly, this letter from Horlick also suggests a growing friendship with Russell when he shares his frustrations about the rabbits on Gigha, “A something, something rabbit has chewed up a number of my *Euonymus Japonicus* and I am a little bit nervous about the heaths and especially the brooms”.

In 1953 Russell appears to be actively involved in planting the Gardens. In January he explains in a letter to the Colonel, accompanied by a plant list (to Mr Malcom Allan, less £50 plants supplied to us, approx. total £120):

If I can do a certain amount of the planting which we sketched out, the rocks by the gate, the rock in the wood and the area just by the edge of the drive, it would be much less expensive as I shall have two men up there at that period, whereas if I bring them up with me after the Camellia Show, I should have to charge the expenses of their journey, which would be a considerable amount. I think that if this is done, we can decide any alterations quite simply when I come up in April.<sup>107</sup>

Correspondence from Russell (on his personal NC notepaper) prior to the visit sends information to the Colonel about the transportation of the plants to Gigha and also the arrival of the two workmen. Russell’s contact address prior to visiting Gigha is Castle Howard, the estate of another of his elite clients and to where he first retires.<sup>108</sup> After the spring visit to Gigha Russell suggests to the Colonel that:

---

<sup>107</sup> Letter from Russell to the Colonel. SN. (27 January 1953). AGT.

<sup>108</sup> Letter from Russell to the Colonel (17 March 1953). AGT.

If it is any help I will come and move the rhodos and azaleas in the drive in the autumn and I also feel that it would be a good thing to try and get out a detailed plan for the bank behind the wall garden.<sup>109</sup>

In May and June the Colonel and Russell correspond about the plants introduced in the spring by Russell. Several plants have not fared well “I am sorry that so many small heaths have died”, and “The Rhododendron Taronense should be true as it is from the plant which received the award”.<sup>110</sup> In a further letter Russell comments “I will check up on the Rhododendron Taronense, as you say, Exbury do make mistakes”.<sup>111</sup>

In September Russell writes to the Colonel about his visit “I do apologise for not writing long before this to say how much I enjoyed my visit”.<sup>112</sup> This letter includes a list of roses and mentions another visit scheduled for the end of October:

Would it suit you if I were to come back on the evening of Monday October 12<sup>th</sup> to do the moving on the Tuesday and Wednesday, leaving on the morning of the 15<sup>th</sup>. I could leave a good man with you until Tuesday 20<sup>th</sup> or for a little longer if you want him.

---

<sup>109</sup> Letter from Russell to the Colonel. (9 April 1953). AGT.

<sup>110</sup> Letter from Russell to the Colonel. SN. (26 May 1953). AGT.

<sup>111</sup> Letter from Russell to the Colonel. SN. (13 June 1953). AGT.

<sup>112</sup> Letter to the Colonel from Russell. Wellbank, Contachy, Angus. (16 September 1953). AGT.

After his visit, Russell writes to thank the Colonel for hosting him and offers to introduce him to other garden owners (Alfred Beit) and sends news about plants and his journey back home to England.<sup>113</sup>

In 1954 the Colonel travels to Rhodesia and whilst he is away Russell and assistant(s) (number not specified) return to Gigha with more plants for the Gardens.<sup>114</sup> The letter refers to a pond: “The pond appears to be a great success in any case everybody is quite delighted with it, and enormous grins spread across their faces whenever it was mentioned”. Further letters from Russell propose a detailed planting plan for the pond feature (plants to the value of £74.7.3)<sup>115</sup> and a return visit to Gigha whilst the Colonel remains in Rhodesia.<sup>116</sup>

### **Formal Plan for Achamore Gardens 1955**

The correspondence between the Colonel and Russell presented above suggest a growing friendship between the two men. Although the correspondence is predominantly about the purchase and placement of plants at the Gardens, the letters increasingly comment on Russell’s travel commitments, weather and growing conditions, and the Colonel’s deteriorating health. In 1955 plants for the Spring Bank and Bog Garden to the value of £192.18.6 are recommended by Russell to the Colonel.<sup>117</sup> A visit by Russell to Gigha is proposed:

---

<sup>113</sup> Letter to the Colonel from Russell. Longnor Hall, Nr Shrewsbury, Shropshire. (22 October 1953). AGT.

<sup>114</sup> Letter to the Colonel from Russell. SN. (2 February 1954). AGT.

<sup>115</sup> Letter to the Colonel from Russell. SN. (17 February 1954). AGT.

<sup>116</sup> Letter to the Colonel from Russell. SN. Including delivery note for plants. (4 March 1954). AGT.

<sup>117</sup> Letter and plant list from Russell to the Colonel. SN. (31 January 1955). AGT.



As far as planting is concerned I would suggest that I come up myself hoping to arrive about March 16<sup>th</sup> and will bring two men with me. I would suggest that we mark out the areas for the azaleas and I could probably leave the men with you for a week and possibly longer. I will then return when I finish the planting in Ireland which should be immediately after Easter.<sup>118</sup>

A letter after the March visit proposes a visit in May and refers to a formal plan for the Gardens: “If you would like Walter Brugger to make the plan for you I could bring him and leave him with you. He is very quick and capable and knows his plants very well”.<sup>119</sup> Further correspondence notes that “Walter Brugger costs around £20 per week as he is a highly skilled draughtsman and surveyor but he is such a quick worker that I don’t think the plan will be very costly”.<sup>120</sup> Russell writes after his visit to Gigha and refers to a rough drawing of plans for the Gardens. The request in the letter for names of areas of the garden suggests that is the first map to employ names for areas. If a previous garden plan had been prepared the named areas would already be available to Brugger.

I am enclosing a “rough” of Walters Brugger’s plan for you because he is anxious to know what you call the various parts of the garden. He will then colour it and send you the completed design on linen paper. He also suggests that for your plan for visitors he has a photograph taken and printed at the size you want.<sup>121</sup>

---

<sup>118</sup> Letter and plant list from Russell to The Colonel. SN. (21 February 1955). AGT.

<sup>119</sup> Letter from Russell to the Colonel. NC. (5 May 1955). AGT.

<sup>120</sup> Letter from Russell to the Colonel. NC. (2 June 1955). AGT.

<sup>121</sup> Letter from Russell to the Colonel. SN. (17 August 1955). AGT.

Russell and the Colonel agree that Brugger will prepare the plan “I am delighted you are pleased with the plan. I will write to Walter Brugger to-night and send the plan back to him and tell him to get in touch with you direct about coming up to finish it”.<sup>122</sup> Brugger then writes to the Colonel to confirm the plans will be ready by the end of September and arrange a visit to Gigha. (Figure 30). The sequence of letters relates to three plans of the Gardens: a large coloured, unsigned linen backed plan of the Gardens (1955) (Figures 31 and 32) and unsigned visitors plan for the Gardens (1955) (Figure 33) and the Walled Garden (1955) (Figure 34).

It will take me probably 4-5 days to complete the plan, and the plants left behind and the difficult areas are the hill and in the woods will be much better accessible with the big plan. I will write the names you indicated on the original and bring everything with me.<sup>123</sup>

---

<sup>122</sup> Letter to the Colonel from Russell. Shielhill House, by Forfar, Angus. (11 September 1955). AGT.

<sup>123</sup> Letter to the Colonel from Brugger. Onslow Gardens, S.W.7. (15 September 1955). AGT.

60 Ouslow Gardens S.W. 7  
15 September 1955.

Dear Colonel Horlick,

I just received a letter from Jim Russell telling me, that you would like to have the plan completed before the end of this month.

May I suggest to come the 22nd; the plane would arrive at Campbelltown Airport at 12.10. I think I will find my way up the coast and hope to find your boat. If you would like to make another suggestion, please let me know.

It will take me probably 4-5 days to complete the plan, and the plants left behind and the difficult areas on the hill and in the woods will be much better accessible with the big plan. I will write the names you indicated on the original, and bring everything with me.

Jim Russell asked me to meet him in Edinburgh the 29th in the morning.

Yours sincerely  
Walter Brugger.

Figure 30. Letter from Brugger to the Colonel (1955). AGT.

On 29 December Russell writes to the Colonel "I am glad you are pleased with Walter Brugger's plan. I think he does them remarkably well". Russell ends the letter "I have a copy of the Gigha plan up here and will write and send list of shrubs that might look pretty in the wall garden borders, particularly sweet-scented plants such as Philadelphus".<sup>124</sup>

By 1956 Russell sends detailed plans for planting at Gigha (and The Timbers).<sup>125</sup> Although Russell explains in a second letter "I have sent you a fairly hefty quotation but there is about

<sup>124</sup> Letter to the Colonel from Russell. Sheilhill House, by Forfar, Angus. (29 December 1955). AGT.

<sup>125</sup> Letter to the Colonel from Russell. SN. (13 February 1956). Four pages of planting advice, one plan for border at Timbers, plant list and prices for Timbers (£356.3.3) and Gigha (£56.14.6). AGT

£300 to set against plants removed from Gigha”.<sup>126</sup> Russell and Horlick continue to correspond about the gardens at Achamore and Timbers and on his next visit Russell asks Horlick if he may “bring my sister with me? We shall both be staying with Hewey Black just before and it would make a very pleasant little jaunt for her”.<sup>127</sup> The visit is arranged for March and a lorry is sent ahead to take plants to and from Gigha.<sup>128</sup> More plants follow in May (to the value of £322.19).<sup>129</sup> Between 1957 and 1961 Horlick and Russell continue corresponding about the gardens at Achamore, Timbers and at the Horlicks factory, Ascot.<sup>130</sup>

---

<sup>126</sup> Letter to the Colonel from Russell. Royal Hibernian Hotel, Dublin. (18 February 1956). AGT.

<sup>127</sup> Letter from Russell to the Colonel. SN. (6 March 1956). AGT.

<sup>128</sup> Letter from Russell to the Colonel. SN. (13 March 1956). AGT.

<sup>129</sup> Letter and plant list from Russell to the Colonel. (3 May 1956). AGT.

<sup>130</sup> Letters to the Colonel from Russell: 12 letters and visits Gigha March and October (1957); 6 letters and visits Gigha in March and November (1958); 5 letters, 3 invoices and visits in March (1959); 8 letters (1960); one letter (1961). The letters combine plant and planting descriptions, information about people and gardens and anecdotes. AGT.

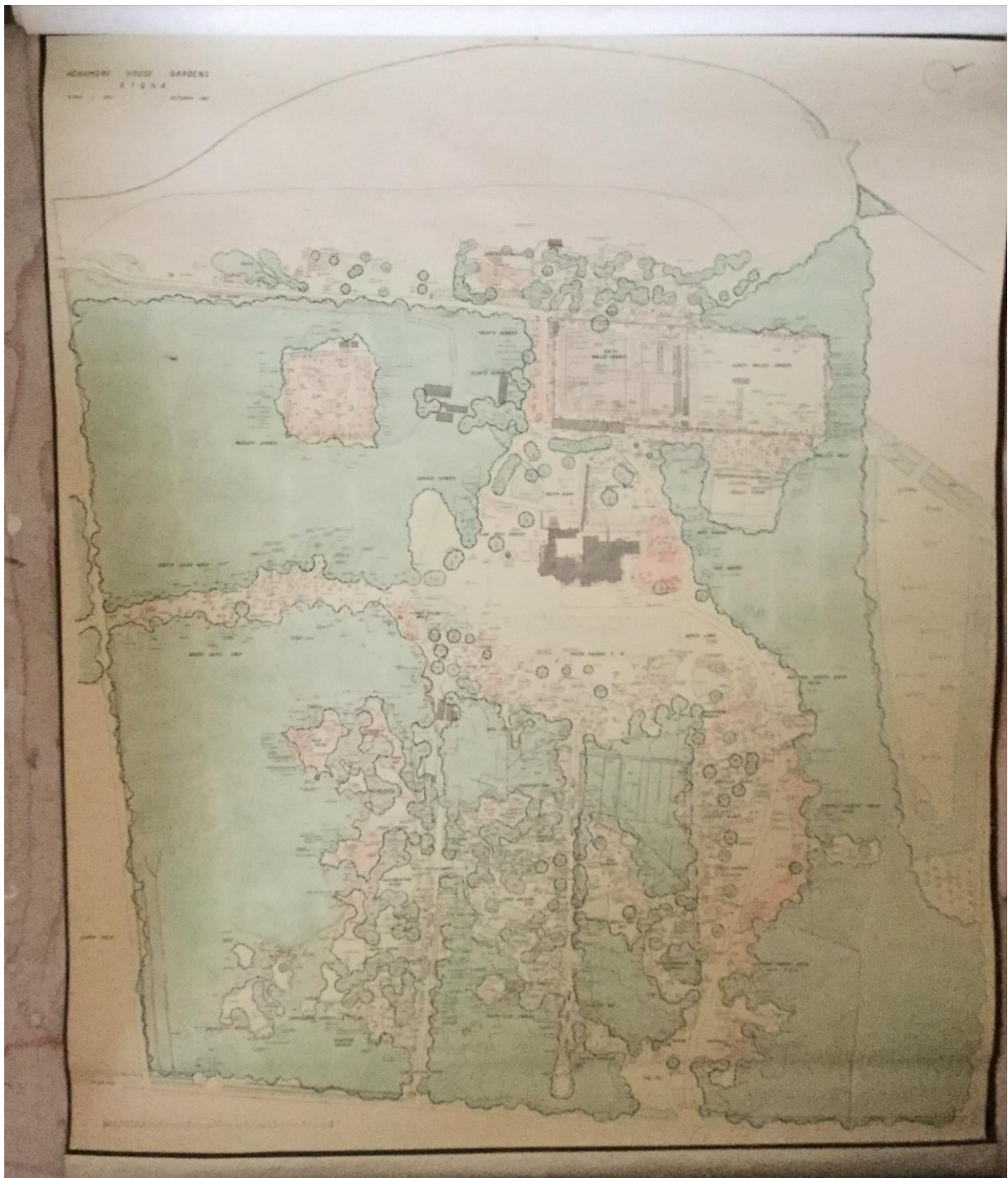

Figure 31. Achamore House Gardens (1955). AGT.



Figure 32. Detail of Walled Garden, South Bank and North Bank (1955). AGT.





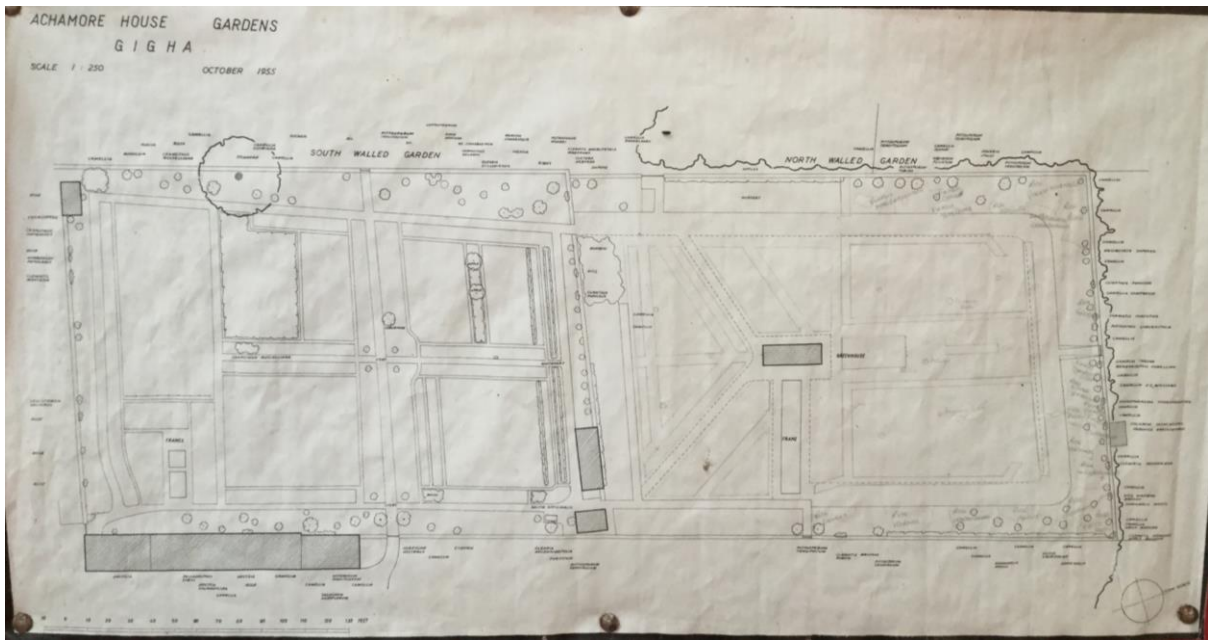

Figure 34. Visitors Plan of the Walled Garden, Achamore House Gardens (1955). AGT.

Further evidence to endorse Russell’s professional involvement in creating the designed landscape at the Gardens can be found in the invoices from SN to the Colonel. Although Russell is said to have developed friendships with his clients rather than business relationships, his manager Thomas took a firmer stance on invoicing clients for services and chasing non-payment. However, it is “quite rare to find any reference to fees paid by clients for Russell’s services”.<sup>131</sup> In the correspondence between SN and Horlick there is evidence that the Colonel paid for services provided by Russell and SN. In 1953 Russell writes “Thank you so much for your letter of May 19<sup>th</sup> and for the cheque on account”.<sup>132</sup> In May 1955 the invoice for plants also specifies costs for delivery, labour and professional fees.<sup>133</sup> (Figure 35)

<sup>131</sup>Legg, *James Russell*, p.vii.

<sup>132</sup> Letter to the Colonel from Russell. SN. (26 May 1953). AGT.

<sup>133</sup> Invoice from SN. (17 May 1955). AGT.



Telephone: Ascot 96 Station: Sunningdale

## THE SUNNINGDALE NURSERIES

**WINDLESHAM**  
**SURREY**

Partners: N. Hamilton-Smith  
Major H. Russell, m.c.  
Manager: J. P. C. Russell

Colonel J.N. Horlick,  
Isle of Gigha,  
Argyll,  
Scotland.

Established 1847

OUR REF. 143

SENT BY Delivered  
TO STATION

DATE 17th May 1955.

DATE	DESCRIPTION	QUANTITY	PRICE	TOTAL
12th April	Cotoneaster Mothschildiana @ 7/6 each	5	2. 5	-
	Cytisus Prascox @ 4/- each	36	7. 4	-
	Beschorneria Yucooides @ 7/6 each	12	4. 10	-
	Callistemon Pallidus @ 7/6 each	6	2. 5	-
	" Sieberi @ 7/6 each	6	2. 5	-
	Leptospermum lanigerum @ 8/6 each	6	2. 11	-
	" blue leaved var. @ 7/6 each	6	2. 5	-
	Cimicifuga Cordifolia @ 2/- each	24	2. 8	-
	" dahurica @ 2/6 each	24	3. -	-
	" ramosa @ 2/- each	24	2. 8	-
	" simplex White Pearl @ 2/- each	60	2. 8	-
	Iris laevigata Rose Queen @ 2/- each	36	6. -	-
	Oncoclea sensibillis @ 3/6 each	6	6. -	-
	Anemone vitifolium robustissima @ 2/6 each	6	15. -	-
	" Albadura @ 2/6 each	6	15. -	-
	" Hupehensis @ 1/6 each	6	9. -	-
	" superba @ 2/6 each	6	15. -	-
	" September Charm @ 2/6 each	6	15. -	-
	" Margaretae @ 2/6 each	6	15. -	-
	Lemonium latifolium violetta @ 3/6 each	12	2. 2	-
	Lobelia Vedarriense @ 3/6 each	12	2. 2	-
	Astilbe Professor van der Wielen @ 2/6 each	36	4. 10	--
	" Granat @ 2/- each	16	1. 12	-
	Kirengeshoma palmata @ 3/6 each	5	17. 6	-
	Lycnis dioica rosea plena @ 2/6 each	24	3. -	-
	Woodwardia radicans @ 25/- each	1	1. 5	-
	Kniphofia Chilcroft @ 5/- each	1	5. -	-
	" Buttercup @ 5/- each	2	10. -	-
	" Underway @ 3/6 each	5	17. 6	-
	Kniphofia Macowani @ 3/6 each	12	2. 2	-
	Azalea Unique @ 15/- each	3	2. 5	-
	" good orange @ 15/- each	20	15. -	-
	" reddish-orange @ 15/- each	4	3. -	-
	" deep orange @ 15/- each	10	7. 10	-
	" Emma @ 15/- each	4	3. -	-
	Rhododendron Formosum 12/15" @ 10/6 each	6	3. 3	-
	" Princess Alice 12/15" @ 10/6 each	6	3. 3	-
	" Maddenii 1 1/2' @ 10/6 each	3	3. 3	-
	" Dalhousiae 9" @ 7/6 each	6	1. 2	6.
	" Burmannicum 12/15" @ 12/6 each	6	3. 15	-
	" sino nuttallii x Lindleyi @ 10/6 each	10	5. 5	-
	Occidentalis and mollis @ 15/- each	165	123. 15	-
	Astilbe Panal @ 2/6 each	44	5. 16	-
	Delivery		67. 10	-
	Labour: 2 men 11/14.4.55.		24. 17	6.
	16/29.3.55.		47. 7	8.
	Professional fees and expenses (Mr. Russell)		39. 11	1.
	Dec. 16-17, 1954 & Mar. 16-19, 1955			
	<i>unaudited a/c</i>		2427. 19	9.

o/f

2427. 19. 9.

PACKING MATERIALS ARE CHARGED AT COST PRICE AND ARE NOT RETURNABLE

Professional fees and expenses (Mr. Russell)

Figure 35. Invoice from SN to the Colonel (1955). AGT.

A letter from Russell shows his discomfort that the financial aspects of the SN business impact on his relationship with Horlick. Russell explains:

First of all I must apologise for the absurd bill which was sent to you (one of the reasons of the troubles, I have had to sack my manager). I can't I'm afraid keep the

costs of the lorry down to £25 these days but it certainly won't be £67.10 and also the amount for fees and expenses is absurd. In any case I enjoy coming to Gigha far too much to charge you any fees and the expenses are nothing like the figure shown. They will send you a proper account shortly.<sup>134</sup>

In 1956 the Colonel receives a letter from Russell informing him that the accounts and counter accounts for the garden will be sent. Although the account is not available, the letter is interesting in that it refers to the fee for Brugger's services:

I am afraid that Walter Brugger's bill has come out at much more than I expected. When I first wrote and said that I reckoned he cost something like £22 per week. I had allowed him spending a fortnight on the plan. He did however go back a second time and put in a great many more plants and draw a smaller plan for the gate, and it totals up in fact from his own vouchers to five weeks work.<sup>135</sup>

In August 1956 Russell proposes to visit Gigha in October to deliver and take away plants.<sup>136</sup> The visit takes place in October and Russell writes to thank the Colonel in November and continue their discussions about plants and planting in the Gardens.<sup>137</sup> In 1957 Russell, now looking after the Colonel's gardens on Gigha and the Timbers, writes to "try and sort out the

---

<sup>134</sup> Letter to the Colonel from Russell. NC. (2 June 1955). AGT.

<sup>135</sup> Letter to the Colonel from Russell. SN. (18 June 1956). AGT.

<sup>136</sup> Letter to the Colonel from Russell. SN. (26 August 1956). "Would mid-October suit you for the upheaving? Would you like me to bring 2 men up? We could perhaps upheave and place and Malcom and his men could plant?" AGT.

<sup>137</sup> Between 27 August and 16 November 1956 Russell sends 6 letters to The Colonel. AGT.

various quotations which I have sent you from time to time".<sup>138</sup> Between 1958 and 1960 six invoices are sent from Russell to the Colonel for professional services.<sup>139</sup> (Figures 36 and 37)

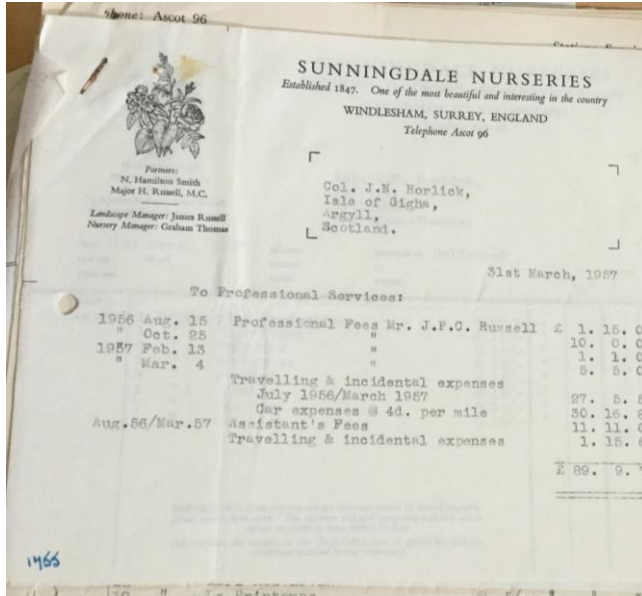

Figure 36. Invoice (1957). AGT.

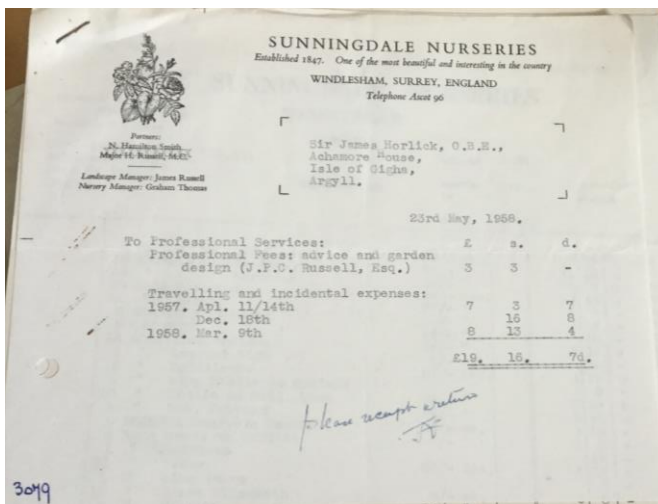

Figure 37. Invoice (1958). AGT.

<sup>138</sup> Letter to the Colonel from Russell. SN. (28 February 1957). AGT.

<sup>139</sup> Invoices from SN to the Colonel. £89.9.7 (31 March 1957); £19.6.7 (23 May 1958); £11.2.2 (12 March 1959), £20.10.6 (9 April 1959), £4.19.0 (31 May 1959), and £13.9.0 (2 December 1959). AGT.

## **The Designed Landscape at the Gardens**

The primary data presented in this chapter offers robust evidence that although the design and planting of the Gardens have traditionally been attributed to Lloyd-Jones, the designed landscape is more accurately attributed to James Russell, with input from the Colonel. The letters and invoices attest to the involvement of Russell in arranging for the plans to be prepared, as well as his visits to Gigha to oversee the planting. A letter from the Colonel to Russell (excerpts of which are presented below) further endorses the friendship between them and the attribution of the Gardens to Russell:

First of all, many congratulations on your new Rhododendron Catalogue which I think is an excellent compilation and a very complete one ... I feel that I must write and tell you what a tremendous success the garden here had this year. In spite of being very much knocked about by almost two months of severe easterly winds, and one south westerly gale at Easter time which destroyed much of the young growth of Prunus' etc it really has put up a most magnificent show. Everyone on the cruise was enchanted with it and it was no use telling them that it was very much better the week before. ... Several people told me that it was the best laid out and kept garden in the whole of Scotland, and I do wish you had seen it this year ... I thought you would like to know all this. The garden owes so much to you. I should like you to see it again so do come up if you possibly can for a day or so ... Bring Jane with you when you come up. Best love from us both. Yours ever.<sup>140</sup>

---

<sup>140</sup> Letter from the Colonel to Russell. (21 May 1960). AGT.

## **Conclusion**

In 1960 the Colonel, aged 74 and concerned about the future of the Gardens, began a correspondence about the future of the Gardens with the NTS for Scotland. In 1961 the Colonel was awarded the RHS Loder Rhododendron Cup, and a final letter from Russell to the Colonel in the same year promises another visit to Gigha laden with plants for the Gardens.<sup>141</sup> The Colonel died at his home in Gigha in 1972 and is buried in the island's cemetery. The next chapter examines how community ownership of the Gardens influences garden conservation and use.

---

<sup>141</sup> Letter from Russell to the Colonel. (21 March 1961). AGT.

## Chapter 5 Achamore Community Gardens

### Introduction

The years between 1944 and 1972 during which Gigha was owned by the Colonel have been described by islanders as the “golden years”.<sup>142</sup> After his death in 1972 Gigha was sold to D.W.N Landale, then Malcom Poitier (1989) and Derek Holt. In 2002 the community bought Gigha and this chapter examines how community garden ownership influences garden conservation and use.

### Gigha Community Buy Out

The community buyout of Gigha came after the purchase of the North Lochinver Estate by the Assynt Crofters Trust (1993), the community purchase of Eigg (1997), Knoydart Peninsula (1999),<sup>143</sup> North Harris (2003) and South Uist (2006).<sup>144</sup> The IGHT assumed ownership of Gigha in March 2002. To pay back part of the loan the House was sold and IGHT retained ownership of the Gardens. The rationale for retaining community ownership of the Gardens was that the many visitors to the Gardens generated an important source of income for their conservation, and also that the community had become used to enjoying access to the Gardens and a new private owner might withdraw this freedom of use.<sup>145</sup>

### Community Owned Gardens

---

<sup>142</sup> Interviews with Alastair McNeil and Amy Wilson (June 2017).

<sup>143</sup> McMarron et al., ‘Reconstructing sustainability’.

<sup>144</sup> Mackenzie, *Places of Possibility*. M. Satsangi, ‘Community land ownership, housing and sustainable development’, *Planning Practice Research*, 24(2) (2009), pp. 251-262.

<sup>145</sup> Interview with Amy Wilson (June 2017).

Community owned gardens are used by people to grow food, flowers and foster strong community relationships<sup>146</sup> and where people play a significant role in community development activities in relation to the production of place and the creation of social networks.<sup>147</sup> Community gardens also benefit the psychological and social wellbeing of the community.<sup>148</sup> In these ways community owned gardens are much more than sites where gardening takes place - they are places for individual, social and cultural transformation.<sup>149</sup>

Community gardens in the UK can be traced back to enclosure of British common land in the 18<sup>th</sup> century. This led to the development of allotments as a form of resistance to the enclosure of land that was formerly owned in common. The Allotments Act 1887 compensated the displaced commoners by providing land, at peppercorn rent, on which to grow food.<sup>150</sup> From this perspective, community owned gardens are framed as part of a long line of defenders of community commons, self-help and empowerment.<sup>151</sup> Community owned gardens have also been framed as proactive, virtuous, grassroots responses to an external threat or crisis.<sup>152</sup> The community buy out of Gigha, and the community ownership of the

---

<sup>146</sup>D. Armstrong, 'A survey of community gardens in upstate New York: Implications for health promotion and community development', *Health & Place*, 6 (2000), pp. 319-327.

<sup>147</sup>C. Firth, D. Maye and D. Pearson, 'Developing "community" in community gardens', *The International Journal of Justice and Sustainability*, 16 (2011), pp. 555-568.

<sup>148</sup>R. Kaplan, 'Some psychological benefits of gardening', *Environment and Behavior*, 5 (1973), pp.145-161. M.A. Mc Bey, 'The therapeutic aspects of gardens and gardening: An aspect of total patient care', *Journal of Advanced Nursing*, 10 (1985), pp. 591-595.

<sup>149</sup>Pudup, 'It takes a garden'.

<sup>150</sup>Nettle, *Community Gardening as Social Action*.

<sup>151</sup>S. Warner, *To Dwell is to Garden. A History of Boston's Community Gardens* (Northeastern University Press, 1987).

<sup>152</sup>A. Bentley, *Eating for Victory: Food Rationing and the Politics of Domesticity* (University of Illinois Press, 1988). M. Von Hassell, *The Struggle for Eden. Community Gardens in New York City* (Bergin and Garvey, 2002).

Gardens, epitomises the social and cultural changes ushered in by 21<sup>st</sup> century Scottish land reform.

Community owned gardens are also idiosyncratic and vary considerably ranging from small pockets of land looked after by a handful of dedicated gardeners to community gardens visited by thousands of visitors each year and venues for multiple activities.<sup>153</sup> Of interest here is how community ownership of the Gardens has influenced garden conservation and use. The land ownership arrangement is however complicated by the donation of the rhododendron collection to the NTS.

### **The National Trust for Scotland**

An early reference to the NTS is made in 1953 when the Colonel mentions “The plants lifted extremely well and are a very handsome lot, the National Trust should be extremely pleased with them”.<sup>154</sup> Although the specific destination of the plants is not noted, the subsequent negotiations between the Colonel and the NTS note giving plants to Brodick. In 1960 Sir George Campbell visits Gigha to appraise the Gardens and send a confidential report to the NTS.<sup>155</sup>

What has been done at Gigha is a wonderful accomplishment by an extremely competent gardener and plantsman, whose knowledge of plants and their particular requirements is on the highest plane ... It is fair to say that the

---

<sup>153</sup>Kurtz, ‘Differentiating multiple meaning’. Firth et al., ‘Developing “community” in community gardens’. Nettle, *Community Gardening as Social Action*.

<sup>154</sup> Letter from Russell to the Colonel. (17 February 1953). AGT.

<sup>155</sup> Sir George Campbell of Succoth, Bart., D.L., J.P., Crarae Lodge, by Inveraray, Argyll.



Gigha Garden – (if) it is to be maintained in its present state – will always be expensive – grass cutting – drainage maintenance – subsidiary shelter must be continuing ... I would say that the Gigha Garden – and I think experts in the gardening world (and I am no expert) would agree if asked, that it is worthy of preservation.<sup>156</sup>

Correspondence between the NTS and Lady Horlick between 1960 and 1962 considers how the plant collection could be maintained and developed. The NTS is interested in the Gardens (not the House) and estimates that 5 gardeners (plus accommodation) would be needed and that this would require a capital fund of £60 000. The NTS is enthusiastic and comments that “With the Colonel, with you and with John of course one can see this as nothing but a grand adventure for the Trust”.<sup>157</sup> In 1961 the suggestion was made by James Stormonth Darling (NTS secretary) “to look upon the collection of plants as something separable from the gardens and certainly the house”, and that £50 000 be donated by the Colonel to “maintain the collection whether that collection remain at Gigha or be removed”.<sup>158</sup>

The plant collection at the Gardens together with an annual endowment of £25 000 (The Horlick Garden Fund) for future maintenance was gifted to the NTS. The aim of the gift was to make the Gardens available for “full public enjoyment”.<sup>159</sup> Many rhododendrons from the Gardens were also sent to Brodick, Culzean and Iverewe.<sup>160</sup>

---

<sup>156</sup> Confidential report of Sir George Campbell’s reactions – Gigha – as requested. (18 October 1960). AGT.

<sup>157</sup> Letter to Lady Horlick from NTS. (14 November 1960). AGT

<sup>158</sup> Strictly Confidential note by Stormonth Darling. (20 June 1961). AGT.

<sup>159</sup> Letter from Stormonth Darling to the Colonel. (10 August 1961). AGT.

<sup>160</sup> The NTS was established in 1931 when it was proposed that Scotland should have its own body to hold land for the public good. Primarily a land-owning institution, the NTS also has care rights for buildings of historic

## **Achamore Community Gardens**

The IGHT commissioned a conservation and development plan for the designed landscape of the Gardens and the final report (2005) confirmed the Gardens to be a designed landscape of national importance.<sup>161</sup> In 2016 Achamore Gardens Trust (AGT) was established to manage the gardens, lead their restoration, and facilitate participation, engagement and regeneration.<sup>162</sup> The influence of community ownership on the Gardens is manifest in three principle activities. First, the community is involved in deciding on how the Gardens will be conserved and used. The AGT board comprises residents from Gigha and open meetings are held to decide on how to best conserve the Gardens. While some visitors are enchanted by the wild yet tranquil Gardens, other visitors would prefer to see greater attention to grass cutting, weeding and woodland management.<sup>163</sup> Lack of funds has limited the employment of professionally qualified gardeners and members of the community are actively involved in trying to protect and conserve the plants, paths, pond and other features in the Gardens. Figures 38 to 43 show the Gardens (Author, June 2017).

---

importance. The increasing costs of land ownership however, meant that acquisition of assets was becoming beyond the scope of most charitable bodies without some form of financial support. Clough, *Isle of Gigha*.

<sup>161</sup> <http://www.gigha.org.uk/gardens/AchamoreProject.php> Accessed 1 August 2017.

<sup>162</sup> <http://www.gigha.org.uk/viewItem.php?id=8845&sectionTitle=Attractions> Accessed 1 August 2017.

<sup>163</sup> Interview with Amy Wilson (June 2017).

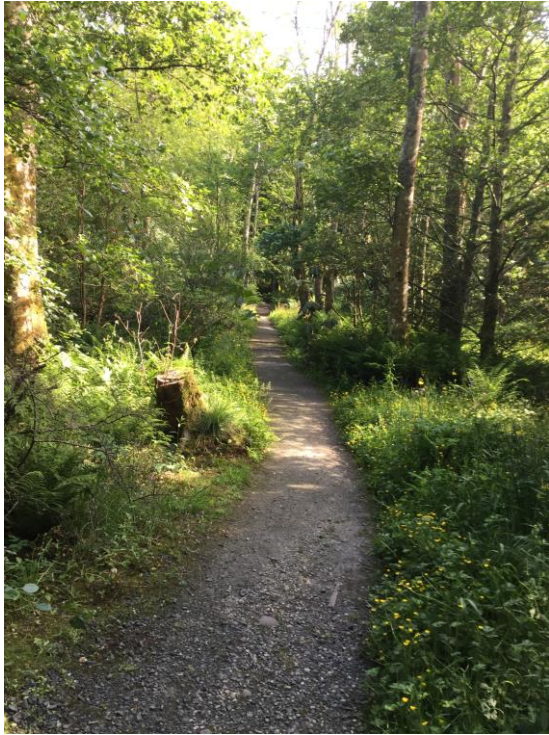

Figure 38. Approach to the Gardens.



Figure 39. New Pond Garden.





Figure 40. Azalea Woods.



Figure 41. Theatre Garden.



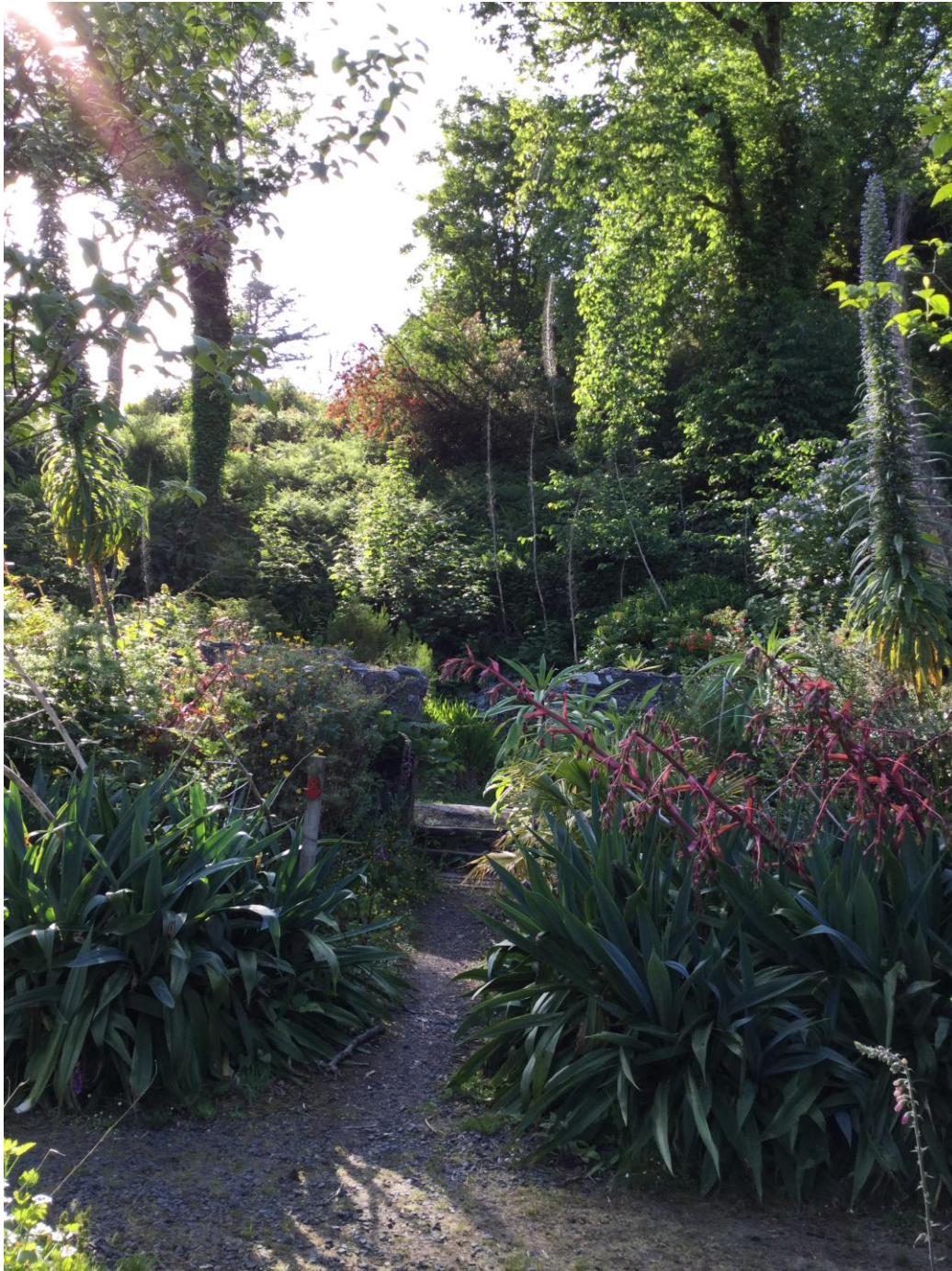

Figure 42. North Walled Garden.





Figure 43. Malcom Allan Garden.

Second, the management of a volunteer gardener programme. The volunteer programme comprises drop in morning and afternoon sessions, family group sessions and camping-volunteer experiences.<sup>164</sup> Volunteer groups are invited to camp in the Gardens, usually for one week at a time, and to attend to specific areas that need the most urgent attention. The AGT plans include providing accommodation for gardeners.

Third, the Gardens are used to benefit the community, e.g., outdoor learning for children from Gigha primary school, for hosting garden theatre and music events, and providing flowers and honey to the community owned hotel. The Gardens also generate income from visitors and feature on the Discover Scottish Gardens programme managed by Visit Scotland.

---

<sup>164</sup><http://discoverscottishgardens.org/garden/achamore-gardens-2/> Accessed 1 August 2017.

## **Conclusion**

This chapter has analysed community ownership of the Gardens and the establishment of the AGT and in doing so has completed the chronology and analytical account of the Gardens. Community ownership heralds a new era in the Gardens in which the community, and not private owners, are responsible for how the Gardens are conserved and used. Community ownership has also strengthened the connections between the Gardens and the residents of Gigha to ensure that the Gardens continue to be available for “full public enjoyment”.<sup>165</sup>

---

<sup>165</sup> Stormonth Darling. (10 August 1961). AGT.

## Chapter 6 Conclusion

### Contributions

The dissertation presents the first chronological and analytical account of the creation of Achamore Gardens. Secondary and primary data was analysed to develop a timeline of ownership and creation of the garden from the 19<sup>th</sup> to the 21<sup>st</sup> centuries. Commencing with the purchase of the island by the Scarlett family, the different owners and their influences on the Gardens are mapped out in a chronology of the Gardens.

The second contribution is the examination of the roles of Kitty Lloyd Jones and James Russell on the designed landscape at the Gardens. Prior to the analysis presented in this dissertation the design of the Gardens had been attributed to Lloyd-Jones. From my analysis of the primary data owned by AGT I present evidence that the designed landscape of the Gardens is attributable to Russell.

The third contribution is to explicate the relationship between land ownership and garden creation, conservation and use. When the Gardens were owned by the Scarlett family, with the exception of the formal drives and pathways, they were primarily for providing ground cover for game hunting. Hunting was a pastime of the aristocracy and community use of the Gardens would have been restricted to labouring. The Colonel created a “paradise garden”<sup>166</sup> in which plants from around the world, especially rhododendrons, were acquired and conserved. During this period island residents were employed as gardeners and the primary school children were invited into the gardens on sports day. The Colonel invited guests to

---

<sup>166</sup> Hellyer, ‘Great British garden makers’.



visit the Gardens and in the 1960s tourists were received by arrangement. More recently the Gardens have come into community ownership and are now used for the benefit of the community and the prosperity of Gigha.

### **Suggestions for Further Research**

The dissertation has analysed a small part of the Gardens archive and several future suggestions research would be possible from the large volume of resources that remain unexplored.

The Gardens archive dates from the early years of the 20<sup>th</sup> century and many documents and photographs relate to the management of the Titness Estate and Little Paddocks. The Estate Log Book records in detail all expenditure at Little Paddocks, of particular interest to garden historians are the purchases of plants and payments to garden staff. Many of the entries can be cross referenced to the invoices from nurseries. Future research to develop the history of the Titness Estate and Little Paddocks would advance knowledge about two little known English gardens.

The Gardens archive contains more than 3 000 photographic slides that date from approximately 1945 to late 1960s. The images are of the Gardens, the Colonel's visits to other gardens, and his international travel. Several of the slides have been included in this dissertation however, a large number remain unused. Each of the slides been labelled, usually with the site and date however, they have not been filed in date order. Future research possibilities include creating a yearly account of the progression of the garden from the 1955 Russell plan to maturity; and analysing the exotic plants on the Gardens.

The Colonel pursued his passion for collecting and breeding rhododendrons and created 48 rhododendron cultivars of which 26 grow in the Gardens. The Colonel was awarded the RHS Victoria Medal of Honour in 1963 for rhododendron cultivation. The archive comprises correspondence between the Colonel and the RHS and some information relating to parentage of rhododendron crosses. The texts in the archive provide information which could be analysed to provide a detailed account of the development of the Horlick hybrids.

Finally, community gardens are increasingly recognised as important sites for promoting community building, conservation, and ecological awareness. The recently formed AGT is tasked with protecting the Gardens at the same time as initiating new projects to bring the community on Gigha together and regenerate the Gardens. Further research that examined the challenges of creating and managing community gardens, as well as their social, cultural, ecological and ethical significance would shed light on this increasingly important category of gardens.

## **Primary Sources**

M. Martin. 1703. The Isle of Gigha.

Knight Frank and Rutley. Sales particulars for Gigha. (1911)

List of plants headed "Bought from Sunningdale Nursery (sale). H. Wight (HW). (18 and 19 October 1939)

Little Paddocks Estate Book (1938-1940)

The Wall Garden at Gigha. (July 1952)

J.P.C. Russell and S. Sitwell. 1955. *Old Garden Roses. Part 1.*

J.P.C Russell and W. Blunt. 1955. *Old Garden Roses. Part 2.*

J.P.C. Russell. 1960. *Rhododendrons at Sunningdale.*

Confidential report by Sir George Campbell. (18 October 1960)

Colonel Horlick. 'Growing camellias of the south west coast of Scotland'. (1964)

Colonel Horlick. 'The making of Gigha Garden'. (30 March 1964)

## **Letters**

### **1937**

Letter from H. White to Lt Col. J. Horlick, Ardwenikie, Kinloch Laggan, Nr Kingussie, SN. (10 August 1937)

Letter from the Colonel to Messrs. H. White. (13 August 1937)

### **1940**

Letter to the Colonel from Russell. NC. (17 August 1940)

Note of order placed by The Colonel with SN for 137 plants for £20. (23 September 1940)

Letter confirmation of order for 7 rhododendrons with SN. (5 May 1940)

Letter from SN to the Colonel, Little Paddocks. (22 October, 1940)

### **1942**

Letter from the Colonel to Mr J R Taylor, Lily Hill Nursery, Bracknell. (30 November 1942)

Letter to the Colonel from the Rhododendron Association. (16 December 1942)

Letter from Rhododendron Association to the Colonel. (29 December 1942)

**1943**

Quarterly Account to the Colonel. SN. (16 April 1943)

Letter from the Colonel to Campbell, Auchindoune, Cawdor, Nairn. (16 November, 1943)

**1944**

Quarterly Account to the Colonel. SN. (15 April 1944)

**1948**

Delivery note for plants. Wm Bates, Winnersh Nurseries. (17 October 1948)

**1949**

Letter to the Colonel from Russell. SN. (5 August 1949)

**1951**

Letter from the Colonel to SN. (2 November 1951)

**1952**

Letter to the Colonel from Russell. SN. (31 May 1952)

Letter from Russell to the Colonel. SN. (18 July 1952)

Letter to the Colonel from Russell. NC. (19 July 1952)

Letter to the Colonel from Russell. Crathes Castle, Crathes, Kincardineshire. (13 August 1952)

Letter to the Colonel from Russell. Wellbank Cottage, Cortacky, Angus. (25 September 1952)

Letter to the Colonel from Russell. Inverness. (11 October 1952)

Letter from Russell to the Colonel. SN. (31 October 1952)

Letter from the Colonel to Russell. (16 November 1952)

**1953**

Letter from Russell to the Colonel. SN. (27 January 1953)

Letter from Russell to the Colonel. (17 February 1953)

Letter from Russell to the Colonel. SN. (24 February 1953)

Letter from Russell to the Colonel. (17 March 1953)

Letter from Russell to the Colonel. (9 April 1953)

Letter from Russell to the Colonel. SN. (26 May 1953)

Letter to the Colonel from Russell. SN. (26 May 1953)

Letter from Russell to the Colonel. SN. (13 June 1953)

Letter to the Colonel from Russell. Wellbank, Contachy, Angus. (16 September 1953)

Letter to the Colonel from Russell. Longnor Hall, Nr Shrewsbury, Shropshire. (22 October 1953)

## **1954**

Letter to the Colonel from Russell. SN. (2 February 1954)

Letter to the Colonel from Russell. SN. (17 February 1954)

Letter to the Colonel from Russell. SN. Including delivery note for plants. (4 March 1954)

Letter from Russell to the Colonel. SN. (24 June 1954)

## **1955**

Letter and plant list from Russell to the Colonel. SN. (31 January 1955)

Letter and plant list from Russell to The Colonel. SN. (21 February 1955)

Letter from Russell to the Colonel. NC. (5 May 1955)

Invoice from SN. (17 May 1955)

Letter from Russell to the Colonel. NC. (2 June 1955)

Letter to the Colonel from Russell. NC. (2 June 1955)

Letter from Russell to the Colonel. SN. (17 August 1955)

Letter to the Colonel from Russell. Shielhill House, by Forfar, Angus. (11 September 1955)

Letter to the Colonel from Brugger. Onslow Gardens, S.W.7. (15 September 1955)

## **1956**

Letter from Russell to Horlick. (13 February 1956)

Letter to the Colonel from Russell. SN. (13 February 1956)

Letter to the Colonel from Russell. Royal Hibernian Hotel, Dublin. (18 February 1956)

Letter from Russell to the Colonel. SN. (6 March 1956)

Letter from Russell to the Colonel. SN. (13 March 1956)

Letter and plant list from Russell to the Colonel. (3 May 1956)

Letter to the Colonel from Russell. SN. (18 June 1956)

Letter to the Colonel from Russell. SN. (26 August 1956)

Between 27 August and 16 November Russell sends 6 letters to the Colonel. (1956)

### **1957**

Letter from Russell to the Colonel. (6 February 1957)

Letter to the Colonel from Russell. SN. (28 February 1957)

Letters to the Colonel from Russell: 12 letters and visits Gigha March and October. (1957)

Invoices from SN to the Colonel. £89.9.7. (31 March 1957)

### **1958**

Letters to the Colonel from Russell 6 letters and visits Gigha in March and November. (1958)

Invoice from SN to the Colonel. £19.6.7. (23 May 1958)

### **1959**

Letters to the Colonel from Russell 5 letters, 3 invoices and visits. (March 1959)

Invoice from SN to the Colonel. £11.2.2. (12 March 1959)

Invoice from SN to the Colonel. £20.10.6. (9 April 1959)

Invoice from SN to the Colonel. £4.19.0. (31 May 1959)

Invoice from SN to the Colonel. £13.9.0. (2 December 1959)

### **1960**

Letter from the Colonel to Russell. (9 May 1960)

Letter from the Colonel to Russell. (21 May 1960)

Letter from Russell to the Colonel. NC. (21 August, 1960)

Letters to the Colonel from Russell 8 letters. (1960)

Letter to Lady Horlick from NTS. (14 November 1960).

## 1961

Letter to the Colonel from Russell. (1961)

Letter from Russell to the Colonel. (21 March 1961)

<sup>1</sup> Strictly Confidential note by J. Stormonth Darling. (20 June 1961)

Letter from J. Stormonth Darling to the Colonel. (10 August 1961)

## Maps

J. Cowley and R.W. Seale. 1734. A new map of North Britain and the Islands there belong. Scotland. <http://maps.nls.uk/scotland/rec/166>

J. Jansson. 1659. Lorna, Knapdalia, Cantire, Jura, Ila, Glota et Buthe insulae. <http://maps.nls.uk/scotland/rec/138>

W.H. Lizars. 1822. Map of the Highlands of Scotland denoting the districts or counties inhabited by the Highland clans. <http://maps.nls.uk/scotland/rec/864>

A. Ortelius. Scotia tabula. 1580. <http://maps.nls.uk/scotland/rec/128>

Ordnance Survey. Kintyre North. OS Explorer Map 357.

Ordnance Survey one inch to the mile first edition. 1856-1891. Maps of Scotland. Sheet 20. Killean. <http://maps.nls.uk/view/74488605>

Ordnance Survey. Second edition. 1885-1890. One inch to the mile maps of Scotland. Sheet 20. <http://maps.nls.uk/view/74488606>

Ordnance Survey. First edition. *Name Book* (1868-1878). <http://maps.nls.uk>

J. Sudbury and G. Humbell. 1610/1629. The Kingdome of Scotlande performed by John Speed. <http://maps.nls.uk/scotland/rec/134>

J. Thompson and W. Johnstone. 1824. John Thomson's Atlas of Scotland 1832. 1824 Northern part of Argyll Shire, Southern Part. Bottom section. <http://maps.nls.uk/atlas/thomson/506.html>

## Plans

Plan for Achamore House. Walker and Harwood, 21 Suffolk Street, SW1 (1947)

Achamore House Gardens (1955)



Visitors Plan for Achamore House Gardens (1955)

Visitors Plan of the Walled Garden, Achamore Gardens (1955)

### **Acts of Parliament**

Land Reform (Scotland) Act. 2003.

The Black Act. 1723.

The Night Poaching Act. 1828.

The Game Act. 1831.

### **Secondary Sources**

Bentley, A., *Eating for Victory: Food Rationing and the Politics of Domesticity*. (University of Illinois Press, 1998).

Clough, P., *Isle of Gigha. Achamore Garden* (National Trust for Scotland, 1970).

Czerkawksa, C., *The Way it Was. The History of Gigha* (Birlinn, 2016).

Hunter, J., *The Making of a Crofting Community* (John Donald, 1976).

Hunter, J., *From the Low Tide of the Sea to the Highest Mountain Tops. Community Ownership of Land in the Highlands and Islands of Scotland* (Islands Book Trust, 2012).

Legg, K., *James Russell. The Archive of James Russell, Garden Designer, Deposited at the Borthwick Institute, University of York* (University of York, 2003).

Lloyd-Jones, K., Reprint. *The Modern Flower Garden. 2. The Herbaceous Border – with Chapters on Planning and Arrangement* (Read Books Ltd, 2013)

Mackenzie, F., *Places of Possibility. Property, Nature and Community Land Ownership* (Wiley Blackwell, 2014).

Nettle, C., *Community Gardening as Social Action* (Ashgate, 2014)

Ostrom, E., *Governing the Commons*. Cambridge (University Press, 1990).

*Oxford Dictionary of Phrase and Fable* (Oxford University Press, 2006).

Von Hassell, M., *The Struggle for Eden. Community Gardens in New York City*. Bergin and Garvey, 2002).

Uglow, J., *A Little History of British Gardening* (Chatto and Windus, 2004).

Warner, S., *To Dwell is to Garden. A History of Boston's Community Gardens* (Northeastern University Press, 1987)

Wightman, A., *Who Owns Scotland* (Canongate, 1997).

Wightman, A., *The Poor had no Lawyers. Who owns Scotland (and how they got it)*. Birlinn, 2010).

### **Journal Articles**

Armstrong, D., 'A survey of community gardens in upstate New York: Implications for health promotion and community development', *Health & Place*, 6 (2000), 319-327.

Atkinson, J., 'The seeds of change: The new place of gardens in contemporary Utopia', *Utopian Studies*, 18 (2007), pp.237-260.

Berger, R., 'Kitty Lloyd-Jones. Lady gardener and nursery woman', *Garden History*, 25(1997), pp.107-116.

Calhoun, C., 'Community: Toward a variable conceptualization for comparative research', *Social History*, 5 (1980), pp. 105-129.

Croft, T.A., 'Conservation charity land ownership in Scotland', *Scottish Geographical Journal*, 120 (2004), pp.71-82.

Firth, C., D. Maye and D. Pearson, 'Developing "community" in community gardens', *The International Journal of Justice and Sustainability*, 16 (2011), pp.555-568.

Ghose, R. and M. Pettygrove, 'Actors and networks in urban community garden development', *Geoforum*, 53 (2014), pp.93-103.

Hellyer, A. 2010., 'Great British garden makers: James Russell 1920-1996', *Country Life*, March 20.

Hoffman. M., 'Why community ownership? Understanding land reform in Scotland', *Land Use Policy*, 31 (2013), pp.289-297.

Jarvie, G. and L. Jackson, 'Deer forests, sporting estates and the aristocracy.' *The Sports Historian*, 18(1998), pp.24-54.

Kaplan, R., 'Some psychological benefits of gardening', *Environment and Behavior*, 5 (1973), pp.145-161.

Kurtz, H., 'Differentiating multiple meanings of garden and community', *Urban Geography*, 22 (2001), pp. 656-670.

Mc Bey, M.A., 'The therapeutic aspects of gardens and gardening: An aspect of total patient care', *Journal of Advanced Nursing*, 10 (1985), pp. 591-595.

McMorran, R., A.J. Scott, & M.F. Price, 'Reconstructing sustainability: participant experiences of community land tenure in North West Scotland', *Journal of Rural Studies*, 33 (2014), pp. 20-31.

McMorran, R., A.J. Scott and M.F. Price, 'Reconstructing sustainability: Community land ownership in the Outer Hebrides, Scotland', *International Journal of the Commons*, 4 (2014), pp.319-344.

Pudup, M.B., 'It takes a garden: Cultivating citizen-subjects in organized garden projects', *Geoforum* 39 (2008), pp. 1228-1240.

Rose, G., 'Imagining Poplar in the 1920s: Contested concepts of community', *Journal of Historical Geography*, 16 (1990), pp. 425-437.

Satsangi, M., 'Community land ownership, housing and sustainable development', *Planning Practice Research*, 24 (2009), pp. 251-262.

Speer, P.W. and J. Hughey, 'Community organizing: An ecological route to empowerment and power', *American Journal of Community Psychology*, 23 (1995), pp. 729-748.

Zimmerman, M.A. and J. Rappaport, 'Citizen participation, perceived control and psychological empowerment', *American Journal of Community Psychology*, 16 (1988), pp. 725-750.

## **Reports**

Higgins, P., L. Jackson and G. Jarvie, *Deer Forests, Sporting estates and the Aristocracy. Some Preliminary Observations* (Scottish Centre Research papers in Sport, Leisure and Society, 1997).

*Historic Environment Scotland Gardens and Designed Landscape Inventory* (1989).

## **Websites**

[www.countrylife.co.uk](http://www.countrylife.co.uk)

<http://discoverscottishgardens.org/garden/achamore-gardens-2/>

<http://www.gigha.org.uk/gardens/AchamoreProject.php>

<http://www.gigha.org.uk/viewItem.php?id=8845&sectionTitle=Attractions>

<http://www.gov.scot/Topics/farmingrural/Rural/rural-land/right-to-buy/Community>

<http://www.parksandgardens.org/places-and-people/site/31/history>

[www.savills.co.uk](http://www.savills.co.uk)

<http://www.tate.org.uk/art/artworks/bateman-highland-scene-t03210>

Appendix 1: List of Named Gardens

Athlone Bay	Hospital Garden	Spring Drive
Ash Garden	House Garden	Sitca Garden
Azalea Woods	Hugh's Border	South Bank
Beech Tree Garden	Islay's Border	South East Garden
Beech Lawns	Leo Garden	South Garden
Blue Tit Ridge	Lime Tree Garden	South Walled Garden
Bog Garden	Loderii Garden	Spring Bank
Brocade Garden	Lower Fulvern	Theatre Garden
Brocade Glade	Macabeanum Garden	The Hill
Chestnut Bay	Malcom Allan Garden	Thomson Garden
Colin's Glade	Montana Mound	Triangle
Circle	New Ash Garden	Upper Fulvern
East Mound	New Pond Garden	Viburnam Garden
Entrance Glade	North Bank	Walled Path
Fabia Bay	North Drive	Walled Walk
First Garden/Old Garden	North walled Garden	West Mound
Fragrant Garden	Nursery Garden	Woodlands
Fusilier Garden	Outer Circle	
Garage Garden	Pond Garden	
Graingers Garden	Pond Woodland	
Green Drive	Power House Walk	
Green Walk		
Griersonianum Garden		

Appendix 2: Plans for Gigha Garden (31 May 1952)

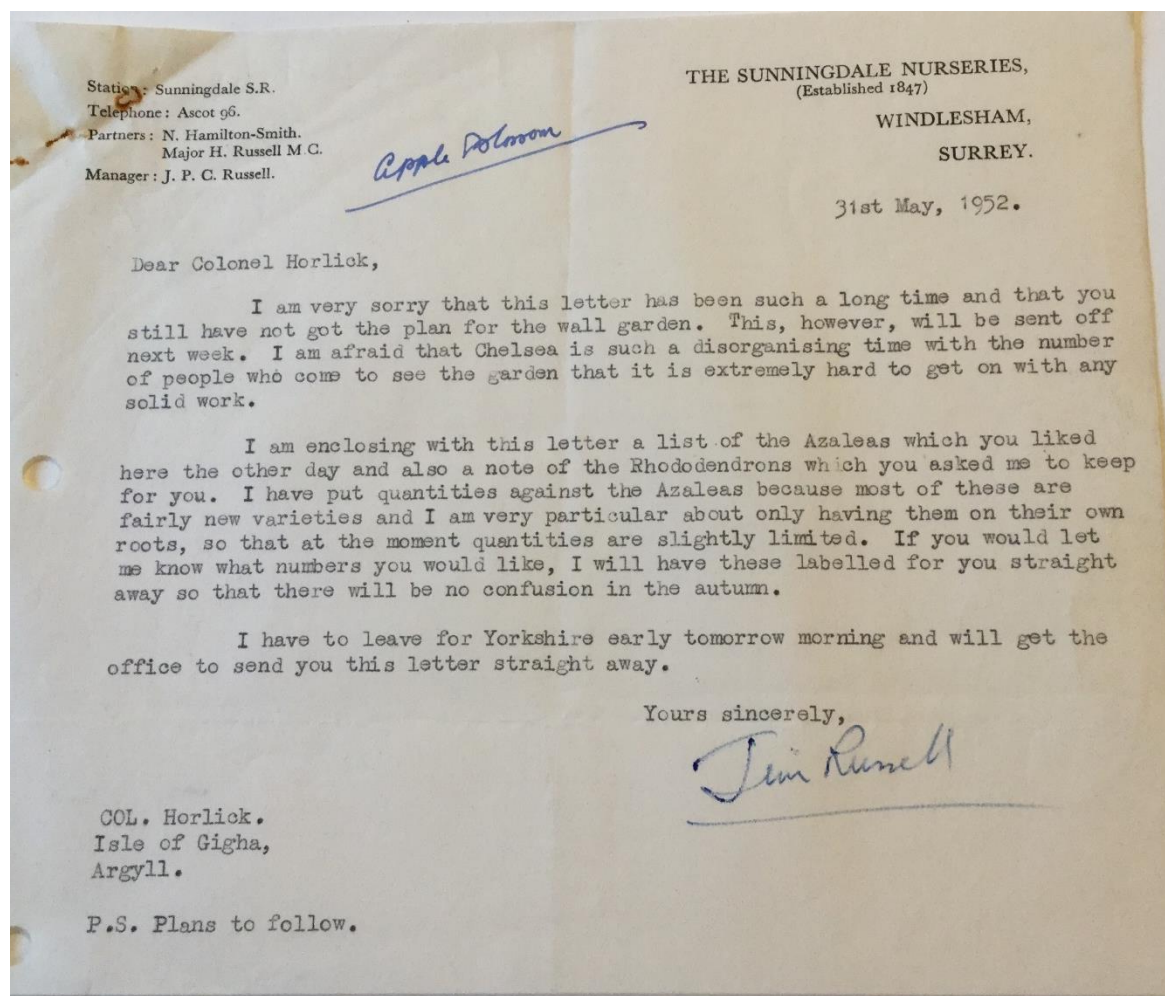

Clump of roses to be planted on lawn in order to hide Electricity plant. The area to be planted here is 50 x 20 yds in all and I would like to suggest the following varieties at the back where they could perhaps scramble into the trees. Moschata Kiftgate form, an exceptionally robust plant with huge bunches of strongly scented single white flowers, Rosa Filipes similar but not quite so vigorous a large growing shrub. Roses to be placed in front of these Moyesii v. Geranium with the typical ferny foliage and blood red flowers of Moyesii. This is an exceptionally free fruiting variety and the name Geranium applies to the colour of its fruits. Rosa Hillierii a somewhat similar plant, with dark blood red flowers, Rosa Nevada a vigorous hybrid from Moyesii with extremely large single creamy white flowers, slightly pink in bud, the trio of comparatively new briar hybrids from Germany with extremely large single flowers, Fruhlingsgelb uniform creamy yellow, Fruhlingssauber cherry pink, Fruhlingsmorgen pink in the bud, shell pink at the edge of the petal creamy yellow at the centre. In front of these again the blue leafed alba celeste with its exquisitely formed shell pink flowers and alba semi plena with perhaps the bluest grey foliage in this group and semi-double white flowers.

Other roses which might perhaps be used in clumps of perhaps 7 to 15 on the other side of the lawn are Xanthina Spontanea a spreading rose with purple stems and single deep canary yellow flowers and Rosa Altaica which might be considered as a large flowering form of the Scotch briar with creamy flowers. Clumps of any of the varieties of Scotch briar would also be very attractive in this setting.

For the rocks just inside the drive I would suggest on the sunny side a grouping of Rosa Richardi a particularly charming small rose from Abyssinia with single shell pink flowers with a bunch of golden stamens at the centre. This is very pretty if combined with the spreading dwarf broom Genista Lydia with its clear yellow flowers. For later effect the new Portuguese Cistus Pallinhalii with huge cup shaped white flowers, and the huge pink Cistus, Silver Pink, perhaps one or two Fothergillas and Vaccinium Virgatum for autumn colour and further back Erica Arborea Alpina and Australis for early Spring.

On the shady side Gaultheria Forrestii and Hookeri should grow well, one with white flowers, the other with the exquisite blue berries. The creeping Gaultheria Mummulariifolia and Ramondia Pyrenaica planted in the crevices of the rock should provide quite a good show and perhaps on the top of the rock clumps of Rh. Femkoense, Rh. Impeditum, Rh. Blue Tit and Rh. Blue Diamond.

The question of background plants in the woodland is a somewhat large one and I think would really best be considered on the ground. Perhaps with a view to some spring planting. I think that anything put in needs to be planted in bold groups as a spotty effect is to be avoided at all costs. There are certain obvious plants which should be used in quantity. I do not know if you have an objection to ferns but these are perhaps the most natural of all woodland plants. If the royal fern Osmunda Regalis does not grow on Gigha then I think this should be introduced in fairly considerable quantity. There is nothing quite so fine as its tall upstanding fronds in their vivid bronzy green. Other beautiful and exceptionally useful ferns are the evergreen Comaria magellanica whose fronds reach some 3/4' and will run happily about in the densest shade. For loose banks the vivid emerald green beech and oak ferns are very attractive and for windy places the spreading feathery plumes of struthiopteris, the ostrich fern are excellent.



As far as shrubs are concerned both Zenobia speciosa and pulverulenta would be worth using on a fairly large scale. Their bluish green foliage is very attractive and the heavy scented large white bells are produced in July at a time when there is comparatively little else in flower. I personally am fond of a few bamboos in the woodland but you may dislike these. If not they add considerably to a rather tropical effect and I would particularly recommend nitida with black stems and graceful feathery foliage, marislae somewhat similar in appearance and the tall falconeri, capable of reaching some 20', with orange stems and bold tufts of foliage. None of these are terrible runners and all are a very great improvement on the ordinary Matake. There is a very attractive dwarf variety pseudo-sasa. This does not run at all, its small black zigzag stems reach 2 $\frac{2}{3}$ ', leaves are olive green with a purple base. Another attractive but at the moment rare plant is chusquea coculey which is a Chilean plant with huge stems and tufts of feather like leaves springing from them all the way up.

In moist places I think a few big clumps of Kalmia latifolia would be attractive and these again flower in late June/July when most of the Rhododendrons are over.

Perhaps of all the woodland shrubs the Hydrangeas are the most rewarding. There are a tremendous number of these which are far too little known and very seldom seen. Arborescens grandiflora is a vigorous and hardy shrub with large heads of white sterile flowers, as these begin to uncurl they are a vivid jade green in colour and form eventually a bell shaped head of creamy white flowers. Cinerea sterilis is again a large and vigorous shrub with rather small heads of fertile flowers with a few large white florets. One of the most handsome and which would be entirely hardy with you is quercifolia. This has large leaves shaped like an oak leaf which turn to a brilliant scarlet in the autumn. The fertile flowers are green and the sterile florets a rather pleasant pinky white. In the Macrophylla group which contains all the ordinary garden varieties, there are one or two which I think are exceptionally attractive. Empress Eugenie is what is known as a semi-lace-capped which means it does not have the huge head of the garden Hydrangea with the large sterile florets clustered all over it, and is a pretty shade of pink. Mandschurica has the heavy blue heads of the ordinary hydrangea but these are carried on glistening black stems which give it an unusual air. Far the prettiest in this section are what is known as the lace-capped varieties. These approximate more to the Wild type of hydrangea, a flat head the centre of which is full of the tiny fertile flowers sometimes white sometimes blue and around them are a ring of the large sterile flowers in various colours. Lanarth White and White Wave are two which have white florets and a deep blue centre, Lilacina has a pink centre and lilac mauve florets, Veitchii has a blue centre and extremely large florets of pure white which turn gradually to red with age. This is a variety which will grow extremely well in dense shade. Blue Wave has a blue centre and vivid blue florets. The serrata hydrangeas are rather more delicate again in appearance than this group. One of the prettiest is Blue Bird with rather china blue flowers and lilac fertile flowers. Thunbergii is a fairly common plant making a small bush  $\frac{3}{4}$ ' high. The deep rose flowers become blood red with age. There are some very pretty hybrids from this



and one of the very best is Grayswood with its rose pink florets becoming blood red with age and Hidcote pink a new variety from Hidcote whose flowers open and remain a very intense rose-pink. The old Paniculata Grandiflora is of course a very useful plant because of its hardiness. We now come to perhaps the most exciting group which is the section known as asperae which contains one very attractive dwarf in involuerata a low shrub some 4/5' high, very free flowering with bright lilac blue fertile flowers and large creamy florets surrounding them. The remainder in this group are the huge tree Hydrangeas which are some of the most effective autumn shrubs to be seen anywhere. Perhaps the best known of these is Villosa a tall shrub some 10/12' with long hairy green leaves and large flat heads of flower. The fertile flowers mauve and the ray florets a bright porcelain blue. Larger and more vigorous than this is strigosa v. macrophylla whose leaves are over a foot in length, sharply pointed and baize green and has large heads of flower of a soft lilac blue. Sargentiana is again a familiar plant with its huge velvety leaves and flat heads of mauve flowers surrounded by white sterile flowers. Rosthornii and Robusta, are not generally hardy although I do not believe you would have any trouble with them, the leaves are enormous and like velvet green baize, the flowers somewhat resemble Sargentiana.

Moschata Kiftsgate @ 5/- each  
 Rosa Filipes @ 5/- each  
 Rosa Moyesii v. Geranium @ 7/6 each  
 Rosa Hillierii @ 10/- each  
 Rosa Moyesii v. Nevada @ 2/- each  
 Rosa Fruhlingsgelb @ 7/6 each  
 Rosa Fruhlingszauber @ 7/6 each  
 Rosa Fruhlingsmorgen @ 7/6 each  
 Rosa Alba celeste @ 5/- each  
 Rosa alba semi-plena @ 6/- each  
 Rosa Xanthina Spontanea @ 6/- each  
 Rosa Altaica @ 5/- each  
 Rosa Richardi @ 5/- each  
 Genista Lydia @ 4/- each  
 Cistus Pallinhai @ 4/- each  
 Cistus Silver Pink @ 4/- each  
 Fothergilla monticola @ 10/6 each  
 Vaccinium Virgatum @ 10/6 each  
 Erica arborea alpina @ 3/6 each  
 Erica Australis @ 4/- each  
 Gaultheria Forrestii @ 15/- each  
 Gaultheria Hookeri @ 10/6 each  
 Gaultheria Nummularifolia @ 5/- each  
 Ramondia Pyrenaica @ 2/- each  
 Rh. Pemakense @ 7/6 each  
 Rh. Impeditum @ 7/6 each  
 Rh. Blue Tit @ 7/6 each  
 Rh. Blue Diamond @ 10/- each  
 Osmanda Regalis @ 7/6 each  
 Lomaria Magellanica @ 5/- each  
 Beech Ferns @ 3/6 each  
 Oak Ferns @ 3/6 each  
 Struthiopteris (Ostrich fern) @ 3/6 each  
 Zenobia speciosa @ 7/6 each  
 Zenobia pulverulenta @ 7/6 each  
 Arundinaria nitida @ 5/- a clump  
 " marielae @ 10/6 each  
 " falconeri @ 10/6 each  
 Bamboo pseudo-sasa @ 6/- a clump  
 " chusquea couleou @ (Not available yet)  
 Kalmia latifolia @ 7/6 each  
 Hydrangea arborescens grandiflora @ 3/6 each  
 Hydrangea cinerea sterilis @ 5/- each  
 " quercifolia @ 5/- each  
 " Empress Eugenie @ 5/- each  
 " Mandshurica @ 5/- each  
 " Lenarth White @ 5/- each  
 " White Wave @ 5/- each  
 " Lilacina @ 5/- each  
 " Veitchii @ 7/6 each

Rhododendrons.

1 Gomer Waterer  
1 Hawk  
1 fastuosum flore pleno layer  
1 Milkmaid  
1 Cinnamomium album  
6 Az. Leo @ 15/- each

### Appendix 3: The Wall Garden at Gigha (Est. 1952)

#### The Wall Garden at Gigha.

This would appear to be reasonably sheltered from the wind and to be very warm. I think you have a very great advantage at Gigha in that you have all the advantages of the warmth of the west Highland climate without the incessant rain which so often goes with it. You thus have a very good chance of ripening and flowering freely many of the Mediterranean and Mexican plants which would not otherwise be likely to succeed. This wall garden is a considerable area some 70 x 55 yds and I feel there should be some bold design in the centre. I am suggesting a design which seems to me to rather suit the surroundings and that is a border in the form of a giant Celtic cross. I must admit this does not sound very attractive but the design is a bold one and although on paper resembles an early exercise in Byzantine piety, I think would prove very effective on the ground.

The entry into the garden would be such as it is now and somewhat concealed by the shrubs which it is proposed to plant. The main effect would be from the seat marked A which I think should be a very bold one and slightly curved. Behind this seat I am suggesting a bold planting to combine a wide variety of foliage from Magnolia Delavayi and the Camellias and I would suggest using here various iris, funkias, ferns and other foliage contrasts while leaving the bamboo which is growing there at the moment. I am only suggesting Camellia reticulata and the Salweenensis hybrids, as it seems to me that these flower with great freedom in Scotland, being themselves plants from high elevations in Yunnan, whereas the ordinary Camellia japonica does not appear to flower with any great freedom. For later effect here I have suggested various leptospermums some of which are new varieties recently sent over from New Zealand.

On the two horns of this planting I think it might be amusing to have two large wooden ship's figureheads looking down the main border and I am suggesting planting around this *Olearia semidentata*, as this is a plant of the utmost beauty in the Highlands where it appears to grow with great freedom and the silver of the leaves is quite as beautiful as the lilac of the flowers.

The vista down the main border would be in fact some 50 yards in length. The central path is tapered very much towards the top to give an additional effect of length. I am a little uncertain in my mind as to what the centre should be. So great an area of washed gravel would distract the eye from the plants and look rather uncomfortable. It would perhaps look better in grass or in water with a

stone path some 8' wide on either side. The water in this case would need to stop short of the top of the border and this would perhaps be far too expensive an idea in any case.

The actual planting of the border I think would be both very decorative and amusing if carried out on the lines suggested. Where I have put 'exotic plants', I mean all sorts of amusing shapes of yucca, various palms and semi-succulent plants which should grow well on Giza, mingled with the many beautiful ~~various~~ bulbous plants which should also flourish, and, for early effect in these groups, I am suggesting tree and herbaceous paeonies. The alternate groups would consist of the China roses, some of the Tea roses and the more restrained Polyanthas, keeping away from that intensely vivid and vulgar orange to which they so much incline. These roses need little pruning and looking after and flower freely for the greater part of the summer. I would suggest using between them clumps of Kniphofia and possibly groups of Funkias of various sorts. I think that these rather feathery shrubs need a base of good solid leaves around them in order to show to their best effect.

In the actual cross itself the circle in the centre would be filled with every sort of amusing exotic which would be likely to grow and I would suggest using amongst these Tigridias and possibly one or two other sorts of bulb which are no trouble in themselves and produce a flamboyant display for a short period. In the centre of this bed, at D, I would like to see a large Baroque statue which would serve as a focus from the seat at A. The four beds of the circle themselves would have at the centre E a large ornamental pot some 5 or 6' high to contain either some exotic shrub such as pomegranate or, if they would survive the climate, and I do not see why they should not, orange trees. As background to this bed I would suggest dracaenas and chameerops and growing around and behind them in a semi-circle some of the old fashioned roses. The rest of the planting around this central group to consist of tree paeonies, various exotic forms of iris and a certain amount of bold foliage.

At the top of the circle at F would be a semicircular seat and on either side I would suggest a rather cool area of grey, silver and blue shrubs and various herbs. Behind the seat another Magnolia Delavayi for its foliage effect and to either side here Viburnum Juddii and lilies to provide a great deal of scent at various periods of the year.

The cross path that leads out on both sides would have a planting of herbaceous paeonies and polyantha roses and again various foliage plants and at



There would be a square seat on either side. The effect of this border should be good at any time of year owing to the amount of rather architectural plants used in it and there should be a considerable showing of colour from May until the autumn from the various paeonies and roses. Lilies are a slightly more difficult question as it always seems to me that each garden has a lily which thrives in it and it is a question of finding out which variety this may be. I would, however, suggest as a start the G.C. Creelman x Regale hybrids as these seem to have extreme vigour and to do well anywhere.

As far as the planting around the wall is concerned, I merely sketched in here what I consider might be a sufficient number of large shrubs or trees to form the backbone and beneath these there should be bold drifts of smaller shrubs, a great many foliage plants of one sort or another and large quantities of bulbs which can look after themselves. I would naturally not intend the border to be quite as curly as it appears on this plan but I do not think it should be a formal shape as there is a large formal design at the centre.

Starting at the left hand side of the entrance, I have suggested three of the fragrant yellow *Oytisus Forlock* which grows to considerable height, then five of the *Embothrium Magellan Straits* form next, then four *Acacia Dealbeta*, the common *Mimosa*, which should grow well here and is attractive as a foliage plant in any case. Above these, three of the tree-like *Ceanothus Arboreus*, with its mass of pretty powder blue flowers which should be out at the same time as the *Mimosa*. Beyond this again five *Olearia Gaudana* A.M. var with a mass of dark violet daisy flowers which should come out at the same time as the three *Fremontia californica* above this with their apricot yellow flowers. Below this I would like to see seven of the silver and mauve *Olearia sessidentata*, then a group of three *Magnolia Grandiflora* in Nancy Lindsay's Persian form. This seems to be an interesting variety which has not yet flowered in this country. It was brought by some mysterious means to the Persian end of the Chinese Trade Route before the 18th Century and may have been one of the Southern Chinese species. Above this a group of three plants of the large-leaved *Hydrangea Hoothernii* with pale lavender flowers, backed by three of the large flowering white *leptospermum* from New Zealand, and then a single bush of the scarlet claw-like *telopea truncata*. At the corner I have suggested a planting of six *Sophora Tetraptera*, a specially graceful tree with elegant green foliage and masses of deep butter yellow flowers. This to be backed by three *Eucalyptus* in the corner and I have also suggested

a plant of *Ceanothus arboreus* so that the blue can pick up the yellow of the *Sophora*. At the top of the cross is *Magnolia Delavayi* with a *Myrtus Letcheriana* on each side. This is a recently introduced myrtle which keeps its foliage down to the ground and has larger flowers than the type produced with exceptional freedom. In the other corner I have repeated the planting of *Sophora* and *Eucalyptus* but with a *Ceanothus arboreus* on either side of the seat. I think the effect would be extremely good of this mass of brilliant golden trees in the Spring. The blue of the eucalyptus will show them up extremely well and the sea and the sky should make them even more brilliant. Below the right hand side another planting of three of Nancy Lindsey's *Magnolia grandiflora* and then two *Photinia glossata*. This is a very handsome evergreen with leaves rather like an oak. The ~~tree~~<sup>young</sup> growth is a bright copper. Then three *Leptospermum Micholisi* in its brilliant crimson form and below this an intermingled group of three of the tall acacia *melanoxylon* with pale cream flowers and the handsome *Itea Yunnanensis* with holly like leaves and very long drooping bunches of creamy green flowers. Below this two of the yellow *Callistemon pendula* with a group of three *Ceanothus austromontanus*, the vigorous variety with brilliant blue flowers, and behind them the tall *Michelia toitsopa* first cousin to the *Magnolia* and a very attractive tree with its white egg-like flowers which are very sweetly scented. Below this again a group of three *Carpentaria californica* and three *Abutilon vitifolium* and a further three *Cytisus Forlock* at the other entry.

Behind the seat I have suggested one *Magnolia Delavayi* flanked on each side by *Guevina avellana* a tree with very large and handsome pinnate leaves and long bunches of nut-like fruit. This would be backed by the existing bamboo and to either side I have suggested planting two *Camellia Reticulata* in the widely spreading garden form and then behind them one *Camellia Reticulata* in the upright wild form. Behind this again on the left, two *Leptospermum Rose Gem*, a new variety from New Zealand, and, on the right, one *Leptospermum Keatleyi*, a rather rare variety with pink flowers said to be the size of a half-crown, and two *Leptospermum Rose Gem*.

For the two horns I have suggested a group of the deep pink *Leptospermum Micholisi* on each side, six in all. In front of these *Clusia scandentata*, fourteen plants in all. At A there would be a long curving seat preferably in wood some 27' in length and at B would be in all four large wooden tubs containing

preferably orange trees or some other exotic plant and on each side a large wooden figure or ship's figurehead.

The wall itself should have a quantity of climbers and I would like to suggest here *Clianthus* <sup>variegata</sup> ~~variegata~~ in its scarlet form, its white form and its rose form, *Senecio Scandens*, the sweetly scented white *Frachiloperrum jasminiflorum*, the more fawn coloured Asiaticum, *Esorencarpus* in both its red and yellow forms, *Clematis Armandii*, *Clematis Moyana*, both spring flowering and very attractive for their large bunches of white or apple-blossom flowers, *Clematis Veitchii* with its masses of small primrose scented flowers in the autumn, *Clematis florida* bicolor with creamy flowers and purple anthers at the centre, the various forms of passion flower and I would suggest a considerable quantity of the less known and rather more tender roses.

I do not see why you should not be able to grow the lovely white *Niphotes* and the *Olerata* roses, such as *La Follette*, of which there are a number of exciting varieties. One would not normally expect these to flower in Scotland but as your rain fall is so light I think they might succeed very well. For instance where there are three *abutilon vitifolium*, it would make a pretty effect if three *La Follette* and two or three bushes of the saffron yellow rose *Star of Persia* were placed in front <sup>and behind</sup> of them.

I am not going to suggest now an underplanting for these trees as I feel this must be done on the ground and it is a mistake to try and hurry a planting of this size but there are many tender things which you could try with advantage. The clear pink *Cestrum Nevalli* should grow well. There are of course many *hydrangeas* which would be effective here. Large numbers of *crinum* and *agapanthus* might be used and should flourish. There are any number of attractive shrubs such as *Nikkau* <sup>Flora</sup> ~~Flora~~ and which could be used in large drifts and, in order to get a fine variety of foliage, the rather more tender *Amorbia*, *Yucca*, *Phoradendron* and any number of plants belonging to the iris family could be used with great effect, though I have not suggested any of the more hardy shrubs which could be used here. If you feel that this scheme might be effective, I would suggest that perhaps I might come and discuss <sup>it</sup> with you in the autumn and we could perhaps mark some of it at any rate out on the garden, as I imagine there is no question of planting ~~anything~~ <sup>anything</sup> before the Spring. I think, where as in this case a number of slightly tender plants have been suggested, spring planting would be very much wiser, although in the actual border the *pasconias* should perhaps be put in in the autumn.



Appendix 4: Letter from Russell to Horlick about Gigha Garden (13 February 1956)

Colonel J. N. Horlick

Page 4.

February 13, 1956.

Gigha

Apart from the *Elaeagnus* and the *Cupressus Allumii* there are one or two plants which I would like to suggest sending up to Gigha for the wall garden and the borders in it. I think you need a group of trees at the centre near the greenhouse to break up this enormous space a little and have suggested the very handsome, rapid growing *Arbutus menziesii* with its fine red stem, large leaves, white flowers, and strawberry fruit, and two of the newer *Prunus*, the *Subhirtella* variety *Rukubana*, a light and graceful but largish shrub flowering in March with semi-double deep rose flowers, and *Prunus Okame*, a hybrid raised by Captain Collingwood Ingram, between the almost scarlet tender *Formosan* cherry and the very hardy *incisa*. This again will form a small tree or very large shrub and produces in March with the greatest freedom its semi-double deep rose flowers. In the borders there are one or two newish plants which I would like to see tried out; *Cistus Elma*, another hybrid of Collingwood Ingram's, with very large bowl shaped flowers of pure white with golden centre; the particularly neat *Cotoneaster* sent home by Ludlow and Sherriff; *Diervilla Bristol Ruby*, a newish variety and the best I have seen, reasonably dwarf, incredibly free flowering and with bright crimson flowers; and two very good *Hibiscus*, *hamabo* with soft pink and fawn coloured flowers, and *Woodbridge* with large deep rose flowers with a darker eye. *Prunus Mume* is a much neglected small shrub, remarkable for its very early flowering and there are three forms of this which are just coming into flower here now. They are very sweetly scented flowers and I think should do extremely well on Gigha. I have put down the white, the pale pink, and crimson variety. I feel also that there should be some tree peonies in this wall garden as there is no doubt that they do remarkably well on Mull and also at Iogen. I have suggested that you have a collection of the twelve varieties in the catalogue less *Hakugan* which is sold out. Again I feel that the wall garden should have a quantity of roses and have suggested a number of climbers - the well known *Panksian Yellow*, the huge pale pink *Belle de Portugal* with its large yellow fruits, the very strongly growing *Gentiliana* and *Moschata Kiftsgate* variety with huge heads of small white flowers very sweetly scented (these would also scramble up the trees on the bank) *Laurence Johnston* with its bright yellow semi-double flowers, the single shell pink *macrantha Daisy Hill*, the pretty Victorian rose *May Queen* with its tightly double pink flowers, one of the old tea roses *Leonie Viennot* with pale yellow flowers tinged with copper, and the flamboyant *Reveil Dijonnais* with deep yellow flowers edged and flushed with flame pink. There are also some very pretty china roses of which I would like to see a group or two in the borders. These flower almost without ceasing from early June right through to the frosts and I think on Gigha would continue till nearly Christmas - *Pavvier* is a dwarf growing variety reaching no more than eighteen inches with very intense crimson flowers, *Felleberg* is a taller grower equally free with crimson pink flowers, *Cecile Brunner* is the charming Victorian button-hole rose, *Gruss an Aachen* is a beautifully shaped creamy coloured flower pink and yellow in the bud, *Gruss an Teplitz* is a very deep very double red with a particularly sweet scent.

There are one or two good shrubs I would like to see put into the wood. *Taxodium distichum* grows well at Loch Inch and is so beautiful in the spring with its vivid fresh green that I think it would be worth putting a few trees around the glade since it revels in wet soil. *Sorbus oligodonta* would be a beautiful tree on the bank and is a quite remarkable variety with deep salmon pink fruit, a wonderful contrast to its grey-green foliage. *Prunus Ssiori* is a newly introduced bird cherry which again would flourish in wettish places in the wood. It is a strong grower and produces with great freedom long racemes of white flowers in May. Lastly, there is a very good hybrid *Pieris* which originated here and which I have called *Flame of the Forest*. This is a cross between *japonica* and *forrestii* and keeps the neat foliage of *japonica* together with the brilliant young growth of *forrestii*.

February 13, 1956.

These are all plants which might be sent up with any Cupressus or Eleagnus you decide you would like in mid March. I would like to suggest, if it would be a help, that I come up myself then and we could perhaps consider rearranging the borders in the wall garden and also think about some much more exotic plants which could perhaps go in later in the spring. I was thinking particularly of various plants which I have seen flourishing at Logan and in Kilarney and other mild places. First of all there are the Fuchsias of which I think you are rather lacking in the better hardy varieties - Mrs. Popple with her huge flowers, Mrs. Ralph Wood a very pretty pink and lilac one, Carmen and Dunrobin Pedder with very elegantly shaped flowers. There are also the Daturas which used to grow well at Logan, the Hedychium, or ginger plants, which flourish in Kilarney and have very good foliage and pretty scented flowers in late summer. I have three or four sorts of these. There is a giant African Senecio which I think might be hardy, and some of the tender Yuccas, Eryngiums, Agaves should grow well. I see no reason why Clivea should not be hardy and possibly even Strelitzia as this grows in Cornwall. There are many very handsome semi-hardy Irises, Kniphofias, and pretty shrubs and climbers like Michelia, Mandevillea, Oxyptalum with its sea green flowers which should flourish and the latter in particular would look magnificent near to your Puyas and there are also a number of very handsome Crinums which should do well. I think the thing to do would be to choose spots for these and to send them up in late May.

Yours sincerely,

