

ALBERTO CAMPO BAEZA, ARCHITECT

THE MA: ANDALUCÍA'S MUSEUM OF MEMORY, GRANADA (SPAIN) 2009

We would like to make "the most beautiful building" for the Museo de la Memoria de Andalucía (Andalusia's Museum of Memory) in Granada. The MA. A museum that would convey the entire history of Andalusia. As early as Roman times, the geographer Strabo described the inhabitants of Andalusia as "the most cultivated of the Iberians, whose laws are written in verse."

Our project for the MA is a building that continues the Central Headquarters of the CAJA GRANADA Savings Bank that we finished in 2001. We propose a podium-like structure measuring 60x120 m and rising three stories, so that its upper level coincides with the podium of the main CAJA GRANADA building. And its façade as well. Everything is arranged around a central courtyard, an elliptic form through which circular ramps rise, connecting the three levels and creating interesting spatial tensions. The dimensions of the elliptical courtyard have been borrowed from the courtyard of the Palace of Charles the V in the Alhambra.

And to finish the whole a strong vertical piece emerges, as if it were a Gate to the City, the same height and width as the main building of the CAJA GRANADA. From the highway that encircles Granada it appears as a screen-like façade covered with messages writ large plasma screens that entirely cover it. Like Piccadilly Circus in London or Times Square in New York.

And to finish the entire operation, a large horizontal platform extends all the way to the River, the MA FIELD, serving as a public space for this new quarter of the city of Granada.

The new building, silent in its forms, is loud in its elements used to communicate the messages of the new millennium in which we are already immersed.

Queríamos hacer "el más hermoso edificio" para el Museo de la Memoria de Andalucía en Granada. El MA. Un Museo que quiere transmitir toda la Historia de Andalucía. Ya en tiempos de los romanos, Estrabón describía a los habitantes de Andalucía como "los más cultos de los iberos, que tienen leyes en verso".

Proyectamos para sede del MA un edificio en continuidad con la Sede Central de CAJA GRANADA que terminamos en 2001. Proponemos un edificio podio de 60x120 m con tres plantas de altura, de manera que su plano superior coincida con el podio del edificio principal de CAJA GRANADA. Y también se alinean sus fachadas. Se organiza todo alrededor de un patio central de traza elíptica en el que se desarrollan unas rampas helicoidales que conectan los tres niveles y crean una tensión espacial de gran interés. Las dimensiones del patio elíptico se toman prestadas del patio del Palacio de Carlos V en la Alhambra.

Y como remate, como si de una Puerta de la Ciudad se tratara, emerge una fuerte pieza vertical de la misma altura y anchura que el edificio principal de CAJA GRANADA. Aparece así frente a la autopista de circunvalación de Granada como una gran fachada pantalla capaz de transmitir mensajes a través de grandes pantallas de plasma que la cubrirán por entero. Como PicadillyCircus en Londres o Times Square en Nueva York.

Y para rematar la operación, una gran plataforma horizontal hasta el río, la CAMPA del MA, que servirá como espacio público de referencia en aquella zona nueva de la ciudad de Granada.

El nuevo edificio, silencioso en sus formas, es clamoroso en sus elementos de transmisión de mensajes de un nuevo milenio en el que ya estamos inmersos.

ALBERTO CAMPO BAEZA, ARCHITECT

THE MA: ANDALUCÍA'S MUSEUM OF MEMORY, GRANADA (SPAIN) 2009



ALBERTO CAMPO BAEZA, ARCHITECT

THE MA: ANDALUCÍA'S MUSEUM OF MEMORY, GRANADA (SPAIN) 2009



ALBERTO CAMPO BAEZA, ARCHITECT

THE MA: ANDALUCÍA'S MUSEUM OF MEMORY, GRANADA (SPAIN) 2009



ALBERTO CAMPO BAEZA, ARCHITECT

THE MA: ANDALUCÍA'S MUSEUM OF MEMORY, GRANADA (SPAIN) 2009



ALBERTO CAMPO BAEZA, ARCHITECT

THE MA: ANDALUCÍA'S MUSEUM OF MEMORY, GRANADA (SPAIN) 2009



ALBERTO CAMPO BAEZA, ARCHITECT

THE MA: ANDALUCÍA'S MUSEUM OF MEMORY, GRANADA (SPAIN) 2009



ALBERTO CAMPO BAEZA, ARCHITECT

THE MA: ANDALUCÍA'S MUSEUM OF MEMORY, GRANADA (SPAIN) 2009



ALBERTO CAMPO BAEZA, ARCHITECT

THE MA: ANDALUCÍA'S MUSEUM OF MEMORY, GRANADA (SPAIN) 2009



ALBERTO CAMPO BAEZA, ARCHITECT

THE MA: ANDALUCÍA'S MUSEUM OF MEMORY, GRANADA (SPAIN) 2009

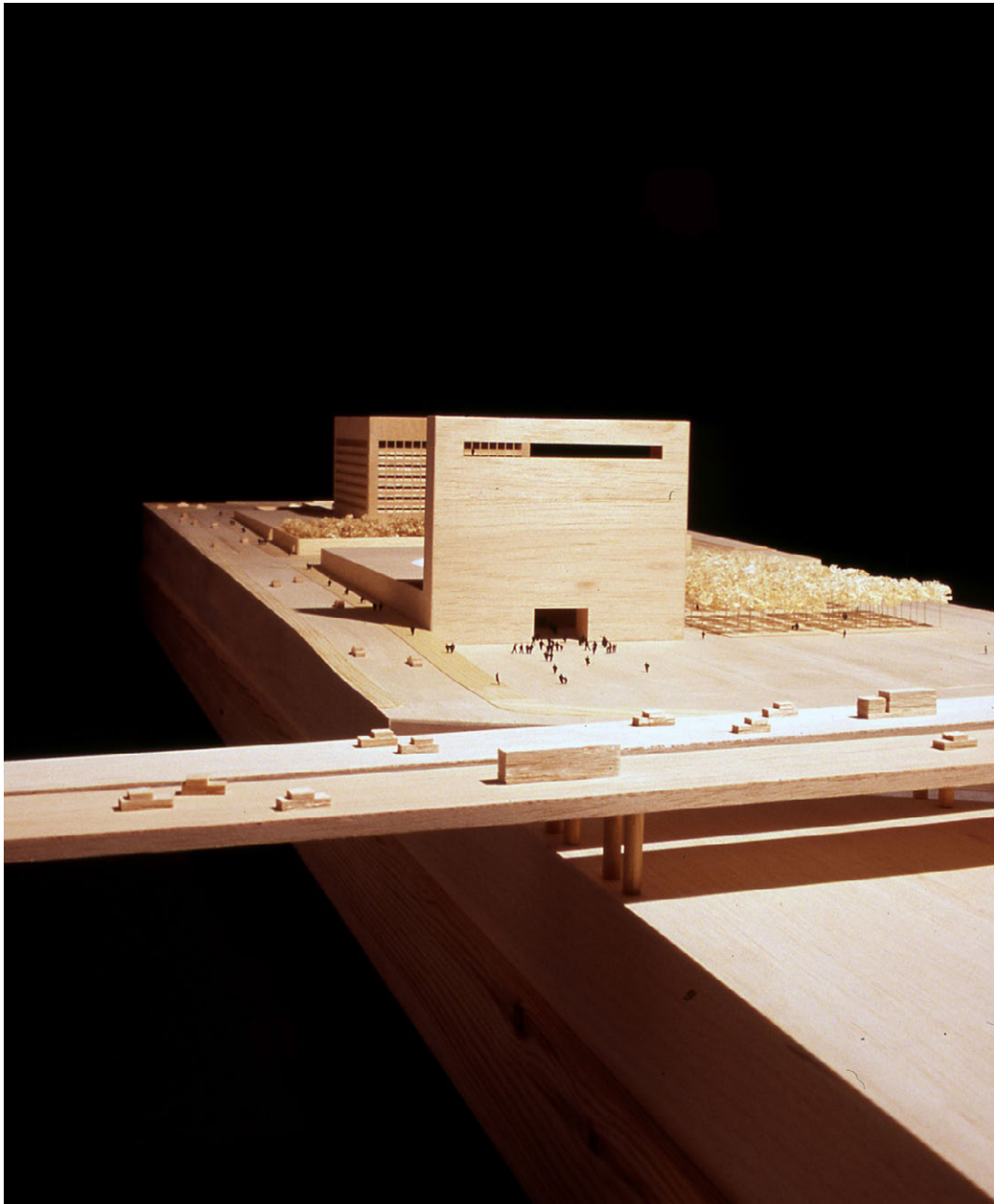

ALBERTO CAMPO BAEZA, ARCHITECT

THE MA: ANDALUCÍA'S MUSEUM OF MEMORY, GRANADA (SPAIN) 2009



ALBERTO CAMPO BAEZA, ARCHITECT

THE MA: ANDALUCÍA'S MUSEUM OF MEMORY, GRANADA (SPAIN) 2009

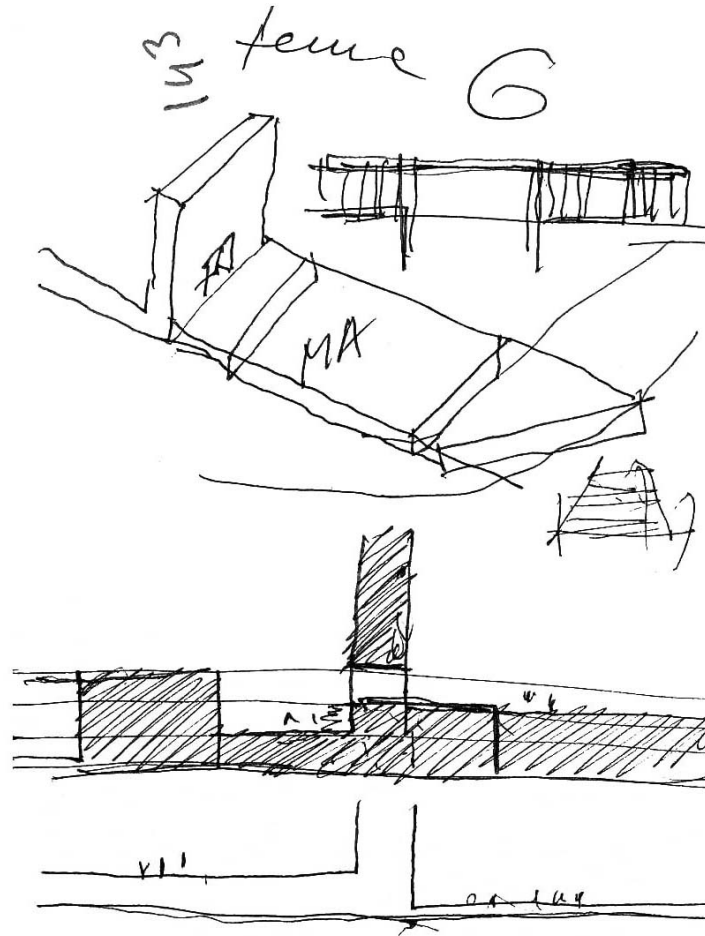

ALBERTO CAMPO BAEZA, ARCHITECT

THE MA: ANDALUCÍA'S MUSEUM OF MEMORY, GRANADA (SPAIN) 2009

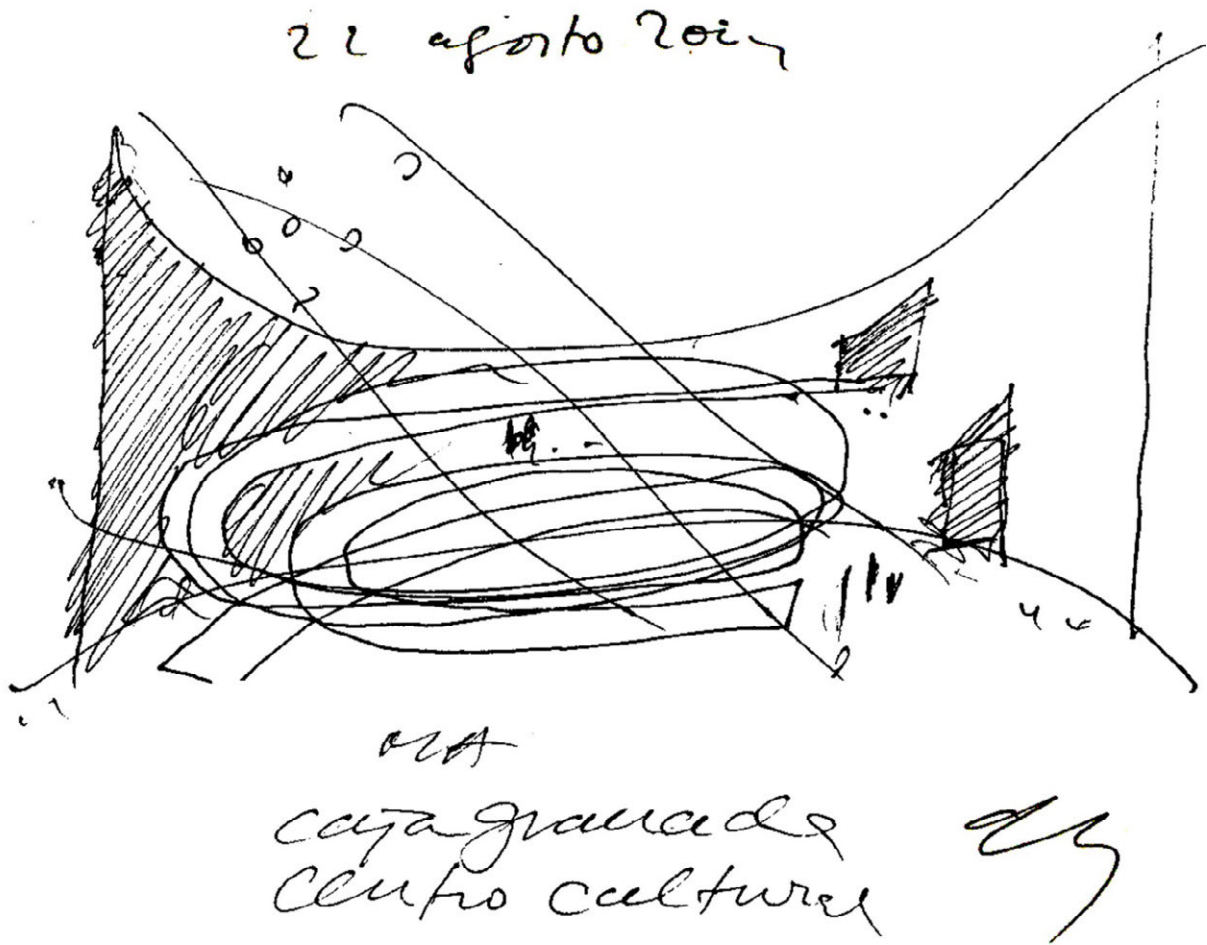

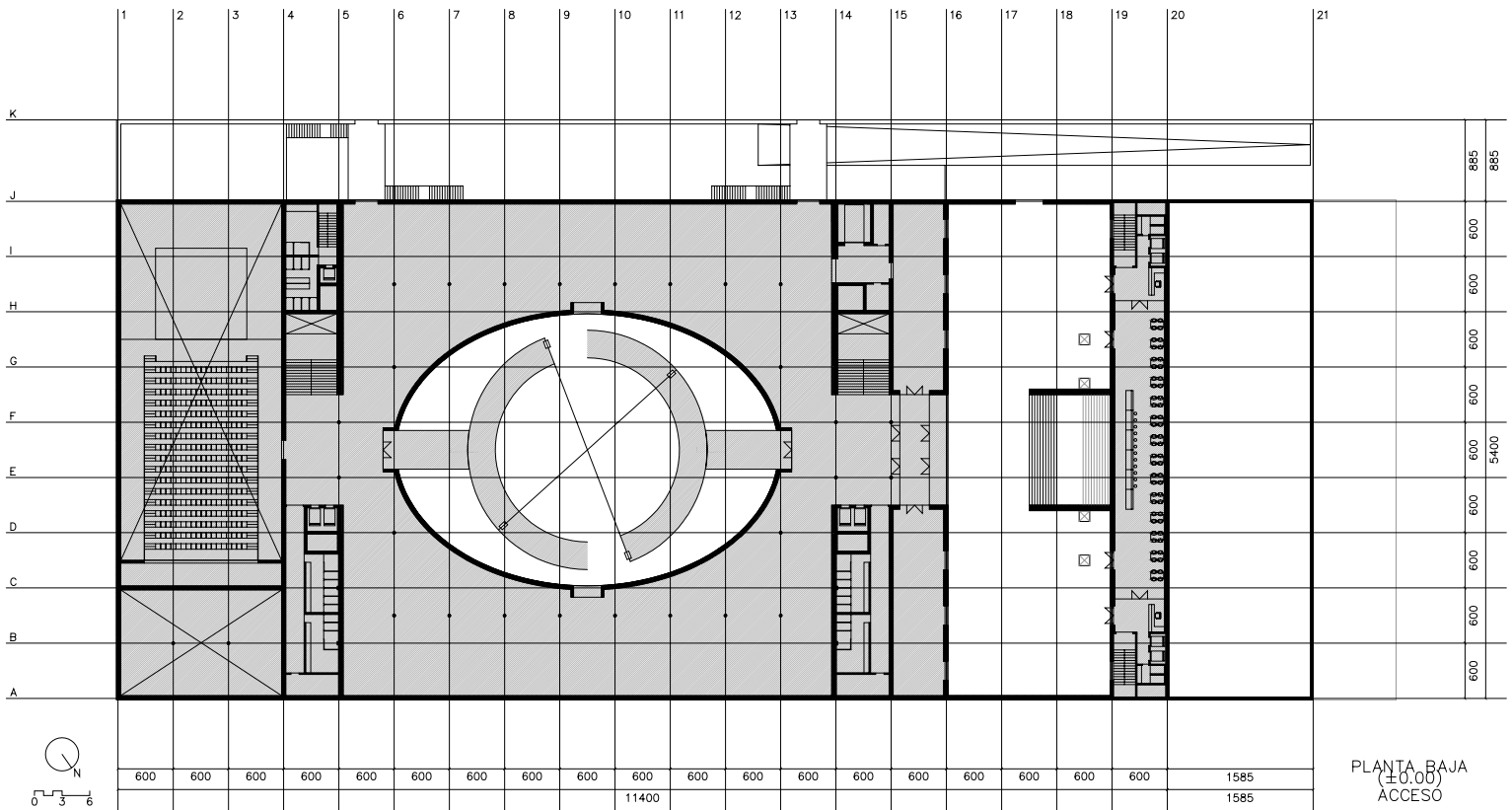
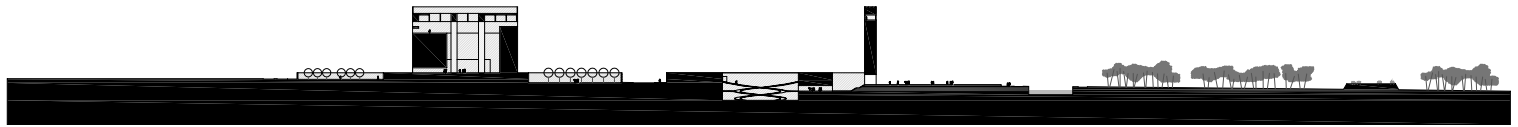
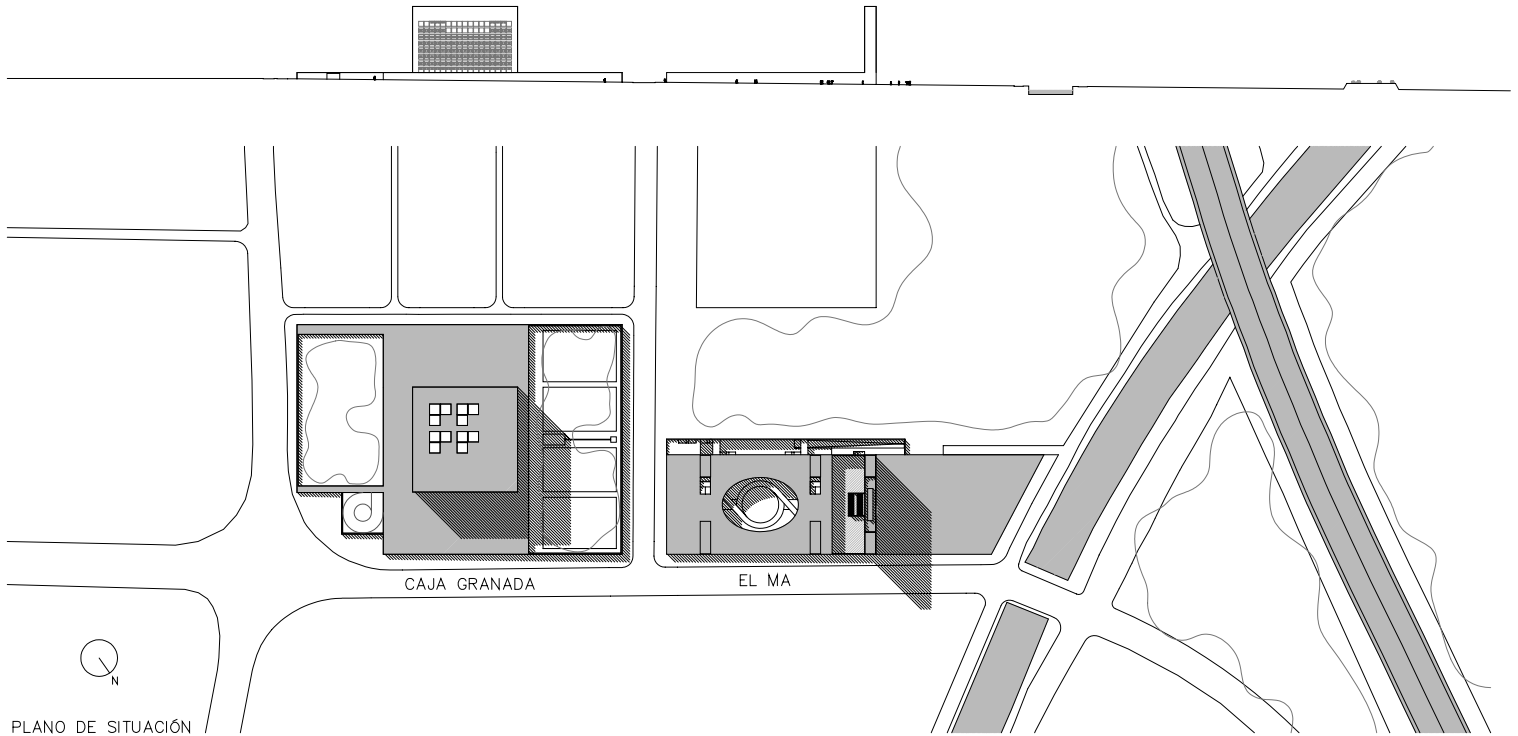

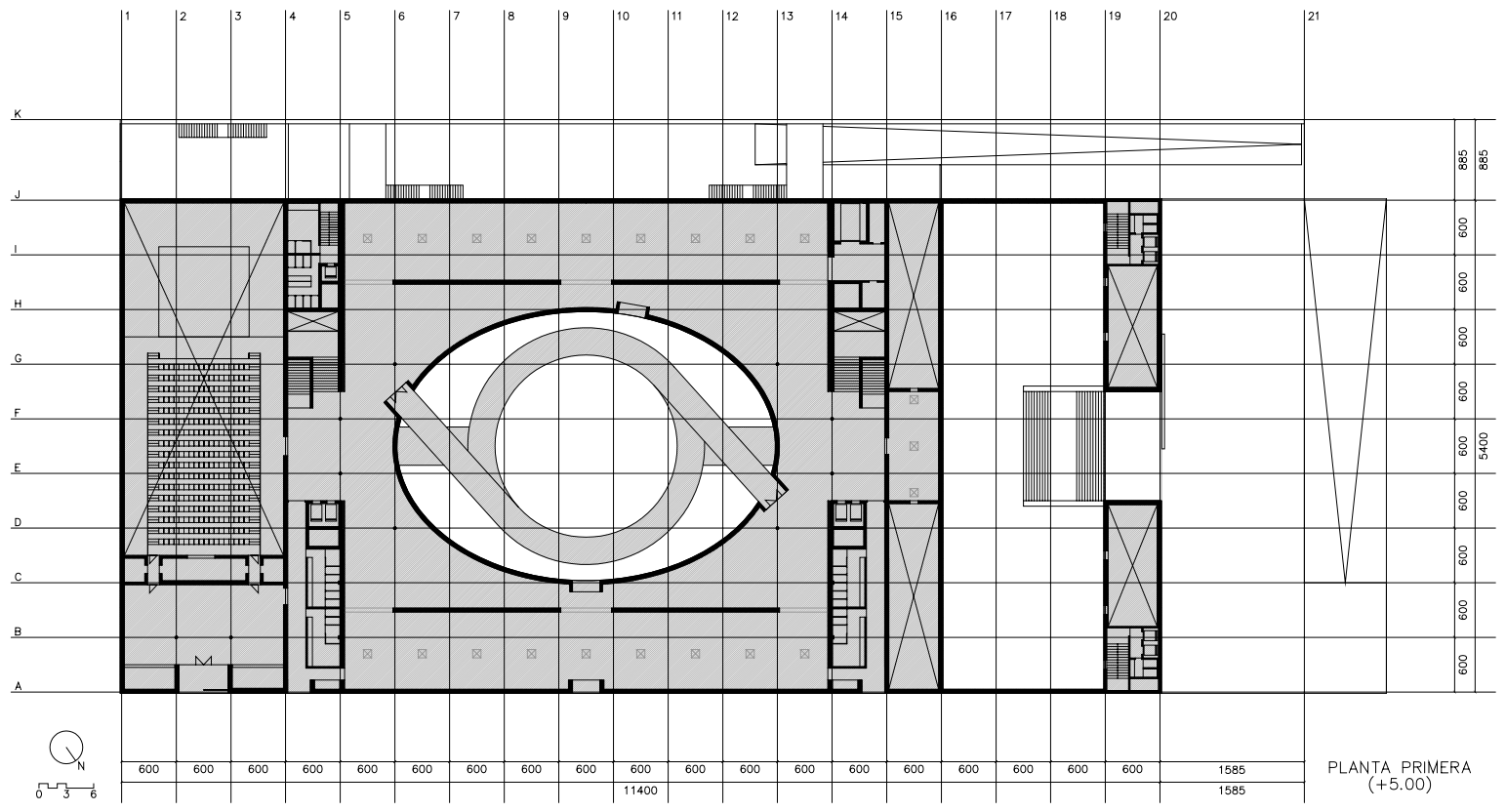

PLANTA PRIMERA
(+5.00)

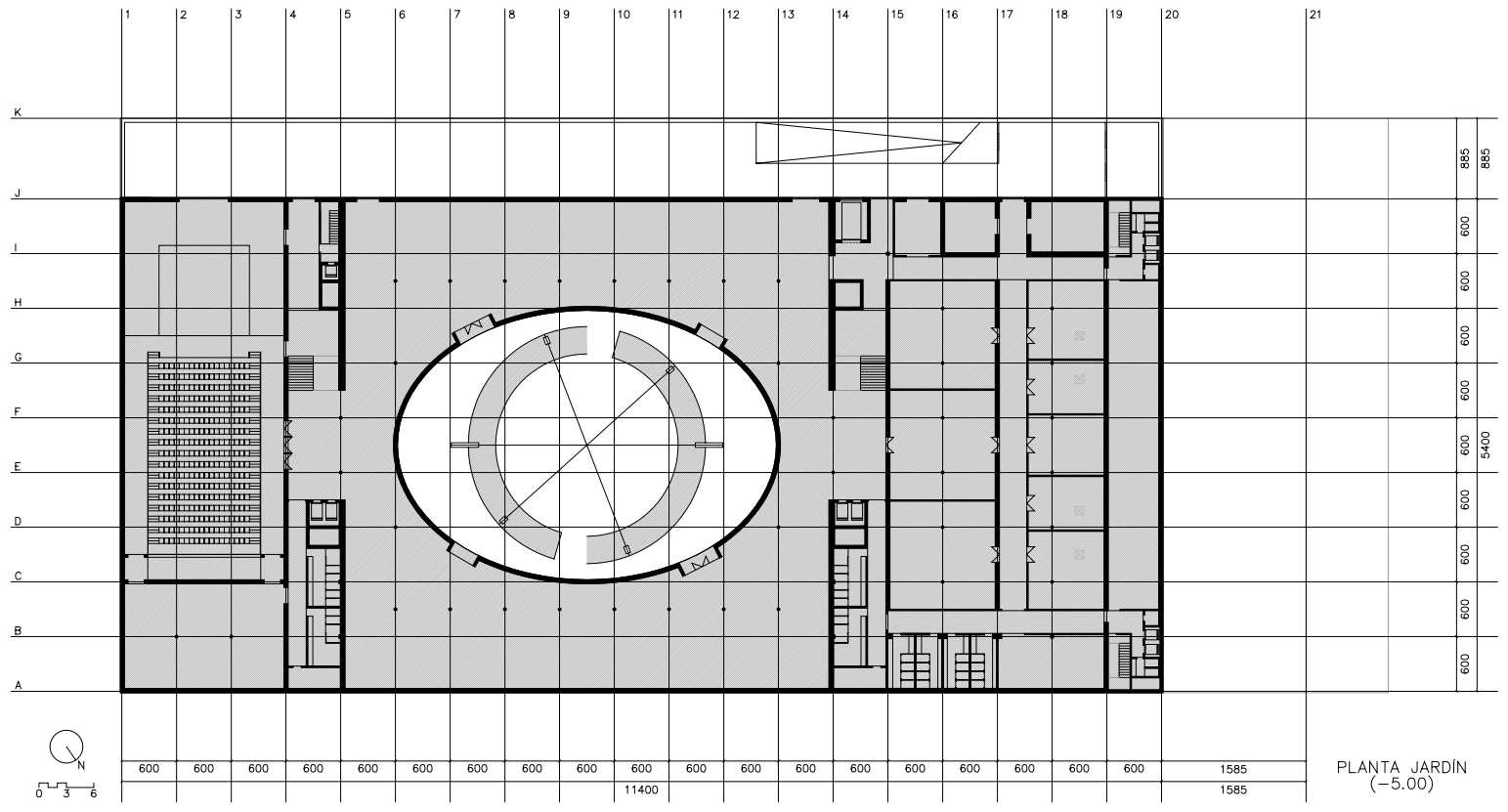

PLANTA JARDIN
(-5.00)

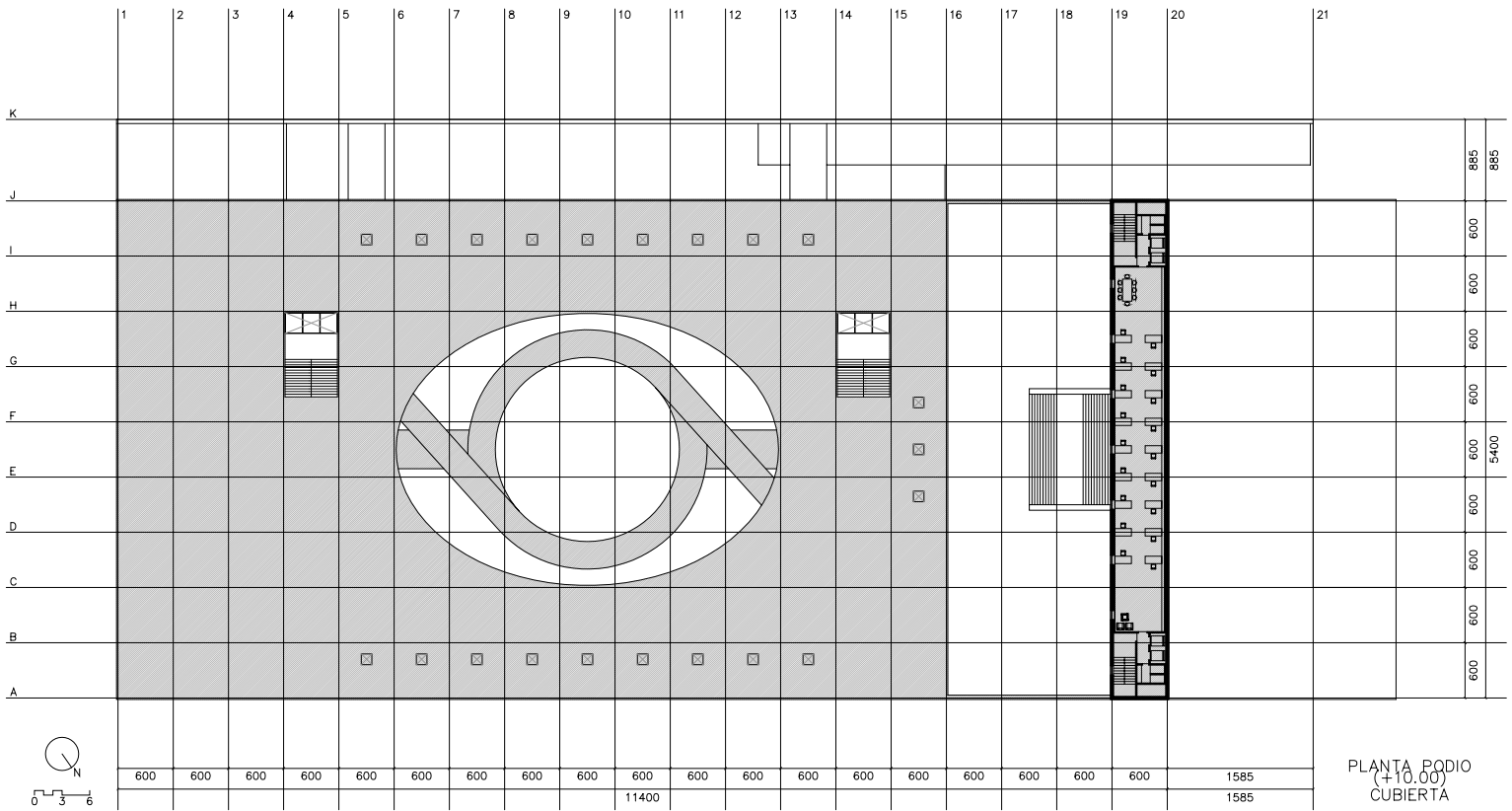
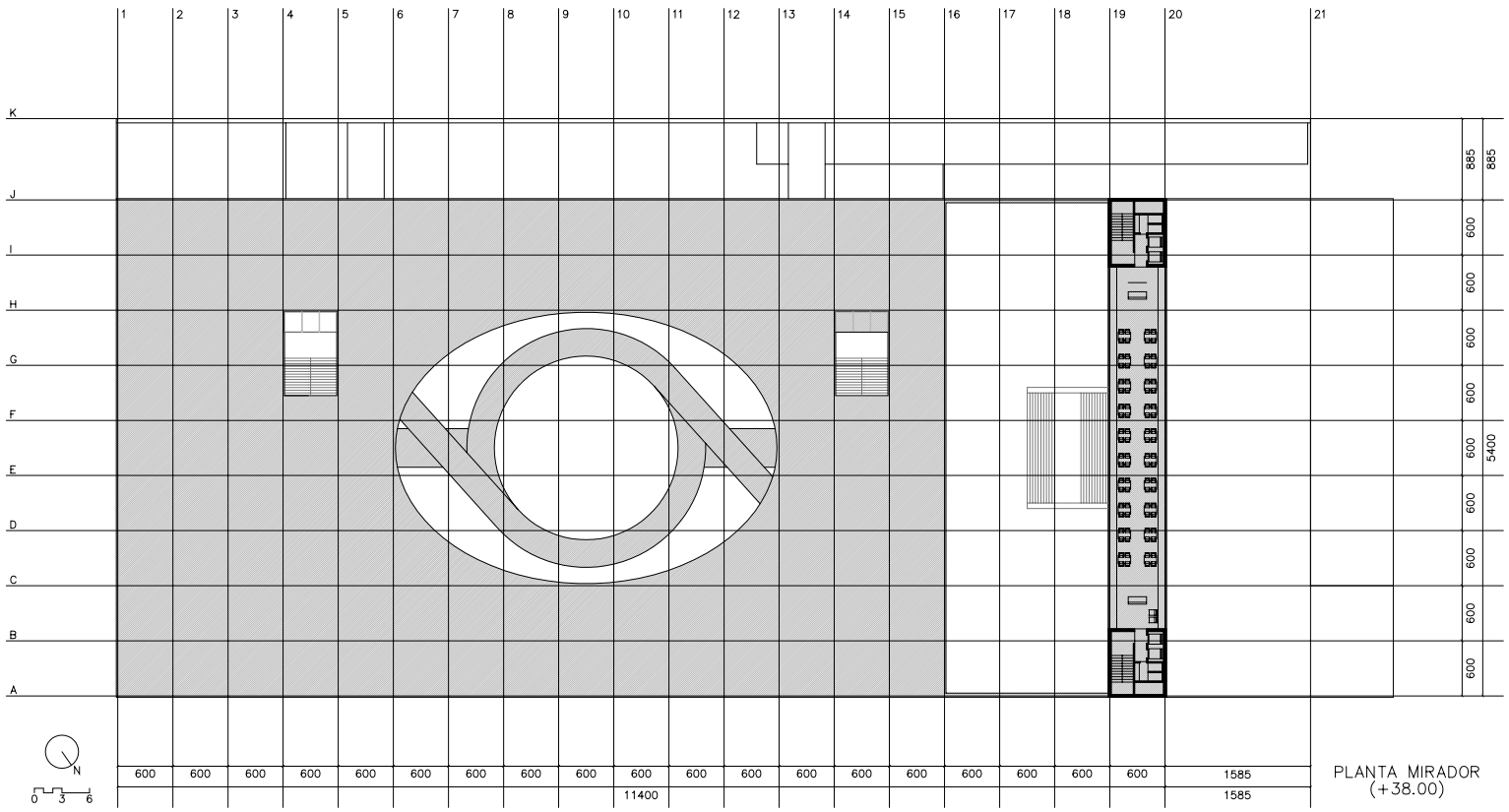

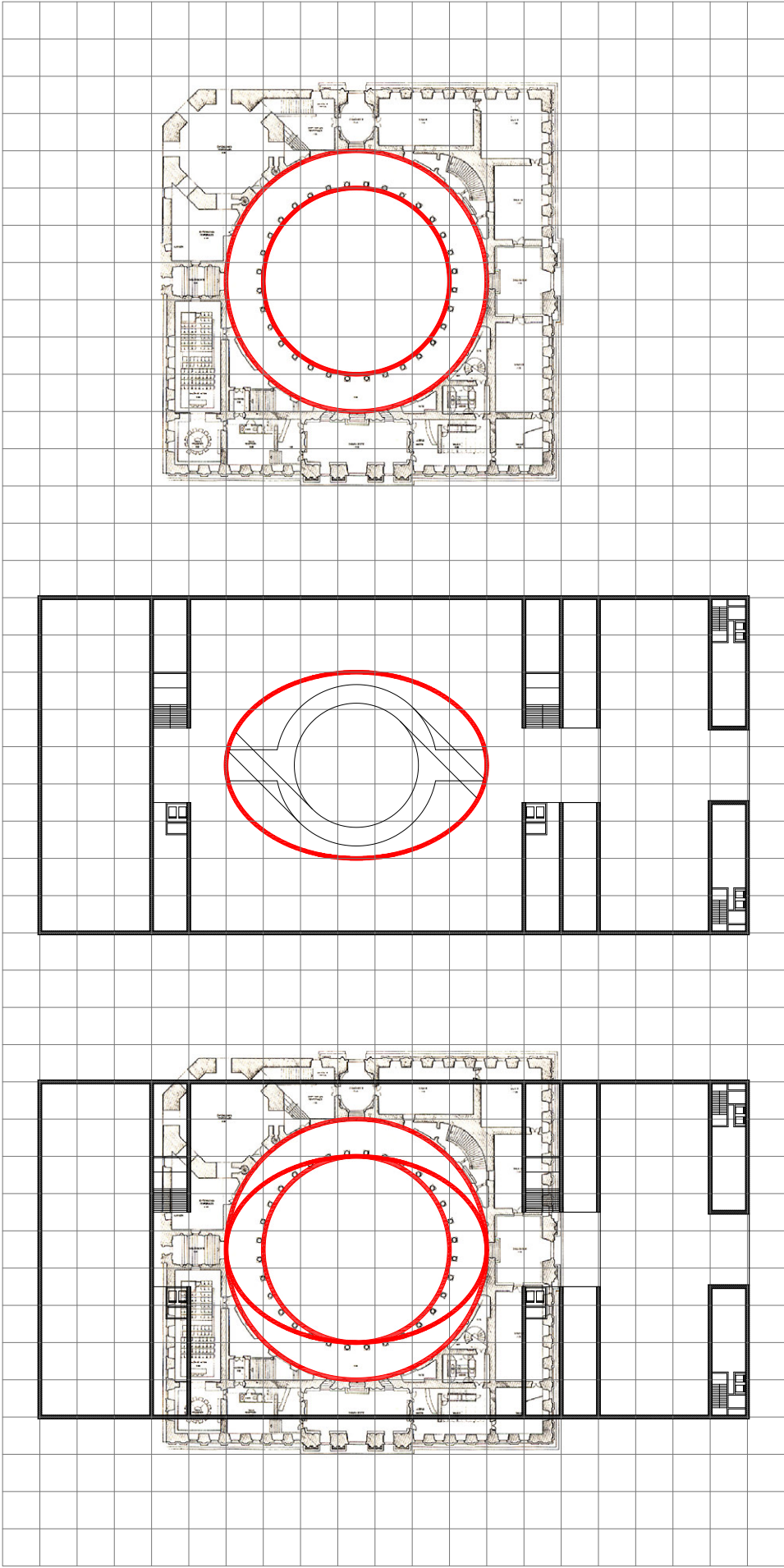

0 3 6 12

EL MA DE GRANADA Y EL PALACIO DE CARLOS V

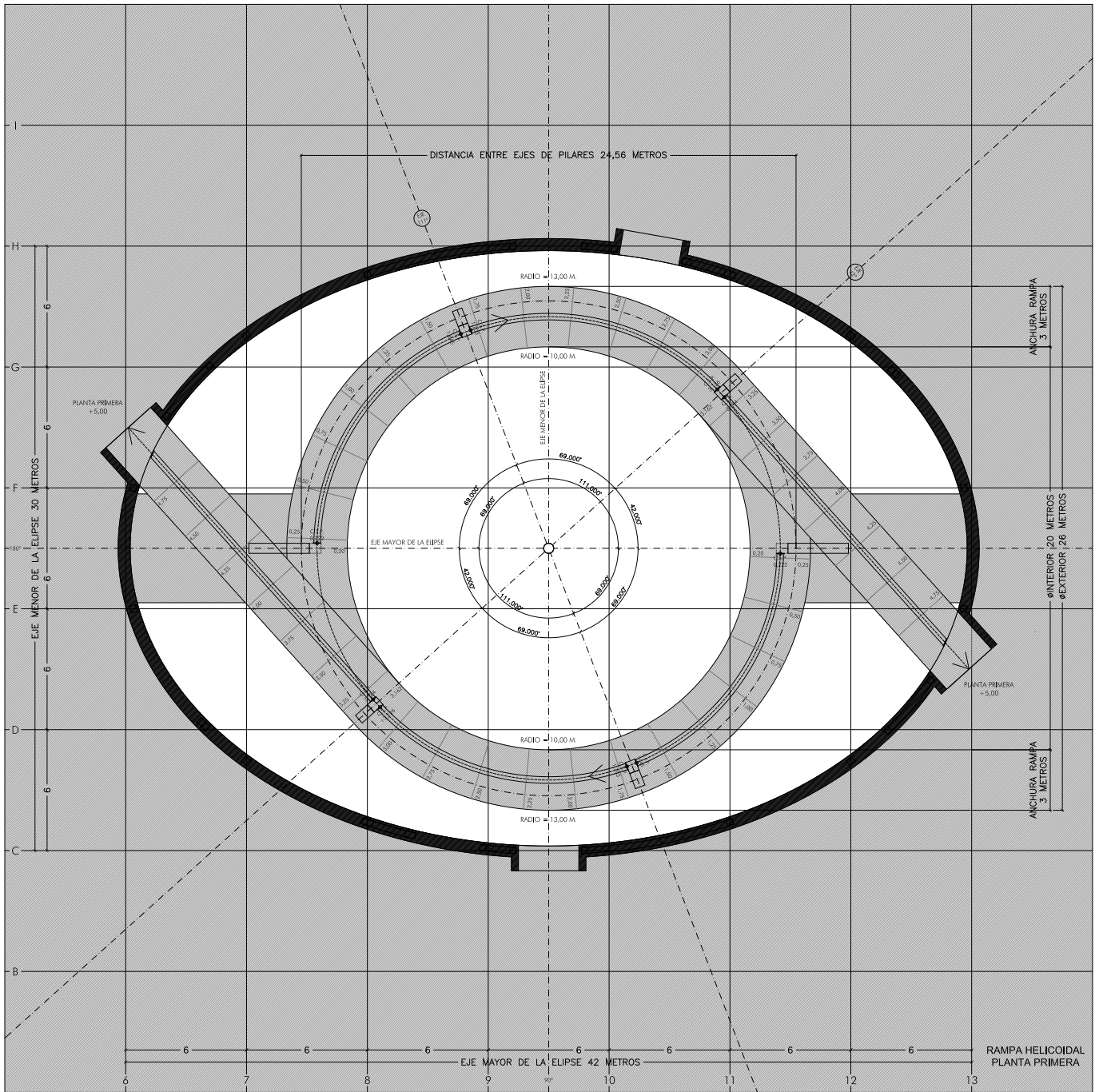

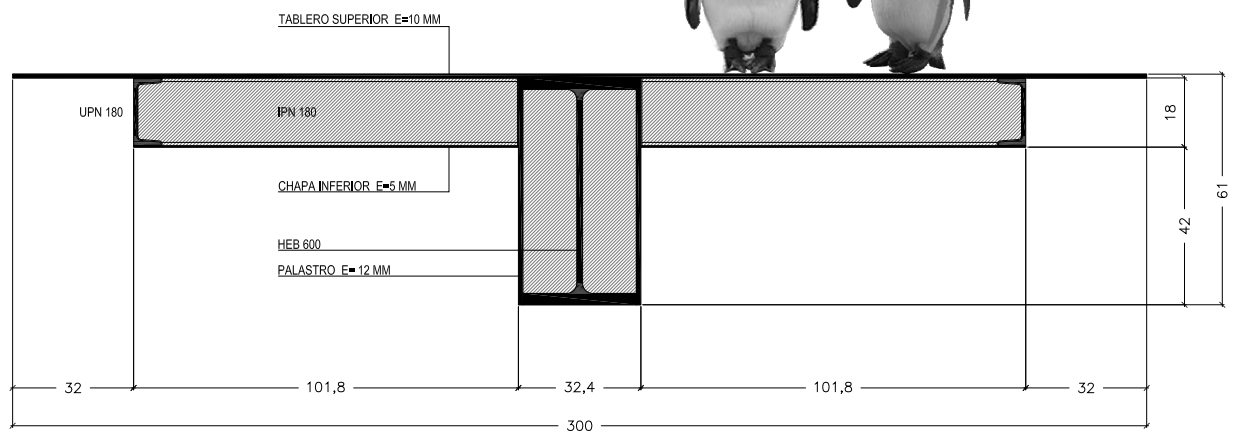

RAMPA HELICOIDAL: SECCIÓN TRANSVERSAL