

The Trustees of ALT are grateful to the following organisations for their generous support for the 2011 conference



ALT-C 2011
18th international conference
University of Leeds, UK, 6–8 September 2011
www.alt.ac.uk/altc2011

ASSOCIATION
FOR LEARNING
TECHNOLOGY



Thriving in a colder and more
challenging climate

Conference guide

Association for Learning Technology

Gipsy Lane
Headington
Oxford
OX3 0BP
UK

admin@alt.ac.uk
www.alt.ac.uk

Registered Charity Number 1063519

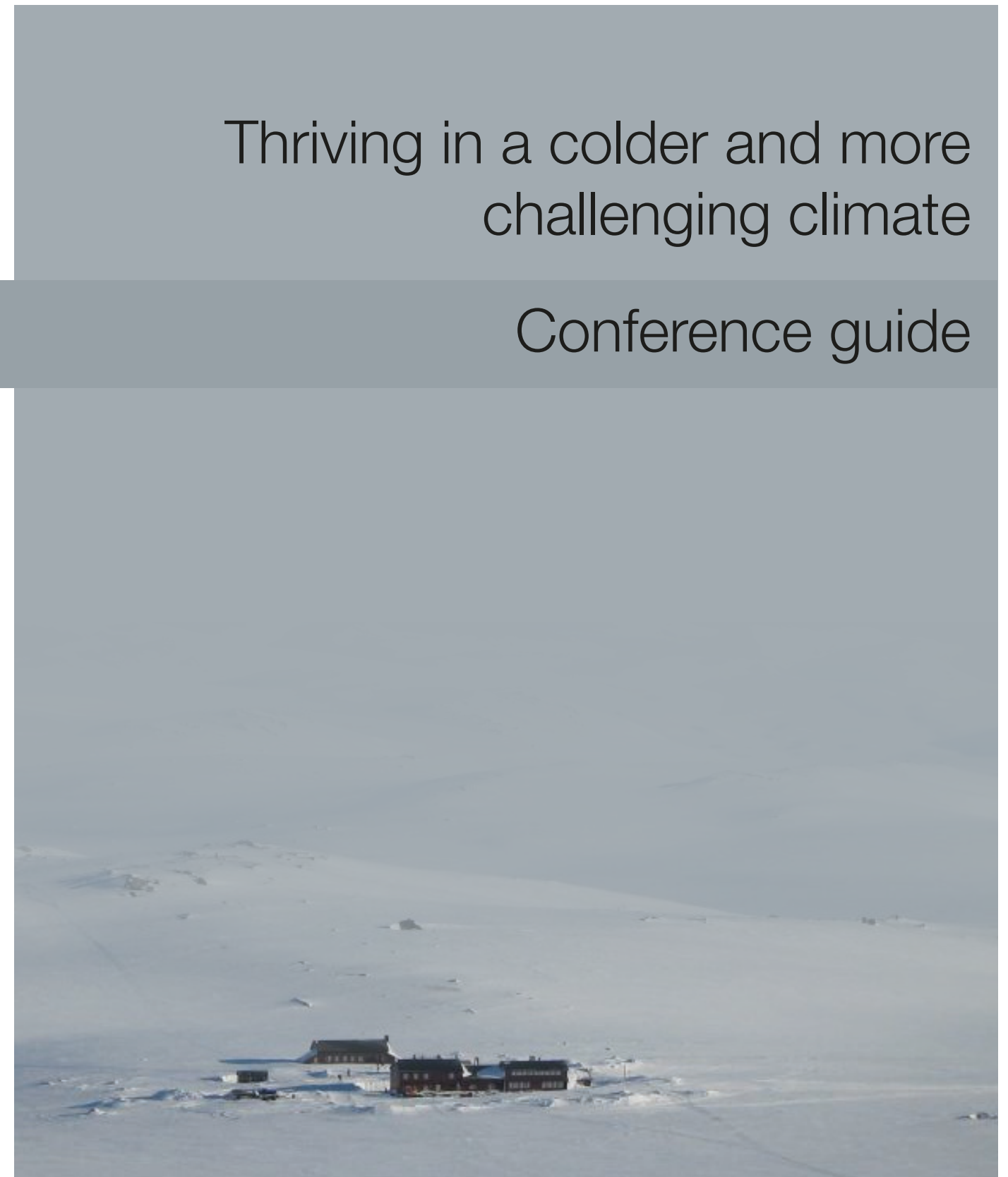

ALT-C 2011

Thriving in a colder and more challenging climate

Conference guide

- 2** Welcome to ALT-C 2011
- 3** Statement of support from Rt Hon David Willetts, MP, Minister of State for Universities and Science
- 4** The ALT staff team and a note of thanks
- 5** ALT-C 2011 Programme Committee
- 7** Major sponsors
- 8** Keynote speakers
- 9** Invited speakers
- 12** Conference publications
- 13** Conference social programme & ALT events and meetings
- 14** Exhibition hall
- 15** Organisers – Association for Learning Technology (ALT)
- 15** Exhibitors
- 19** ePoster information
- 20** Conference information
- 23** Map: main conference area – University of Leeds
- 24** Map: University of Leeds Campus

Acknowledgements

Production editing by Anna Davidge, ALT

Design by Jamie Shaw

Cover design by Jamie Shaw

Printed by Tewkesbury Printing Company Limited

Registered Charity Number 1063519

With the exception of sponsor logos, the ministerial statement, the maps and floor plans the material in this conference guide is copyright The Association for Learning Technology (ALT) – www.alt.ac.uk – but licensed under a Creative Commons Attribution-NonCommercial-ShareAlike 2.0 UK: England and Wales license, see <http://creativecommons.org/licenses/by-nc-sa/2.0/uk>

Copyright of the editorial and the individual papers remains vested with individual authors and/or their institutions, but all are licensed under a Creative Commons Attribution-NonCommercial-2.0 UK: England and Wales license, see: <http://creativecommons.org/licenses/by-nc-nd/2.0/uk>

This document is available online at <http://repository.alt.ac.uk/2163>

Welcome to ALT-C 2011

Right now you can tell if a person is on the Internet, by looking at him or her, because the devices that connect to the Internet are big enough to be seen. But just as you can now no longer tell whether a person is on the phone or talking to themselves, so, soon, you will simply not know whether someone is using the Internet. Similarly, you can't tell by looking if a person operating the checkout counter in a supermarket knows arithmetic or not. Some now argue that arithmetic is becoming an outdated life skill, like swordplay or horse riding.

We are entering a world where it will be difficult, maybe impossible, to tell whether a person is educated or not. At the same time, education world-wide is undergoing a massive transformation as a result of the digital revolution that is mediating adaptations in terms of structures, agency and cultural practices.

This transformation is similar to the transition from apprenticeship to universal schooling that occurred in the 19th century as a result of the industrial revolution. In the apprenticeship era, most of people's learning occurred outside of school.

Universal schooling led people to identify learning with school; however, today the identification between the two is unravelling. The central challenge is to ascertain whether our current sites of formal learning will be able to adapt and incorporate the new power of technology-mediated learning for the next generation of public schooling and education in further, higher and adult contexts.

So is the climate cold? It depends who is asking the question, who is doing the positioning! Is education as we know it, an outdated idea? Or is there scope for adaptation?

The six themes of ALT-C 2011 are:

- research and rigour;
- making things happen;
- broad tents and strange bedfellows;
- at the sharp end;
- teachers of the future;
- preparing for a thaw.

Within the framework provided by these themes, we are confident that ALT-C 2011 will rise to the challenge of describing and debating how new ways of learning, and new structures, modes of human agency and practices are transforming the environment for learning.

The scope for people in our community to make a difference is great.

Co-Chairs, ALT-C 2011 Programme Committee



John Cook Professor of Technology Enhanced Learning at the Learning Technology Research Institute, London Metropolitan University



Sugata Mitra Professor of Educational Technology at Newcastle University and Visiting Professor at MIT Media Lab



Statement of support from Rt Hon David Willetts, MP, Minister of State for Universities and Science

It gives me great pleasure to record, once again, my support for the Association for Learning Technology.

Its members use ICT for the right reasons: to provide students with access to the best learning resources; to prepare them for a predominantly digital world; and to help universities, colleges and other providers thrive in an increasingly competitive educational environment.

I wish every success to the delegates gathering at this year's conference in Leeds.

A handwritten signature in black ink that reads "David Willetts". The signature is written in a cursive style.

BIS | Department for Business
Innovation & Skills

The ALT staff team and a note of thanks

Shown below is the current ALT staff team, all of whom have played a part in the production and organisation of the conference over the last 18 months. John Slater led on the overall content of the conference, and Maren Deepwell on the organisation. Anna Davidge played a key role in the production of the conference materials, and Liz Wyatt handled bookings. Celia Gough dealt with finances.

Most of us will be in Leeds for most of the conference. Though we may sometimes seem distracted, do not let this stop you buttonholing any of us.

For the last few years we've managed annually to improve the conference. We hope that ALT-C 2011 will match or exceed the quality of previous conferences, and that you will appreciate various changes including:

- a better implementation of the conference programme in the CrowdVine networking site;
- a move to Pecha Kucha short presentations in place of posters;
- a reduction in the amount of printed materials;
- improved presentation of the "back-channel", including through Twitter;
- a more inclusive Gala Buffet Dinner, which all delegates present on Wednesday 7 September are entitled to attend;
- ALT-C Live Beta, our first foray into live broadcasting from the conference.

A note of thanks

Four groups deserve ALT's particular thanks. Firstly, the conference sponsors – whose names and logos are shown on page 7 – without whose financial contribution the conference would not take place. Secondly, the conference programme committee – see page 5 – whose extensive voluntary activity as reviewers and editors is crucially important. Thirdly, the very wide range of people who have "speaking parts" at ALT-C, including the conference co-chairs, the keynote and invited speakers, and, most of all, every individual presenter. Finally the staff in the conference team at the University of Leeds and the staff and student of Leeds College of Technology who are responsible for the production and service of the Gala Buffet Dinner.



Seb Schmoller Chief Executive



Anna Davidge
Interim Administration Officer

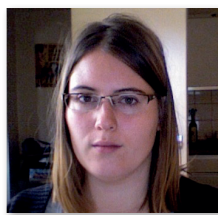

Maren Deepwell
Operations and Services Manager



Celia Gough
Interim Finance Manager



Seb Schmoller
Chief Executive



John Slater
Acting Director of Development



Liz Wyatt
Administration Officer

ALT-C 2011 Programme Committee

Co-Chairs



John Cook Professor of Technology Enhanced Learning at the Learning Technology Research Institute, London Metropolitan University



Sugata Mitra Professor of Educational Technology at Newcastle University and Visiting Professor at MIT Media Lab

Research Proceedings editors

David Hawkrige University of Leicester and the Open University

Kia Ng University of Leeds

Stevan Verjans Open University of the Netherlands

Abstracts editors

Elizabeth Hartnell-Young Department of Education and Early Childhood Development, Australia

Laurence Habib Oslo University College

Mark Johnson Bolton University

Tina Wilson The Open University

Web participation coordinators

James Clay Gloucestershire College

Juliet Culver Open University

Matt Lingard London School of Economics

Thom Cochrane Unitec, New Zealand

Committee members

Tom Abeles Sagacity, Inc., USA

Joe Allen Queen's University Belfast, Northern Ireland

Ana Maria de Almeida University of Coimbra, Portugal

Timos Almpanis Southampton Solent University

Kumiko Aoki The Open University of Japan

Jo Axe Royal Roads University, Canada

John Baker Desire2Learn, Canada

Bob Banks Tribal Group

Trevor Barker University of Hertfordshire

Sarah Bartlett Talis Ltd

Hans-Peter

Baumeister Reutlingen University, Germany

Liz Bennett University of Huddersfield

Adriana Berlanga Open University of the Netherlands

Miles Berry Roehampton University

Tim Bilham University of Bath

Andy Black

Haydn Blackey University of Glamorgan, Wales

Alex Bols National Union of Students

Alexandre Borovik University of Manchester

Patris van Boxel VU University Amsterdam, Netherlands

Mark Brown Massey University, New Zealand

Kevin Burden University of Hull

Alan Cann University of Leicester

Linda Castaneda Universidad de Murcia, Spain

James Clay Gloucestershire College

Thom Cochrane Unitec, New Zealand

Fiona Collard University of Gloucestershire

Patrick Craven Cambridge Assessment

Juliette Culver The Open University

Adele Cushing City and Islington College

Matt Dean Association of Colleges

Lesley Diack Robert Gordon University, Scotland

Martin Ebner Graz University of

Technology, Austria

Nigel Ecclesfield Learning and Skills Improvement Service (LSIS)

Shirley Evans Inclusive Learning Advisory Services Ltd

Malcolm Field Hakodate Future University, Japan

Janet Finlay Leeds Metropolitan University

Manuel Frutos-Perez University of the West of England

Alex Furr University of Southampton

Devampika Getkahn London School of Business and Finance

Lisa Gray JISC

Jonathan Grove Futurate Software Services Ltd

Laurence Habib Oslo University College, Norway

Marion Hall The Open University

Mohammad Hamarsheh West Bank, Palestine

Helen Harrop Sero Consulting Ltd

Elizabeth Hartnell-Young Department of Education and Early Childhood Development, Australia

David Hawkrige University of Leicester, The Open University

Michelle A. Hoyle University of Sussex, The Open University

Sandra Huskinson Loughborough University, University of Leicester

Ersun Iscioglu Eastern Mediterranean University, North Cyprus

Jose Janssen Open University of the Netherlands

Nick Jeans Sero Consulting Ltd

Amanda Jefferies University of Hertfordshire

Mark Johnson University of Bolton

Sue C Jones King's College London

Ajitha Nayar K Indian Institute of Information Technology and Management, India

Helen Keegan University of Salford

Jacquie Kelly JISC infoNet

Ayse Kok

Rita Kop National Research Council of Canada, Canada

Kevin McLaughlin Old Mill Primary School, Broughton Astley, Leicestershire

Philippa Levy University of Sheffield

Ann Liggett Nottingham Trent University

Matt Lingard London School of Economics

Styliani Kleanthous Loizou University of Leeds

Brenda Mallinson South African Institute for Distance Education, South Africa

Adam McMillan Waikato Institute of Technology, New Zealand

Rashid Mehmood Swansea University, Wales

Virendra Mistry University of Glamorgan, Wales

Terumi Miyazoe Tokyo Denki University, Japan

Sabine Moebs Dublin City University, Eire

Dick Moore Moore Answers Ltd

Rafael Morales Universidad de Guadalajara, México

Markus Mostert Rhodes University, South Africa

Kia Ng University of Leeds

Xiaopeng Ni Cleveland State University, USA

Ioannis Papadopoulos University of Thessaloniki, Greece

Sandra Partington City University

Anna Peachey Eygus Ltd

Maria Chiara Pettenati University of Florence, Italy

Stephen Powell University of Bolton

Frank Rennie University of the Highlands and Islands, Scotland

Clare Riley Microsoft

George Roberts Oxford Brookes University

Viv Rolfe De Montfort University

Steve Ryan London School of Economics

Dean Sheetz Higher Colleges of Technology, United Arab Emirates

Carol Shergold University of Sussex

Sarah Sherman The Bloomsbury Colleges

Joaquim F. Silva Porto University, Portugal

David Smith Austrian Federal Ministry of Education, Austria

Louise Starkey Victoria University of Wellington, New Zealand

Geoff Stead Tribal Group

Becky Strachan Northumbria University

Helen Tracy Hemsley Fraser Group Ltd

Kathryn Trinder Glasgow Caledonian University, Scotland

Steven Verjans Open University of the Netherlands

Julie Voce Imperial College London

Steve Wheeler University of Plymouth

Tina Wilks Symbiont Ltd, New Zealand

Tina Wilson The Open University

Gail Wilson Southern Cross University, Australia

Denise Wood University of South Australia, Australia

Major sponsors

The trustees of ALT would like to thank the following organisations for their generous support for ALT-C 2011.

1	 Adobe	2	 Blackboard
3		4	
5		6	
7		8	
9		10	 The Positive Internet Company
11	 UNIVERSITY OF LEEDS	12	

- 1 Adobe
- 3 Department for Business, Innovation and Skills (BIS)
- 5 Google
- 7 Intellect
- 9 Pearson
- 11 University of Leeds

- 2 Blackboard
- 4 Desire2Learn
- 6 Intel
- 8 LSIS
- 10 The Positive Internet Company
- 12 Sonic Foundry

Keynote speakers

Miguel Brechner

President of the Uruguayan Centre for Technological and Social Inclusion (CITS)

The educational and social impacts of Plan Ceibal – a new approach to the use of technology in education

Uruguay has deployed more than 450,000 computers to every pupil in state education from the 1st year of primary to the 3rd year of secondary school. 99% of these students now have Internet connectivity in their school.

For example, as soon as all pupils have laptops and connectivity new challenges appear and the personalization of education becomes a real possibility.

Changes also take place in the role of the teacher, in the way learning is assessed, and in the way technology can be used to simplify the learning experience.

Miguel Brechner's talk will report on Plan Ceibal to date, and examine in detail its many social, cultural and educational impacts.



Karen Cator

Director of the Office of Educational Technology at the U.S. Department of Education

Transforming American education: learning powered by technology

The U.S. Department of Education's National Education Technology Plan articulates a bold vision of powerful learning. Creativity and innovation are hallmarks of powerful learning and technology provides an environment for developing these skills. Ms. Cator will convene a discussion of the opportunities and barriers to leveraging technology for improving the opportunity to learn.



John Naughton

Professor of the Public Understanding of Technology, the Open University

The elusive technological future

Many of the most important technological developments in computing and networking have come as surprises – pleasant and/or unpleasant – to professional communities and commercial organisations, including those which are supposed to know what the future holds. How does this happen? Why are we so bad at anticipating the technological future? And what would we need to do to improve?



Invited speakers

Rajeev Arora

Vice President of Marketing and Strategy for Blackboard Collaborate

The ROI of online collaboration: doing more with less

It's an exciting time for education and training. Teaching, learning, and collaboration are evolving from traditional classroom lectures and activities to online courses, collaborative ad-hoc discussions, and easy access to information and experts. To achieve their academic, administrative, and financial goals, today's educational institutions are investing in online collaborative technologies that go beyond web conferencing or the virtual classroom to also facilitate the business of education. The time has come to blend pedagogy with sound business decision-making. Learning for the digital age must be less structured and more informal, self-enabled, interactive, and collaborative. The early success of new tools, like social networks, video, wikis, podcasts, IM, and more, show a demand for learner-driven education. At the same time, educators are resource constrained and must economically find and leverage relevant content and peer expertise to develop new practices with these 21st century tools—while maintaining high-quality teaching and learning. On an organizational level, a collaborative approach can help increase competitive advantage, drive peer-to-peer learning and engagement, support strategic planning and decision making, and enhance productivity for faculty and staff. With ever-decreasing budgets, academic institutions and training organizations must balance important educational impacts with bottom-line revenue implications, including a rapid return on their investment in technology. Hear how educational organizations at all levels are implementing integrated collaborative technologies that enable them to:

- Enhance teacher effectiveness and learning experiences;
- Increase learner comprehension, engagement, and satisfaction;
- Increase retention and completion rates;
- Facilitate adoption of learning technologies;
- Increase operational efficiency and productivity;
- Leverage existing technology investments;
- Reduce travel and physical infrastructure costs.

Jo Axe

Associate Dean in the Faculty of Management at Royal Roads University, Canada

Opening our bridge: purpose, process, and pedagogy

Open Educational Resources (OER) can support sharing amongst educators by providing free access to teaching and learning tools. Royal Roads University in British Columbia, through funding support from BC Campus, was involved in a project that resulted in opening several of the university's online courses. The Bridge to BCom is one of the most recent examples. This online course was originally developed in 2006 to provide an environment in which incoming students could begin the development of an on-campus learning community. Jo will provide an overview of the most recent version of the course, as well as discuss the process taken in converting it to an OER.



Anne-Marie Cunningham

Clinical Lecturer and Academic Lead for eLearning in the School of Medicine at Cardiff University



On being public... how social media reshapes professional identity

Social media has created opportunities for all of us to spend a lot more time in public than we used to. Professionals who have grown used to working in confined spaces, with distinct boundaries, are learning how to be in the digital world at large. In the past three years I have inhabited these spaces as a professional in public: an educator and a doctor. What are the opportunities and challenges this has brought me? I will describe my personal journey, but consider the wider implications for professional identity of increasing opportunities, and sometimes pressure, to maintain a public profile.

Dr. Dónal Fitzpatrick

Lecturer at the School of Computing at Dublin University

I have a blind student in my maths/science class, should I panic? How to promote inclusion for blind students

For many students the realisation that mathematics and science are part of the curriculum engenders panic, worry and (let's be honest) downright fear. These emotional responses are exacerbated in the case of blind learners who, because of a lack of access to tools and technologies to help them, are somewhat marginalised when it comes to taking courses in these areas. The presence of a blind student in a class, whether said class is provided in person or virtually, often elicits the same reactions in the person giving the class. Phrases like "how will I present my material", "how will I get my message across" or "how will I read their homework" are questions which I often have to deal with. In this talk, I aim to show how a blind learner can approach the study of Science, Technology, engineering and Mathematics, and more importantly, to attempt to outline some strategies for teaching this information in a manner which is accessible and inclusive.

Josie Fraser

ICT Strategy Lead (Children's Capital) Leicester City Council



The city as the learning environment: making change happen in Leicester's schools

Josie Fraser works for Leicester City Council, which is rebuilding or remodelling each of the secondary schools in the city. Her role is to ensure that the investment made in technology supports the City's aspirations, which are to:

- create school environments in which young people feel engaged and believe in themselves;
- provide teachers with world-class learning environments in which they too feel valued and inspired;
- root schools in the centre of their communities so that they become hubs that help revitalise areas.

Josie will talk about:

- the current social, economic and technological drivers shaping learning technology in the schools sector;
- the city-wide strategy and the practical steps that will transform learning with technology;
- what Leicester's young people have told the council about their own technology priorities.

Malcolm Read

Executive Secretary of JISC

JISC's support for learning and teaching in a changing educational environment

JISC has helped promote significant innovation in learning and teaching over the past ten years. This talk will focus on how we can help institutions improve student satisfaction through the effective use of ICT in the changing HE and FE environment. Topics to be covered will include improving student feedback, e-assessment and the growing value of open educational resources. This will also be placed in the context of the creation of a new JISC as a separate legal entity and our planned work in support of learning and teaching over the next few years.



Gilly Salmon

Chair of ALT and Executive Director and Professor of Learning Futures at the Australian Digital Futures Institute at the University of Southern Queensland

Well, the kookaburras thought it was funny anyway! Gilly Salmon explores innovation in UK and Australian Higher Education

Kookaburras are best known for their unmistakable call, which sounds uncannily like loud, echoing human laughter; good-natured, but rather hysterical. Have you heard it around your university? Kookaburras adapt to a wide variety of wild and human habitats. They are feted by Australian people, (the first owners of the land as well as settlers) for their ability to kill snakes (as well as, more recently, pre-dead barbecue meat!). Gilly Salmon shares pictures, stories and kookaburras from dipping and diving in search of innovation in UK and Australian Higher Education. She identifies some 'snakes' that she was considering offering up. She marks out some similarities, differences and lessons for the future...



Ewart Wooldridge

Chief Executive of the Leadership Foundation for Higher Education

Leadership in a cold climate. Leading where the past is no reliable guide to the future. A reflection on the strategic leadership of people, technology and institutions in UK HE

Ewart Wooldridge will focus on the potential discontinuity of change facing universities across the UK as a result of funding and legislative measures of governments. In that scenario, we have to 'unlearn' old ways of thinking – about how we see technology in the context of strategic leadership, and about how we stimulate new ways of being entrepreneurial, collaborative and efficient. The session will take delegates through a way of categorising our responses to such major drivers of change. It will offer a new model of leadership for universities. Ewart will draw on an extensive programme of research conducted by the Leadership Foundation over the last 7 years and his own intensive practical experience of leadership in this and many other sectors.



Yangka

Director (Academic Affairs), Royal University of Bhutan, Bhutan

At time of publication the abstract for this session was not available.



Conference publications

Conference Guide

This guide is itself available online as a PDF at: <http://repository.alt.ac.uk/2163>.

Conference Proceedings

You will have received a printed copy of the Proceedings for ALT-C 2011 on your arrival, if you chose this option when you booked.

The Proceedings are available as a PDF at: <http://repository.alt.ac.uk/2159>.

Individual papers are available online in HTML, PDF, EPUB, and MOBI format at: www.alt.ac.uk/alt-conference/alt-c-2011/conference-proceedings.



Conference Abstracts

The Abstracts for ALT-C 2011 are published as an electronic document only and are available as a PDF at: <http://repository.alt.ac.uk/2160>. The abstracts are also available on the conference CrowdVine site at <http://altc2011.alt.ac.uk>.

Within the Conference Abstracts, each abstract has the following layout:

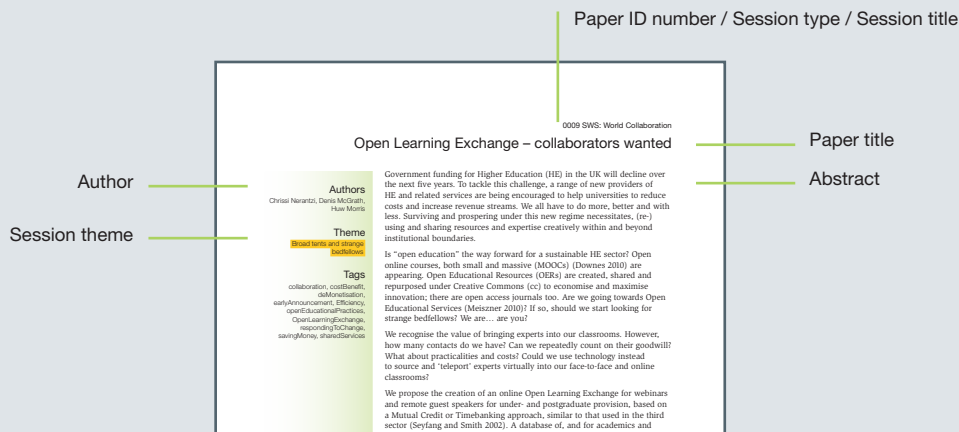

Programme timetable

This year we will be supplying the Programme Timetable as a separate handout with your delegate materials, it will also be accessible from a tab on the conference CrowdVine site at <http://altc2011.alt.ac.uk>.

Within the Programme Timetable, each session has the following graphical layout:

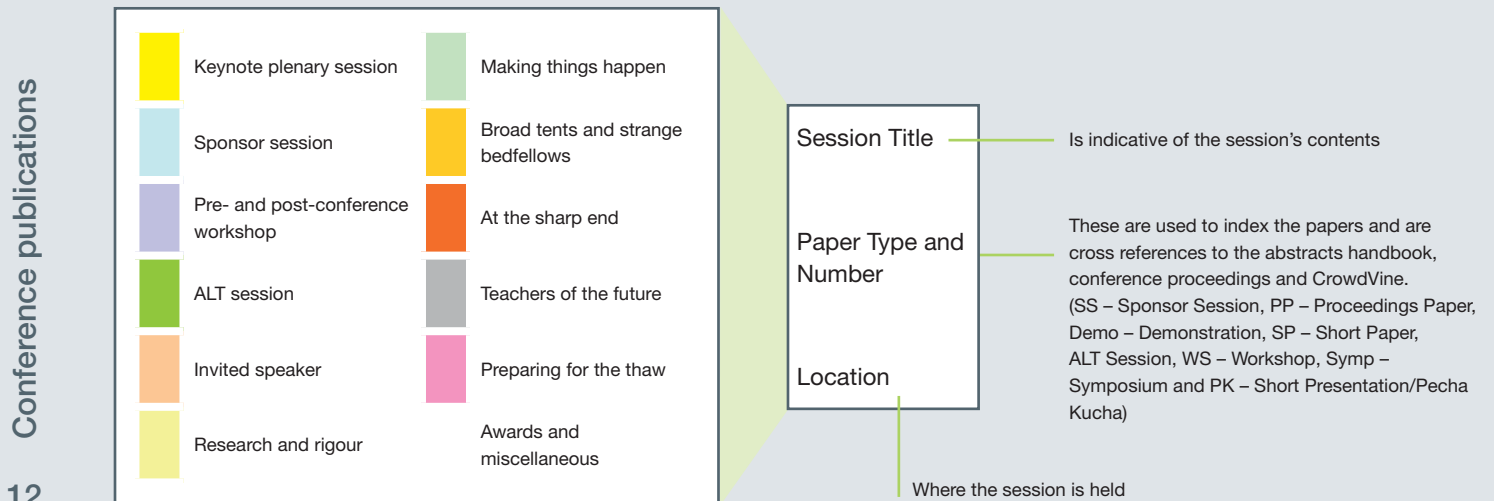

Conference social programme

Monday 5 September

19:30 onwards **Pre conference reception**
We will mark the opening of the exhibition and start of the conference with a buffet for delegates and exhibitors taking place in the Exhibition Hall.

Tuesday 6 September

18:20 onwards **ALT New Members' reception**
Our annual reception for new members will take place from 18:20 in the Exhibition Hall gallery.

19:00 onwards **Evening meal & drinks in the Terrace Bar**
An evening meal will be available, served in the Exhibition Hall, for those who requested it when they booked. After the meal we will move to the Terrace Bar for drinks (cash bar) and entertainment.

Wednesday 7 September

19:30 onwards **Gala dinner buffet**
This year the gala dinner buffet will be served on campus at 19:30 and will showcase regional student talent as in previous years. The winners of the Learning Technologist of the Year, Best Paper and Poster Awards, the ALT-Epigeum Award and the Jorum Learning and Teaching Competition will also be announced at the end of the dinner.

Thursday 8 September

13:00 onwards **Close of conference lunch**
'Lunch in a bag' will be provided before departure to those who requested it when they booked.

ALT events and meetings

Tuesday 6 September

11:40 – 12:40	Welcome to ALT-C; Explore ALT (0405, 0406)	ALT stand, Exhibition Hall
17:30 – 18:20	Inclusive Learning Special Interest Group Meeting (0421)	ECS SR 9.90
17:30 – 18:20	Video in Education Special Interest Group Meeting (0422)	ECS SR 8.60
17:30 – 18:20	Policy and Critical Theory Special Interest Group Meeting (0426)	ECS SR .62
17:30 – 18:20	Getting Involved with ALT (0401)	ALT stand, Exhibition Hall
17:30 – 18:20	Learning Environment Review Special Interest Group Meeting (0423)	ECS SR 7.70
17:30 – 18:20	Regional SIG Session (0424)	ECS SR 7.73
17:30 – 18:20	Games and Learning Special Interest Group Meeting (0425)	ECS SR 7.83

Wednesday 7 September

12:00 – 13:00	Find out about CMALT (0410)	ECS SR 8.90
15:05 – 15:40	18th ALT Annual General Meeting (0312) All individual members and the representatives of organisational and sponsoring members are warmly invited to this brief but important meeting.	Conference Auditorium 1
16:45 – 17:45	Annual Certified Members' Meeting (0409)	ECS SR 7.83

Thursday 8 September

09:00 – 10:00	Meet ALT Members (0411)	ALT stand, Exhibition Hall
10:30 – 11:30	Keep in Touch with ALT (0412)	ALT stand, Exhibition Hall
13:50 – 14:50	ALT Central Executive Committee Meeting	

Exhibition hall

The Exhibition hall is the main hub of the conference where most meals will be served and where refreshments are available throughout the conference. Registration, the cloakroom and the Conference Helpdesk are also located here. Comfortable seating and a quiet zone are located in the Exhibition Hall Gallery.

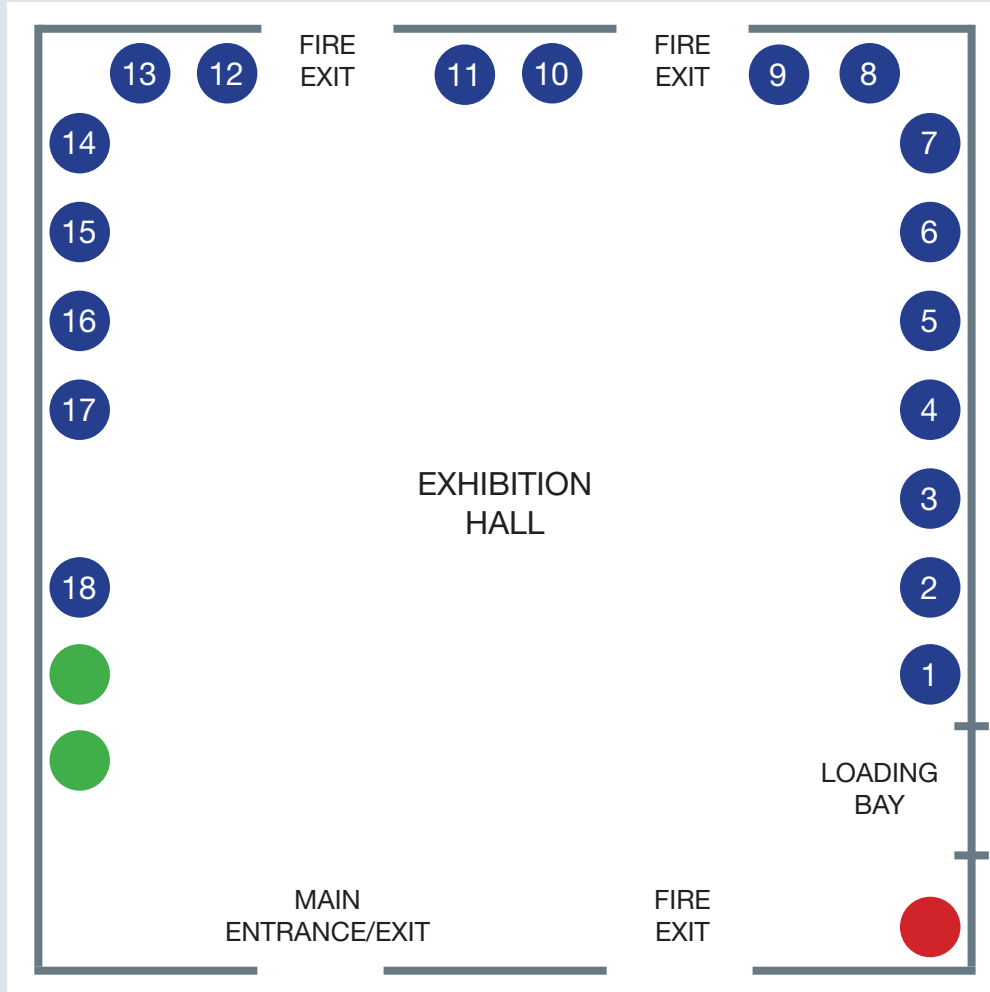

- | | | |
|--|--|--|
|  ALT & ALT Live stands |  Helpdesk & Cloakroom | |
|  1 Blackboard Collaborate |  7 Support Centre for Open Resources in Education (SCORE) |  13 Extegrity Exam4 |
|  2 Blackboard |  8 Pearson |  14 PebblePad |
|  3 Blackboard Connect/txtools |  9 Learning Objects Inc |  15 Google |
|  4 JISC |  10 Desire2Learn UK |  16 Moodlerooms Inc |
|  5 Jorum |  11 Desire2Learn UK |  17 Adobe |
|  6 Turning Point |  12 LSIS |  18 Technology Enhanced Learning (TEL) Research Programme |

Exhibition hall

14



Organisers – Association for Learning Technology (ALT)

www.alt.ac.uk

ALT-C is the annual conference of the Association for Learning Technology (ALT), a professional and scholarly association for individuals and organisations with an interest in the use of learning technology. We have over 200 organisational and over 850 individual members. As well as ALT-C, we run CMALT (a certification scheme for learning technologists), one-day conferences and regular workshops on practical aspects of learning technology. Our publications include policy responses, a fortnightly emailed digest, a quarterly printed update, an online newsletter and an international journal, Research in Learning Technology.

Exhibitors

1

Blackboard Collaborate www.blackboardcollaborate.com

Blackboard Collaborate is a leading global provider of learning and collaboration solutions for Higher Education. The Blackboard Collaborate™ platform delivers web conferencing, enterprise instant messaging and voice authoring capabilities for blended education, that bridge technology and pedagogy by enabling a rich and engaging environment between students and academics.

Online collaboration can help universities to achieve their strategic objectives and improve competitiveness by:

- Developing new revenue opportunities;
- Reducing costs and delivering operational efficiencies;
- Enhancing the student experience;
- Improving student completions and outcomes;
- Supporting greater engagement with partners and industry.

2

Blackboard www.blackboard.com

Blackboard works with our clients to develop and implement technology that improves every aspect of education. We enable clients to engage more students in exciting new ways, reaching them on their terms and devices – connecting more effectively, keeping students informed, involved, and collaborating together. Through this innovative technology, services and expertise we work with our clients to build a better education experience.

3

Blackboard Connect/txttools www.txttools.co.uk

Blackboard Connect is a powerful, messaging tool that allows you to send voice, SMS and e-mail to your entire community in an instant. Connect will allow you to reach your community when it matters most. Millions of messages can be delivered to landlines, mobile phones and email addresses in minutes.

txttools allows you to send and receive SMS txt messages to multiple people (or an individual) in an instant using your computer. Two way communication that is quick, to the person, to the point, secure and cost effective. You can schedule messages to go later in the day, week, month or year.

JISC www.jisc.ac.uk

JISC works with college and university staff to support their use of digital technologies and explore how they can be used in education and research. JISC shares its expertise through a range of specialist services providing information, advice and training, a trusted technical infrastructure and access to a wealth of digital resources.

Speak to us on the JISC stand and participate in JISC conference sessions to find out how technology can help improve digital literacy, assessment and access to open educational resources in your college or university.

More information about JISC activities at the conference is available from our website.

4

Jorum www.jorum.ac.uk

Jorum provides access to thousands of free learning and teaching resources, available under Creative Commons (CC) licences, and created and shared by the UK Further and Higher Education community. Visit the Jorum stand to see our collection of Open Educational Resources (OER), and find out about recent Jorum developments; you can also explore ways of engaging with Jorum by sharing your resources, utilising the Jorum widgets and discussing other benefits with members of the Jorum team. Further information will be available on this year's Jorum Learning and Teaching Competition, with resources to be showcased and prizes awarded during the conference.

5

Turning Point www.turningtechnologies.co.uk

Don't assume...Ask!

Engaging your group is a piece of cake with TurningPoint®, the award-winning interactive response system that loves making Microsoft® PowerPoint® engaging, interactive and fun. TurningPoint allows your group to share their opinions during your session and it's got some very impressive reporting tools too! The point? People just like you are using TurningPoint to make their lessons, conferences, team meetings, consultancy sessions and social events more interactive! Come and see us at the ALT Conference to find out how organisations like yours are already enjoying the benefits of TurningPoint.

6

Support Centre for Open Resources in Education (SCORE) www.OpenEd.ac.uk

SCORE, the Support Centre for Open Resources in Education, supports both the creation and use of Open Educational Resources (OER) in universities and colleges. Visit our stand to find out more about what SCORE can do for you including workshops on a wide range of OER topics, short-term fellowships to get the skills you need to become an OER practitioner and advice on how to use OER to support you in your professional practice.

7

Pearson www.pearsonplatforms.info

Pearson works with educators to understand their priorities and develop programmes that are tailored to meet their specific needs. Our expertise covers the full range of educational services and can demonstrate knowledge in delivering tried and tested solutions customers rely on everyday.

8

Please visit the Pearson exhibit stand to learn more about our collaborative teaching and learning solutions for online and blended learning environments. Our award-winning educational technologies from EQUELLA, Fronter, Pearson LearningStudio and MyLabs are used by millions worldwide because we ensure our products are easy-to-use, and deliver measureable success.

9

Learning Objects Inc www.learningobjects.com

Campus Pack, powered by Learning Objects, Inc., is a marketplace for social learning applications that engage learners, increase student retention, and seamlessly integrate into any eLearning environment. Selected applications in the Campus Pack bundle include:

- Social media assignments and activities;
- Portfolios;
- Personal Development Plans;
- Social Network and Academic Commons.

10

11

Desire2Learn UK www.Desire2Learn.com

Desire2Learn Incorporated is a world-leading provider of enterprise eLearning solutions that enable institutions and other organisations to create teaching and learning environments that reflect their vision, values, goals, and branding. Desire2Learn and its subsidiaries support more than six million learners worldwide. Clients include higher education, schools, and healthcare, as well as associations, government and other leading organisations. Founded in 1999, Desire2Learn has personnel in the United States, Canada, the United Kingdom, and Australia. For more information, visit: www.Desire2Learn.com, call 1.519.772.0325 or toll-free 1.888.772.0325 (within North America), +44 808.234.4235 (U.K. and Europe), 0.800.452.069 (New Zealand) and 1.800.656.210 (Australia).

12

LSIS www.lsis.org.uk

The Learning and Skills Improvement Service (LSIS) is a sector-owned and sector-led body driving the development of excellent and sustainable provision in learning and teaching through further education and skills providers. Working alongside its educational partners, LSIS devises new approaches to improvement which build upon the sector's own capacity and innovation to design, commission and deliver quality services and strategic change.

LSIS also initiates research, disseminates policy information, runs seminars and conferences and provides dedicated online leadership, organisational development and teaching and learning resources, in order to inform institutional improvement through the sharing of information and best practice.

13

Extegrity Exam4 www.exam4.com

Extegrity Exam4 is exam software purpose-built for high-stakes essay exams. It provides a secure workspace for long-form typed answers on student- or school-owned computers (both PC and Mac), saves and backs-up work frequently, encrypts all files, and does not allow re-entry to a closed exam. Streamlined administrative utilities support file collection and printing. Features include a secure multiple choice system, a very flexible web-based take-home exam system, batch printing to PDF, and more. Exam4 is a settled, mature product that has protected well over 2 million exams since 2001 and is used by one third of US law schools.

PebblePad www.pebblepad.co.uk

PebblePad is much more than an e-portfolio. It is an award-winning personal learning system being used in a wide range of learning contexts in universities and by professional bodies. PebblePad supports learners, teachers and assessors by providing structure, streamlining processes and supporting timely access to work. To find out more, visit our exhibition stand for a chat about PebblePad and our newly released book, *Pebblegogy*, highlighting pedagogically sound learning activities you can use with your learners.

14

Google www.google.com/apps/edu

Google's mission is to organise the world's information and make it universally accessible and useful. Beginning in 1996, Stanford University graduate students Larry Page and Sergey Brin built a search engine that used links to determine the importance of individual web pages. By 1998, they had formalised their work, creating the company that you know today as Google. From offering search in a single language, we now offer dozens of products and services in scores of languages. Google Apps for Education – used by more than 12 million students – offers a free (and ad-free) set of customisable tools that enable teaching staff, other staff and students to work together and learn more effectively.

15

Moodlerooms Inc. www.moodlerooms.com

Moodlerooms provides educators and learners across the globe with proven e-learning solutions that are flexible, reliable and affordable. By combining Dell Cloud Hosting, Managed Open-Source, and SaaS delivery, Moodlerooms' customers receive the benefits of open-source Moodle with the comfort and assurance that comes from enterprise-level services. With an unwavering commitment to creating a more effective and engaging education community, Moodlerooms is the CHANGE you want e-learning to be.

16

Adobe www.adobe.com

We help our customers create, deliver, and optimize compelling content and applications – improving the impact of their communications, enhancing their brands and productivity, and ultimately bringing them greater business success. Together, we're turning ordinary interactions into more valuable digital experiences every day, across media and devices, anywhere, anytime. We offer our customers solutions in three critical endeavours: content authoring, customer experience management, online marketing.

17

Technology Enhanced Learning Research Programme www.tel.ac.uk

The Technology Enhanced Learning (TEL) Research Programme is a £12m initiative funded by the Economic and Social Research Council and Engineering and Physical Sciences Research Council (UK). We have eight major interdisciplinary projects running between 2007 and 2012. We aim to understand and develop the roles of digital technologies in improving the quality of learning and teaching. The project is led by Professor Richard Noss at the London Knowledge Lab, Institute of Education, London.

18

ePoster information

The award for the best ePoster will be decided by an online vote open to conference delegates and to those outside the conference. The URL for the posters will be publicised in the final conference briefing.

Please vote on Wednesday 7 September between 09:00 and 15:00. To vote go to <http://goo.gl/ViIV6>.

This year many ePosters will be accompanied by a short Pecha Kucha presentation in Auditorium 2. These are scheduled in conference sessions between 11:40 on Tuesday 6 September and 10:20 on Wednesday 7 September. This gives a good opportunity to see the format in action and form your own opinion about its effectiveness.

The winner of the best Pecha Kucha award will be announced at the gala buffet dinner on Wednesday evening.

Abstracts for the ePosters are included in the Conference Abstracts.

The timing of the presentations in Auditorium 2 is given by the following table.





Tuesday

ePoster	Time
0024	Tuesday 11:40
0058	Tuesday 11:50
0173	Tuesday 12:00
0225	Tuesday 12:10
0236	Tuesday 12:20
0176	Tuesday 13:40
0177	Tuesday 13:50
0228	Tuesday 14:00
0221	Tuesday 14:10
0241	Tuesday 14:20
0015	Tuesday 14:50
0065	Tuesday 15:00
0110	Tuesday 15:10
0210	Tuesday 15:20
0233	Tuesday 15:30
0031	Tuesday 16:20
0044	Tuesday 16:30
0148	Tuesday 16:40
0224	Tuesday 16:50
0243	Tuesday 17:00
0046	Tuesday 17:30
0076	Tuesday 17:40
0165	Tuesday 17:50
0172	Tuesday 18:00
0197	Tuesday 18:10

Wednesday

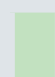
ePoster	Time
0206	Wednesday 09:00
0071	Wednesday 09:10
0249	Wednesday 09:20
0127	Wednesday 09:30
0138	Wednesday 09:40
0092	Wednesday 09:50
0190	Wednesday 10:00

This information is correct at time of press, please refer to the timetable for full details.

	Making things happen
	Broad tents and strange bedfellows
	At the sharp end
	Teachers of the future

Conference information

Conference registration

The registration desks are located in the Exhibition Hall.

Helpdesk and enquiries

All general enquiries should be directed to the Conference Help Desk located in the Exhibition Hall. An IT help desk will also be provided in the Exhibition Hall to help with any IT or wireless Internet-related questions. The telephone number for the IT Helpdesk is +44 (0)113 343 67 67.

We have a team of conference helpers. They are all familiar with the Leeds Conference Centre and its environs and are identifiable by white ALT-C t-shirts. There will also be a member of ALT staff in each of the main areas during conference sessions.

If you need to contact a member of the ALT staff team during the conference, telephone +44 (0)113 343 67 67.

Printing and photocopying

This can be provided (at cost) through the media services shop, open between 9.00am and 4.30pm, Monday to Friday, located on the ground floor of the Roger Stevens building.

Email and internet

Delegates will have access to the University wired and wireless networks. The wireless network provides near complete coverage across the campus and Storm Jameson residence with the JANET roaming service eduroam, available for delegates from institutions signed up to the service.

Eduroam is the recommended service for all conference delegates but for those who cannot use the eduroam service, there is the University of Leeds Wireless network.

Along with the wireless network, the University also provides access to PCs with internet connections in Bragg Cluster, and wired connections in each of the rooms at Storm Jameson.

Food and refreshments

All food and refreshment during the days on which you are booked to attend is included in the cost of registration if you have selected these options at time of booking. For those staying in Storm Jameson Court, breakfast will be served between 07:30 and 09:00 in the Refectory.

In the scheduled breaks tea, coffee, juice, water and biscuits will be available in the Exhibition Hall. A varied menu for lunch will be served from the Exhibition Hall, where seating will be provided.

On Tuesday evening dinner will be served at 19:00 in the Exhibition Hall. The gala dinner buffet on Wednesday evening will be served on campus, in the Refectory, at 19:30. Tickets will be supplied when registering at the conference. Please ensure that you have your ticket with you when you attend the dinner, as you will be asked for this. Thursday's close of conference 'lunch in a bag' will be served in the Exhibition Hall before departure at 13:00.

Special dietary requirements have been catered for according to the information given by delegates when booking to attend the conference. Please make yourself known to the serving staff if you have requested a special diet.

Cloakroom / luggage store

A cloakroom is available in the Exhibition Hall and will be staffed as follows:

Monday 5 September 13:30 – 20:00

Tuesday 6 September 08:30 – 18:00

Wednesday 7 September 08:30 – 18:00

Thursday 8 September 08:30 – 14:00

You may leave your luggage at the cloakroom during the conference and you will be issued with a ticket. Use of the cloakroom is at owner's own risk. Please do not leave valuables or laptops. Please collect items at least ten minutes before closing time.

On Thursday a luggage-drop will be available in the exhibition hall gallery for delegates who would like to depart promptly after the last session.

Fire, medical and other emergencies

If the fire alarm sounds, please evacuate the building immediately via the nearest fire exit. Please wait to be given the "all clear" before re-entering. Please familiarise yourself with the fire procedure posted around the conference centre and accommodation.

Hospital – the nearest emergency department is at the Leeds General Infirmary, telephone +44(0) 113 2432799, which is situated adjacent to the University.

Chemists – Cohen Chemist is situated on Woodhouse Lane across from the Parkinson Building. Boots late night pharmacy, which is open until midnight, is located at Leeds City Train Station.

Health and safety

Accidents, security breaches and other incidents occurring during your stay must be reported immediately to a member of staff in the building. In emergencies call Security via an internal telephone on x32222 or externally on +44(0)113 343 2222 – available 24-hours.

Mobility or other requirements

Leeds University is easily accessible by wheelchair users. If you have not previously notified us of any mobility, sensory or access requirements, please contact a member of the Conference Team as soon as possible.

Car parking

Parking at the University of Leeds is very limited from Monday to Friday and costs £5.00 at the University Main Entrance barrier on Woodhouse Lane.

Security

Delegates are requested to reduce the risk of theft by not leaving valuables unattended on University premises. Subject to statutory rights, neither ALT nor Leeds University will accept responsibility for accidents to delegates while on University property, or for damage to, or loss of, their personal property.

For delegates staying on campus security staff are on duty 24 hours a day. University of Leeds Security can be contacted on +44(0) 113 343 5494. Please take sensible security precautions: keep valuables secure and out of sight and refrain from walking alone at night on campus. You are advised not to leave rooms unlocked or property unattended at any time.

Banks and shops

There are cash points located within the Student Union building situated adjacent to the Refectory on the University campus. There are also several major banks opposite the University main entrance – opening times vary but usually only open Monday to Friday. The nearest Post Office is in the St John's Centre in the City Centre. City Centre shops generally open between 9.00am and 5.30pm Monday to Saturday and 11.00am to 5.00pm on Sundays. Some shops remain open until 7.00pm on Thursdays.

The Student Union building on campus houses a number of shops, bars and coffee bars, a hairdressers and Essentials which is a mini-supermarket selling newspapers, magazines, stationery, drinks, sandwiches, snack and confectionery items.

Sports facilities

Sports facilities, including a pool, squash courts and a climbing wall, are available free of charge to delegates who have booked accommodation on campus. You will be required to show your room key and complete a brief registration document.

Transport

Taxis

Local taxis may be ordered from Streamline Telecabs +44 (0) 113 244 3322 or +44 (0)113 263 0404 or Amber Cars +44(0) 113 231 1366. The journey from the city centre takes around 10 minutes by taxi depending on traffic.

For the Storm Jameson Residence (part of Charles Morris Hall), please request to be taken to corner of **Mount Preston Street and Cromer Terrace**

For the Conference Venue direct, please request **Willow Terrace Road**

Without specific instruction, most taxis will likely drop you off at the Parkinson Building which is a 5–10 minute walk from the other event venues.

Buses

The campus is approximately half a mile from the City Centre on Woodhouse Lane, the A660. The number 1 bus leaves from Infirmary Street, near the City railway station in City Square, to the campus every ten minutes during the day and every half hour in the evening. There are frequent buses from the central bus station including numbers 28, 56, 96, 97. You should get off the bus at the main entrance adjacent to the Parkinson Building.

There is a cheap bus service running every few minutes Monday to Saturday, linking the railway station, City Centre and the south end of the University campus (6.30am to 7.30pm only). Each journey costs 50p. The red bus has City Bus written along the side.

Other useful numbers include:

- National Rail Enquiries: +44(0) 845 748 4950
- Leeds Bradford Airport: +44(0) 871 288 2288
- National Express: +44 (0) 871 781 8178

Participating online

Information about how to participate online will be made available shortly before the conference via <http://altc2011.alt.ac.uk>.

This will include detailed instructions for accessing the wireless network, and will:

- Summarise the current state of play concerning use of CrowdVine, Twitter, Facebook, Elluminate, Adobe Connect, YouTube, Cloudworks, and online voting tools;
- Provide details of the aggregated RSS feed from those who will be blogging about the conference;
- Explain arrangements for those who would prefer to be seated in plenary sessions away from those who are communicating online.

If you are writing about ALT-C 2011 using tools that support tagging, please include the tags `altc2011` or `#altc2011` – depending on context – in what you write.

For obvious reasons these details were being finalised very close to the start of the conference and therefore we have decided not to attempt to summarise them here. We do, however, want to record our special thanks to James Clay, Thom Cochrane, Juliet Culver and Matt Lingard for their extensive work and patient efforts over the last nine months in guiding ALT's planning of this aspect of the conference.

Map: main conference area – University of Leeds

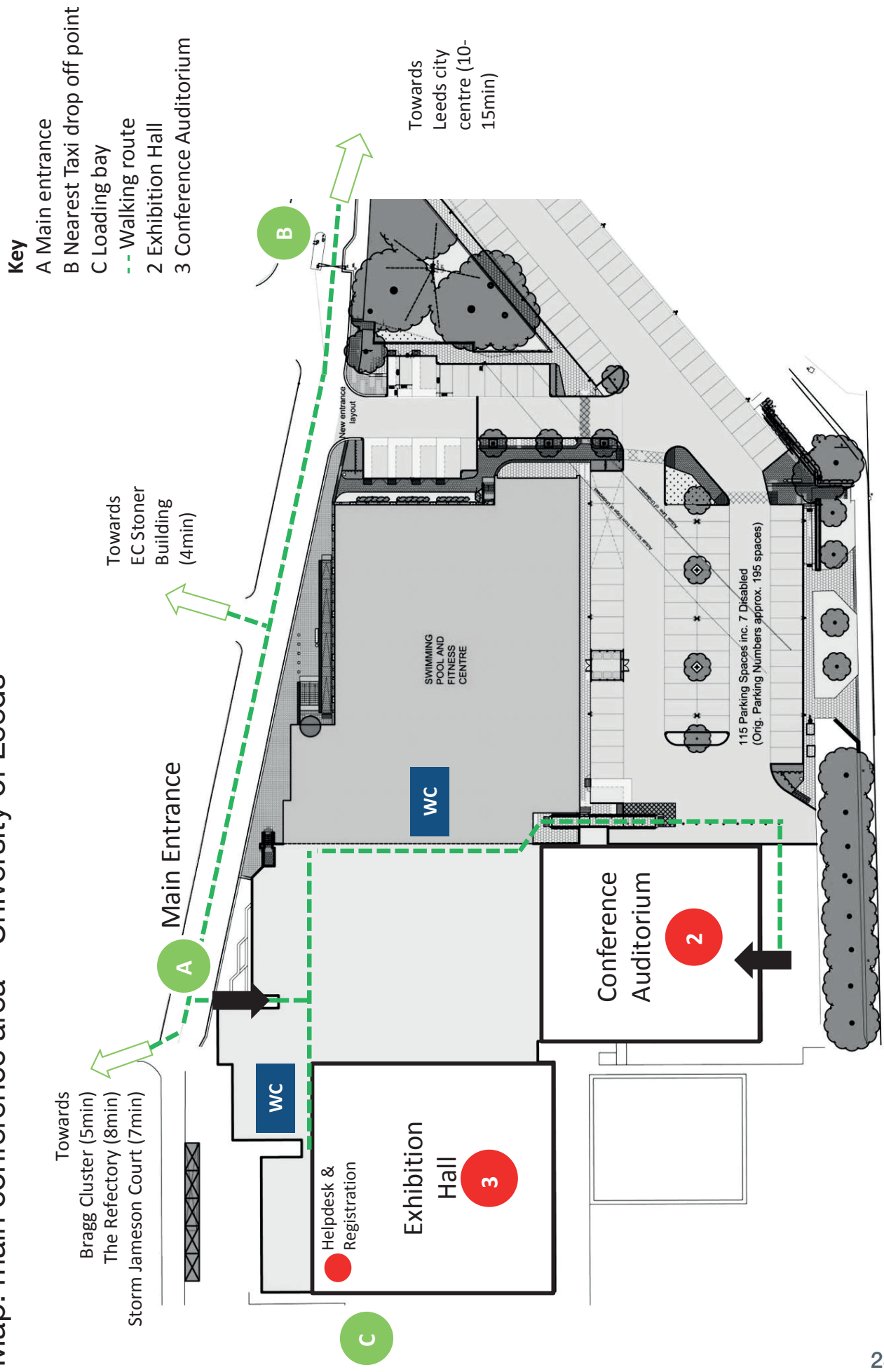

Map: University of Leeds Campus

**MEET
INLEEDS
.CO.UK**

ALT-C 2011

Map of Venues University of Leeds Campus

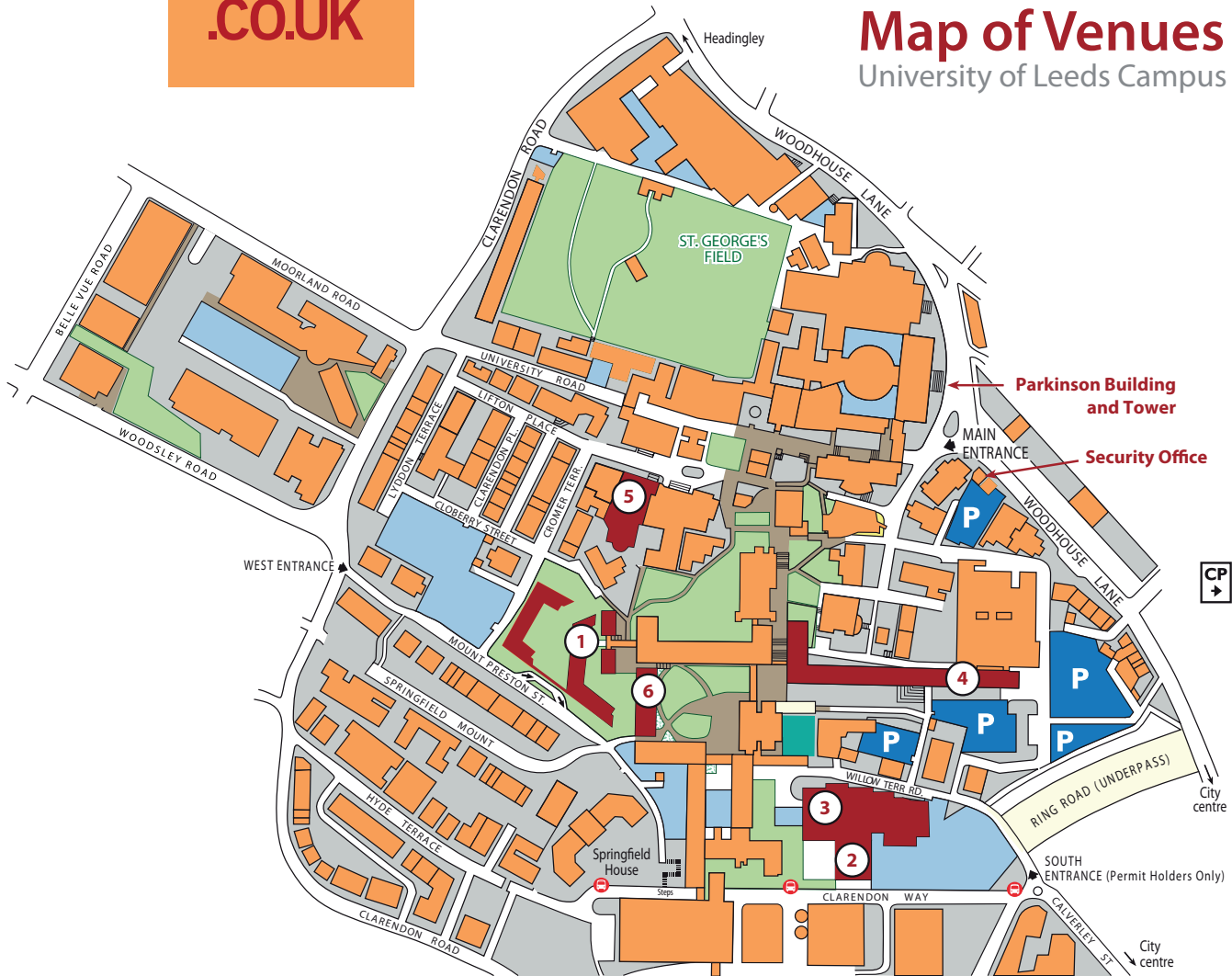

Key

Conference Venues

1. Charles Morris Hall (incl Storm Jameson Court)
2. Conference Auditorium
3. Exhibition Hall and The Edge Sports Facilities
4. EC Stoner Building
5. The Refectory
6. The Bragg Cluster and Staff Centre



Meals & Refreshments



1. The Refectory, Breakfast and Gala Buffet
2. Exhibition Hall, Lunch and Tuesday dinner

Accommodation

1. Charles Morris Hall/Storm Jameson Court

Car Parks

- University visitors' car parks (limited access) 
- Other university car parks 
- Public multi-storey car park 

- City Centre Bus Stop 
- Pedestrian Only Area 
- Lawns 